

Appendix G

Revised Landscape Master Plan and Broadbrush Tree Survey

Application for Permission Under Section
16 of the Town Planning Ordinance (Cap.
131) for Proposed Comprehensive
Development including Flats, Retail and
Community Facilities and Minor
Relaxation of Plot Ratio and Building
Height Restriction in “Comprehensive
Development Area” Zone at Various Lots
in S.D.4 and Adjoining Government
Land, Kau Wa Keng, Kwai Chung
Landscape Master Plan and Broadbrush Tree Survey

Draft | Dec 2025

This report takes into account the particular instructions and requirements of our client. It is not intended for and should not be relied upon by any third party and no responsibility is undertaken to any third party.

293595

Arup Hong Kong Limited
Level 5 Festival Walk
80 Tat Chee Avenue
Kowloon Tong,
Kowloon
Hong Kong
arup.com

Contents

1	INTRODUCTION	3
1.1	Background	3
1.2	Land Use Zoning	3
1.3	Purpose of this report	3
2	SITE DESCRIPTION	4
2.1	Existing Site Context	4
3	EXISTING TREES	5
3.1	Key Findings	5
3.2	Identified Trees with High Value for Priority Preservation	6
3.3	Impacts of Existing Trees	7
3.4	Preliminary Compensatory Tree Planting Proposal	7
4	LANDSCAPE DESIGN PROPOSAL	8
4.1	Landscape Design Objectives	8
4.2	Hardscape Design Proposal	9
4.3	Softscape Design Proposal	10
4.4	Drainage and Irrigation	13
4.5	Provision of Local Open Space and Green Coverage	13

Figures

Figure 1.1	Outline Zoning Plan
Figure 1.2	Tree Survey Plan
Figure 1.3a	Tree Recommendation Plan (With Excavation Layout)
Figure 1.3b	Tree Recommendation Plan (With Building Layout)
Figure 1.4	Compensatory Tree Planting Plan
Figure 1.5a	Landscape Master Plan (Overall)
Figure 1.5b	Landscape Master Plan (Sheet 1 of 2)
Figure 1.5c	Landscape Master Plan (Sheet 2 of 2)
Figure 1.5d	Landscape Master Plan (Ground Floor)
Figure 1.5e	Landscape Master Plan (Podium Floor)
Figure 1.6	Section A-A
Figure 1.7	Section B-B
Figure 1.8	Section C-C
Figure 1.9	Section D-D
Figure 1.10	Perspective 01
Figure 1.11	Perspective 02
Figure 1.12	Perspective 03
Figure 1.13	Perspective 04
Figure 1.14	Local Open Space Provision
Figure 1.15	Calculation of Green Coverage
Figure 1.16	Typical Planter Detail
Figure 1.17	Elevation 1
Figure 1.18	Landscape Master Plan (Interim Scenario)
Figure 1.19a	Section A-A'
Figure 1.19b	Section B-B'
Figure 1.19c	Section C-C'

Appendix

Appendix A	Tree Assessment Schedule
Appendix B	Tree Survey Photo Record
Appendix C	Detailed Assessment for the Trees with High Value for Priority Preservation

1 INTRODUCTION

1.1 Background

- 1.1.1 This report presents the Landscape Master Plan (LMP) submission which forms part of the Supporting Planning Statement in support of the Section 16 (S16) Planning Application for Proposed Comprehensive Development including Flats, Retail and Community Facilities and Minor Relaxation of Plot Ratio and Building Height Restriction in “Comprehensive Development Area” Zone at Various Lots in S.D.4 and Adjoining Government Land, Kau Wa Keng, Kwai Chung (the Application Site).
- 1.1.2 The LMP intends to demonstrate the overall landscape design of the Proposed Scheme at the Application Site and provide other relevant information as required in the Planning Department’s Practice Note for Professional Persons No. 1/2019. The LMP is attached in **Figure 1.5**.

1.2 Land Use Zoning

- 1.2.1 The Application Site falls within an area zoned “Comprehensive Development Area” (“CDA”) on the Approved Kwai Chung Outline Zoning Plan (OZP) No. S/KC/32 (**Figure 1.1** refers) gazetted on 13 October 2023.
- 1.2.2 According to the Notes of the OZP, the planning intention of the “CDA” zone is for *“comprehensive development/redevelopment of the area for residential and/or commercial uses with the provision of open space and other supporting facilities. The zoning is to facilitate appropriate planning control over the development mix, scale, design and layout of development, taking account of various environmental, traffic, infrastructure and other constraints”*. Furthermore, it is also specified in Remark (3) of the Notes of the OZP that *“no new development, or addition, alteration and/or modification to or redevelopment of an existing building shall result in a total development and/or redevelopment in excess of a maximum total plot ratio of 5.0 for the site north of Lai King Hill Road ..., or the plot ratio of the existing building, whichever is the greater”*. According to the OZP, the “CDA” zone is subject to a maximum building height of 120mPD.

1.3 Purpose of this report

- 1.3.1 The purpose of this report is to carry out a technical assessment include existing tree baseline review and landscape proposal to support of the S16 Planning Application for the Application Site.

2 SITE DESCRIPTION

2.1 Existing Site Context

- 2.1.1 The Application Site, with a site area of about 48,313 m², situates to the north of Lai King Hill Road and lies at the Kau Wa Keng valley floor with a natural topography which rises from about +4mPD from the southwest towards the northeast to about +19mPD.
- 2.1.2 At the south of the Application Site is largely unused land with scattered temporary structures, a few domestic structures of the Kau Wa Keng San Tsuen, an open-air temporary refuse collection point and a car park serving the Kau Wa Keng area. The northeastern portion is occupied by the Kau Wa Keng Old Village with substandard living environment and minimal infrastructural provision. The existing structures within the Application Site are typically 1 to 3 storeys high. There are 12 existing Grade 3 historic buildings scattering within the Old Village.
- 2.1.3 The Application Site is surrounded on three sides by steep vegetated slope of Kau Wa Keng valley to the north, east and west. To the immediate northwest of the Application Site is Kau Wa Keng San Tsuen at the upper valley; to the immediate southeast is Chung Shan Terrace comprising house-type developments of 2 to 4 storeys high on a higher platform; to the south across Lai King Hill Road are a cluster of medium-to-high-rise residential developments, including Happy Villa, Lai Yan Court, Wah Lai Estate, Wah Fung Garden, Lai Chi Kok Bay Garden and Nob Hill; and to the further southwest on the hilltop are Kwai Chung Hospital and Princess Margaret Hospital.

Image 1.1 Aerial Photo



3 EXISTING TREES

3.1 Key Findings

- 3.1.1 A total of 287 nos. of individually surveyed trees belonging to 42 species are recorded within the site boundary and summarized in the following table. The general health and form of the existing trees were fair to poor and five dead trees are found within the site.
- 3.1.2 Tree Survey Plan showing the locations of exiting tree within the survey boundary is attached in **Figure 1.2**. Details of tree condition are included in the Tree Assessment Schedule in **Appendix A**. Photographic records are shown in **Appendix B**.

Table 3.1 Summary of Identified Individual Surveyed Trees

Scientific name	Chinese name	Quantity
<i>Aglaia odorata</i>	米仔蘭	2
<i>Araucaria heterophylla</i>	異葉南洋杉	3
<i>Artocarpus heterophyllus</i>	菠蘿蜜	28
<i>Aleurites moluccana</i>	石栗	2
<i>Averrhoa carambola</i>	楊桃	3
<i>Bombax ceiba</i>	木棉	1
<i>Broussonetia papyrifera</i>	構樹	2
<i>Bauhinia purpurea</i>	紅花羊蹄甲	1
<i>Carica papaya</i>	番木瓜	11
<i>Celtis sinensis</i>	朴樹	5
<i>Cinnamomum camphora</i>	樟	4
<i>Citrus maxima</i>	柚	27
<i>Clausena lansium</i>	黃皮	11
<i>Delonix regia</i>	鳳凰木	2
<i>Dimocarpus longan</i>	龍眼	45
<i>Diospyros kaki</i>	柿子	1
<i>Eriobotrya japonica</i>	枇杷	3
<i>Elaeocarpus sylvestris</i>	杜英	1
<i>Ficus elastica</i>	印度橡	1
<i>Ficus hispida</i>	對葉榕	3
<i>Ficus microcarpa</i>	細葉榕	4

Scientific name	Chinese name	Quantity
<i>Ficus subpisocarpa</i>	筆管榕	6
<i>Ficus variegata</i>	青果榕	11
<i>Ficus virens</i>	大葉榕	3
<i>Ilex rotunda</i>	鐵冬青	2
<i>Leucaena leucocephala</i>	銀合歡	5
<i>Ligustrum sinense</i>	山指甲	1
<i>Litchi chinensis</i>	荔枝	6
<i>Litsea glutinosa</i>	潺槁樹	1
<i>Livistona chinensis</i>	蒲葵	1
<i>Macaranga tanarius var. tomentosa</i>	血桐	26
<i>Mallotus paniculatus</i>	白楸	4
<i>Mangifera indica</i>	芒果	8
<i>Michelia x alba</i>	白蘭	2
<i>Microcos nervosa</i>	布渣葉	14
<i>Morus alba</i>	桑	2
<i>Plumeria rubra</i>	雞蛋花	1
<i>Psidium guajava</i>	番石榴	4
<i>Roystonea regia</i>	王棕	12
<i>Sterculia lanceolata</i>	假蘋婆	11
<i>Syzygium jambos</i>	蒲桃	1
<i>Zanthoxylum avicennae</i>	簕欖花椒	1
Dead Tree	死樹	5
		287

3.2 Identified Trees with High Value for Priority Preservation

- 3.2.1 There is no Registered Old and Valuable Tree (OVT) or stonewall tree recorded in this report. However, eight (8) Mature Trees including *Ficus microcarpa* (細葉榕), *Ficus elastica* (印度橡樹), *Ficus virens* (大葉榕), *Mangifera indica* (芒果), *Dimocarpus longan* (龍眼) and *Cinnamomum camphora* (樟樹) with a DBH range of 780 - 2000mm are found within the site boundary. In accordance with Development Bureau GLTMS – Management Guidelines for Mature Tree, any trees with an individual trunk(s) over 750mm DBH would be classified as Mature Tree. The full justifications of the tree treatment recommendation of these Mature Trees are included in **Appendix A** and **B**. A detailed assesment for each mature tree is included in **Appendix C**.

3.3 Impacts of Existing Trees

- 3.3.1 According to the development layout, 27 existing trees (T007, T008, T009, T044, T045, T101, T102, T106, T108, T114, T115, T117, T121, T122, T123, T135, T138, T139, T148, T149, T151, T152, 1A-T048, 1A-T049, 1A-T050, 1A-T053, 1A-T056) would not have direct conflict with the proposed development and are proposed to be retained at their original location. 11 nos. of existing surveyed trees are proposed to be transplanted, including one *Dimocarpus longan* 龍眼 (1A-T084), one *Ficus macrocarpa* 細葉榕 (T036) and nine *Roystonea regia* 王棕 (T037, T038, T039, T040, T042, T043, T046, 1A-T044, 1A-T045). Total 248 existing trees are in direct conflict with the development layout, they are inevitably be affected during the work stage. The locations of the preserved tree and transplanted tree are indicated in **Figure 1.3a** and **Figure 1.3b**.

Table 3.2 Summary of Proposed Treatment of Existing Tree

Proposed Treatment	Number of Trees	Percentage of Trees
Retain	27	9%
Transplant	11	4%
Fell	249	87%

- 3.3.2 Besides, out of 249 affected trees, 6 *Leucaena leucocephala* (銀合歡) are identified. The undesirable species should be removed and excluded in the compensatory tree planting proposal as according to LAO PN No. 6/2023, it is not necessary for the following types of tree removal, (a) removal of common undesirable species characterised by their aggressive and invasive growing habits and ability to prevent natural succession of native species.

3.4 Preliminary Compensatory Tree Planting Proposal

- 3.4.1 To compensate the tree loss, 243 nos. of newly trees shall be compensated within the development site. The proposed compensatory tree locations are indicated in the Compensatory Tree Planting Plan (**Figure 1.4**). The proposed tree species are presented in **Section 4.4**.

4 LANDSCAPE DESIGN PROPOSAL

4.1 Landscape Design Objectives

- 4.1.1 The design objectives for the proposed Indicative Landscape Master Plan is to:
- Provide a quality and sustainable environment with adequate landscape area for the enjoyment of the residents of the proposed development;
 - Provide sufficient landscape treatment along the boundary to minimize the potential visual impact of the built form;
 - Incorporate new trees and shrubs to enhance the greenery; and
 - Fully integrate the landscape with the architecture where each exterior component draws upon the merits of the corresponding interior/ building component.
- 4.1.2 The focus of the residential landscape design is to provide a high quality and harmonious setting to the proposed development through the incorporation of spatial functions and the implementation of quality natural materials. The design comprises attractive active and passive open spaces for the future residents whilst maximising the available green coverage to assist with visually softening the visibility of built form at ground level. To achieve this vision, the landscape is divided into carefully designed zones, each serving a specific function:
- 4.1.3 **Landscape Plaza:** At the entrance of each residential tower, the landscape plaza serves as a meeting and orientation point for users, providing access to other functional spaces. The plaza incorporates specimen tree planting and informal seating, creating a welcoming and organized environment.
- 4.1.4 **Open Lawn Area & Kids Play Area:** Outdoor play zones, such as the open lawn area and the children's playground, are strategically located outside main circulation routes to ensure safety and minimize interruptions. These spaces support recreational activities and social interaction, with the kids' zone featuring a slide, swing set, and climbing structure. A covered play area will offer age-appropriate equipment for toddlers, including soft play blocks and a small climbing frame.
- 4.1.5 **Outdoor Gym Area:** The outdoor gym area is designed for residents to gather and engage in various physical activities, including yoga, ball games, and exercise training. Adequate seating, shaded by trees and shelters, is provided for individuals to rest and recharge during activities.
- 4.1.6 **Swimming Pool:** Five outdoor swimming pools are situated near the exterior areas of the clubhouse at Block2, Block 6, Block 7, Block 8, Block 9 and Block 11, promoting a seamless connection between indoor and outdoor recreational spaces. This design enhances the overall leisure experience by integrating water features with the surrounding landscape.
- 4.1.7 **Courtyard & Pocket Seating Space:** The courtyard and pocket seating space have been created as a place for residents to use as a flexible outdoor space for sitting out. This has been positioned in a convenient location near the main pedestrian access so that it can be easily accessed.

- 4.1.8 **Historical Theme Plaza:** The thematic garden settings are thoughtfully integrated with the preserved Grade 3 historic buildings to enhance their landscape and visual appeal. This design approach highlights the site's cultural significance while enriching the aesthetic experience for residents and visitors.
- 4.1.9 **F&B Area & Rooftop Farm:** The F&B area serves as a vibrant social hub with indoor and outdoor seating, surrounded by greenery for a relaxing dining experience. Shaded seating and planters enhance comfort while maintaining a connection to the landscape. The rooftop farm promotes sustainability and community engagement, offering residents an opportunity to grow fresh produce and herbs. It functions as both a recreational and educational space, fostering eco-friendly practices and social interaction.
- 4.1.10 **Common Ground Garden:** The Common Ground Garden integrates a multi-purpose lawn with seating zones, serving as an inclusive outdoor space for leisure, gatherings, and informal activities for both residents and the local village community.
- 4.1.11 **Green Edge along the Boundary:** The proposed boundary treatment responds to varying site conditions and infrastructure constraints. Along the eastern boundary near Block 13 and Block 14, a green wall with stepped planter is introduced to accommodate an underground drainage diversion while providing adequate soil depth for planting. In contrast, the northern boundary and the area between Block 10 and Block 12, where no underground utilities are present, the planting area allows sufficient soil depth for tree, shrub and climber planting. Wire trellises are proposed on the retaining walls in these areas to support climbers, enhancing greenery and integrating with the existing slope.
- 4.1.12 Please refer to **Figure 1.5a to Figure 1.5e** for the details of the landscape proposal.

4.2 Hardscape Design Proposal

Proposed materials

- 4.2.1 The materials and finishes for the exterior landscape spaces are specified to compliment the quality of the architectural finishes for the centre users and the staff.

Table 4.1: Indicative Hard Landscape Materials Schedule

Material	Colour	Finish
Granite slab	Light earth tone with subtle colour variations or warm grey	Non-Slip Surface
Wood deck	Wood colour	Non-Slip Surface
EPDM safety surfacing	Vibrant Colour	Non-Slip Surface

Paving

- 4.2.2 The landscape areas aim to present a high-quality and inviting frontage to the development through the use of premium hardscape materials. The proposed paving treatments include:
- Natural granite/ artificial granite with R12 slip resistance to ensure safety for driveways and access ramps;
 - Natural granite/ artificial granite slabs for feature paving at the entrances;
 - Natural stone/ artificial stone for pedestrian footpaths;
 - Natural stone/ artificial stone and homogenous tiles for water feature/ swimming pool;
 - Water and insect resistant non-slip wood for decking; and
 - EPDM safety surfacing for outdoor children's play areas and gym areas

Site Furniture

- 4.2.3 Site furniture will include benches, litter bins and flowerpots.

4.3 Softscape Design Proposal

Proposed Planting List

- 4.3.1 To maintain the landscape features and the local biodiversity of existing environment, 16 native species and 4 exotic species are proposed throughout the site. A summary of plant materials (categories of planting, species list and size) is provided as below:

Table 4.2: Proposed Tree Planting

Abbreviated Name	Botanical Name	Origin	Chinese Name	Size	Quantity
Mic. ner.	<i>Microcos nervosa</i>	Native	布渣葉	Heavy Standard Tree	9
Fic. mic.	<i>Ficus microcarpa</i>	Native	細葉榕	Heavy Standard Tree	23
Bri. tom.	<i>Bridelia tomentosa</i>	Native	土蜜樹	Standard Tree	14
Cel. sin.	<i>Celtis sinensis</i>	Native	朴樹	Standard Tree	9
Cin. bur.	<i>Cinnamomum burmanii</i>	Native	陰香	Heavy Standard Tree	12
Lit. glu.	<i>Litsea glutinosa</i>	Native	潺槁樹	Heavy Standard Tree	8
Cin. cam.	<i>Cinnamomum camphora</i>	Native	樟	Heavy Standard Tree	11
Bau. bla.	<i>Bauhinia × blakeana</i>	Native	洋紫荊	Heavy Standard Tree	12

Abbreviated Name	Botanical Name	Origin	Chinese Name	Size	Quantity
Liq. for.	<i>Liquidambar formosana</i>	Native	楓香	Heavy Standard Tree	4
Vib. odo.	<i>Viburnum odoratissimum</i>	Native	珊瑚樹	Heavy Standard Tree	9
Pod. mac.	<i>Podocarpus macrophyllus</i>	Native	羅漢松	Conifers	9
Gar. sub.	<i>Garcinia subelliptica</i>	Exotic	菲島福木	Conifers	10
Ile. rot.	<i>Ilex rotunda</i> var. <i>microcarpa</i>	Native	小果鐵冬青	Standard Tree	6
Ste. lan.	<i>Sterculia lanceolata</i> Cav.	Native	假蘋婆	Standard Tree	13
Cle. ner.	<i>Cleistocalyx nervosum</i>	Native	水翁	Standard Tree	27
Sap. seb.	<i>Sapium sebiferum</i>	Native	烏柏	Light Standard Tree	17
Ace. tut.	<i>Acer tutcheri</i> Duthie	Native	嶺南槭	Light Standard Tree	13
Lag. spe.	<i>Lagerstroemia speciose</i>	Exotic	大花紫薇	Light Standard Tree	10
Plu. acu.	<i>Plumeria acutifolia</i>	Exotic	雞蛋花	Light Standard Tree	17
Syz. jam.	<i>Syzygium jambos</i>	Exotic	蒲桃	Light Standard Tree	10
Total					243

Specification:

Light Standard Tree shall be in accordance with CEDD General Specification clause 3.13

Standard Tree shall be in accordance with CEDD General Specification clause 3.14

Heavy Standard Tree shall be in accordance with CEDD General Specification clause 3.13

Conifers shall be in accordance with CEDD General Specification clause 3.19 and have a root ball at lease 750mm in diameter and 400mm deep

Table 4.3: Proposed Shrub and Groundcover Plantings

Botanical Name	Chinese Name	Origin	Size (Height x Spread) (mm)	Spacing (mm)
Shrub				

Botanical Name	Chinese Name	Origin	Size (Height x Spread) (mm)	Spacing (mm)
<i>Camellia sinensis</i>	茶花	Native	400 x 300	300
<i>Ardisia crenata</i>	朱砂根	Native	400 x 300	300
<i>Gardenia jasminoides</i>	梔子	Native	300 x 250	250
<i>Ixora chinensis</i>	龍船花	Native	300 x 250	250
Groundcover				
<i>Asparagus densiflorus</i> cv. <i>Sprengeri</i>	非洲天門冬	Exotic	250 x 200	200
<i>Nephrolepis exaltata</i> var. <i>bostoniensis</i>	波士頓蕨	Exotic	250 x 200	200
Lawn				
<i>Axonopus affinis</i>	大葉油草	Exotic	N/A	N/A

Minimum Soil Depth for Planting

- 4.3.2 According to the General Specification for Building 2012 Edition – Section 25, the proposed soil depths shall make reference to the following requirements:

Plant Category	Minimum Soil Depth (Excluded Drainage Layer)
Trees	1,200mm
Small palms and shrubs	600mm
Ground covers/ turf and climbers	300mm

4.4 Drainage and Irrigation

- 4.4.1 The site will adopt both manual and automatic irrigation systems to ensure efficient water management across all soft landscape areas. Manual water points will be provided at regular intervals, equipped with uPVC sleeves, taps, and protective housings for ease of maintenance. In parallel, an automatic irrigation system comprising drip lines and sprinklers with programmable timers will be installed to deliver consistent watering based on zone-specific needs. Drainage provisions will comply with all relevant regulations to ensure proper runoff and site sustainability.

4.5 Provision of Local Open Space and Green Coverage

- 4.5.1 In accordance with Hong Kong Planning Standard and Guidelines (HKPSG), the standards of provision of open space set out in section 1.8 of Chapter 4 Recreation, Open Space and Greening. In comprehensive residential developments, the standard of provision for Local Open Space is 1m² per residents throughout the Territory. Please refer to **Figure 1.14** for the Local Open Space Provision. The provision of local open space is summarized as follows:

Table 4.4 Summary of Local Open Space Provision

	Area				
Application Site Area	48,313 m ²				
Proposed Resident Population	Phase 1A	Phase 1B	Remaining Phase A	Remaining Phase B	Total
	5,348	3,985	3,126	6,579	19,038
Local Open Space Provision	Phase 1A	Phase 1B	Remaining Phase A	Remaining Phase B	Total
(Not less than 1m ² per residents)	Not less than 5,348 m ²	Not less than 3,985 m ²	Not less than 3,126 m ²	Not less than 6,579 m ²	Not less than 19,038 m²

4.5.2 According to PNAP APP-152, for a site above 20,000 m² in area, the total greenery area should be 30% or more (**Figure 1.7**). The greenery coverage is summarized as follows:

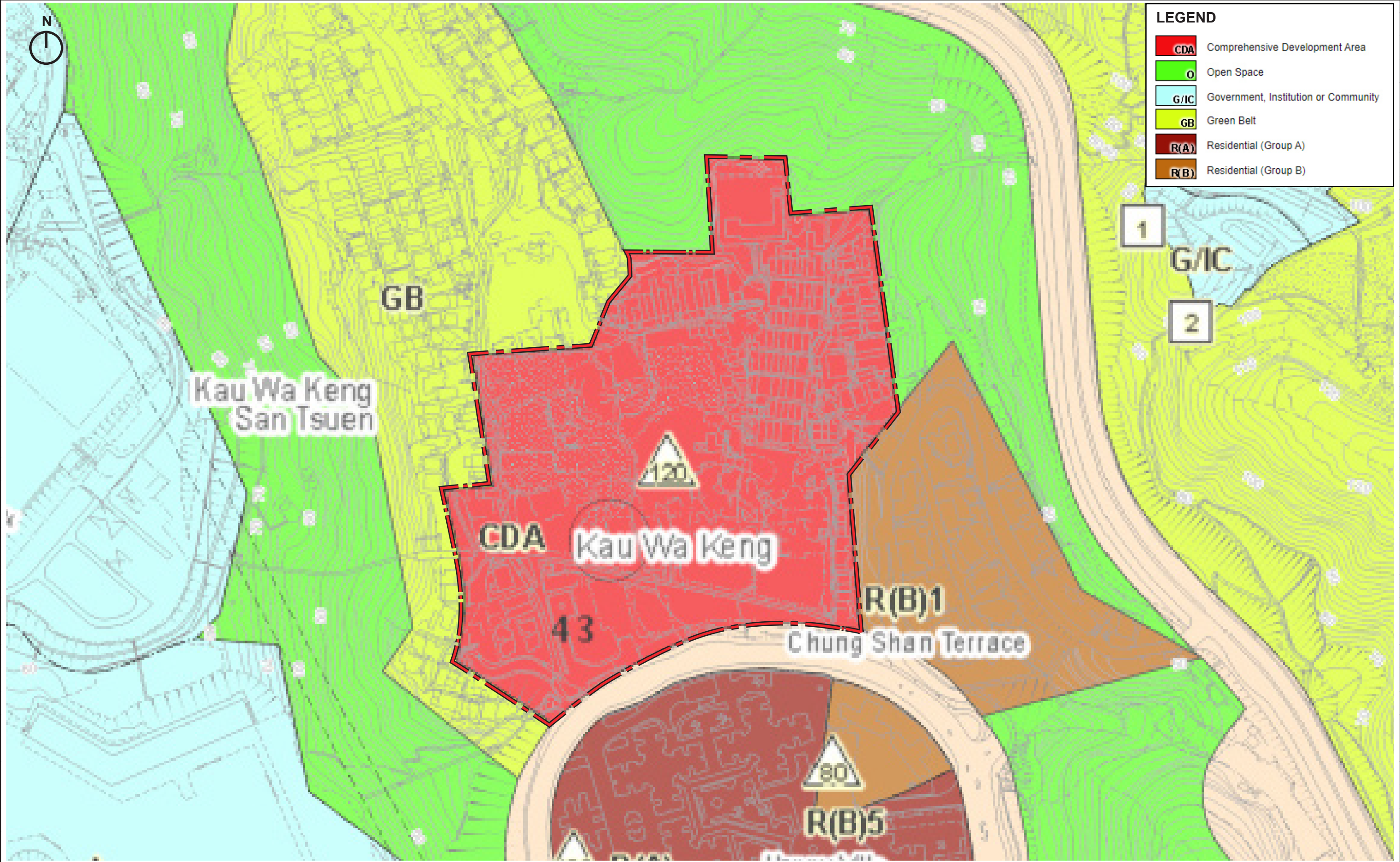
Table 4.5 Summary of Greenery Coverage

	Area
Application Site Area	48,313 m ²
Overall Greenery	Not less than 14,494 m ² (30%)

Table 4.6 Summary of Greenery Coverage of Each Phase

	Area			
Application Site Area	48,313 m ²			
Site Area (About) (m ²)	Phase 1A	Phase 1B	Remaining Phase A	Remaining Phase B
	13,577	10,112	7,935	16,689
Local Open Space Provision	Phase 1A	Phase 1B	Remaining Phase A	Remaining Phase B
(Not less than 1m ² per residents)	Not less than 4,073 m ² (30%)	Not less than 3,034 m ² (30%)	Not less than 1,984 m ² (25%)	Not less than 5,841 m ² (35%)

Figures



LEGEND	
<div>CDA</div>	Comprehensive Development Area
<div>O</div>	Open Space
<div>G/IC</div>	Government, Institution or Community
<div>GB</div>	Green Belt
<div>R(A)</div>	Residential (Group A)
<div>R(B)</div>	Residential (Group B)

LEGEND	DRAWING TITLE OUTLINE ZONING PLAN	DATE DEC 2025	FIGURE NO. FIG 1.1	SCALE AND ORIENTATION N.T.S.	ARUP	
		DRAWN AC	JOB TITLE Application for Permission Under Section 16 of the Town Planning Ordinance (Cap. 131) for Proposed Comprehensive Development including Flats, Retail and Community Facilities and Minor Relaxation of Plot Ratio and Building Height Restriction in "Comprehensive Development Area" Zone at Various Lots in S.D.4 and Adjoining Government Land, Kau Wa Keng, Kwai Chung			
		CHECKED RH				
		APPROVED CY				



LEGEND

SITE BOUNDARY

EXISTING TREE

DEAD TREE

LEGEND	DRAWING TITLE		DATE	FIGURE NO.	SCALE AND ORIENTATION	ARUP
	TREE SURVEY PLAN		DEC 2025	FIG 1.2	1:1500@A3	
	DRAWN		JOB TITLE Application for Permission Under Section 16 of the Town Planning Ordinance (Cap. 131) for Proposed Comprehensive Development including Flats, Retail and Community Facilities and Minor Relaxation of Plot Ratio and Building Height Restriction in "Comprehensive Development Area" Zone at Various Lots in S.D.4 and Adjoining Government Land, Kau Wa Keng, Kwai Chung			
	CHECKED					
	APPROVED					
	CY					



LEGEND

SITE BOUNDARY

PROPOSED DEVELOPMENT LAYOUT

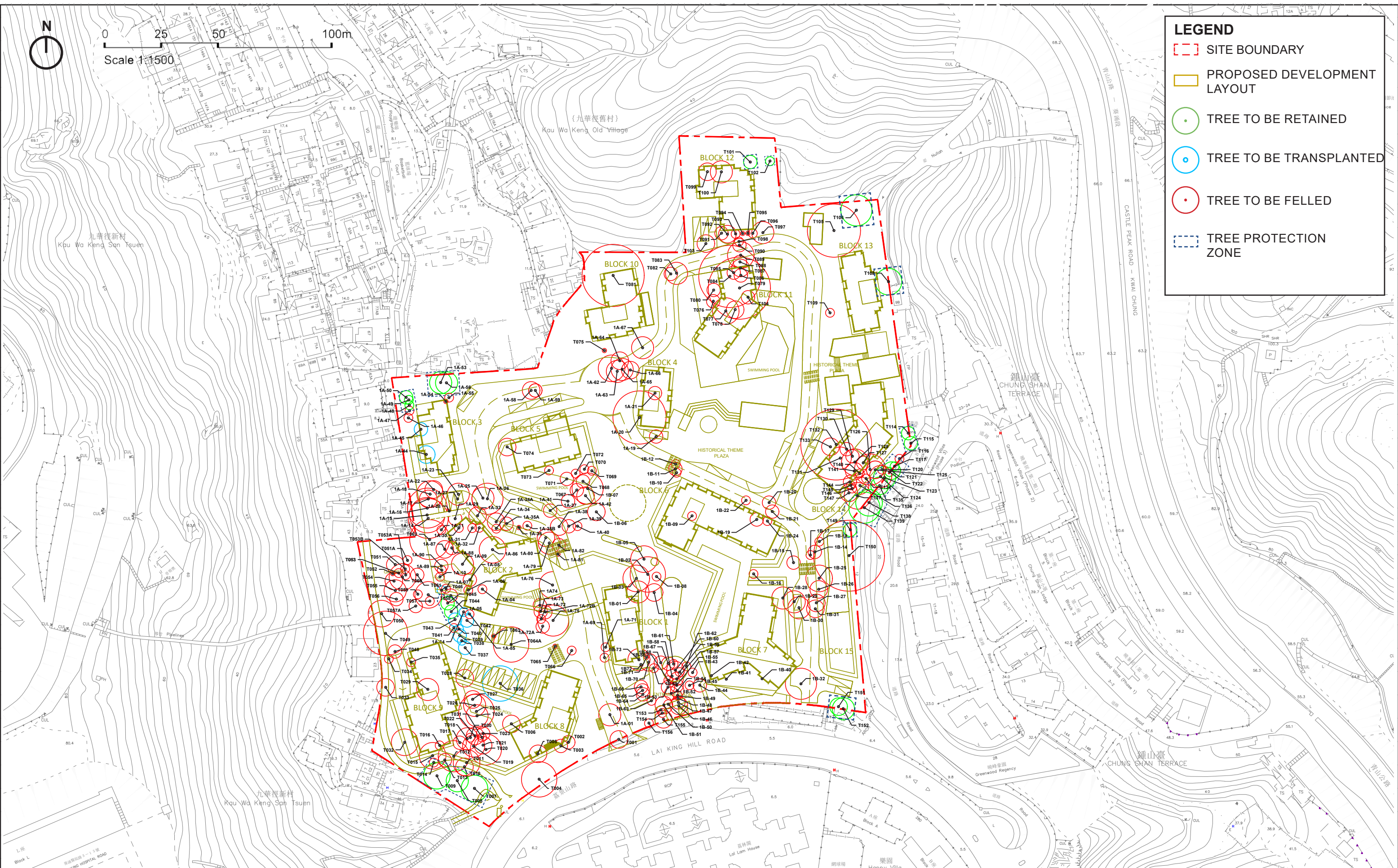
TREE TO BE RETAINED

TREE TO BE TRANSPLANTED

TREE TO BE FELLED

TREE PROTECTION ZONE

LEGEND	DRAWING TITLE TREE TREATMENT PLAN (WITH EXCAVATION LAYOUT)	DATE DEC 2025	FIGURE NO. FIG 1.3a	SCALE AND ORIENTATION N.T.S	ARUP
		DRAWN AC	JOB TITLE Application for Permission Under Section 16 of the Town Planning Ordinance (Cap. 131) for Proposed Comprehensive Development including Flats, Retail and Community Facilities and Minor Relaxation of Plot Ratio and Building Height Restriction in "Comprehensive Development Area" Zone at Various Lots in S.D.4 and Adjoining Government Land, Kau Wa Keng, Kwai Chung		
		CHECKED RH			
		APPROVED CY			



LEGEND	DRAWING TITLE TREE TREATMENT PLAN (WITH BUILDING LAYOUT)		DATE	FIGURE NO.	SCALE AND ORIENTATION	ARUP
			DEC 2025	FIG 1.3b	1:1500@A3	
			DRAWN	JOB TITLE		
			AC	Application for Permission Under Section 16 of the Town Planning Ordinance (Cap. 131) for Proposed Comprehensive Development including Flats, Retail and Community Facilities and Minor Relaxation of Plot Ratio and Building Height Restriction in "Comprehensive Development Area" Zone at Various Lots in S.D.4 and Adjoining Government Land, Kau Wa Keng, Kwai Chung		
	CHECKED					
			APPROVED			
			CY			



Abbreviat- ed Name	Botanical Name	Origin	Chinese Name	Size	Quantity
Mic. ner.	Microcos ner- vosa	Native	布渣菜	Heavy Standard Tree	9
Fic. mic.	Ficus micro- carpa	Native	細葉榕	Heavy Standard Tree	23
Bri. tom.	Bridelia to- mentosa	Native	土蜜樹	Standard Tree	14
Cel. sin.	Celtis sinensis	Native	朴樹	Standard Tree	9
Cin. bur.	Cinnamomum burmanii	Native	陰香	Heavy Standard Tree	12
Lit. glu.	Litsea glut- inosa	Native	潺槁樹	Heavy Standard Tree	8
Cin. cam.	Cinnamomum camphora	Native	樟	Heavy Standard Tree	11
Bau. bla.	Bauhinia x blakeana	Native	洋紫荊	Heavy Standard Tree	12
Liq. for.	Liquidambar formosana	Native	楓香	Heavy Standard Tree	4
Vib. odo.	Viburnum odo- ratissimum	Native	珊瑚樹	Heavy Standard Tree	9
Pod. mac.	Podocarpus macrophyllus	Native	羅漢松	Conifers	9
Gar. sub.	Garcinia sub- elliptica	Exotic	菲島福木	Conifers	10
Ile. rot.	Ilex rotunda var. micro- carpa	Native	小果鐵冬 青	Standard Tree	6
Ste. lan.	Sterculia lan- ceolata Cav.	Native	假蘋婆	Standard Tree	13
Cle. ner.	Cleistocalyx nervosum	Native	水翁	Standard Tree	27
Sap. seb.	Sapium sebi- ferum	Native	烏柏	Light Standard Tree	17
Ace. tut.	Acer tutcheri Duthie	Native	嶺南槭	Light Standard Tree	13
Lag. spe.	Lagerstroemia speciose	Exotic	大花紫薇	Light Standard Tree	10
Plu. acu.	Plumeria acuti- folia	Exotic	雞蛋花	Light Standard Tree	17
Syz. jam.	Syzygium jam- bos	Exotic	蒲桃	Light Standard Tree	10
Total					243

LEGEND

RETAINED TREE

TRANSPLANT TREE

DRAWING TITLE

COMPENSATORY TREE PLANTING PLAN

DATE

DEC 2025

FIGURE NO.

FIG 1.4

SCALE AND ORIENTATION

1:1500@A3

DRAWN

AC

CHECKED

RH

APPROVED

CY

JOB TITLE

Application for Permission Under Section 16 of the Town Planning Ordinance (Cap. 131) for Proposed Comprehensive Development including Flats, Retail and Community Facilities and Minor Relaxation of Plot Ratio and Building Height Restriction in "Comprehensive Development Area" Zone at Various Lots in S.D.4 and Adjoining Government Land, Kau Wa Keng, Kwai Chung

ARUP



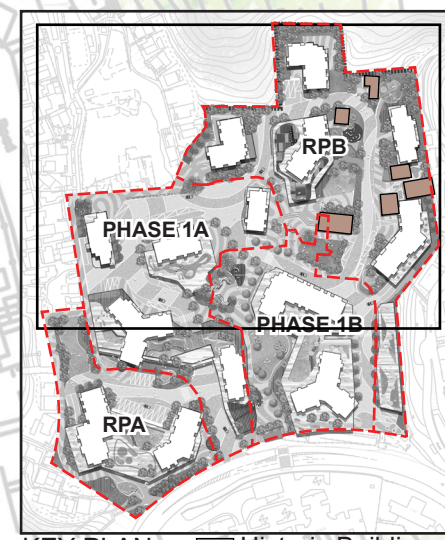
LEGEND	DRAWING TITLE LANDSCAPE MASTER PLAN	DATE DEC 2025	FIGURE NO. FIG 1.5a	SCALE AND ORIENTATION 1:1500@A3	ARUP
		DRAWN AC	JOB TITLE Application for Permission Under Section 16 of the Town Planning Ordinance (Cap. 131) for Proposed Comprehensive Development including Flats, Retail and Community Facilities and Minor Relaxation of Plot Ratio and Building Height Restriction in "Comprehensive Development Area" Zone at Various Lots in S.D.4 and Adjoining Government Land, Kau Wa Keng, Kwai Chung		
		CHECKED RH			
		APPROVED CY			



0 10 20 50m
Scale 1:1000

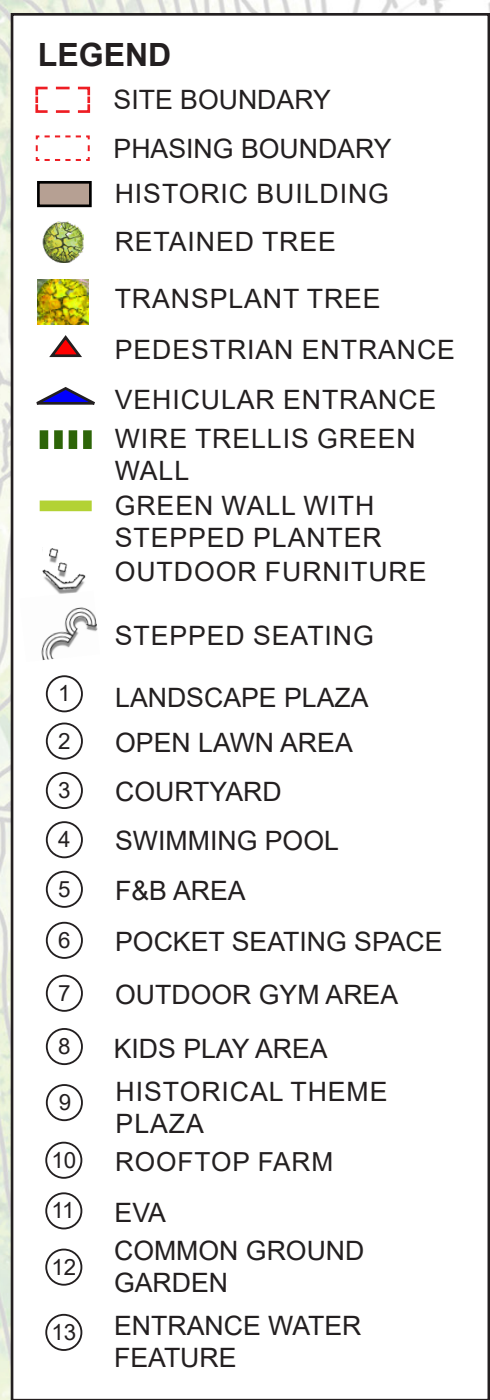
LEGEND


- SITE BOUNDARY
- PHASING BOUNDARY
- HISTORIC BUILDING
- RETAINED TREE
- TRANSPLANT TREE
- PEDESTRIAN ENTRANCE
- VEHICULAR ENTRANCE
- WIRE TRELLIS GREEN WALL
- GREEN WALL WITH STEPPED PLANTER
- OUTDOOR FURNITURE
- STEPPED SEATING
- LANDSCAPE PLAZA
- OPEN LAWN AREA
- COURTYARD
- SWIMMING POOL
- F&B AREA
- POCKET SEATING SPACE
- OUTDOOR GYM AREA
- KIDS PLAY AREA
- HISTORICAL THEME PLAZA
- ROOFTOP FARM
- EVA
- COMMON GROUND GARDEN

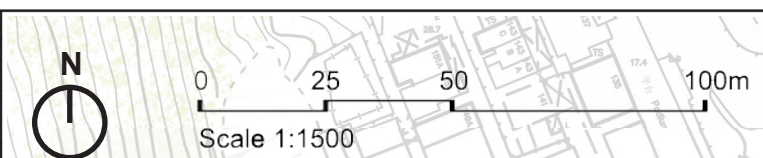


LEGEND	DRAWING TITLE LANDSCAPE MASTER PLAN -PART 1	DATE DEC 2025	FIGURE NO. FIG 1.5b	SCALE AND ORIENTATION 1:1000@A3	
		DRAWN AC	JOB TITLE Application for Permission Under Section 16 of the Town Planning Ordinance (Cap. 131) for Proposed Comprehensive Development including Flats, Retail and Community Facilities and Minor Relaxation of Plot Ratio and Building Height Restriction in "Comprehensive Development Area" Zone at Various Lots in S.D.4 and Adjoining Government Land, Kau Wa Keng, Kwai Chung		
		CHECKED RH			
		APPROVED CY			

ARUP



LEGEND	DRAWING TITLE	DATE	FIGURE NO.	SCALE AND ORIENTATION	
	LANDSCAPE MASTER PLAN - PART 2	DEC 2025	FIG 1.5c	1:1000@A3	
		DRAWN	JOB TITLE Application for Permission Under Section 16 of the Town Planning Ordinance (Cap. 131) for Proposed Comprehensive Development including Flats, Retail and Community Facilities and Minor Relaxation of Plot Ratio and Building Height Restriction in "Comprehensive Development Area" Zone at Various Lots in S.D.4 and Adjoining Government Land, Kau Wa Keng, Kwai Chung		
		AC			
	CHECKED	APPROVED			
	RH	CY			



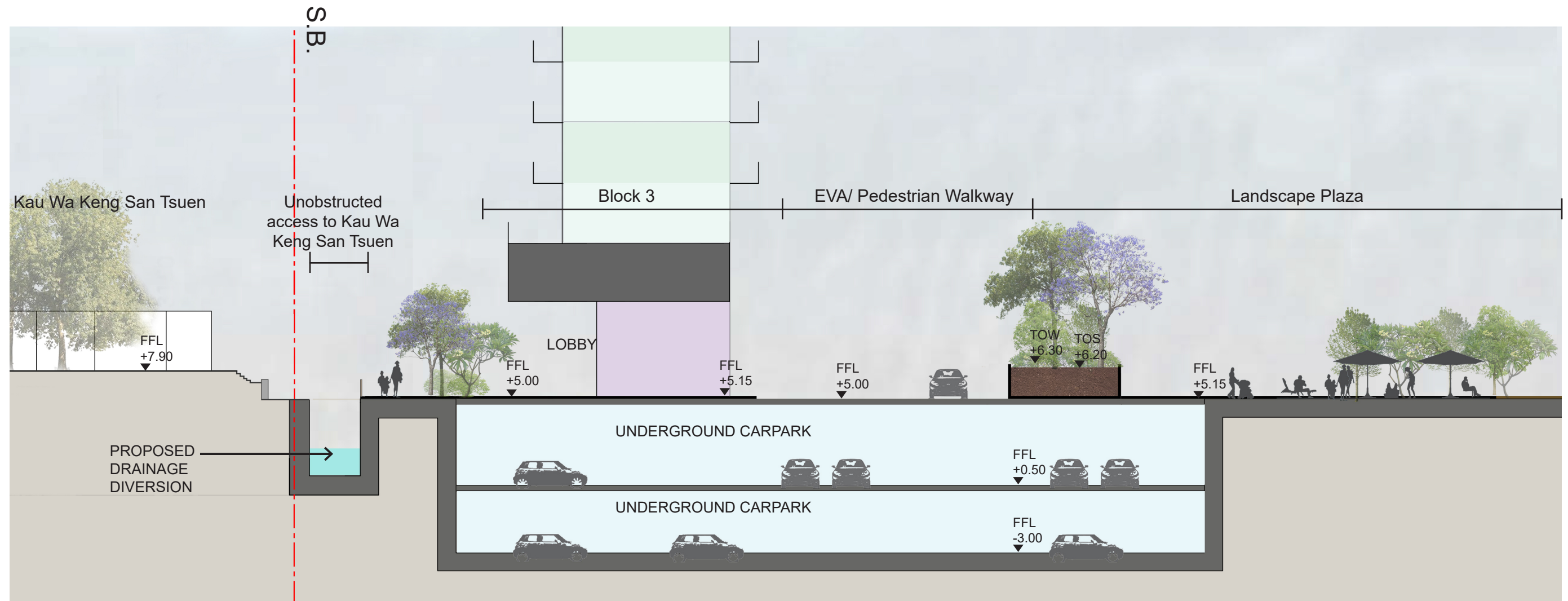
- LEGEND**
- SITE BOUNDARY
 - PHASING BOUNDARY
 - HISTORIC BUILDING
 - RETAINED TREE
 - TRANSPLANT TREE
 - PEDESTRIAN ENTRANCE
 - VEHICULAR ENTRANCE
 - WIRE TRELLIS GREEN WALL
 - GREEN WALL WITH STEPPED PLANTER
 - OUTDOOR FURNITURE
 - STEPPED SEATING
 - LANDSCAPE PLAZA
 - OPEN LAWN AREA
 - COURTYARD
 - SWIMMING POOL
 - F&B AREA
 - POCKET SEATING SPACE
 - OUTDOOR GYM AREA
 - KIDS PLAY AREA
 - HISTORICAL THEME PLAZA
 - EVA
 - COMMON GROUND GARDEN
 - ENTRANCE WATER FEATURE

LEGEND	DRAWING TITLE LANDSCAPE MASTER PLAN - GROUND FLOOR	DATE DEC 2025	FIGURE NO. FIG 1.5d	SCALE AND ORIENTATION 1:1500@A3	ARUP
		DRAWN AC	JOB TITLE Application for Permission Under Section 16 of the Town Planning Ordinance (Cap. 131) for Proposed Comprehensive Development including Flats, Retail and Community Facilities and Minor Relaxation of Plot Ratio and Building Height Restriction in "Comprehensive Development Area" Zone at Various Lots in S.D.4 and Adjoining Government Land, Kau Wa Keng, Kwai Chung		
		CHECKED RH			
		APPROVED CY			



- LEGEND**
- [Red dashed line] SITE BOUNDARY
 - [Red dashed line] PHASING BOUNDARY
 - ① ROOFTOP FARM
 - ② OPEN LAWN AREA
 - ③ COURTYARD
 - ④ SWIMMING POOL
 - ⑤ F&B AREA
 - ⑥ POCKET SEATING SPACE
 - ⑦ OUTDOOR GYM AREA
 - ⑧ KIDS PLAY AREA

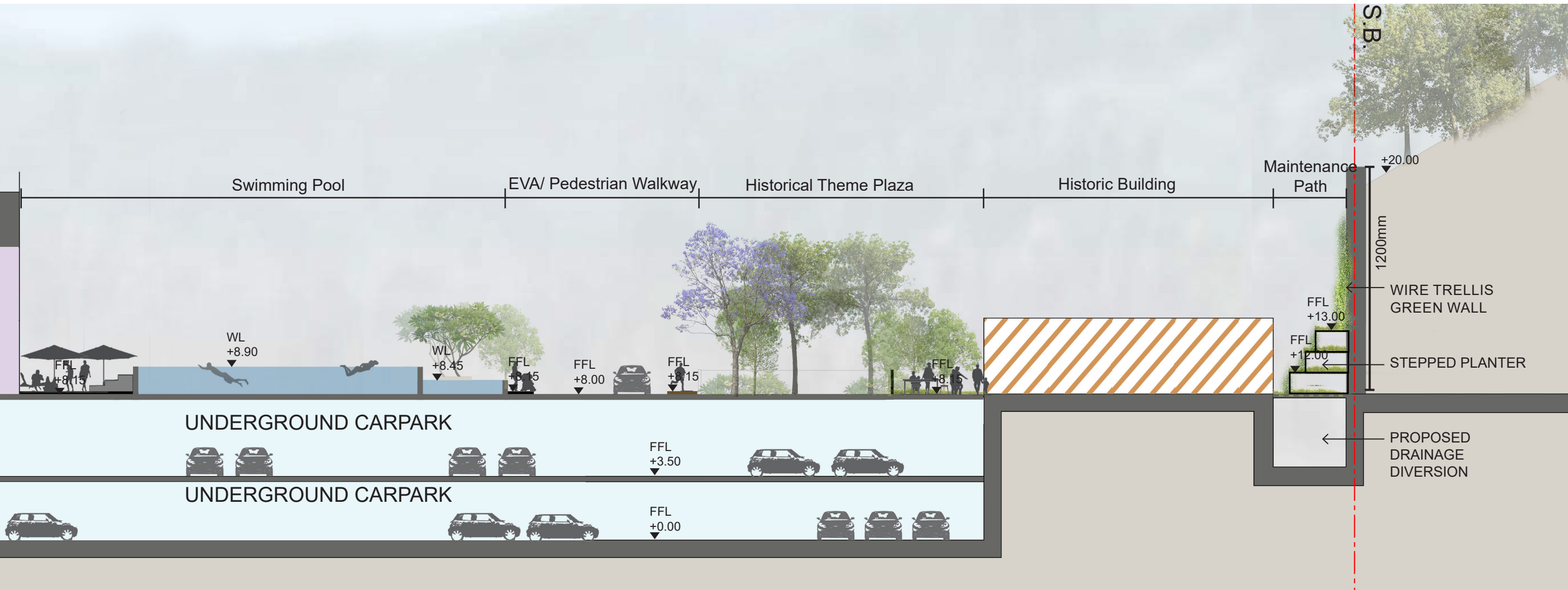
LEGEND	DRAWING TITLE LANDSCAPE MASTER PLAN - PODIUM FLOOR	DATE DEC 2025	FIGURE NO. FIG 1.5e	SCALE AND ORIENTATION 1:1500@A3	ARUP
		DRAWN AC	JOB TITLE Application for Permission Under Section 16 of the Town Planning Ordinance (Cap. 131) for Proposed Comprehensive Development including Flats, Retail and Community Facilities and Minor Relaxation of Plot Ratio and Building Height Restriction in "Comprehensive Development Area" Zone at Various Lots in S.D.4 and Adjoining Government Land, Kau Wa Keng, Kwai Chung		
		CHECKED RH			
		APPROVED CY			



KEY PLAN

- Historic Building
- Site Boundary
- Phasing Boundary

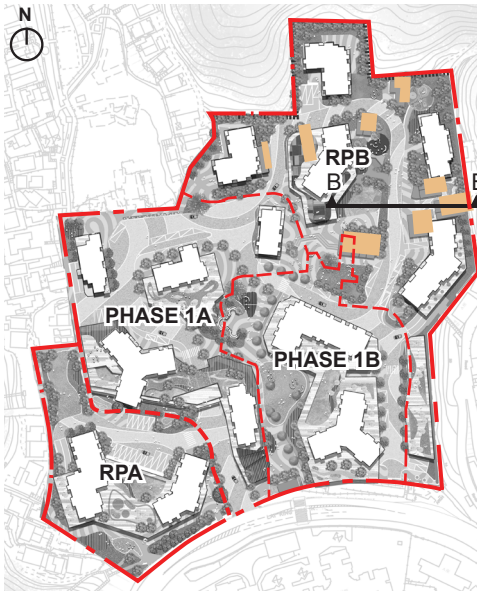
LEGEND	DRAWING TITLE SECTION A-A'	DATE DEC 2025	FIGURE NO. FIG 1.6	SCALE AND ORIENTATION N.T.S	<div>ARUP</div>
		DRAWN AC	JOB TITLE Application for Permission Under Section 16 of the Town Planning Ordinance (Cap. 131) for Proposed Comprehensive Development including Flats, Retail and Community Facilities and Minor Relaxation of Plot Ratio and Building Height Restriction in "Comprehensive Development Area" Zone at Various Lots in S.D.4 and Adjoining Government Land, Kau Wa Keng, Kwai Chung		
		CHECKED RH			
		APPROVED CY			



REFERENCE IMAGE OF GREEN WALL

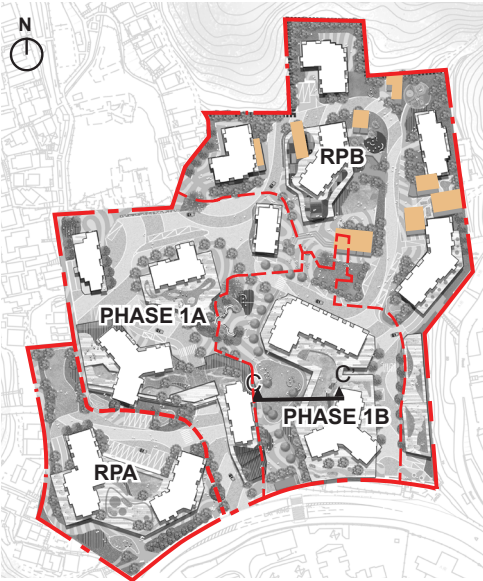
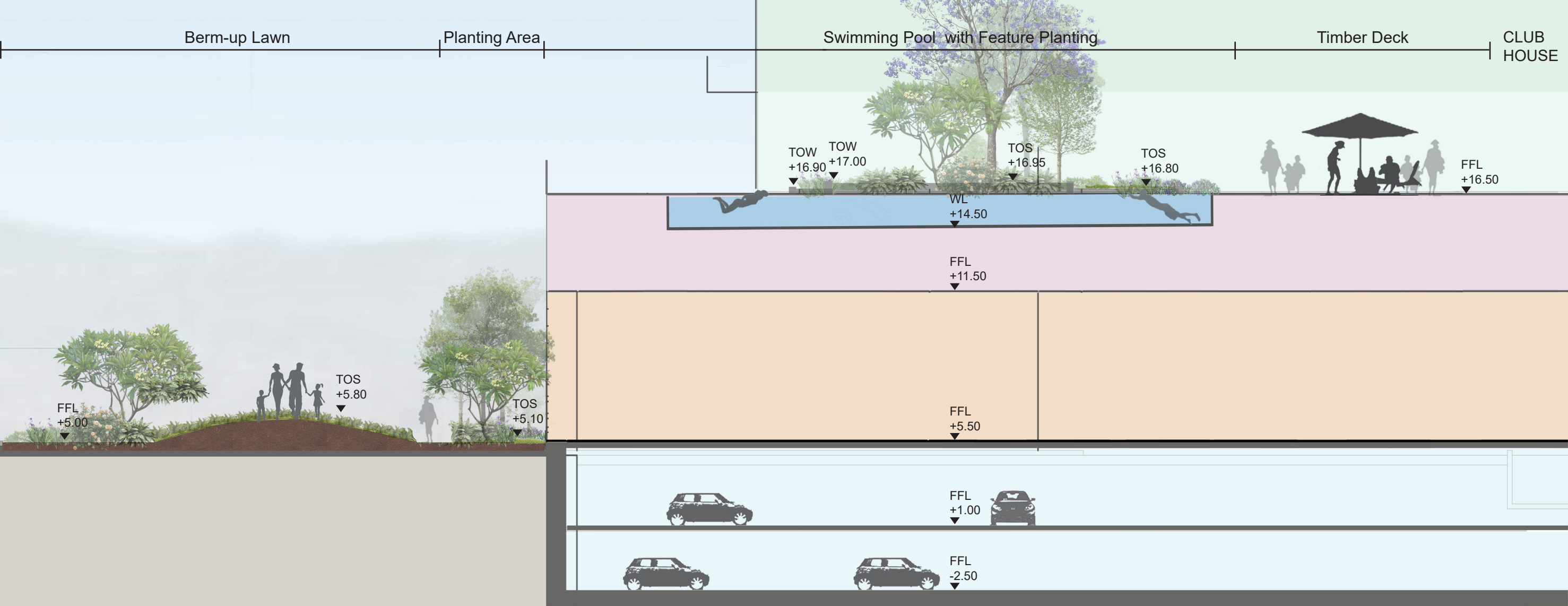


REFERENCE IMAGE OF STEPPED PLANTER



KEY PLAN
Historic Building
Site Boundary
Phasing Boundary

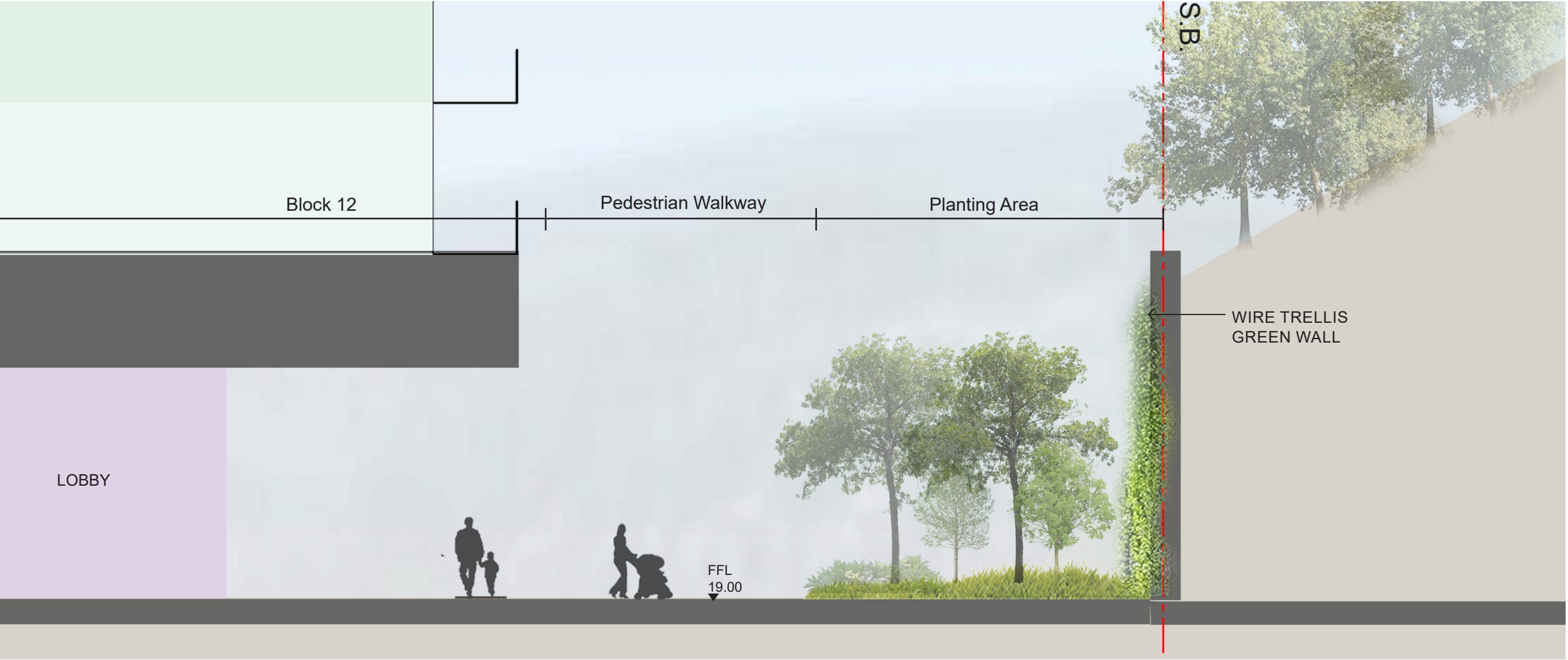
LEGEND	DRAWING TITLE SECTION B-B'	DATE DEC 2025	FIGURE NO. FIG 1.7	SCALE AND ORIENTATION N.T.S	ARUP
		DRAWN AC	JOB TITLE Application for Permission Under Section 16 of the Town Planning Ordinance (Cap. 131) for Proposed Comprehensive Development including Flats, Retail and Community Facilities and Minor Relaxation of Plot Ratio and Building Height Restriction in "Comprehensive Development Area" Zone at Various Lots in S.D.4 and Adjoining Government Land, Kau Wa Keng, Kwai Chung		
		CHECKED RH			
		APPROVED CY			



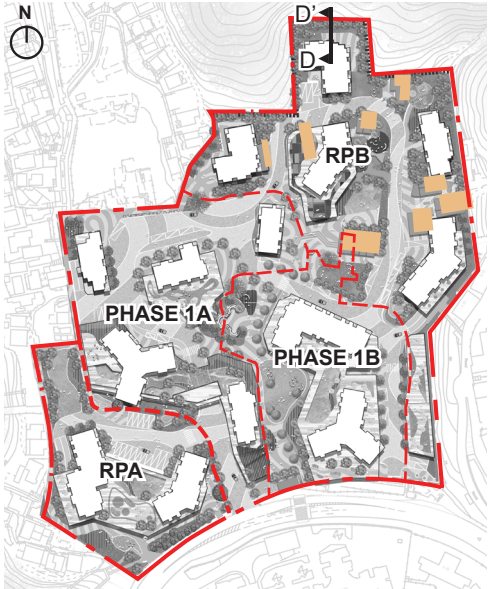
KEY PLAN

- Historic Building
- Site Boundary
- Phasing Boundary

LEGEND	DRAWING TITLE SECTION C-C'	DATE DEC 2025	FIGURE NO. FIG 1.8	SCALE AND ORIENTATION N.T.S	ARUP
		DRAWN AC	JOB TITLE Application for Permission Under Section 16 of the Town Planning Ordinance (Cap. 131) for Proposed Comprehensive Development including Flats, Retail and Community Facilities and Minor Relaxation of Plot Ratio and Building Height Restriction in "Comprehensive Development Area" Zone at Various Lots in S.D.4 and Adjoining Government Land, Kau Wa Keng, Kwai Chung		
		CHECKED RH			
		APPROVED CY			



REFERENCE IMAGE OF GREEN WALL



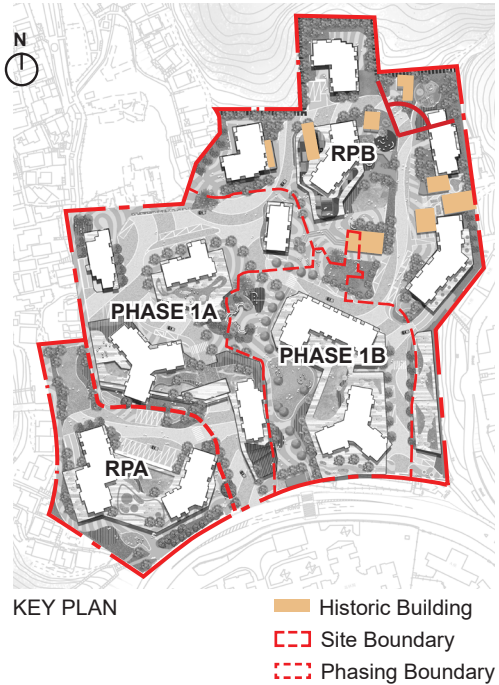
- KEY PLAN
- Historic Building
 - Site Boundary
 - Phasing Boundary

LEGEND	DRAWING TITLE SECTION D-D'	DATE DEC 2025	FIGURE NO. FIG 1.9	SCALE AND ORIENTATION N.T.S	ARUP
		DRAWN AC	JOB TITLE Application for Permission Under Section 16 of the Town Planning Ordinance (Cap. 131) for Proposed Comprehensive Development including Flats, Retail and Community Facilities and Minor Relaxation of Plot Ratio and Building Height Restriction in "Comprehensive Development Area" Zone at Various Lots in S.D.4 and Adjoining Government Land, Kau Wa Keng, Kwai Chung		
		CHECKED RH			
		APPROVED CY			

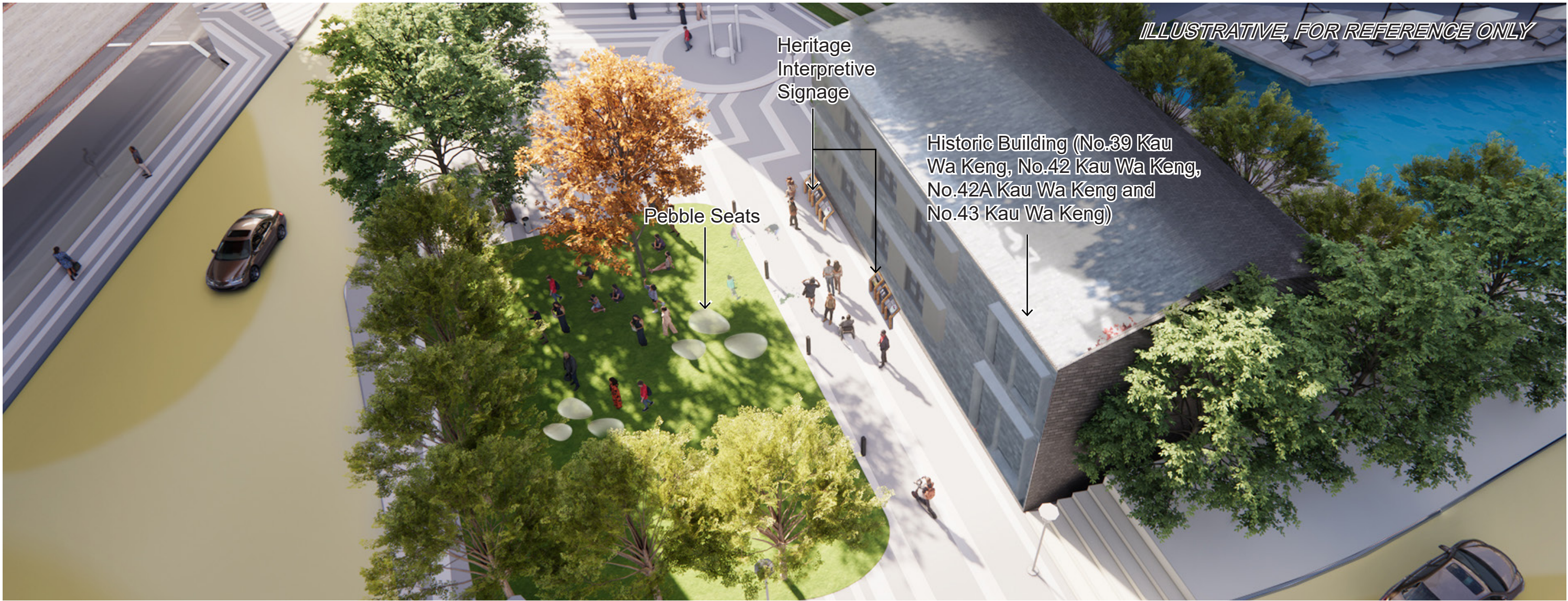


Image of existing conditions of the Grade 3 Historic Building (No.10 Kau Wa Keng)

*Notes: The historic buildings will be fully preserved and form part of the landscape to create a distinctive community environment for the project.

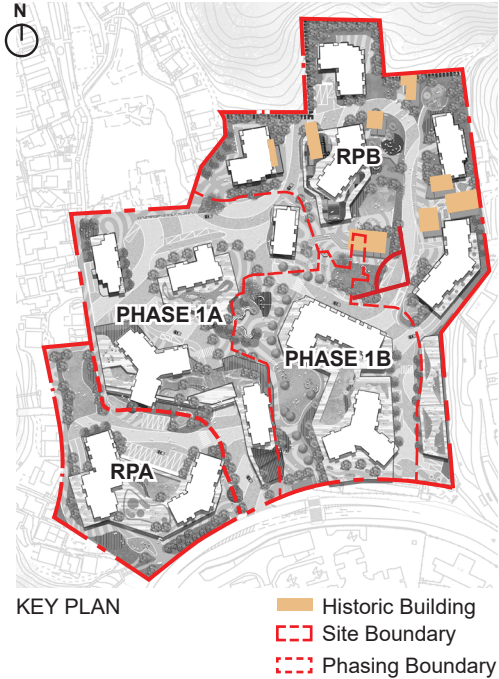


LEGEND	DRAWING TITLE PERSPECTIVE 01	DATE DEC 2025	FIGURE NO. FIG 1.10	SCALE AND ORIENTATION N.T.S	ARUP
		DRAWN AC	JOB TITLE Application for Permission Under Section 16 of the Town Planning Ordinance (Cap. 131) for Proposed Comprehensive Development including Flats, Retail and Community Facilities and Minor Relaxation of Plot Ratio and Building Height Restriction in "Comprehensive Development Area" Zone at Various Lots in S.D.4 and Adjoining Government Land, Kau Wa Keng, Kwai Chung		
		CHECKED RH			
		APPROVED CY			



Images of existing conditions of the Grade 3 Historic Building (No.39 Kau Wa Keng, No.42 Kau Wa Keng, No.42A Kau Wa Keng and No.43 Kau Wa Keng)

*Notes: The historic buildings will be fully preserved and form part of the landscape to create a distinctive community environment for the project.

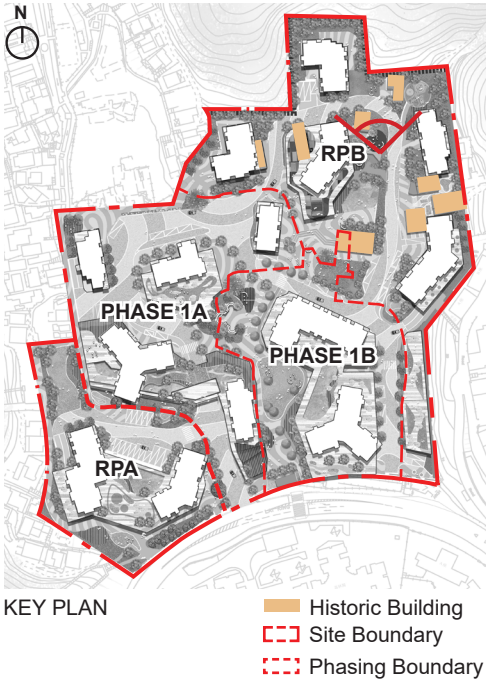


LEGEND	DRAWING TITLE	DATE	FIGURE NO.	SCALE AND ORIENTATION	ARUP
	PERSPECTIVE 02	DEC 2025	FIG 1.11	N.T.S	
		DRAWN	JOB TITLE Application for Permission Under Section 16 of the Town Planning Ordinance (Cap. 131) for Proposed Comprehensive Development including Flats, Retail and Community Facilities and Minor Relaxation of Plot Ratio and Building Height Restriction in "Comprehensive Development Area" Zone at Various Lots in S.D.4 and Adjoining Government Land, Kau Wa Keng, Kwai Chung		
		AC			
		CHECKED			
		RH			
		APPROVED			
		CY			

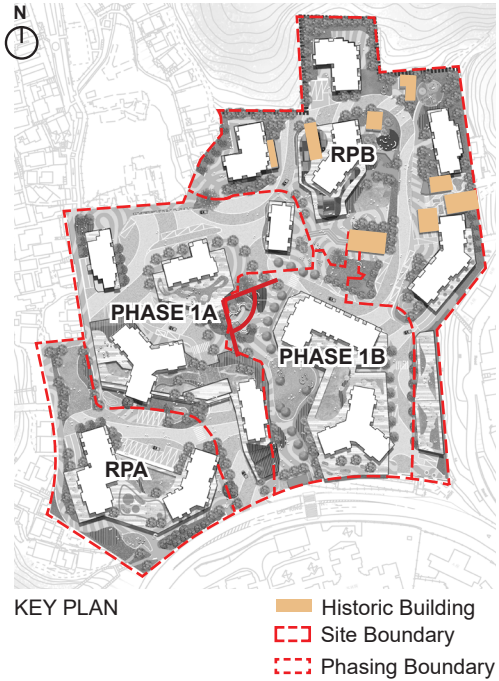


Images of existing conditions of the Grade 3 Historic Building (No.14-15 Kau Wa Keng and No.10 Kau Wa Keng)

*Notes: The historic buildings will be fully preserved and form part of the landscape to create a distinctive community environment for the project.



LEGEND	DRAWING TITLE PERSPECTIVE 03	DATE DEC 2025	FIGURE NO. FIG 1.12	SCALE AND ORIENTATION N.T.S	ARUP
		DRAWN AC	JOB TITLE Application for Permission Under Section 16 of the Town Planning Ordinance (Cap. 131) for Proposed Comprehensive Development including Flats, Retail and Community Facilities and Minor Relaxation of Plot Ratio and Building Height Restriction in "Comprehensive Development Area" Zone at Various Lots in S.D.4 and Adjoining Government Land, Kau Wa Keng, Kwai Chung		
		CHECKED RH			
		APPROVED CY			



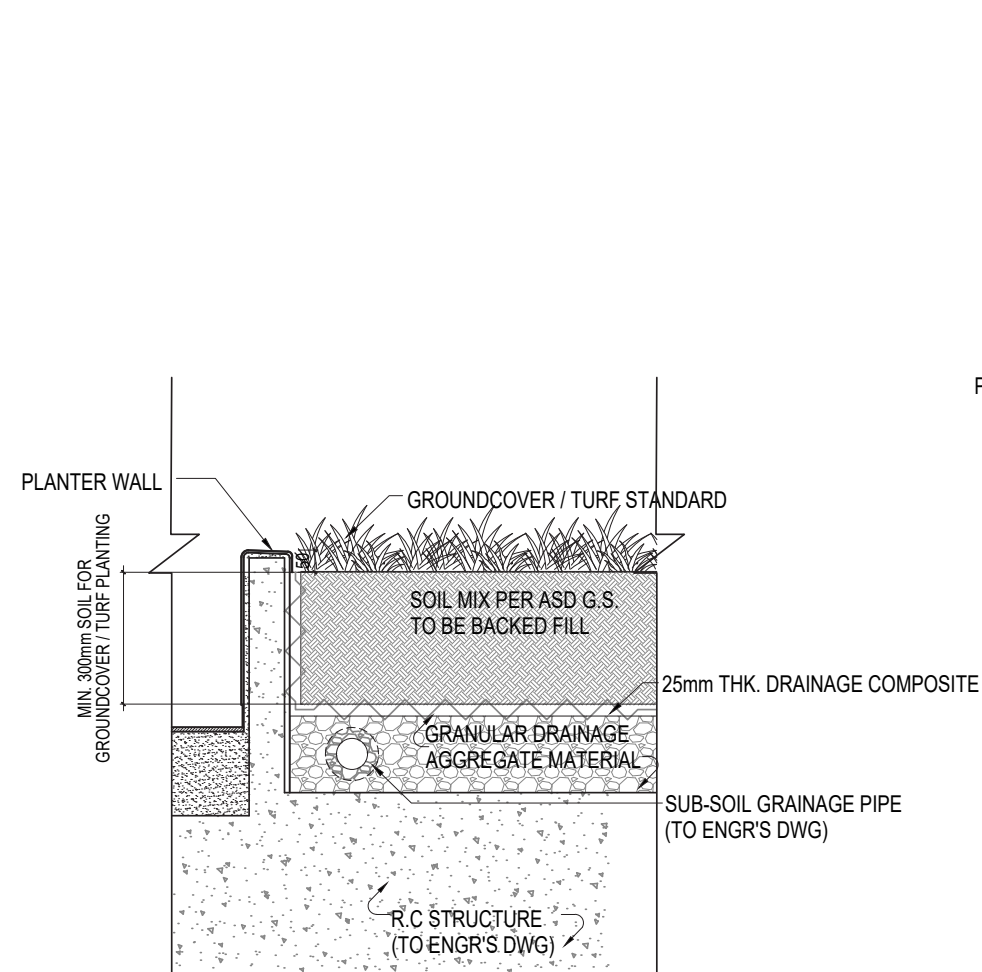
LEGEND	DRAWING TITLE PERSPECTIVE 04	DATE DEC 2025	FIGURE NO. FIG 1.13	SCALE AND ORIENTATION N.T.S	ARUP
		DRAWN AC	JOB TITLE Application for Permission Under Section 16 of the Town Planning Ordinance (Cap. 131) for Proposed Comprehensive Development including Flats, Retail and Community Facilities and Minor Relaxation of Plot Ratio and Building Height Restriction in "Comprehensive Development Area" Zone at Various Lots in S.D.4 and Adjoining Government Land, Kau Wa Keng, Kwai Chung		
		CHECKED RH			
		APPROVED CY			



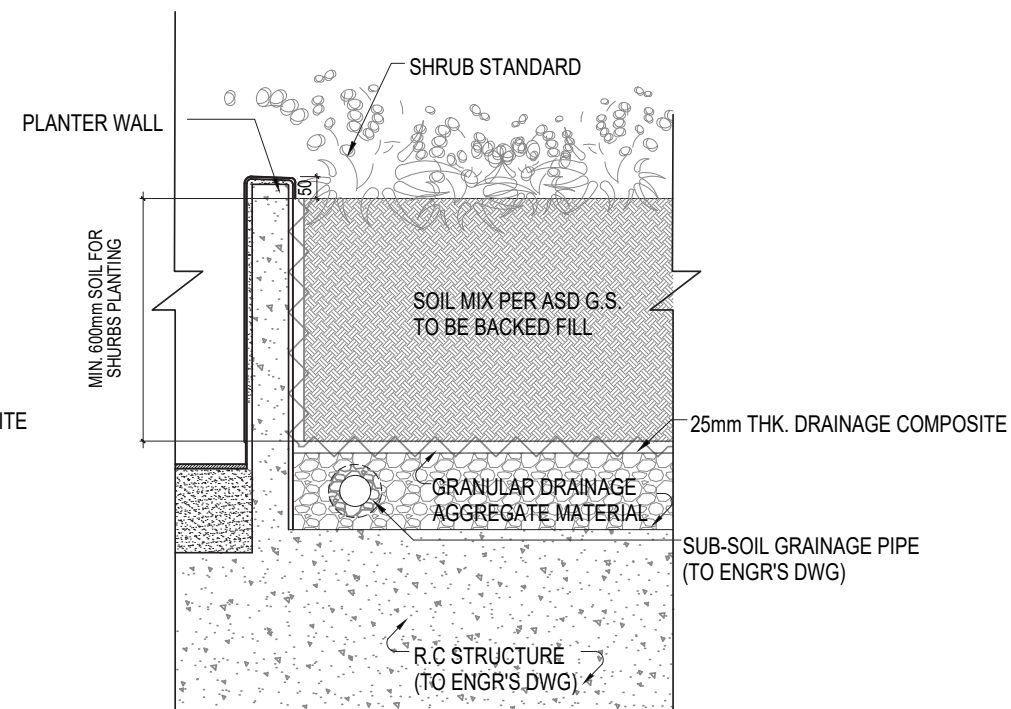
<div>LEGEND</div> <div>Local Open Space Provision: Not less than 19,038 sqm</div>	<div>DRAWING TITLE</div>	<div>DATE</div> <div>DEC 2025</div>	<div>FIGURE NO.</div> <div>FIG 1.14</div>	<div>SCALE AND ORIENTATION</div> <div>N.T.S</div>	<div>ARUP</div>	
		<div>DRAWN</div> <div>AC</div>	<div>JOB TITLE</div> <div>Application for Permission Under Section 16 of the Town Planning Ordinance (Cap. 131) for Proposed Comprehensive Development including Flats, Retail and Community Facilities and Minor Relaxation of Plot Ratio and Building Height Restriction in "Comprehensive Development Area" Zone at Various Lots in S.D.4 and Adjoining Government Land, Kau Wa Keng, Kwai Chung</div>			
		<div>CHECKED</div> <div>RH</div>				
		<div>APPROVED</div> <div>CY</div>				



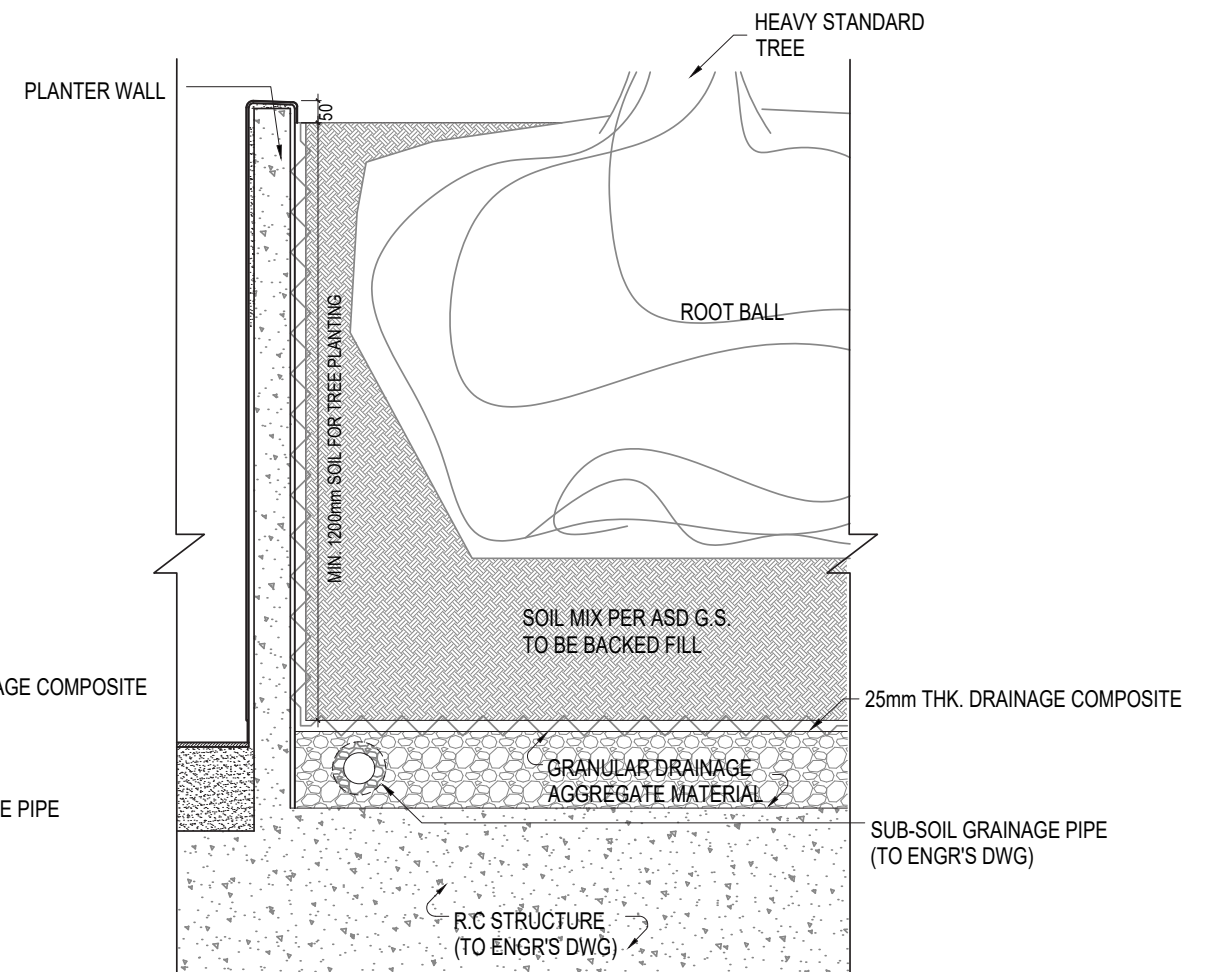
LEGEND	Greenery Area Provision: Total Not less than 14,494 sqm (30%)	DRAWING TITLE	DATE	FIGURE NO.	SCALE AND ORIENTATION	ARUP
		CALCULATION OF GREEN COVERAGE	DEC 2025	FIG 1.15	N.T.S	
			DRAWN	JOB TITLE		
			AC	Application for Permission Under Section 16 of the Town Planning Ordinance (Cap. 131) for Proposed Comprehensive Development including Flats, Retail and Community Facilities and Minor Relaxation of Plot Ratio and Building Height Restriction in "Comprehensive Development Area" Zone at Various Lots in S.D.4 and Adjoining Government Land, Kau Wa Keng, Kwai Chung		
		CHECKED	RH			
		APPROVED	CY			



2A
-
LAWN AND GROUND COVER SOIL DEPTH REQUIREMENT

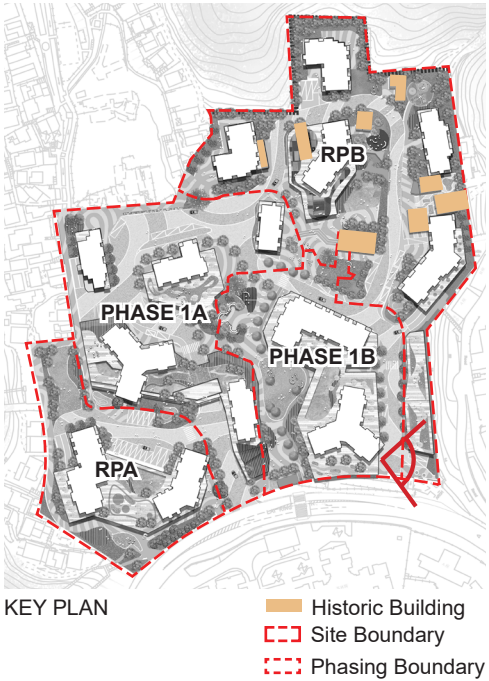


2B
-
SHRUBS SOIL DEPTH REQUIREMENT



2C
-
TREES SOIL DEPTH REQUIREMENT

LEGEND	DRAWING TITLE TYPICAL PLANTER DETAIL	DATE DEC 2025	FIGURE NO. FIG 1.16	SCALE AND ORIENTATION N.T.S	ARUP
		DRAWN AC	JOB TITLE Application for Permission Under Section 16 of the Town Planning Ordinance (Cap. 131) for Proposed Comprehensive Development including Flats, Retail and Community Facilities and Minor Relaxation of Plot Ratio and Building Height Restriction in “Comprehensive Development Area” Zone at Various Lots in S.D.4 and Adjoining Government Land, Kau Wa Keng, Kwai Chung		
		CHECKED RH			
		APPROVED CY			

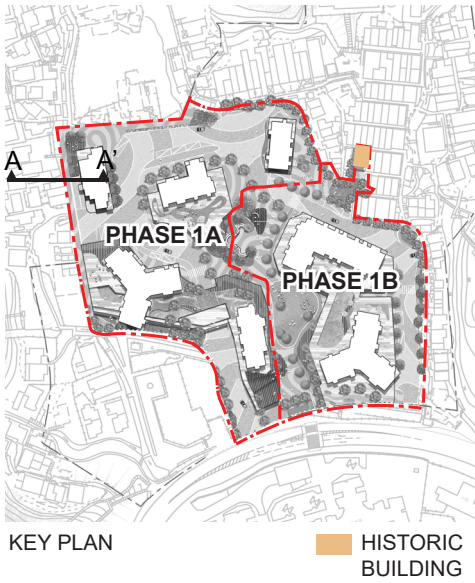
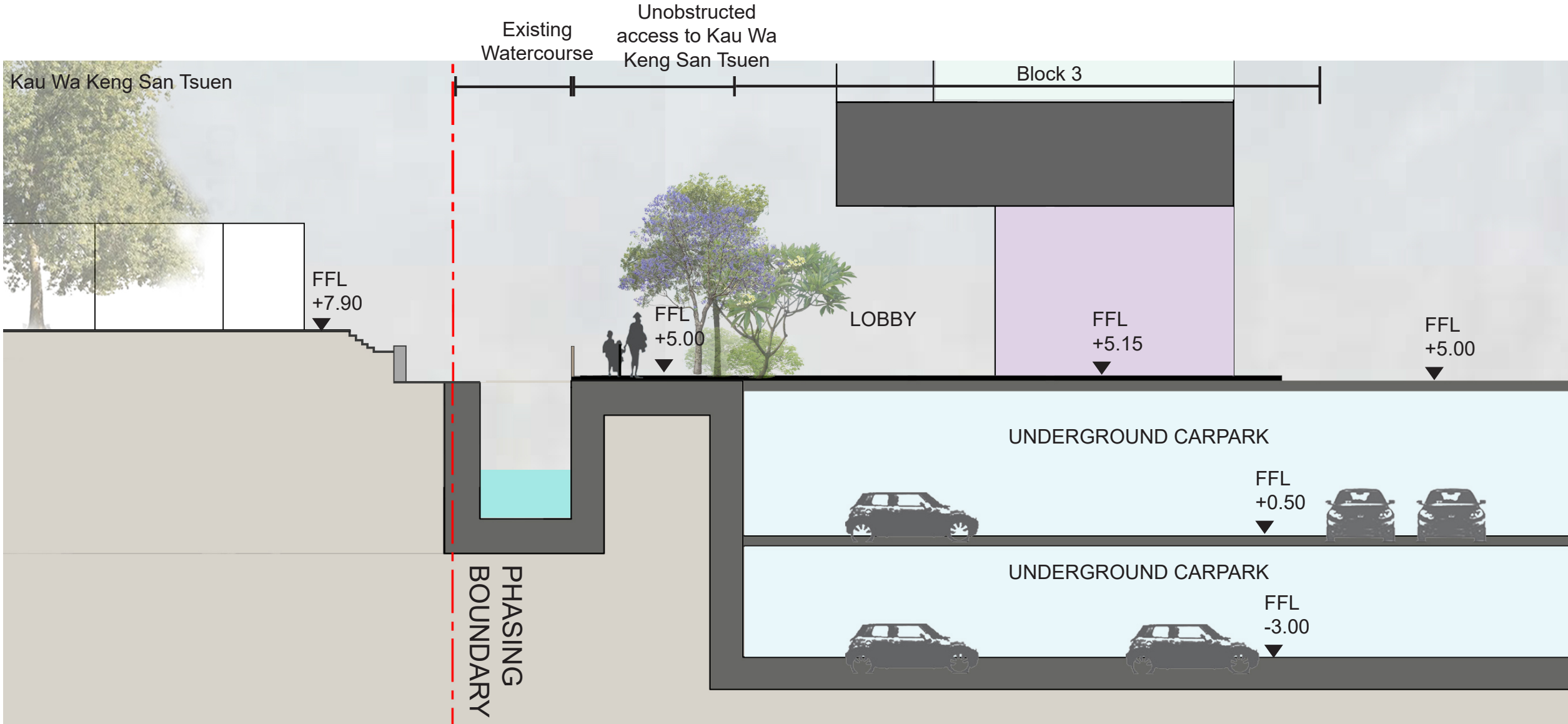


LEGEND	DRAWING TITLE ELEVATION 1	DATE DEC 2025	FIGURE NO. FIG 1.17	SCALE AND ORIENTATION N.T.S	ARUP
		DRAWN AC	JOB TITLE Application for Permission Under Section 16 of the Town Planning Ordinance (Cap. 131) for Proposed Comprehensive Development including Flats, Retail and Community Facilities and Minor Relaxation of Plot Ratio and Building Height Restriction in "Comprehensive Development Area" Zone at Various Lots in S.D.4 and Adjoining Government Land, Kau Wa Keng, Kwai Chung		
		CHECKED RH			
		APPROVED CY			

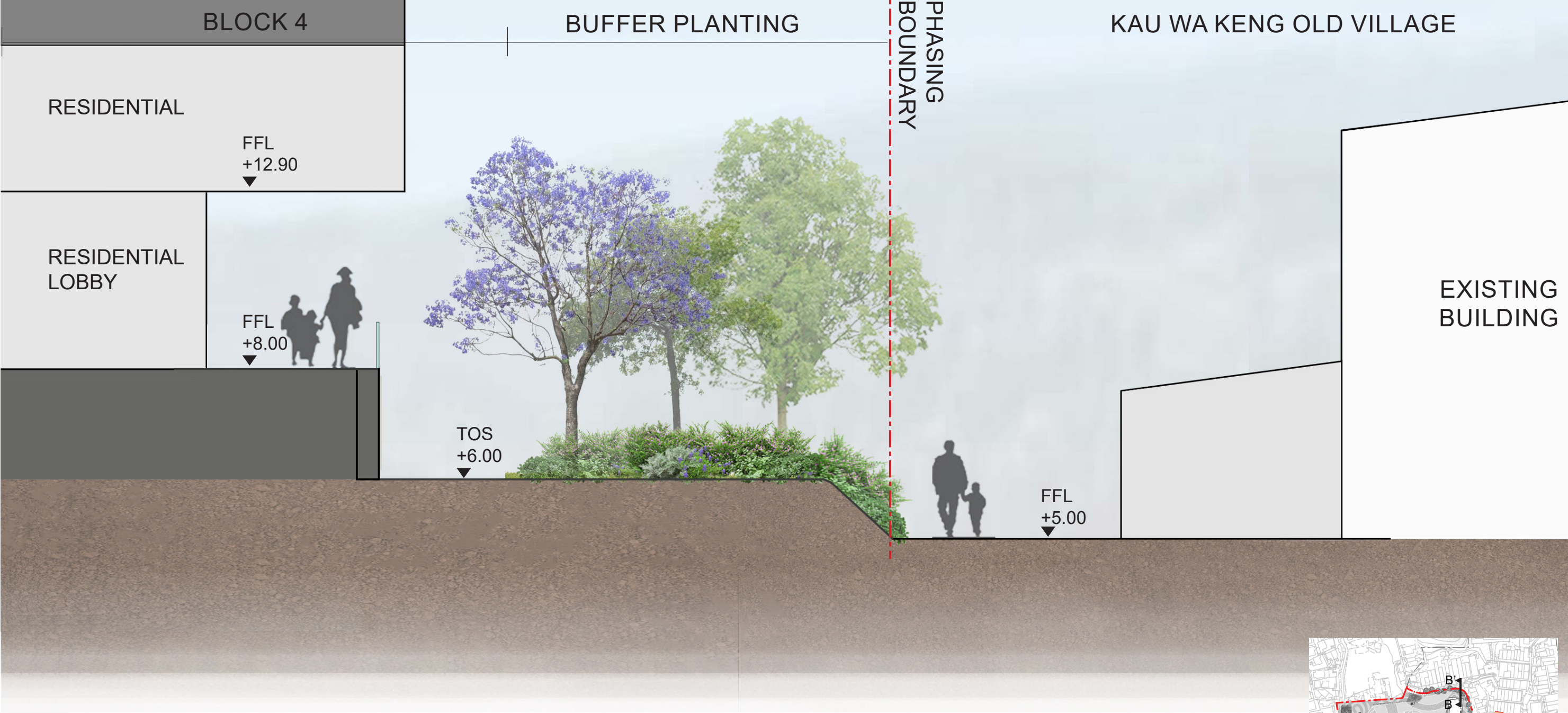


- LEGEND**
- [Red dashed line] SITE BOUNDARY
 - [Red dotted line] PHASING BOUNDARY
 - [Brown rectangle] HISTORIC BUILDING
 - [Green circle with cross] RETAINED TREE
 - [Yellow square] TRANSPLANT TREE
 - [Red triangle] PEDESTRIAN ENTRANCE
 - [Blue triangle] VEHICULAR ENTRANCE
 - [Green line] GREEN WALL
 - ① LANDSCAPE PLAZA
 - ② OPEN LAWN AREA
 - ③ COURTYARD
 - ④ SWIMMING POOL
 - ⑤ F&B AREA
 - ⑥ POCKET SEATING SPACE
 - ⑦ OUTDOOR GYM AREA
 - ⑧ KIDS PLAY AREA
 - ⑨ HISTORICAL THEME PLAZA
 - ⑩ EVA

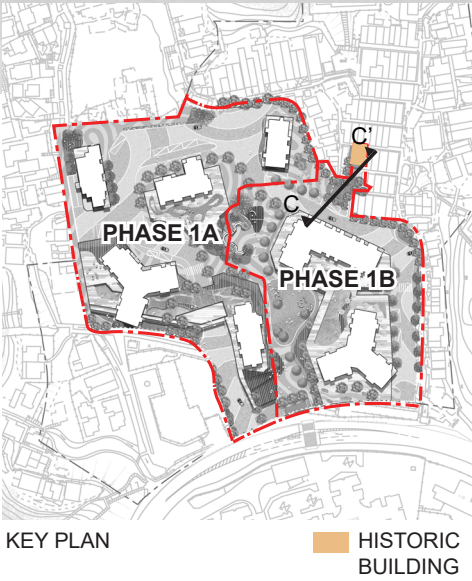
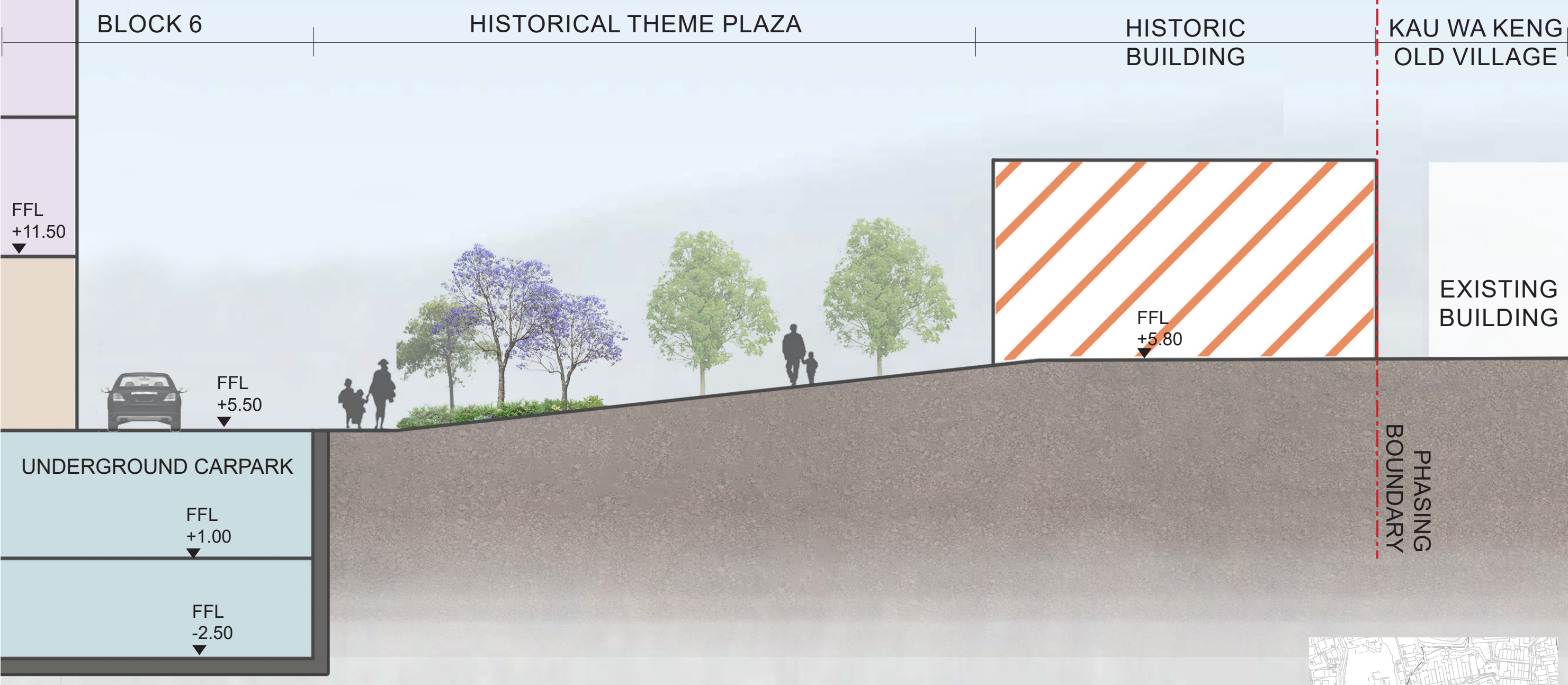
LEGEND	DRAWING TITLE LANDSCAPE MASTER PLAN	DATE DEC 2025	FIGURE NO. FIG 1.18	SCALE AND ORIENTATION 1:1500@A3	ARUP
		DRAWN AC	JOB TITLE Application for Permission Under Section 16 of the Town Planning Ordinance (Cap. 131) for Proposed Comprehensive Development including Flats, Retail and Community Facilities and Minor Relaxation of Plot Ratio and Building Height Restriction in "Comprehensive Development Area" Zone at Various Lots in S.D.4 and Adjoining Government Land, Kau Wa Keng, Kwai Chung		
		CHECKED RH			
		APPROVED CY			



LEGEND	DRAWING TITLE SECTION A-A'	DATE DEC 2025	FIGURE NO. FIG 1.19a	SCALE AND ORIENTATION N.T.S	ARUP
		DRAWN AC	JOB TITLE Application for Permission Under Section 16 of the Town Planning Ordinance (Cap. 131) for Proposed Comprehensive Development including Flats, Retail and Community Facilities and Minor Relaxation of Plot Ratio and Building Height Restriction in "Comprehensive Development Area" Zone at Various Lots in S.D.4 and Adjoining Government Land, Kau Wa Keng, Kwai Chung		
		CHECKED RH			
		APPROVED CY			



LEGEND	DRAWING TITLE SECTION B-B'	DATE	FIGURE NO.	SCALE AND ORIENTATION	ARUP
		DEC 2025	FIG 1.19b	N.T.S	
		DRAWN	JOB TITLE Application for Permission Under Section 16 of the Town Planning Ordinance (Cap. 131) for Proposed Comprehensive Development including Flats, Retail and Community Facilities and Minor Relaxation of Plot Ratio and Building Height Restriction in "Comprehensive Development Area" Zone at Various Lots in S.D.4 and Adjoining Government Land, Kau Wa Keng, Kwai Chung		
		CHECKED			
		APPROVED			
		AC			
		RH			
		CY			



LEGEND	DRAWING TITLE SECTION C-C'	DATE DEC 2025	FIGURE NO. FIG 1.19c	SCALE AND ORIENTATION N.T.S	ARUP
		DRAWN AC	JOB TITLE Application for Permission Under Section 16 of the Town Planning Ordinance (Cap. 131) for Proposed Comprehensive Development including Flats, Retail and Community Facilities and Minor Relaxation of Plot Ratio and Building Height Restriction in "Comprehensive Development Area" Zone at Various Lots in S.D.4 and Adjoining Government Land, Kau Wa Keng, Kwai Chung		
		CHECKED RH			
		APPROVED CY			

Appendix A

Tree Assessment Schedule

Tree Survey Schedule

Prepared by
Field Study was conducted in

Luk Ka Chun (ISA Certification no.HK-0662A)
21/03/2024

Tree No.	Scientific Name	Chinese Common Name	Measurement			(Good/Fair/Poor)				Suitability for Transplant (High/Medium/Low)	Conservation Status	Recommendation (Retain/Transplant/Fell)	Justification [1]	Department to provide expert advice to LandsD	Additional Remarks
			Height (m)	DBH (mm)	Crown Spread (m)	Amenity	Form	Health	Structure						
1A-T001	<i>Bombax ceiba</i>	木棉	10	430	5	Fair	Fair	Fair	Fair	Low	-	Fell	A, D, E	LandsD/ Tree Unit	Restricted Root Flare, Leaning
1A-T004	<i>Artocarpus heterophyllus</i>	菠蘿蜜	6	100	2	Fair	Fair	Fair	Fair	Low	-	Fell	A, D, E	LandsD/ Tree Unit	Restricted Root Flare
1A-T005	<i>Artocarpus heterophyllus</i>	菠蘿蜜	6	160	3	Fair	Fair	Fair	Fair	Low	-	Fell	A, D, E	LandsD/ Tree Unit	Restricted Root Flare
1A-T006	<i>Clausena lansium</i>	黃皮	4	160	2	Fair	Fair	Fair	Fair	Low	-	Fell	A, D, E	LandsD/ Tree Unit	Restricted Root Flare
1A-T007	<i>Clausena lansium</i>	黃皮	5	100	2	Fair	Fair	Fair	Fair	Low	-	Fell	A, D, E	LandsD/ Tree Unit	Restricted Root Flare
1A-T008	<i>Citrus maxima</i>	柚子	5	100	3	Fair	Fair	Fair	Fair	Low	-	Fell	A, D, E	LandsD/ Tree Unit	Restricted Root Flare
1A-T009	<i>Dimocarpus longan</i>	龍眼	12	330	5	Poor	Poor	Poor	Poor	Low	-	Fell	A, D, E	LandsD/ Tree Unit	Restricted Root Flare
1A-T010	<i>Clausena lansium</i>	黃皮	4	100	2	Fair	Fair	Fair	Fair	Low	-	Fell	A, D, E	LandsD/ Tree Unit	Restricted Root Flare, Crossed with the fencing
1A-T011	<i>Dimocarpus longan</i>	龍眼	5	100	2	Poor	Poor	Poor	Poor	Low	-	Fell	A, D, E	LandsD/ Tree Unit	Twisted Trunk, Co-dominant Trunk
1A-T014	<i>Dimocarpus longan</i>	龍眼	11	480	9	Fair	Fair	Fair	Fair	Low	-	Fell	A, C, D, E	LandsD/ Tree Unit	
1A-T015	<i>Dimocarpus longan</i>	龍眼	10	340	8	Poor	Poor	Poor	Poor	Low	-	Fell	A, D, E	LandsD/ Tree Unit	Leaning, Co-dominant Trunk, Restricted Root Flare
1A-T016	<i>Dimocarpus longan</i>	龍眼	6	150	9	Poor	Poor	Poor	Poor	Low	-	Fell	A, D, E	LandsD/ Tree Unit	Leaning, Twisted Trunk, Restricted Root Flare
1A-T017	<i>Clausena lansium</i>	黃皮	7	160	4	Poor	Poor	Poor	Poor	Low	-	Fell	A, D, E	LandsD/ Tree Unit	Leaning,Co-dominant Trunk, Included Bark, Restricted Root Flare
1A-T018	<i>Dimocarpus longan</i>	龍眼	10	380	6	Poor	Poor	Poor	Poor	Low	-	Fell	A, D, E	LandsD/ Tree Unit	Leaning, Restricted Root Flare
1A-T019	<i>Averrhoa carambola</i>	楊桃	4	170+170	3	Fair	Fair	Fair	Fair	Low	-	Fell	A, D, E	LandsD/ Tree Unit	Leaning, Restricted Root Flare
1A-T020	<i>Ficus microcarpa</i>	細葉榕	8	2000	12	Fair	Fair	Fair	Fair	Low	-	Fell	A, D, E	LandsD/ Tree Unit	Mature Tree, Co-dominant Trunk, Cross Branches, Twisted Branches
1A-T021	<i>Dimocarpus longan</i>	龍眼	5	150	3	Poor	Poor	Poor	Poor	Low	-	Fell	A, D, E	LandsD/ Tree Unit	Co-dominant Trunk, Leaning
1A-T022	<i>Mangifera indica</i>	芒果	8	390	4	Poor	Poor	Poor	Poor	Low	-	Fell	A, D, E	LandsD/ Tree Unit	Co-dominant Trunk, Unbalanced Form, Broken Branches, Crossed Branches, Restricted Root Flare
1A-T023	<i>Dimocarpus longan</i>	龍眼	7	250	5	Poor	Poor	Poor	Poor	Low	-	Fell	A, D, E	LandsD/ Tree Unit	Leaning, Restricted Root Flare
1A-T025	<i>Dimocarpus longan</i>	龍眼	10	400	5	Poor	Poor	Poor	Poor	Low	-	Fell	A, B, D, E	LandsD/ Tree Unit	Dead
1A-T026	<i>Litchi chinensis</i>	荔枝	8	420	7	Poor	Poor	Poor	Poor	Low	-	Fell	A, D, E	LandsD/ Tree Unit	Leaning, Restricted Root Flare, Crossed Branches, Twisted Branches
1A-T027	<i>Clausena lansium</i>	黃皮	8	280	4	Fair	Fair	Fair	Fair	Low	-	Fell	A, D, E	LandsD/ Tree Unit	Multi Stem, Restricted Root Flare
1A-T028	<i>Artocarpus heterophyllus</i>	菠蘿蜜	5	100	1	Poor	Poor	Poor	Poor	Low	-	Fell	A, B, D, E	LandsD/ Tree Unit	Dead
1A-T029	<i>Artocarpus heterophyllus</i>	菠蘿蜜	6	180	3	Fair	Fair	Fair	Fair	Low	-	Fell	A, D, E	LandsD/ Tree Unit	Leaning
1A-T030	<i>Artocarpus heterophyllus</i>	菠蘿蜜	7	150	2	Fair	Fair	Fair	Fair	Low	-	Fell	A, D, E	LandsD/ Tree Unit	Co-dominant Trunk, Wound
1A-T031	<i>Artocarpus heterophyllus</i>	菠蘿蜜	6	110	2	Fair	Fair	Fair	Fair	Low	-	Fell	A, D, E	LandsD/ Tree Unit	Leaning, Wound
1A-T032	<i>Artocarpus heterophyllus</i>	菠蘿蜜	7	130	2	Fair	Fair	Fair	Fair	Low	-	Fell	A, D, E	LandsD/ Tree Unit	Co-dominant Trunk, Wound
1A-T033	<i>Citrus maxima</i>	柚子	7	140	4	Fair	Fair	Fair	Fair	Low	-	Fell	A, D, E	LandsD/ Tree Unit	Co-dominant Trunk, Wound, Inclued Bark
1A-T034	<i>Artocarpus heterophyllus</i>	菠蘿蜜	7	130	2	Fair	Fair	Fair	Fair	Low	-	Fell	A, D, E	LandsD/ Tree Unit	Co-dominant Trunk
1A-T034A	<i>Litchi chinensis</i>	荔枝	5	110	4	Fair	Fair	Fair	Fair	Low	-	Fell	A, C, D, E	LandsD/ Tree Unit	
1A-T035	<i>Psidium guajava</i>	番石榴	4	120	1	Fair	Fair	Fair	Fair	Low	-	Fell	A, D, E	LandsD/ Tree Unit	Wound
1A-T035A	<i>Artocarpus heterophyllus</i>	菠蘿蜜	7	190	3	Fair	Fair	Fair	Fair	Low	-	Fell	A, C, D, E	LandsD/ Tree Unit	
1A-T035B	<i>Psidium guajava</i>	番石榴	4	160	2	Fair	Fair	Fair	Fair	Low	-	Fell	A, C, D, E	LandsD/ Tree Unit	
1A-T037	<i>Artocarpus heterophyllus</i>	菠蘿蜜	4	150	3	Fair	Fair	Fair	Fair	Low	-	Fell	A, D, E	LandsD/ Tree Unit	Restricted Root Flare
1A-T038	<i>Artocarpus heterophyllus</i>	菠蘿蜜	7	150	4	Fair	Fair	Fair	Fair	Low	-	Fell	A, D, E	LandsD/ Tree Unit	Restricted Root Flare
1A-T039	<i>Dimocarpus longan</i>	龍眼	5	130	3	Poor	Poor	Poor	Poor	Low	-	Fell	A, D, E	LandsD/ Tree Unit	Restricted Root Flare
1A-T040	<i>Artocarpus heterophyllus</i>	菠蘿蜜	6	110	2	Fair	Fair	Fair	Fair	Low	-	Fell	A, D, E	LandsD/ Tree Unit	Restricted Root Flare
1A-T041	<i>Artocarpus heterophyllus</i>	菠蘿蜜	7	120	3	Fair	Fair	Fair	Fair	Low	-	Fell	A, D, E	LandsD/ Tree Unit	Restricted Root Flare
1A-T042	<i>Cinnamomum camphora</i>	樟樹	8	170	4	Fair	Fair	Fair	Fair	Low	-	Fell	A, D, E	LandsD/ Tree Unit	Restricted Root Flare
1A-T044	<i>Roystonea regia</i>	王棕	10	500	4	Fair	Fair	Fair	Fair	Medium	-	Transplant	A	LandsD/ Tree Unit	-
1A-T045	<i>Roystonea regia</i>	王棕	11	450	3	Fair	Fair	Fair	Fair	Medium	-	Transplant	A	LandsD/ Tree Unit	-
1A-T046	<i>Dimocarpus longan</i>	龍眼	3	120	2	Poor	Poor	Poor	Poor	Low	-	Fell	A, D, E	LandsD/ Tree Unit	Leaning, Restricted Root Flare
1A-T047	<i>Macaranga tanarius</i>	血桐	4	160	2	Fair	Fair	Fair	Fair	Low	-	Fell	A, D, E	LandsD/ Tree Unit	Leaning, Crossed with 1A-T048
1A-T048	<i>Macaranga tanarius</i>	血桐	5	170	2	Fair	Fair	Fair	Fair	Low	-	Retain	-	LandsD/ Tree Unit	Leaning, Crossed with 1A-T049, Restricted Root Flare
1A-T049	<i>Macaranga tanarius</i>	血桐	4	150	2	Fair	Fair	Fair	Fair	Low	-	Retain	-	LandsD/ Tree Unit	Leaning, Crossed with 1A-T048
1A-T050	<i>Roystonea regia</i>	王棕	11	460	3	Fair	Fair	Fair	Fair	Medium	-	Retain	-	LandsD/ Tree Unit	-
1A-T053	<i>Dimocarpus longan</i>	龍眼	7	360	5	Poor	Poor	Poor	Poor	Low	-	Retain	-	LandsD/ Tree Unit	Co-dominant Trunk, Included Bark
1A-T054	<i>Carica papaya</i>	番木瓜	4	100	1	Fair	Fair	Fair	Fair	Low	-	Fell	A, D, E	LandsD/ Tree Unit	Leaning
1A-T055	<i>Litchi chinensis</i>	荔枝	6	120	2	Fair	Fair	Fair	Fair	Low	-	Fell	A, D, E	LandsD/ Tree Unit	Co-dominant Trunk
1A-T056	<i>Dimocarpus longan</i>	龍眼	8	140	5	Poor	Poor	Poor	Poor	Low	-	Retain	-	LandsD/ Tree Unit	Co-dominant Trunk, Restricted Root Flare
1A-T058	<i>Morus alba</i>	桑	7	170	4	Fair	Fair	Fair	Fair	Low	-	Fell	A, C, D, E	LandsD/ Tree Unit	
1A-T059	<i>Artocarpus heterophyllus</i>	菠蘿蜜	6	140	3	Fair	Fair	Fair	Fair	Low	-	Fell	A, C, D, E	LandsD/ Tree Unit	
1A-T062	<i>Citrus maxima</i>	柚子	8	130	6	Fair	Fair	Fair	Fair	Low	-	Fell	A, D, E	LandsD/ Tree Unit	Leaning
1A-T063	<i>Mangifera indica</i>	芒果	7	260	5	Poor	Poor	Poor	Poor	Low	-	Fell	A, D, E	LandsD/ Tree Unit	Leaning, Twisted Branches, Crossed with other vegetation
1A-T064	<i>Psidium guajava</i>	番石榴	6	200	4	Fair	Fair	Fair	Fair	Low	-	Fell	A, D, E	LandsD/ Tree Unit	Leaning, Restricted Root Flare
1A-T065	<i>Dimocarpus longan</i>	龍眼	6	210	5	Poor	Poor	Poor	Poor	Low	-	Fell	A, D, E	LandsD/ Tree Unit	Leaning, Crossed with 1A-T060
1A-T066	<i>Mangifera indica</i>	芒果	8	180	4	Poor	Poor	Poor	Poor	Low	-	Fell	A, D, E	LandsD/ Tree Unit	Restricted Root Flare, Multi Stem
1A-T067	<i>Macaranga tanarius</i>	血桐	5	220	5	Fair	Fair	Fair	Fair	Low	-	Fell	A, D, E	LandsD/ Tree Unit	Restricted Root Flare, Leaning, Crossed Branches
1A-T069	<i>Carica papaya</i>	番木瓜	4	130	2	Fair	Fair	Fair	Fair	Low	-	Fell	A, C, D, E	LandsD/ Tree Unit	On slope, Restricted Root Flare
1A-T071	<i>Carica papaya</i>	番木瓜	2.5	130	2	Fair	Fair	Fair	Fair	Low	-	Fell	A, C, D, E	LandsD/ Tree Unit	On slope, Restricted Root Flare
1A-T072	<i>Ficus hispida</i>	對葉榕	5	130	2	Fair	Fair	Fair	Fair	Low	-	Fell	A, D, E	LandsD/ Tree Unit	Co-dominant Trunk, Restricted Root Flare
1A-T072A	<i>Carica papaya</i>	番木瓜	4	140	3	Fair	Fair	Fair	Fair	Low	-	Fell	A, C, D, E	LandsD/ Tree Unit	
1A-T072B	<i>Mallotus paniculatus</i>	白楸	5	140	3	Fair	Fair	Fair	Fair	Low	-	Fell	A, C, D, E	LandsD/ Tree Unit	

Tree No.	Scientific Name	Chinese Common Name	Measurement			(Good/Fair/Poor)				Suitability for Transplant (High/Medium/Low)	Conservation Status	Recommendation (Retain/Transplant/Fell)	Justification [1]	Department to provide expert advice to LandsD	Additional Remarks
			Height (m)	DBH (mm)	Crown Spread (m)	Amenity	Form	Health	Structure						
1A-T073	<i>Clausena lansium</i>	黃皮	4	150	3	Fair	Fair	Fair	Fair	Low	-	Fell	A, D, E	LandsD/ Tree Unit	Co-dominant Trunk, Restricted Root Flare
1A-T074	<i>Artocarpus heterophyllus</i>	菠蘿蜜	6	235	3	Fair	Fair	Fair	Fair	Low	-	Fell	A, D, E	LandsD/ Tree Unit	Restricted Root Flare
1A-T075	<i>Macaranga tanarius</i>	血桐	5	350	7	Fair	Fair	Fair	Fair	Low	-	Fell	A, D, E	LandsD/ Tree Unit	Leaning, Twisted Branches, Unbalanced Form
1A-T076	<i>Macaranga tanarius</i>	血桐	6	160+145	6	Fair	Fair	Fair	Fair	Low	-	Fell	A, D, E	LandsD/ Tree Unit	Leaning, Restricted Root Flare
1A-T079	<i>Macaranga tanarius</i>	血桐	6	170	5	Fair	Fair	Fair	Fair	Low	-	Fell	A, D, E	LandsD/ Tree Unit	Co-dominant Trunk, On slope
1A-T080	<i>Ficus hispida</i>	對葉榕	4	140+125	4	Poor	Poor	Poor	Poor	Low	-	Fell	A, B, D, E	LandsD/ Tree Unit	Dead
1A-T081	<i>Ficus variegata</i>	青果榕	3	110	1	Fair	Fair	Fair	Fair	Low	-	Fell	A, D, E	LandsD/ Tree Unit	Covered by climber and vine
1A-T082	<i>Artocarpus heterophyllus</i>	菠蘿蜜	6	130	3	Fair	Fair	Fair	Fair	Low	-	Fell	A, D, E	LandsD/ Tree Unit	Leaning, Crossed with Fencing
1A-T084	<i>Dimocarpus longan</i>	龍眼	4	110	2	Fair	Fair	Fair	Fair	Medium	-	Transplant	A	LandsD/ Tree Unit	-
1A-T085	<i>Artocarpus heterophyllus</i>	菠蘿蜜	4	110	2	Fair	Fair	Fair	Fair	Low	-	Fell	A, C, D, E	LandsD/ Tree Unit	
1A-T086	<i>Dimocarpus longan</i>	龍眼	4	260	6	Fair	Fair	Fair	Fair	Low	-	Fell	A, C, D, E	LandsD/ Tree Unit	
1A-T087	<i>Litchi chinensis</i>	荔枝	6	165	4	Fair	Fair	Fair	Fair	Low	-	Fell	A, C, D, E	LandsD/ Tree Unit	
1A-T088	<i>Litchi chinensis</i>	荔枝	6	135	3	Fair	Fair	Fair	Fair	Low	-	Fell	A, C, D, E	LandsD/ Tree Unit	
1A-T089	<i>Elaeocarpus sylvestris</i>	杜英	4	110	2	Fair	Fair	Fair	Fair	Low	-	Fell	A, C, D, E	LandsD/ Tree Unit	
1A-T090	<i>Artocarpus heterophyllus</i>	菠蘿蜜	5	160	3	Fair	Fair	Fair	Fair	Low	-	Fell	A, C, D, E	LandsD/ Tree Unit	
1B-T001	<i>Dimocarpus longan</i>	龍眼	8	380	5	Poor	Poor	Poor	Poor	Low	-	Fell	A, D, E	LandsD/ Tree Unit	Leaning, Restricted Root Flare
1B-T002	<i>Celtis sinensis</i>	朴樹	8	460	8	Fair	Fair	Fair	Fair	Low	-	Fell	A, D, E	LandsD/ Tree Unit	Co-dominant Trunks, Restricted Root Flare
1B-T003	<i>Dimocarpus longan</i>	龍眼	9	380	6	Poor	Poor	Poor	Poor	Low	-	Fell	A, D, E	LandsD/ Tree Unit	Leaning, Crossed Branches, Crossed with other vegetation
1B-T004	<i>Dimocarpus longan</i>	龍眼	6	200	4	Poor	Poor	Poor	Poor	Low	-	Fell	A, D, E	LandsD/ Tree Unit	Leaning, Twisted Branches, Crossed with other vegetation
1B-T005	<i>Mangifera indica</i>	芒果	10	400	6	Fair	Fair	Fair	Fair	Low	-	Fell	A, D, E	LandsD/ Tree Unit	Co-dominant Trunk
1B-T006	<i>Artocarpus heterophyllus</i>	菠蘿蜜	8	160	4	Fair	Fair	Fair	Fair	Low	-	Fell	A, D, E	LandsD/ Tree Unit	Leaning, Crossed with the fencing
1B-T007	<i>Morus alba</i>	桑	8	200	7	Fair	Fair	Fair	Fair	Low	-	Fell	A, D, E	LandsD/ Tree Unit	Leaning, Crossed with the fencing
1B-T008	<i>Psidium guajava</i>	番石榴	4	200	2	Fair	Fair	Fair	Fair	Low	-	Fell	A, D, E	LandsD/ Tree Unit	Heavy Leaning
1B-T009	<i>Clausena lansium</i>	黃皮	5	150	2	Fair	Fair	Fair	Fair	Low	-	Fell	A, D, E	LandsD/ Tree Unit	Dieback
1B-T010	<i>Michelia x alba</i>	白蘭	12	140	2	Fair	Fair	Fair	Fair	Low	-	Fell	A, D, E	LandsD/ Tree Unit	Restricted Root Flare
1B-T011	<i>Michelia x alba</i>	白蘭	14	200	3	Fair	Fair	Fair	Fair	Low	-	Fell	A, D, E	LandsD/ Tree Unit	Restricted Root Flare
1B-T012	<i>Clausena lansium</i>	黃皮	6	110	2	Fair	Fair	Fair	Fair	Low	-	Fell	A, D, E	LandsD/ Tree Unit	Restricted Root Flare
1B-T014	<i>Aleurites moluccanus</i>	石栗	16	680	3	Fair	Fair	Fair	Fair	Low	-	Fell	A, D, E	LandsD/ Tree Unit	Restricted Root Flare, Twisted Branches
1B-T015	<i>Litchi chinensis</i>	荔枝	12	580	3	Fair	Fair	Fair	Fair	Low	-	Fell	A, D, E	LandsD/ Tree Unit	Co-dominant Trunk, Twisted Trunk
1B-T016	<i>Citrus maxima</i>	柚子	6	160	2	Fair	Fair	Fair	Fair	Low	-	Fell	A, D, E	LandsD/ Tree Unit	Unbalanced Form, Leaning
1B-T017	<i>Macaranga tanarius</i>	血桐	4	130	2	Fair	Fair	Fair	Fair	Low	-	Fell	A, D, E	LandsD/ Tree Unit	Leaning, Twisted Branches, Restricted Root Flare
1B-T018	<i>Citrus maxima</i>	柚子	4	160	2	Fair	Fair	Fair	Fair	Low	-	Fell	A, D, E	LandsD/ Tree Unit	Leaning, Restricted Root Flare
1B-T019	<i>Clausena lansium</i>	黃皮	3	95	3	Fair	Fair	Fair	Fair	Low	-	Fell	A, D, E	LandsD/ Tree Unit	Leaning, Restricted Root Flare
1B-T020	<i>Ficus virens</i>	大葉榕	9	1500	3	Fair	Fair	Fair	Fair	Low	-	Fell	A, D, E	LandsD/ Tree Unit	Mature Tree, Covered with climbers, Co-dominant Trunk
1B-T021	<i>Dimocarpus longan</i>	龍眼	6	230	3	Fair	Fair	Fair	Fair	Low	-	Fell	A, D, E	LandsD/ Tree Unit	Cross with other vegetation
1B-T022	<i>Mangifera indica</i>	芒果	8	420	2	Fair	Fair	Fair	Fair	Low	-	Fell	A, D, E	LandsD/ Tree Unit	Leaning
1B-T024	<i>Dimocarpus longan</i>	龍眼	4	100	2	Fair	Fair	Fair	Fair	Low	-	Fell	A, D, E	LandsD/ Tree Unit	Cross with other vegetation, Dieback
1B-T025	<i>Dimocarpus longan</i>	龍眼	8	180	6	Fair	Fair	Fair	Fair	Low	-	Fell	A, D, E	LandsD/ Tree Unit	Co-dominant Trunk, Restricted Root Flare
1B-T026	<i>Clausena lansium</i>	黃皮	7	130	4	Fair	Fair	Fair	Fair	Low	-	Fell	A, D, E	LandsD/ Tree Unit	Co-dominant Trunk, Restricted Root Flare
1B-T027	<i>Dimocarpus longan</i>	龍眼	7	280	4	Fair	Fair	Fair	Fair	Low	-	Fell	A, D, E	LandsD/ Tree Unit	Restricted Root Flare, Co-dominant Trunk
1B-T028	<i>Macaranga tanarius</i>	血桐	9	260	5	Fair	Fair	Fair	Fair	Low	-	Fell	A, D, E	LandsD/ Tree Unit	Leaning, Restricted Root Flare
1B-T029	<i>Averrhoa carambola</i>	楊桃	8	260	5	Fair	Fair	Fair	Fair	Low	-	Fell	A, D, E	LandsD/ Tree Unit	Co-dominant Trunk, Restricted Root Flare
1B-T030	<i>Bauhinia purpurea</i>	紅花羊蹄甲	10	560	5	Fair	Fair	Fair	Fair	Low	-	Fell	A, D, E	LandsD/ Tree Unit	Multi Trunk, Restricted Root Flare,Broken Branches
1B-T031	<i>Microcos nervosa</i>	布渣葉	8	180	4	Fair	Fair	Fair	Fair	Low	-	Fell	A, D, E	LandsD/ Tree Unit	Co-dominant Trunk, Restricted Root Flare
1B-T032	<i>Ficus elastica</i>	印度橡樹	13	1000	7	Fair	Fair	Poor	Fair	Low	-	Fell	A, B, D, E	LandsD/ Tree Unit	Mature Tree, Leaning, Dead Branches, Co-dominant Trunk, Restricted Root Flare
1B-T040	<i>Ficus variegata</i>	青果榕	6	380	6	Fair	Fair	Fair	Fair	Low	-	Fell	A, D, E	LandsD/ Tree Unit	Restricted Root, Co-dominant Trunk
1B-T041	<i>Ficus subpisocarpa</i>	筆管榕	3.5	270	4	Fair	Fair	Fair	Fair	Low	-	Fell	A, C, D, E	LandsD/ Tree Unit	On slope, Restricted Root Flare
1B-T043	<i>Dimocarpus longan</i>	龍眼	5	110	2	Fair	Fair	Fair	Fair	Low	-	Fell	A, C, D, E	LandsD/ Tree Unit	On slope, Restricted Root Flare
1B-T044	<i>Eriobotrya japonica</i>	枇杷	4	130	3	Fair	Fair	Fair	Fair	Low	-	Fell	A, D, E	LandsD/ Tree Unit	Twisted Trunk
1B-T045	<i>Eriobotrya japonica</i>	枇杷	4	120	2	Fair	Fair	Fair	Fair	Low	-	Fell	A, D, E	LandsD/ Tree Unit	Forked
1B-T046	<i>Dimocarpus longan</i>	龍眼	6	220	4	Fair	Fair	Fair	Fair	Low	-	Fell	A, D, E	LandsD/ Tree Unit	Restricted Root Flare
1B-T047	<i>Citrus maxima</i>	柚子	5	180	3	Fair	Fair	Fair	Fair	Low	-	Fell	A, D, E	LandsD/ Tree Unit	Restricted Root Flare
1B-T049	<i>Citrus maxima</i>	柚子	5	130	2	Fair	Fair	Fair	Fair	Low	-	Fell	A, D, E	LandsD/ Tree Unit	Co-dominant Trunk, Cross with fencing
1B-T050	<i>Citrus maxima</i>	柚子	5	100	2	Fair	Fair	Fair	Fair	Low	-	Fell	A, D, E	LandsD/ Tree Unit	Co-dominant Trunk, Cross with fencing, Leaning
1B-T051	<i>Citrus maxima</i>	柚子	5	110	4	Fair	Fair	Fair	Fair	Low	-	Fell	A, D, E	LandsD/ Tree Unit	Co-dominant Trunk
1B-T052	<i>Citrus maxima</i>	柚子	5	140	3	Fair	Fair	Fair	Fair	Low	-	Fell	A, D, E	LandsD/ Tree Unit	Co-dominant Trunk, Included Bark, Twisted Branches
1B-T053	<i>Citrus maxima</i>	柚子	4	120	3	Fair	Fair	Fair	Fair	Low	-	Fell	A, D, E	LandsD/ Tree Unit	Co-dominant Trunk, Included Bark, Twisted Branches
1B-T054	<i>Dimocarpus longan</i>	龍眼	6	140	3	Fair	Fair	Fair	Fair	Low	-	Fell	A, D, E	LandsD/ Tree Unit	Leaning, Covered by vine/ climber
1B-T055	<i>Citrus maxima</i>	柚子	4	130	3	Fair	Fair	Fair	Fair	Low	-	Fell	A, D, E	LandsD/ Tree Unit	Co-dominant Trunk, Twisted Branches
1B-T056	<i>Citrus maxima</i>	柚子	4	110	2	Fair	Fair	Fair	Fair	Low	-	Fell	A, D, E	LandsD/ Tree Unit	Co-dominant Trunk, Incuded Bark, Restricted Root Flare
1B-T057	<i>Citrus maxima</i>	柚子	4	110	3	Fair	Fair	Fair	Fair	Low	-	Fell	A, D, E	LandsD/ Tree Unit	Co-dominant Trunk, Twisted Branches
1B-T058	<i>Citrus maxima</i>	柚子	4	140	3	Fair	Fair	Fair	Fair	Low	-	Fell	A, D, E	LandsD/ Tree Unit	Forked, Restricted Root Flare
1B-T059	<i>Citrus maxima</i>	柚子	4	130	2	Fair	Fair	Fair	Fair	Low	-	Fell	A, D, E	LandsD/ Tree Unit	Co-dominant Trunk, Included Bark
1B-T060	<i>Citrus maxima</i>	柚子	5	140	4	Fair	Fair	Fair	Fair	Low	-	Fell	A, D, E	LandsD/ Tree Unit	Co-dominant Trunk
1B-T061	<i>Dimocarpus longan</i>	龍眼	6	100	2	Fair	Fair	Fair	Fair	Low	-	Fell	A, D, E	LandsD/ Tree Unit	Leaning
1B-T062	<i>Dimocarpus longan</i>	龍眼	6	100	2	Fair	Fair	Fair	Fair	Low	-	Fell	A, D, E	LandsD/ Tree Unit	Leaning
1B-T063	<i>Dimocarpus longan</i>	龍眼	5	110	2	Poor	Poor	Poor	Poor	Low	-	Fell	A, B, D, E	LandsD/ Tree Unit	Dead
1B-T064	<i>Citrus maxima</i>	柚子	4	120	3	Fair	Fair	Fair	Fair	Low	-	Fell	A, D, E	LandsD/ Tree Unit	Co-dominant Trunks, Restricted Root Flare
1B-T065	<i>Citrus maxima</i>	柚子	4	140	3	Fair	Fair	Fair	Fair	Low	-	Fell	A, D, E	LandsD/ Tree Unit	Co-dominant Trunks, Crossed Branches, Twisted Branches

Tree No.	Scientific Name	Chinese Common Name	Measurement			(Good/Fair/Poor)				Suitability for Transplant (High/Medium/Low)	Conservation Status	Recommendation (Retain/Transplant/Fell)	Justification [1]	Department to provide expert advice to LandsD	Additional Remarks
			Height (m)	DBH (mm)	Crown Spread (m)	Amenity	Form	Health	Structure						
1B-T066	<i>Citrus maxima</i>	柚子	5	150	3	Fair	Fair	Fair	Fair	Low	-	Fell	A, D, E	LandsD/ Tree Unit	Co-dominant Trunks, Crossed Branches, Twisted Branches
1B-T067	<i>Citrus maxima</i>	柚子	4	130	3	Fair	Fair	Fair	Fair	Low	-	Fell	A, D, E	LandsD/ Tree Unit	Co-dominant Trunks, Included Bark
1B-T068	<i>Citrus maxima</i>	柚子	5	150	3	Fair	Fair	Fair	Fair	Low	-	Fell	A, D, E	LandsD/ Tree Unit	Forked, Included Bark
1B-T069	<i>Citrus maxima</i>	柚子	4	130	2	Fair	Fair	Fair	Fair	Low	-	Fell	A, D, E	LandsD/ Tree Unit	Twisted Trunk
1B-T070	<i>Dimocarpus longan</i>	龍眼	6	200	4	Poor	Poor	Poor	Poor	Low	-	Fell	A, D, E	LandsD/ Tree Unit	Co-dominant Trunks, Included Bark, Covered by vines/ climbers
1B-T072	<i>Citrus maxima</i>	柚子	4	100	1	Fair	Fair	Fair	Fair	Low	-	Fell	A, D, E	LandsD/ Tree Unit	Co-dominant Trunk, Included Bark, Restricted Root Flare
1B-T073	<i>Dimocarpus longan</i>	龍眼	7	330	5	Poor	Poor	Poor	Poor	Low	-	Fell	A, D, E	LandsD/ Tree Unit	Multi Stem, Included Bark
T001	<i>Celtis sinensis</i>	朴樹	4	150	4	Poor	Poor	Poor	Poor	Low	-	Fell	A, D, E	LandsD/ Tree Unit	Dead Branches, Restricted Root Flare, Crossed with the fencing
T002	<i>Celtis sinensis</i>	朴樹	3.5	110	3	Poor	Poor	Poor	Poor	Low	-	Fell	A, D, E	LandsD/ Tree Unit	Unbalance Form, Restricted Root Flare, Crossed with the fencing
T003	<i>Celtis sinensis</i>	朴樹	3.5	100	3	Poor	Poor	Poor	Poor	Low	-	Fell	A, D, E	LandsD/ Tree Unit	Rotten Trunk, Twisting Trunk, Included Bark, Co-dominant Trunks, Restricted Root Flare, Crossed with the fencing
T004	<i>Ficus subpisocarpa</i>	筆管榕	7	380	8	Poor	Poor	Poor	Poor	Low	-	Fell	A, C, D, E	LandsD/ Tree Unit	On slope, Included Bark, Co-dominant Trunks, Restricted Root Flare, Broken Branches
T005	<i>Celtis sinensis</i>	朴樹	4	280	4	Poor	Poor	Poor	Poor	Low	-	Fell	A, C, D, E	LandsD/ Tree Unit	On Slope, Forked, Included Bark, Leaning, Co-dominant Trunks, Restricted Root Flare
T006	<i>Leucaena leucocephala</i>	銀合歡	4	130	4	Fair	Fair	Fair	Fair	Low	-	Fell	A, D, E	LandsD/ Tree Unit	Invasive tree species
T007	<i>Microcos nervosa</i>	布渣葉	8	250	6	Poor	Poor	Poor	Poor	Low	-	Retain	-	LandsD/ Tree Unit	On Slope, Included Bark, Co-dominant Trunks, Crossed with other vegetation
T008	<i>Ficus subpisocarpa</i>	筆管榕	7	450	5	Poor	Poor	Poor	Poor	Low	-	Retain	-	LandsD/ Tree Unit	On Slope, Co-dominant Trunks, Twisted Branches, Covered by climber
T009	<i>Ficus subpisocarpa</i>	筆管榕	12	360	6	Fair	Fair	Fair	Fair	Low	-	Retain	-	LandsD/ Tree Unit	On Slope, Rotten Trunk, Twisted Branches
T010	<i>Dimocarpus longan</i>	龍眼	4	130	4	Poor	Poor	Poor	Poor	Low	-	Fell	A, C, D, E	LandsD/ Tree Unit	On Slope, Leaing, Rotten Trunk, Unbalance Form
T011	<i>Dimocarpus longan</i>	龍眼	7	320	6	Poor	Poor	Poor	Poor	Low	-	Fell	A, C, D, E	LandsD/ Tree Unit	On Slope, Leaing, Twisted Trunk
T012	<i>Delonix regia</i>	鳳凰木	12	470	7	Fair	Fair	Fair	Fair	Low	-	Fell	A, D, E	LandsD/ Tree Unit	Covered by vine/climber, Dieback, Broken Branches
T013	<i>Dimocarpus longan</i>	龍眼	6	160	3	Poor	Poor	Poor	Poor	Low	-	Fell	A, C, D, E	LandsD/ Tree Unit	On Slope, Leaning, Co-dominant Trunks
T014	<i>Plumeria rubra</i>	雞蛋花	9	240	2	Poor	Poor	Poor	Poor	Low	-	Fell	A, D, E	LandsD/ Tree Unit	Unbalanced Form, Co-dominant Trunks, Restricted Root Flare, Broken & Dead Branches
T015	<i>Artocarpus heterophyllus</i>	菠蘿蜜	6	330	6	Fair	Fair	Fair	Fair	Low	-	Fell	A, C, D, E	LandsD/ Tree Unit	On Slope, Covered by vine/ climber
T016	<i>Livistona chinensis</i>	蒲葵	9	250	2	Fair	Fair	Fair	Fair	Low	-	Fell	A, D, E	LandsD/ Tree Unit	Covered by vine/ climber
T017	<i>Macaranga tanarius</i>	血桐	10	130	3	Fair	Fair	Fair	Fair	Low	-	Fell	A, D, E	LandsD/ Tree Unit	Leaing, Unbalance Form, Restricted Root Flare
T018	<i>Macaranga tanarius</i>	血桐	7	130	5	Fair	Fair	Fair	Fair	Low	-	Fell	A, D, E	LandsD/ Tree Unit	Leaning, Co-dominant Trunks, Included Bark, Twisted Branches
T019	<i>Microcos nervosa</i>	布渣葉	6	150	5	Fair	Fair	Fair	Fair	Low	-	Fell	A, D, E	LandsD/ Tree Unit	Restricted Root, Twisted Branches, Crossed with other tree (T20)
T020	<i>Diospyros kaki</i>	柿子	5	230	7	Poor	Poor	Poor	Poor	Low	-	Fell	A, D, E	LandsD/ Tree Unit	Restricted Root, Twisted Trunk, Crossed with other tree (T19)
T021	<i>Microcos nervosa</i>	布渣葉	8	250+200	4	Fair	Fair	Fair	Fair	Low	-	Fell	A, D, E	LandsD/ Tree Unit	Restricted Root, Twisted Trunk
T022	<i>Ficus variegata</i>	青果榕	13	440	4	Fair	Fair	Fair	Fair	Low	-	Fell	A, D, E	LandsD/ Tree Unit	Leaning, Co-dominant Trunks, Restricted Root Flare
T023	<i>Sterculia lanceolata</i>	假蘋婆	8	180	3	Fair	Fair	Fair	Fair	Low	-	Fell	A, D, E	LandsD/ Tree Unit	Leaning, Restricted Root Flare
T024	<i>Ficus subpisocarpa</i>	筆管榕	9	370	5	Fair	Fair	Fair	Fair	Low	-	Fell	A, D, E	LandsD/ Tree Unit	Leaning, Restricted Root Flare, Crossed with Fencing
T025	<i>Delonix regia</i>	鳳凰木	12	490	8	Fair	Fair	Fair	Fair	Low	-	Fell	A, D, E	LandsD/ Tree Unit	Co-dominant Trunks, Restricted Root Flare
T026	<i>Ficus virens</i>	大葉榕	6	140	5	Fair	Fair	Fair	Fair	Low	-	Fell	A, D, E	LandsD/ Tree Unit	Co-dominant Trunks, Restricted Root Flare
T027	<i>Dimocarpus longan</i>	龍眼	9	170	4	Poor	Poor	Poor	Poor	Low	-	Fell	A, D, E	LandsD/ Tree Unit	Leaning, Restricted Root Flare
T028	<i>Leucaena leucocephala</i>	銀合歡	8	150	4	Poor	Poor	Poor	Poor	Low	-	Fell	A, B, D, E	LandsD/ Tree Unit	
T029	<i>Macaranga tanarius</i>	血桐	4	160	5	Fair	Fair	Fair	Fair	Low	-	Fell	A, D, E	LandsD/ Tree Unit	Co-dominant Trunks, Cross with other trees
T030	<i>Dimocarpus longan</i>	龍眼	7	110	2	Poor	Poor	Poor	Poor	Low	-	Fell	A, D, E	LandsD/ Tree Unit	Co-dominant Trunks, Restricted Root Flare
T031	<i>Dimocarpus longan</i>	龍眼	7	110	2	Poor	Poor	Poor	Poor	Low	-	Fell	A, D, E	LandsD/ Tree Unit	Co-dominant Trunks, Dieback, On Slope, Restricted Root Flare
T032	<i>Dimocarpus longan</i>	龍眼	11	380	6	Poor	Poor	Poor	Poor	Low	-	Fell	A, D, E	LandsD/ Tree Unit	Co-dominant Trunks, Leaning, Dieback
T033	<i>Dimocarpus longan</i>	龍眼	8	400	4	Fair	Fair	Fair	Fair	Low	-	Fell	A, C, D, E	LandsD/ Tree Unit	
T034	<i>Dimocarpus longan</i>	龍眼	6	160	2	Fair	Fair	Fair	Fair	Low	-	Fell	A, C, D, E	LandsD/ Tree Unit	
T035	<i>Citrus maxima</i>	柚子	4	95	2	Fair	Fair	Fair	Fair	Low	-	Fell	A, C, D, E	LandsD/ Tree Unit	
T036	<i>Ficus microcarpa</i>	細葉榕	8	600	8	Fair	Fair	Fair	Fair	Medium	-	Transplant	A	LandsD/ Tree Unit	Co-dominant Trunks
T037	<i>Roystonea regia</i>	王棕	11	490	3	Fair	Fair	Fair	Fair	Medium	-	Transplant	A	LandsD/ Tree Unit	-
T038	<i>Roystonea regia</i>	王棕	11	500	2	Fair	Fair	Fair	Fair	Medium	-	Transplant	A	LandsD/ Tree Unit	-
T039	<i>Roystonea regia</i>	王棕	11	510	3	Fair	Fair	Fair	Fair	Medium	-	Transplant	A	LandsD/ Tree Unit	-
T040	<i>Roystonea regia</i>	王棕	11	490	2	Fair	Fair	Fair	Fair	Medium	-	Transplant	A	LandsD/ Tree Unit	-
T041	<i>Araucaria heterophylla</i>	異葉南洋杉	10	210	2	Fair	Fair	Fair	Fair	Low	-	Fell	A, D, E	LandsD/ Tree Unit	Heavy Leaning
T042	<i>Roystonea regia</i>	王棕	13	580	3	Fair	Fair	Fair	Fair	Medium	-	Transplant	A	LandsD/ Tree Unit	-
T043	<i>Roystonea regia</i>	王棕	13	510	3	Fair	Fair	Fair	Fair	Medium	-	Transplant	A	LandsD/ Tree Unit	-
T044	<i>Roystonea regia</i>	王棕	11	520	3	Fair	Fair	Fair	Fair	Medium	-	Retain	A	LandsD/ Tree Unit	-
T045	<i>Roystonea regia</i>	王棕	11	520	3	Fair	Fair	Fair	Fair	Medium	-	Retain	A	LandsD/ Tree Unit	-
T046	<i>Roystonea regia</i>	王棕	11	480	2	Fair	Fair	Fair	Fair	Medium	-	Transplant	A	LandsD/ Tree Unit	-
T048	<i>Microcos nervosa</i>	布渣葉	5	300	3	Poor	Poor	Poor	Poor	Low	-	Fell	A, C, D, E	LandsD/ Tree Unit	On Slope, Multi Trunks, Restricted Root Flare
T049	<i>Sterculia lanceolata</i>	假蘋婆	8	700	10	Poor	Poor	Poor	Poor	Low	-	Fell	A, C, D, E	LandsD/ Tree Unit	On Slope, Restricted Root Flare
T050	<i>Ficus hispida</i>	對葉榕	4	320	6	Fair	Fair	Fair	Fair	Low	-	Fell	A, C, D, E	LandsD/ Tree Unit	On Slope, Restricted Root Flare
T051	<i>Litsea glutinosa</i>	潺槁樹	4	220	4	Fair	Fair	Fair	Fair	Low	-	Fell	A, C, D, E	LandsD/ Tree Unit	On Slope, Restricted Root Flare
T051A	<i>Macaranga tanarius</i>	血桐	5	110	2	Fair	Fair	Fair	Fair	Low	-	Fell	A, C, D, E	LandsD/ Tree Unit	
T052	<i>Carica papaya</i>	番木瓜	5	100	1	Fair	Fair	Fair	Fair	Low	-	Fell	A, C, D, E	LandsD/ Tree Unit	On Slope, Restricted Root Flare
T053	<i>Broussonetia papyrifera</i>	構樹	5	100	2	Fair	Fair	Fair	Fair	Low	-	Fell	A, C, D, E	LandsD/ Tree Unit	On Slope, Restricted Root Flare
T053A	<i>Syzygium jambos</i>	蒲桃	5	100	2	Fair	Fair	Fair	Fair	Low	-	Fell	A, C, D, E	LandsD/ Tree Unit	
T053B	<i>Macaranga tanarius</i>	血桐	5	110	2	Fair	Fair	Fair	Fair	Low	-	Fell	A, C, D, E	LandsD/ Tree Unit	
T054	<i>Macaranga tanarius</i>	血桐	5	150	4	Fair	Fair	Fair	Fair	Low	-	Fell	A, C, D, E	LandsD/ Tree Unit	On Slope, Restricted Root Flare
T055	<i>Macaranga tanarius</i>	血桐	6	250	5	Fair	Fair	Fair	Fair	Low	-	Fell	A, C, D, E	LandsD/ Tree Unit	On Slope, Restricted Root Flare
T056	<i>Macaranga tanarius</i>	血桐	5	140	3	Fair	Fair	Fair	Fair	Low	-	Fell	A, C, D, E	LandsD/ Tree Unit	On Slope, Restricted Root Flare, Crossed with fencing

Tree No.	Scientific Name	Chinese Common Name	Measurement			(Good/Fair/Poor)				Suitability for Transplant (High/Medium/Low)	Conservation Status	Recommendation (Retain/Transplant/Fell)	Justification [1]	Department to provide expert advice to LandsD	Additional Remarks
			Height (m)	DBH (mm)	Crown Spread (m)	Amenity	Form	Health	Structure						
T057	<i>Dimocarpus longan</i>	龍眼	5	110	2	Poor	Poor	Poor	Poor	Low	-	Fell	A, D, E	LandsD/ Tree Unit	Co-dominant Trunks, Included Bark, Restricted Root Flare
T057A	<i>Macaranga tanarius</i>	血桐	5	156	3	Fair	Fair	Fair	Fair	Low	-	Fell	A, C, D, E	LandsD/ Tree Unit	
T058	<i>Mangifera indica</i>	芒果	10	430	6	Fair	Fair	Fair	Fair	Low	-	Fell	A, C, D, E	LandsD/ Tree Unit	
T059	<i>Araucaria heterophylla</i>	異葉南洋杉	12	400	2	Fair	Fair	Fair	Fair	Low	-	Fell	A, D, E	LandsD/ Tree Unit	Leaning, Restricted Root Flare, Crossed with other vegetation
T060	<i>Dimocarpus longan</i>	龍眼	9	360	6	Poor	Poor	Poor	Poor	Low	-	Fell	A, D, E	LandsD/ Tree Unit	Leaning, Restricted Root Flare
T061	<i>Ficus variegata</i>	青果榕	5	180	3	Fair	Fair	Fair	Fair	Low	-	Fell	A, D, E	LandsD/ Tree Unit	Leaning, Restricted Root Flare
T062	<i>Aleurites moluccanus</i>	石栗	13	730	9	Fair	Fair	Fair	Fair	Low	-	Fell	A, D, E	LandsD/ Tree Unit	Black Knot, Twisted Trunk, Restricted Root Flare, Rotten Trunk
T063	<i>Carica papaya</i>	番木瓜	4	150	1	Fair	Fair	Fair	Fair	Low	-	Fell	A, C, D, E	LandsD/ Tree Unit	On Slope
T064A	<i>Macaranga tanarius</i>	血桐	4	212	6	Fair	Fair	Fair	Fair	Low	-	Fell	A, C, D, E	LandsD/ Tree Unit	
T065	<i>Carica papaya</i>	番木瓜	4	150	1	Fair	Fair	Fair	Fair	Low	-	Fell	A, C, D, E	LandsD/ Tree Unit	On Slope
T066	<i>Carica papaya</i>	番木瓜	2.5	160	2	Fair	Fair	Fair	Fair	Low	-	Fell	A, C, D, E	LandsD/ Tree Unit	On Slope
T067	<i>Artocarpus heterophyllus</i>	菠蘿蜜	7	120	3	Fair	Fair	Fair	Fair	Low	-	Fell	A, C, D, E	LandsD/ Tree Unit	On Slope, Restricted Root Flare
T068	<i>Artocarpus heterophyllus</i>	菠蘿蜜	8	120	3	Fair	Fair	Fair	Fair	Low	-	Fell	A, C, D, E	LandsD/ Tree Unit	On Slope, Restricted Root Flare
T069	<i>Artocarpus heterophyllus</i>	菠蘿蜜	8	100	2	Fair	Fair	Fair	Fair	Low	-	Fell	A, C, D, E	LandsD/ Tree Unit	On Slope, Restricted Root Flare
T070	<i>Artocarpus heterophyllus</i>	菠蘿蜜	8	100	2	Fair	Fair	Fair	Fair	Low	-	Fell	A, C, D, E	LandsD/ Tree Unit	On Slope, Restricted Root Flare
T071	<i>Artocarpus heterophyllus</i>	菠蘿蜜	5	140	3	Fair	Fair	Fair	Fair	Low	-	Fell	A, C, D, E	LandsD/ Tree Unit	On Slope, Restricted Root Flare
T072	<i>Artocarpus heterophyllus</i>	菠蘿蜜	6	120	2	Fair	Fair	Fair	Fair	Low	-	Fell	A, C, D, E	LandsD/ Tree Unit	On Slope, Restricted Root Flare
T073	<i>Artocarpus heterophyllus</i>	菠蘿蜜	8	120	2	Fair	Fair	Fair	Fair	Low	-	Fell	A, C, D, E	LandsD/ Tree Unit	On Slope, Restricted Root Flare
T074	<i>Macaranga tanarius</i>	血桐	9	180	4	Fair	Fair	Fair	Fair	Low	-	Fell	A, C, D, E	LandsD/ Tree Unit	On Slope, Restricted Root Flare
T075	<i>Carica papaya</i>	番木瓜	4	110	1	Fair	Fair	Fair	Fair	Low	-	Fell	A, C, D, E	LandsD/ Tree Unit	On Slope, Restricted Root Flare
T076	<i>Eriobotrya japonica</i>	枇杷	6	130	3	Poor	Poor	Poor	Poor	Low	-	Fell	A, C, D, E	LandsD/ Tree Unit	On Slope, Restricted Root Flare
T077	<i>Ficus hispida</i>	對葉榕	4	340	6	Fair	Fair	Fair	Fair	Low	-	Fell	A, D, E	LandsD/ Tree Unit	Restricted Root Flare
T078	<i>Clauseria lansium</i>	黃皮	7	170	4	Fair	Fair	Fair	Fair	Low	-	Fell	A, D, E	LandsD/ Tree Unit	Restricted Root Flare
T079	<i>Dimocarpus longan</i>	龍眼	12	780	14	Fair	Poor	Poor	Poor	Low	-	Fell	A, C, D, E	LandsD/ Tree Unit	Mature Tree, On Slope, Included Bark, Co-dominant Trunk, Leaning, Heavy Lateral Limb, Restricted Root, Unbalanced Form
T080	<i>Averrhoa carambola</i>	楊桃	6	100	3	Fair	Fair	Fair	Fair	Low	-	Fell	A, D, E	LandsD/ Tree Unit	Co-dominant Trunk, Leaning, Restricted Root
T081	<i>Cinnamomum camphora</i>	樟樹	16	1600	14	Poor	Poor	Poor	Poor	Low	-	Fell	A, D, E	LandsD/ Tree Unit	Mature Tree, Leaning, Climbers on Crown, Co-dominant Trunk, On Slope, Restricted Root Flare
T082	<i>Microcos nervosa</i>	布渣葉	5	130	3	Fair	Fair	Fair	Fair	Low	-	Fell	A, D, E	LandsD/ Tree Unit	Restricted Root Flare
T083	<i>Microcos nervosa</i>	布渣葉	5	130	5	Fair	Fair	Fair	Fair	Low	-	Fell	A, D, E	LandsD/ Tree Unit	Restricted Root Flare
T084	<i>Mangifera indica</i>	芒果	14	1050	14	Fair	Poor	Poor	Fair	Low	-	Fell	A, B, D, E	LandsD/ Tree Unit	Mature Tree, Cracks on Trunk, Cross Branches, Black Knot, Twisted Branches
T085	<i>Ilex rotunda</i>	鐵冬青	4	100	3	Fair	Fair	Fair	Fair	Low	-	Fell	A, C, D, E	LandsD/ Tree Unit	On Slope, Restricted Root Flare
T086	<i>Dimocarpus longan</i>	龍眼	7	150	3	Poor	Poor	Poor	Poor	Low	-	Fell	A, C, D, E	LandsD/ Tree Unit	On Slope, Restricted Root Flare
T087	<i>Ilex rotunda</i>	鐵冬青	4	110	4	Fair	Fair	Fair	Fair	Low	-	Fell	A, C, D, E	LandsD/ Tree Unit	On Slope, Restricted Root Flare
T088	<i>Mangifera indica</i>	芒果	7	110	3	Fair	Fair	Fair	Fair	Low	-	Fell	A, C, D, E	LandsD/ Tree Unit	On Slope, Restricted Root Flare
T089	<i>Aglaia odorata</i>	米仔蘭	5	140	6	Fair	Fair	Fair	Fair	Low	-	Fell	A, C, D, E	LandsD/ Tree Unit	On Slope, Restricted Root Flare
T090	<i>Aglaia odorata</i>	米仔蘭	4	100	3	Fair	Fair	Fair	Fair	Low	-	Fell	A, C, D, E	LandsD/ Tree Unit	On Slope, Restricted Root Flare
T091	<i>Citrus maxima</i>	柚子	6	150	3	Fair	Fair	Fair	Fair	Low	-	Fell	A, D, E	LandsD/ Tree Unit	Restricted Root Flare
T092	<i>Artocarpus heterophyllus</i>	菠蘿蜜	8	250	4	Fair	Fair	Fair	Fair	Low	-	Fell	A, D, E	LandsD/ Tree Unit	Leaning, Restricted Root Flare
T093	<i>Citrus maxima</i>	柚子	6	120	2	Fair	Fair	Fair	Fair	Low	-	Fell	A, D, E	LandsD/ Tree Unit	Restricted Root Flare
T094	<i>Carica papaya</i>	番木瓜	6	100	1	Fair	Fair	Fair	Fair	Low	-	Fell	A, D, E	LandsD/ Tree Unit	Restricted Root Flare
T095	<i>Carica papaya</i>	番木瓜	7	110	1	Fair	Fair	Fair	Fair	Low	-	Fell	A, D, E	LandsD/ Tree Unit	Restricted Root Flare
T096	<i>Zanthoxylum avicennae</i>	筋攞花椒	6	100	2	Fair	Fair	Fair	Fair	Low	-	Fell	A, D, E	LandsD/ Tree Unit	Leaning, Restricted Root Flare
T097	<i>Macaranga tanarius</i>	血桐	5	220	5	Fair	Fair	Fair	Fair	Low	-	Fell	A, D, E	LandsD/ Tree Unit	Leaning, Co-dominant Trunks, Restricted Root Flare
T098	<i>Carica papaya</i>	番木瓜	8	200	2	Fair	Fair	Fair	Fair	Low	-	Fell	A, D, E	LandsD/ Tree Unit	Leaning, Restricted Root Flare
T099	<i>Macaranga tanarius</i>	血桐	5	110	4	Fair	Fair	Fair	Fair	Low	-	Fell	A, C, D, E	LandsD/ Tree Unit	On Slope
T100	<i>Macaranga tanarius</i>	血桐	5	120	5	Fair	Fair	Fair	Fair	Low	-	Fell	A, C, D, E	LandsD/ Tree Unit	On Slope
T101	<i>Ficus variegata</i>	青果榕	10	240	3	Fair	Fair	Fair	Fair	Low	-	Retain	-	LandsD/ Tree Unit	Covered by vine/climber
T102	<i>Ficus variegata</i>	青果榕	8	120	2	Fair	Fair	Fair	Fair	Low	-	Retain	-	LandsD/ Tree Unit	On Slope
T103	<i>Ficus virens</i>	大葉榕	4	120	4	Fair	Fair	Fair	Fair	Low	-	Fell	A, C, D, E	LandsD/ Tree Unit	On Slope
T104	<i>Microcos nervosa</i>	布渣葉	6	100	3	Poor	Poor	Poor	Poor	Low	-	Fell	A, C, D, E	LandsD/ Tree Unit	On Slope, Restricted Root Flare
T105	<i>Mangifera indica</i>	芒果	15	680	12	Fair	Fair	Fair	Fair	Low	-	Fell	A, D, E	LandsD/ Tree Unit	Multi Stem, Restricted Root Flare
T106	<i>Ficus variegata</i>	青果榕	12	430	7	Fair	Fair	Fair	Fair	Low	-	Retain	-	LandsD/ Tree Unit	On Slope, Restricted Root Flare
T108	<i>Dimocarpus longan</i>	龍眼	14	500	6	Fair	Fair	Fair	Fair	Low	-	Retain	-	LandsD/ Tree Unit	On Slope, Restricted Root Flare
T109	<i>Araucaria heterophylla</i>	異葉南洋杉	5	240	2	Fair	Fair	Fair	Fair	Low	-	Fell	A, D, E	LandsD/ Tree Unit	Restricted Root Flare
T114	<i>Ficus variegata</i>	青果榕	8	140	3	Fair	Fair	Fair	Fair	Low	-	Retain	-	LandsD/ Tree Unit	Leaning
T115	<i>Ficus variegata</i>	青果榕	9	160	3	Fair	Fair	Fair	Fair	Low	-	Retain	-	LandsD/ Tree Unit	On Slope, Restricted Root Flare
T116	<i>Leucaena leucocephala</i>	銀合歡	9	120	2	Fair	Fair	Fair	Fair	Low	-	Fell	A, D, E	LandsD/ Tree Unit	Invasive tree species
T117	<i>Sterculia lanceolata</i>	假蘋婆	8	100	2	Poor	Poor	Poor	Poor	Low	-	Retain	-	LandsD/ Tree Unit	On Slope, Restricted Root Flare, Crossed with T121
T120	<i>Microcos nervosa</i>	布渣葉	8	120	2	Poor	Poor	Poor	Poor	Low	-	Fell	A, C, D, E	LandsD/ Tree Unit	On Slope, Leaning
T121	<i>Ficus subpisocarpa</i>	筆管榕	4	100	4	Fair	Fair	Fair	Fair	Low	-	Retain	-	LandsD/ Tree Unit	On Slope, Leaning, Restricted Root Flare
T122	<i>Sterculia lanceolata</i>	假蘋婆	5	100	2	Poor	Poor	Poor	Poor	Low	-	Retain	-	LandsD/ Tree Unit	On Slope, Twisted Trunk
T123	<i>Microcos nervosa</i>	布渣葉	8	220	4	Poor	Poor	Poor	Poor	Low	-	Retain	-	LandsD/ Tree Unit	On Slope, Leaning, Twisted Trunk
T124	<i>Dimocarpus longan</i>	龍眼	10	300	5	Poor	Poor	Poor	Poor	Low	-	Fell	A, C, D, E	LandsD/ Tree Unit	On Slope, Leaning, Restricted Root Flare
T125	<i>Sterculia lanceolata</i>	假蘋婆	8	330	4	Poor	Poor	Poor	Poor	Low	-	Fell	A, C, D, E	LandsD/ Tree Unit	On Slope, Leaning, Restricted Root Flare
T126	<i>Macaranga tanarius</i>	血桐	7	320	7	Fair	Fair	Fair	Fair	Low	-	Fell	A, C, D, E	LandsD/ Tree Unit	On Slope, Leaning, Restricted Root Flare
T127	<i>Microcos nervosa</i>	布渣葉	8	110	3	Poor	Poor	Poor	Poor	Low	-	Fell	A, C, D, E	LandsD/ Tree Unit	On Slope, Co-dominant Trunks, Restricted Root Flare
T128	<i>Microcos nervosa</i>	布渣葉	8	280	6	Poor	Poor	Poor	Poor	Low	-	Fell	A, C, D, E	LandsD/ Tree Unit	On Slope, Multi Trunks, Restricted Root Flare

Tree No.	Scientific Name	Chinese Common Name	Measurement			(Good/Fair/Poor)				Sustainability for Transplant (High/Medium/Low)	Conservation Status	Recommendation (Retain/Transplant/Fell)	Justification [1]	Department to provide expert advice to LandsD	Additional Remarks
			Height (m)	DBH (mm)	Crown Spread (m)	Amenity	Form	Health	Structure						
T129	<i>Dimocarpus longan</i>	龍眼	6	110	3	Poor	Poor	Poor	Poor	Low	-	Fell	A, C, D, E	LandsD/ Tree Unit	On Slope, Restricted Root Flare
T130	<i>Sterculia lanceolata</i>	假蘋婆	6	130	3	Poor	Poor	Poor	Poor	Low	-	Fell	A, C, D, E	LandsD/ Tree Unit	On Slope, Twisted Trunk, Restricted Root Flare
T131	<i>Sterculia lanceolata</i>	假蘋婆	8	270	5	Fair	Fair	Fair	Fair	Low	-	Fell	A, D, E	LandsD/ Tree Unit	Co-dominant Trunk, On Slope, Restricted Root Flare
T132	<i>Ficus microcarpa</i>	細葉榕	12	1200	16	Fair	Poor	Fair	Fair	Low	-	Fell	A, D, E	LandsD/ Tree Unit	Mature Tree, Crossed Branches, Leaning, On Slope, Restricted Root Flare, Unbalanced Form
T135	<i>Sterculia lanceolata</i>	假蘋婆	7	230	4	Fair	Fair	Fair	Fair	Low	-	Retain	-	LandsD/ Tree Unit	Multi Trunk, Restricted Root Flare, Leaning
T136	<i>Microcos nervosa</i>	布渣葉	8	360	4	Fair	Fair	Fair	Fair	Low	-	Fell	A, D, E	LandsD/ Tree Unit	Co-dominant Trunks, Restricted Root Flare
T137	<i>Microcos nervosa</i>	布渣葉	6	260	6	Fair	Fair	Fair	Fair	Low	-	Fell	A, D, E	LandsD/ Tree Unit	Twisted Trunk, Leaning, On Slope
T138	<i>Macaranga tanarius</i>	血桐	8	260	6	Fair	Fair	Fair	Fair	Low	-	Retain	-	LandsD/ Tree Unit	On Slope, Co-dominant Trunks
T139	<i>Dimocarpus longan</i>	龍眼	10	380	7	Poor	Poor	Poor	Poor	Low	-	Retain	-	LandsD/ Tree Unit	On Slope, Leaning
T140	<i>Ligustrum sinense</i>	山指甲	5	100	2	Fair	Fair	Fair	Fair	Low	-	Fell	A, C, D, E	LandsD/ Tree Unit	On Slope, Leaning
T141	<i>Sterculia lanceolata</i>	假蘋婆	6	130	4	Fair	Fair	Fair	Fair	Low	-	Fell	A, D, E	LandsD/ Tree Unit	Co-dominant Trunk, On Slope, Restricted Root Flare
T142	<i>Mallotus paniculatus</i>	白楸	7	140	4	Fair	Fair	Fair	Fair	Low	-	Fell	A, C, D, E	LandsD/ Tree Unit	On Slope, Leaning
T144	<i>Broussonetia papyrifera</i>	構樹	9	180	3	Fair	Fair	Fair	Fair	Low	-	Fell	A, C, D, E	LandsD/ Tree Unit	On Slope, Leaning
T145	<i>Sterculia lanceolata</i>	假蘋婆	9	180	2	Poor	Poor	Poor	Poor	Low	-	Fell	A, C, D, E	LandsD/ Tree Unit	On Slope, Leaning
T146	<i>Sterculia lanceolata</i>	假蘋婆	3	100	2	Fair	Fair	Fair	Fair	Low	-	Fell	A, D, E	LandsD/ Tree Unit	Twisted Trunk, Leaning, On Slope
T147	<i>Ficus variegata</i>	青果榕	9	470	4	Fair	Fair	Fair	Fair	Low	-	Fell	A, D, E	LandsD/ Tree Unit	Twisted Trunk, Co-dominant Trunk, Restricted Root, On Slope
T148	<i>Mallotus paniculatus</i>	白楸	3	100	5	Fair	Fair	Fair	Fair	Low	-	Retain	-	LandsD/ Tree Unit	Leaning, Imbalance Form, On Slope
T149	<i>Ficus variegata</i>	青果榕	8	160	3	Fair	Fair	Fair	Fair	Low	-	Retain	-	LandsD/ Tree Unit	
T150	<i>Ficus microcarpa</i>	細葉榕	18	1500	16	Fair	Poor	Poor	Fair	Low	-	Fell	A, B, D, E	LandsD/ Tree Unit	Mature Tree, Twisted Trunk, Co-dominant Trunk, Restricted Root, On Slope
T151	<i>Mallotus paniculatus</i>	白楸	4	150	4	Fair	Fair	Fair	Fair	Low	-	Retain	-	LandsD/ Tree Unit	-
T152	<i>Dimocarpus longan</i>	龍眼	5	230	5	Fair	Fair	Fair	Fair	Low	-	Retain	-	LandsD/ Tree Unit	-
T153	<i>Leucaena leucocephala</i>	銀合歡	6	120	2	Fair	Fair	Fair	Fair	Low	-	Fell	A, D, E	LandsD/ Tree Unit	Invasive tree species
T154	<i>Leucaena leucocephala</i>	銀合歡	6	120	2	Fair	Fair	Fair	Fair	Low	-	Fell	A, D, E	LandsD/ Tree Unit	Invasive tree species
T155	<i>Macaranga tanarius</i>	血桐	4	120	4	Fair	Fair	Fair	Fair	Low	-	Fell	A, C, D, E	LandsD/ Tree Unit	On Slope, Leaning, Co-dominant Trunk
T156	<i>Leucaena leucocephala</i>	銀合歡	6	110	2	Fair	Fair	Fair	Fair	Low	-	Fell	A, D, E	LandsD/ Tree Unit	Invasive tree species

SUMMARY:	Total number of trees surveyed =	287	nos.
	Nos. trees to be retained =	27	nos.
	Nos. trees to be transplanted =	11	nos.
	Nos. trees to be felled =	249	nos.

Note:

[1] Justification: A- in conflict with proposed development/ site formation

B- tree in poor health condition

C- growing on slope or difficult to form a proper root ball for transplanting

D- tree with a low survival rate after transplanting

E- Common non-local species and/ or not cost effective to transplant