

☐Urgent ☐Return receipt ☐Expand Group ☐Restricted ☐Prevent Copy ☐Confidential

---

**From:** [REDACTED]  
**Sent:** 2025-07-29 星期二 18:23:29  
**To:** Shirley Ka Kei CHAN/PLAND <skkchan@pland.gov.hk>  
**Subject:** RE: A/NE-FTA/261 - departmental comments  
**Attachment:** Comments from the TD Department.pdf; DD52 188 D.G.STORE  
HGV SWEPT PATH (TD-01).pdf; DD52 188 D.G.STORE PRIVATE  
CAR SWEPT PATH(TD-02).pdf

Dear Shirley

Attached the response to the departmental comments.

Regards

Leo

**Response to the Comments from the Commissioner for Transport (Contact Person: Mr. TAM Kam-fai, Tel. 2399 2405)**

- (i) The applicant should justify the adequacy of the proposed 6m width of the ingress and egress points for vehicular access;  
出入口擴闊至 12 米(請參閱 TD-01 及 TD-02)
- (ii) The applicant shall demonstrate the satisfactory maneuvering of the goods vehicles entering and exiting the subject site, maneuvering within the subject site and into/out of the parking and loading/unloading spaces, preferably using the swept path analysis;  
附上掃掠路徑分析圖(Swept Path Analysis)(請參閱 TD-01 及 TD-02)以顯示貨車足夠進出停放和裝卸空間, 以供參考。
- (iii) The applicant shall advise the management/control measures to be implemented to ensure no queuing of vehicles outside the subject site;  
申請範圍提供車輛緩衝區, 避車處及出入口, 可供進出車輛作緩衝, 另外場內車輛管制措施, 只供政府部門/授權車輛出入口(緊急情況下才開放), 訪客及員工車輛禁止在北面進入場地, 主要採用西南面入口進入場地, 並確保車輛不會在門外等候及排隊, 造成交通擠塞;  
申請範圍於營業時間內將安排交通督導員指揮交通, 確保場內及場外交通保持順暢。
- (iv) The applicant shall advise the provision of pedestrian facilities and management measures to ensure pedestrian safety;  
申請範圍於營業時間內將安排交通督導員指揮交通, 保障行人安全。
- (v) The applicant shall advise the management/control measures to be implemented to ensure no queuing of vehicles outside the subject site;  
申請位置入口外標貼 “不准泊車” 之告示, 並安排交通督導員站崗阻止車輛停泊, 如車輛不合作, 將向警署舉報違例泊車事項。
- (i) The proposed vehicular access between Man Kam To Road and the application site is not managed by TD. The applicant should seek comments from the responsible party.  
申請人知悉文錦渡道與申請地點之間的擬議行車通道並非由運輸署管理, 規劃署可轉介民政事務署徵求意見。

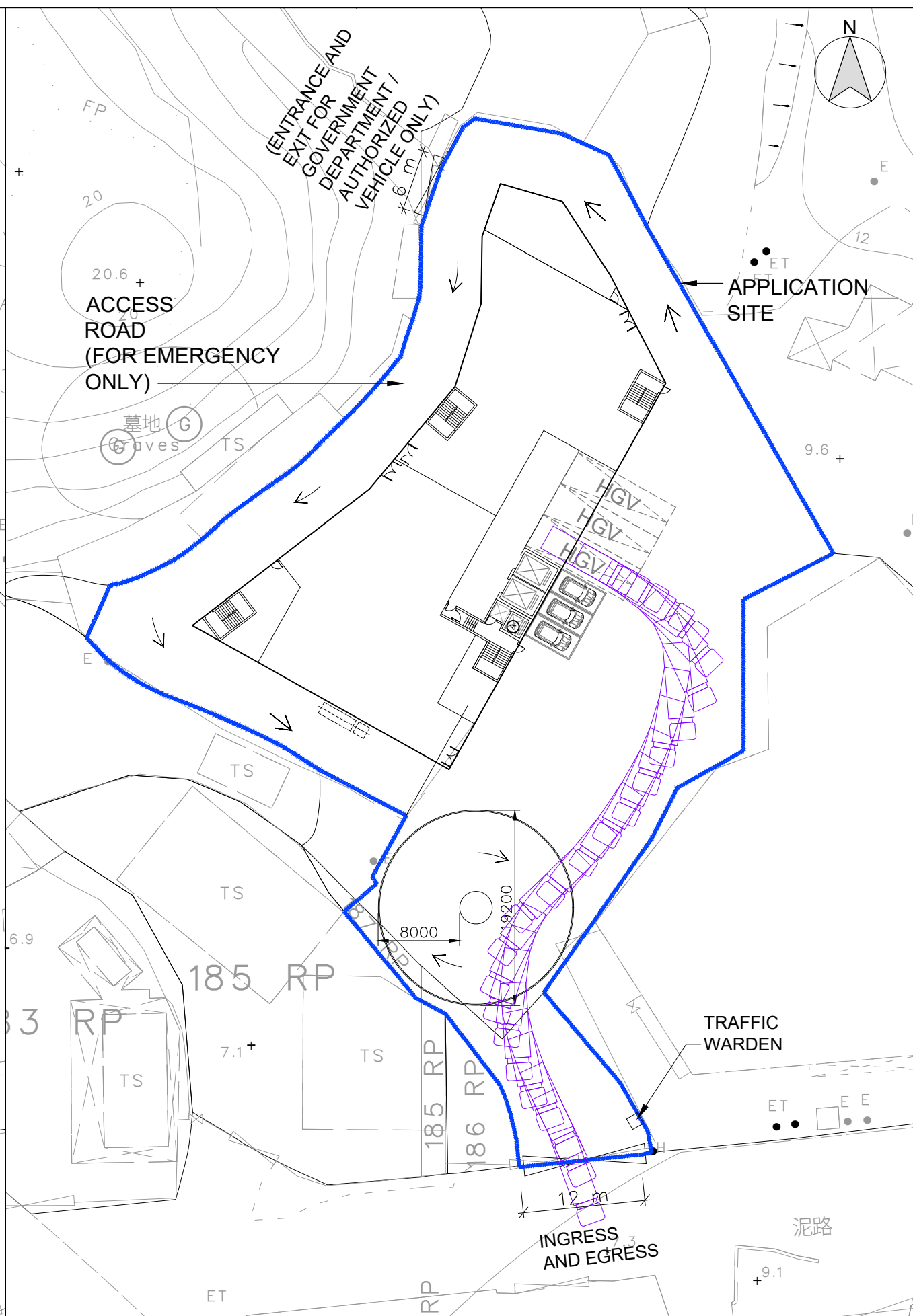
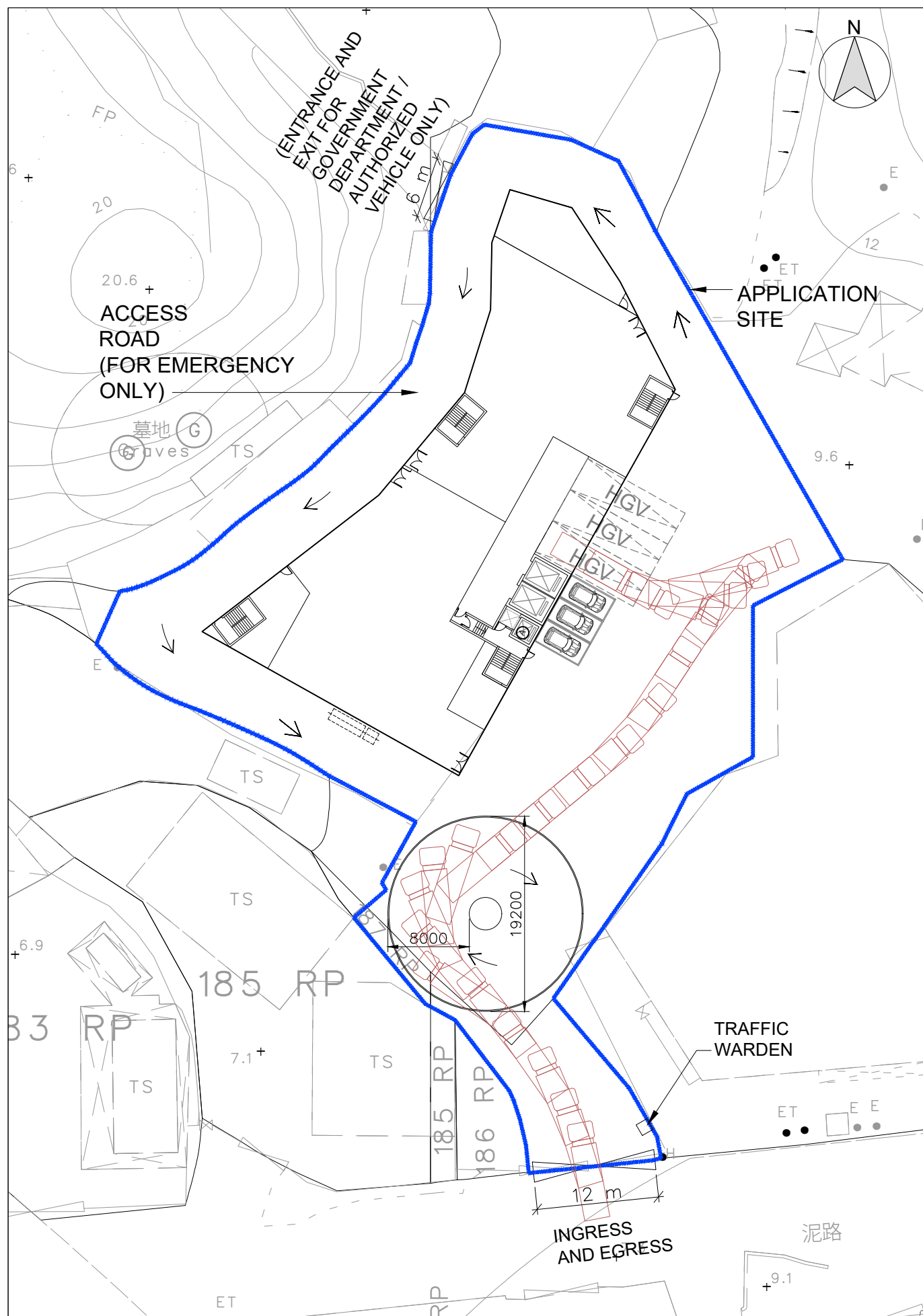

B.D. Reference		屋宇署檔案		
M.W. Reference		小型工程檔案		
L.D. Reference		地政署檔案		
F.S.D. Reference		消防處檔案		
Notes		註釋		
Copyright Reserved nothing may be reprinted or utilized in any form or by any means without written permission from the M&D.				
REV	DESCRIPTION	DATE		
Project			項目	
LOTS 187R.P.(PART) AND 188(PART) IN D.D.52 AND ADJOINING GOVERNMENT LAND, FU TEI AU, SHEUNG SHUI, NEW TERRITORIES				
Application			申請	
PROPOSED TEMPORARY DANGEROUS GOODS GODOWN (CAT.2,3,4,5,6,7,8,9 DANGEROUS GOODS) WITH ANCILLARY OFFICE USE AND ASSOCIATED FILLING OF LAND FOR A PERIOD OF 3 YEARS				
Drawing Title			標題	
PROPOSED SWEPT PATH ANALYSIS (HEAVY GOODS VEHICLE)				
Scale		Revisions	修訂	
1:500 (A3)		—		
Designed by		Drawn by		制圖人
LW		Arthur		
Checked by		Date		日期
LW		30—JUN—2025		
Job No.		Drawing No.		圖號
—		TD—01		

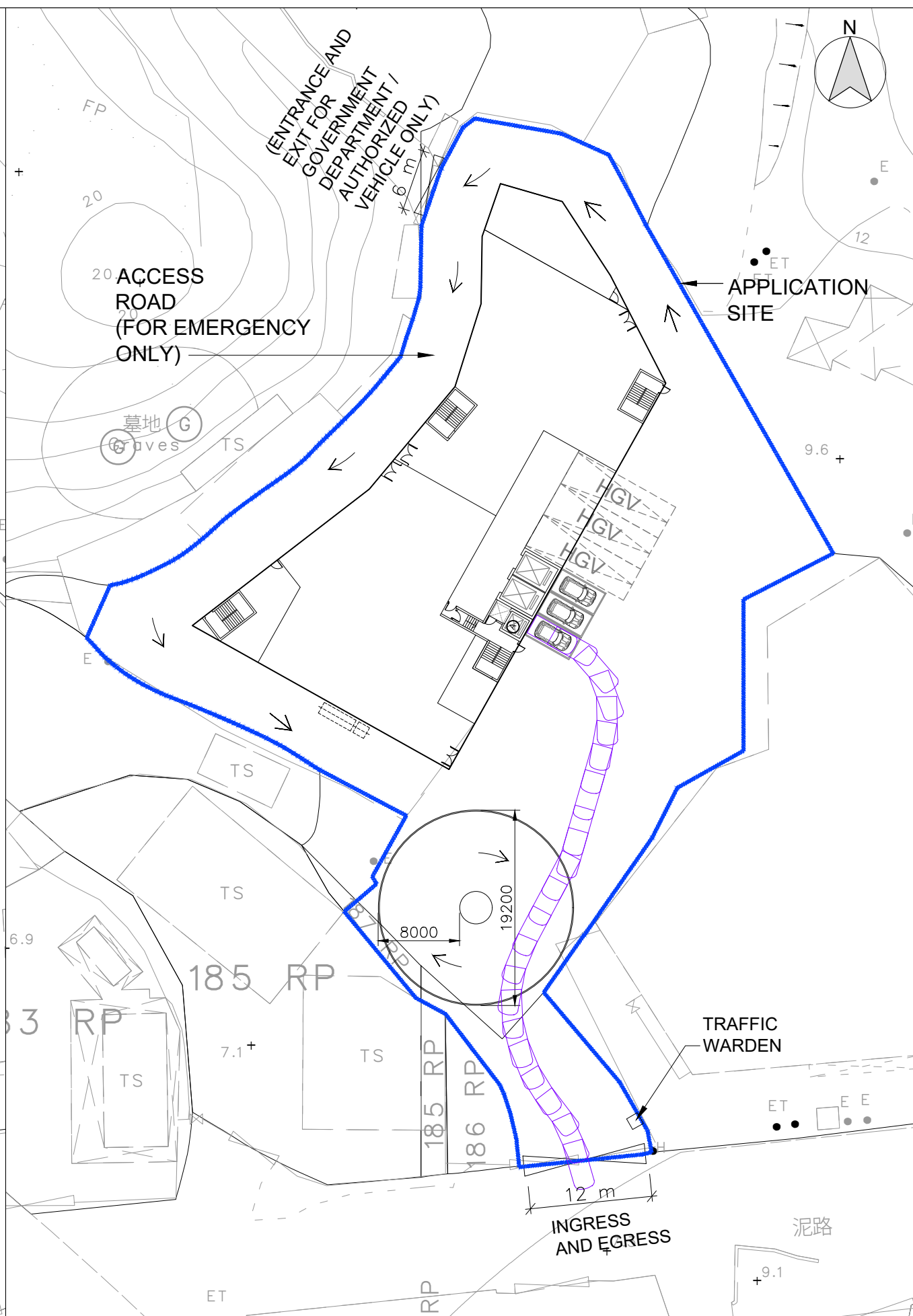
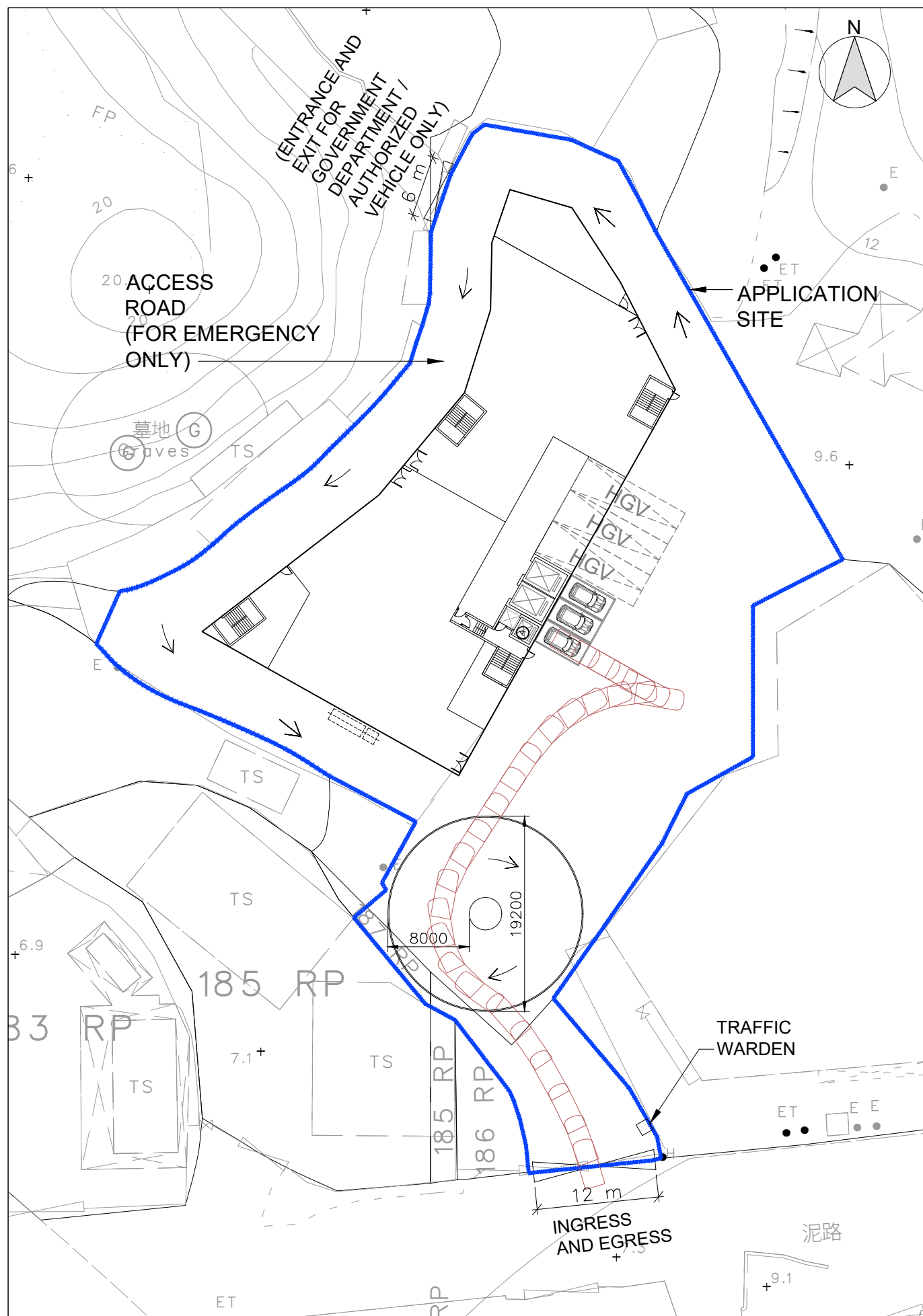
[illegible]