

**LEGEND**

MGV/HGV (Rigid) SIZE = (2.5x11m) APPROX.

PATH OF MEDIUM GOODS VEHICLE/  
HEAVY GOODS VEHICLE (Rigid) IN

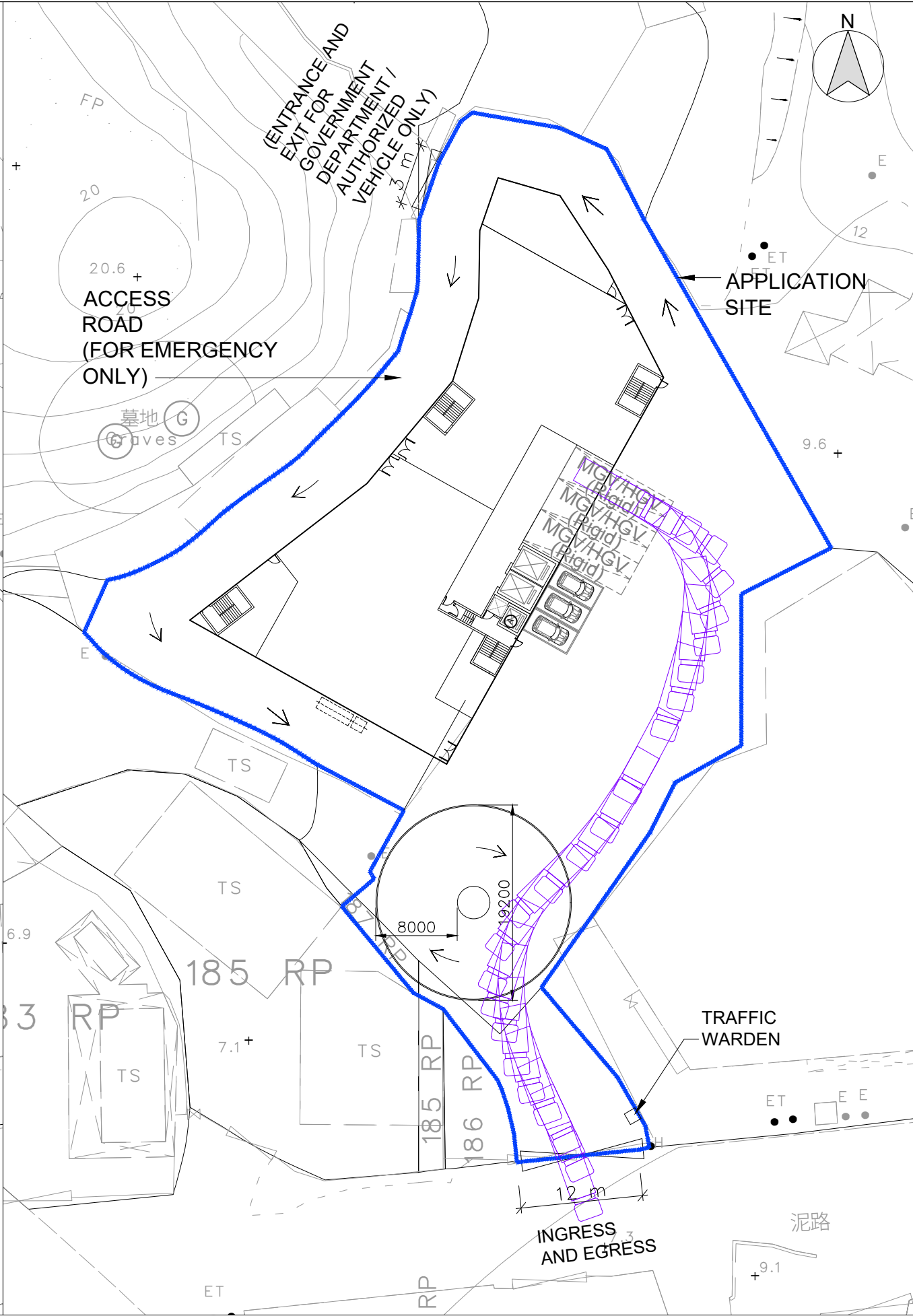

PATH OF MEDIUM GOODS VEHICLE/  
HEAVY GOODS VEHICLE (Rigid) OUT

B.D. Reference		地形圖參考
M.W. Reference		小區工程圖
L.D. Reference		地政署圖
F.S.D. Reference		消防處圖
Notes		註釋
Copyright Reserved nothing may be reprinted or utilized in any form or by any means without written permission from the M&D.		
REV	DESCRIPTION	DATE
Project		
LOTS 187R.P.(PART) AND 188(PART) IN D.D.52 AND ADJOINING GOVERNMENT LAND, FU TEI AU, SHEUNG SHUI, NEW TERRITORIES		
Application		
PROPOSED TEMPORARY DANGEROUS GOODS GODOWN (CAT.2,3,4,5,6,7,8,9 DANGEROUS GOODS) WITH ANCILLARY OFFICE USE AND ASSOCIATED FILLING OF LAND FOR A PERIOD OF 3 YEARS		
Drawing Title		
PROPOSED SWEEP PATH ANALYSIS (MGV/HGV VEHICLE (Rigid))		
Scale		Revisions
1:500 (A3)		—
Designed by	Drawn by	
LW	Arthur	
Checked by	Date	
LW	07-AUG-2025	
Job No.	Drawing No.	
—	TD-03	