

FIRE SERVICES NOTES:**1. HOSE REEL SYSTEM**

- 1.1 HOSE REEL SHALL BE PROVIDED AT POSITIONS AS INDICATED ON PLANS.
- 1.2 THERE SHALL BE SUFFICIENT HOSE REELS TO ENSURE THAT EVERY PART OF THE BUILDING CAN BE REACHED BY A LENGTH OF NOT MORE THAN 30M OF HOSE REEL TUBING. ONE ACTUATING POINT AND ONE AUDIO WARNING DEVICE TO BE LOCATED AT EACH HR POINT. THE ACTUATING POINT SHOULD INCLUDE FACILITIES FOR THE FIRE PUMP START DEVICE INITIATION.
- 1.3 A MODIFIED HOSE REEL SYSTEM OF 2,000 LITRES WATER TANK TO BE PROVIDED FOR THE ENTIRE BUILDING AS INDICATED ON PLAN.
- 1.4 NO FIRE SERVICES INLET TO BE PROVIDED FOR THE MODIFIED HOSE REEL SYSTEM.
- 1.5 WATER SUPPLY FOR THE MODIFIED HOSE REEL SYSTEM TO BE SINGLE END FEED FROM THE GOVERNMENT TOWN MAIN.
- 1.6 TWO FIXED FIRE PUMPS (DUTY/STANDBY) TO BE PROVIDED AT F.S. & SPR. PUMP ROOM.
- 1.7 THE HR SYSTEM INSTALLED SHOULD BE IN ACCORDANCE WITH PARA. 5.14 OF THE CODE OF PRACTICE FOR MINIMUM FIRE SERVICE INSTALLATION AND EQUIPMENT 2022.
- 1.8 AN INSTRUCTION PLATE SHALL BE PROVIDED NEXT TO THE BREAK GLASS UNIT FOR OPERATION OF HOSE REEL.

2. AUTOMATIC SPRINKLER SYSTEM

- 2.1 AUTOMATIC SPRINKLER SYSTEM SUPPLIED BY A 135,000L SPRINKLER WATER TANK AND HAZARD CLASS OH3 SHALL BE PROVIDED TO THE ENTIRE BUILDING/ STRUCTURE IN ACCORDANCE WITH LPC RULES INCORPORATING BS EN12845: 2015 AND FSD CIRCULAR LETTER 5/2020.
- 2.2 THE SPRINKLER TANK, SPRINKLER PUMP ROOM, SPRINKLER INLET AND SPRINKLER CONTROL VALVE GROUP SHALL BE CLEARLY MARKED ON PLANS.
- 2.3 THE CLASSIFICATION OF THE AUTOMATIC SPRINKLER INSTALLATION TO BE ORDINARY HAZARD GROUP 3.
- 2.4 ONE NUMBER 135,000 LITRES SPRINKLER WATER TANK TO BE PROVIDED AS INDICATED ON PLANS.
- 2.5 SPRINKLER CONTROL VALVE SET AND SPRINKLER INLET TO BE PROVIDED AS INDICATED ON PLANS.
- 2.6 THE MAXIMUM STORAGE AREAS SHALL BE 50m² FOR ANY SINGLE BLOCK, WITH NO LESS THAN 2.4m CLEARANCE AROUND THE BLOCK.
- 2.7 TYPE OF STORAGE METHOD FOR THE BUILDING IS AS FOLLOWS:
 - (A) STORAGE CATEGORY: CATEGORY (I)
 - (B) STORAGE HEIGHT: NOT EXCEEDING 4M
 - (C) STORAGE: ST1

3. FIRE ALARM SYSTEM

- 3.1 FIRE ALARM SYSTEM SHALL BE PROVIDED THROUGHOUT THE ENTIRE BUILDING IN ACCORDANCE WITH BS 5839-1: 2017 AND FSD CIRCULAR LETTER NO.6/2021. ONE ACTUATING POINT AND ONE AUDIO WARNING DEVICE SHOULD BE LOCATED AT EACH HOSE REEL POINT. THE ACTUATION POINT SHOULD INCLUDE FACILITIES FOR FIRE PUMP START AND AUDIO / VISUAL WARNING DEVICE INITIATION.
- 3.2 AN ADDRESSABLE TYPE FIRE ALARM PANEL TO BE PROVIDED AND LOCATED INSIDE G/F F.S. & SPR. PUMP ROOM.

4. MISCELLANEOUS F.S. INSTALLATION

- 4.1 PORTABLE FIRE EXTINGUISHER WITH SPECIFIED TYPE AND CAPACITY TO BE PROVIDED AT LOCATIONS AS INDICATED ON PLANS.
- 4.2 SUFFICIENT EMERGENCY LIGHTING SHALL BE PROVIDED THROUGHOUT THE ENTIRE BUILDINGS/STRUCTURES IN ACCORDANCE WITH BS 5266-1:2016, BS EN 1838:2013 AND FSD CL 4/2021.
- 4.3 SUFFICIENT DIRECTIONAL AND EXIT SIGN SHALL BE PROVIDED IN ACCORDANCE WITH BS 5266: PART 1 AND FSD CIRCULAR LETTER 5/2008.
- 4.4 NO EMERGENCY GENERATOR TO BE PROVIDED FOR SERVING THE EMERGENCY POWER. DUPLICATED POWER SUPPLIES FOR ALL FIRE SERVICES INSTALLATIONS COMPRISING A CABLE CONNECTED FROM ELECTRICITY MAINS DIRECTLY BEFORE THE MAIN SWITCH.
- 4.5 WHEN A VENTILATION/ AIR CONDITIONING CONTROL SYSTEM TO A BUILDING IS PROVIDED, IT SHALL STOP MECHANICALLY INDUCED AIR MOVEMENT WITHIN A DESIGNATED FIRE COMPARTMENT.
- 4.6 NO DYNAMIC SMOKE EXTRACTION SYSTEM SHALL BE PROVIDED SINCE FIRE COMPARTMENT NOT EXCEEDING 7000 CUBIC METRES AND THE AGGREGATE AREA OF OPENABLE WINDOWS OF THE RESPECTIVE COMPARTMENT EXCEEDS 6.25% OF THE FLOOR AREA OF THAT COMPARTMENT.

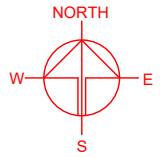

PLANNING CONSULTANT



PROJECT

PROPOSED WAREHOUSE (EXCLUDING DANGEROUS GOODS GODOWN) WITH ANCILLARY FACILITIES FOR A PERIOD OF 5 YEARS

SITE LOCATION

LOT 138 (PART) IN D.D. 52, FU TEI AU, SHEUNG SHUI, NEW TERRITORIES

SCALE

-

DRAWN BY

MN

DATE

2.6.2025

REVISED BY

DATE

APPROVED BY

DATE

DWG. TITLE

FSIs PROPOSAL (1/4)

DWG NO.

APPENDIX I

VER.

001

DEVELOPMENT PARAMETERS

APPLICATION SITE AREA	: 2,151 m ²	(ABOUT)
COVERED AREA	: 1,316 m ²	(ABOUT)
UNCOVERED AREA	: 835 m ²	(ABOUT)
PLOT RATIO	: 1.2	(ABOUT)
SITE COVERAGE	: 61 %	(ABOUT)
NO. OF STRUCTURE	: 2	
DOMESTIC GFA	: N/A	
NON-DOMESTIC GFA	: 2,552 m ²	(ABOUT)
BUILDING HEIGHT	: 7 m - 15 m	(ABOUT)
NO. OF STOREY	: 1 - 2	

STRUCTURE	USE	COVERED AREA	GFA	BUILDING HEIGHT
B1	WAREHOUSE (EXCL. D.G.G.) SITE OFFICE, WASHROOM, FS WATER TANK AND PUMP ROOM	1,236 m ² (ABOUT)	2,472 m ² (ABOUT)	15 m (ABOUT)(2-STOREY)
B2	RAIN SHELTER FOR L/UL ACTIVITIES	80 m ² (ABOUT)	80 m ² (ABOUT)	7 m (ABOUT)(1-STOREY)
TOTAL		1,316 m ² (ABOUT)	2,552 m ² (ABOUT)	

* D.G.G. - DANGEROUS GOODS GODOWN
L/UL - LOADING / UNLOADING

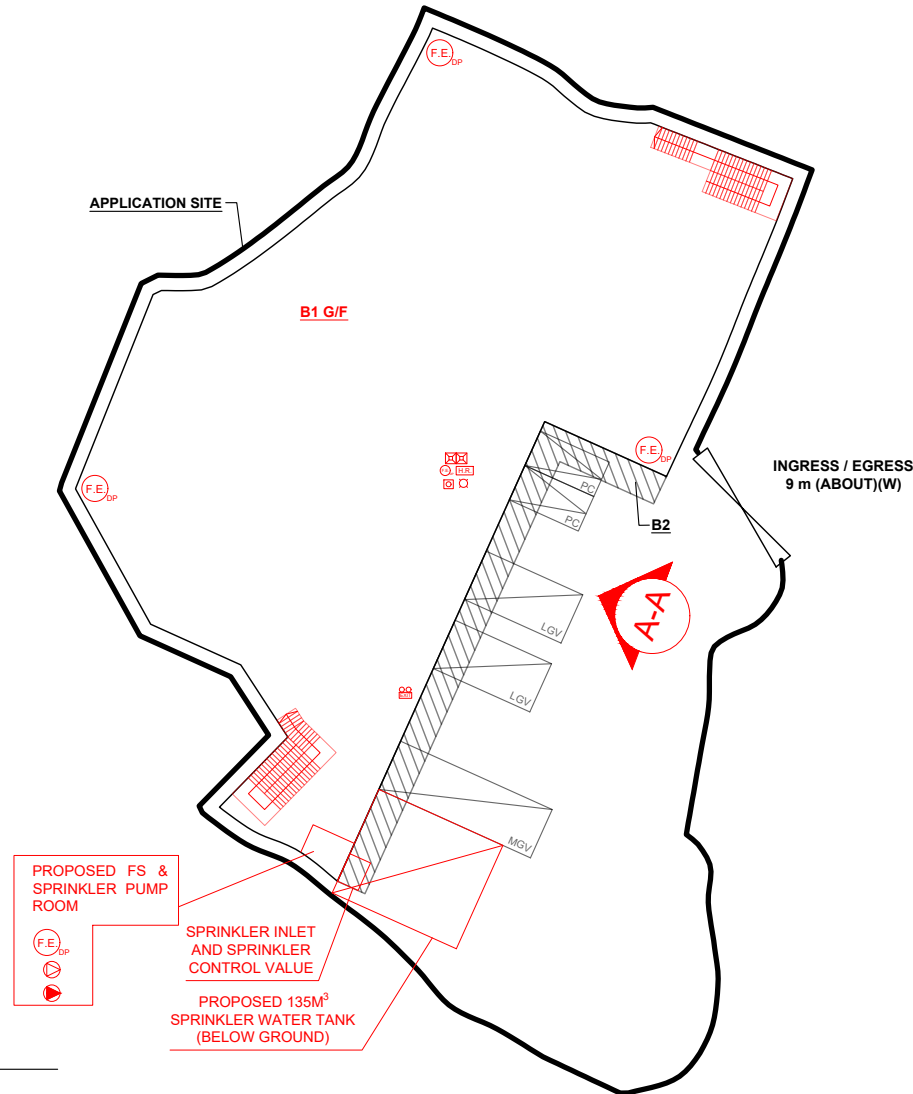
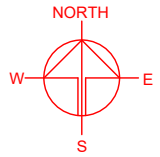

FIRE SERVICE INSTALLATIONS

- EMERGENCY LIGHTING AND EXIT SIGN
- 5 KG CO2 TYPE FIRE EXTINGUISHER
- 4 KG DRY POWER TYPE FIRE EXTINGUISHER
- HOSE REEL PUMP
- SPRINKLER PUMP
- BREAK GLASS UNIT
- VISUAL ALARM DEVICE
- 2,000 LITRES FIBRE GLASS F.S. WATER TANK
- 135,000 LITRES R.C. SPRINKLER WATER TANK
- HOSE REEL SET

LEGEND

- APPLICATION SITE
- STRUCTURE
- PARKING SPACE (PC)
- LOADING/UNLOADING SPACE (LGV)
- LOADING/UNLOADING SPACE (MGV)
- INGRESS / EGRESS

PARKING AND LOADING / UNLOADING PROVISIONS

NO. OF PRIVATE CAR PARKING SPACE	: 2
DIMENSION OF PARKING SPACE	: 5 m (L) x 2.5 m (W)
NO. OF L/UL SPACE FOR LIGHT GOODS VEHICLE	: 2
DIMENSION OF PARKING SPACE	: 7 m (L) x 3.5 m (W)
NO. OF L/UL SPACE FOR MEDIUM GOODS VEHICLE	: 1
DIMENSION OF L/UL SPACE	: 11 m (L) x 3.5 m (W)

PLANNING CONSULTANT



PROJECT

PROPOSED WAREHOUSE (EXCLUDING DANGEROUS GOODS GODOWN) WITH ANCILLARY FACILITIES FOR A PERIOD OF 5 YEARS

SITE LOCATION

LOT 138 (PART) IN D.D. 52, FU TEI AU, SHEUNG SHUI, NEW TERRITORIES

SCALE

1 : 500 @ A4

DRAWN BY

MN

DATE

2.6.2025

REVISED BY

DATE

APPROVED BY

DATE

DWG. TITLE

FSIs PROPOSAL (2/4)

DWG NO.

APPENDIX I

VER.

001

DEVELOPMENT PARAMETERS

APPLICATION SITE AREA	: 2,151 m ²	(ABOUT)
COVERED AREA	: 1,316 m ²	(ABOUT)
UNCOVERED AREA	: 835 m ²	(ABOUT)
PLOT RATIO	: 1.2	(ABOUT)
SITE COVERAGE	: 61 %	(ABOUT)
NO. OF STRUCTURE	: 2	
DOMESTIC GFA	: N/A	
NON-DOMESTIC GFA	: 2,552 m ²	(ABOUT)
BUILDING HEIGHT	: 7 m - 15 m	(ABOUT)
NO. OF STOREY	: 1 - 2	

STRUCTURE	USE	COVERED AREA	GFA	BUILDING HEIGHT
B1	WAREHOUSE (EXCL. D.G.G.) SITE OFFICE, WASHROOM, FS WATER TANK AND PUMP ROOM	1,236 m ² (ABOUT)	2,472 m ² (ABOUT)	15 m (ABOUT)(2-STOREY)
B2	RAIN SHELTER FOR L/UL ACTIVITIES	80 m ² (ABOUT)	80 m ² (ABOUT)	7 m (ABOUT)(1-STOREY)
TOTAL		1,316 m ² (ABOUT)	2,552 m ² (ABOUT)	

* D.G.G. - DANGEROUS GOODS GODOWN
L/UL - LOADING / UNLOADING

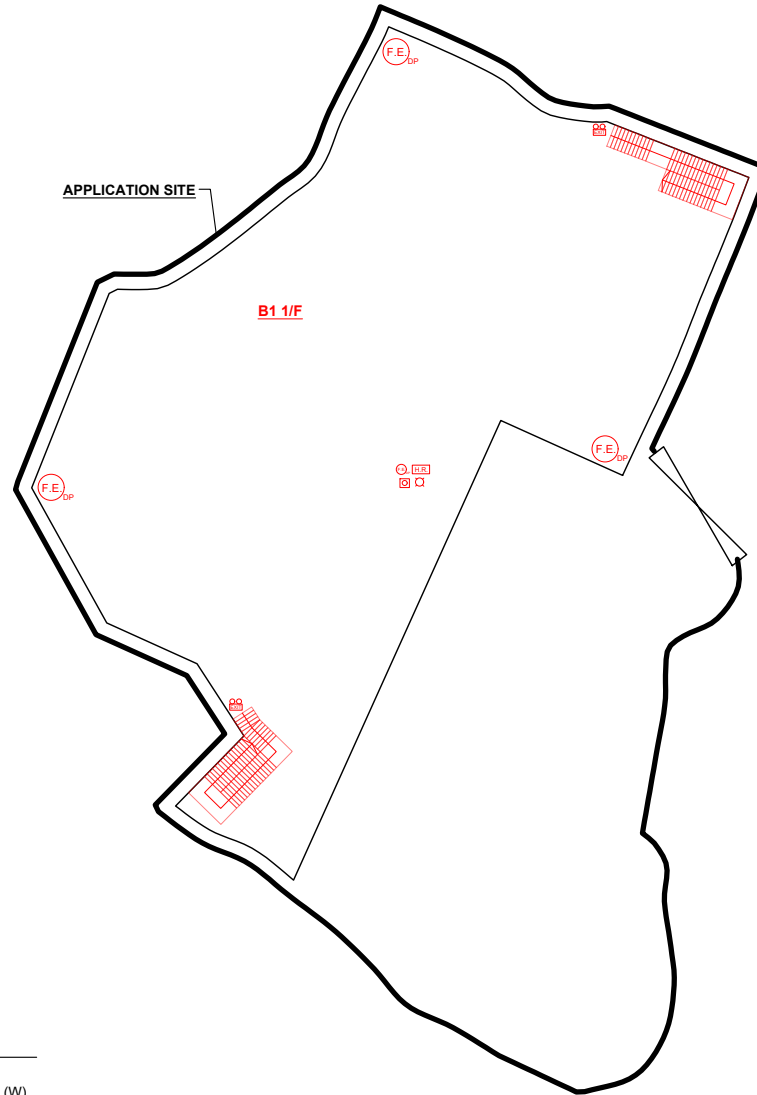
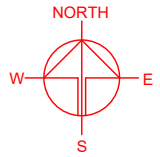

FIRE SERVICE INSTALLATIONS

- EMERGENCY LIGHTING AND EXIT SIGN
- 5 KG CO2 TYPE FIRE EXTINGUISHER
- 4 KG DRY POWER TYPE FIRE EXTINGUISHER
- HOSE REEL PUMP
- SPRINKLER PUMP
- BREAK GLASS UNIT
- VISUAL ALARM DEVICE
- 2,000 LITRES FIBRE GLASS F.S. WATER TANK
- 135,000 LITRES R.C. SPRINKLER WATER TANK
- HOSE REEL SET

LEGEND

- APPLICATION SITE
- STRUCTURE
- PARKING SPACE (PC)
- LOADING/UNLOADING SPACE (LGV)
- LOADING/UNLOADING SPACE (MGV)
- INGRESS / EGRESS

PARKING AND LOADING / UNLOADING PROVISIONS

NO. OF PRIVATE CAR PARKING SPACE	: 2
DIMENSION OF PARKING SPACE	: 5 m (L) x 2.5 m (W)
NO. OF L/UL SPACE FOR LIGHT GOODS VEHICLE	: 2
DIMENSION OF PARKING SPACE	: 7 m (L) x 3.5 m (W)
NO. OF L/UL SPACE FOR MEDIUM GOODS VEHICLE	: 1
DIMENSION OF L/UL SPACE	: 11 m (L) x 3.5 m (W)

PLANNING CONSULTANT



PROJECT

PROPOSED WAREHOUSE (EXCLUDING DANGEROUS GOODS GODOWN) WITH ANCILLARY FACILITIES FOR A PERIOD OF 5 YEARS

SITE LOCATION

LOT 138 (PART) IN D.D. 52, FU TEI AU, SHEUNG SHUI, NEW TERRITORIES

SCALE

1 : 500 @ A4

DRAWN BY

MN

DATE

2.6.2025

REVISED BY

DATE

APPROVED BY

DATE

DWG. TITLE

FSIs PROPOSAL (3/4)

DWG NO.

APPENDIX I

VER.

001

STRUCTURE	USE	COVERED AREA	GFA	BUILDING HEIGHT
B1	WAREHOUSE (EXCL. D.G.G.) SITE OFFICE, WASHROOM, FS WATER TANK AND PUMP ROOM	1,236 m ² (ABOUT)	2,472 m ² (ABOUT)	15 m (ABOUT)(2-STOREY)
B2	RAIN SHELTER FOR L/UL ACTIVITIES	80 m ² (ABOUT)	80 m ² (ABOUT)	7 m (ABOUT)(1-STOREY)
TOTAL		1,316 m ² (ABOUT)	2,552 m ² (ABOUT)	
* D.G.G. L/UL		- DANGEROUS GOODS GODOWN - LOADING / UNLOADING		

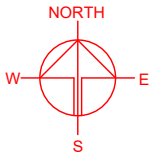

OPENABLE WINDOW AREA CALCULAION UNDER F.S.D. REQUIREMENT FOR COMPARTMENT EXCEEDING 7000m ³	
LOCATION	STRUCTURE B1
GFA	2,472 m ²
OPENABLE WINDOW AREA REQUIRED	2,472 m ² X 6.25% = 154.5 m ²
OPENABLE WINDOW AREA PROVIDED	REFER TO ELEVATION (A-A) = 159 m ²
	TOTAL = 159 m ² > 154.5 m ²

ELEVATION PLAN (A-A)

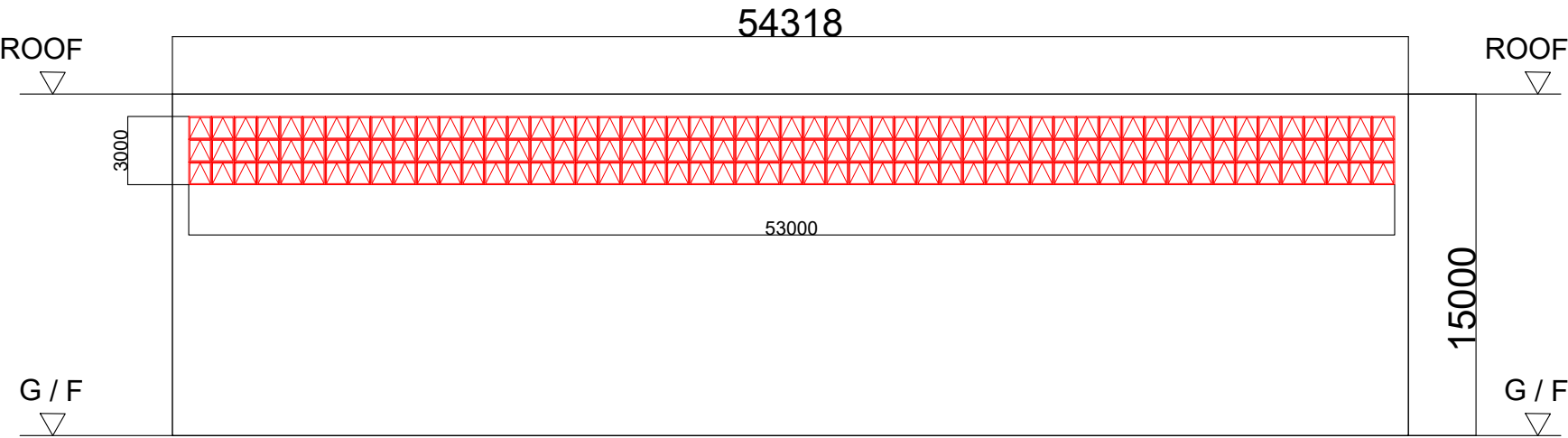

PROJECT
PROPOSED WAREHOUSE (EXCLUDING DANGEROUS GOODS GODOWN) WITH ANCILLARY FACILITIES FOR A PERIOD OF 5 YEARS

SITE LOCATION
LOT 138 (PART) IN D.D. 52, FU TEI AU, SHEUNG SHUI, NEW TERRITORIES

SCALE 1 : 500 @ A4	
DRAWN BY MN	DATE 2.6.2025
REVISED BY	DATE
APPROVED BY	DATE
DWG. TITLE FSIs PROPOSAL (4/4)	
DWG NO. APPENDIX I	VER. 001

