

**LOCATION OF THE APPLICATION SITE**

APPLICATION SITE AREA : 3,110 m<sup>2</sup> (ABOUT)

**VEHICULAR ACCESS**  
ACCESSIBLE FROM KONG NGA PO ROAD VIA A LOCAL ACCESS

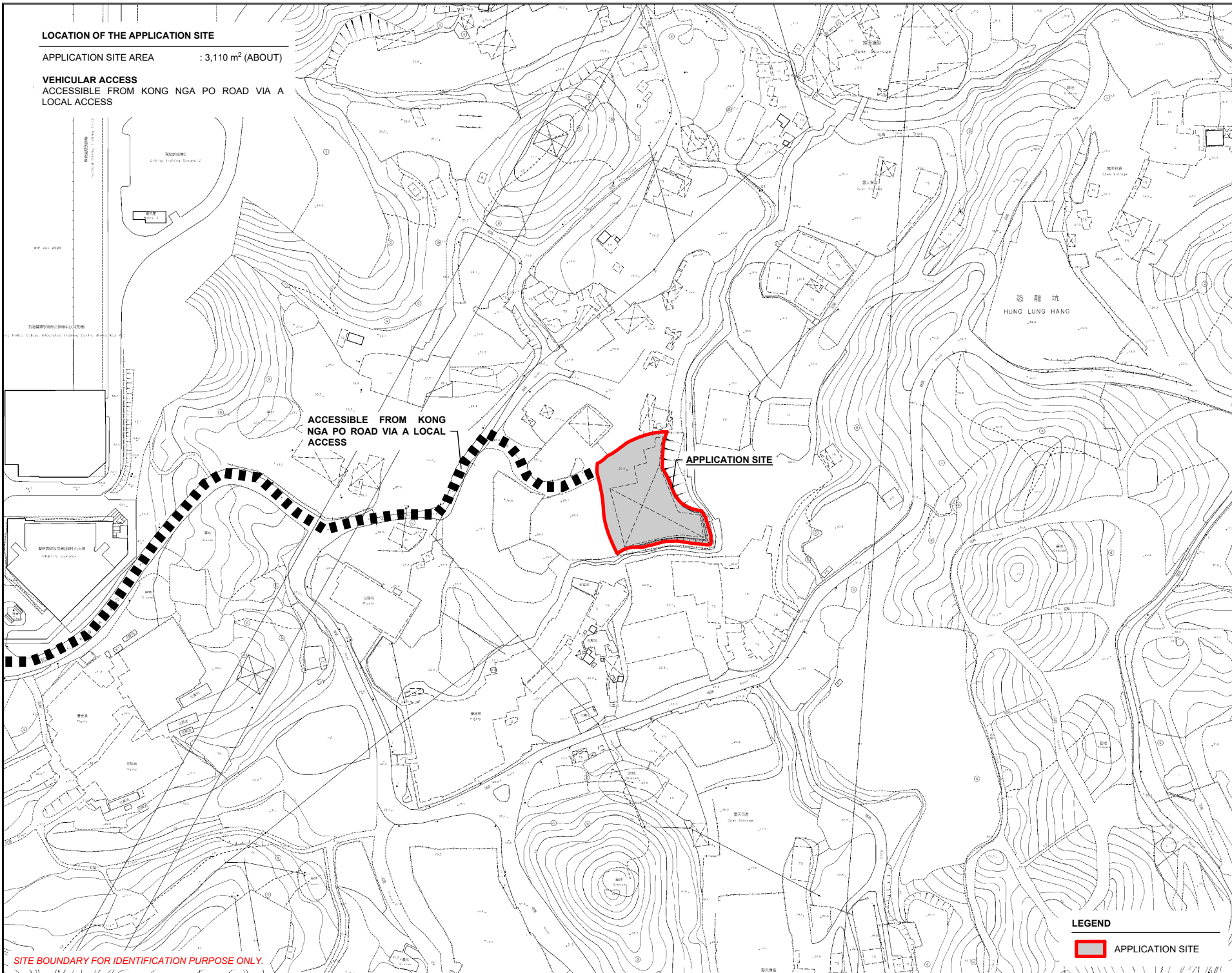
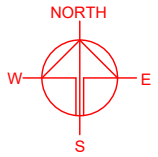

ACCESSIBLE FROM KONG  
NGA PO ROAD VIA A LOCAL  
ACCESS

APPLICATION SITE

**LEGEND**

 APPLICATION SITE

SITE BOUNDARY FOR IDENTIFICATION PURPOSE ONLY.

PLANNING CONSULTANT



PROJECT

PROPOSED TEMPORARY RURAL  
WORKSHOP AND OPEN  
STORAGE OF RECYCLABLE  
MATERIALS WITH ANCILLARY  
FACILITIES AND ASSOCIATED  
FILLING OF LAND FOR A PERIOD  
OF 3 YEARS

SITE LOCATION

LOTS 357 (PART) AND 359  
(PART) IN D.D. 87, HUNG LUNG  
HANG, NEW TERRITORIES

SCALE  
1 : 3000 @ A4

DRAWN BY  
MN 22.4.2026

CHECKED BY  
DATE

APPROVED BY  
DATE

DWG. TITLE  
LOCATION PLAN

DWG NO.  
PLAN 1

VER.  
001

**ZONING OF THE APPLICATION SITE**

APPLICATION SITE AREA : 3,110 m<sup>2</sup> (ABOUT)  
OUTLINE ZONING PLAN : APPROVED FU TEI AU & SHA LING OZP  
OZP PLAN NO. : S/NE-FTA/18  
ZONING OF THE SITE : "AGRICULTURE" ("AGR")

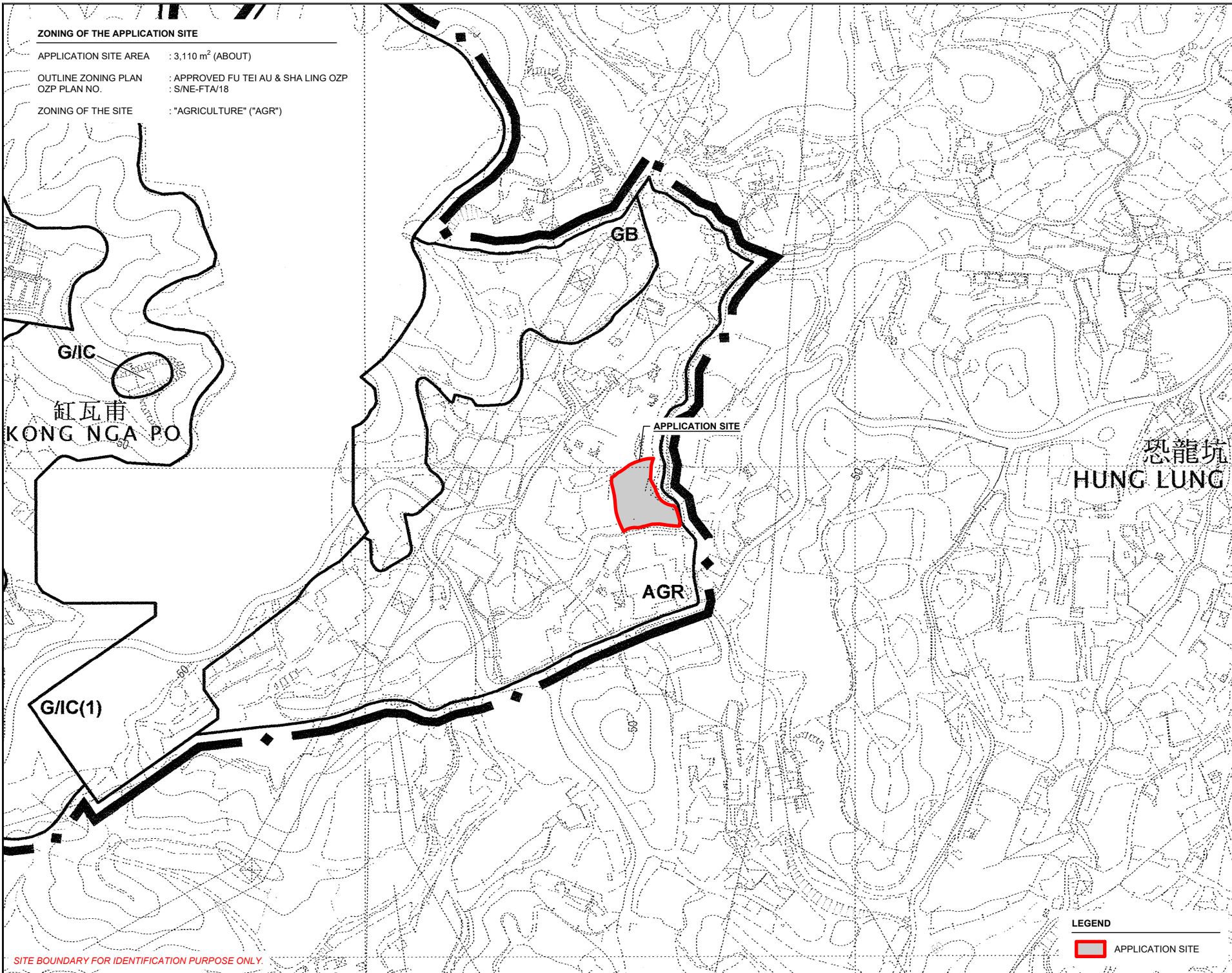

SITE BOUNDARY FOR IDENTIFICATION PURPOSE ONLY.

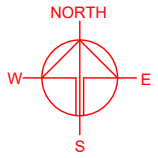

PLANNING CONSULTANT



PROJECT

PROPOSED TEMPORARY RURAL WORKSHOP AND OPEN STORAGE OF RECYCLABLE MATERIALS WITH ANCILLARY FACILITIES AND ASSOCIATED FILLING OF LAND FOR A PERIOD OF 3 YEARS

SITE LOCATION

LOTS 357 (PART) AND 359 (PART) IN D.D. 87, HUNG LUNG HANG, NEW TERRITORIES

SCALE  
1 : 3000 @ A4

DRAWN BY: MN DATE: 22.4.2026

CHECKED BY: DATE:

APPROVED BY: DATE:

DWG. TITLE  
ZONING OF THE SITE

DWG NO.: PLAN 2 VER.: 001

**LEGEND**

 APPLICATION SITE

**LAND STATUS OF THE APPLICATION SITE**

APPLICATION SITE AREA : 3,110 m<sup>2</sup> (ABOUT)  
 AREA OF PRIVATE LAND : 3,110 m<sup>2</sup> (ABOUT)  
 AREA OF GOVERNMENT LAND : NOT APPLICABLE

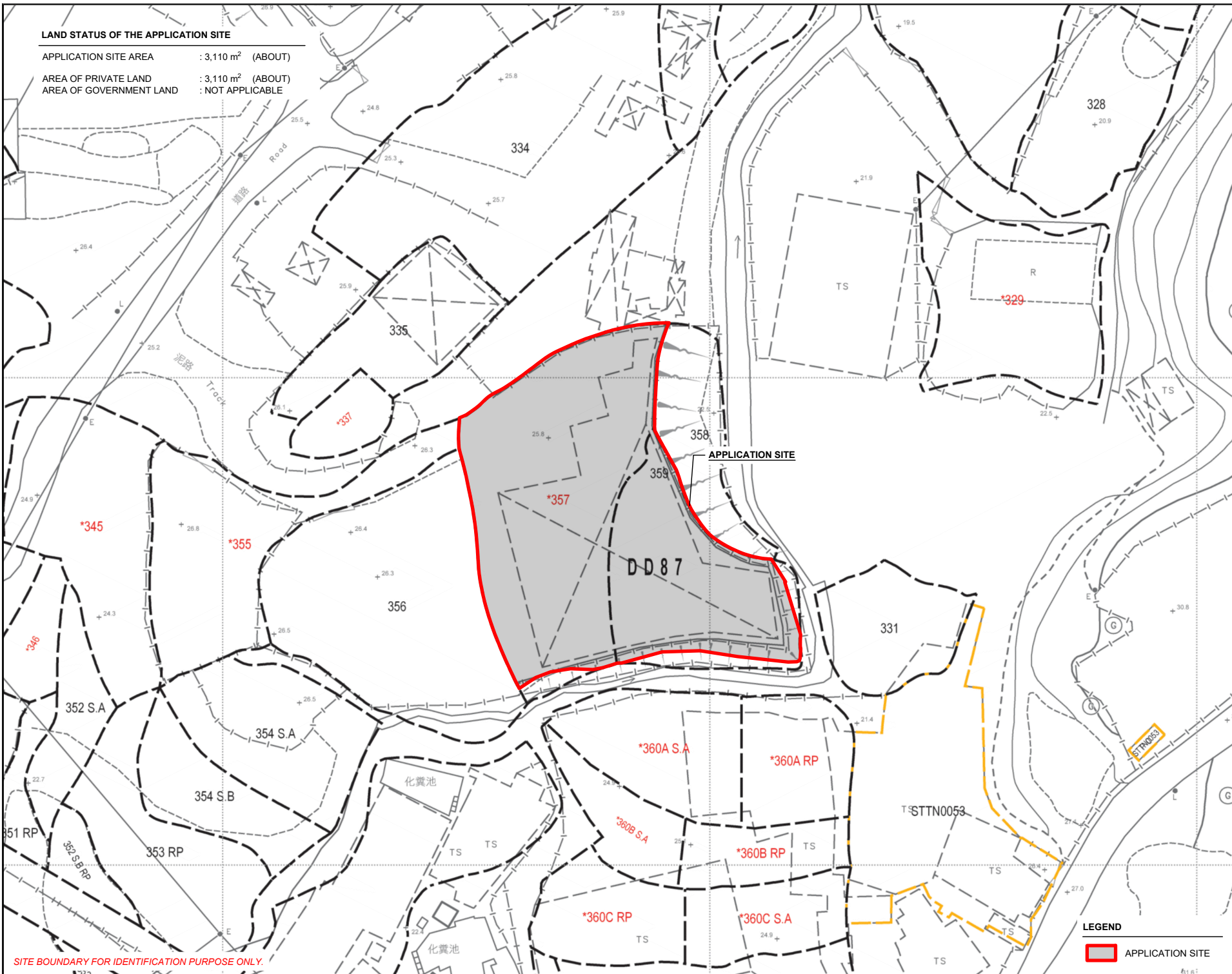
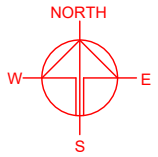

SITE BOUNDARY FOR IDENTIFICATION PURPOSE ONLY.

APPLICATION SITE

D-D 87

**LEGEND**

APPLICATION SITE

PLANNING CONSULTANT



PROJECT

PROPOSED TEMPORARY RURAL WORKSHOP AND OPEN STORAGE OF RECYCLABLE MATERIALS WITH ANCILLARY FACILITIES AND ASSOCIATED FILLING OF LAND FOR A PERIOD OF 3 YEARS

SITE LOCATION

LOTS 357 (PART) AND 359 (PART) IN D.D. 87, HUNG LUNG HANG, NEW TERRITORIES

SCALE  
1: 1000 @ A4

DRAWN BY	DATE
MN	22.4.2026

CHECKED BY	DATE

APPROVED BY	DATE

DWG. TITLE  
LAND STATUS OF THE SITE

DWG NO.	VER.
PLAN 3	001

**TOWN PLANNING BOARD GUIDELINES NO. 13G  
FOR APPLICATION FOR OPEN STORAGE AND PORT BACK-UP  
USES UNDER SECTION 16 OF THE TOWN PLANNING ORDINANCE**

APPLICATION SITE AREA : 3,110 m<sup>2</sup> (ABOUT)

CATEGORY OF THE SITE : CATEGORY 2 AREA

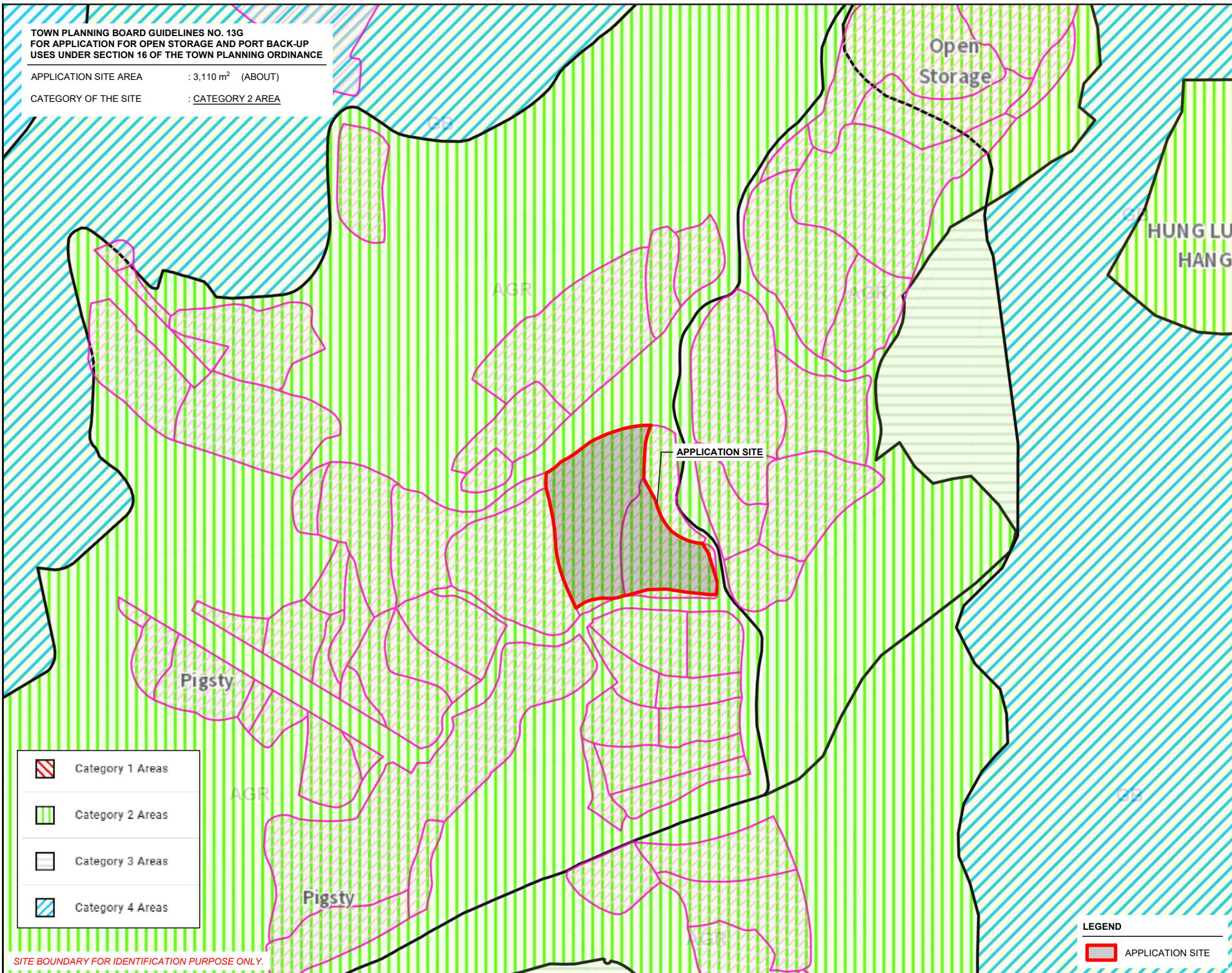
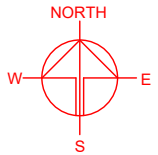

	Category 1 Areas
	Category 2 Areas
	Category 3 Areas
	Category 4 Areas

SITE BOUNDARY FOR IDENTIFICATION PURPOSE ONLY.

**LEGEND**

	APPLICATION SITE
--	------------------

PLANNING CONSULTANT  
 R-RICHES PLANNING LIMITED

PROJECT  
 PROPOSED TEMPORARY RURAL WORKSHOP AND OPEN STORAGE OF RECYCLABLE MATERIALS WITH ANCILLARY FACILITIES AND ASSOCIATED FILLING OF LAND FOR A PERIOD OF 3 YEARS

SITE LOCATION  
 LOTS 357 (PART) AND 359 (PART) IN D.D. 87, HUNG LUNG HANG, NEW TERRITORIES

SCALE 1 : 2000 @ A4	
DRAWN BY MN	DATE 22.4.2026
CHECKED BY	DATE
APPROVED BY	DATE
DWG. TITLE TPB PG-NO. 13G	
DWG. NO. PLAN 4	VER. 001

**DEVELOPMENT PARAMETERS**

APPLICATION SITE AREA	: 3,110 m <sup>2</sup>	(ABOUT)
COVERED AREA	: 1,320 m <sup>2</sup>	(ABOUT)
UNCOVERED AREA	: 1,790 m <sup>2</sup>	(ABOUT)
PLOT RATIO	: 0.42	(ABOUT)
SITE COVERAGE	: 42 %	(ABOUT)
NO. OF STRUCTURE	: 7	
DOMESTIC GFA	: NOT APPLICABLE	
NON-DOMESTIC GFA	: 1,320 m <sup>2</sup>	(ABOUT)
TOTAL GFA	: 1,320 m <sup>2</sup>	(ABOUT)
BUILDING HEIGHT	: 7.5 m	(ABOUT)
NO. OF STOREY	: 1	
OPEN STORAGE AREA	: 224 m <sup>2</sup>	(ABOUT)
STACKING HEIGHT	: NOT MORE THAN 3 m	

STRUCTURE	USE	COVERED AREA	GROSS FLOOR AREA	BUILDING HEIGHT
B1	COVERED LOADING / UNLOADING AREA	171 m <sup>2</sup> (ABOUT)	171 m <sup>2</sup> (ABOUT)	7.5 m (ABOUT)(1-STOREY)
B2	COVERED LOADING / UNLOADING AREA	165 m <sup>2</sup> (ABOUT)	165 m <sup>2</sup> (ABOUT)	7.5 m (ABOUT)(1-STOREY)
B3	STORAGE OF RECYCLABLE MATERIALS	222 m <sup>2</sup> (ABOUT)	222 m <sup>2</sup> (ABOUT)	7.5 m (ABOUT)(1-STOREY)
B4	RURAL WORKSHOP	178 m <sup>2</sup> (ABOUT)	178 m <sup>2</sup> (ABOUT)	7.5 m (ABOUT)(1-STOREY)
B5	RURAL WORKSHOP	204 m <sup>2</sup> (ABOUT)	204 m <sup>2</sup> (ABOUT)	7.5 m (ABOUT)(1-STOREY)
B6	STORAGE OF RECYCLABLE MATERIALS	229 m <sup>2</sup> (ABOUT)	229 m <sup>2</sup> (ABOUT)	7.5 m (ABOUT)(1-STOREY)
B7	RURAL WORKSHOP	151 m <sup>2</sup> (ABOUT)	151 m <sup>2</sup> (ABOUT)	7.5 m (ABOUT)(1-STOREY)
<b>TOTAL</b>		<b>1,320 m<sup>2</sup> (ABOUT)</b>	<b>1,320 m<sup>2</sup> (ABOUT)</b>	

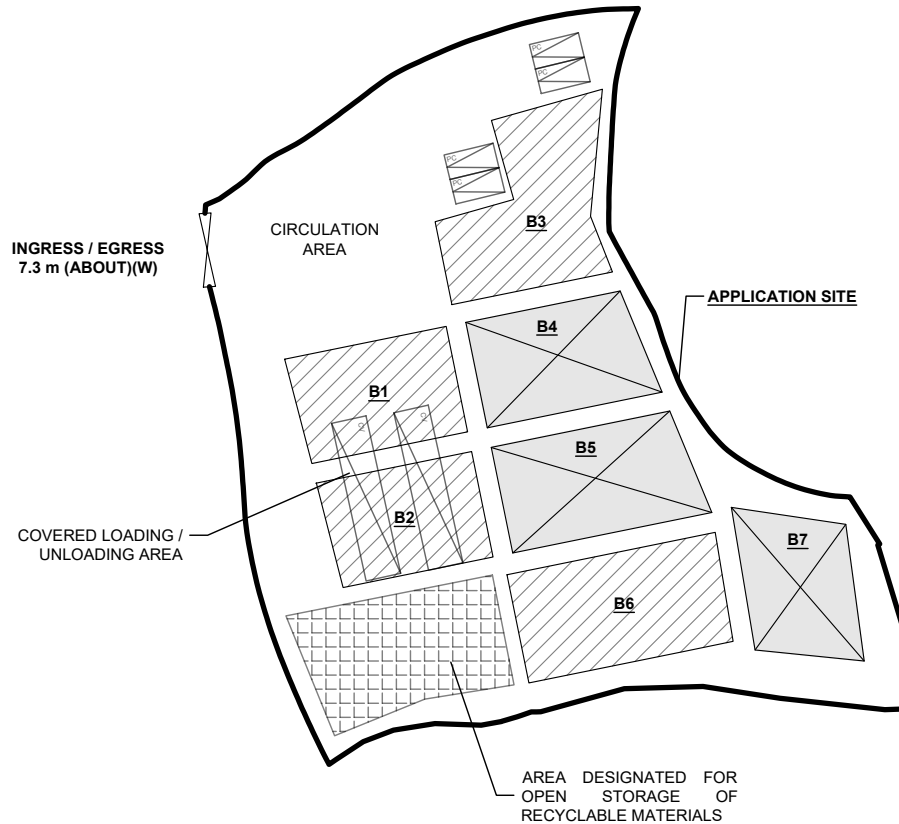
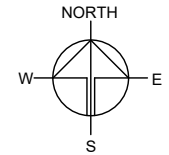

**PARKING AND LOADING/UNLOADING PROVISIONS**

NO. OF PRIVATE CAR PARKING SPACE	: 4
DIMENSION OF PARKING SPACE	: 5 m (L) X 2.5 m (W)
NO. OF L/UL SPACE FOR CONTAINER VEHICLE	: 2
DIMENSION OF L/UL SPACE	: 16 m (L) X 3.5 m (W)

SITE BOUNDARY FOR IDENTIFICATION PURPOSE ONLY.

**LEGEND**

- APPLICATION SITE
- STRUCTURE (ENCLOSED)
- STRUCTURE (SHED)
- OPEN STORAGE AREA
- PARKING SPACE (PRIVATE CAR)
- L/UL SPACE (CONTAINER VEHICLE)
- INGRESS / EGRESS

PLANNING CONSULTANT



PROJECT

PROPOSED TEMPORARY RURAL WORKSHOP AND OPEN STORAGE OF RECYCLABLE MATERIALS WITH ANCILLARY FACILITIES AND ASSOCIATED FILLING OF LAND FOR A PERIOD OF 3 YEARS

SITE LOCATION

LOTS 357 (PART) AND 359 (PART) IN D.D. 87, HUNG LUNG HANG, NEW TERRITORIES

SCALE

1 : 750 @ A4

DRAWN BY: MN DATE: 22.4.2026

CHECKED BY: DATE:

APPROVED BY: DATE:

DWG. TITLE  
LAYOUT PLAN

DWG NO.: PLAN 5 VER.: 001

**THE APPLICATION SITE BEFORE FILLING OF LAND**

APPLICATION SITE AREA : 3,110 m<sup>2</sup> (ABOUT)  
 SOILED GROUND AREA : 3,110 m<sup>2</sup> (ABOUT)  
 SITE LEVELS BEFORE FILLING : +25.5 mPD TO +25.9 mPD (ABOUT)

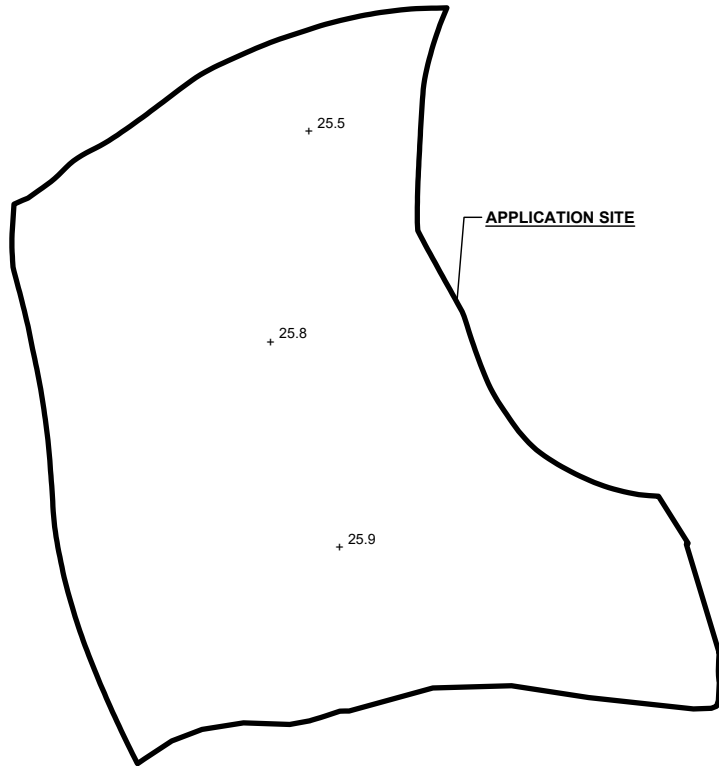

**LEGEND**

-  APPLICATION SITE
- + 25.5 SITE LEVEL BEFORE FILLING

\*SITE LEVELS ARE FOR ILLUSTRATION PURPOSE ONLY

SITE BOUNDARY FOR IDENTIFICATION PURPOSE ONLY.



**EXISTING CONDITION OF THE APPLICATION SITE**

APPLICATION SITE AREA : 3,110 m<sup>2</sup> (ABOUT)  
 PROPOSED FILLING AREA : 3,110 m<sup>2</sup> (ABOUT)  
 DEPTH OF LAND FILLING : NOT MORE THAN 0.2 m  
 PROPOSED SITE LEVELS : +25.7 mPD TO +26.1 mPD (ABOUT)  
 MATERIAL OF LAND FILLING : CONCRETE  
 USE : SITE FORMATION OF STRUCTURE,  
 PARKING AND LOADING / UNLOADING SPACE,  
 OPEN STORAGE AND CIRCULATION AREA

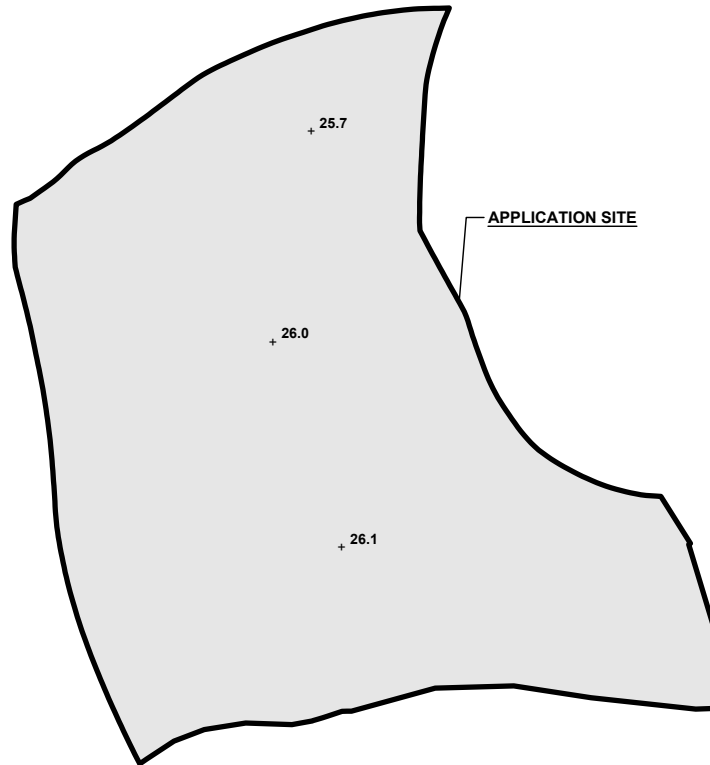
*THE APPLICATION SITE HAS ALREADY BEEN HARD-PAVED. NO FURTHER FILLING OF LAND WILL BE CARRIED OUT AFTER PERMISSION HAS BEEN GRANTED FROM THE TOWN PLANNING BOARD.*



**LEGEND**

-  APPLICATION SITE
-  EXISTING PAVED AREA
- + 26.1 EXISTING SITE LEVEL

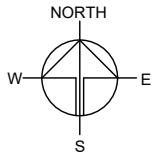

PLANNING CONSULTANT



PROJECT

PROPOSED TEMPORARY RURAL WORKSHOP AND OPEN STORAGE OF RECYCLABLE MATERIALS WITH ANCILLARY FACILITIES AND ASSOCIATED FILLING OF LAND FOR A PERIOD OF 3 YEARS

SITE LOCATION

LOTS 357 (PART) AND 359 (PART) IN D.D. 87, HUNG LUNG HANG, NEW TERRITORIES

SCALE

1 : 750 @ A4

DRAWN BY	DATE
MN	22.4.2026

REVISED BY	DATE

APPROVED BY	DATE

DWG. TITLE  
 FILLING OF LAND AREA

DWG NO.	VER.
PLAN 6	001

**SWEPT PATH ANALYSIS**

TYPE OF VEHICLE : CONTAINER VEHICLE  
 DIMENSION OF VEHICLE : 2.5m (W) X 16m (L)

SWEPT PATHS GENERATED BY AUTODESK VEHICLE TRACKING 2024

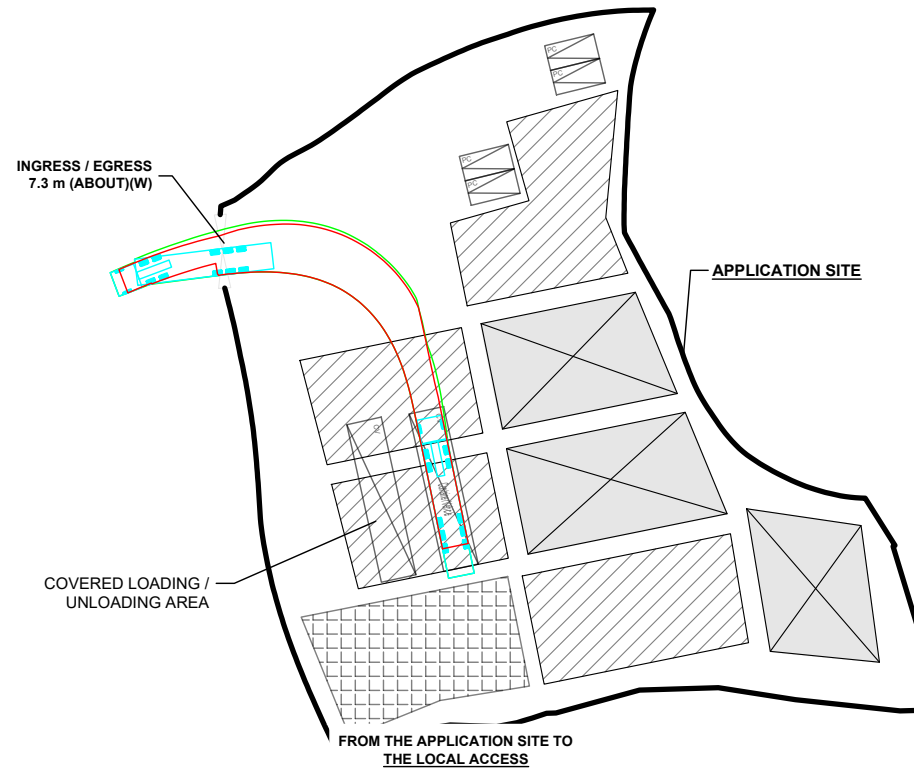
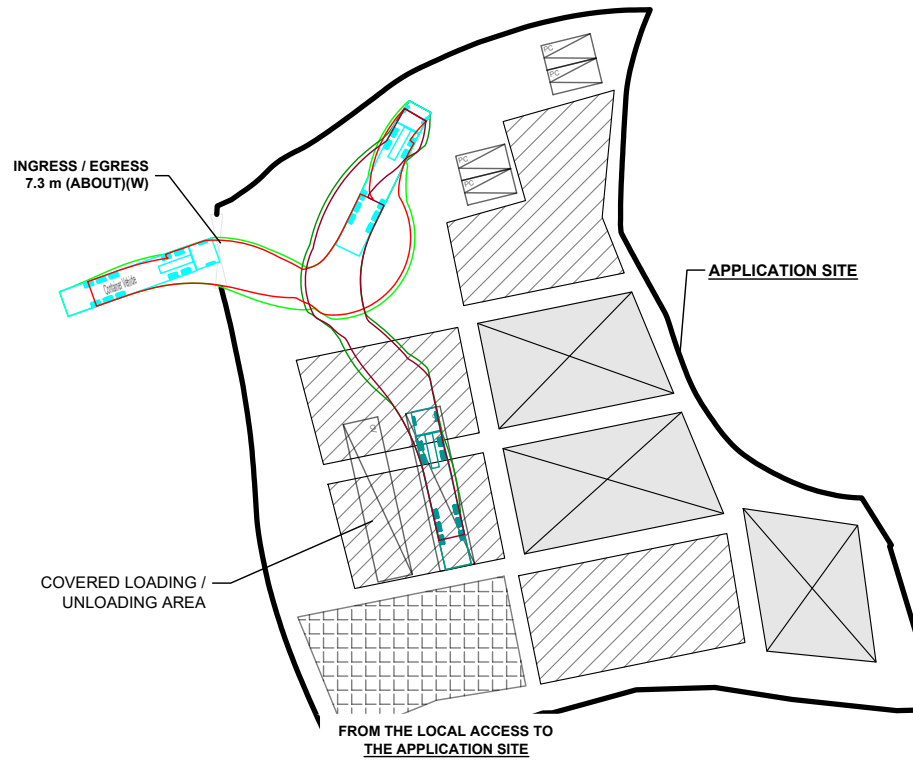

**LEGEND**

- APPLICATION SITE
- STRUCTURE (ENCLOSED)
- STRUCTURE (SHED)
- PARKING SPACE (PRIVATE CAR)
- L/U/L SPACE (CONTAINER VEHICLE)
- INGRESS / EGRESS
- CONTAINER VEHICLE
- SWEPT PATH OF VEHICLE

SITE BOUNDARY FOR IDENTIFICATION PURPOSE ONLY.

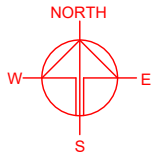

PLANNING CONSULTANT



PROJECT

PROPOSED TEMPORARY RURAL WORKSHOP AND OPEN STORAGE OF RECYCLABLE MATERIALS WITH ANCILLARY FACILITIES AND ASSOCIATED FILLING OF LAND FOR A PERIOD OF 3 YEARS

SITE LOCATION

LOTS 357 (PART) AND 359 (PART) IN D.D. 87, HUNG LUNG HANG, NEW TERRITORIES

SCALE  
 1 : 500 @ A4

DRAWN BY: MN DATE: 22.4.2026

CHECKED BY: DATE:

APPROVED BY: DATE:

DWG. TITLE  
 SWEPT PATH ANALYSIS

DWG NO. VER.  
 PLAN 7 001