

**Appendix V**

Tree Survey



# Tree Survey Report

**Date of Survey: 2<sup>nd</sup> October 2024**

**Location:**

**Various Lots in D.D.89 And Adjoining Government Land,  
Man Kam To, New Territories**

Prepared by:

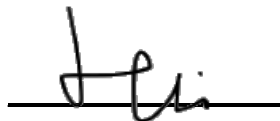

Mak Ka Hei

Registered Arborist

Date: 2<sup>nd</sup> October 2024

## **Table of contents**

1. Introduction	3
2. Summary of Existing Trees	4

### Appendix:

- I. Tree Survey Schedule
- II. Tree Survey Plan
- III. Photo Records

### Disclaimer:

The tree survey conducted indicates the condition of the surveyed trees at the time of inspection only. The assessments of amenity value, form, health and structural condition of the trees surveyed are based on visual inspection from the ground only. No aerial inspection, root digging or mapping, or diagnostic testing has been conducted as part of this survey. Wing Ho Yuen Landscaping Company Limited cannot accept responsibility for future failure or defects detected after the time of inspection of the trees surveyed in this report.

## **1. Introduction**

The survey conducted is to record all the existing trees in the tree survey boundary. The survey include tree species identification, tree tagging with durable labels, the measurements of overall tree height, Diameter at Breast Height (DBH), average crown spread, the evaluation on amenity value, form, health and structural conditions.

The tree survey was conducted on 2<sup>nd</sup> October 2024. Plants with DBH less than 95mm were not recorded in the survey.

## **2. Summary of Existing Trees**

The surveyed site is located at Various Lots in D.D.89 And Adjoining Government Land, Man Kam To, New Territories.

At the time of inspection on 2<sup>nd</sup> October 2024, **28 nos.** tree were found within the Site. **One** dead tree (T23) was recorded in the surveyed area. Location of individual tree refers to Appendix I.

Details of tree conditions and photo records for individual tree are recorded in the Appendix II and Appendix III respectively.

# Appendix I – Tree Survey Plan

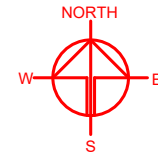
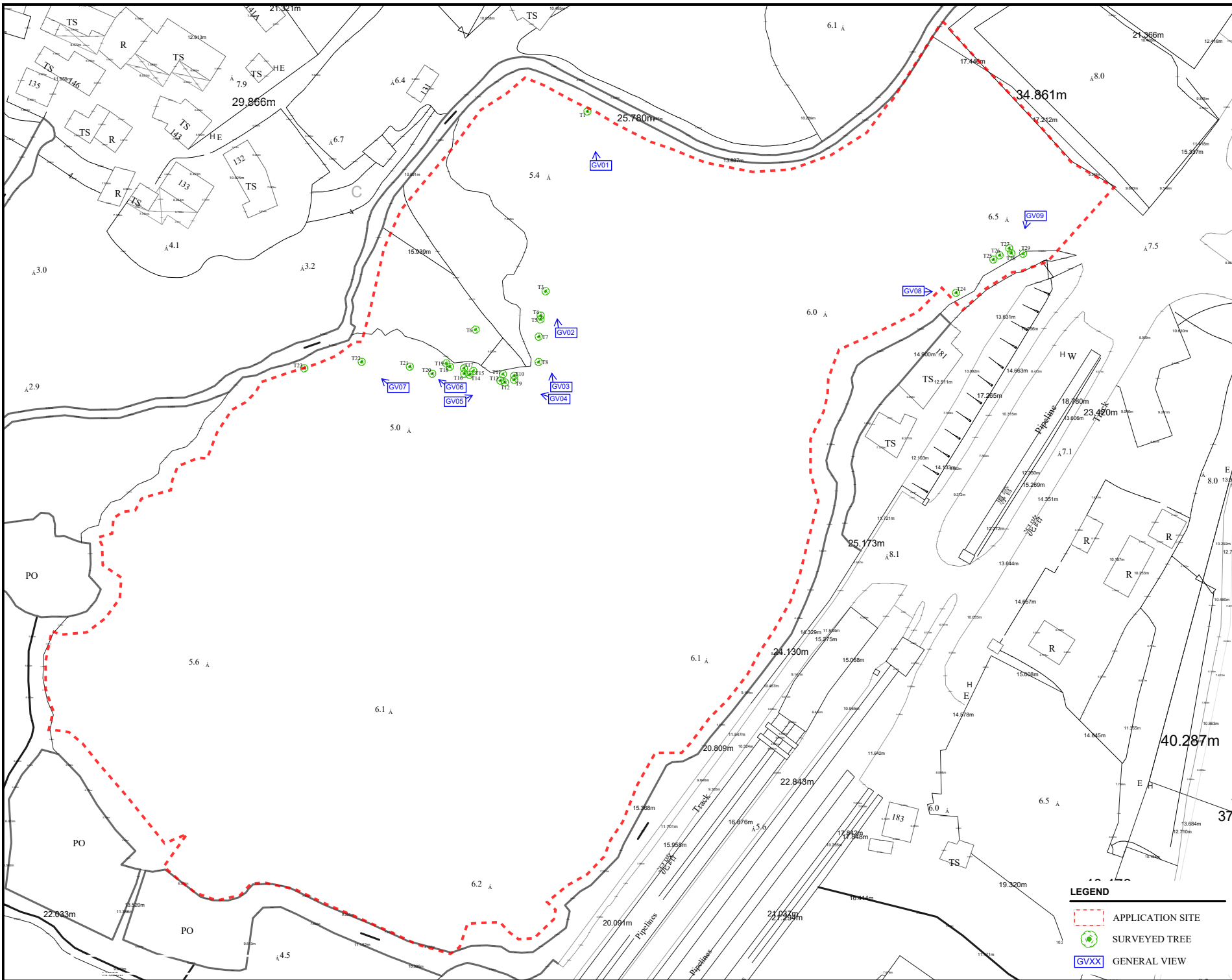

PLANNING CONSULTANT  
**R-Riches**  
 Property Consultants Ltd.

PROJECT  
 PROPOSED TEMPORARY WAREHOUSE (EXCLUDING DANGEROUS GOODS GODOWN) WITH ANCILLARY FACILITIES FOR A PERIOD OF 3 YEARS AND ASSOCIATED FILLING OF LAND

SITE LOCATION  
 VARIOUS LOTS IN D.D.89 AND ADJOINING GOVERNMENT LAND, MAN KAM TO, NEW TERRITORIES

SCALE  
 AS SHOWN

DRAWN BY KYu	DATE 2.10.2024
REVISED BY	DATE
APPROVED BY	DATE

**LEGEND**

	APPLICATION SITE
	SURVEYED TREE
	GENERAL VIEW

DWG. TITLE  
 TREE SURVEY PLAN

DWG. NO. TSP	VER. 0
-----------------	-----------

## Appendix II –Tree Survey Schedule

**Tree Survey Schedule**

Location: Various Lots in D.D.89 And Adjoining Government Land, Man Kam To, New Territories  
 Tree surveyor(s): Mak Ka Hei  
 Field Survey was conducted on: 2 October 2024



Tree No.	Tree Species		Tree Size Measurements			Amenity Value	Form	Health Condition	Structural Condition	Suitability for Transplanting	Remarks
	Botanical Name	Chinese Name	Overall Height (m)	DBH (mm)	Average Crown Spread (m)	High /Med /Low	Good /Fair /Poor	Good /Fair /Poor /Dead	Good /Fair /Poor	High /Med /Low	
T1	<i>Macaranga tanarius var. tomentosa</i>	血桐	6.0	165	6.0	Low	Fair	Fair	Poor	Low	co-dominant trunks
T3	<i>Leucaena leucocephala</i>	銀合歡	8.0	135	7.0	Low	Poor	Poor	Poor	Low	invasive species
T4	<i>Leucaena leucocephala</i>	銀合歡	8.0	100	7.0	Low	Poor	Poor	Poor	Low	invasive species
T5	<i>Leucaena leucocephala</i>	銀合歡	8.0	95	5.0	Low	Poor	Poor	Poor	Low	invasive species
T6	<i>Sapium sebiferum</i>	烏桕	5.0	130	5.0	Low	Fair	Fair	Fair	Low	
T7	<i>Macaranga tanarius var. tomentosa</i>	血桐	7.0	120	8.0	Low	Fair	Fair	Fair	Low	
T8	<i>Macaranga tanarius var. tomentosa</i>	血桐	6.0	110	6.0	Low	Fair	Fair	Fair	Low	
T9	<i>Leucaena leucocephala</i>	銀合歡	9.0	95	5.0	Low	Poor	Poor	Poor	Low	invasive species
T10	<i>Macaranga tanarius var. tomentosa</i>	血桐	8.0	100	6.0	Low	Fair	Fair	Fair	Low	
T11	<i>Sapium sebiferum</i>	烏桕	5.0	130	5.0	Low	Fair	Fair	Fair	Low	
T12	<i>Leucaena leucocephala</i>	銀合歡	10.0	95	5.0	Low	Poor	Poor	Poor	Low	invasive species
T13	<i>Leucaena leucocephala</i>	銀合歡	10.0	95	4.0	Low	Poor	Poor	Poor	Low	invasive species
T14	<i>Leucaena leucocephala</i>	銀合歡	10.0	120	5.0	Low	Poor	Poor	Poor	Low	invasive species
T15	<i>Leucaena leucocephala</i>	銀合歡	10.0	130	4.0	Low	Poor	Poor	Poor	Low	invasive species
T16	<i>Leucaena leucocephala</i>	銀合歡	10.0	130	5.0	Low	Poor	Poor	Poor	Low	invasive species
T17	<i>Leucaena leucocephala</i>	銀合歡	10.0	130	4.0	Low	Poor	Poor	Poor	Low	invasive species
T18	<i>Leucaena leucocephala</i>	銀合歡	10.0	110	6.0	Low	Poor	Poor	Poor	Low	invasive species
T19	<i>Leucaena leucocephala</i>	銀合歡	10.0	150	4.0	Low	Poor	Poor	Poor	Low	invasive species
T20	<i>Leucaena leucocephala</i>	銀合歡	5.0	220	3.0	Low	Poor	Poor	Poor	Low	invasive species, leaning, topped
T21	<i>Leucaena leucocephala</i>	銀合歡	6.0	210	3.0	Low	Poor	Poor	Poor	Low	invasive species, leaning, topped
T22	<i>Leucaena leucocephala</i>	銀合歡	9.0	130	5.0	Low	Poor	Poor	Poor	Low	invasive species, climber
T23	<i>Leucaena leucocephala</i>	銀合歡	9.0	180	5.0	-	-	Dead	-	-	invasive species, dead tree
T24	<i>Leucaena leucocephala</i>	銀合歡	11.0	350	8.0	Low	Poor	Poor	Poor	Low	invasive species, leaning, decay and wound on trunk
T25	<i>Macaranga tanarius var. tomentosa</i>	血桐	8.0	100	5.0	Low	Fair	Fair	Fair	Low	
T26	<i>Leucaena leucocephala</i>	銀合歡	8.0	120	4.0	Low	Poor	Poor	Poor	Low	invasive species
T27	<i>Leucaena leucocephala</i>	銀合歡	8.0	120	5.0	Low	Poor	Poor	Poor	Low	invasive species
T28	<i>Leucaena leucocephala</i>	銀合歡	9.0	235	5.0	Low	Poor	Poor	Poor	Low	invasive species
T29	<i>Leucaena leucocephala</i>	銀合歡	8.0	170	5.0	Low	Poor	Poor	Poor	Low	invasive species

**Notes: Amenity Value, Form, Health Condition and Structural Condition of trees were obtained by Visual Assessment Only.**

## Appendix III – Photo Records

# General View



General view 01



General view 02

# General View



General view 03



General view 04

# General View



General view 05



General view 06

# General View



General view 07



General view 08

# General View



General view 09

# Photo Records



T1 (Overview)



T3 (Overview)



T4 (Overview)



T5 (Overview)

# Photo Records



T6 (Overview)

2024-10-02



T7 (Overview)

2024-10-02



T8 (Overview)

2024-10-02



T9 (Overview)

2024-10-02

# Photo Records



T10 (Overview)



T11 (Overview)



T12 (Overview)



T13 (Overview)

# Photo Records



T14 (Overview)



T15 (Overview)



T16 (Overview)



T17 (Overview)

# Photo Records



T18 (Overview)



T19 (Overview)



T20 (Overview)



T21 (Overview)

# Photo Records



T22 (Overview)



T23 (Overview)



T24 (Overview)



T24 Decay and wound on trunk

# Photo Records



T25 (Overview)



T26 (Overview)



T27 (Overview)



T28 (Overview)

# Photo Records



T29 (Overview)