

☐Urgent ☐Return receipt ☐Expand Group ☐Restricted ☐Prevent Copy

---

**From:** Info Fotton Ela <[REDACTED]>  
**Sent:** 2025-09-09 星期二 11:07:49  
**To:** tpbpd/PLAND <tpbpd@pland.gov.hk>; [REDACTED]  
**Subject:** RE: Supplemental Information for Application Reference A/NE-KTS/564  
**Attachment:** 2025 Sep 9 - Layout Plan D-01 Rev B.pdf

Dear Sir/Madam,

I write on behalf of the applicant, we hereby confirm that there is no change in the layout of the application site. The site layout remains in accordance with the updated Layout Plan D-01 Rev. B as attached, where the ingress and egress points, along with their respective widths, are clearly indicated.

We further confirm that the operation hours will remain unchanged, continuing to operate 24 hours per day, 7 days a week, including all public holidays.

Should you have any questions, please do not hesitate to contact me.

Regards,

KC LEE

--

---

**Fotton ELA Architects Limited**

Tel.: [REDACTED] Fax: [REDACTED]

Address: Address: [REDACTED]  
[REDACTED]

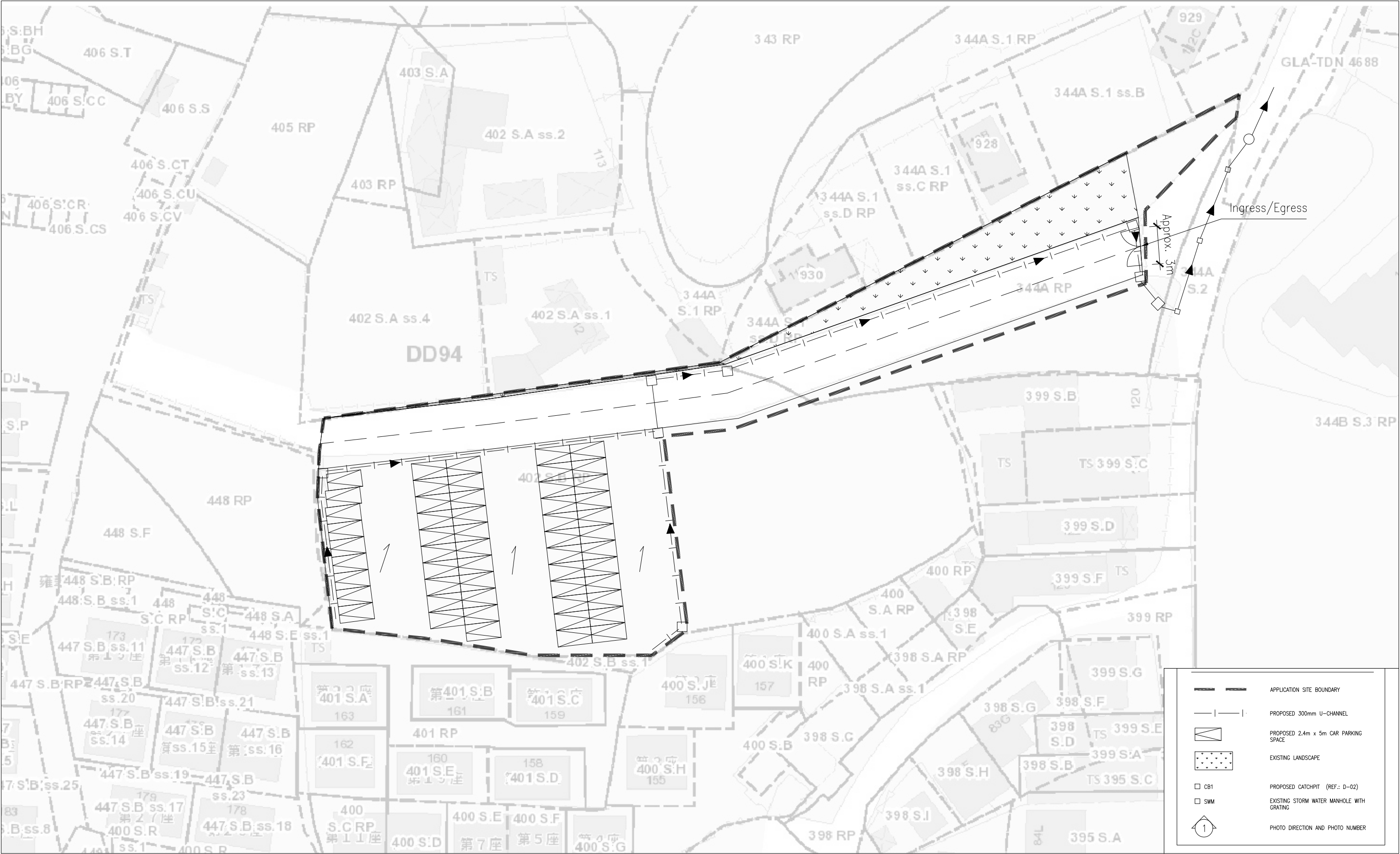

PROJECT PROPOSED TEMPORARY OPEN SPACE CAR PARK AT LOT NOS. 344A RP  
(PART), 402 S.B RP (PART) IN DD94, HANG TAU TAI PO, SHUENG SHUI,  
NEW TERRITORIES

DRAWING TITLE  
PROPOSED LAYOUT PLAN

DRAWING NO. D-01

SCALE 1:500

PROJECT REF.

CAD REF. Z:\Fotton ELA Project\Fotton Project\New Territories\18016999 坑頭大布DD94 LOTS 344A RP 402SB 448RP HANG TAU\2022  
Temp Carpark\Pre Approval\Drawings\drainage plan-3 (3) 2013.dwg

Rev.	Date	Description	Drawn by	Checked by	Approved by
A	07-2023				
B	09-2025				