

LOCATION OF THE APPLICATION SITE

APPLICATION SITE AREA : 853 m<sup>2</sup> (ABOUT)

VEHICULAR ACCESS

ACCESSIBLE FROM HANG TAU ROAD VIA A LOCAL ACCESS

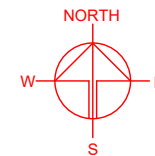

APPLICATION SITE

ACCESSIBLE FROM HANG TAU ROAD VIA A LOCAL ACCESS

SITE BOUNDARY FOR IDENTIFICATION PURPOSE ONLY

LEGEND



APPLICATION SITE

PLANNING CONSULTANT



PROJECT

PROPOSED WAREHOUSE (EXCLUDING DANGEROUS GOODS GODOWN) WITH ANCILLARY FACILITIES AND ASSOCIATED FILLING OF LAND FOR A PERIOD OF 3 YEARS

SITE LOCATION

LOT 424 RP (PART) IN D.D. 94, KWU TUNG SOUTH, SHEUNG SHUI, NEW TERRITORIES

SCALE

1 : 3000 @ A4

DRAWN BY

MN

DATE

19.8.2025

CHECKED BY

DATE

APPROVED BY

DATE

DWG. TITLE

LOCATION PLAN

DWG NO.

PLAN 1

VER.

001



# ZONING OF THE APPLICATION SITE

APPLICATION SITE AREA : 853 m<sup>2</sup> (ABOUT)  
 OUTLINE ZONING PLAN : APPROVED KWU TUNG SOUTH OZP  
 OZP PLAN NO. : S/NE-KTS/22  
 ZONING OF THE SITE : "AGRICULTURE" ("AGR")

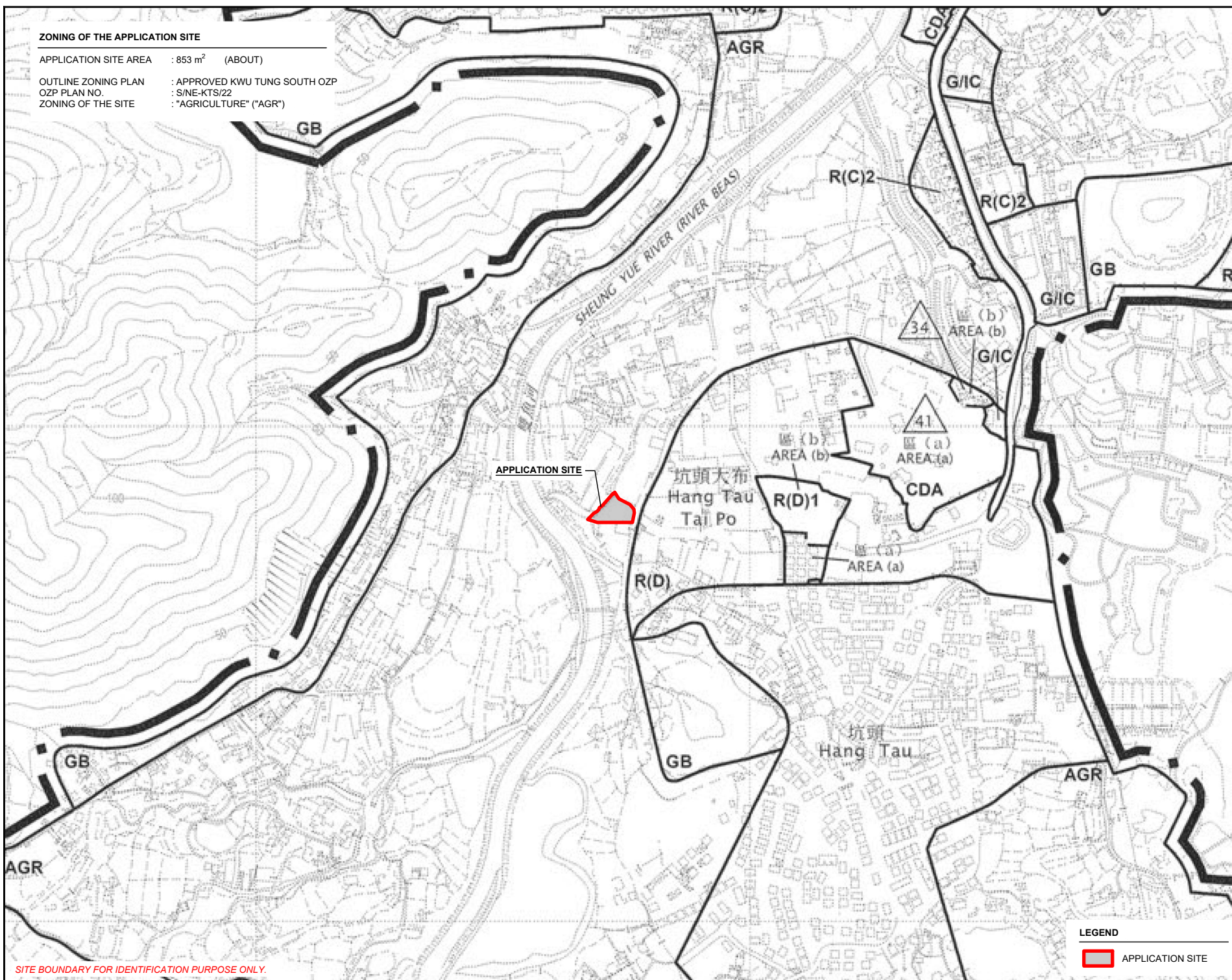
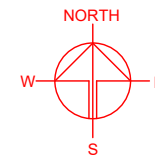

APPLICATION SITE

坑頭大布  
Hang Tau  
Tai Po

區 (b)  
AREA (b)

區 (a)  
AREA (a)

34 區 (b)  
AREA (b)

41 區 (a)  
AREA (a)

CDA

R(D)1

R(D)

坑頭  
Hang Tau

## LEGEND

APPLICATION SITE

PLANNING CONSULTANT



PROJECT

PROPOSED WAREHOUSE (EXCLUDING DANGEROUS GOODS GODOWN) WITH ANCILLARY FACILITIES AND ASSOCIATED FILLING OF LAND FOR A PERIOD OF 3 YEARS

SITE LOCATION

LOT 424 RP (PART) IN D.D. 94, KWU TUNG SOUTH, SHEUNG SHUI, NEW TERRITORIES

SCALE

1 : 5000 @ A4

DRAWN BY

MN

DATE

19.8.2025

CHECKED BY

DATE

APPROVED BY

DATE

DWG. TITLE

ZONING OF THE SITE

DWG NO.

PLAN 2

VER.

001

SITE BOUNDARY FOR IDENTIFICATION PURPOSE ONLY.



# LAND STATUS OF THE APPLICATION SITE

APPLICATION SITE AREA : 853 m<sup>2</sup> (ABOUT)  
 AREA OF PRIVATE LAND : 853 m<sup>2</sup> (ABOUT)  
 AREA OF GOVERNMENT LAND : NOT APPLICABLE

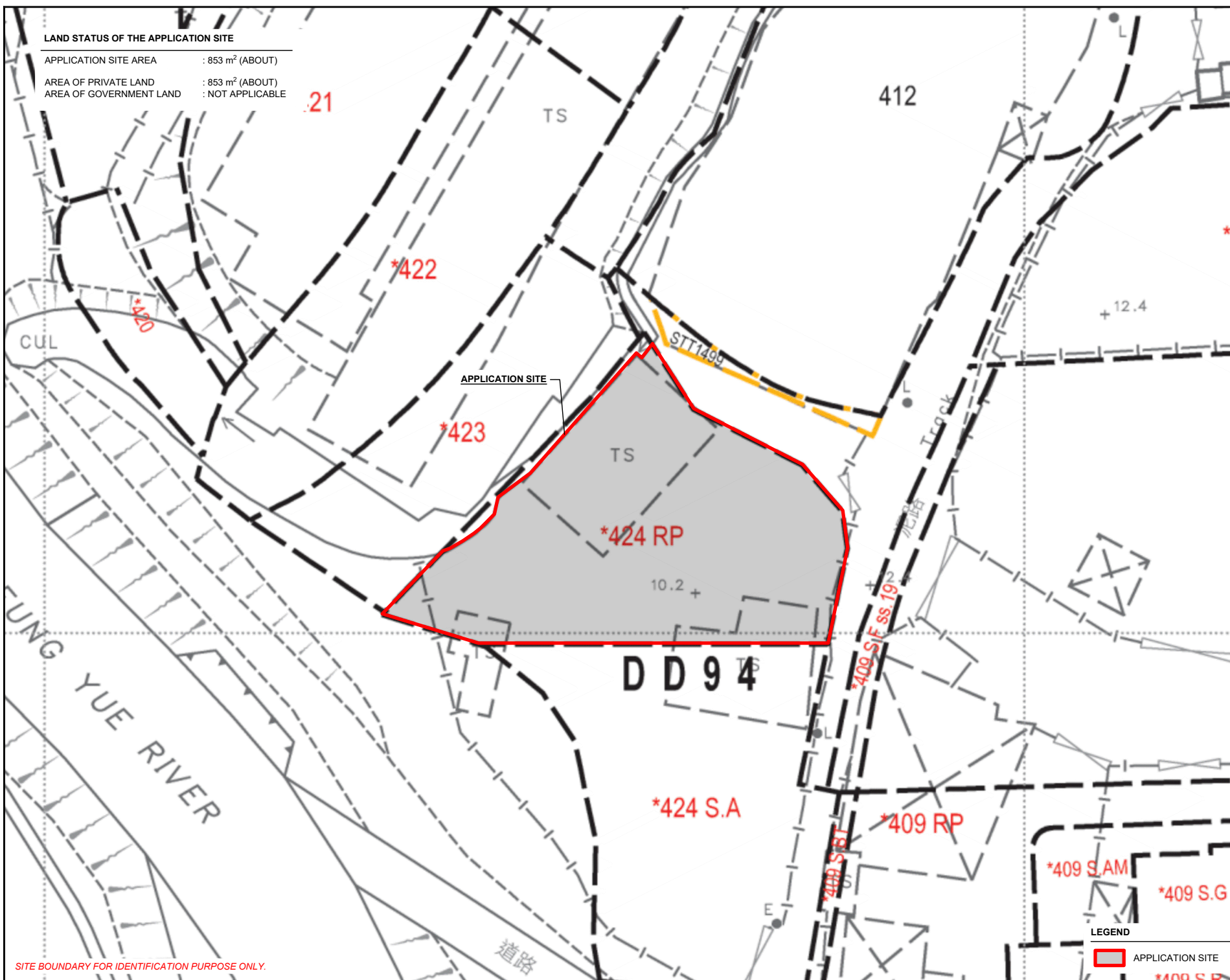
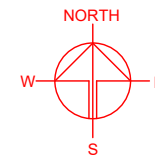

SITE BOUNDARY FOR IDENTIFICATION PURPOSE ONLY.

PLANNING CONSULTANT



PROJECT

PROPOSED WAREHOUSE (EXCLUDING DANGEROUS GOODS GODOWN) WITH ANCILLARY FACILITIES AND ASSOCIATED FILLING OF LAND FOR A PERIOD OF 3 YEARS

SITE LOCATION

LOT 424 RP (PART) IN D.D. 94, KWU TUNG SOUTH, SHEUNG SHUI, NEW TERRITORIES

SCALE

1 : 500 @ A4

DRAWN BY

MN

DATE

19.8.2025

CHECKED BY

DATE

APPROVED BY

DATE

DWG. TITLE

LAND STATUS OF THE SITE

DWG NO.

PLAN 3

VER.

001

LEGEND

APPLICATION SITE

# DEVELOPMENT PARAMETERS

APPLICATION SITE AREA	: 853 m <sup>2</sup>	(ABOUT)
COVERED AREA	: 457 m <sup>2</sup>	(ABOUT)
UNCOVERED AREA	: 396 m <sup>2</sup>	(ABOUT)
PLOT RATIO	: 0.54	(ABOUT)
SITE COVERAGE	: 54 %	(ABOUT)
NO. OF STRUCTURE	: 2	
DOMESTIC GFA	: NOT APPLICABLE	
NON-DOMESTIC GFA	: 457 m <sup>2</sup>	(ABOUT)
TOTAL GFA	: 457 m <sup>2</sup>	(ABOUT)
BUILDING HEIGHT	: 13 m	(ABOUT)
NO. OF STOREY	: 1	

STRUCTURE	USE	COVERED AREA	GROSS FLOOR AREA	BUILDING HEIGHT
B1	WAREHOUSE (EXCLUDING D.G.G.), SITE OFFICE AND WASHROOM	228 m <sup>2</sup> (ABOUT)	228 m <sup>2</sup> (ABOUT)	13 m (ABOUT)(1-STOREY)
B2	WAREHOUSE (EXCLUDING D.G.G.),	229 m <sup>2</sup> (ABOUT)	229 m <sup>2</sup> (ABOUT)	13 m (ABOUT)(1-STOREY)
TOTAL:		457 m <sup>2</sup> (ABOUT)	457 m <sup>2</sup> (ABOUT)	

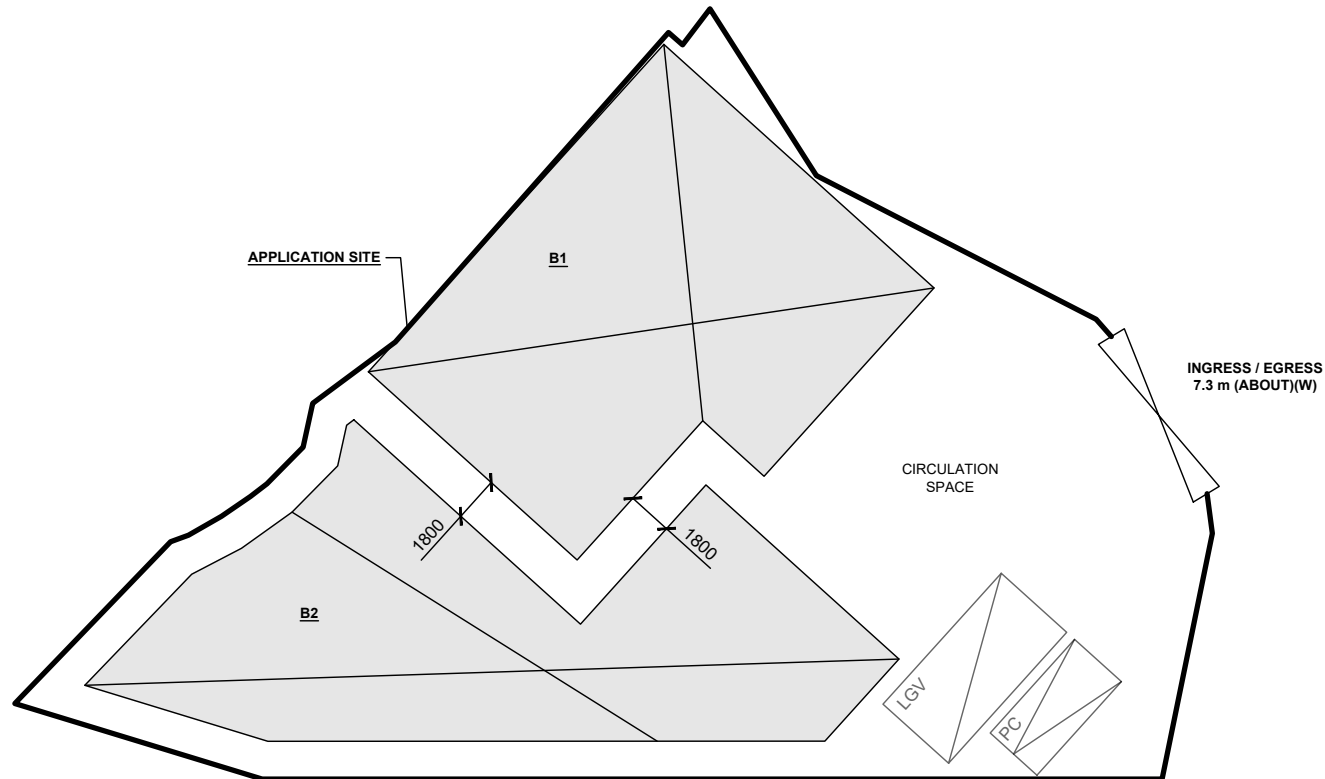
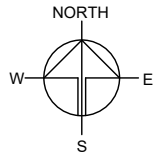

## PARKING AND LOADING/UNLOADING PROVISION

NO. OF PRIVATE CAR PARKING SPACE	: 1
DIMENSION OF PARKING SPACE	: 5 m (L) X 2.5 m (W)
NO. OF LIGHT GOODS VEHICLE PARKING SPACE	: 1
DIMENSION OF LOADING/UNLOADING SPACE	: 7 m (L) X 3.5 m (W)

SITE BOUNDARY FOR IDENTIFICATION PURPOSE ONLY.

## LEGEND

	APPLICATION SITE
	STRUCTURE
	PARKING SPACE (PC)
	LOADING / UNLOADING SPACE (LGV)
	INGRESS / EGRESS

PLANNING CONSULTANT



PROJECT

PROPOSED TEMPORARY  
WAREHOUSE (EXCLUDING  
DANGEROUS GOODS GODOWN)  
WITH ANCILLARY FACILITIES  
AND ASSOCIATED FILLING OF  
LAND FOR A PERIOD OF 3  
YEARS

SITE LOCATION

LOT 424 RP (PART) IN D.D. 94,  
KWU TUNG SOUTH, SHEUNG  
SHUI, NEW TERRITORIES

SCALE

1 : 500 @ A4

DRAWN BY	DATE
MN	19.8.2025
CHECKED BY	DATE
APPROVED BY	DATE
DWG. TITLE	
LAYOUT PLAN	
DWG NO.	VER.
PLAN 4	001

# FILLING OF LAND AREA OF THE APPLICATION SITE

APPLICATION SITE AREA	: 853 m <sup>2</sup>	(ABOUT)
EXISTING FILLED AREA	: 853 m <sup>2</sup>	(ABOUT)
EXISTING SITE LEVEL	: +10.3 mPD	(ABOUT)
DEPTH OF LAND FILLING	: NOT MORE THAN 0.1 m	
MATERIAL OF FILLING OF LAND	: CONCRETE	
PURPOSE OF FILLING OF LAND	: SITE FORMATION OF STRUCTURE CIRCULATION AREA AND PARKING AND LOADING/UNLOADING SPACE	

THE APPLICATION SITE HAS ALREADY BEEN FILLED. NO FURTHER FILLING OF LAND WILL BE CARRIED OUT AT THE SITE DURING THE PLANNING APPROVAL PERIOD.

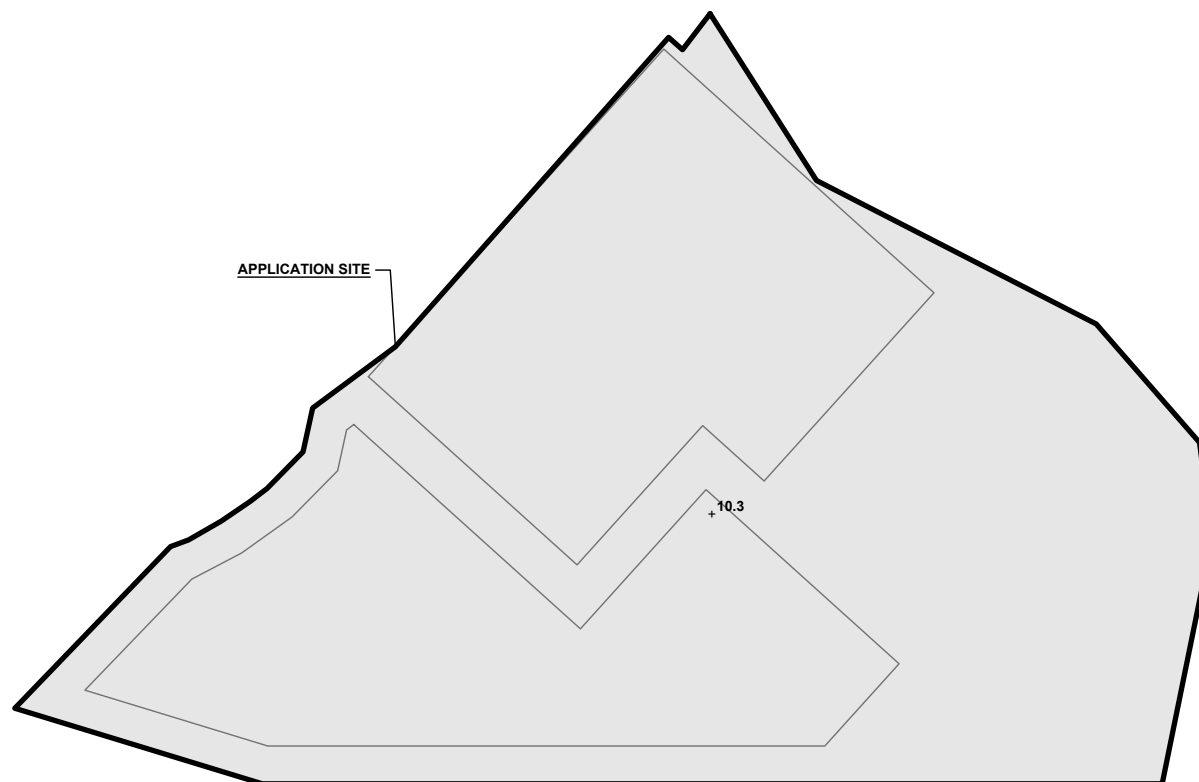

SITE BOUNDARY FOR IDENTIFICATION PURPOSE ONLY.

## LEGEND

	APPLICATION SITE
	LOCATION OF STRUCTURE
	EXISTING HARD-PAVED AREA
	EXISTING SITE LEVEL

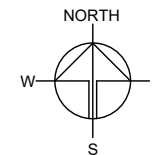

PLANNING CONSULTANT



PROJECT

PROPOSED WAREHOUSE (EXCLUDING DANGEROUS GOODS GODOWN) WITH ANCILLARY FACILITIES AND ASSOCIATED FILLING OF LAND FOR A PERIOD OF 3 YEARS

SITE LOCATION

LOT 424 RP (PART) IN D.D. 94, KWU TUNG SOUTH, SHEUNG SHUI, NEW TERRITORIES

SCALE

1 : 300 @ A4

DRAWN BY	DATE
MN	19.8.2025
CHECKED BY	DATE
APPROVED BY	DATE

DWG. TITLE  
FILLING OF LAND AREA

DWG NO. PLAN 5	VER. 001
-------------------	-------------

# SWEPT PATH ANALYSIS

TYPE OF VEHICLE : LIGHT GOODS VEHICLE  
DIMENSION OF VEHICLE : 2.1 m (W) X 5.2 m (L)  
WIDTH OF XYZ : 7.3 m (ABOUT)

SWEPT PATHS GENERATED BY AUTODESK VEHICLE TRACKING

APPLICATION SITE

INGRESS / EGRESS  
7.3 m (ABOUT)(W)

泥路

FENCING AND GATE  
NO LONGER EXIST

TS

FROM THE LOCAL ACCESS TO  
THE APPLICATION SITE

TS

E

道路

SITE BOUNDARY FOR IDENTIFICATION PURPOSE ONLY.

TS

APPLICATION SITE

INGRESS / EGRESS  
7.3 m (ABOUT)(W)

泥路

FENCING AND GATE  
NO LONGER EXIST

TS

FROM THE APPLICATION SITE  
TO THE LOCAL ACCESS

E

道路

## LEGEND

- APPLICATION SITE
- STRUCTURE
- PARKING SPACE
- LOADING / UNLOADING SPACE
- INGRESS / EGRESS
- LIGHT GOODS VEHICLE
- SWEPT PATH OF VEHICLE

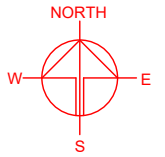

PLANNING CONSULTANT



PROJECT

PROPOSED WAREHOUSE (EXCLUDING DANGEROUS GOODS GODOWN) WITH ANCILLARY FACILITIES AND ASSOCIATED FILLING OF LAND FOR A PERIOD OF 3 YEARS

SITE LOCATION

LOT 424 RP (PART) IN D.D. 94, KWU TUNG SOUTH, SHEUNG SHUI, NEW TERRITORIES

SCALE

1 : 500 @ A4

DRAWN BY

MN

DATE

19.8.2025

CHECKED BY

DATE

APPROVED BY

DATE

DWG. TITLE

SWEPT PATH ANALYSIS (LGV)

DWG NO.

PLAN 6

VER.

001