

# 地段索引圖 LOT INDEX PLAN



地政總署測繪處 Survey and Mapping Office, Lands Department

比例尺 SCALE 1:1 000  
 米 metres 10 0 10 20 30 40 50 metres



Locality : NORTH

Lot Index Plan No. : YL1318062017

District Survey Office : Yuen Long

Date : 29-Jun-2017

Reference No. : 3-NW-25C,3-SW-5A

香港特別行政區政府 — 版權所有

© Copyright reserved - Hong Kong SAR Government

SMO-P01

20170629105856 10

## 免責聲明

本圖則乃地段索引圖的複本，顯示地段界線的大概位置，包括根據政府撥地、臨時政府撥地、短期租約及政府土地租用牌照而臨時佔用土地的位置。臨時佔用土地的情況可憑藉短期通知出現或終止，因此應向有關的分區地政專員核證。本圖則所示的資料必須透過實地測量予以核實。當有更佳或新的地界證據時，地段索引圖可能會被修訂而無須事先通知。

## Disclaimer

This plan is a copy of the lot index plan showing the approximate location of lot boundaries, including the temporary occupation of land under Government Land Allocations, Temporary Government Land Allocations, Short Term Tenancies and Government Land Licences. The temporary occupation of land may be created or terminated at short notice and should be confirmed with the District Lands Officer. The information shown on this plan **MUST** be verified by field survey. The lot index plan may be revised without prior notification as better or new boundary evidence becomes available.

# SITE PLAN

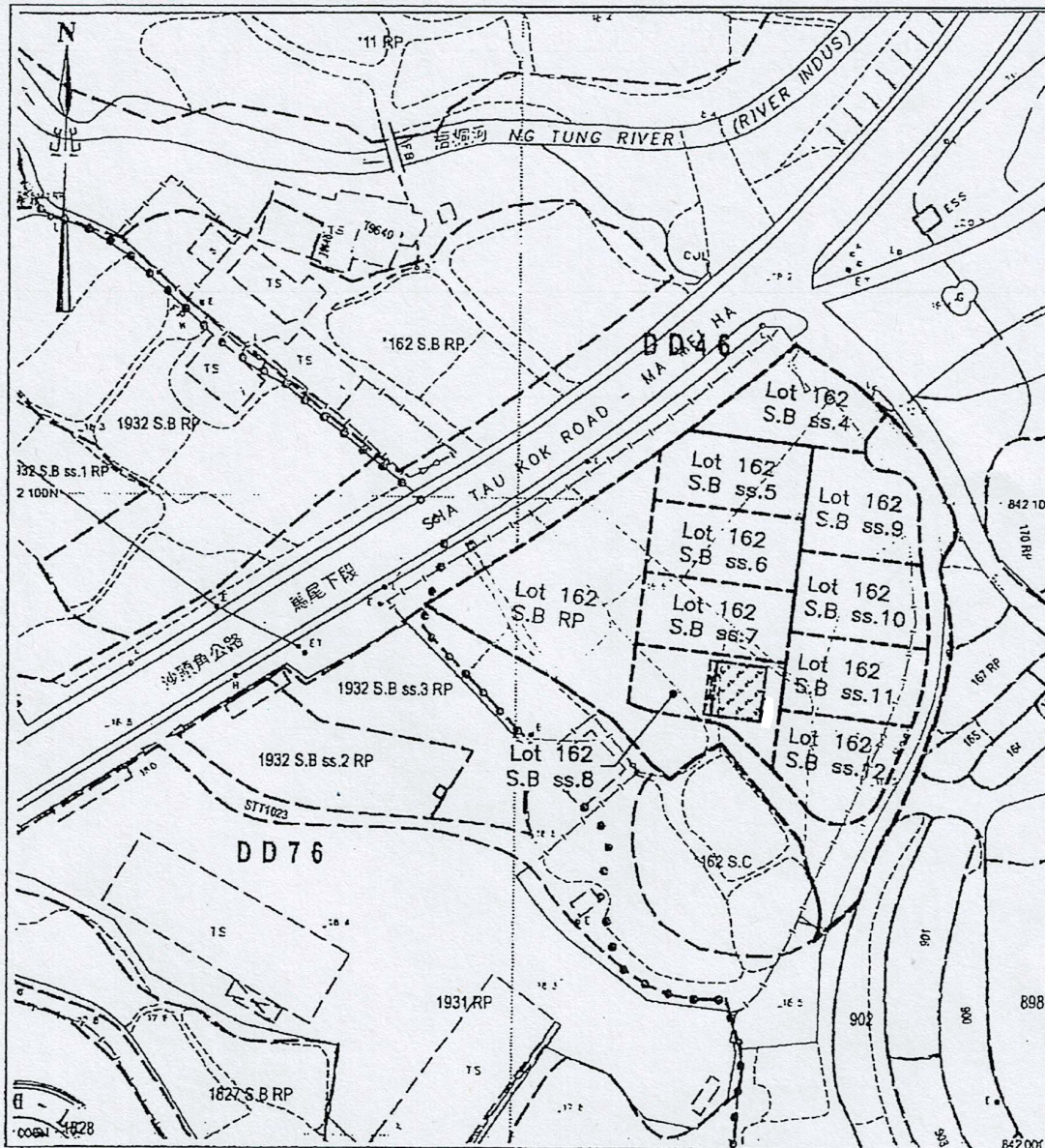

Survey Sheet No. 3-NW-25C

For Identification Purposes Only  
(Scale 1 : 1,000)

## LEGEND



Proposed Small House (7.620m x 8.534m) = 65.03 sq.m (about)



Proposed Balcony (8.534m x 1.220m) = 10.41 sq.m (about)