

<p>Project Title :</p> <p>Proposed Temporary Warehouse for Storage of Construction Materials for a period of 3 years</p>	<p>Scale :</p> <p>1 : 1000</p>	<p>Plan No. :</p> <p>CW/580/90/LOP</p>
<p>Drawing Title :</p> <p>Location Plan (D.D. 90 Lot No. 580)</p>	<p>Date :</p> <p>25-01-2026</p>	<p>Survey Sheet No. :</p> <p>3-NW-17A</p>
<p>卓 弘 測 量 服 務 公 司 CHUO WANG SURVEY SERVICES COMPANY</p>		

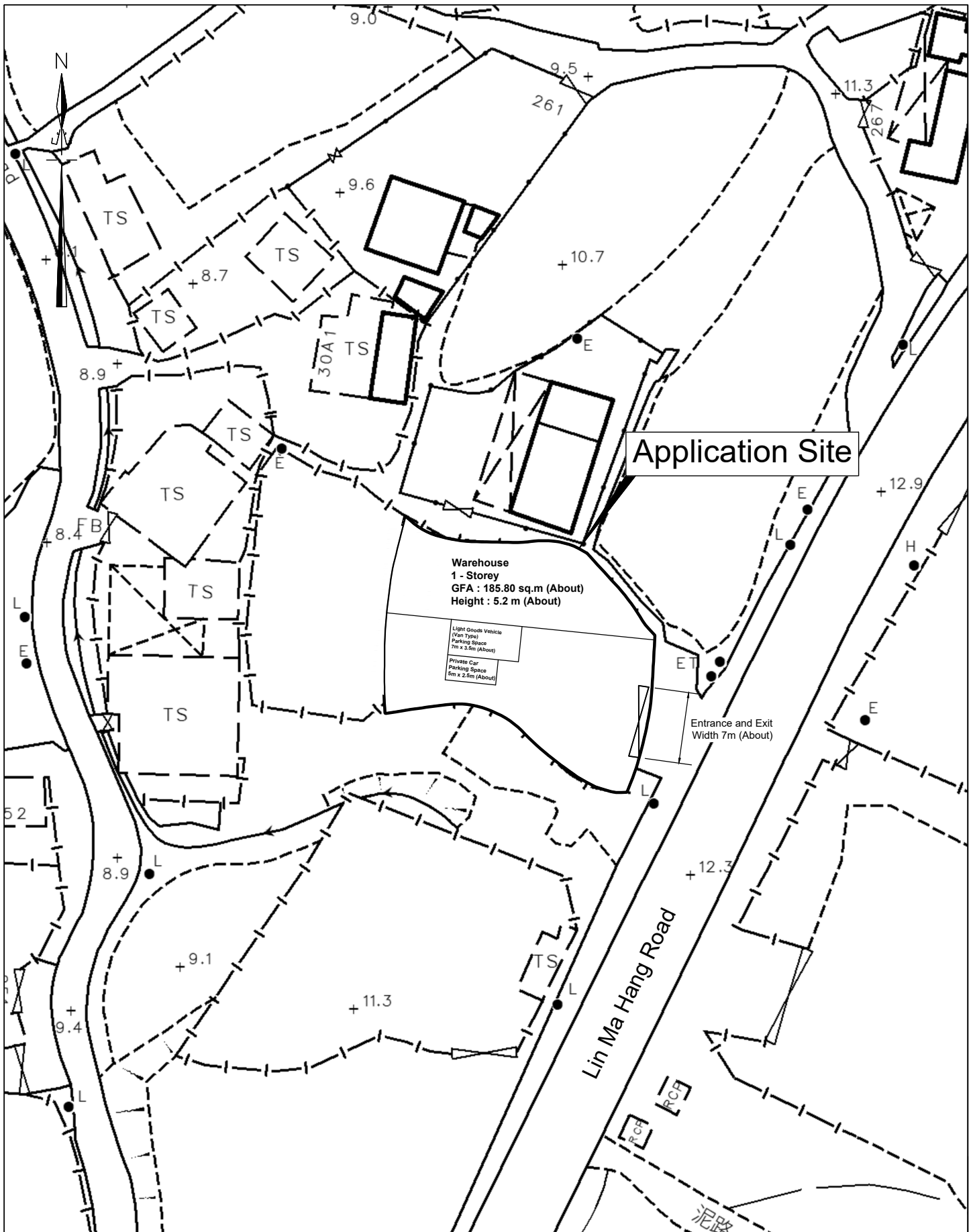

<p>Project Title :</p> <p>Proposed Temporary Warehouse for Storage of Construction Materials for a period of 3 years</p>	<p>Scale :</p> <p>1 : 500</p>	<p>Plan No. :</p> <p>CW/580/90/LOP</p>
<p>Drawing Title :</p> <p>Layout Plan (D.D. 90 Lot No. 580)</p>	<p>Date :</p> <p>25-01-2026</p>	<p>Survey Sheet No. :</p> <p>3-NW-17A</p>
<p>卓 弘 測 量 服 務 公 司 CHUO WANG SURVEY SERVICES COMPANY</p>		

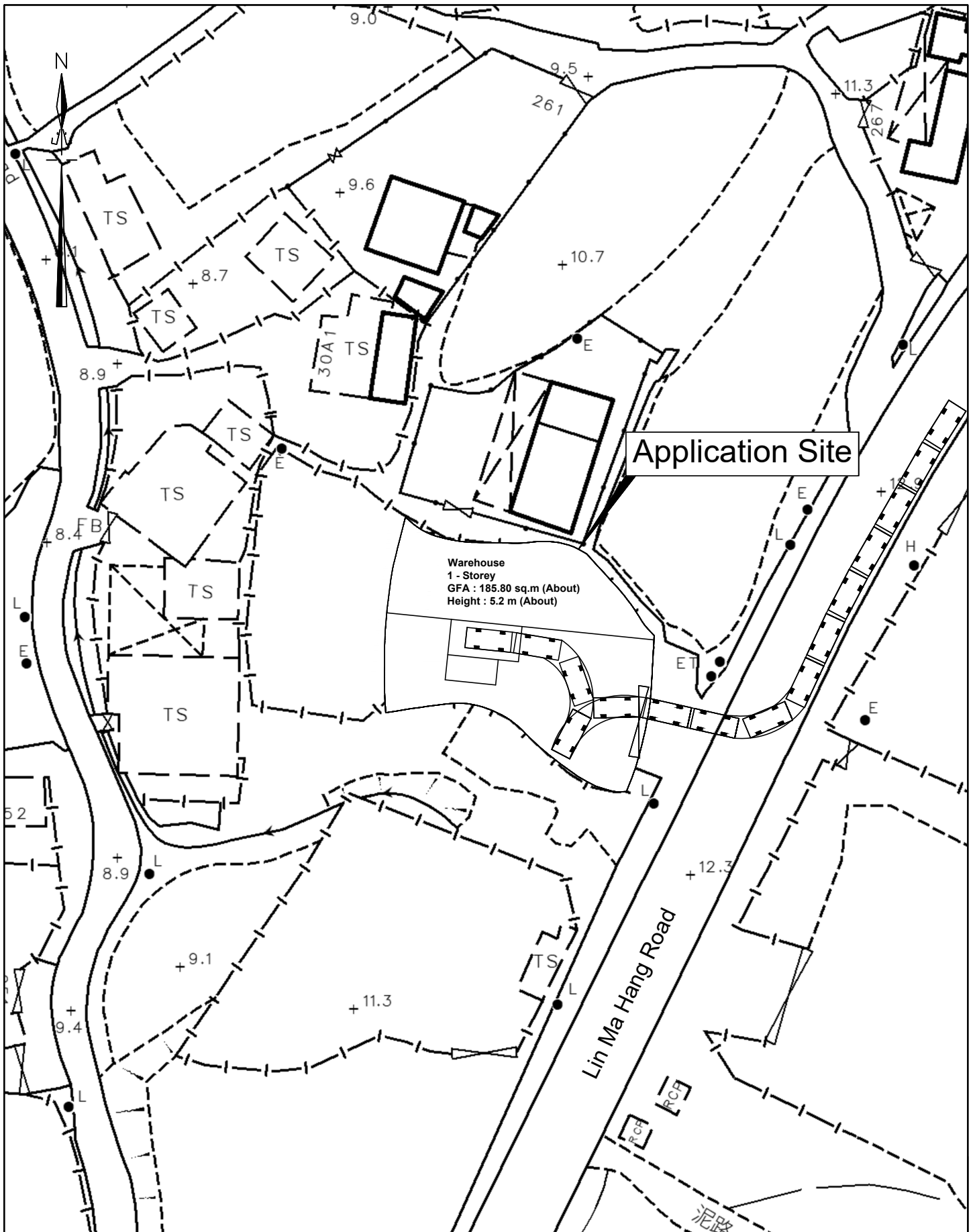

Project Title : Proposed Temporary Warehouse for Storage of Construction Materials for a period of 3 years	Scale : 1 : 500	Plan No. : CW/580/90/VRP1
Drawing Title : Vehicle Routing Plan (D.D. 90 Lot No. 580)	Date : 25-01-2026	Survey Sheet No. : 3-NW-17A
卓 弘 測 量 服 務 公 司 CHUO WANG SURVEY SERVICES COMPANY		

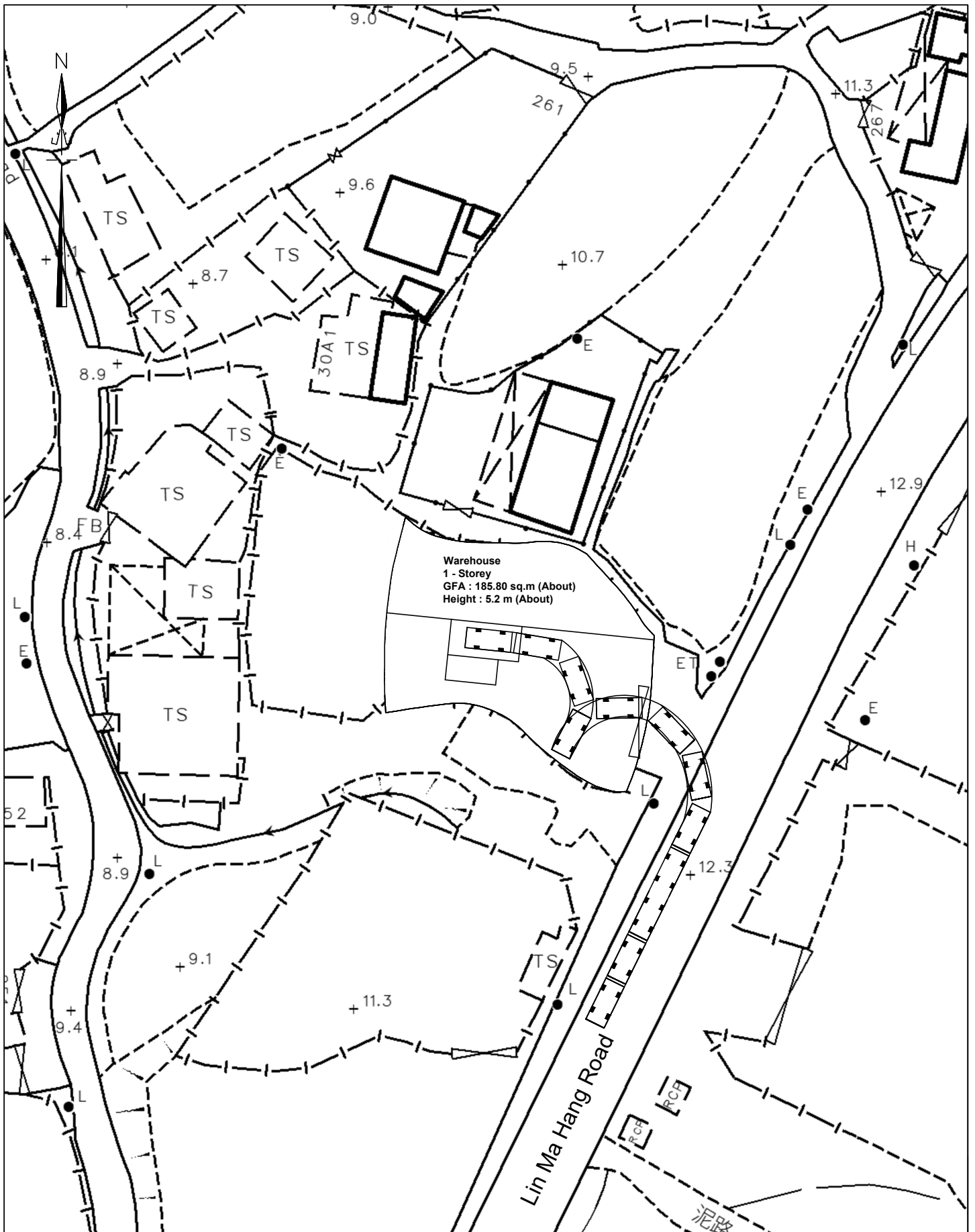

Project Title :

Proposed Temporary Warehouse for Storage of Construction Materials
for a period of 3 years

Drawing Title :

Vehicle Routing Plan (D.D. 90 Lot No. 580)

Scale :

1 : 500

Date :

25-01-2026

Plan No. :

CW/580/90/VRP2

Survey Sheet No. :

3-NW-17A

卓 弘 測 量 服 務 公 司
CHUO WANG SURVEY SERVICES COMPANY