

Extracted from Approved Man Kam To Outline Zoning Plan No. S/NE-MKT/7

| | | |
|---------------------|----------------------------------|--|
| <p>Not to scale</p> | <p>Location Plan</p> | <p>Goldrich Planners & Surveyors Ltd.</p> |
| <p>March 2026</p> | <p>Lots 479 and 480 in DD.90</p> | <p>Plan 1 (P 26019)</p> |

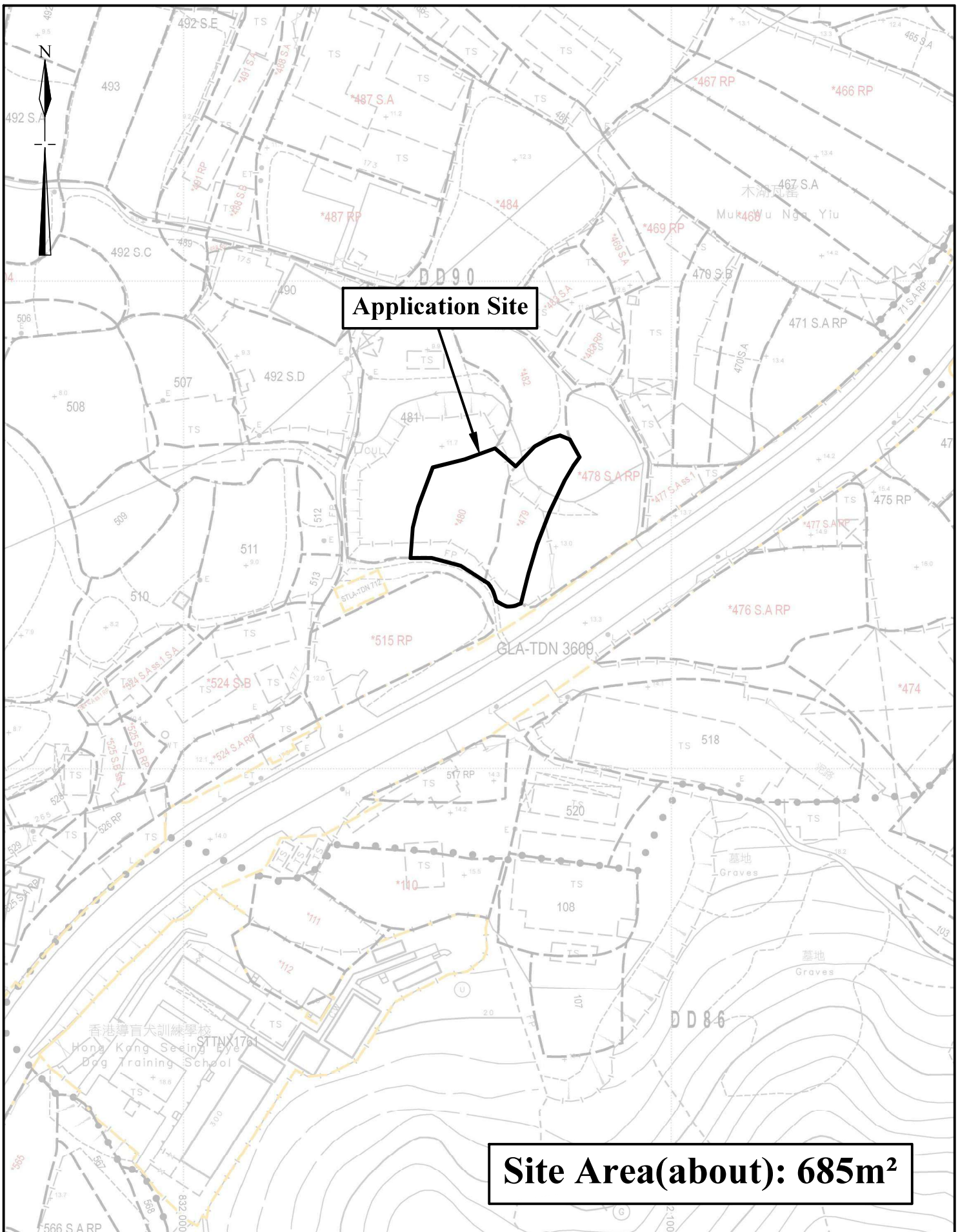

Application Site

Site Area(about): 685m²

| | | |
|--------------------------|---|--|
| <p>1:1000</p> | <p>Lot Index Plan</p> | <p>Goldrich Planners & Surveyors Ltd.</p> |
| <p>March 2026</p> | <p>Lots 479 and 480 in DD.90</p> | <p>Plan 2 (P 26019)</p> |



Application Site

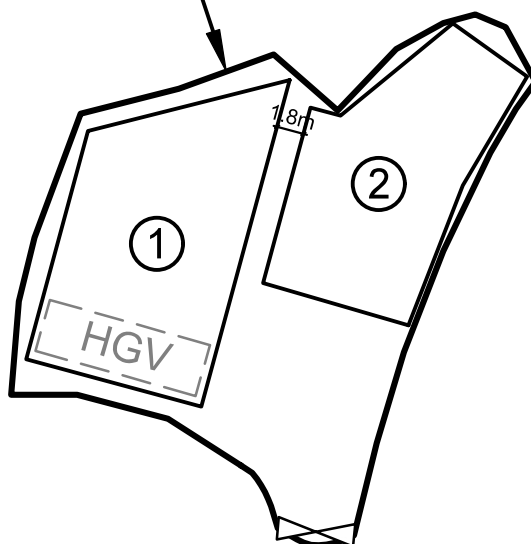

Legend

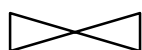

Vehicular Ingress/ Egress



Parking space for heavy goods vehicle
(11m (L) x 3.5m (W))

Site Area(about): 685m²

| No. | Uses | Floor Area (about) | Covered Area (about) | Storeys | Height |
|--------------|------------------|--------------------------|--------------------------|---------|--------|
| 1 | Warehouse | 228 m ² | 228 m ² | 1 | 9m |
| 2 | Ancillary Office | 185 m ² | 185 m ² | 1 | 9m |
| Total | | <u>413 m²</u> | <u>413 m²</u> | | |

1:500

Layout Plan

**Goldrich Planners &
Surveyors Ltd.**

March 2026

Lots 479 and 480 in DD.90

**Plan 3
(P 26019)**

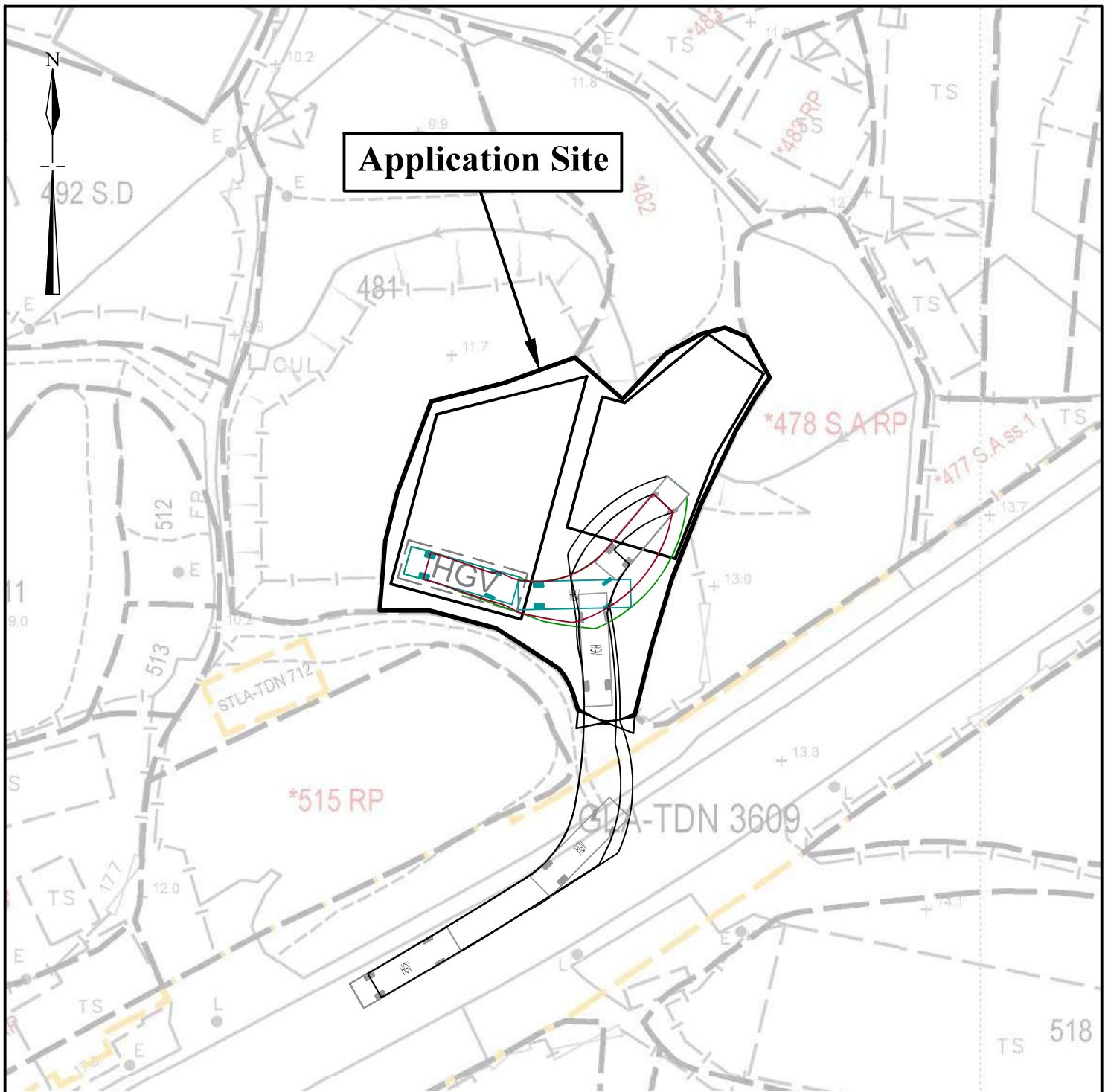

Legend



Vehicular Ingress/ Egress



Parking space for heavy goods vehicle
(11m (L) x 3.5m (W))



Heavy goods vehicle
(7m (L) x 3.5m (W))

1:500

Swept Path Analysis

Goldrich Planners &
Surveyors Ltd.

March 2026

Lots 479 and 480 in DD.90

Plan 4
(P 26019)

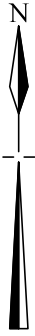

Application Site

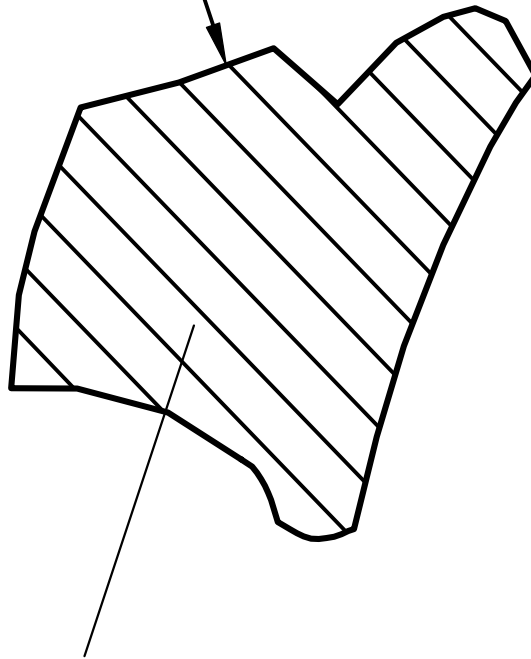

The site is proposed to be filled with concrete of about 1.3m in depth for erection of structures and vehicle maneuvering.

N.T.S

Plan Showing Proposed Filling of Land

Goldrich Planners & Surveyors Ltd.

June 2026

Lots 479 and 480 in DD.90

**Plan 5
(P 26019)**