

Attachment 5 - Response-to-Comments Table

No.	Comments	Responses
1	<p>Drainage Services Department (DSD), dated 15.4.2025</p> <p>(a) Cross-sections under the Appendix A refer. Please indicate the proposed drainage facilities in the cross-section views for our reference. Also, please clarify if hoarding will be erected along the site boundary, which may affect the passing of overland flow. Besides, the proposed formation profile under Section A is missing, please supplement.</p> <p>(b) Please review if the future ground level indicated in the cross-section view align with the level indicated in the "filling of land plan". For example, the proposed formation level in Section B within the application site is below 15mPD, however, it is indicated as around 16.9mPD in the Plan 5. As reflected in Appendix D, the runoff from the catchment area to the south of the application site shall flow through the application site, please ensure the formation land and corresponding drainage facilities would cater such purpose.</p> <p>(c) The existing underground drain DN900 indicated in Appendix B and H is not DSD's facility. You shall properly maintain the section within the application site to ensure its normal operation to convey the flow from the eastern catchment area.</p> <p>(d) Appendix H photo VP7 and VP8 refer. Please validate if it's dimension is aligned with your assumption in the calculation. Also, overgrown vegetation is observed at the discharge point, please carry out regular clearance works to ensure smooth flow path.</p>	<p>(a) Noted. Proposed drainage facilities have been shown in revised drawings of Appendix A Master Layout Plan for your easy reference. Chaining fence / garden wood barrier will be used to define site boundary of this development. There is a gap (i.e. at least 20mm) between chaining fence / garden wood barrier and finished ground surface. This allows overland flow passing through. Under Section A, the proposed formation profile is same as existing ground profile. The ground surface material will be partially filled from soil to concrete.</p> <p>(b) Noted. The levels shown on the Filling of Land Plan (Plan 5) in Appendix A Master Layout Plan have been reviewed and updated. Applicant will ensure the formation land and corresponding drainage facilities would cater such purpose.</p> <p>(c) Noted. Applicant will closely coordinate with nearby villagers to ensure its normal operation to convey the flow from the eastern catchment area. If any blockage of existing underground drain DN900 identified, Applicant / nearby villagers will take necessary action to remove the blockage.</p> <p>(d) Topographical survey has been carried out. River bank level, river invert level and river alignment have been incorporated into site layout. River dimension is aligned with our design assumption. Details refer to topographical survey drawings for that area in Appendix H Site Photos and Topographical Survey. Noted. Applicant will carry out regular clearance works to ensure smooth flow</p>

	<p>(e) Para 5.2.1 refers. You shall devise adequate temporary drainage arrangement and flood relief measures during construction stage, particularly while the drainage facilities were being implemented, to ensure no adverse drainage impacts would be induced to the adjoining areas.</p>	<p>path.</p> <p>(e) Noted. Adequate temporary drainage arrangement and flood relief measures during construction stage have been added in revised report. Details refer to Section 6 of revised DIA report.</p>
--	---	--

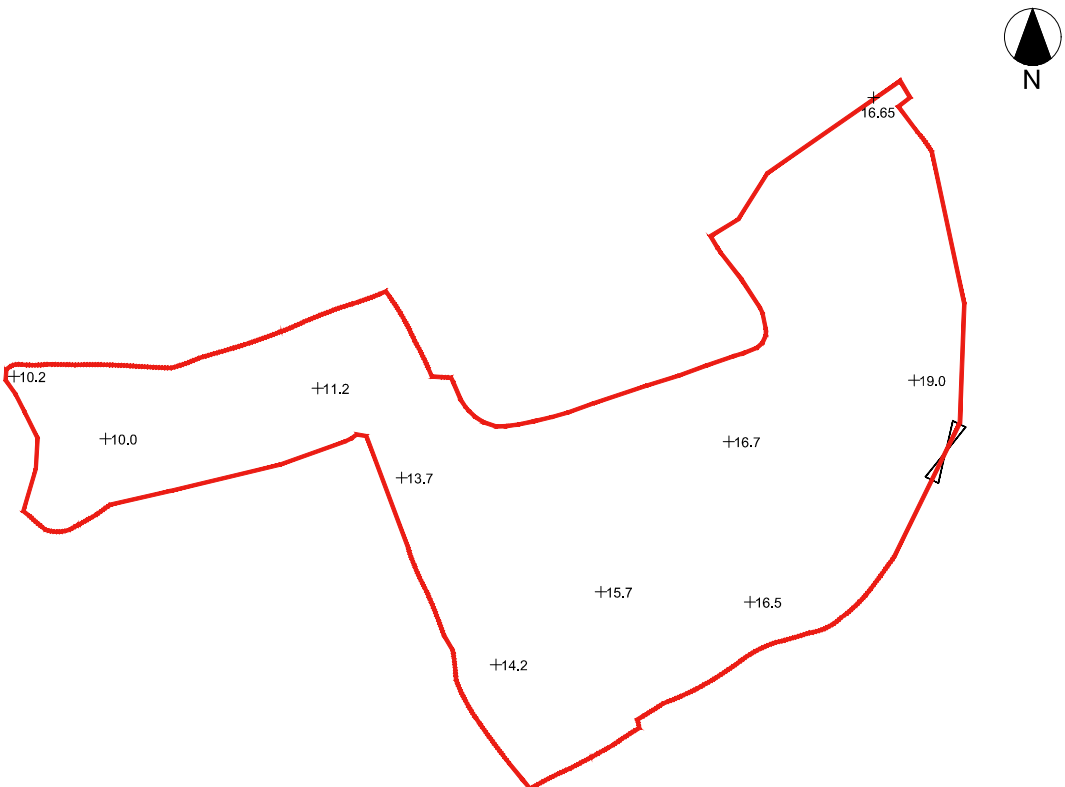

EXISTING SITE LEVEL

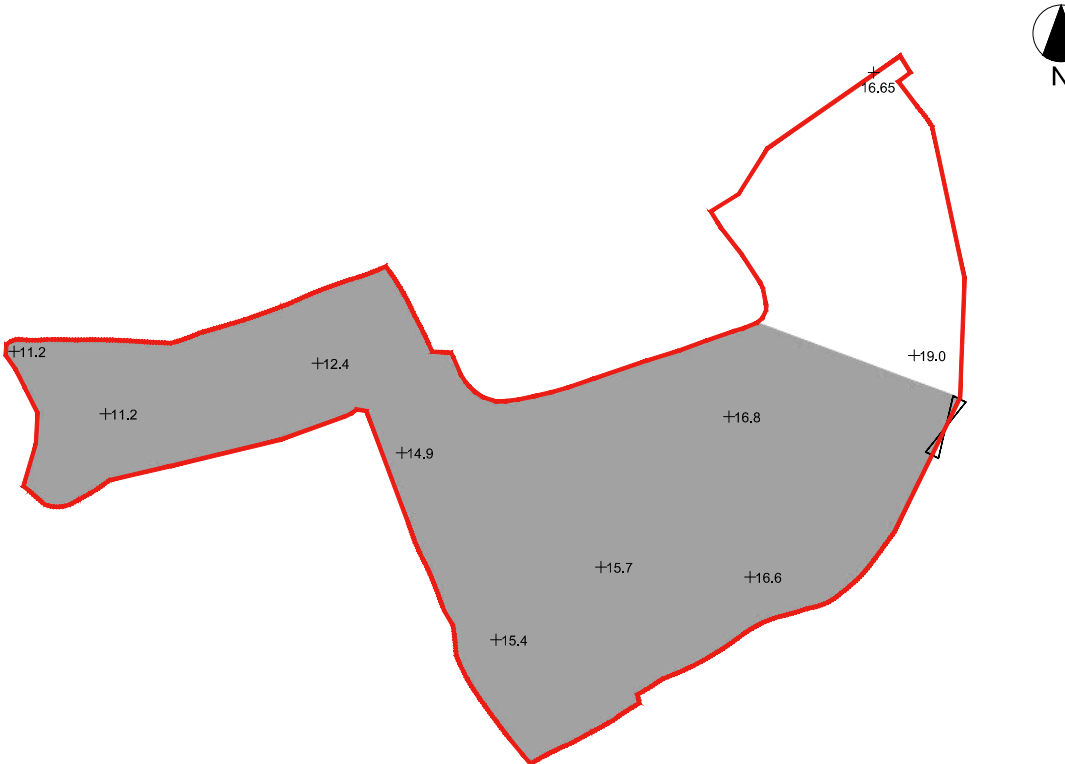

PROPOSED SITE LEVEL

PROPOSED FILLING OF LAND AREA OF THE APPLICATION SITE

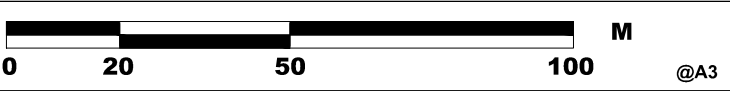

APPLICATION SITE AREA	: ABOUT 7,978 m ²
PROPOSED FILLING OF LAND AREA	: ABOUT 7,978 m ²
LAND FILLING DEPTH	: NOT MORE THAN 1.2 m
PROPOSED SITE LEVELS	: +11.2 mPD TO +19 mPD

SITE BOUNDARY FOR IDENTIFICATION PURPOSE ONLY.



- ALL DIMENSIONS ARE IN MILLIMETER EXCEPT OTHERWISE NOTED
- DO NOT SCALE DRAWING

LEGEND

-  APPLICATION SITE
-  + 10.0 PROPOSED SITE LEVEL
-  PROPOSED FILL UP

D	SITE LEVEL REVISED	17 APR 2025
C	SITE BOUNDARY REVISED	31 MAR 2025
B	SITE BOUNDARY REVISED	18 FEB 2025
A	SITE BOUNDARY REVISED	17 OCT 2024
-	FILLING OF LAND PLAN	23 AUG 2024

REVISION		
	name	
drawn	CL & LY	DATE 23 AUG 2024
checked	-	DATE -
approved	-	DATE -
contract no. -		
project no.		
TITLE :		
PROPOSED TEMPORARY PLACE OF RECREATION, SPORTS AND CULTURE (HOBBY FARM) FOR A PERIOD OF 3 YEARS AND ASSOCIATED FILLING OF LAND		

SITE LOCATION :		
VARIOUS LOTS IN D.D. 96, SHUN YEE SAN TSUEN, MA TSO LUNG, NEW TERRITORIES		
drawing title.		
FILLING OF LAND PLAN		
drawing no.	rev.	scale
PLAN 5	D	N.T.S.