

☐Urgent ☐Return receipt ☐Expand Group ☐Restricted ☐Prevent Copy ☐Confidential

William Shu Tai WONG/PLAND

寄件者: SammyYC LI [REDACTED]
寄件日期: 2025年12月18日星期四 14:09
收件者: William Shu Tai WONG/PLAND
主旨: Re: Application No. A/NE-MUP/226 - Temporary Public Utility Installation (Solar Photovoltaic System)
附件: 092000047825Acknowledgement Letter_82868503180_20250609145847.pdf; A_NE-MUP_226_Plan.pdf

類別: Internet Email

致 William WONG

終於找到了

李智濤上

09 June 2025

Attention:

CLP Electricity :
Account Number

Application No. :

Please quote our application number whenever you correspond with us about this application

Dear

**CLP Renewable Energy Feed-in Tariff (FiT) Scheme – Application Acknowledgement Letter
Renewable Energy System at DD 81 LOT 37 SBSS1, SHA TAU KOK ROAD, WO HANG, SHA TAU
KOK with a Total Generation Capacity of 10.00 kW**

Thank you for your application to take part in CLP Renewable Energy Feed-in Tariff (FiT) Scheme. This is a major community initiative to promote renewable energy in Hong Kong and we greatly appreciate your support.

We received your FiT Application Form and all the preliminary supporting documents on 03 February 2025. Please be advised that the renewable energy system referred to in your application will be considered as a single system with a total generation capacity of 10.00 kW.

Your provisional FiT rate, following the prevailing rate published on our website on 03 February 2025, is set out below together with the validity period of each FiT rate:

Renewable energy system	Generation capacity (kW)	Provisional FiT rate (\$/kWh)	Validity period (expiry date)
New solar system at DD 81 LOT 37 SBSS1, SHA TAU KOK ROAD, WO HANG, SHA TAU KOK, NEW TERRITORIES	10.00 (Three-phase)	4.00	9 months (expire on 08 March 2026)

If you cannot complete your application by the above expiry date, your FiT rate will follow the prevailing rate published on our website at the time when your application is completed.

We will conduct a technical assessment of your FiT Scheme application. Please refer to the attachment and submit the supplementary information required.

Please be reminded that the design, installation, operation and maintenance of your renewable energy system should comply with all applicable laws, regulations, guidelines, and safety and technical requirements. This includes compliance with the requirements set out under the Technical Guidelines on Grid Connection of Renewable Energy Power Systems and the Guidance Notes for Solar Photovoltaic (PV) System Installation, both issued by the Electrical and Mechanical Services Department ("EMSD").

We would also like to remind you that, according to the FiT Scheme Terms and Conditions, all the electricity generated by the renewable energy system under the Scheme will be sold to CLP and

Scheme participants are restricted in claiming emissions reduction benefits that may arise from the renewable energy system. Scheme participants who wish to claim emissions reduction benefits may consider purchasing CLP Renewable Energy Certificates. Please contact your Account Manager for details.

Thank you once again for supporting this meaningful scheme to encourage the use of green energy in Hong Kong. If you have any questions, please do not hesitate to contact your Account Manager, Lam, Hon Sing on [REDACTED]

Yours sincerely,

CLP Power Hong Kong Limited

Note: This is a computer printout letter that requires no signature.

FiT Scheme Technical Assessment Guidance Notes

Please read and follow these instructions to submit the required documents and install and test your renewable energy system so as to complete your FiT Scheme application.

1. We will send you an email to inform you of the documents you need to submit for review. Please submit the required documents as instructed in the email.
2. Once we have received the required documents, we will give you the contact information of the CLP engineer assigned to your FiT Scheme application.
3. The CLP engineer will advise you with respect to the design of your renewable energy system and the associated electrical installations, when necessary, to ensure compliance with CLP's technical requirements.
4. Once your FiT Scheme application has been fully reviewed, the CLP engineer will inform you of the review result. Based on the result and our recommendations, you may then start the installation of your renewable energy system. In order to ensure that your renewable energy system and the associated electrical installations comply with CLP's technical requirements, **we recommend you not to start installing your renewable energy system until you have been notified of the review result.**
5. After you have completed the installation of your renewable energy system, you are required to submit the Test and Commissioning (T&C) report and FiT Project Cost Form to the CLP engineer.
6. If the T&C report is accepted, the CLP engineer will witness on-site tests of your renewable energy system accordingly. You should employ and arrange a qualified registered electrical contractor to conduct the required tests and submit the signed work completion certificate (Form WR1) to us.
7. We will issue a Completion Letter to you if all required tests have been completed and we agree for the renewable energy system to be connected to the CLP network. The Completion Letter will confirm the FiT rate applicable to your renewable energy system and the commencement date and end date of the FiT Scheme agreement.

Note:

- The renewable energy system shall not be connected to the CLP network until all required tests have been completed to our satisfaction and in accordance with the FiT Scheme Terms and Conditions and any applicable safety and technical requirements.
- Upon request from the Government, we will ask you to provide copies of any available supporting documents (such as invoices) for the project cost information provided in the FiT Project Cost Form. By providing the information to us, you consent to us passing the information to the Government for data analysis purposes.

If you have any questions regarding technical requirements, please do not hesitate to contact Ms. Lee Tang Fong on [REDACTED]

太陽能板 30 塊

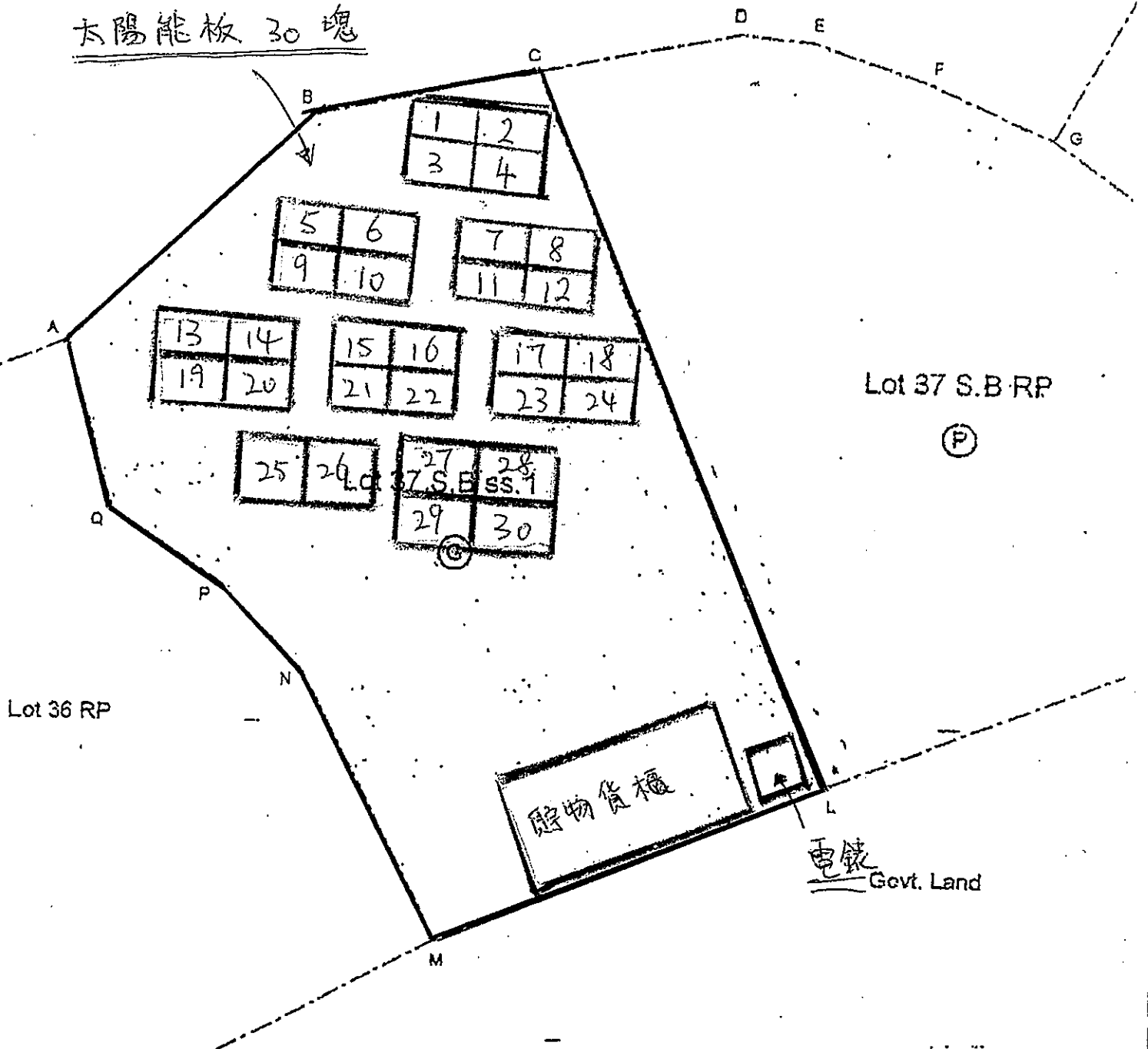

D.D.81 Lot 37 S.B S.S.1 平面圖

擬議公用事業設施裝置 (太陽能光伏系統)
連附屬存放相關的維修零件及工具設施 (為期三年)

註: 每塊太陽能板 $(1.7 \times 1.3 \text{ m}) = 2.21 \text{ m}^2$

電錶 $(0.6 \times 0.6 \text{ m}) = 0.36 \text{ m}^2$

貨櫃 $(6 \times 2.4 \text{ m}) = 14.4 \text{ m}^2$

繪圖者: 申請人
李智濤

日期: 2025-11-24

太陽能板共30塊, 總面積為 $30 \times 2.21 \text{ m}^2 = 66.3 \text{ m}^2$

[Signature]

地段索引圖 LOT INDEX PLAN

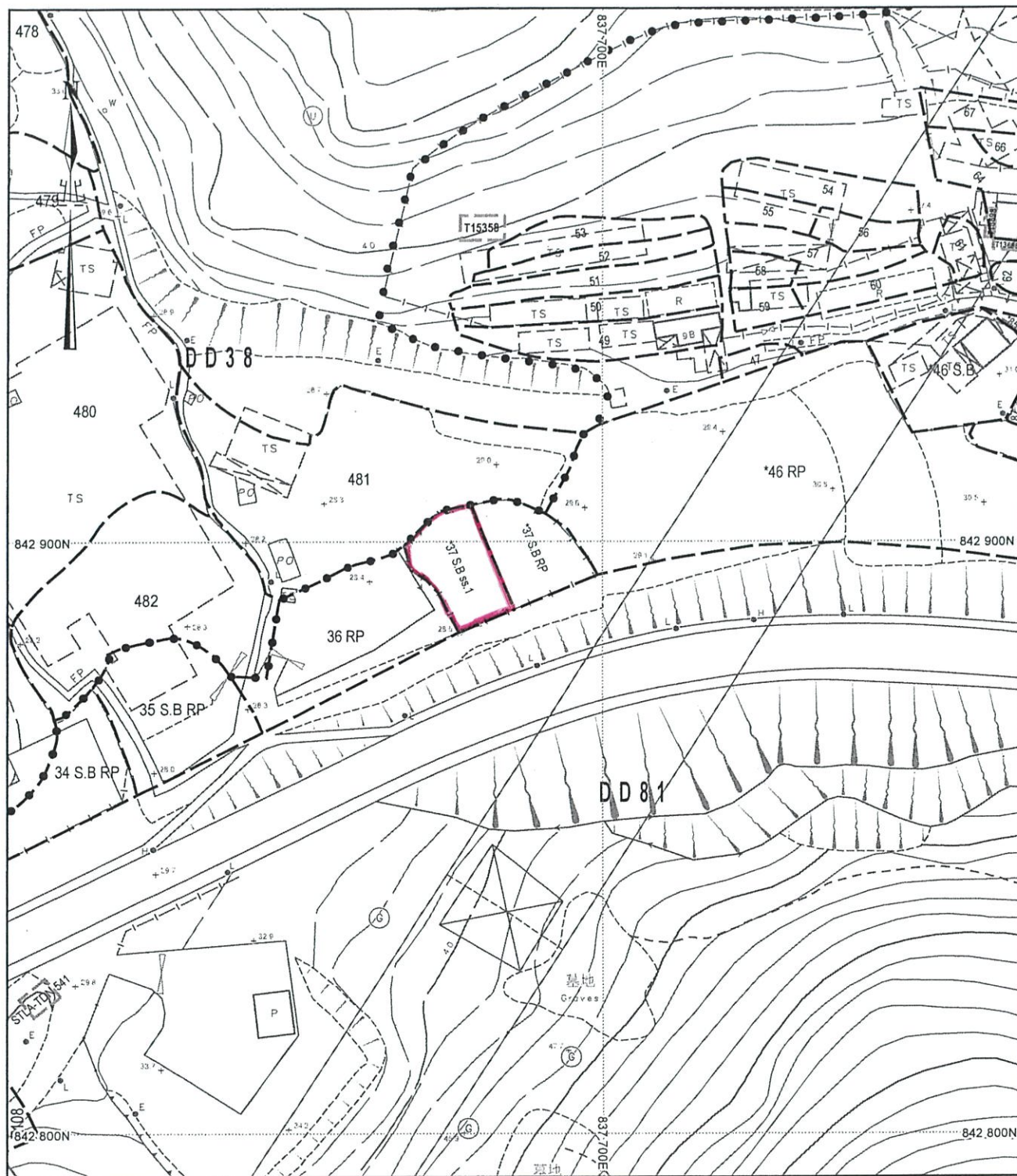

地政總署測繪處 Survey and Mapping Office, Lands Department

比例尺 SCALE 1:1000



Locality : _____

Lot Index Plan No. : LIP1642748P

District Survey Office : DSOYL

Date : 20-Oct-2025

Reference No. : 3-NE-21A

香港特別行政區政府 — 版權所有
© Copyright reserved - Hong Kong SAR Government
SMO-P01 20251020111842 10

摘要說明：本地段索引圖在其背景的地形圖上標示了各種永久和短期持有的土地的圖像界線。這些土地包括私人地段、政府撥地、短期租約批地，以及其他作核准用途的土地。請注意：(1)本索引圖上的資料會被不時更新而不作事先通知；(2)索引圖的更新或會延後於有關資料的實際變更；以及(3)本索引圖中顯示的界線僅供識別之用，資料是否準確可靠，應徵詢專業土地測量師的意見。
免責說明：如因使用本地段索引圖，或因所依據的本索引圖資料出錯、遺漏、過時或有誤差而引致任何損失或損害，政府概不承擔任何法律責任。

Explanatory notes : This plan shows the graphical boundaries of different kinds of permanent and temporary land holdings with the topographic map in the backdrop. The land holdings as shown may include private lots, government land allocations, short term tenancies and other permitted uses of land. It must be noted that: (1) the information shown on this plan is subject to update without prior notification; (2) there may be time lag between an update and the related changes taken place; and (3) the graphical boundaries as shown are for identification purpose only and interpretation of their accuracy and reliability requires the advice from professional land surveyor.
Disclaimer : The Government shall not be responsible for any loss or damage howsoever arising from the use of this plan or in reliance upon its correctness, completeness, timeliness or accuracy.