

Structure 1,
tools storage units
GFA: about 15 sqm
Height: about 2.6m
No.of storey: 1

Structure 2,
Toilets units and portable drinking
water point
GFA: about 15 sqm (total)
Height: about 2.6m
No.of storey: 1

Private Car Parking Spaces

26 parking spaces of 5mx 2.5m
for private car
4 parking spaces of 7.5mx3.2m
for Van
2 parking spaces of 5m x 3.8m
for disabled

**Field
study/Education/Visitor
Centre activities area**

(A) 1600 sq metres
Lot 404 SB

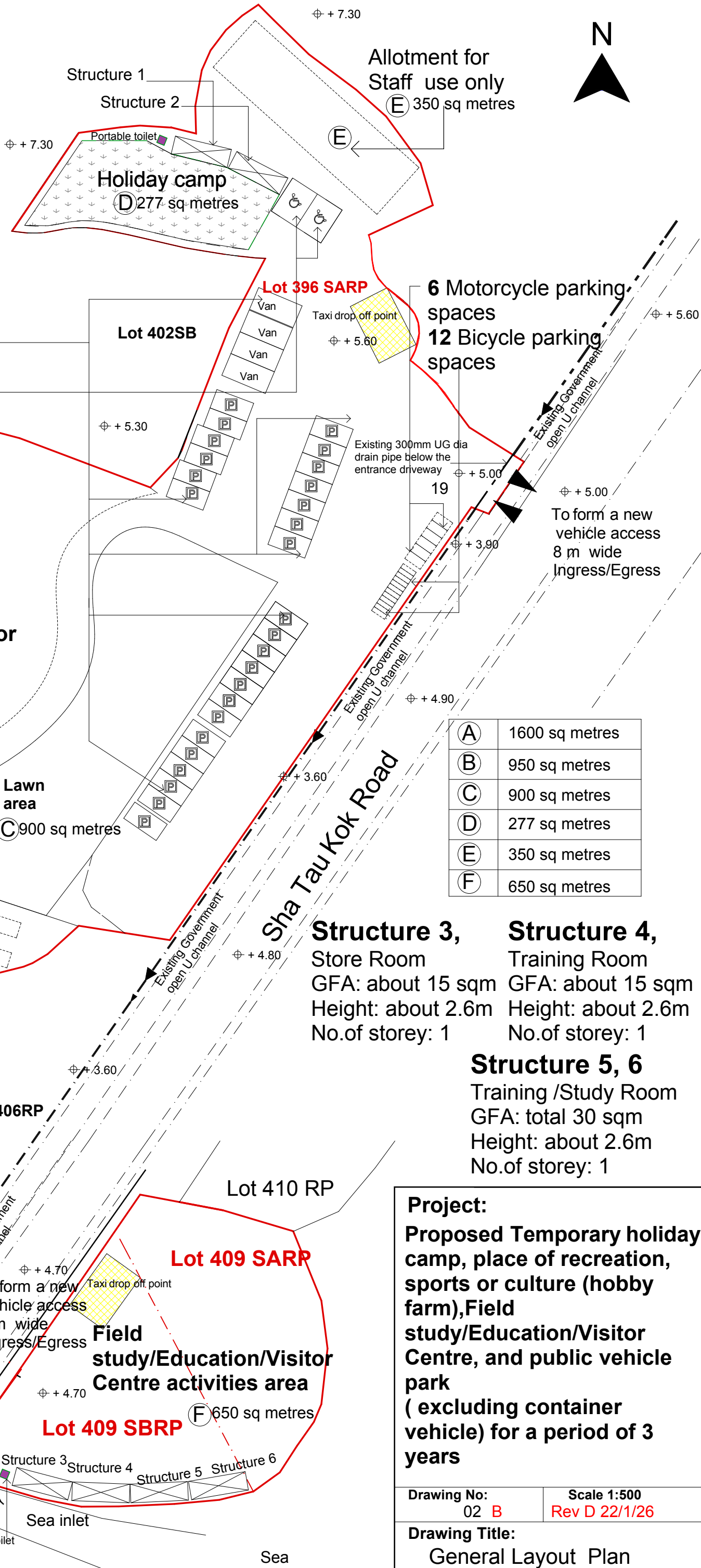

Project:
Proposed Temporary holiday
camp, place of recreation,
sports or culture (hobby
farm), Field
study/Education/Visitor
Centre, and public vehicle
park
(excluding container
vehicle) for a period of 3
years

Drawing No: 02 B
Scale 1:500
Rev D 22/1/26

Drawing Title:
General Layout Plan