



# Application Site

Total footpath area: 526 sq.m.  
 (Including 65 sq.m. of ex. footpath area)  
 Total green house area: 752 sq.m.  
 Total storage area: 139 sq.m.

●●●●● Grass lane (foot path)

**LEGEND**

Green House	Living Hut
Storage	Meeting point
Farm Entrance	Septic tank
Proposed Footpath	Existing Footpath
Mobile Toilet 1.5m(L) x 1.2m(W) x 2.3m(H)	
Loading/unloading (Van: 6.0m(L) x 2.0m(W) x 2.6m(H) Area: 196 sq.m. (about)	

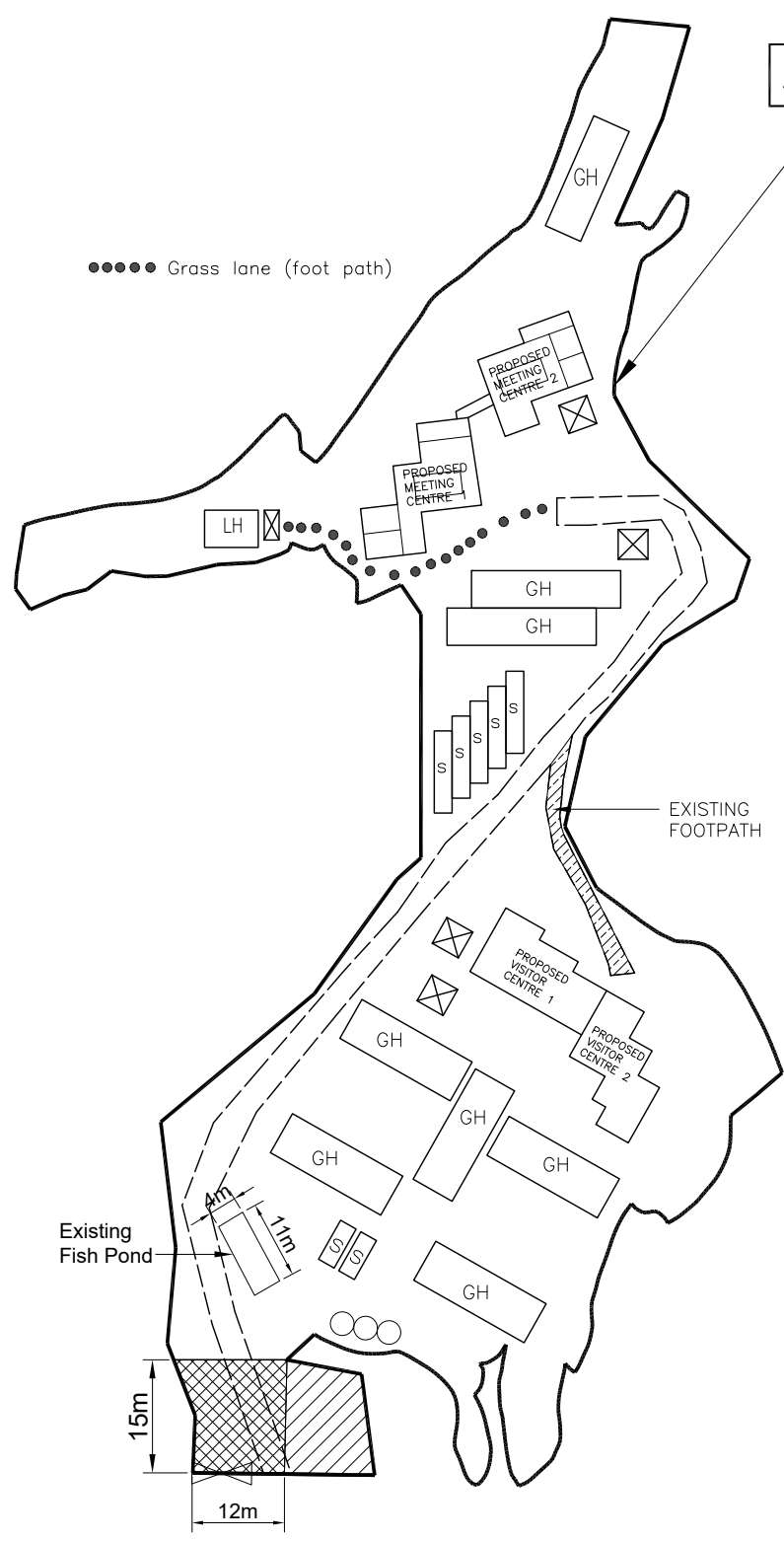
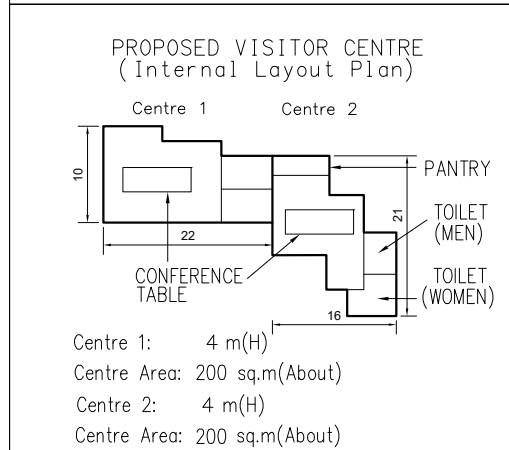
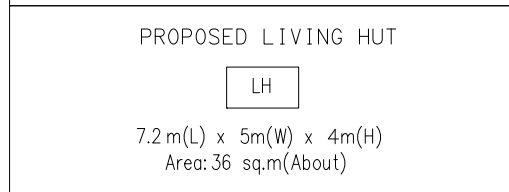
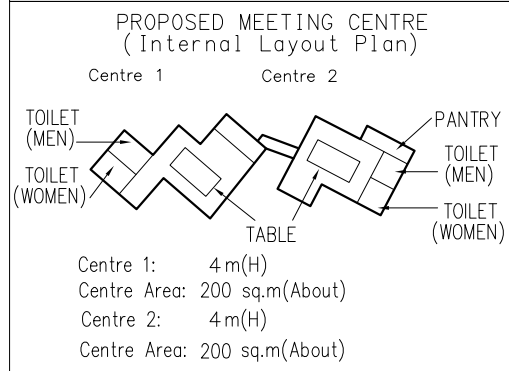

Site Area: 8093 sq.m. (About)

<p>Not to Scale</p>	<p><b>Layout Plan</b></p> <p>Proposed Filling and Excavation of Land for the Permitted Agricultural use</p>	<p>INNOVATIVE LAND USE PLANNING CONSULTANCY CO.</p>
<p>MAR 2026</p>	<p>Part of Lots 1517 , 1525 , 1535 , 1536 , 1538 , 1540 , 1545 , 1553 , 1554 , 1575 , 1576 , 1581 , 1582 , 1584 , 1585 , 1586 , 1587 and 1588. Whole Lot of Lots 1518 , 1526 , 1539 , 1541 , 1542RP , 1543 , 1544 , 1571S.A , 1571S.B , 1572 , 1574 , 1577 , 1578 , 1579 , 1580 in D.D.17 and Adjoining Government Land, Ting Kok, Tai Po, New Territories</p>	<p>PLAN 3</p>

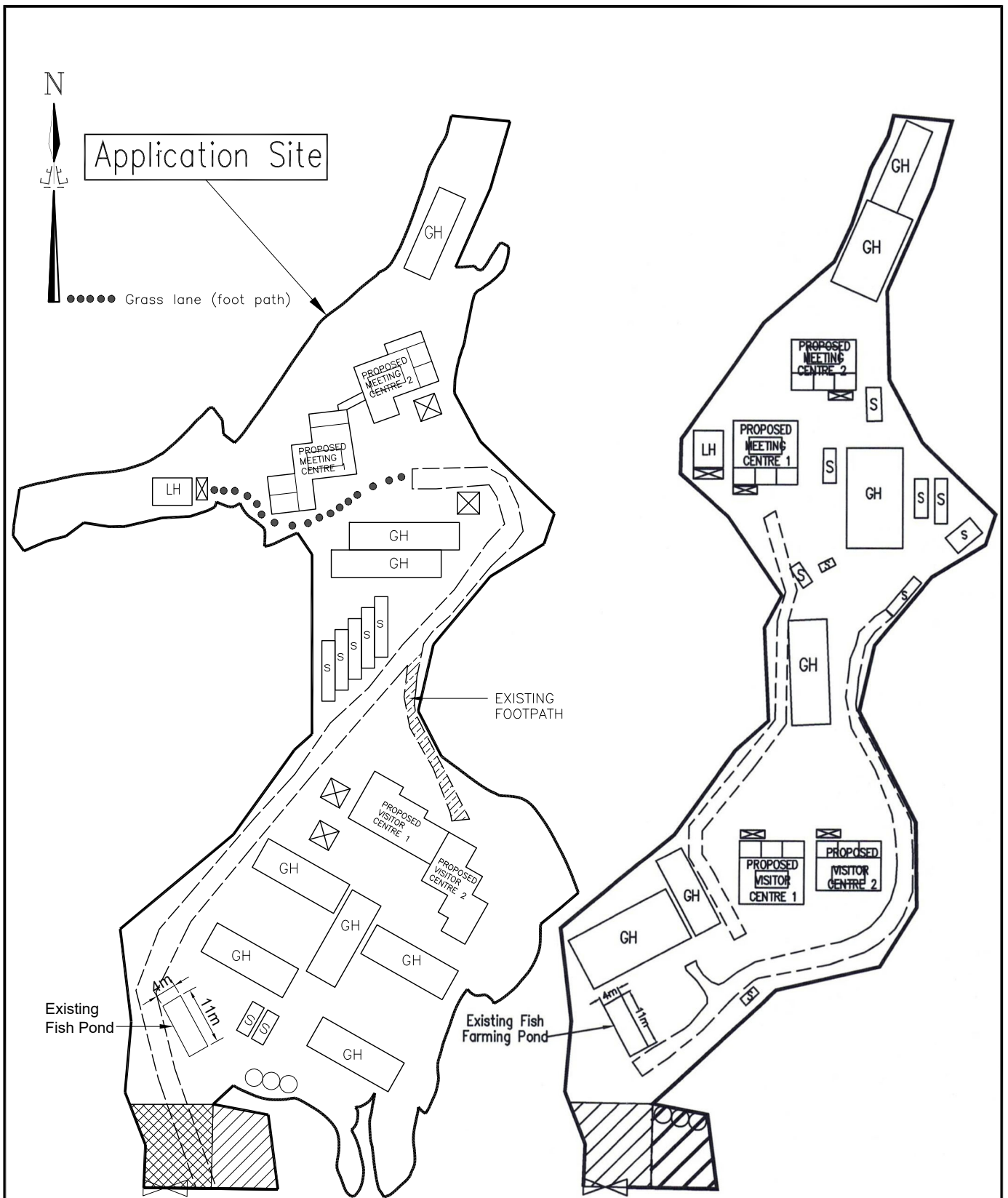

**CURRENT PROPOSED LAYOUT PLAN**

**PREVIOUS APPROVED LAYOUT PLAN**  
( UNDER APPROVED TPB CASE NO. : A\_NE-TK/840 )

<p><b>Not to Scale</b></p>	<p><b>Layout Plan (Comparison)</b></p> <p>Proposed Filling and Excavation of Land for the Permitted Agricultural use</p>	<p>INNOVATIVE LAND USE PLANNING CONSULTANCY CO.</p>
<p><b>MAR 2026</b></p>	<p>Part of Lots 1517 , 1525 , 1535 , 1536 , 1538 , 1540 , 1545 , 1553 , 1554 , 1575 , 1576 , 1581 , 1582 , 1584 , 1585 , 1586 , 1587 and 1588. Whole Lot of Lots 1518 , 1526 , 1539 , 1541 , 1542RP , 1543 , 1544 , 1571S.A , 1571S.B , 1572 , 1574 , 1577 , 1578 , 1579 , 1580 in D.D.17 and Adjoining Government Land, Ting Kok, Tai Po, New Territories</p>	<p><b>PLAN 3.1</b></p>

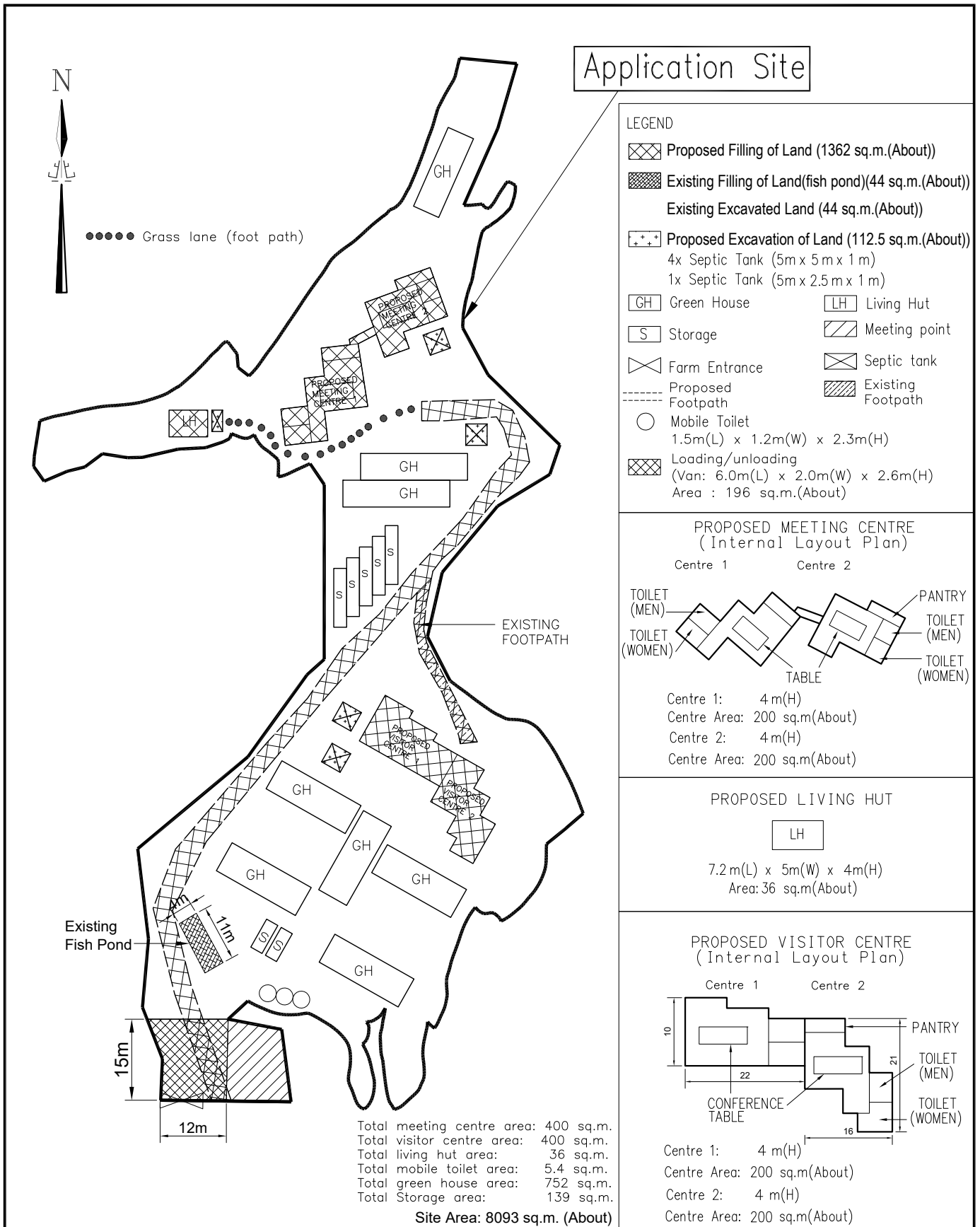

<p>Not to Scale</p>	<p align="center"><b>Land Filling and Excavation Plan</b></p> <p align="center">Proposed Filling and Excavation of Land for the Permitted Agricultural use</p>	<p align="center">INNOVATIVE LAND USE PLANNING CONSULTANCY CO.</p>
<p>MAR 2026</p>	<p>Part of Lots 1517 , 1525 , 1535 , 1536 , 1538 , 1540 , 1545 , 1553 , 1554 , 1575 , 1576 , 1581 , 1582 , 1584 , 1585 , 1586 , 1587 and 1588. Whole Lot of Lots 1518 , 1526 , 1539 , 1541 , 1542RP , 1543 , 1544 , 1571S.A , 1571S.B , 1572 , 1574 , 1577 , 1578 , 1579 , 1580 in D.D.17 and Adjoining Government Land, Ting Kok, Tai Po, New Territories</p>	<p align="center"><b>PLAN 4</b></p>