

**LCH Planning and Development
Consultants Limited**

Figure 1 : Location Plan

(For reference only. Not to scale.)

Section 16 Application for Proposed Temporary Public Vehicle Park (Private Cars Only) and Eating Place with Ancillary Electric Vehicle Charging Facilities and Solar Panels for a Period of 3 Years at Lots 333 S.B RP, 346, 348 RP, 349 RP and 350 in D.D. 221, Tai Mong Tsai Road, Sai Kung, New Territories

(Source: HK GEODATA STORE, HKSAR Government)

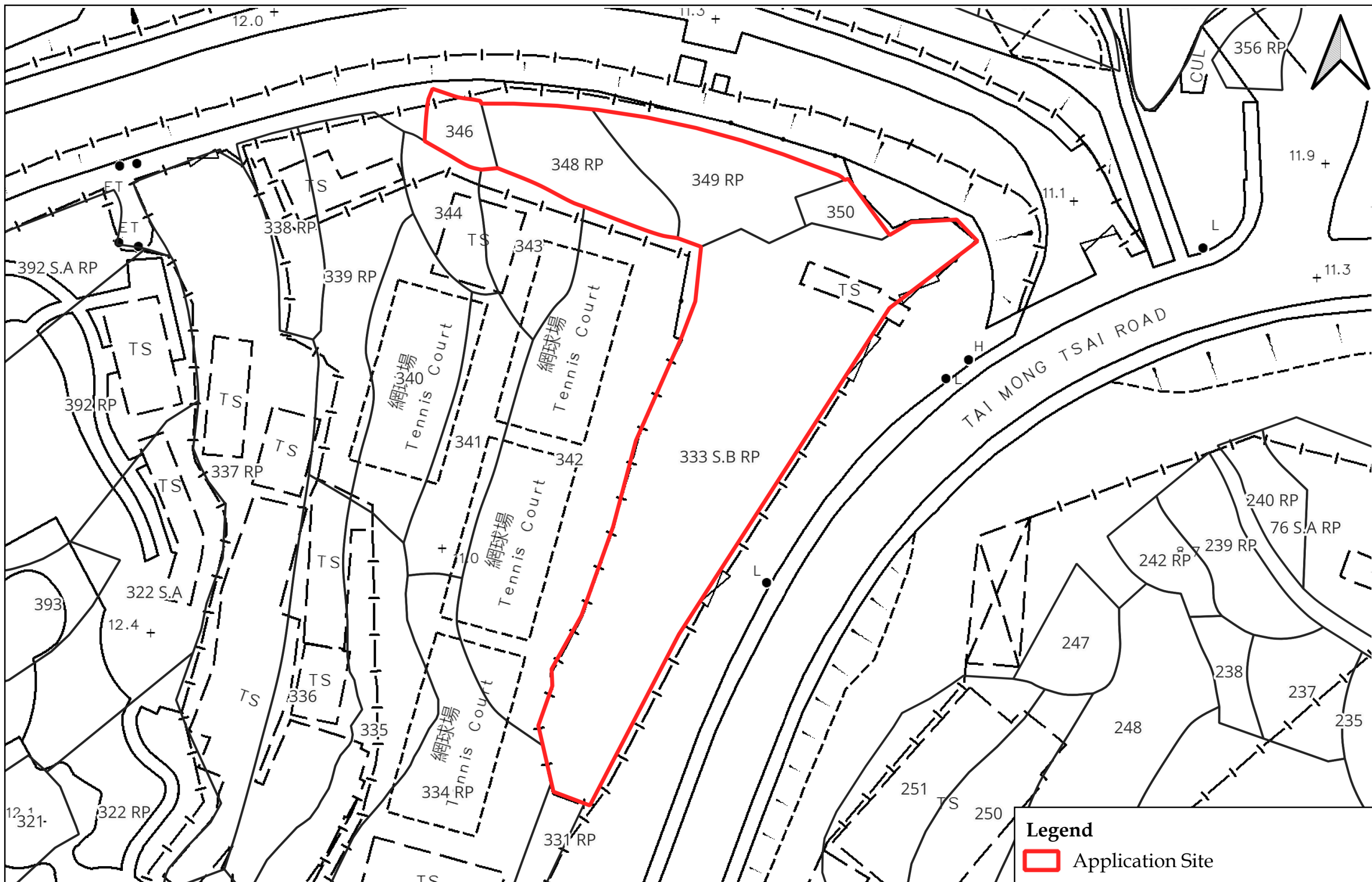

Legend

Application Site



**LCH Planning and Development
Consultants Limited**

Figure 2 : Lot Index Plan

(For reference only. Not to scale.)

Section 16 Application for Proposed Temporary Public Vehicle Park (Private Cars Only) and Eating Place with Ancillary Electric Vehicle Charging Facilities and Solar Panels for a Period of 3 Years at Lots 333 S.B RP, 346, 348 RP, 349 RP and 350 in D.D. 221, Tai Mong Tsai Road, Sai Kung, New Territories

(Source: HK GEODATA STORE, HKSAR Government)

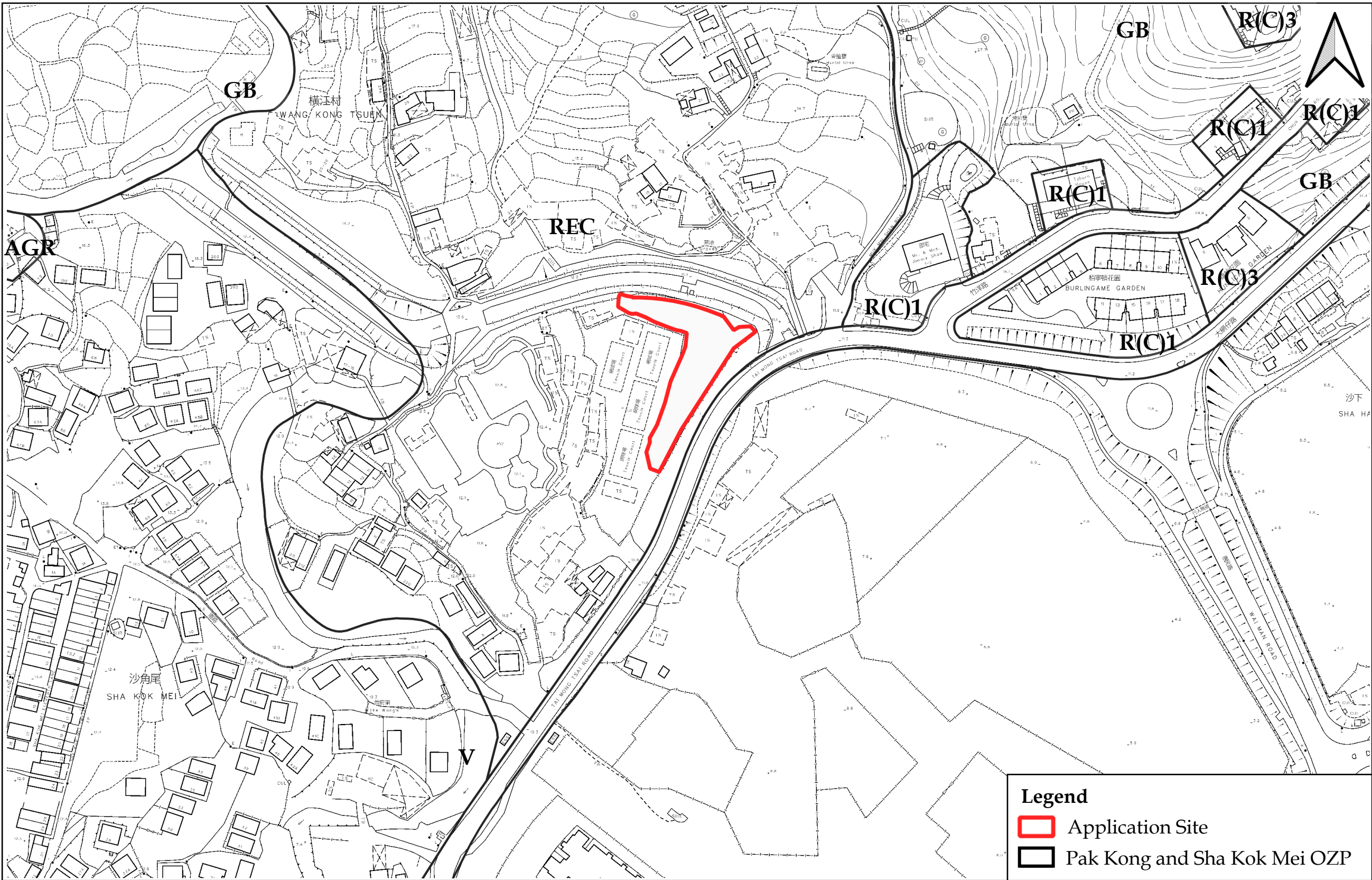

**LCH Planning and Development
Consultants Limited**

Figure 3 : Extract of Outline Zoning Plan No. S/SK-PK/11

(For reference only. Not to scale.)

Section 16 Application for Proposed Temporary Public Vehicle Park (Private Cars Only) and Eating Place with Ancillary Electric Vehicle Charging Facilities and Solar Panels for a Period of 3 Years at Lots 333 S.B RP, 346, 348 RP, 349 RP and 350 in D.D. 221, Tai Mong Tsai Road, Sai Kung, New Territories

(Source: Town Planning Board and HK GEODATA STORE, HKSAR Government)

Structures 3 - 6
Solar panels with height of not more than 3 m
Covered Area: About 477 sq. m.

Structure 2
Resting Area with Solar Panels on rooftop with height of not more than 3.5 m
Covered Area: About 30 sq. m.

5 nos. of 200kW Fast Charger (750(W)x750(D)x1920(H) each)

36 nos. of Private Car Parking Spaces (2.5m x 5m each)

Structure 1
Station Café with Solar Panels on rooftop with height of not more than 3.5 m

Covered Area: About 80 sq. m.

Ingress/Egress of about 4.5m wide for pedestrian access

Ingress of about 5.4m wide

13 nos. of 7kW Medium Charger (300(W)x150(D)x410(H) each)

Egress of about 4.2m wide

Legend

- Application Site
- Parking Space with EV charging and Solar PV Panels on top
- 7kW/200kW Charger
- Joint Box
- HV Pillar
- E&M
- Structures**
- Structures
- Solar Panels



**LCH Planning and Development
Consultants Limited**

Figure 4 : Indicative Layout Plan

(For reference only. Not to scale.)

Section 16 Application for Proposed Temporary Public Vehicle Park (Private Cars Only) and Eating Place with Ancillary Electric Vehicle Charging Facilities and Solar Panels for a Period of 3 Years at Lots 333 S.B RP, 346, 348 RP, 349 RP and 350 in D.D. 221, Tai Mong Tsai Road, Sai Kung, New Territories

(Source: Town Planning Board and HK GEODATA STORE, HKSAR Government)

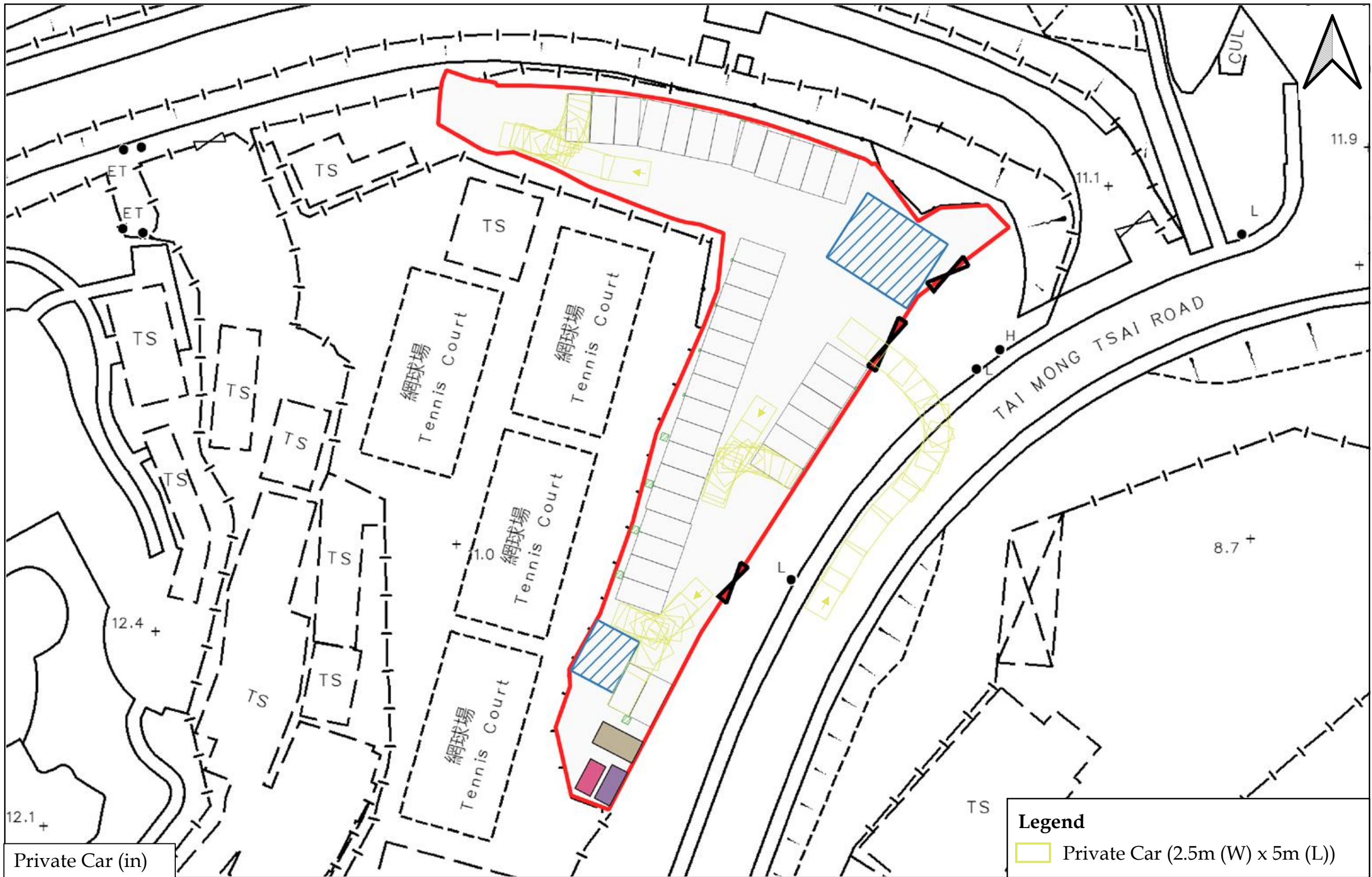

**LCH Planning and Development
Consultants Limited**

Annex 1a: Swept Path Analysis

(For reference only. Not to scale.)

Section 16 Application for Proposed Temporary Public Vehicle Park (Private Cars Only) and Eating Place with Ancillary Electric Vehicle Charging Facilities and Solar Panels for a Period of 3 Years at Lots 333 S.B RP, 346, 348 RP, 349 RP and 350 in D.D. 221, Tai Mong Tsai Road, Sai Kung, New Territories

(Source: Town Planning Board and HK GEODATA STORE, HKSAR Government)

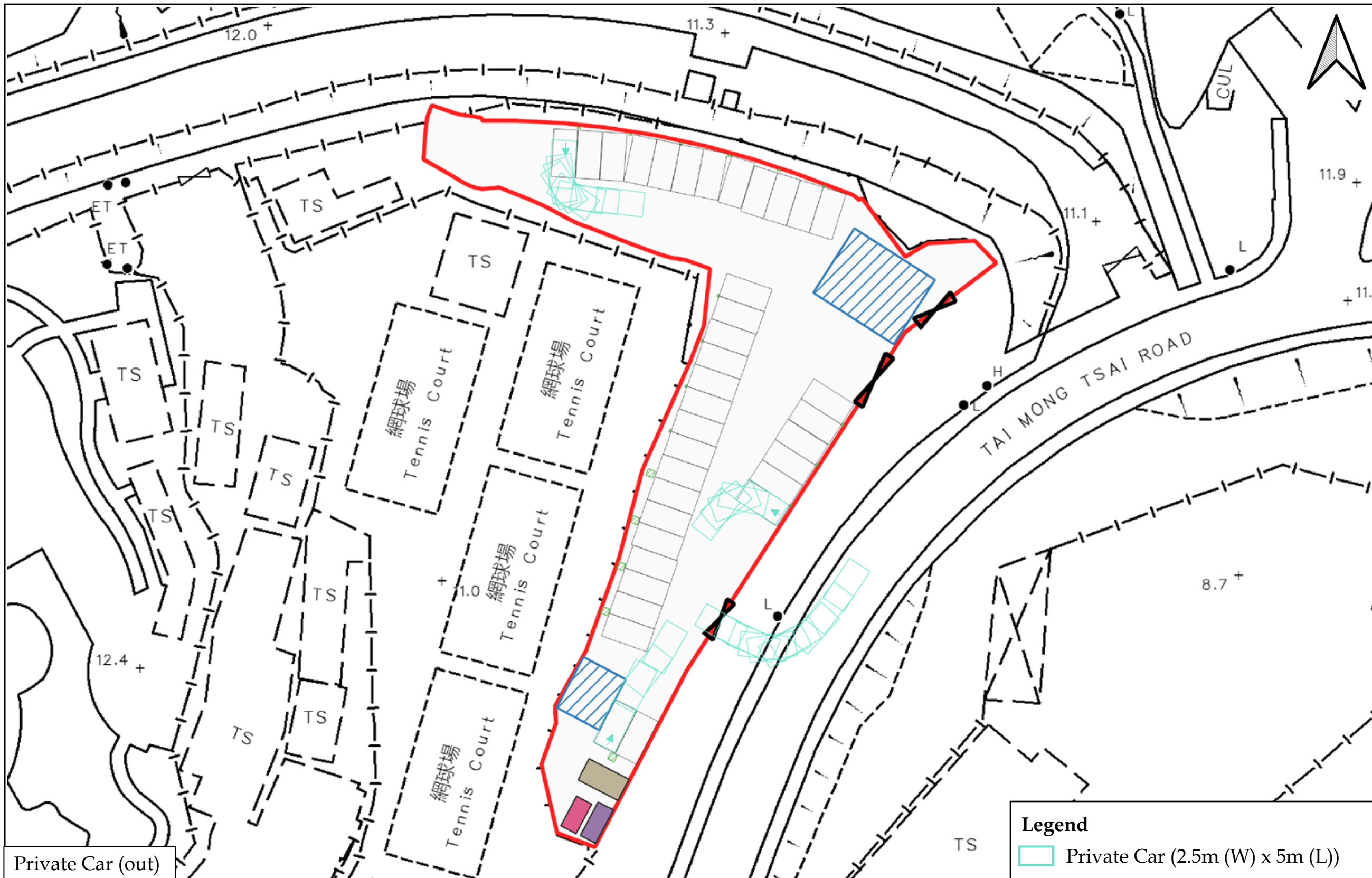

Private Car (out)

Legend
 Private Car (2.5m (W) x 5m (L))

**LCH Planning and Development
Consultants Limited**

Annex 1b : Swept Path Analysis

(For reference only. Not to scale.)

Section 16 Application for Proposed Temporary Public Vehicle Park (Private Cars Only) and Eating Place with Ancillary Electric Vehicle Charging Facilities and Solar Panels for a Period of 3 Years at Lots 333 S.B RP, 346, 348 RP, 349 RP and 350 in D.D. 221, Tai Mong Tsai Road, Sai Kung, New Territories

(Source: Town Planning Board and HK GEODATA STORE, HKSAR Government)