

TREE SURVEY REPORT

Project title:	Pole & Stay Erection At Pui O, Lantau
Map no.	14NW01B
Project ref.	
Plan ref.	
Inspection Date:	16 May 2024

Contents

1.	Tree Survey Summary & Recommendation
2.	Site Plan and Tree Location Plan
3.	Tree Survey Schedule
4.	Tree Survey Photographic Record

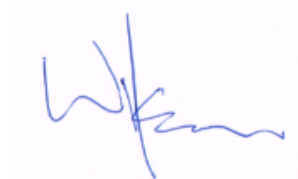

Wilson Chin Chi Wai
ISA. Certified Arborist
(Certificate No. HK0797A)
Date: 23 May 2024

Tree Survey Summary and Recommendation

Tree Species	Chinese Names	Tree Condition	Nos. of Trees
<i>Zanthoxylum avicennae</i>	簕欖花椒（簕欖）		2
<i>Microcos nervosa</i>	破布葉（布渣葉）		8
<i>Alangium chinense</i>	八角楓		7
<i>Heteropanax fragrans</i>	幌傘楓（火通木）		3
<i>Clausena lansium</i>	黃皮		1
<i>Aquilaria sinensis</i>	土沉香		1
<i>Tetradium glabrifolium</i>	棟葉吳茱萸		5
<i>Sterculia lanceolata</i>	假蘋婆		1
<i>Celtis sinensis</i>	朴樹		1
<i>Mangifera indica</i>	芒果		1
Dead tree	死樹		1
		Total	31

1. A total of 31 existing trees are surveyed near the proposed pole and stay erection area.
2. All surveyed trees are common species.
3. There is no tree with cultural, historic or conservation value on the site.
4. No Old and Valuable Trees (OVT) is found on the survey area.
5. One (T16) rare species (as defined by AFCD's Rare and Precious Plants in Hong Kong) was find on the survey area.
6. No Champion Trees is found on the survey area.

Tree location plan

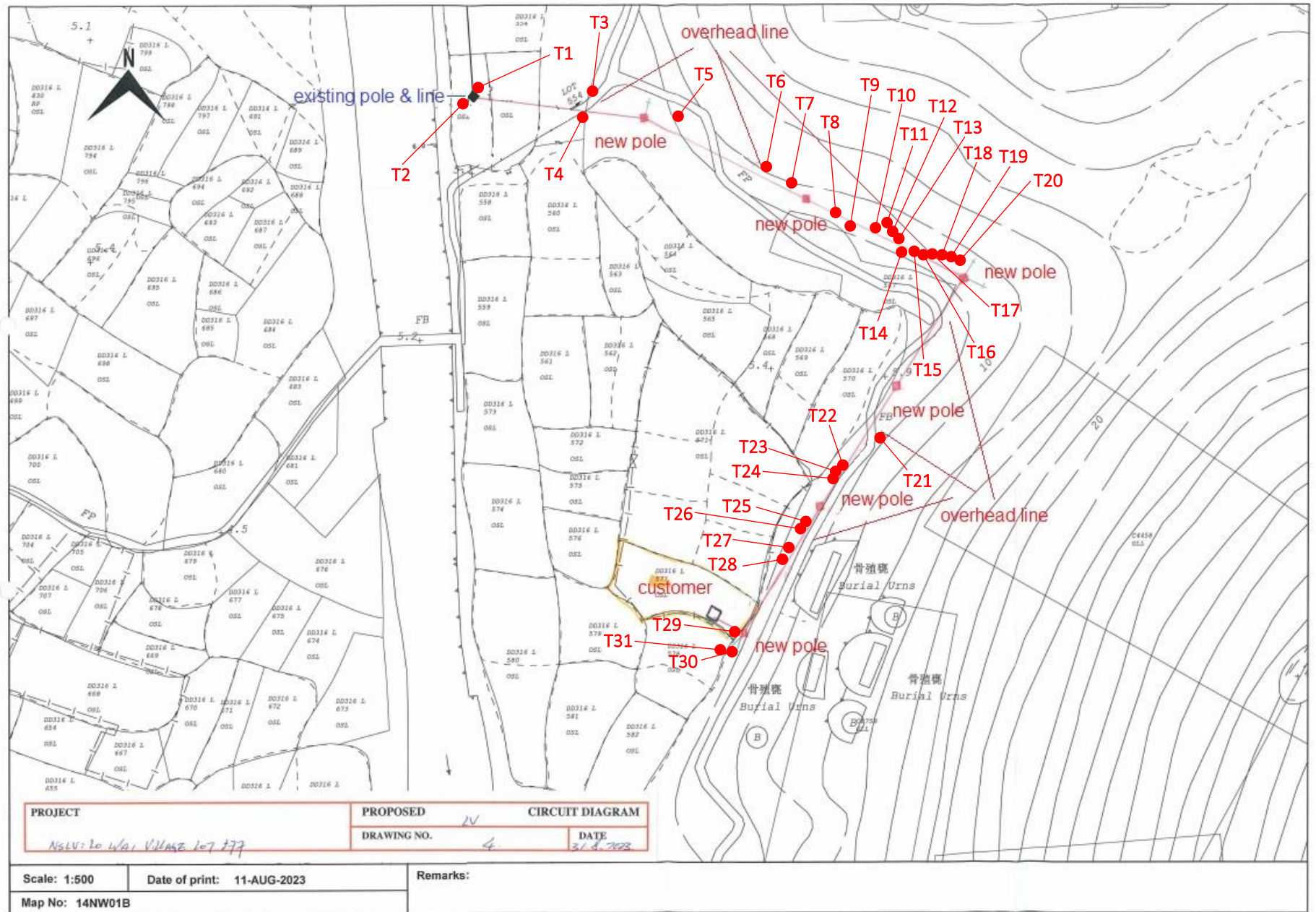

Tree Assessment Schedule

Project title: Pole & Stay Erection at Pui O, Lantau
 Inspection date: 16 May 2024
 Tree Surveyor : Chin Chi Wai (ISA Certified Arborist no.HK-0797A)
 Surveyed by: Tarzan Landscape Contractors Ltd.

Tree No. ²	Species ³		Measurements			Amenity value ⁵	Form	Health Condition	Structural condition	Suitability for transplanting ⁶		Conservation status ⁸	Recommendation	Maintenance department to provide comments on TPRP ⁹		Additional Remarks ¹⁰
	Scientific name	Chinese name	Height (m)	DBH ⁴ (mm)	Crown Spread (m)	(high(H)/medium(M)/low(L))	(good G)/average (A)/poor (P))			(high(H)/medium(M)/low(L))	Remarks ⁶		(Retain/Transplant/Fell)	Before	After	
T1	<i>Zanthoxylum avicennae</i>	簕欏花椒 (簕欏)	5	95	2	M	P	A	A	L	—	—	Retain			Dead branch / leaning
T2	<i>Microcos nervosa</i>	破布葉 (布渣葉)	6	135	2	M	P	A	P	L	—	—	Retain			Topped / epicormics / wound
T3	<i>Microcos nervosa</i>	破布葉 (布渣葉)	8	160	5	M	A	A	A	L	—	—	Retain			-
T4	<i>Zanthoxylum avicennae</i>	簕欏花椒 (簕欏)	5	95	2	M	P	A	A	L	—	—	Retain			Covered by climber / leaning
T5	<i>Alangium chinense</i>	八角楓	8	150	4	M	P	A	A	L	—	—	Retain			Covered by climber / leaning
T6	<i>Alangium chinense</i>	八角楓	7	115	3	M	A	A	A	L	—	—	Retain			Covered by climber
T7	<i>Alangium chinense</i>	八角楓	8	125	3	M	A	A	A	L	—	—	Retain			Covered by climber
T8	<i>Heteropanax fragrans</i>	幌傘楓 (火通木)	12	140	5	M	A	A	A	L	—	—	Retain			Wound on trunk
T9	<i>Heteropanax fragrans</i>	幌傘楓 (火通木)	12	125	4	M	A	A	A	L	—	—	Retain			Wound on trunk
T10	<i>Alangium chinense</i>	八角楓	8	115	4	M	A	A	A	L	—	—	Retain			Exposed root
T11	<i>Microcos nervosa</i>	破布葉 (布渣葉)	12	115	4	M	A	A	A	L	—	—	Retain			Crack on trunk / exposed root
T12	<i>Microcos nervosa</i>	破布葉 (布渣葉)	13	250	5	M	A	A	A	L	—	—	Retain			Codominant stems / included bark / exposed root
T13	<i>Heteropanax fragrans</i>	幌傘楓 (火通木)	13	170	5	M	A	A	A	L	—	—	Retain			Covered by climber / exposed root
T14	<i>Clausena lansium</i>	黃皮	8.5	120	5	M	P	A	A	L	—	—	Retain			Covered by climber / leaning
T15	<i>Microcos nervosa</i>	破布葉 (布渣葉)	8	110	4	M	A	A	A	L	—	—	Retain			Covered by climber / crack on trunk
T16	<i>Aquilaria sinensis</i>	土沉香	12	235	6	H	A	A	A	L	—	—	Retain			Rare species / covered by climber
T17	Dead tree	死樹	7	130	2	L	P	P	P	L	—	—	Fell			Broken main trunk / crack
T18	<i>Alangium chinense</i>	八角楓	7	95	3	M	A	A	A	L	—	—	Retain			Covered by climber / crack on trunk / leaning
T19	<i>Alangium chinense</i>	八角楓	7	95	4	M	P	A	P	L	—	—	Retain			Bark crack / covered by climber / exposed root / leaning
T20	<i>Microcos nervosa</i>	破布葉 (布渣葉)	8.5	250	5	M	A	A	A	L	—	—	Retain			Covered by climber
T21	<i>Tetradium glabrifolium</i>	棟葉吳茱萸	8.5	160	4	M	P	A	A	L	—	—	Retain			Covered by climber / leaning
T22	<i>Microcos nervosa</i>	破布葉 (布渣葉)	8	95	3	M	P	A	A	L	—	—	Retain			Dead branch / covered by climber / leaning
T23	<i>Tetradium glabrifolium</i>	棟葉吳茱萸	7	100	3	M	P	A	A	L	—	—	Retain			Leaning
T24	<i>Alangium chinense</i>	八角楓	7	95	3	M	P	A	A	L	—	—	Retain			Bark crack / decay / leaning
T25	<i>Tetradium glabrifolium</i>	棟葉吳茱萸	7	110	4	M	P	A	A	L	—	—	Retain			Covered by climber / leaning

Tree Assessment Schedule

Project title: Pole & Stay Erection at Pui O, Lantau

Inspection date: 16 May 2024

Tree Surveyor : Chin Chi Wai (ISA Certified Arborist no.HK-0797A)

Surveyed by: Tarzan Landscape Contractors Ltd.

Tree No. ²	Species ³		Measurements			Amenity value ⁵	Form	Health Condition	Structural condition	Suitability for transplanting ⁶		Conservation status ⁸	Recommendation	Maintenance department to provide comments on TPRP ⁹		Additional Remarks ¹⁰
	Scientific name	Chinese name	Height (m)	DBH ⁴ (mm)	Crown Spread (m)	(high(H)/medium(M)/low(L))	(good G)/average (A)/poor (P))			(high(H)/medium(M)/low(L))	Remarks ⁶		(Retain/Transplant/Fell)	Before	After	
T26	<i>Microcos nervosa</i>	破布葉 (布渣葉)	8	110	4	M	P	A	A	L	—	—	Retain			Covered by climber / leaning
T27	<i>Tetradium glabrifolium</i>	棟葉吳茱萸	8	185	4	M	P	A	A	L	—	—	Retain			Covered by climber / leaning
T28	<i>Sterculia lanceolata</i>	假蘋婆	7	165	4	M	A	A	A	L	—	—	Retain			Covered by climber
T29	<i>Celtis sinensis</i>	朴樹	11	200	6	M	A	A	A	L	—	—	Retain			-
T30	<i>Mangifera indica</i>	杧果	13	450	10	M	A	A	A	L	—	—	Retain			-
T31	<i>Tetradium glabrifolium</i>	棟葉吳茱萸	7	95	3	M	A	A	A	L	—	—	Retain			-
END																

1 For large-scale infrastructure works projects, such as site formation works and advance infrastructure works for new town development, tree group survey can be adopted subject to the justification(s) provided.

2 Tree(s) in the Register of Old and Valuable Trees should be highlighted with their registration numbers.

3 Guidance on proper use of scientific name of plants is given in the Agriculture, Fisheries and Conservation Department's Nature Conservation Practice Note No. 3, which can be viewed at AFCD's web page http://www.afcd.gov.hk/english/conservation/con_tech/files/common/NCPC_No.03_The_use_of_plant_names_rev_2008_2.pdf.

4 DBH of a tree refers to its diameter at breast height (i.e. measured at 1.3 m above ground level). Guidance on DBH measurement is given in the Agriculture, Fisheries and Conservation Department's Nature Conservation Practice Note No. 2, which can be viewed at AFCD's web page http://www.afcd.gov.hk/english/conservation/con_tech/files/common/NCPN_No.02_measurement_of_DBH_ver.2006.pdf.

5 Amenity value of a tree should be assessed by its functional values for shade, seasonal interest, screening, reduction of pollution and noise and also its fung shui significance, and classified into the following categories.

High (H): important trees which should be retained by adjusting the design layout accordingly.

Medium (M): trees that are desirable to be retained in order to create a pleasant environment, which includes healthy specimens of lesser importance than "High" trees.

Low(L): trees that are dead, dying or potentially hazardous and should be removed.

6 Assessment shall take into account conditions of an individual tree at the time of survey (including health, structure, age and root conditions), site conditions (including topography and accessibility), and intrinsic characters of tree species (survival rate after transplanting).

7 Major determining factors for the rating on suitability for transplanting should be included if necessary.

8 State the rarity and protection status of the species.

9 Refer to paragraphs 35 and 36 of the Circular.

10 Any additional information deemed necessary for consideration of the proposed management recommendation.

Project title: Pole & Stay Erection at Pui O, Lantau
Inspection date: 16 May 2024

Tree Survey Photographic Record



T1



T1-1



T1-2



T1-3



T2



T2-1



T2-2



T2-3



T3



T3-1

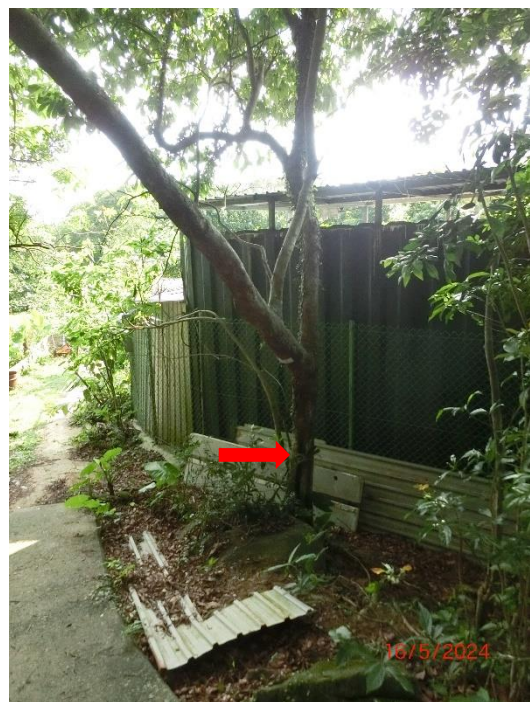

T3-2



T3-3



T4



T4-1



T4-2



T4-3



T5



T5-1



T5-2



T5-3



T6



T6-1



T6-2



T6-3



T7



T7-1



T7-2



T7-3



T8



T8-1



T8-2



T8-3



T9

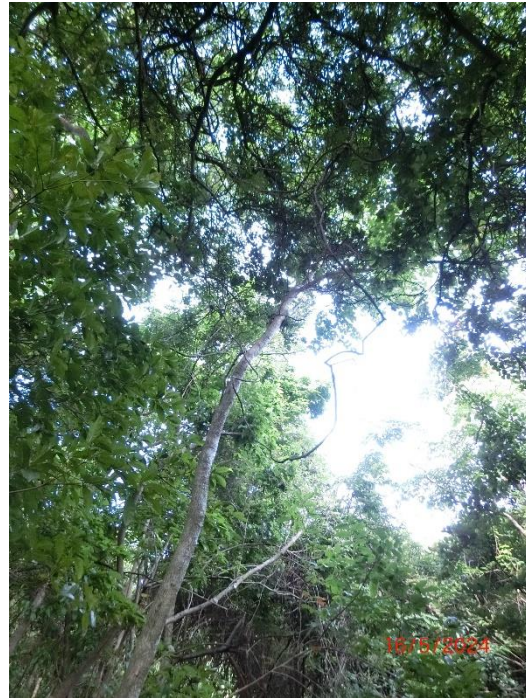

T9-1



T9-2



T9-3



T10



T10-1



T10-2



T10-3



T11



T11-1



T11-2



T11-3



T12



T12-1



T12-2



T12-3



T13



T13-1



T13-2



T13-3



T14



T14-1



T14-2



T14-3



T15



T15-1



T15-2



T15-3



T16



T16-1



T16-2



T16-3



T17



T17-1



T17-2



T17-3



T18



T18-1



T18-2



T18-3



T19



T19-1



T19-2



T19-3

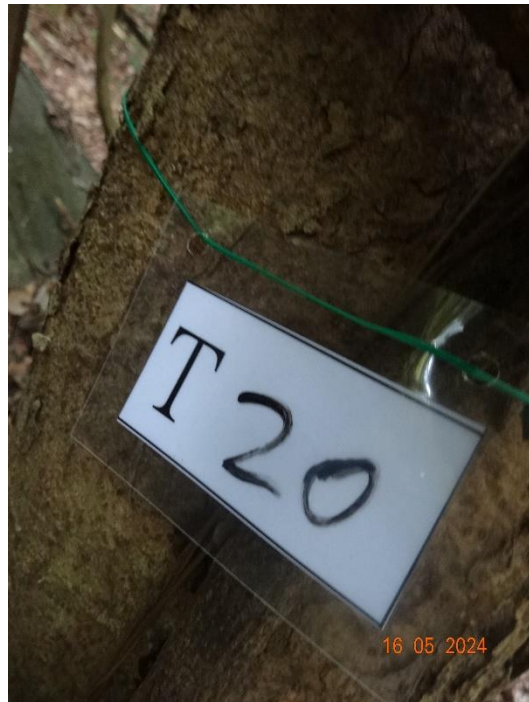

T20



T20-1



T20-2



T20-3



T21



T21-1



T21-2



T21-3



T22



T22-1



T22-2



T22-3



T23



T23-1



T23-2



T23-3



T24



T24-1



T24-2



T24-3



T25



T25-1



T25-2



T25-3



T26



T26-1



T26-2



T26-3



T27



T27-1



T27-2



T27-3



T28



T28-1



T28-2



T28-3



T29



T29-1



T29-2



T29-3

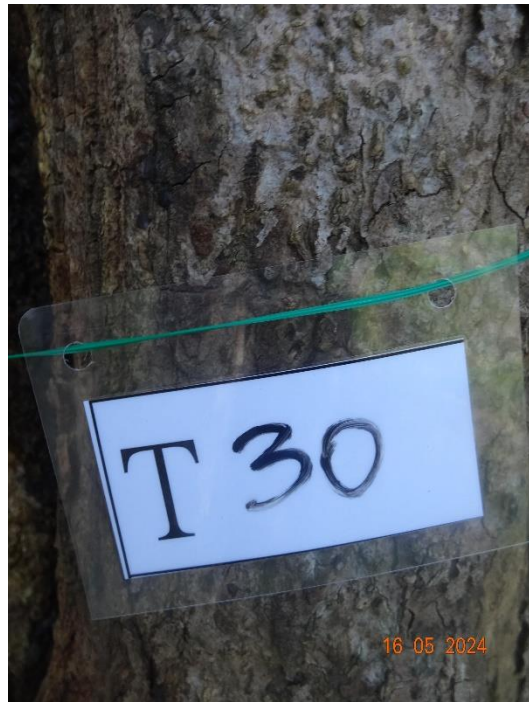

T30



T30-1



T30-2



T30-3



T31



T31-1



T31-2



T31-3