

Attachment 2

4 Tree Preservation and Removal Proposal

4.1 Tree Survey Findings

4.1.1 The tree survey for the Application Site was carried out on 3rd and 24th of September 2024. There are 31 nos. of tree (24 nos. of living tree, 7 nos. of dead tree) found within the Site. Outside the Site there are 4 nos. of tree were found in close proximity. The surveyed species include ~~Alangium chinense, Ficus hispida, Acacia confusa, Mallotus paniculatus, Sapium sebiferum, Celtis sinensis and Microcos nervosa~~ *Alangium chinense, Ficus hispida, Acacia confusa, Mallotus paniculatus, Sapium sebiferum, Celtis sinensis and Microcos nervosa*. The condition of the trees range from poor to fair, and most are of low amenity value. For the Tree Survey details, refer to Tree Assessment Schedule and Tree Photographs (**Annex A** and **Annex B** refers).

	Nos. of Existing Trees
Within Site	31
Total	31

Table 4.1: Summary of Existing Trees

4.1.2 None of the existing trees are protected species listed under the Forestry Regulations, Forests and Countryside Ordinance (Cap. 96 sub. leg.) or are “*Old and Valuable Tree*” or “*Potential Old and Valuable Tree*” as defined in DEVB TC (W) No. 5/2020 “*Registration of Old and Valuable Trees*” or “*Champion Tree*” as identified in the book “*Champion Trees in Urban Hong Kong*”.

4.1.3 35 nos. of whips will be planted on slopes with min. 1.5m spacing, 18 nos. of heavy standard tree will be planted on adjacent slopes with min. 3m spacing within the planting area of the Site, mainly on garden landscaped area, with soil depth of a minimum 1200mm excluding drainage layer. (**Figure 4.1** refers).

4.1.4 A summary of the proposed treatments of existing trees within the Application Site boundary is provided below:-

	Nos. of Existing Trees to be felled	Nos. Compensatory Trees
Within Site – (North)	29	18 (Heavy Standard)
Within Site – (South)	2	35 (Whips)
Total	31	53

Table 4.2: Summary of Treatment of Existing Trees

4.1.5 The calculation of compensatory planting ratio is as shown below:-

Compensatory Planting Ratio Calculation					
Total nos. of trees proposed to be felled	=	35	nos.		
Total DBH of trees proposed to be felled	=		9,140		mm
Total nos. of Proposed Heavy Standard Trees	=		18		nos.
Total nos. of Proposed Whip Trees	=		35		nos.
Total nos. of Proposed Compensatory Planting	=	18 + 35	=	53	nos.
DBH of Heavy Standard Tree	=		95		mm
Total Proposed Heavy Standard Trees DBH	=	18 × 95	=	1,710	mm
DBH of Whip Tree	=		10		mm
Total Proposed Whip Trees DBH	=	35 × 10	=	350	mm
Total Proposed Compensatory Planting DBH	=	1,710 + 350	=	2,060	mm
Compensatory Planting Ratio in terms of number	=	35 : 53	=	1 : 1.51	(>1:1)
Compensatory Planting Ratio in terms of aggregated DBH	=	9,140 : 2,060	=	1 : 0.23	(<1:1)

Table 4.3: Compensatory Planting Ratio Calculation

size of low shrubs will vary from 300mm to 600mm whilst the tall shrubs will be above 800mm. For groundcovers, 100mm to 300mm size will be provided.

5.4.5 **Table 5.2** indicated the Proposed Compensation Trees:-

No.	Species	Chinese Name	Size	Quantity	Species Native/ Exotic
FEATURED TREE / COMPENSATORY TREE					
1	<i>Sapium sebiferum</i>	烏柏	Heavy Standard	1	Native
2	<i>Polyspora axillaris</i>	大頭茶	Heavy Standard	5	Native
3	<i>Livistona chinensis</i>	蒲葵	Heavy Standard	8	Exotic
4	<i>Pyrus calleryana</i>	豆梨	Heavy Standard	1	Native
5	<i>Viburnum odoratissimum</i>	珊瑚樹	Heavy Standard	3	Native
6	<i>Bridelia tomentosa</i>	土密樹	Whip	6	Native
7	<i>Quercus championii</i>	嶺南青岡	Whip	6	Native
8	<i>Quercus myrsiniflora</i> or <i>Cyclobalanopsis myrsinifolia</i>	小葉青岡	Whip	6 7	Native
9	<i>Reevesia thyrsoidea</i>	梭羅樹	Whip	6	Native
10	<i>Cleistocalyx nervosum</i> Water Adoptable	水翁	Whip	9 10	Native
Total Native Species: 45 (85%)					
Total Exotic Species: 8 (15%)					
Total: 53					

Table 5.2: Proposed Compensation Trees.

5.4.6 In the landscape proposal, only one exotic species, *Livistonia chinensis* was selected; all the other trees are native species. The *Livistonia chinensis* was selected as it can contribute to the local biodiversity as a habitat creator and food source. This selection is not excessive, considering that only 15% of the total 53 trees planted are exotic.

5.4.7 The species in the **Table 5.3** will form the basis of the planting schedule with the reference image shown in Figure 5.4.

The below plant will be considered at the details design stage*		
No.	Species	Chinese Name
BUTTERFLY-FRIENDLY SEASONAL CHANGING PLANT		
1	<i>Crotalaria retusa</i>	吊裙草
2	<i>Lantana camara</i>	馬纓丹
3	<i>Duranta erecta</i> "Lass"	蕾絲假連翹
4	Chinese ixora <i>Ixora chinensis</i>	龍船花
5	<i>Orthosiphom aristatus</i>	貓蘇草
6	<i>Gardenia jasminoides</i>	梔子花
7	<i>Agapanthus africanus</i>	百子蓮
8	<i>Angelonia angustifolia</i>	狹葉天使花
9	<i>Belamcanda chinensis</i>	射干
10	<i>Canna indica</i>	美人蕉
11	<i>Hedychium coronarium</i>	薑花
12	<i>Iris tectorum</i>	鳶尾
13	<i>Asclepias curassavica</i>	馬利筋
14	<i>Zephyranthes candida</i>	蔥蘭

The below plant will be considered at the details design stage*		
No.	Species	Chinese Name
EVERGREE SHRUB / GROUND COVER		
1	<i>Codlaecum variegatum</i> <i>Codiaeum variegatum</i>	灑金榕
2	<i>Phyllostachys aurea</i>	羅漢竹
3	<i>Liriope spicata</i>	山麥冬
4	<i>Asaparagua densiflorous "Sprengeri"</i> <i>Asparagus cochinchinensis</i>	天門冬
5	<i>B-Zoysia tenuiflia</i> <i>Zoysia tenuifolia</i>	朝鮮草
ROOFTOP PLANT		
1	<i>Cyanotic cristata</i>	四孔草
2	<i>Callisia repens</i>	洋竹草
3	<i>Portulaca oleracea</i>	馬齒莧

Table 5.3: Planting Schedule

*Note: Species selection will be subject to detail design development & market availability

5.5 Soil Depth, Drainage and Irrigation

- 5.5.1 In order to provide adequate soil depth and to use natural soil mix, 1,200mm soil depth excluding drainage layer for tree planting is designed. In general, the soil depth provided, with all drainage layer, water-proofing and protective screening exclusive is listed below:-

Planting Type	Soil Depth (Minimum)
Tree / Palm Tree	1,200mm
Shrub	600mm
Groundcover	450mm
Turf	300mm

Table 5.4: Soil Depth of Planting Types

- 5.5.2 Drainage system for each planter will be provided and under checked for all planting areas.
- 5.5.3 The irrigation system consists of three parts, i.e. the planters at grade will be served by traditional manual watering with irrigation points. Inaccessible Green roofs will be served by automatic irrigation system.
- 5.5.4 Water points at 20m hose radius will be provided for effective maintenance and watering of plants.

5.6 Landscape Area Provision

- 5.6.1 The Proposed Centre will include about not less than 20% of greenery of landscape area including at-grade green space, outdoor activity lawn and roof green system.

5.7 Site Coverage of Greenery

- 5.7.1 Not less than 20% of greenery (of total site area of 1,110 sq.m.) will be achieved in accordance with the requirement of Buildings Department PNAP (APP-152).



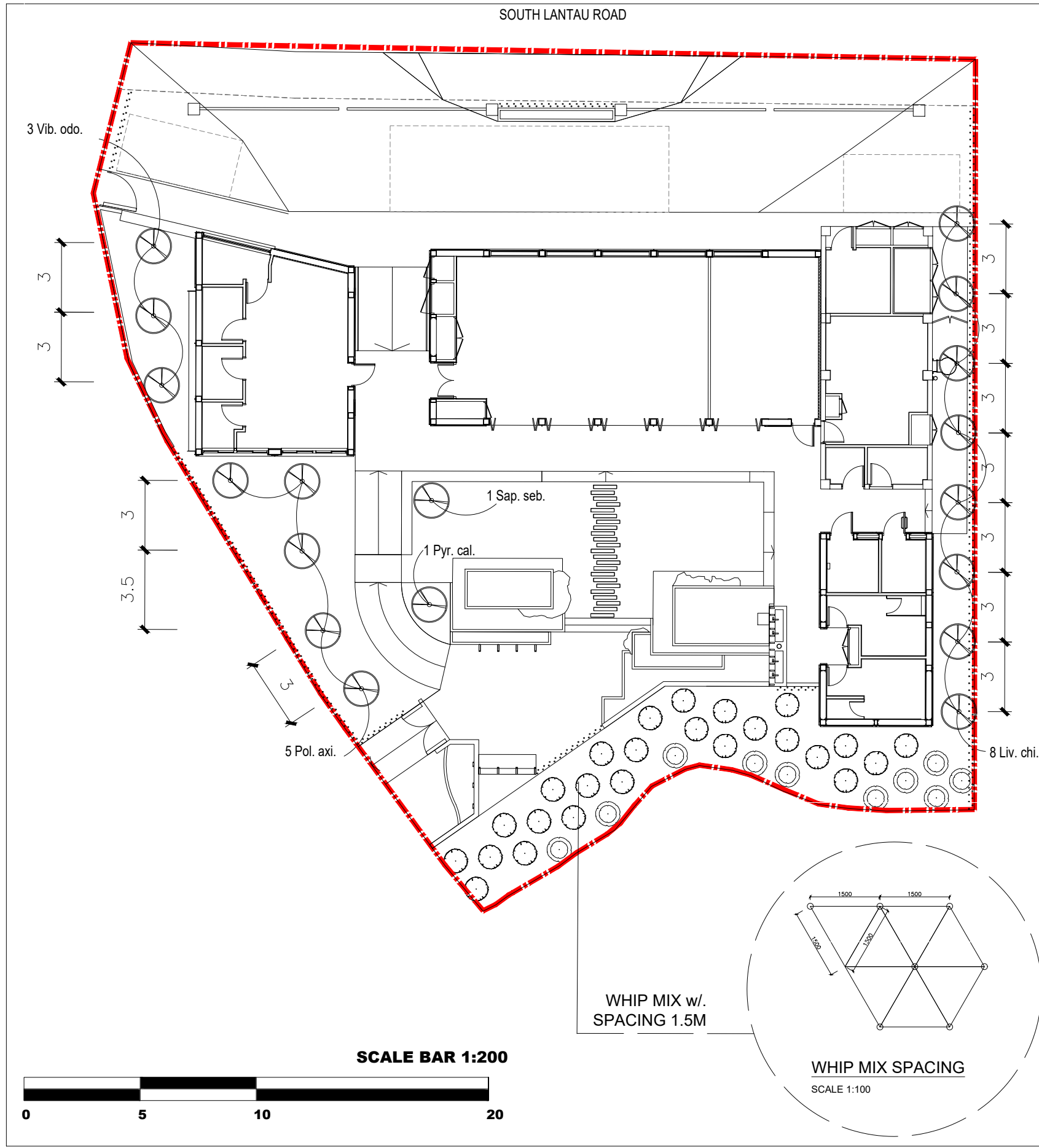

Area of the Site = 1,110 sq.m.

Site Coverage of Greenery Requirements: -

- Minimum Total Greenery Areas = 222 sq.m. (i.e. 20% of Area of the Site)
 - Minimum At-grade Greenery Area = 111 sq.m. (i.e. 10% of Area of the Site)
- 5.7.2 Not less than 20% of greenery will be provided (**Figure 5.7** refers).



LEGEND:

-  COMPENSATED TREE
-  COMPENSATED WHIP MIX
-  COMPENSATED WATER ADOPTABLE WHIP MIX
-  APPLICATION SITE

LEGEND	Botanical Name	Chinese Name	Size (mm)	Quantity
Sap. seb.	<i>Sapium sebiferum</i> (Native)	烏柏	Heavy standard	1
Pol. axi.	<i>Polyspora axillaris</i> (Native)	大頭茶	Heavy standard	5
Liv. Chi.	<i>Livistona chinensis</i> (Exotic)	蒲葵	Heavy standard	8
Pyr. cal.	<i>Pyrus calleryana</i> (Native)	豆梨	Heavy standard	1
Vib. odo.	<i>Viburnum odoratissimum</i> (Native)	珊瑚樹	Heavy standard	3
WHIP MIX	<i>Bridelia tomentosa</i> (Native)	土密樹	Whip mix	6
	<i>Quercus championii</i> (Native)	嶺南青岡	Whip mix	6
	<i>Quercus myrsinifolia</i> or <i>Cyclobalanopsis myrsinifolia</i> (Native)	小葉青岡	Whip mix	7
	<i>Reevesia thyrsoidea</i> (Native)	梭羅樹	Whip mix	6
	<i>Cleistocalyx nervosum</i> (Native)	水翁	Whip mix	10
	Water Adoptable whip			

File Name :
Source :

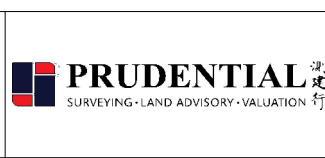

JOB TITLE:
Section 16 Application for Proposed Shui Hau Education Centre on the Approved South Lantau Coast Outline Zoning Plan NO. S/SLC/23 in Shui Hau, Lantau Island, Hong Kong

Drawing Title
Tree Compensatory Plan

-	Submission	18/02/2025	Drawn	WC	Date	26/09/24	Drawing No.
A	Layout Update	10/03/2025	Checked	KC	Approved	KC	Fig. 4.1
Rev	Description	Date	Scale	1:200@A3		Rev.	A

Featured Tree /Compensatory Tree



Sapium sebiferum
烏柏



Pyrus calleryana
豆梨



Polyspora axillaris
大頭茶



Viburnum odoratissimum
珊瑚樹



Quercus myrsinifolia or Cyclobalanopsis myrsinifolia
小葉青岡



Quercus championii
嶺南青岡



Livistona chinensis
蒲葵



Bridelia tomentosa
土密樹



Reevesia thyrsoidea
梭羅樹

Butterfly-Friendly Seasonal Changing Plant

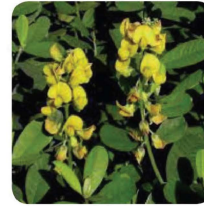

Crotalaria retusa
吊裙草



Lantana camara
馬纓丹



Duranta erecta "Lass"
蕾絲假連翹



Chinese ixora
Ixora chinensis 龍船花



Orthosiphon aristatus
貓蘇草



Gardenia jasminoides
梔子花



Agapanthus africanus
百子蓮



Angelonia angustifolia
狹葉天使花



Belamcanda chinensis
射干

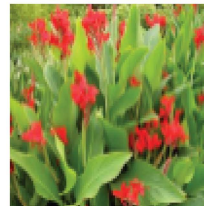

Canna indica
美人蕉



Hedychium coronarium
薑花



Iris tectorum
鳶尾



Asclepias curassavica
馬利筋

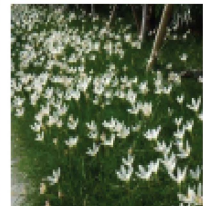

Zephyranthes candida
蔥蘭

Evergreen Shrub/Ground Cover



Codiaeum variegatum
Codiaeum variegatum
灌金榕



Phyllostachys aurea
羅漢竹



Liriope spicata
山麥冬



Asparagus densiflorus Sprengerii
Asparagus cochinchinensis
天門冬



B.Zoysia Tenuifolia
Zoysia tenuifolia
朝鮮草

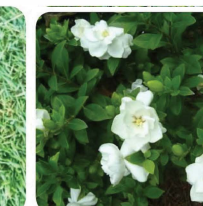

Gardenia jasminoides
梔子花

File Name
Source

Drawn	Date	Drawing No. Fig. 5.4
Checked	Approved	
Rev	Description	Scale 1: 200 @ A3
	Date	Rev.