

Top Bright Consultants Ltd.

Extract Plan Based on Map
Series HM20C of Sheet 2

Location Plan

Scale 1 : 20 000

FIGURE 1

For Identification Purpose

Date: 11.7.2025

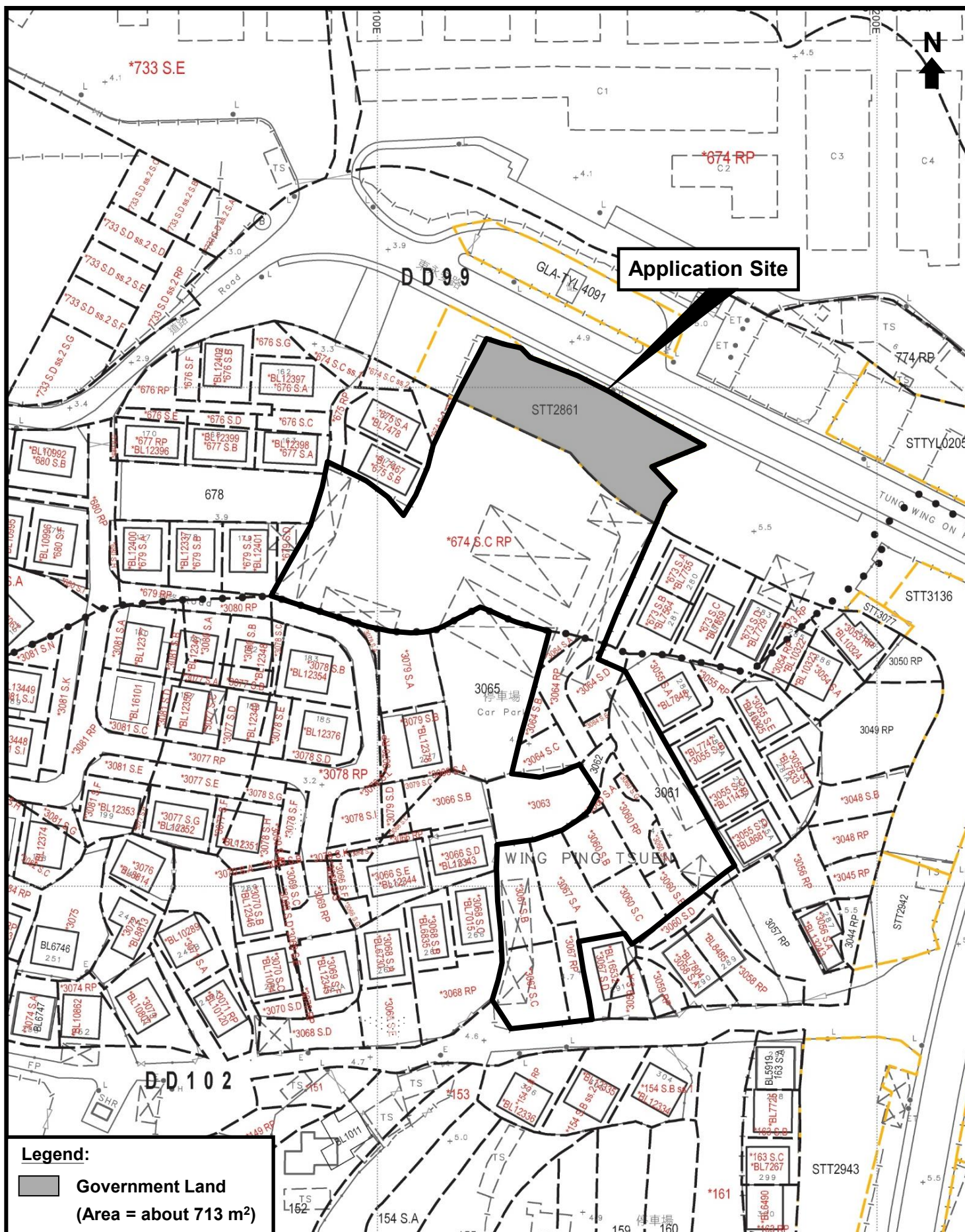

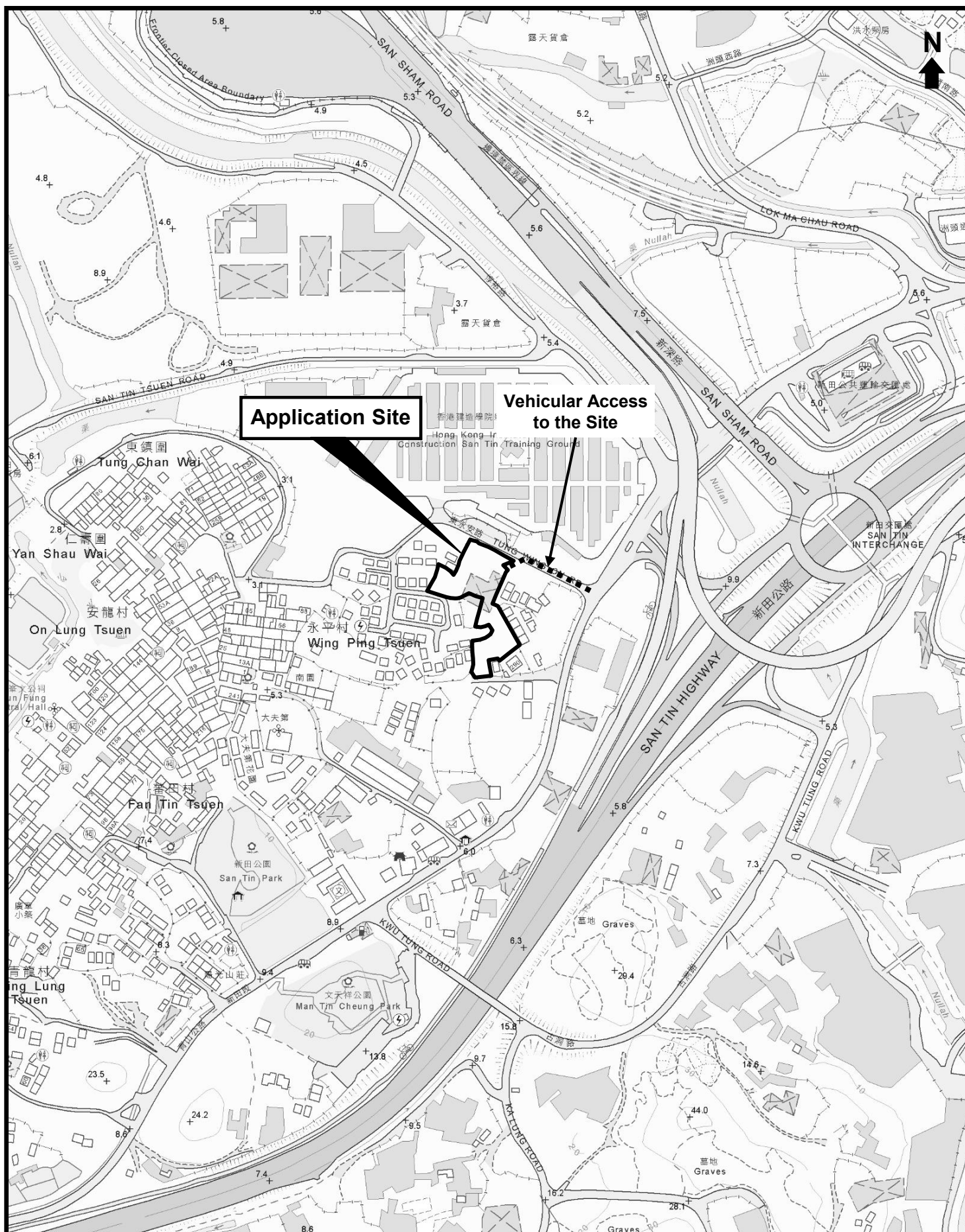

Top Bright Consultants Ltd.

Extracted Plan Based on Map
Series HP5C of Sheet Nos.
2-SE-A & B

Plan Showing the General Area

Scale 1 : 5 000

FIGURE 3

For Identification Purpose

Date: 11.7.2025

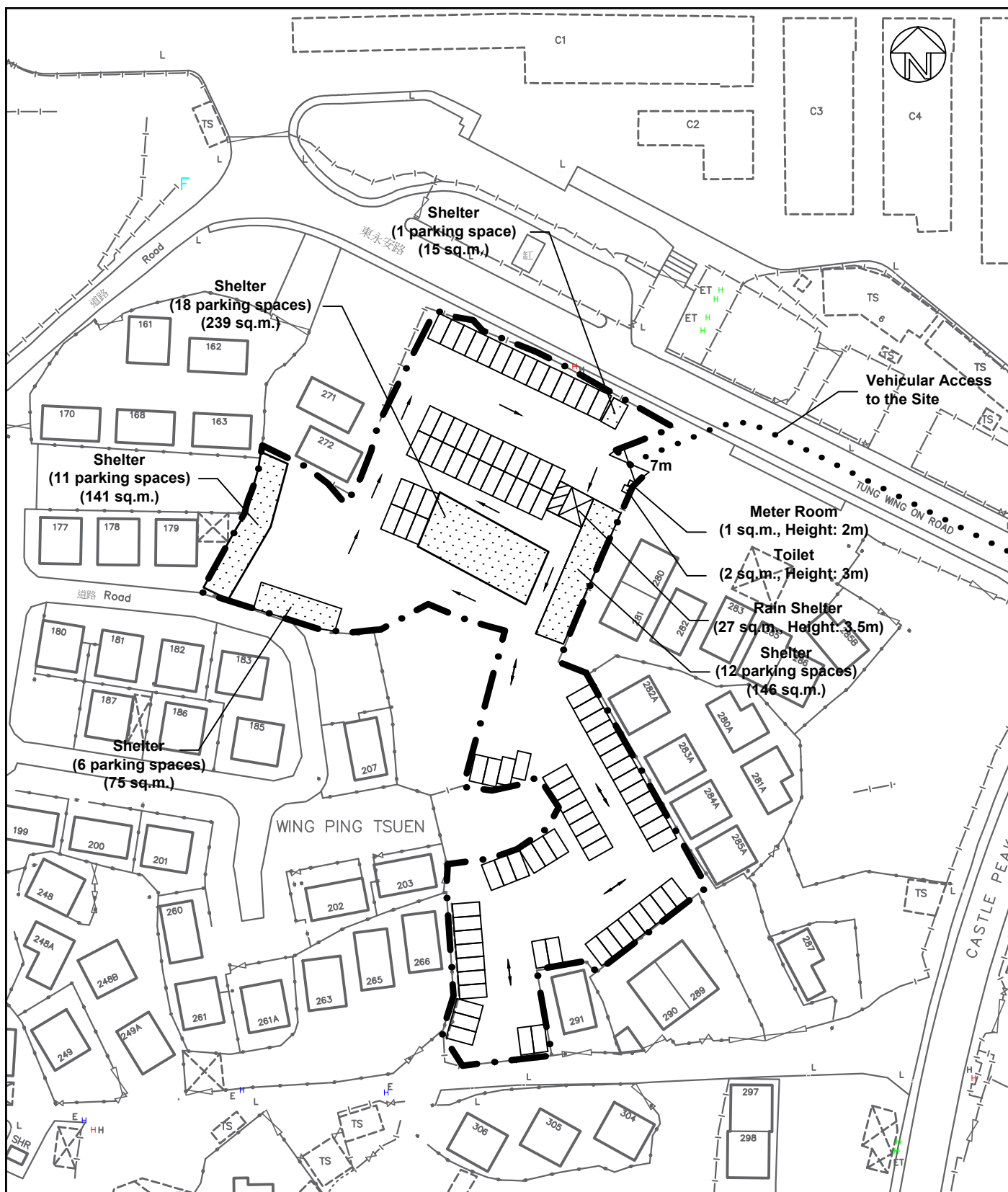

LEGEND:

- Application Site (Area = about 4,955 sq. m.)
- Parking Spaces for Private Vehicles (2.5m x 5m) (142 nos.)
- Shelter for Parking of Private Vehicles (Height: about 2.4m)
- Site Office (15 sq.m. x 2-storey = 30 sq.m., Height: about 5m)



Top Bright Consultants Ltd.

Drawing No. :TB/25/870/05

Layout Plan

Various Lots in D.D. 99 and D.D. 102 and
Adjoining Government Land, San Tin,
Yuen Long, N.T.

FIGURE 5

FOR IDENTIFICATION PURPOSE

Date: 11.7.2025

Scale: 1 : 1000 (A4)