

## Appendix 6

---

Tree Survey

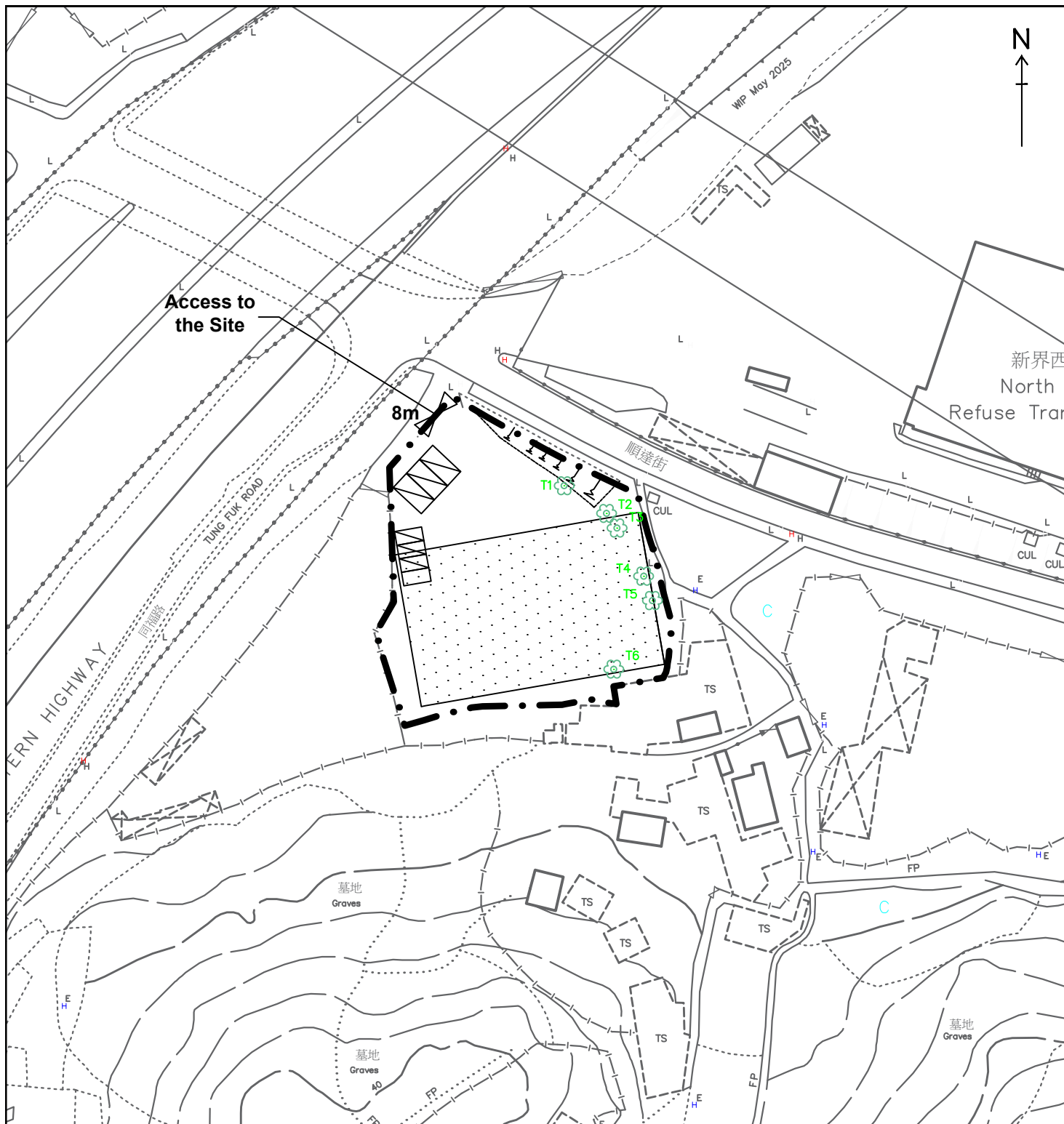

T1



**Existing Trees within the Application Site**

**T1 - T6 Ficus microcarpa (All proposed to be felled)**

**For details, please refer to Tree Assessment Schedule**

**Legend:**



**Application Site (Area: about 2,287m<sup>2</sup>)**

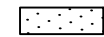

**Warehouse with Ancillary Facilities (Height: not exceeding 13m)**



**Loading/Unloading Spaces for Light Goods Vehicles (3 nos.) (3.5m x 7m)**



**Private Car Parking Spaces for Staff/Visitors (4 nos.) (2.5m x 5m)**

**Existing Trees within the Application Site**

**Figure 6**

**Scale 1:1000**



**羅迅測計師行**

**Lawson David & Sung**

**SURVEYORS LIMITED**

Property Consultants • Planning • Valuers • Auctioneers  
Estate Agency Licence No. C-006328

## Photographic Record of Tree Survey



T1



T2



T3



T4



T5



T6

Tree Survey  
Project Title: Lot 2447 S.A RP in D.D. 130  
Date of survey: 5-12-2025  
Surveyed by: C K Lau Surveyors Limited  
Tree Assessment Schedule

Tree No.	Photo No.	Species		Measurements			Location		Top of soil level above root collar (mPD)	Amenity Values	Form	Health	Structural Condition	Suitability for Transplanting		# Conservation Status	Additional Remarks
		Botanical Name	Chinese Name	Height (m)	Trunk DBH (mm)	Crown Spread (m)	Northing	Easting		(High(H)/ Medium(M) /Low(L)	Good(G)/ Average(A)/ Poor(P)			(High(H)/ Medium(M) /Low(L)	* Remarks		
T1	T1	<i>Ficus microcarpa</i>	細葉榕	7	350	5	817581.988	831464.121	22.7	L	P	A	A	L	a b	Nil	Hangers, wound on trunk, codominant stems
T2	T2	<i>Ficus microcarpa</i>	細葉榕	9	500	8	817589.690	831459.084	22.8	L	A	A	A	L	a b c d	Nil	Codominant stems
T3	T3	<i>Ficus microcarpa</i>	細葉榕	8	520	6	817591.595	831456.419	22.9	L	A	A	A	L	a b	Nil	Codominant stems
T4	T4	<i>Ficus microcarpa</i>	細葉榕	12	400	10	817596.444	831447.656	23.2	L	A	A	A	L	a b c d	Nil	Codominant stems
T5	T5	<i>Ficus microcarpa</i>	細葉榕	12	420	10	817598.031	831443.229	23.4	L	P	A	A	L	a b c d	Nil	Crooked, wound on trunk
T6	T6	<i>Ficus microcarpa</i>	細葉榕	12	350	10	817591.005	831430.752	24.4	L	P	P	P	L	a b c d	Nil	Restricted root, Significant diebacks, crooked, epicormics

**\* Remarks for suitability for transplanting**  
a) low amenity value;  
b) irrecoverable form after transplanting (e.g. if substantial crown and root pruning are necessary to facilitate the transplanting)  
c) low survival rate after transplanting;  
d) very large size (unless the feasibility to transplant has been considered financially reasonable and technically feasible during the feasibility stage);  
e) with evidence of over-maturity and onset of senescence;  
f) with poor health, structure or form (e.g. imbalanced form, leaning, with major cavity/cracks/splits);  
g) undesirable species (e.g. Leucaena leucocephala which is an invasive exotic tree), or  
h) on steep slope.  
i) trees grown under poor conditions which have limited the formation of proper root ball necessary for transplanting

**#Conservation status**  
(A) The Protection of Endangered Species of Animals and Plants Ordinance (Cap.586)  
(B) Forests and Countryside Ordinance (Cap. 96)  
(C) Rare and Precious Plants of Hong Kong  
(D) IUCN Red List of Threatened Species