

LIST OF PLANS

Plan 1	Location plan
Plan 2	Zoning plan
Plan 3	Land status plan
Plan 4	Original Premises – location and zoning
Plan 5	Original Premises – NDA phasing and resumption
Plan 6	Alternative sites for relocation
Plan 7	Aerial photo
Plan 8	Layout plan
Plan 9	Plan showing the filling of land
Plan 10	Swept path analysis

LOCATION OF THE APPLICATION SITE

APPLICATION SITE AREA : 1,379 m² (ABOUT)

VEHICULAR ACCESS
ACCESSIBLE FROM KONG SHAM WESTERN HIGHWAY
VIA A LOCAL ACCESS

施工中
Works in progress

ACCESSIBLE FROM KONG SHAM WESTERN HIGHWAY VIA A LOCAL ACCESS

APPLICATION SITE

廈村
HA TSUEN

祥降圍
Tseung Kong Wai

LEGEND

APPLICATION SITE

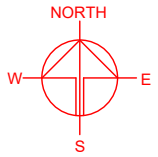

PLANNING CONSULTANT



PROJECT

PROPOSED WAREHOUSE WITH ANCILLARY FACILITIES AND ASSOCIATED FILLING OF LAND FOR A PERIOD OF 3 YEARS
TEMPORARY (EXCLUDING DANGEROUS GOODS GODOWN)

SITE LOCATION

VARIOUS LOTS IN D.D. 125 AND ADJOINING GOVERNMENT LAND, HA TSUEN, YUEN LONG, NEW TERRITORIES

SCALE

1 : 5000 @ A4

DRAWN BY

MN

DATE

12.3.2026

CHECKED BY

DATE

APPROVED BY

DATE

DWG. TITLE

LOCATION PLAN

DWG. NO.

PLAN 1

VER.

001

*SITE BOUNDARY FOR IDENTIFICATION PURPOSE ONLY.

ZONING OF THE APPLICATION SITE

APPLICATION SITE AREA : 1,379 m² (ABOUT)
 OUTLINE ZONING PLAN : APPROVED HA TSUEN FRINGE OZP
 OZP PLAN NO. : SYL-HTF/12
 ZONING OF THE SITE : "GREEN BELT" ("GB")

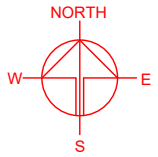
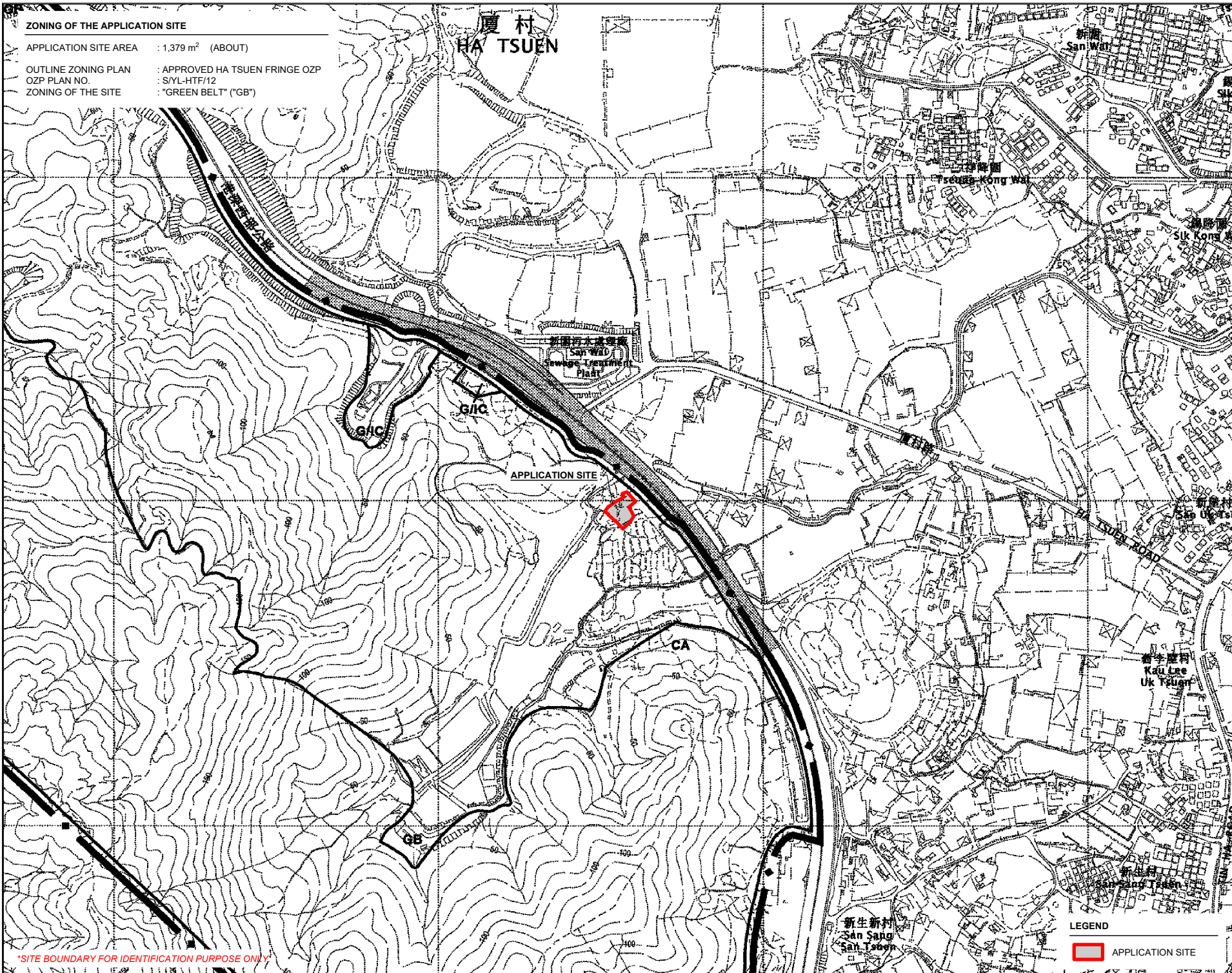

PLANNING CONSULTANT



PROJECT
 PROPOSED WAREHOUSE (EXCLUDING DANGEROUS GOODS GODOWN) WITH ANCILLARY FACILITIES AND ASSOCIATED FILLING OF LAND FOR A PERIOD OF 3 YEARS
 TEMPORARY (EXCLUDING DANGEROUS GOODS GODOWN) WITH ANCILLARY FACILITIES AND ASSOCIATED FILLING OF LAND FOR A PERIOD OF 3 YEARS

SITE LOCATION
 VARIOUS LOTS IN D.D. 125 AND ADJOINING GOVERNMENT LAND, HA TSUEN, YUEN LONG, NEW TERRITORIES

SCALE
 1: 7500 @ A4

DRAWN BY MN	DATE 12.3.2026
CHECKED BY	DATE
APPROVED BY	DATE

DWG. TITLE
 ZONING PLAN

DWG NO. PLAN 2	VER. 001
-------------------	-------------

LEGEND
 APPLICATION SITE

*SITE BOUNDARY FOR IDENTIFICATION PURPOSE ONLY

LOCATION OF THE ORIGINAL PREMISES

● VARIOUS LOTS IN D.D. 124, HUNG SHUI KIU, YUEN LONG, NEW TERRITORIES

LOCATION OF THE APPLICATION SITE

● VARIOUS LOTS IN D.D. 125 AND ADJOINING GOVERNMENT LAND, HA TSUEN, YUEN LONG, NEW TERRITORIES

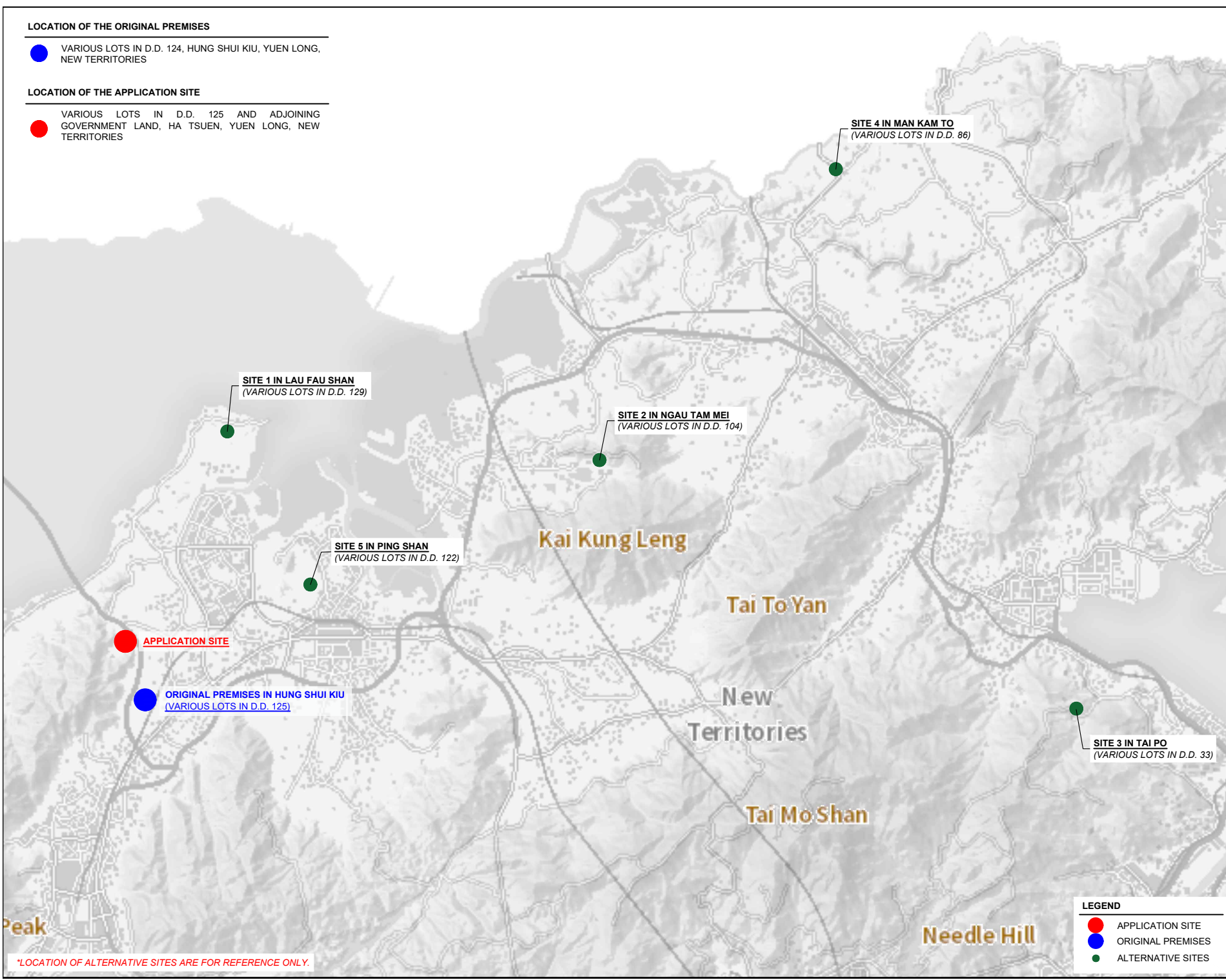
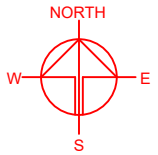

SITE 1 IN LAU FAU SHAN
(VARIOUS LOTS IN D.D. 129)

SITE 2 IN NGAU TAM MEI
(VARIOUS LOTS IN D.D. 104)

SITE 4 IN MAN KAM TO
(VARIOUS LOTS IN D.D. 86)

SITE 5 IN PING SHAN
(VARIOUS LOTS IN D.D. 122)

APPLICATION SITE

ORIGINAL PREMISES IN HUNG SHUI KIU
(VARIOUS LOTS IN D.D. 125)

SITE 3 IN TAI PO
(VARIOUS LOTS IN D.D. 33)

LEGEND

- APPLICATION SITE
- ORIGINAL PREMISES
- ALTERNATIVE SITES

*LOCATION OF ALTERNATIVE SITES ARE FOR REFERENCE ONLY.

PLANNING CONSULTANT



PROJECT

PROPOSED WAREHOUSE (EXCLUDING DANGEROUS GOODS GODOWN) WITH ANCILLARY FACILITIES AND ASSOCIATED FILLING OF LAND FOR A PERIOD OF 3 YEARS

SITE LOCATION

VARIOUS LOTS IN D.D. 125 AND ADJOINING GOVERNMENT LAND, HA TSUEN, YUEN LONG, NEW TERRITORIES

SCALE
INDICATIVE ONLY

DRAWN BY LT	DATE 12.3.2026
CHECKED BY	DATE
APPROVED BY	DATE

DWG. TITLE
ALTERNATIVE SITES

DWG NO. PLAN 6	VER. 001
-------------------	-------------

EXISTING CONDITION OF THE APPLICATION SITE

APPLICATION SITE AREA : 1,379 m² (ABOUT)

SOURCE OF AERIAL PHOTO : TPB STATUTORY PLANNING PORTAL 3

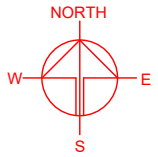

APPLICATION SITE

KONG SHAM WESTERN HIGHWAY

PLANNING CONSULTANT



PROJECT

PROPOSED WAREHOUSE (EXCLUDING DANGEROUS GOODS GODOWN) WITH ANCILLARY FACILITIES AND ASSOCIATED FILLING OF LAND FOR A PERIOD OF 3 YEARS

SITE LOCATION

VARIOUS LOTS IN D.D. 125 AND ADJOINING GOVERNMENT LAND, HA TSUEN, YUEN LONG, NEW TERRITORIES

SCALE
1 : 1000 @ A4

DRAWN BY: MN DATE: 12.3.2026

CHECKED BY: DATE:

APPROVED BY: DATE:

DWG. TITLE
AERIAL PHOTO OF THE SITE

DWG NO.: PLAN 7 VER.: 001

LEGEND

 APPLICATION SITE

*SITE BOUNDARY FOR IDENTIFICATION PURPOSE ONLY.

DEVELOPMENT PARAMETERS

APPLICATION SITE AREA	: 1,379 m ²	(ABOUT)
COVERED AREA	: 545 m ²	(ABOUT)
UNCOVERED AREA	: 834 m ²	(ABOUT)
PLOT RATIO	: 0.4	(ABOUT)
SITE COVERAGE	: 40 %	(ABOUT)
NO. OF STRUCTURE	: 3	
DOMESTIC GFA	: NOT APPLICABLE	
NON-DOMESTIC GFA	: 545 m ²	(ABOUT)
TOTAL GFA	: 545 m ²	(ABOUT)
BUILDING HEIGHT	: 8 m	(ABOUT)
NO. OF STOREY	: 1	

STRUCTURE	USE	COVERED AREA	GROSS FLOOR AREA	BUILDING HEIGHT
B1	WAREHOUSE (EXCL. D.G.G.)	216 m ² (ABOUT)	216 m ² (ABOUT)	8 m (ABOUT)(1-STOREY)
B2	WAREHOUSE (EXCL. D.G.G.)	180 m ² (ABOUT)	180 m ² (ABOUT)	8 m (ABOUT)(1-STOREY)
B3	WAREHOUSE (EXCL. D.G.G.) SITE OFFICE AND WASHROOM	149 m ² (ABOUT)	149 m ² (ABOUT)	8 m (ABOUT)(1-STOREY)
TOTAL		545 m² (ABOUT)	545 m² (ABOUT)	

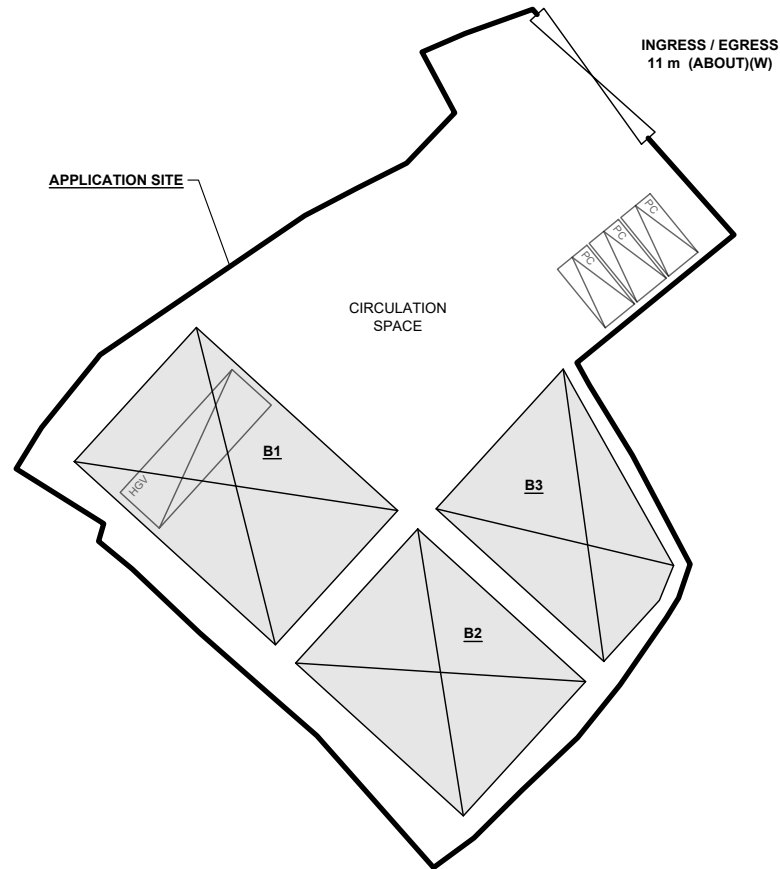
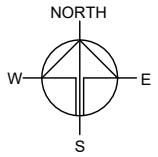

PARKING PROVISIONS

NO. OF PRIVATE CAR PARKING SPACE	: 3
DIMENSION OF PARKING SPACE	: 5 m (L) X 2.5 m (W)

LOADING/UNLOADING PROVISIONS

NO. OF L/UL SPACE FOR HEAVY GOODS VEHICLE	: 1
DIMENSION OF L/UL SPACE	: 11 m (L) X 3.5 m (W)

*SITE BOUNDARY FOR IDENTIFICATION PURPOSE ONLY.

LEGEND

- APPLICATION SITE
- STRUCTURE
- PARKING SPACE (PRIVATE CAR)
- L/UL SPACE (HEAVY GOODS VEHICLE)
- INGRESS / EGRESS

PLANNING CONSULTANT



PROJECT

PROPOSED WAREHOUSE (EXCLUDING DANGEROUS GOODS GODOWN) WITH ANCILLARY FACILITIES AND ASSOCIATED FILLING OF LAND FOR A PERIOD OF 3 YEARS

SITE LOCATION

VARIOUS LOTS IN D.D. 125 AND ADJOINING GOVERNMENT LAND, HA TSUEN, YUEN LONG, NEW TERRITORIES

SCALE

1 : 2000 @ A4

DRAWN BY	DATE
MN	12.3.2026

CHECKED BY	DATE

APPROVED BY	DATE

DWG. TITLE
LAYOUT PLAN

DWG NO.	VER.
PLAN 8	001

EXISTING CONDITION OF THE APPLICATION SITE

APPLICATION SITE AREA : 1,379 m² (ABOUT)
 EXISTING SITE LEVELS : +18.0 mPD (ABOUT)
 AREA COVERED BY SOIL : 1,379 m² (ABOUT)

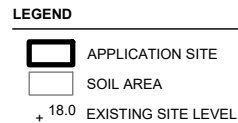
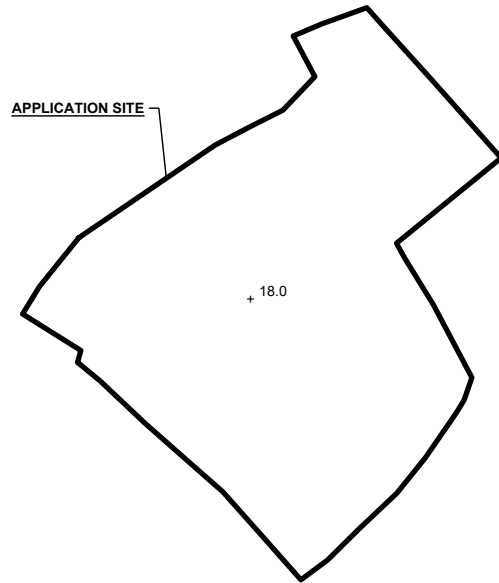

*SITE LEVELS ARE FOR REFERENCE ONLY.
 EXACT SITE LEVELS ARE SUBJECT TO DETAILED SURVEY.

PROPOSED FILLING OF LAND AT THE APPLICATION SITE

APPLICATION SITE AREA : 1,379 m² (ABOUT)
 FILLING OF LAND AREA : 1,379 m² (ABOUT)
 MATERIAL OF FILLING : CONCRETE
 DEPTH OF LAND FILLING : NOT MORE THAN 0.2 m
 SITE LEVELS : +18.2 mPD (ABOUT)
 USE : PARKING AND LOADING / UNLOADING SPACE,
 SITE FORMATION OF STRUCTURES AND
 CIRCULATION SPACE

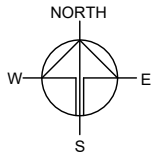
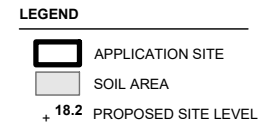
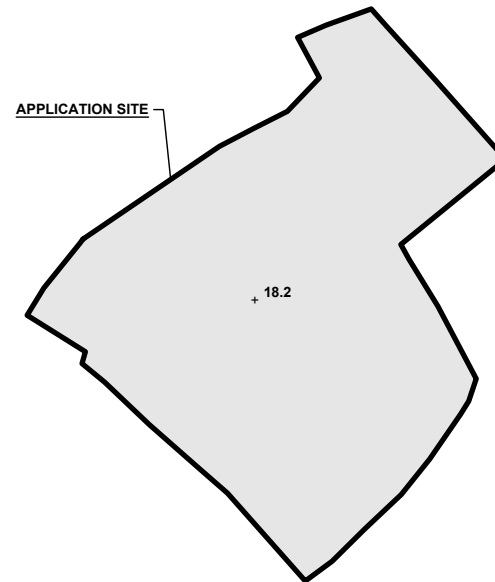

PLANNING CONSULTANT



PROJECT

PROPOSED TEMPORARY WAREHOUSE (EXCLUDING DANGEROUS GOODS GODOWN) WITH ANCILLARY FACILITIES AND ASSOCIATED FILLING OF LAND FOR A PERIOD OF 3 YEARS

SITE LOCATION

VARIOUS LOTS IN D.D. 125 AND ADJOINING GOVERNMENT LAND, HA TSUEN, YUEN LONG, NEW TERRITORIES

SCALE

1 : 750 @ A4

DRAWN BY	DATE
MN	12.3.2026

REVISED BY	DATE

APPROVED BY	DATE

DWG. TITLE
 FILLING OF LAND

DWG NO. PLAN 9	VER. 001
-------------------	-------------

SWEPT PATH ANALYSIS

TYPE OF VEHICLE : HEAVY GOODS VEHICLE
 DIMENSION OF VEHICLE : 3.5 m (W) X 11 m (L)

SWEPT PATHS GENERATED BY AUTODESK VEHICLE TRACKING

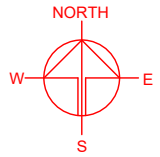
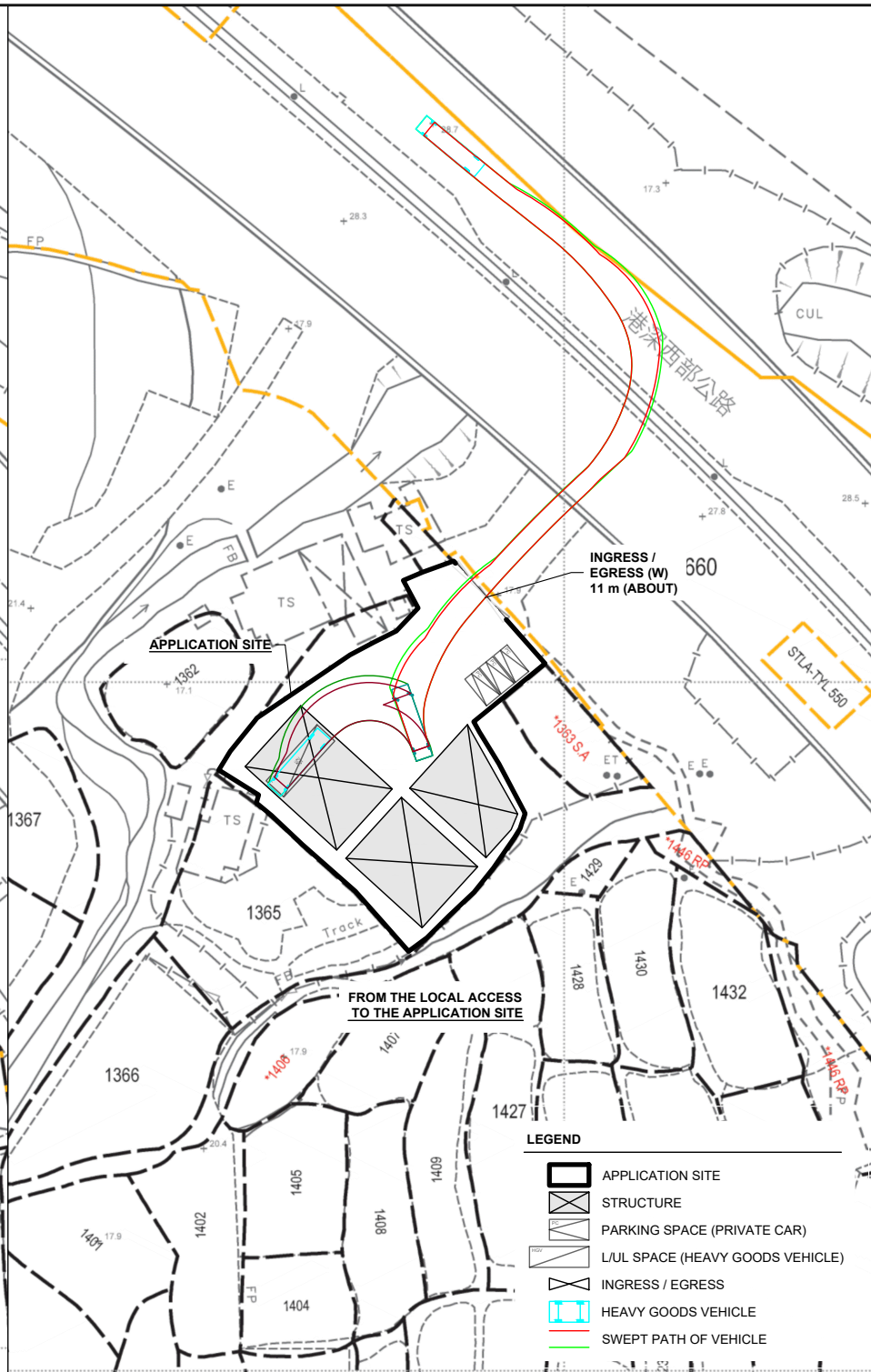
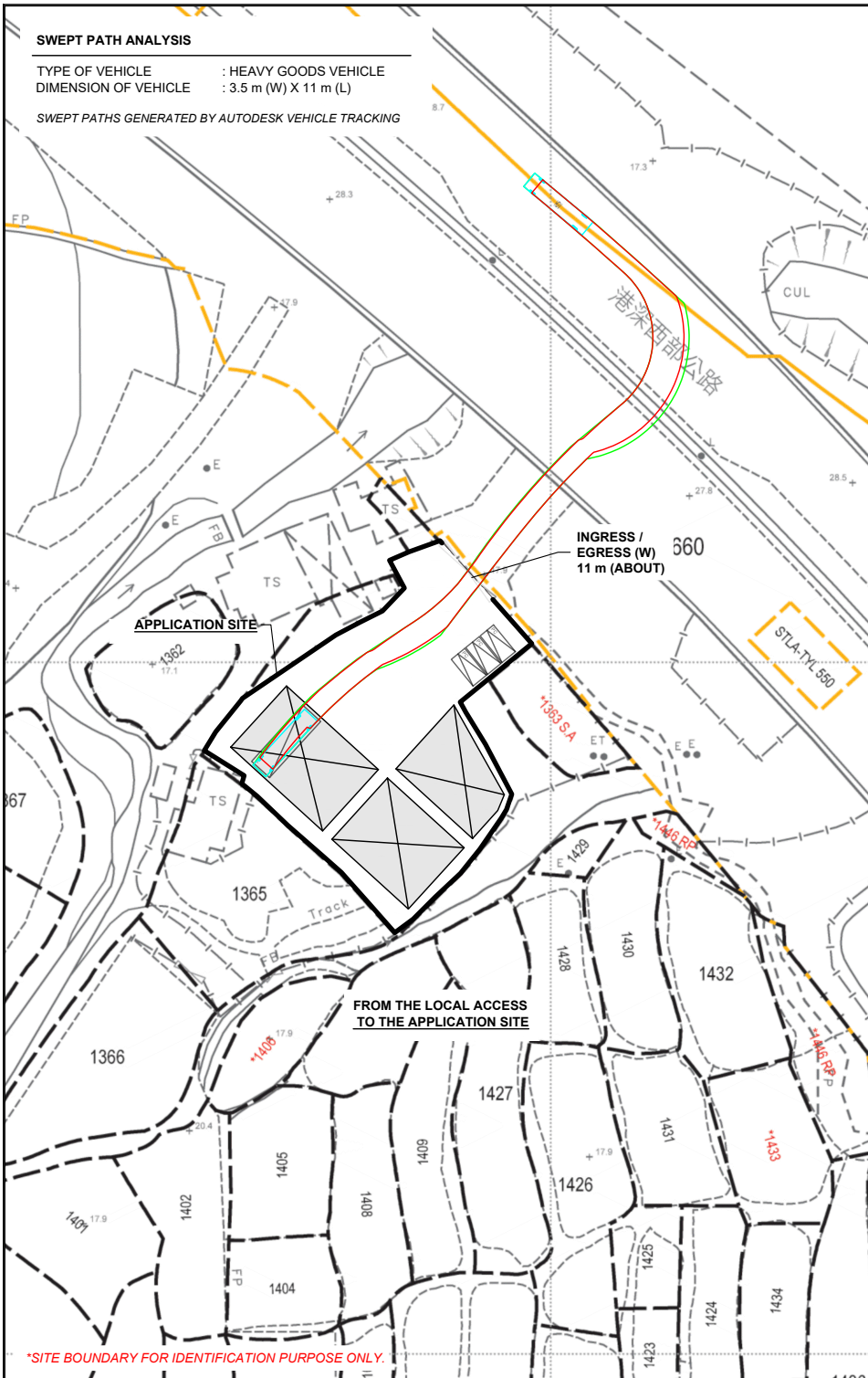

PLANNING CONSULTANT



PROJECT

PROPOSED WAREHOUSE (EXCLUDING DANGEROUS GOODS GODOWN) WITH ANCILLARY FACILITIES AND ASSOCIATED FILLING OF LAND FOR A PERIOD OF 3 YEARS

SITE LOCATION

VARIOUS LOTS IN D.D. 125 AND ADJOINING GOVERNMENT LAND, HA TSUEN, YUEN LONG, NEW TERRITORIES

SCALE

1: 1000 @ A4

DRAWN BY: MN DATE: 12.3.2026

REVISED BY: DATE:

APPROVED BY: DATE:

DWG. TITLE
 SWEEP PATH ANALYSIS

DWG. NO.: PLAN 10 VER.: 001

LEGEND

- APPLICATION SITE
- STRUCTURE
- PARKING SPACE (PRIVATE CAR)
- LUL SPACE (HEAVY GOODS VEHICLE)
- INGRESS / EGRESS
- HEAVY GOODS VEHICLE
- SWEEP PATH OF VEHICLE

*SITE BOUNDARY FOR IDENTIFICATION PURPOSE ONLY.