

寄件者: Anson Lee [REDACTED]  
寄件日期: 2025年08月06日星期三 17:52  
收件者: tpbpd/PLAND  
副本: David Chi Chiu CHENG/PLAND  
主旨: RE: S. 16 Planning Application no. A/YL-KTN/1133 - Further Information  
附件: 2648AL04.pdf  
  
類別: Internet Email

To: TPB

Dear sir/madam,

Please see the attached FI submission for the captioned planning application.

Regards,

Anson Lee  
Lanbase Surveyors Limited

---

Our Ref.: YL/TPN/2648A/L04

6 August 2025

Secretary  
Town Planning Board  
15/F, North Point Government Offices  
333 Java Road, North Point  
Hong Kong

**By Post and Email**

Dear Sir/Madam,

**Planning Application for  
“Temporary Shop and Services (Vehicle Showrooms, Sales of Second-Hand Private  
Cars, Vehicle Parts and Accessories) with Ancillary Facilities”  
For a Period of 3 Years  
Lot No. 4202RP(Part) in D.D. 104  
Long Ha, Yuen Long, New Territories  
(Planning Application No. A/YL-KTN/1133)**

We refer to the captioned planning application.

We would like to supersede our previous letter (Ref.: YL/TPN/2648A/L03) dated 6 August 2025 and submit herewith a set of “Response-to-Comments” in response to the government departmental comments for the captioned planning application.

Should you have any queries, please feel free to call our Mr. Anson Lee at [REDACTED].  
Thank you for your kind attention.

Yours faithfully,  
For and on behalf of  
LANBASE SURVEYORS LIMITED

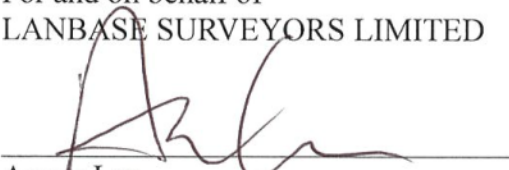
  
Anson Lee  
RK/AL  
Encl.

c.c.  
DPO/FSS & YLE (Attn.: Mr. David Cheng By Email )

### Response-to-Comments

	Departmental Comments	Responses
	<b><u>Transport Department (TD)</u></b> <b>(Contact: Mr. Donald LEUNG at 2399-2778)</b>	
(1)	It is noted that visitors will only be accepted by appointment. Considering the site location and the nature of the shop, it is reasonable to assume that majority of the visitors will (or prefer) to drive to the site. Please clarify whether parking spaces will be provided to the visitors with appointment. If not, please clarify how to handle the visitors come by driving.	Noted. For handling the visitors coming by driving with appointment, the Applicant would provide a visitor car parking space (private car) within car showroom. Please see the attached revised Layout Plan.  The Applicant will request the visitor to make efficient use of public transport to visit the site rather than driving in order to avoid illegal parking outside the site.
	<b><u>DPO/FSS&amp;YLE, Planning Department (PlanD)</u></b> <b>(Contact: Mr. David Cheng at 3168-4046)</b>	
(1)	Please undertake that no heavy vehicle or container vehicle will be involved within the application site.	The Applicant undertakes that no heavy vehicle or container vehicle will be involved within the application site.



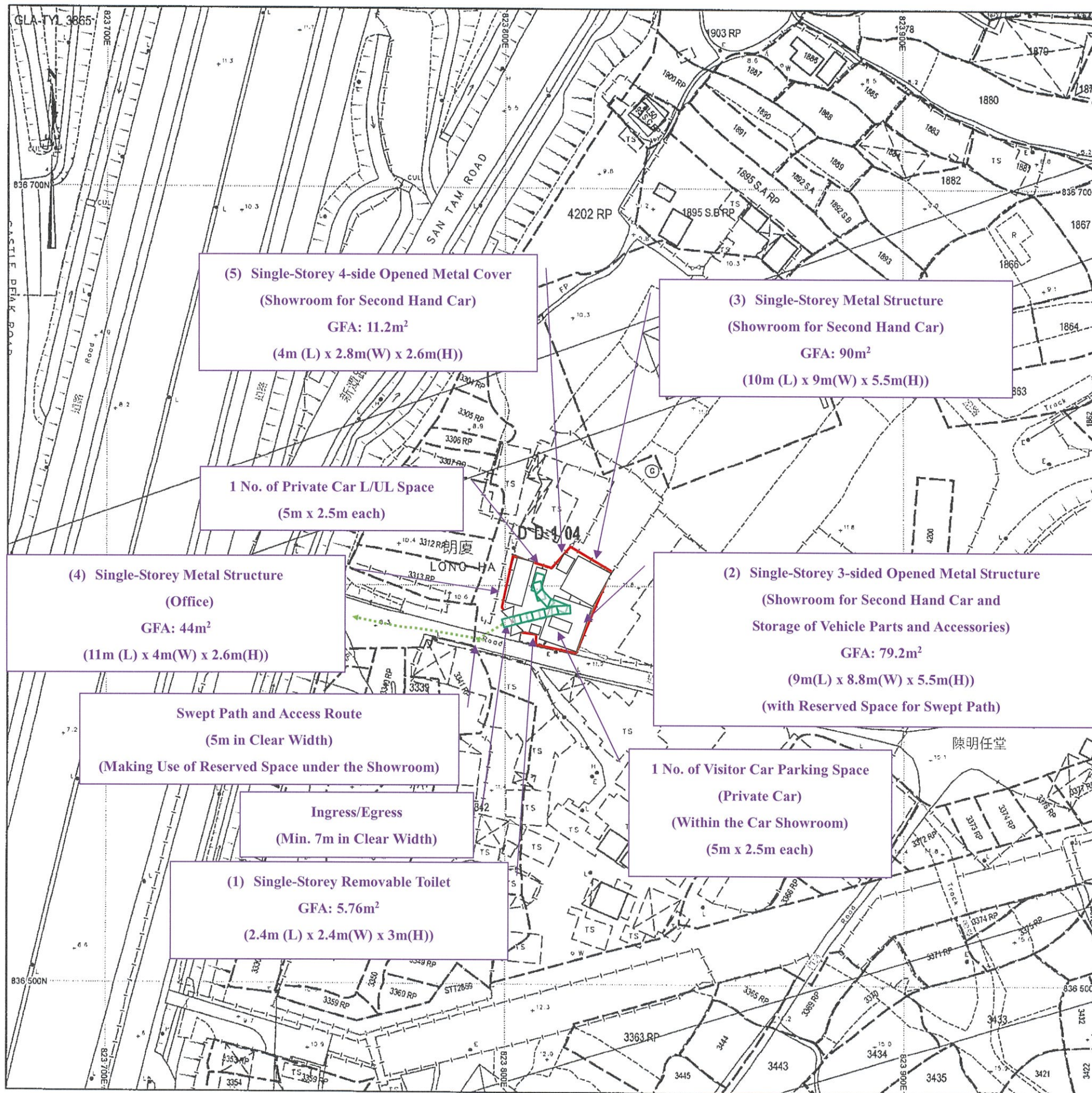

 Application Site

## 地段索引圖 LOT INDEX PLAN

摘要說明：本地段索引圖在其背景的地形圖上標示了各種永久和短期持有的土地的圖像界線。這些土地包括私人地段、政府撥地、短期租約批地，以及其他作核准用途的土地。請注意：(1)本索引圖上的資料會被不時更新而不作事先通知；(2)索引圖的更新或會延後於有關資料的實際變更；以及(3)本索引圖中顯示的界線僅供識別之用，資料是否準確可靠，應徵詢專業土地測量師的意見。  
免責說明：如因使用本地段索引圖，或因所依據的本索引圖資料出錯、遺漏、過時或有誤差而引致任何損失或損害，政府概不承擔任何法律責任。

**Explanatory notes:** This plan shows the graphical boundaries of different kinds of permanent and temporary land holdings with the topographic map in the backdrop. The land holdings as shown may include private lots, government land allocations, short term tenancies and other permitted uses of land. It must be noted that: (1) the information shown on this plan is subject to update without prior notification; (2) there may be time lag between an update and the related changes taken place; and (3) the graphical boundaries as shown are for identification purpose only and interpretation of their accuracy and reliability requires the advice from professional land surveyor.  
**Disclaimer:** The Government shall not be responsible for any loss or damage howsoever arising from the use of this plan or in reliance upon its correctness, completeness, timeliness or accuracy.



地政總署測繪處  
Survey and Mapping Office  
Lands Department

香港特別行政區政府 — 版權所有  
© Copyright reserved — Hong Kong SAR Government

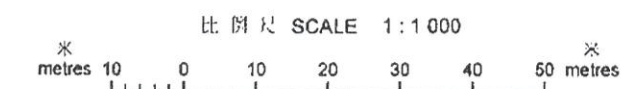

Locality :
Lot Index Plan No. : ags_S00000099880_0001
District Survey Office : Lands Information Center
Date :06-Sep-2022
Reference No. : 2-SE-21B,2-SE-21D