

寄件者: lo mingkong [REDACTED]
寄件日期: 2025年09月08日星期一 17:57
收件者: tpbpd/PLAND
副本: Andrea Wing Yin YAN/PLAND; 'leungyh@yahoo.com'
主旨: (A/YL-KTN/1151) Further Information
附件: TPB_L03 FSIs Proposal.pdf; KTN_1151-FSIs Proposal.REV A.pdf

類別: Internet Email

Dear Sir/Madam,

Referring to the captioned application, we submit the Fire Service Installations (FSIs) Proposal for your reference.

Should you have any queries or require further information, please feel free to contact the undersigned at [REDACTED]

Best Regards,

Lo Ming Kong
Top Bright Consultants Ltd.
[REDACTED]



才鴻顧問有限公司
TOP BRIGHT CONSULTANTS LIMITED

Your Ref.: A/YL-KTN/1151

Our Ref.: 25/858/L03

September 8, 2025

Secretary
Town Planning Board
15/F., North Point Government Offices
333 Java Road, North Point
Hong Kong

By Email

Dear Sir/Madam,

Temporary Place of Recreation, Sports or Culture with Ancillary Facilities and Associated Filling of Land for a Period of 3 Years in “Agriculture” and “Village Type Development” Zones, Lots 655(Part), 656(Part), 657(Part), 668(Part), 669(Part), 671(Part), 672SA(Part), 674(Part), 678(Part), 679(Part), 680(Part), 681, 682(Part), 684RP(Part), 763SA(Part), 763RP(Part), 764, 765, 766(Part), 768(Part), 769(Part), 770(Part), 771(Part), 772(Part), 781(Part), 782(Part), 783(Part), 784(Part), 785(Part), 786(Part), 787, 788(Part), 1615(Part) and Adjoining Government Land in DD109, Shui Mei Tsuen, Kam Tin North, Yuen Long, New Territories

Dear Sir/Madam,

Referring to the captioned application, we submit the Fire Service Installations Proposal (FSIs Proposal) for your reference.

Should you have any queries or require further information, please feel free to contact the undersigned at [REDACTED]

Yours faithfully,

For and on behalf of
Top Bright Consultants Ltd.

Lo Ming Kong

Encl.
c.c. Kam Tin Country Club Ltd. (the Applicant)



FIRE SERVICES NOTES:

1. EMERGENCY LIGHTING
- 1.1 SUFFICIENT EMERGENCY LIGHTING WITH 2 HOURS BATTERY BACKUP SHALL BE PROVIDED THROUGHOUT THE ENTIRE BUILDINGS/STRUCTURES IN ACCORDANCE WITH BS 5266:–1:2016 AND BS EN 1838:2013 AND THE FSD CIRCULAR LETTER NO. 4/2021.
2. EXIT SIGN
- 2.1 SUFFICIENT DIRECTIONAL AND EXIT SIGN SHALL BE PROVIDED IN ACCORDANCE WITH BS 5266:–1:2016 AND FSD CIRCULAR LETTER 5/2008.
3. MISCELLANEOUS F.S. INSTALLATION
- 3.1 PORTABLE FIRE EXTINGUISHERS WITH SPECIFIED TYPE AND CAPACITY TO BE PROVIDED AT LOCATION AS INDICATED ON PLAN.
- 3.2 NO EMERGENCY GENERATOR TO BE PROVIDED FOR SERVING THE EMERGENCY POWER. DUPLICATED POWER SUPPLIES FOR ALL FIRE SERVICES INSTALLATIONS COMPRISING A CABLE CONNECTED FROM ELECTRICITY MAINS DIRECTLY BEFORE THE MAIN SWITCH.
- 3.2 WHEN A VENTILATION / AIR CONDITIONING CONTROL SYSTEM TO A BUILDING IS PROVIDED, IT SHALL STOP MECHANICALLY INDUCED AIR MOVEMENT WITHIN A DESIGNATED FIRE COMPARTMENT.
- 3.3 NO DYNAMIC SMOKE EXTRACTION SYSTEM SHALL BE PROVIDED SINCE FIRE COMPARTMENT EXCEEDING 7000 CUBIC METRES AND THE AGGREGATE AREA OF OPENABLE WINDOWS OF THE RESPECTIVE COMPARTMENT EXCEEDS 6.25% OF THE FLOOR AREA OF THAT COMPARTMENT.

LEGEND (FOR LAYOUT PLAN)

- F.E_{CO2}

F.E_{D,P}

S.B.

5Kg CO2 TYPE FIRE EXTINGUISHER
4Kg DRY POWDER TYPE FIRE EXTINGUISHER
SAND BUCKET
- EMERGENCY LIGHTING
EXIT SIGN

ABBREVIATION

- SPR. SPRINKLER
- H.R. HOSE REEL
- F.E. FIRE EXTINGUISHER
- CO₂ CARBON DIOXIDE
- L.P.C. LOSS PREVENTION COUNCIL
- F.S.I. FIRE SERVICES INSTALLATION
- H/L HIGH LEVEL
- M/L MID LEVEL
- L/L LOW LEVEL
- F/B FROM BELOW
- F/A FROM ABOVE
- T/A TO ABOVE
- T/B TO BELOW
- U/G UNDERGROUND
- F.S. FIRE SERVICES

DRAWING LIST

DRAWING NO	DESCRIPTION
EP–20349–FS01	FS NOTES, LEGEND, ABBREVIATIONS AND DRAWING LIST
EP–20349–FS02	PROPOSED FSI LAYOUT PLAN

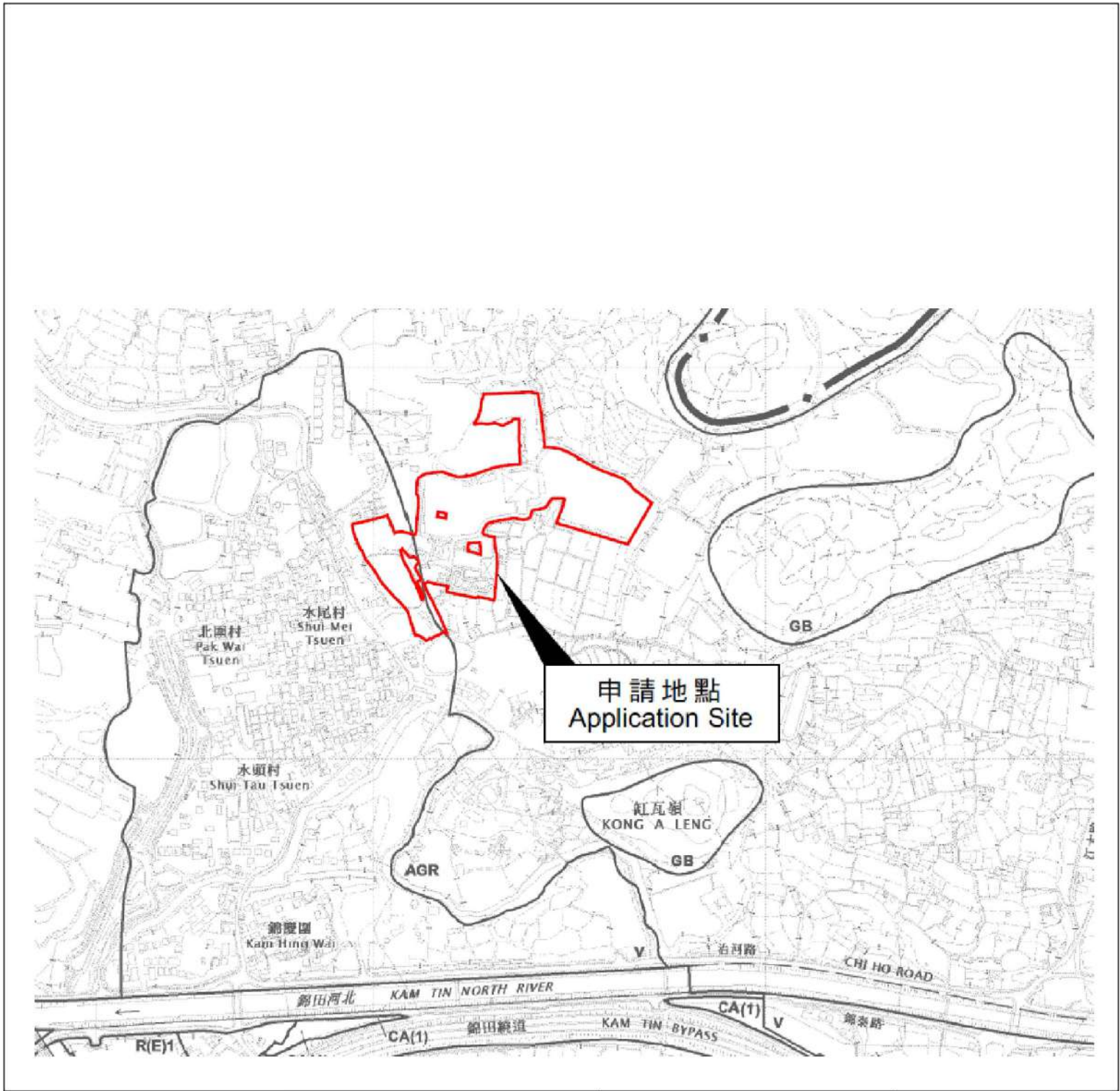

LOCATION PLAN (SCALE : N.T.S)

A	FSD SUBMISSION	07–09–2025	WC
REV	DESCRIPTION	DATE	BY

FSI CONTRACTOR

East Power Engineering Limited

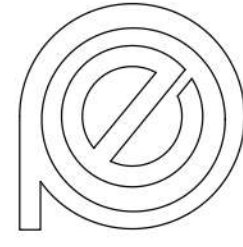

PROJECT

VARIOUS LOTS IN D.D.109 AND ADJOINING GOVERNMENT LAND, SHUI MEI TSUEN, KAM TIN NORTH, YUEN LONG, NEW TERRITORIES

DRAWING TITLE

FS NOTES, LEGEND, ABBREVIATIONS AND DRAWING LIST

	INITIAL	DESIGNATION	DATE
DRAWN BY	CAD	CAD	07–09–2025
DESIGNED BY	JN	SEng	07–09–2025
CHECKED BY	CM	PM	07–09–2025
APPROVED BY	–	–	–
PROJECT NO.	A/YL–KTN/1151		
PAPER SIZE	A3	PLOT SCALE	1 : 1
DRAWING NO.	EP–20349–FS01		
SCALE	N. T. S.	REVISION	A

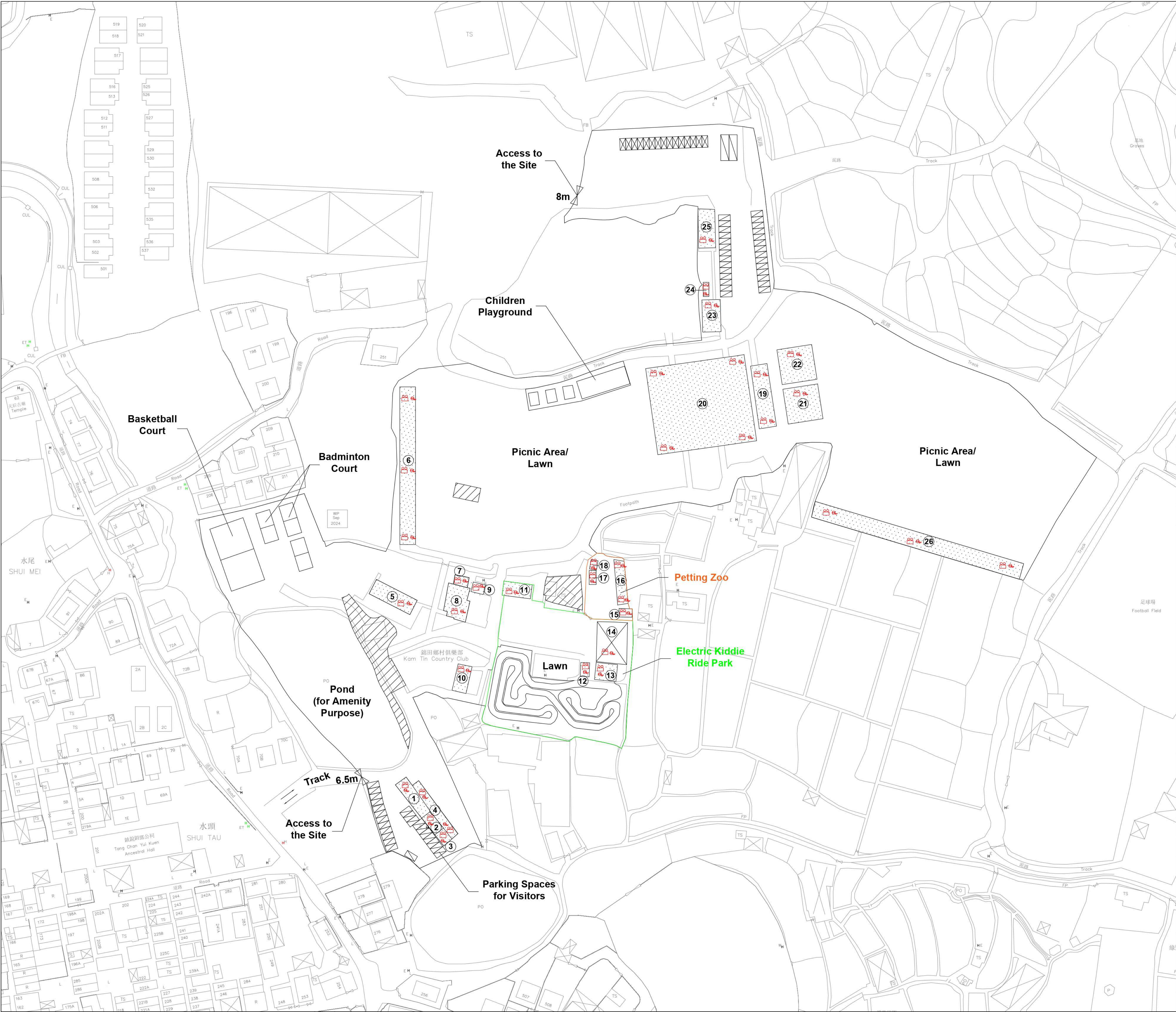

LEGEND:

Application Site (Area: about 40,616 sq.m.)

Area Excluded from the Application Site

Temporary Structures

Loading/Unloading Spaces for Medium Goods Vehicles (3.5m x 11m) (2 nos.)

Parking Spaces for Visitors (2.5m x 5m) (51 nos.)

Drop-off Spaces for Taxis (15 nos.)

Details of Structures:

A

FSD SUBMISSION

07-09-2025

WC

REV

DESCRIPTION

DATE

BY

FSI CONTRACTOR

East Power Engineering Limited

PROJECT

VARIOUS LOTS IN D.D.109 AND ADJOINING GOVERNMENT LAND, SHUI MEI TSUEN, KAM TIN NORTH, YUEN LONG, NEW TERRITORIES

DRAWING TITLE

PROPOSED FIRE SERVICE INSTALLATION LAYOUT PLAN