

Appendix I
Tree Survey

Tree Survey Report

Date of Survey: 6th November 2025

Location:

Lot 802 Rp (Part) In D.D. 109, Kam Tin, Yuen Long, New Territories

Prepared by:



Mak Ka Hei

Registered Arborist

Date: 10th November 2025

Table of contents

| | |
|------------------------------|---|
| 1. Introduction | 3 |
| 2. Summary of Existing Trees | 4 |

Appendix:

- I. Tree Survey Plan
- II. Tree Survey Schedule
- III. Photo Records

Disclaimer:

The tree survey conducted indicates the condition of the surveyed trees at the time of inspection only. The assessments of amenity value, form, health and structural condition of the trees surveyed are based on visual inspection from the ground only. No aerial inspection, root digging or mapping, or diagnostic testing has been conducted as part of this survey. Wing Ho Yuen Landscaping Company Limited cannot accept responsibility for future failure or defects detected after the time of inspection of the trees surveyed in this report.

1. Introduction

The survey conducted is to record all the existing trees in the tree survey boundary. The survey include tree species identification, tree tagging with durable labels, the measurements of overall tree height, Diameter at Breast Height (DBH), average crown spread, the evaluation on amenity value, form, health and structural conditions.

The tree survey was conducted on 6th November 2025. Plants with DBH less than 95mm were not recorded in the survey.

2. Summary of Existing Trees

The surveyed site is located at Lot 802 Rp (Part) In D.D. 109, Kam Tin, Yuen Long, New Territories.

At the time of inspection on 6th November 2025, **24 nos.** trees were found within the Site. **No** dead tree was recorded in the surveyed area. Location of individual tree refers to Appendix I.

Details of tree conditions and photo records for individual tree are recorded in the Appendix II and Appendix III respectively.

Appendix I – Tree Survey Plan

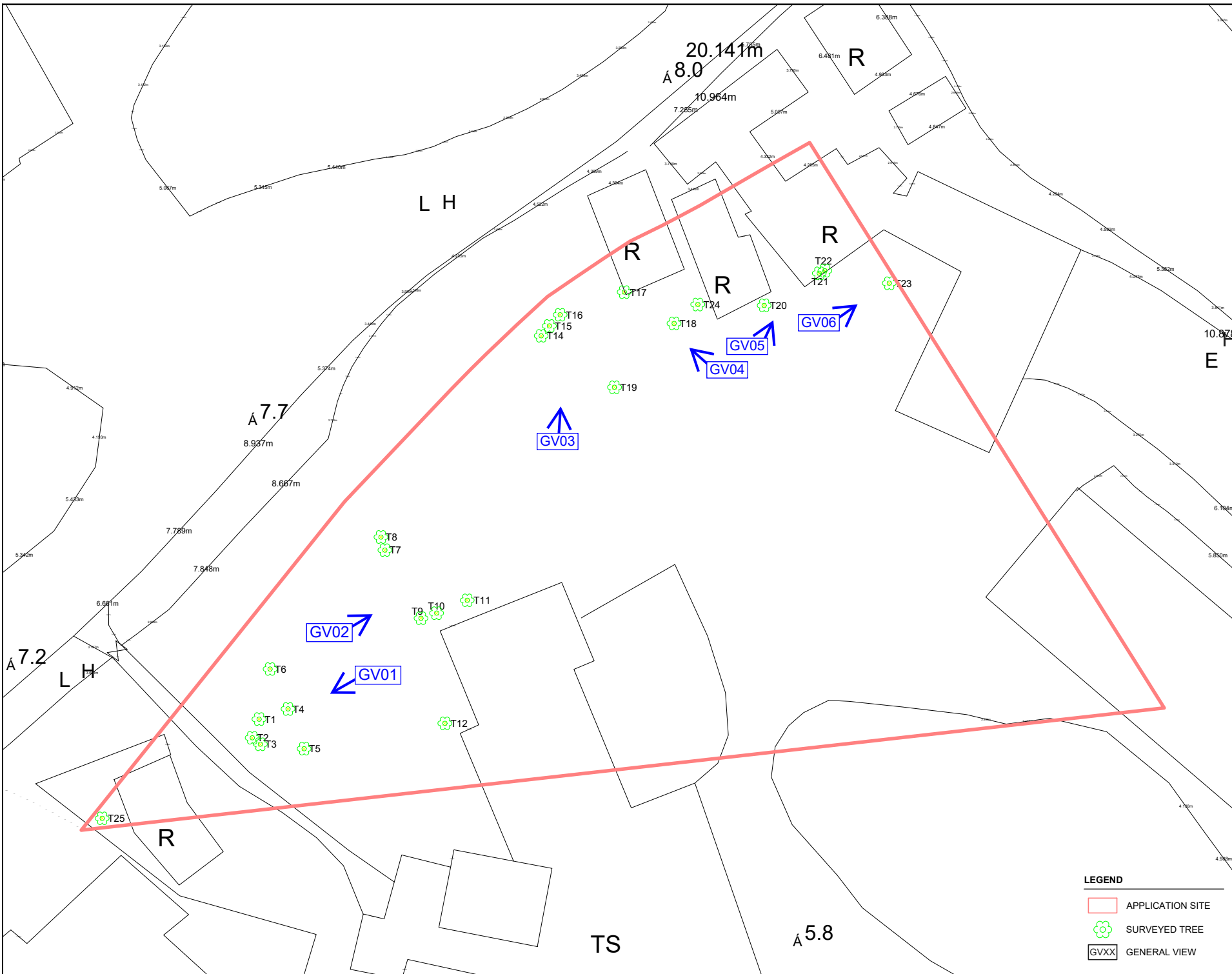

PROJECT
 PROPOSED WAREHOUSE (EXCLUDING DANGEROUS GODDOWN) WITH ANCILLARY FACILITIES AND ASSOCIATED FILLING OF LAND FOR A PERIOD OF 3 YEARS

SITE LOCATION
 LOT 802 RP (PART) IN D.D. 109, KAM TIN, YUEN LONG, NEW TERRITORIES

SCALE
 NOT ON SCALE

| | |
|-----------------|--------------------|
| DRAWN BY KYU | DATE 06.11.2025 |
| REVISED BY | DATE |

| | |
|-------------|------|
| APPROVED BY | DATE |
|-------------|------|

DWG. TITLE
 TREE SURVEY PLAN

| | |
|----------------|-----------|
| DWG NO. TSP | VER. 0 |
|----------------|-----------|

- LEGEND**
- APPLICATION SITE
 - ⊗ SURVEYED TREE
 - GVXX GENERAL VIEW

Appendix II –Tree Survey Schedule

Tree Survey Schedule

Location: Lot 802 Rp (Part) In D.D. 109, Kam Tin, Yuen Long, New Territories
 Tree surveyor(s): Mak Ka Hei
 Field Survey was conducted on: 6 November 2025



| Tree No. | Tree Species | | Tree Size Measurements | | | Amenity Value | Form | Health Condition | Structural Condition | Suitability for Transplanting | Remarks |
|----------|------------------------------|--------------|------------------------|----------|--------------------------|----------------|------------------|------------------------|----------------------|-------------------------------|------------------------------|
| | Botanical Name | Chinese Name | Overall Height (m) | DBH (mm) | Average Crown Spread (m) | High /Med /Low | Good /Fair /Poor | Good /Fair /Poor /Dead | Good /Fair /Poor | High /Med /Low | |
| T1 | <i>Leucaena leucocephala</i> | 銀合歡 | 8.0 | 100 | 4.0 | Low | Poor | Poor | Poor | Low | uprooted, leaning |
| T2 | <i>Melia azedarach</i> | 楝(苦楝) | 7.0 | 100 | 3.0 | Low | Poor | Poor | Poor | Low | leaning |
| T3 | <i>Leucaena leucocephala</i> | 銀合歡 | 7.0 | 110 | 3.0 | Low | Poor | Poor | Poor | Low | leaning |
| T4 | <i>Leucaena leucocephala</i> | 銀合歡 | 7.0 | 220 | 3.0 | Low | Poor | Poor | Poor | Low | |
| T5 | <i>Leucaena leucocephala</i> | 銀合歡 | 7.0 | 148 | 5.0 | Low | Poor | Poor | Poor | Low | co-dominant trunks, leaning |
| T6 | <i>Melia azedarach</i> | 楝(苦楝) | 6.0 | 100 | 3.0 | Low | Poor | Poor | Poor | Low | |
| T7 | <i>Melia azedarach</i> | 楝(苦楝) | 6.0 | 140 | 4.0 | Low | Poor | Poor | Poor | Low | collapsed |
| T8 | <i>Melia azedarach</i> | 楝(苦楝) | 6.0 | 95 | 3.0 | Low | Poor | Poor | Poor | Low | |
| T9 | <i>Melia azedarach</i> | 楝(苦楝) | 6.0 | 100 | 4.0 | Low | Poor | Poor | Poor | Low | |
| T10 | <i>Melia azedarach</i> | 楝(苦楝) | 6.0 | 100 | 4.0 | Low | Poor | Poor | Poor | Low | |
| T11 | <i>Leucaena leucocephala</i> | 銀合歡 | 6.0 | 95 | 4.0 | Low | Poor | Poor | Poor | Low | |
| T12 | <i>Dimocarpus longan</i> | 龍眼 | 8.5 | 360 | 7.0 | Med | Poor | Poor | Poor | Low | |
| T14 | <i>Mangifera indica</i> | 芒果 | 5.0 | 100 | 3.0 | Med | Poor | Poor | Poor | Low | |
| T15 | <i>Mangifera indica</i> | 芒果 | 5.0 | 100 | 3.0 | Med | Poor | Poor | Poor | Low | |
| T16 | <i>Dimocarpus longan</i> | 龍眼 | 9.0 | 623 | 7.0 | Med | Poor | Poor | Poor | Low | co-dominant trunks, climbers |
| T17 | <i>Ficus microcarpa</i> | 榕樹(細葉榕) | 8.0 | 140 | 6.0 | Low | Poor | Poor | Poor | Low | |
| T18 | <i>Celtis sinensis</i> | 朴樹 | 5.0 | 95 | 4.0 | Low | Poor | Poor | Poor | Low | wound on trunk |
| T19 | <i>Melia azedarach</i> | 楝(苦楝) | 5.0 | 95 | 4.0 | Low | Poor | Poor | Poor | Low | |
| T20 | <i>Albizia lebbek</i> | 大葉合歡 | 5.0 | 100 | 3.0 | Low | Poor | Poor | Poor | Low | leaning |
| T21 | <i>Ficus hispida</i> | 對葉榕(牛乳樹) | 6.0 | 147 | 3.0 | Low | Poor | Poor | Poor | Low | multi-trunks |
| T22 | <i>Ficus hispida</i> | 對葉榕(牛乳樹) | 6.0 | 110 | 3.0 | Low | Poor | Poor | Poor | Low | |
| T23 | <i>Dimocarpus longan</i> | 龍眼 | 11.0 | 640 | 10.0 | Med | Poor | Poor | Poor | Low | |
| T24 | <i>Ficus microcarpa</i> | 榕樹(細葉榕) | 6.0 | 95 | 2.0 | Low | Poor | Poor | Poor | Low | |
| T25 | <i>Bridelia tomentosa</i> | 土蜜樹(逼迫仔) | 6.0 | 240 | 5.0 | Low | Poor | Poor | Poor | Low | |

Notes: Amenity Value, Form, Health Condition and Structural Condition of trees were obtained by Visual Assessment Only.

Appendix III – Photo Records

General View



General view 01



General view 02

General View



General view 03



General view 04

General View



General view 05



General view 06

Photo Records



T1 (Overview)



T1 Uprooted



T2 (Overview)



T3 (Overview)

Photo Records



2025-11-06

T4 (Overview)



2025-11-06

T5 (Overview) (Leaning)



2025-11-06

T6 (Overview)



2025-11-06

T7 (Overview) (Collapsed)

Photo Records



T8 (Overview)



T9 (Overview)



T10 (Overview)

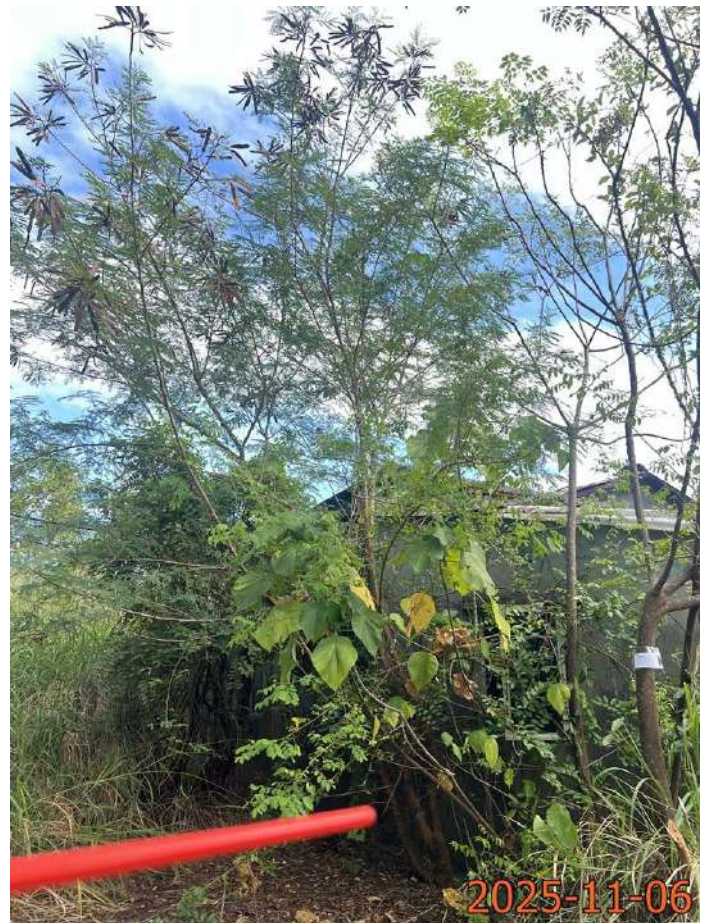

T11 (Overview)

Photo Records



T12 (Overview)

2025-11-06



T14 (Overview)

2025-11-06



T15 (Overview)

2025-11-06



T16 (Overview)

2025-11-06

Photo Records



2025-11-06

T16 Climbers



2025-11-06

T17 (Overview)



2025-11-06

T18 (Overview)



2025-11-06

T18 Wound on trunk

Photo Records



T19 (Overview)



T20 (Overview)



T21 (Overview)



T22 (Overview)

Photo Records



T23 (Overview)



T24 (Overview)



T25 (Overview)

Appendix II
Landscape Proposal

LANDSCAPE PROPOSAL

APPLICATION SITE AREA : 1,880 m² (ABOUT)
 NO. OF EXISTING TREES : 24* (E1 TO E12, E14 to E25)
 NO. OF TREES TO BE FELLED : 24 (E1 TO E12, E14 to E25)

*PLEASE REFER TO TREE SURVEY REPORT FOR DETAILS

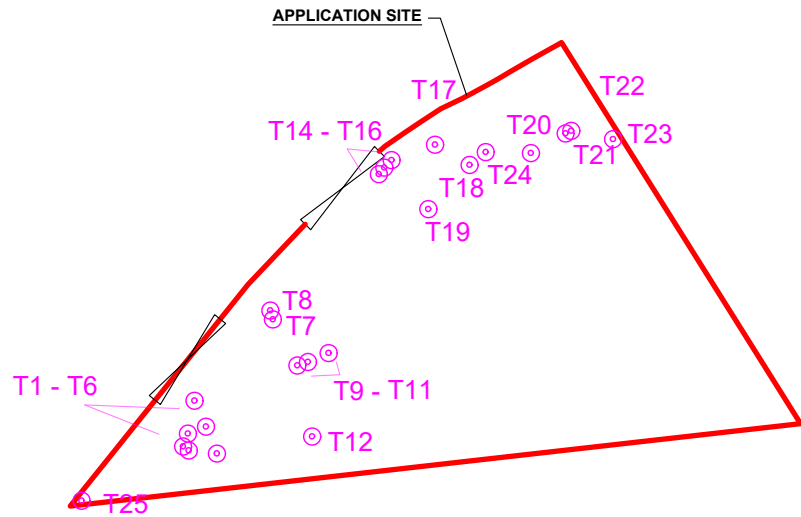

LANDSCAPE PROPOSAL

APPLICATION SITE AREA : 1,880 m² (ABOUT)
 COVERED AREA : 648 m² (ABOUT)
 UNCOVERED AREA : 1,232 m² (ABOUT)

NO. OF NEW TREES WILL BE PLANTED : 24 (N1 TO N24)
 SPECIES OF NEW TREES : POLYSPORA AXILLARIS
 HEIGHT OF NEW TREES : NO LESS THAN 2.75 m
 SPACING OF NEW TREES : NOT LESS THAN 3 m
 DIMENSION OF SOIL TRENCH : 1.2 m (W) X 1.2 m (D)

NOTES:

- 1) THE APPLICANT WILL MAINTAIN TREES IN GOOD CONDITION DURING THE PLANNING APPROVAL PERIOD.
- 2) THE APPLICANT WILL REPLACE TREES WHICH ARE DYING OR DEAD DURING THE PLANNING APPROVAL PERIOD.
- 3) THE APPLICANT WILL PROVIDE ADEQUATE IRRIGATION FOR TREES.

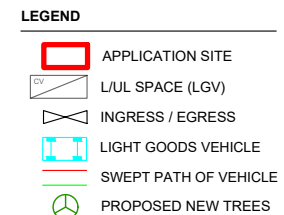
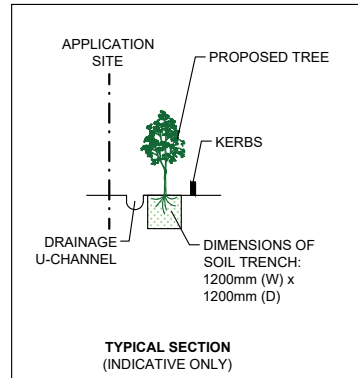
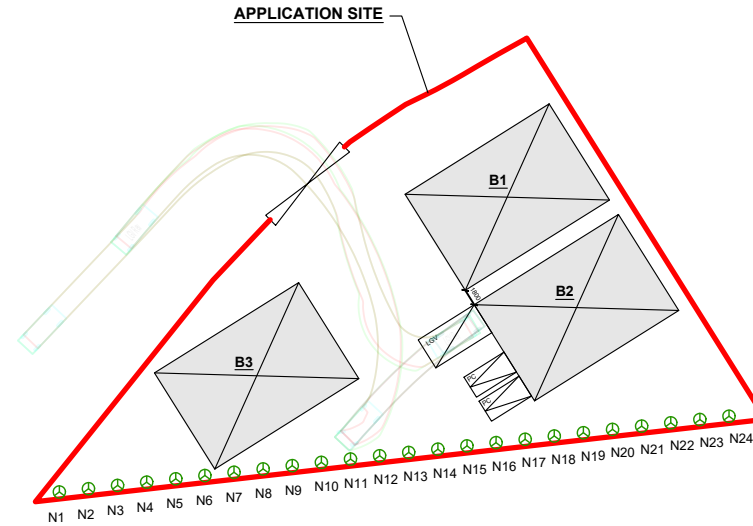
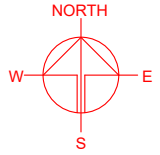

PLANNING CONSULTANT

PROJECT
 PROPOSED WAREHOUSE (EXCLUDING DANGEROUS GOODS GODOWN) WITH ANCILLARY FACILITIES AND ASSOCIATED FILLING OF LAND FOR A PERIOD OF 3 YEARS

SITE LOCATION
 LOT 802 RP (PART) IN D.D. 109, KAM TIN, YUEN LONG, NEW TERRITORIES

SCALE
 1 : 800 @ A4

DRAWN BY
 LT 31.3.2026

CHECKED BY
 DATE

APPROVED BY
 DATE

DWG. TITLE
 LANDSCAPE PROPOSAL

DWG. NO.
 APPENDIX II

VER.
 001