

Our Ref. : DD106 Lot 136 RP
Your Ref. : TPB/A/YL-KTS/1080

The Secretary,
Town Planning Board,
15/F, North Point Government Offices,
333 Java Road,
North Point, Hong Kong

By E-mail

25 June 2025

Dear Sir,

Supplementary Information

Proposed Temporary Warehouse (Excluding Dangerous Goods Godown) with Ancillary Facilities and Associated Filling of Land for a Period of 3 Years in "Agriculture" Zone, Lots 136 RP (Part) and 2149 in D.D. 106 and Adjoining Government Land, Kam Tin, Yuen Long, New Territories

(S.16 Planning Application No. A/YL-KTS/1080)

We write to submit a revised Layout Plan for the captioned application.

Should you require more information regarding the application, please contact our [REDACTED]
[REDACTED] or the undersigned at your convenience.
Thank you for your kind attention.

Yours faithfully,

For and on behalf of
R-riches Planning Limited



Christian CHIM
Town Planner

cc DPO/FSYLE, PlanD

(Attn.: Mr. Michael SO

email: mckso@pland.gov.hk)



LOCATION OF THE APPLICATION SITE

APPLICATION SITE AREA : 4,451 m² (ABOUT)

VEHICULAR ACCESS

ACCESSIBLE FROM KAM HO ROAD VIA A LOCAL ACCESS

APPLICATION SITE

ACCESSIBLE FROM KAM HO ROAD VIA A LOCAL ACCESS

LEGEND



APPLICATION SITE

SITE BOUNDARY FOR IDENTIFICATION PURPOSE ONLY.

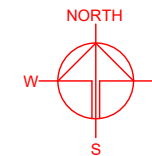

PLANNING CONSULTANT



PROJECT

PROPOSED WAREHOUSE (EXCLUDING DANGEROUS GOODS GODOWN) WITH ANCILLARY FACILITIES AND ASSOCIATED FILLING OF LAND FOR A PERIOD OF 3 YEARS

SITE LOCATION

LOT 136 (PART) AND 2149 IN D.D. 106 AND ADJOINING GOVERNMENT LAND, KAM TIN, YUEN LONG, NEW TERRITORIES

SCALE

1 : 3000 @ A4

DRAWN BY

MN

DATE

20.5.2025

CHECKED BY

DATE

APPROVED BY

DATE

DWG. TITLE

LOCATION PLAN

DWG NO.

PLAN 1

VER.

001

ZONING OF THE APPLICATION SITE

APPLICATION SITE AREA : 4,451 m² (ABOUT)

OUTLINE ZONING PLAN : APPROVED KAM TIN SOUTH OZP
OZP PLAN NO. : S/YL-KTS/15
ZONING OF THE SITE : "AGRICULTURE" ("AGR")

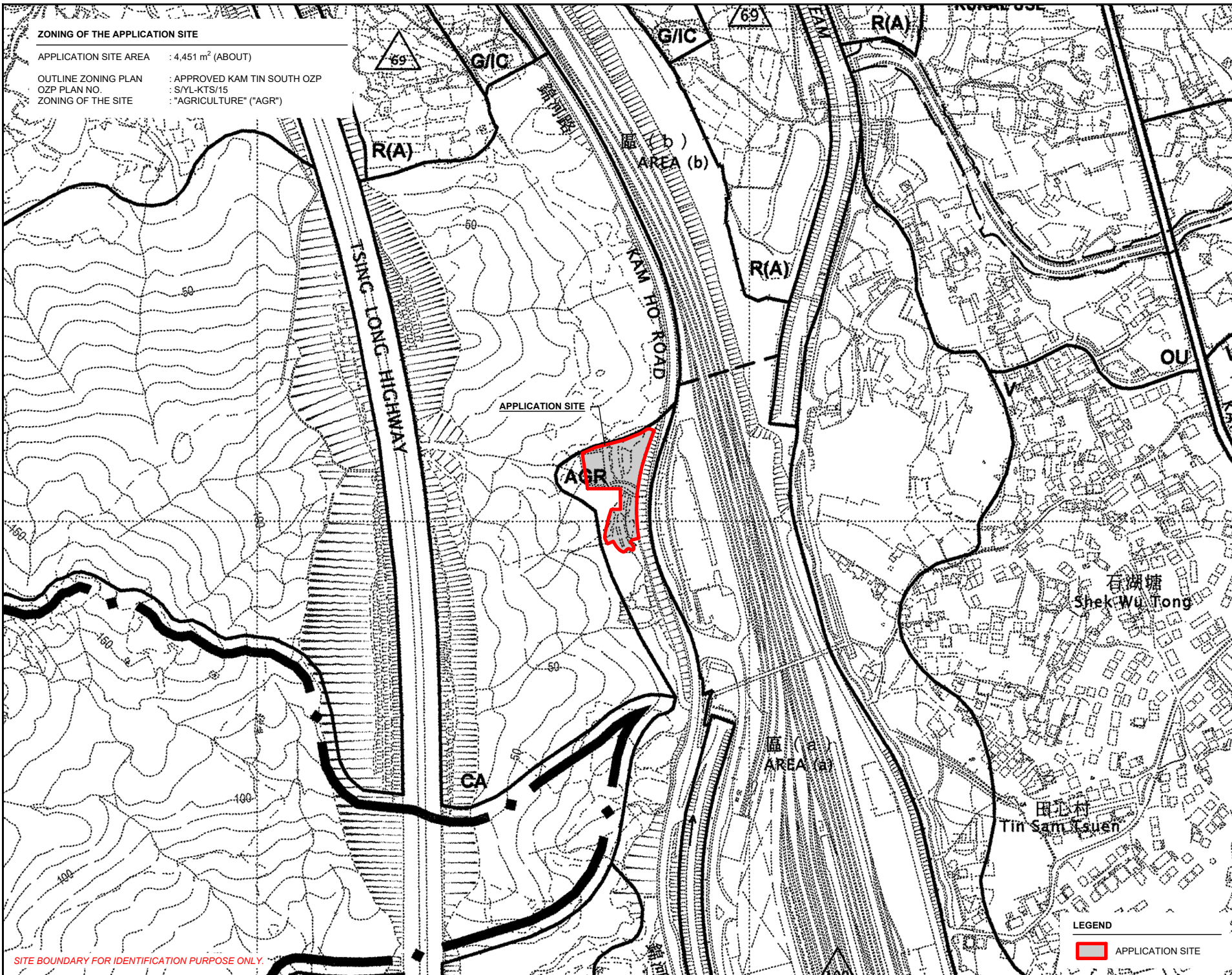
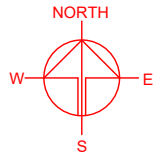

SITE BOUNDARY FOR IDENTIFICATION PURPOSE ONLY

LEGEND

 APPLICATION SITE

PLANNING CONSULTANT



PROJECT

PROPOSED WAREHOUSE (EXCLUDING DANGEROUS GOODS GODOWN) WITH ANCILLARY FACILITIES AND ASSOCIATED FILLING OF LAND FOR A PERIOD OF 3 YEARS

SITE LOCATION

LOT 136 (PART) AND 2149 IN D.D. 106 AND ADJOINING GOVERNMENT LAND, KAM TIN, YUEN LONG, NEW TERRITORIES

SCALE

1 : 5000 @ A4

DRAWN BY

MN

DATE

20.5.2025

CHECKED BY

DATE

APPROVED BY

DATE

DWG. TITLE

ZONING OF THE SITE

DWG NO.

PLAN 2

VER.

001

LAND STATUS OF THE APPLICATION SITE

APPLICATION SITE AREA : 4,451 m² (ABOUT)
 AREA OF PRIVATE LAND : 2,940 m² (ABOUT)
 AREA OF GOVERNMENT LAND : 1,511 m² (ABOUT)

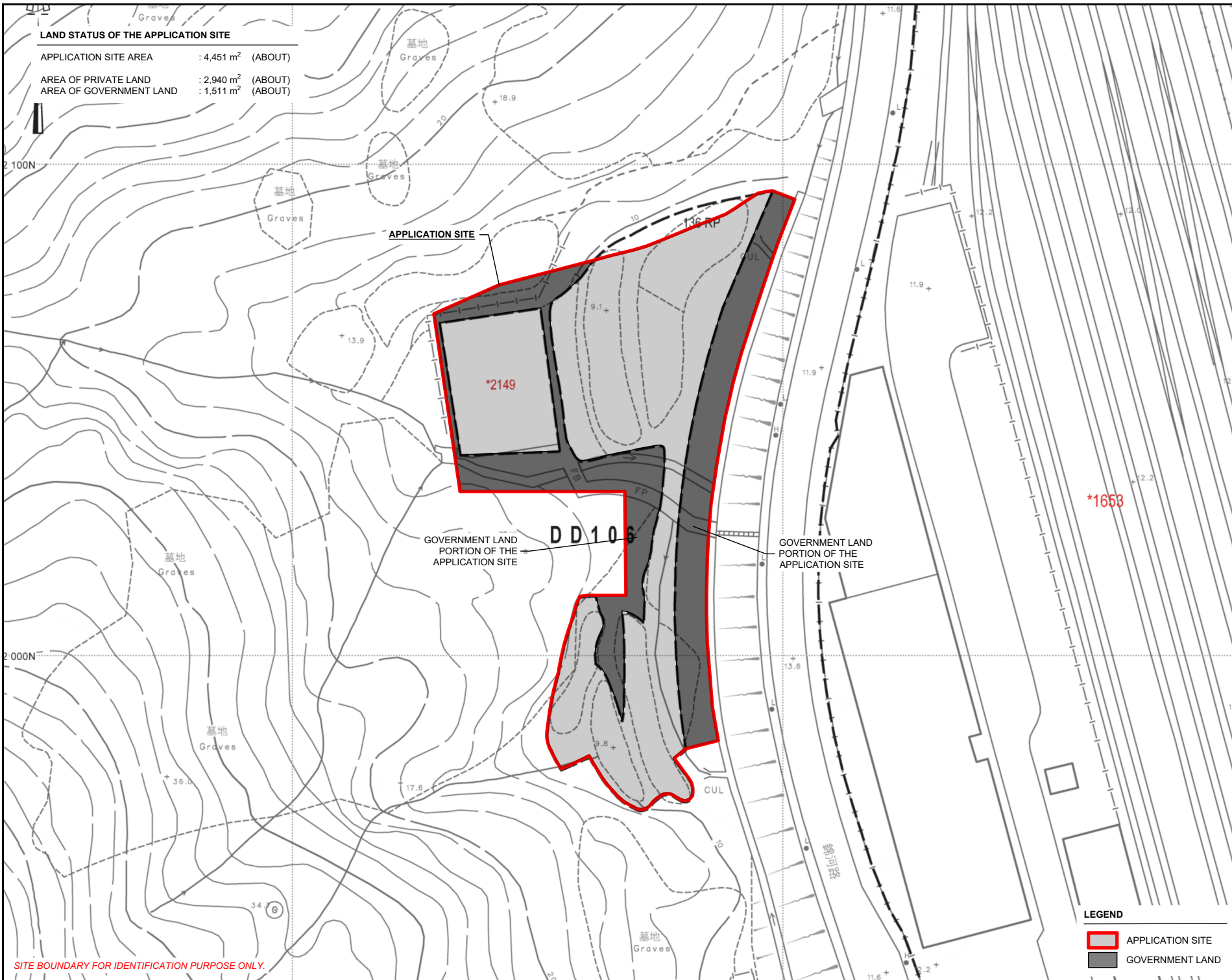
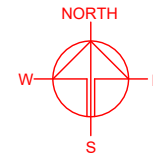

SITE BOUNDARY FOR IDENTIFICATION PURPOSE ONLY.

LEGEND

- APPLICATION SITE
- GOVERNMENT LAND

PLANNING CONSULTANT



PROJECT

PROPOSED WAREHOUSE (EXCLUDING DANGEROUS GOODS GODOWN) WITH ANCILLARY FACILITIES AND ASSOCIATED FILLING OF LAND FOR A PERIOD OF 3 YEARS

SITE LOCATION

LOT 136 (PART) AND 2149 IN D.D. 106 AND ADJOINING GOVERNMENT LAND, KAM TIN, YUEN LONG, NEW TERRITORIES

SCALE

1 : 1000 @ A4

DRAWN BY MN DATE 20.5.2025

CHECKED BY DATE

APPROVED BY DATE

DWG. TITLE LAND STATUS OF THE SITE

DWG NO. PLAN 3 VER. 001

DEVELOPMENT PARAMETERS

APPLICATION SITE AREA	: 4,451 m ²	(ABOUT)
COVERED AREA	: 3,520 m ²	(ABOUT)
UNCOVERED AREA	: 931 m ²	(ABOUT)
PLOT RATIO	: 1.6	(ABOUT)
SITE COVERAGE	: 79 %	(ABOUT)
NO. OF STRUCTURE	: 2	
DOMESTIC GFA	: NOT APPLICABLE	
NON-DOMESTIC GFA	: 7,040 m ²	(ABOUT)
TOTAL GFA	: 7,040 m ²	(ABOUT)
BUILDING HEIGHT	: 13 m	(ABOUT)
NO. OF STOREY	: 2	

STRUCTURE	USE	COVERED AREA	GROSS FLOOR AREA	BUILDING HEIGHT
B1	(G/F)	WAREHOUSE (EXCLUDING D.G.G.)	2,583 m ² (ABOUT)	13 m (ABOUT)(2-STOREY)
	(1/F)	SITE OFFICE AND WASHROOM WAREHOUSE (EXCLUDING D.G.G.)	2,583 m ² (ABOUT)	
B2	(G/F)	WAREHOUSE (EXCLUDING D.G.G.)	937 m ² (ABOUT)	13 m (ABOUT)(2-STOREY)
	(1/F)	SITE OFFICE AND WASHROOM WAREHOUSE (EXCLUDING D.G.G.)	937 m ² (ABOUT)	
TOTAL		3,520 m ² (ABOUT)	7,040 m ² (ABOUT)	

** INCLUDING 438 m² (ABOUT) OF COVERED AREA FOR L/U/L ACTIVITIES
 *** INCLUDING 415 m² (ABOUT) OF COVERED AREA FOR L/U/L ACTIVITIES

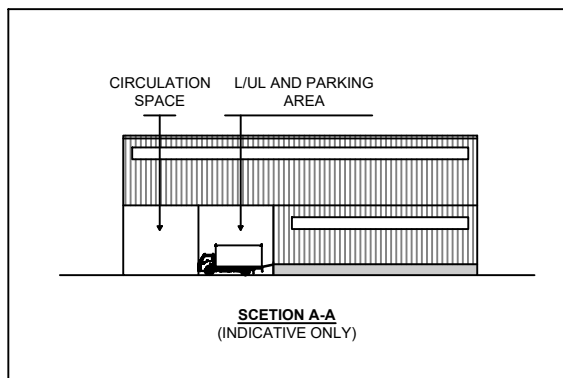
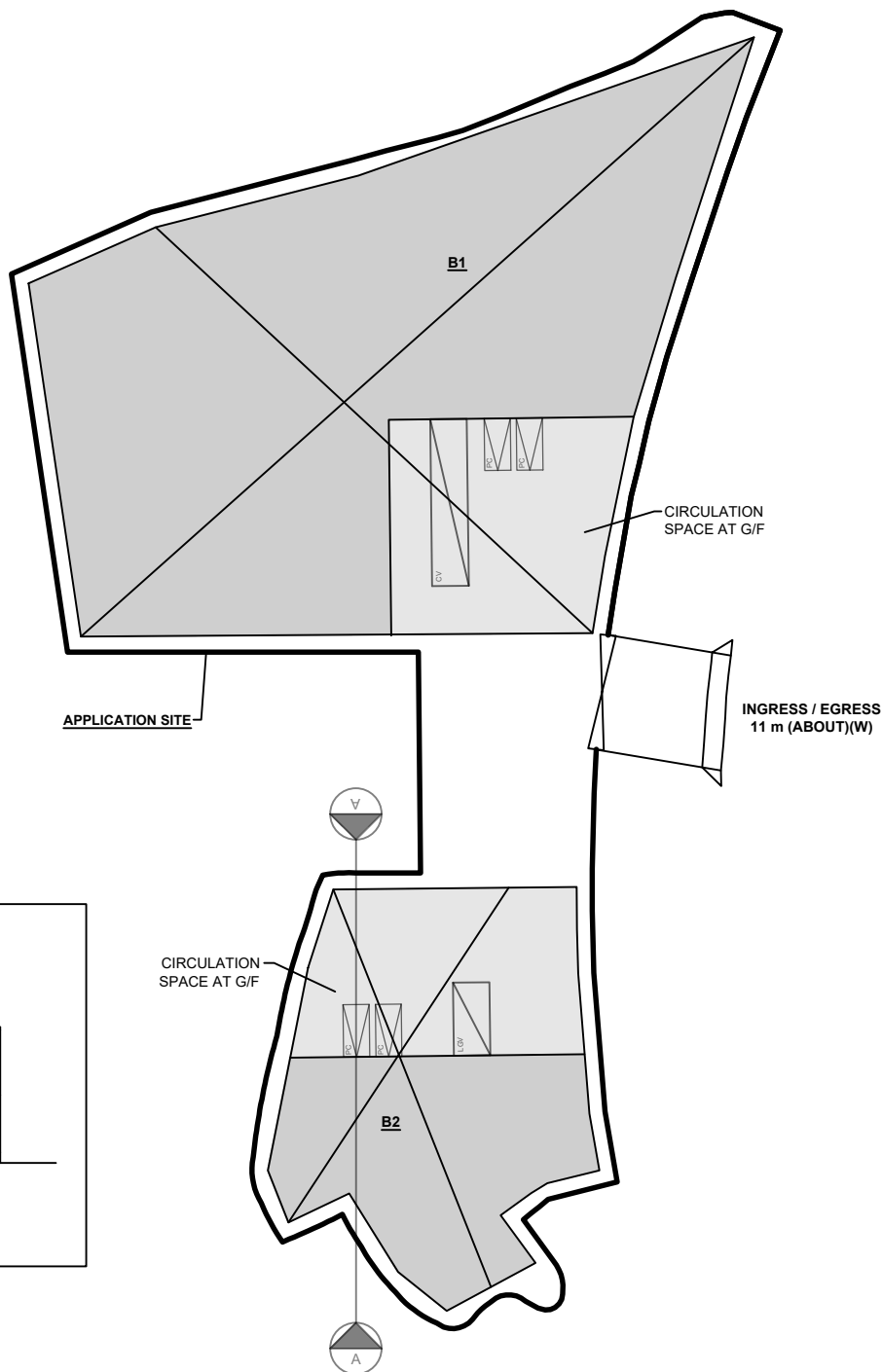

PARKING AND LOADING/UNLOADING PROVISIONS

NO. OF PRIVATE CAR PARKING SPACE	: 4
DIMENSION OF PARKING SPACE	: 5 m (L) X 2.5 m (W)
NO. OF L/U/L SPACE FOR LIGHT GOODS VEHICLE	: 1
DIMENSION OF L/U/L SPACE	: 7 m (L) X 3.5 m (W)
NO. OF L/U/L SPACE FOR CONTAINER VEHICLE	: 1
DIMENSION OF L/U/L SPACE	: 16 m (L) X 3.5 m (W)

LEGEND

	APPLICATION SITE
	STRUCTURE
	PARKING SPACE (PC)
	LOADING/UNLOADING SPACE (LGV)
	LOADING/UNLOADING SPACE (CV)
	INGRESS / EGRESS

PLANNING CONSULTANT

..\\L\\Logo\\Planning logo (20250415).png

PROJECT

PROPOSED TEMPORARY WAREHOUSE
 (EXCLUDING DANGEROUS GOODS GODOWN)
 WITH ANCILLARY FACILITIES AND
 ASSOCIATED FILLING OF LAND FOR A PERIOD
 OF 3 YEARS

ADDRESS

LOTS 136 (PART) AND 2149 IN D.D. 106 AND
 ADJOINING GOVERNMENT LAND, KAM TIN,
 YUEN LONG, NEW TERRITORIES

SCALE
1 : 700 @ A4DRAWN BY
MNDATE
25.6.2025

REVISED BY

DATE

TITLE
LAYOUT PLANDWS NO.
PLAN 4VER.
001

EXISTING CONDITION OF THE APPLICATION SITE

APPLICATION SITE AREA	: 4,451 m ²	(ABOUT)
EXISTING SOILED GROUND AREA	: 4,451 m ²	(ABOUT)
EXISTING SITE LEVELS	: +9.1 mPD TO +9.6 mPD	(ABOUT)

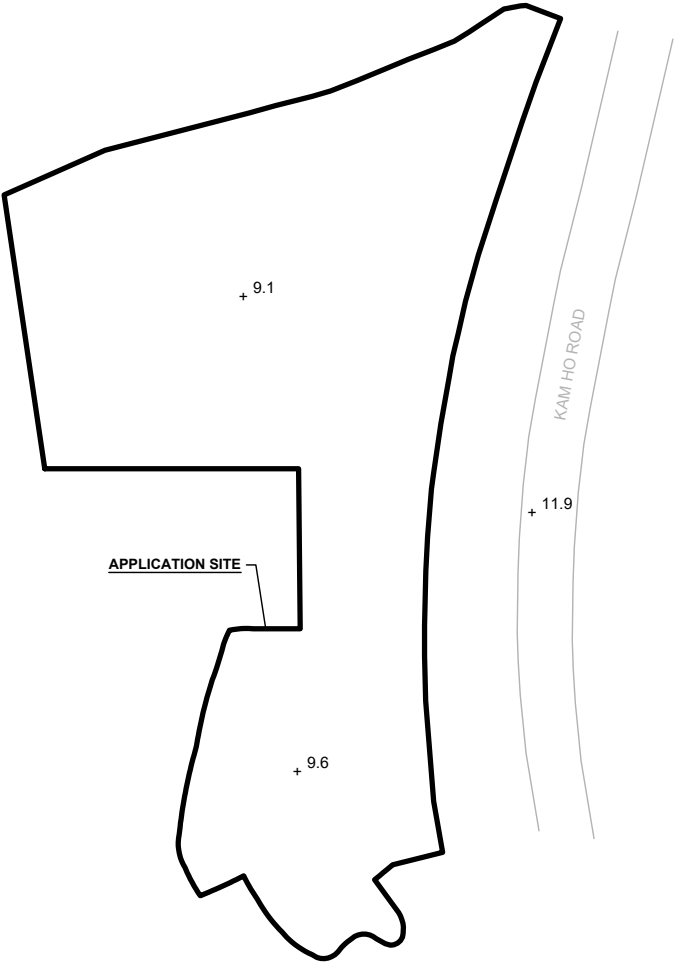

LEGEND

	APPLICATION SITE
	EXISTING SITE LEVEL

*SITE LEVELS ARE FOR REFERENCE ONLY.
EXACT SITE LEVELS ARE SUBJECT TO DETAILED SURVEY.

PROPOSED FILLING OF LAND AREA

APPLICATION SITE AREA	: 4,451 m ²	(ABOUT)
COVERED BY STRUCTURE	: 3,520 m ²	(ABOUT)
PROPOSED FILLING AREA	: 4,451 m ²	(ABOUT)
DEPTH OF LAND FILLING	: NOT MORE THAN 2.8 m	
PROPOSED SITE LEVELS	: +11.9 mPD	(ABOUT)
MATERIAL OF LAND FILLING	: CONCRETE	
USE	: PARKING AND LOADING / UNLOADING SPACE, SITE FORMATION OF STRUCTURE AND CIRCULATION SPACE	

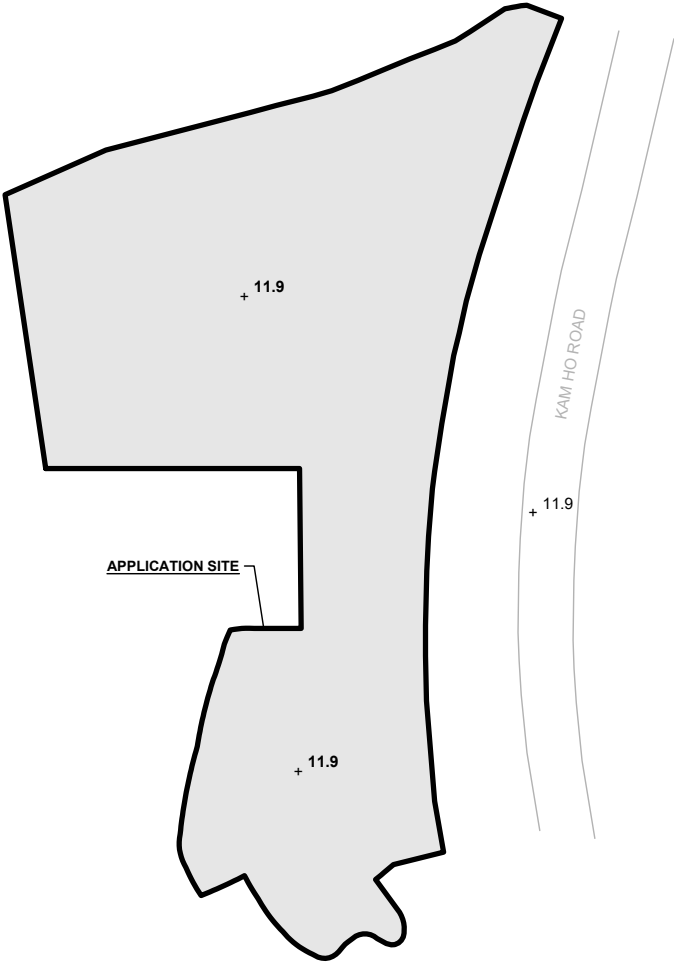

LEGEND

	APPLICATION SITE
	FILLING OF LAND AREA
	PROPOSED SITE LEVEL

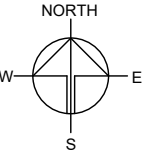

PLANNING CONSULTANT



PROJECT

PROPOSED WAREHOUSE (EXCLUDING DANGEROUS GOODS GODOWN) WITH ANCILLARY FACILITIES FOR A PERIOD OF 3 YEARS AND ASSOCIATED FILLING OF LAND

SITE LOCATION

LOT 136 (PART) AND 2149 IN D.D. 106 AND ADJOINING GOVERNMENT LAND, KAM TIN, YUEN LONG, NEW TERRITORIES

SCALE

1 : 1000 @ A4

DRAWN BY	DATE
MN	20.5.2025
REVISED BY	DATE
APPROVED BY	DATE

DWG. TITLE
FILLING OF LAND

DWG NO. PLAN 5	VER. 001
-------------------	-------------

SWEPT PATH ANALYSIS

TYPE OF VEHICLE : CONTAINER VEHICLE
 DIMENSION OF VEHICLE : 2.5 m (W) X 16 m (L)

SWEPT PATHS GENERATED BY AUTODESK VEHICLE TRACKING

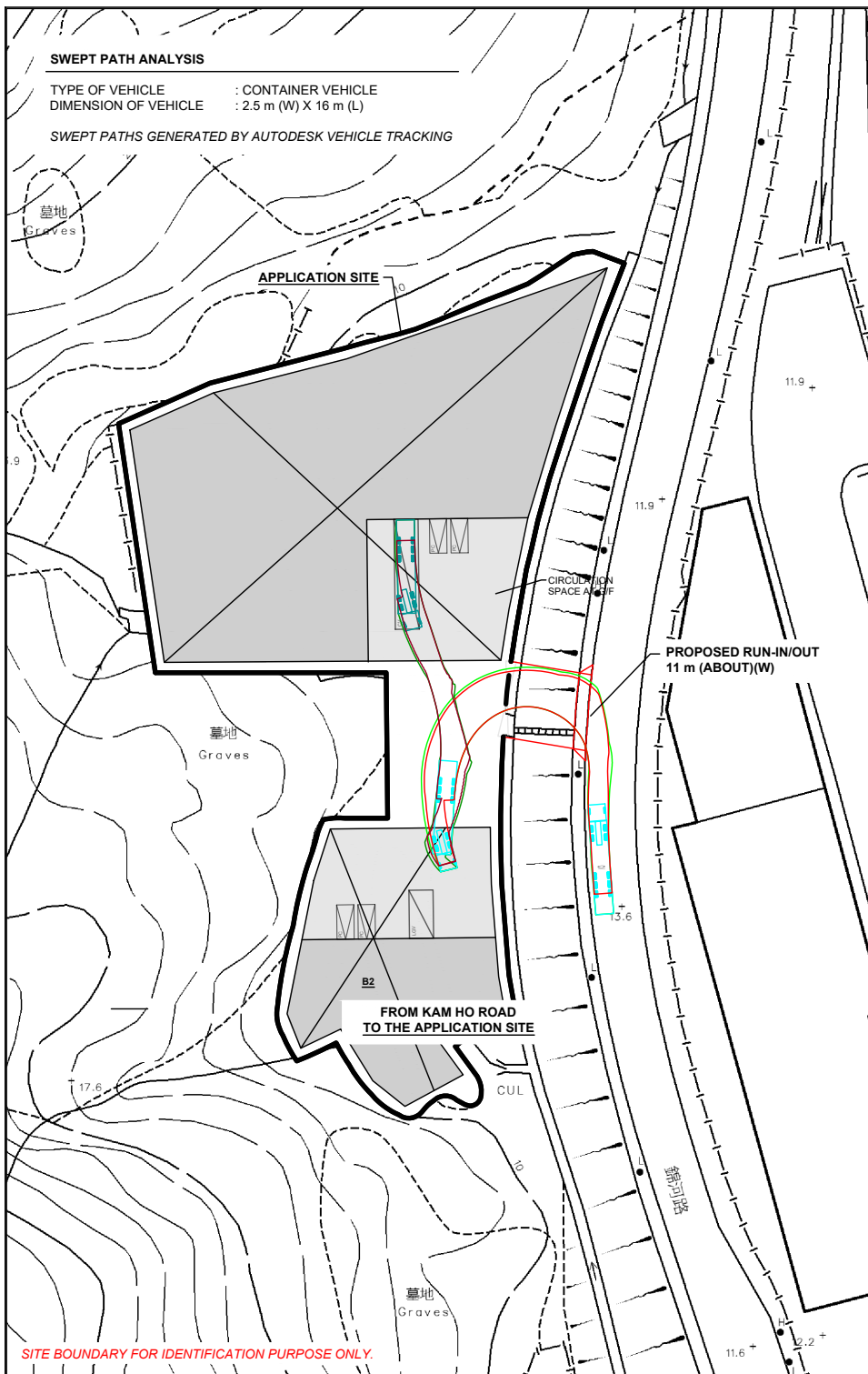
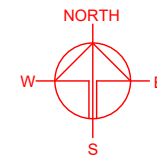

SITE BOUNDARY FOR IDENTIFICATION PURPOSE ONLY.

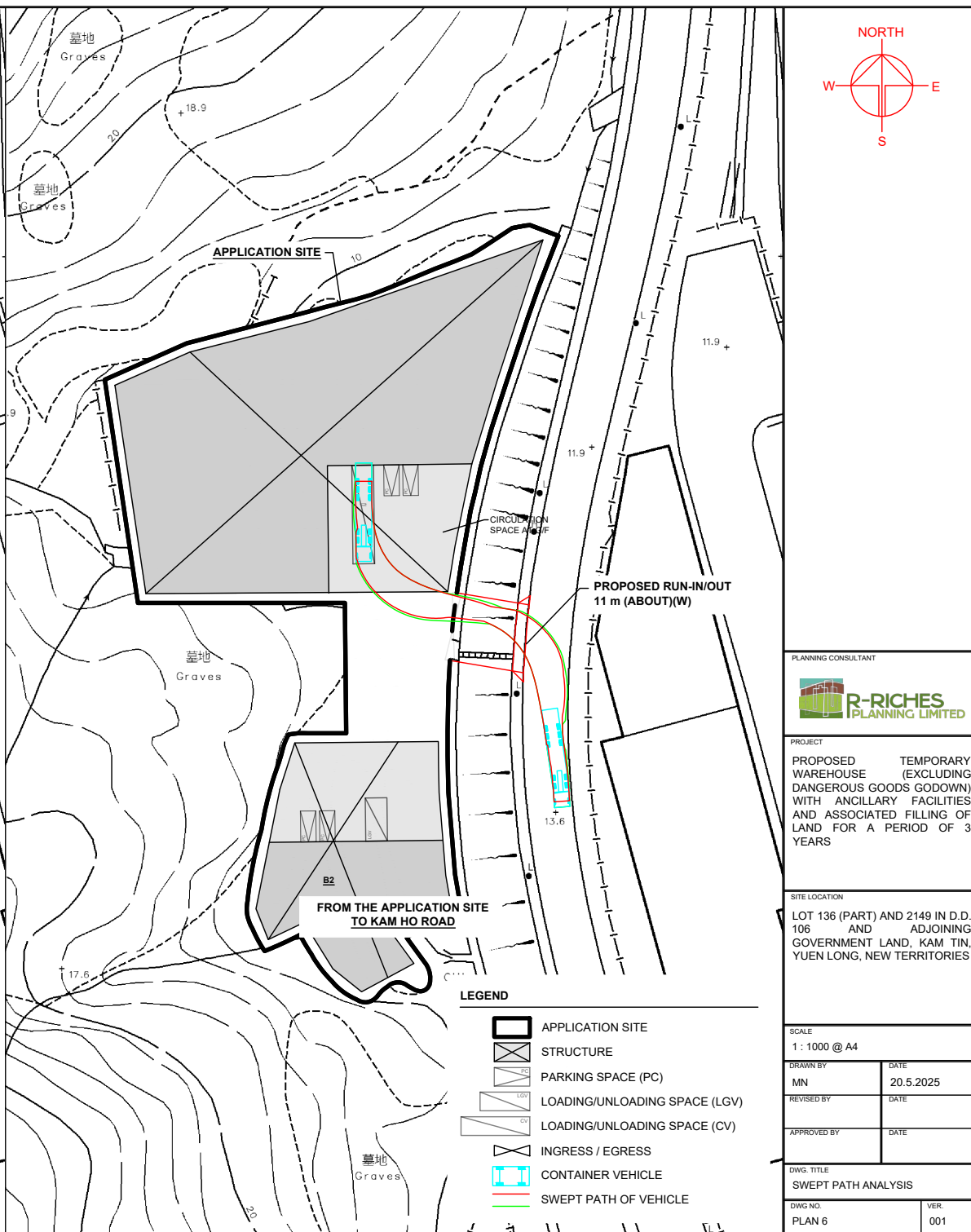

LEGEND

- APPLICATION SITE
- STRUCTURE
- PARKING SPACE (PC)
- LOADING/UNLOADING SPACE (LGV)
- LOADING/UNLOADING SPACE (CV)
- INGRESS / EGRESS
- CONTAINER VEHICLE
- SWEEP PATH OF VEHICLE

PLANNING CONSULTANT



PROJECT

PROPOSED TEMPORARY WAREHOUSE (EXCLUDING DANGEROUS GOODS GODOWN) WITH ANCILLARY FACILITIES AND ASSOCIATED FILLING OF LAND FOR A PERIOD OF 3 YEARS

SITE LOCATION

LOT 136 (PART) AND 2149 IN D.D. 106 AND ADJOINING GOVERNMENT LAND, KAM TIN, YUEN LONG, NEW TERRITORIES

SCALE

1 : 1000 @ A4

DRAWN BY

MN

DATE

20.5.2025

REVISED BY

DATE

APPROVED BY

DATE

DWG. TITLE

SWEPT PATH ANALYSIS

DWG NO.

PLAN 6

VER.

001