

Top Bright Consultants Ltd.

Extract Plan Based on Map
Series HM20C of Sheet 6

Location Plan

Scale 1 : 20 000

FIGURE 1

For Identification Purpose

Date: 28.7.2025

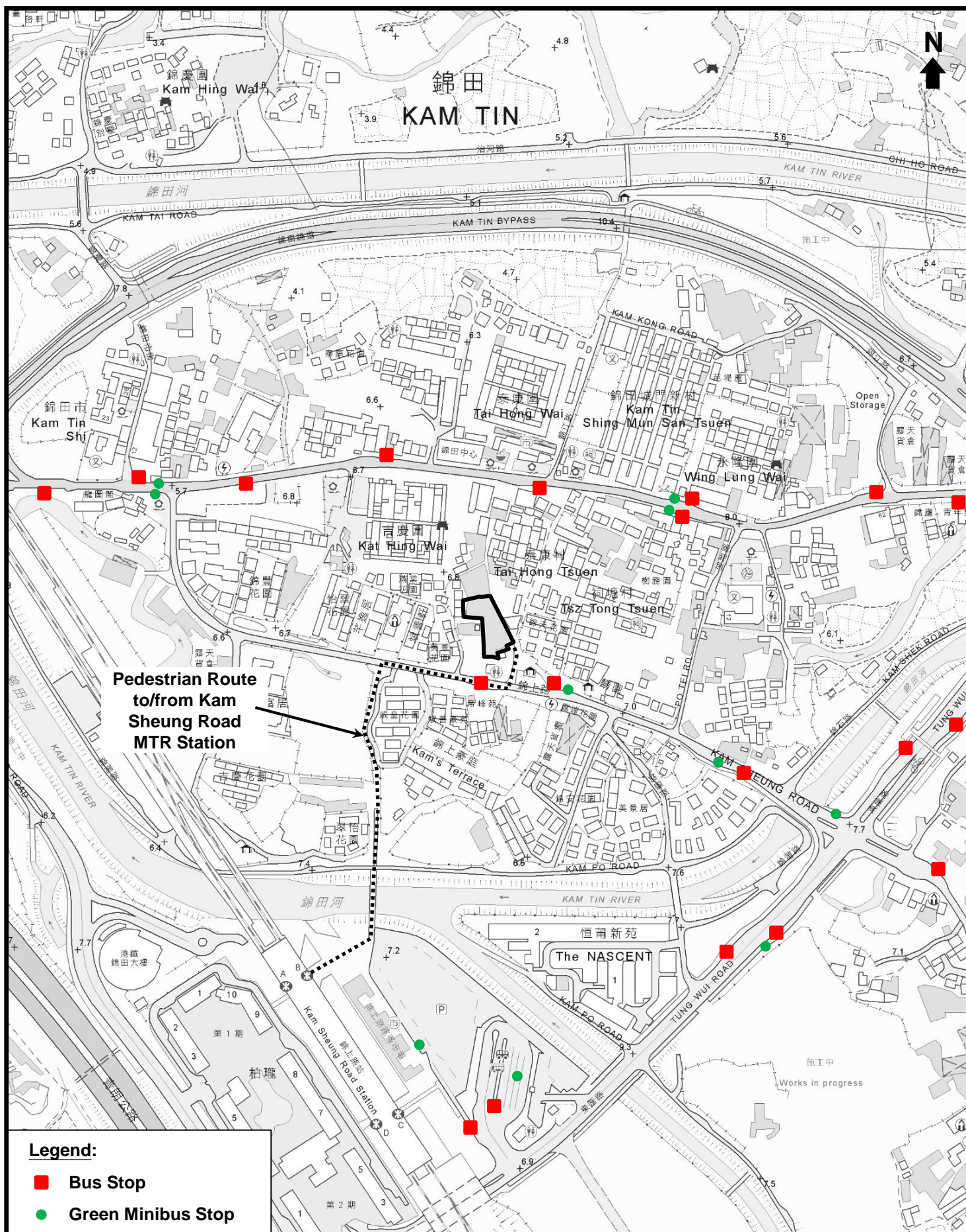

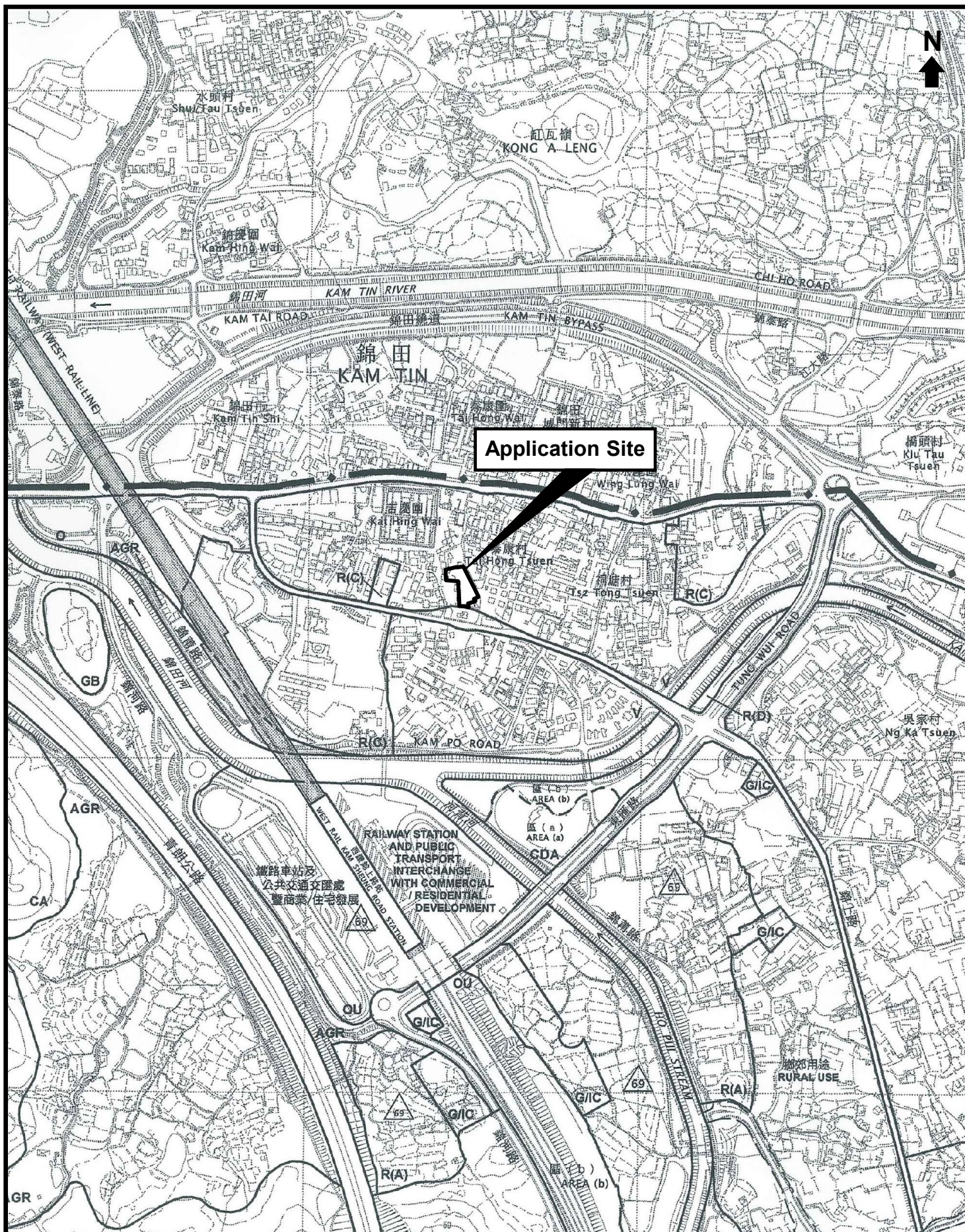

Extract from Kam Tin South Outline Zoning Plan
No. S/YL-KTS/15 gazetted on 21.12.2018

FIGURE 4

For Identification Purpose

Date: 28.7.2025

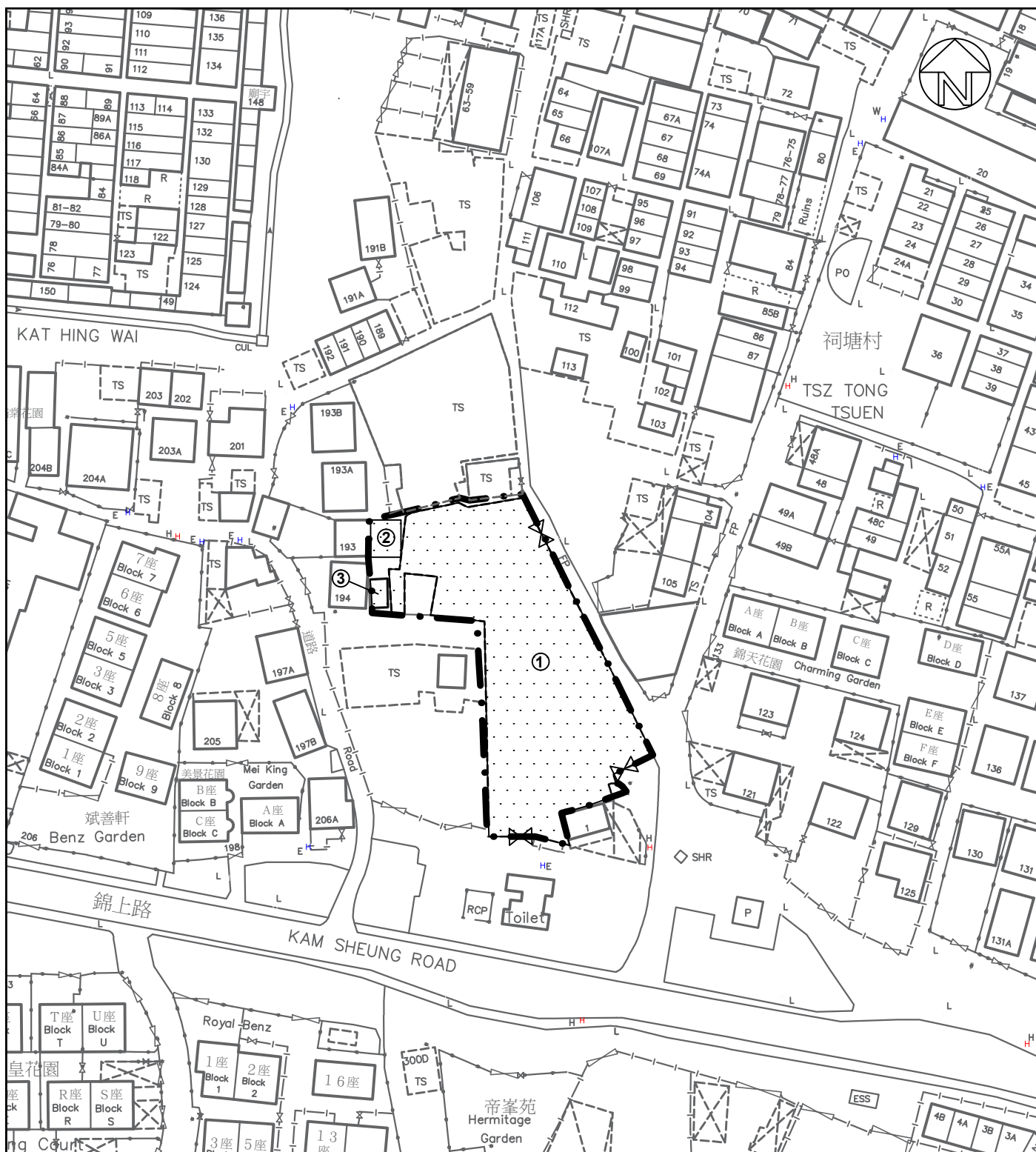

Structure No.	Uses	Floor Area (m ²)	Height (m)
1	Flea Market and Eating Place	1,401	5-5.5
2	Flea Market	36	3
3	Eating Place	15	3

LEGEND:

-  Application Site (Area: about 1,581 sq.m.)
-  Temporary Structures (1-storey)
-  Entrance/Exit



Top Bright Consultants Ltd.

Drawing No. :TB/25/868/05A

Layout Plan

Lots 398(Part), 399SA(Part), 399RP(Part),
400(Part) and Adjoining Government Land
in DD109, Kam Sheung Road, Yuen Long, N.T.

FIGURE 5

FOR IDENTIFICATION PURPOSE





Date: 4.9.2025

Scale: 1 : 1000 (A4)



Area subject to detailed survey

LEGEND:

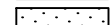
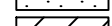
-  Application Site (Area: about 1,581 sq.m.)
-  Stalls of Flea Market (about 758 sq.m.)
-  Eating Place (about 90 sq.m.)
-  Sitting Out Area of Eating Place (about 96 sq.m.)
-  Storeroom (about 46 sq.m.)
-  Entrance/Exit



Top Bright Consultants Ltd.

Drawing No. :TB/25/868/06

Internal Layout

Lots 398(Part), 399SA(Part), 399RP(Part),
400(Part) and Adjoining Government Land
in DD109, Kam Sheung Road, Yuen Long, N.T.

FIGURE 6

FOR IDENTIFICATION PURPOSE

Date: 28.7.2025

Scale: 1 : 500 (A4)