

List of Figures

Figure 1	Indicative Layout Plan
Figure 2 & 2(a)	The Location Plan
Figure 3	Lot Boundaries Plan Extract of Lot Index Plan (No.ags-S00000138365-001)
Figure 4	Extract from the Approved Kam Tin South Outline Zoning Plan No. S/YL-KTS/15
Figure 5	Land Filling Plan

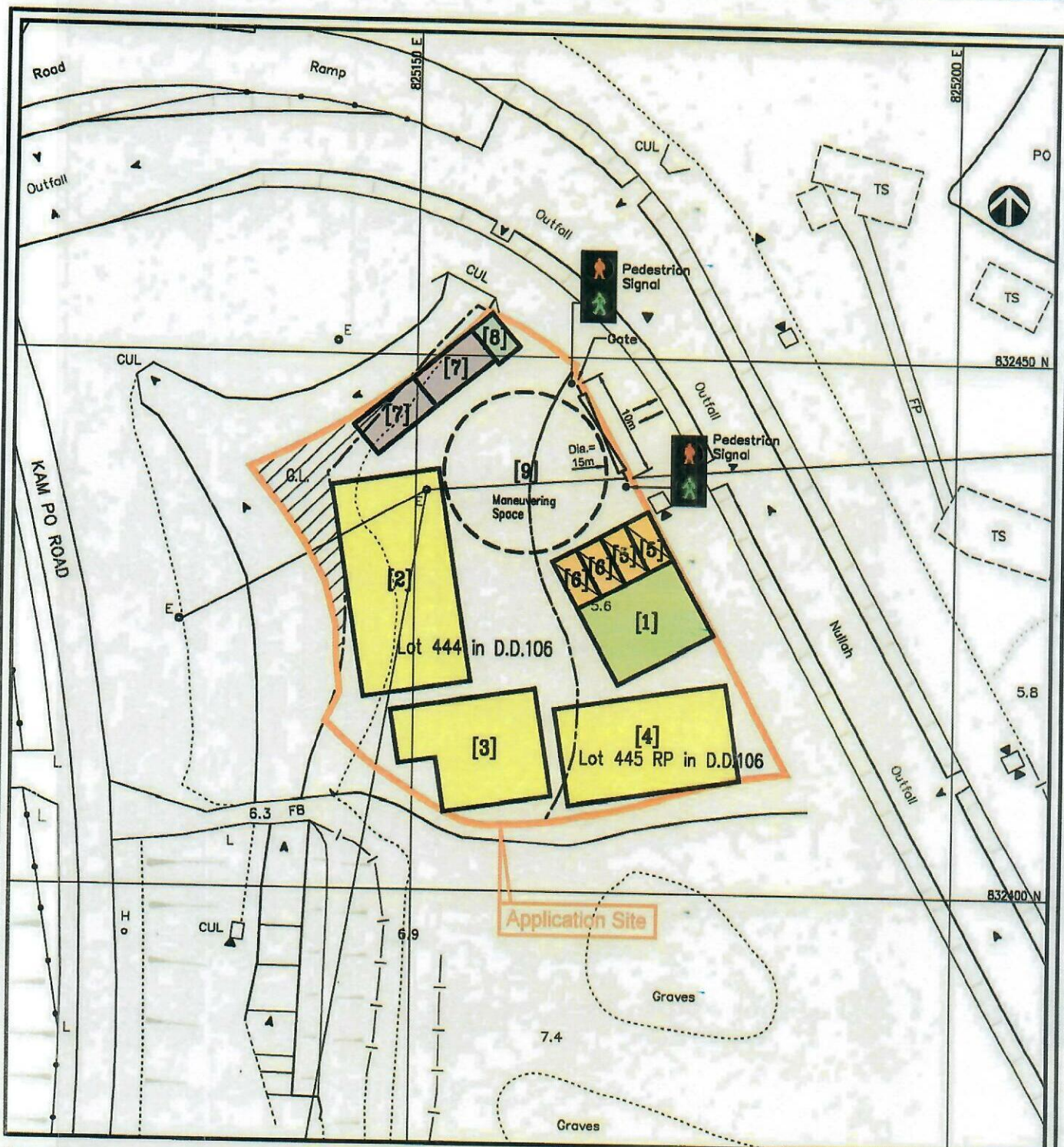

Scale 1 : 500

Legends:

- The Application Site Boundary (For Identification Only)
- [1] Office 10 m x 8 m x 7.5 m (h)
Area About : 80 sq.m
- [2] Warehouse 20 m x 10 m x 7.5 m (h)
Area About : 200 sq.m
- [3] Warehouse (10m x 10m)+(3.5m x 5m) x 7.5m (h)
Area About : 117.5 sq.m
- [4] Warehouse 16 m x 9 m x 7.5 m (h)
Area About : 144 sq.m

- [5] Private Car Parking Space 5 m x 2.5 m (2 nos.) Area About : 12.5 sq.m/per 1
- [6] LGV Parking Space 5 m x 2.5 m (2 nos.) Area About : 12.5 sq.m/per 1
- [7] LGV Loading and Unloading Bay 7 m x 3.5 m Area About : 49 sq.m (2 nos.)
- [8] Guard House 2.5 m x 4.0 m x 3.5 m (h) Area About : 10 sq.m
- [9] Maneuvering Circle 15 m diameter Area About : 176.71 sq.m

- Pedestrian Signal
- Ingress/egress Development Parameters:

Site Area: 1374.02 sq.m (About)
Cover Area: 551.5 sq.m
Uncover Area: 822.52 sq.m (About)
Site Coverage 40.13% (About)
Plot Ratio: 0.4013 (About)
Total GFA: 551.5 sq.m

Project:

Proposed Temporary Warehouse (excluding Dangerous Goods Godown) with Ancillary Facilities for a Period of 3 Years at Lot 444 (Part), 445 RP in DD 106, and adjoining Government Land, Kam Tin, New Territories

Title:

Indicative Layout Plan

Figure:

01 Rev. B

Scale:

1 : 500

Date:

Aug. 2025

Consultant:

MC Man Chi
Consultants And Construction Limited

2025-07-08 08:00 dicky

\\psa2015\cad drawing\PROJECT-2025\Miscellaneous\Lot 444 & 445 RP in D.D.106\Lot 444 & 445 RP in D.D.106_F1.dwg

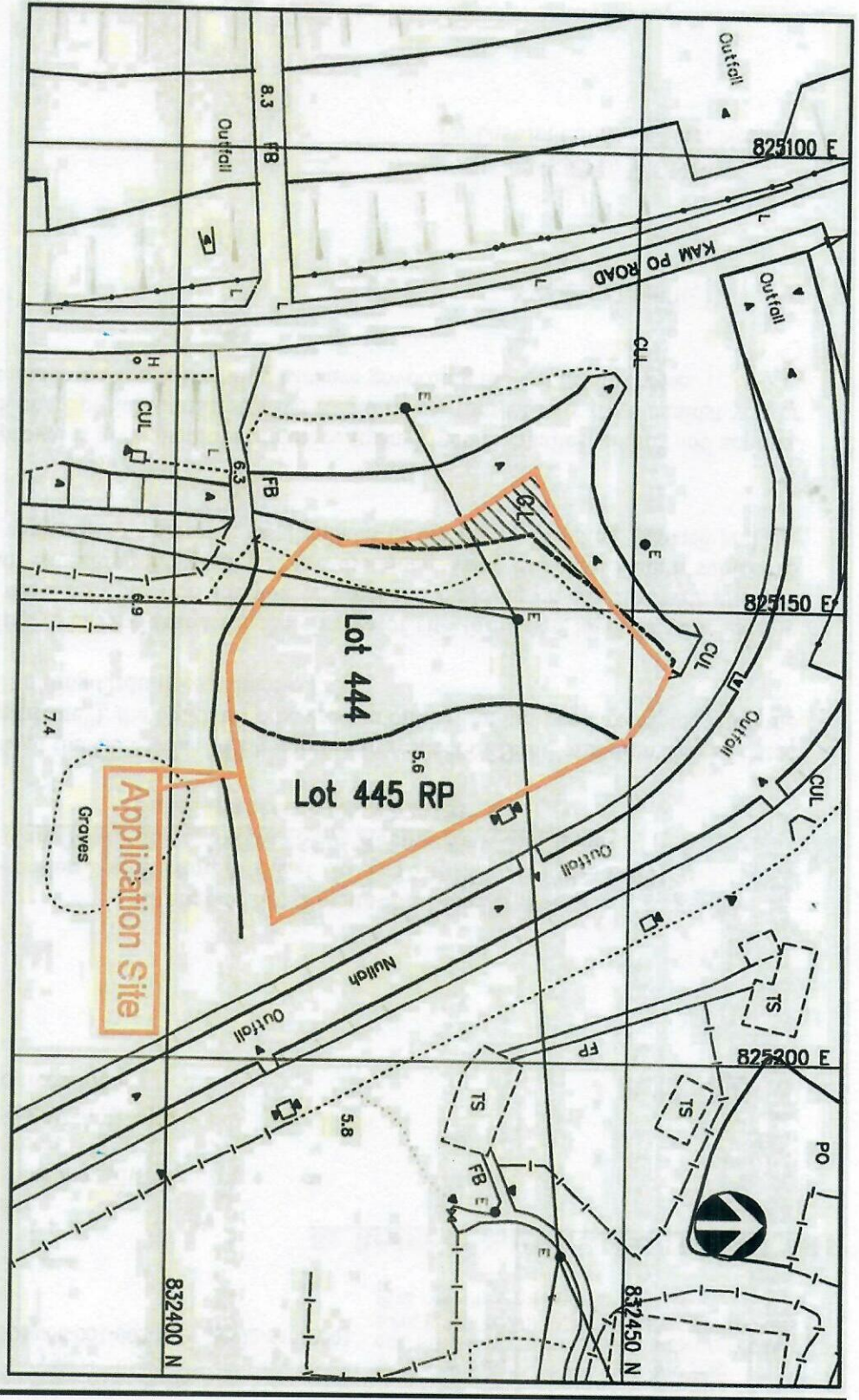

Project: Proposed Temporary Warehouse (excluding Dangerous Goods Godown) with Ancillary Facilities for a Period of 3 Years at Lot 444 (Part), 445 RP in DD 106, and adjoining Government Land, Kam Tin, New Territories	Title: Location Plan of the Application Site (For Identification Only)	Figure:02 Scale: Not to Scale August 2025	Man Chi Consultants and Construction Limited
---	---	--	---

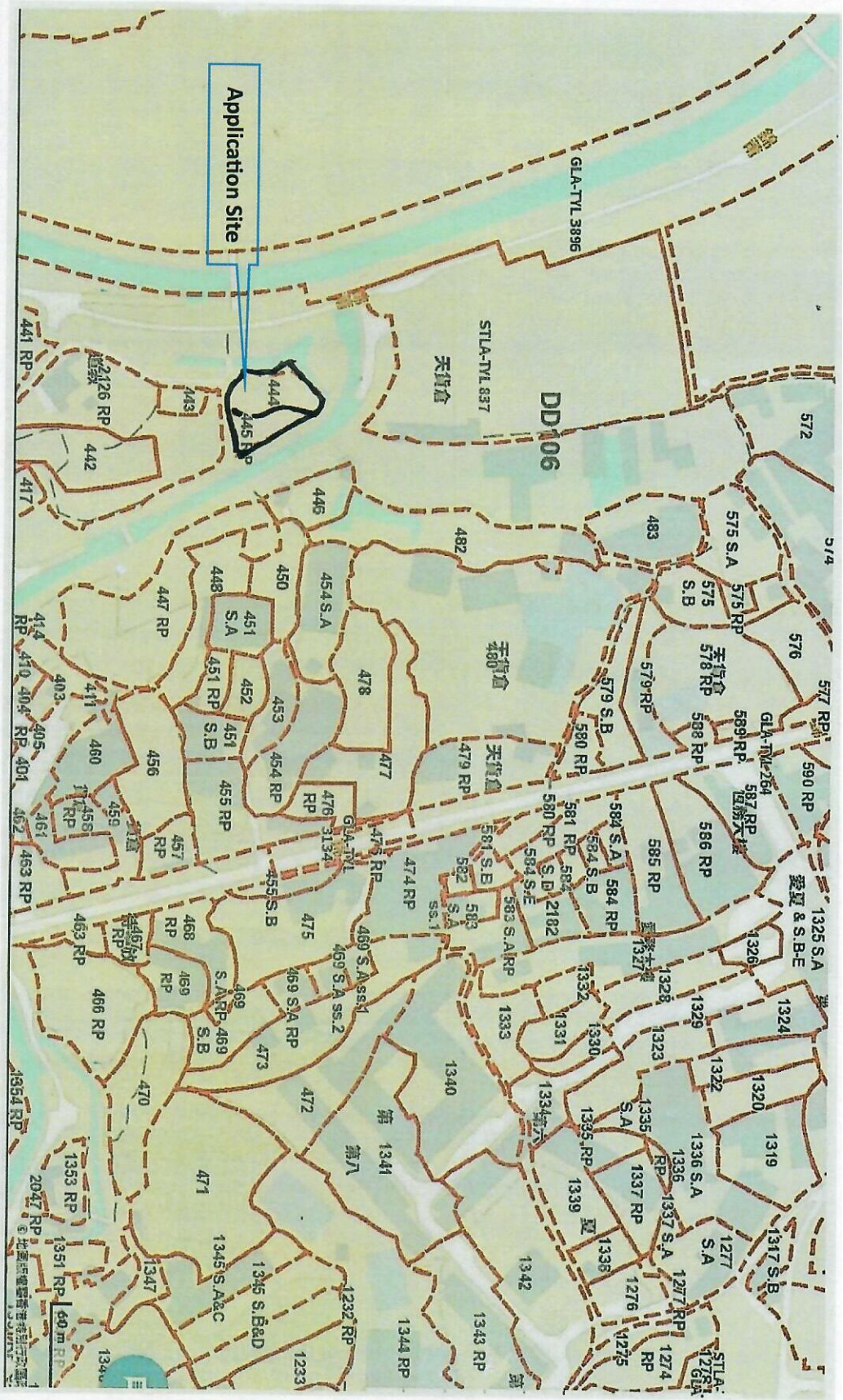

Project: Proposed Temporary Warehouse (excluding Dangerous Goods Godown) with Ancillary Facilities for a Period of 3 Years at Lot 444 (Part), 445 RP in DD 106, and adjoining Government Land, Kam Tin, New Territories	Title: Location Plan of the Application Site (For Identification Only)	Figure:02(a) Scale: Not to Scale August 2025	Man Chi Consultants and Construction Limited
---	---	---	---

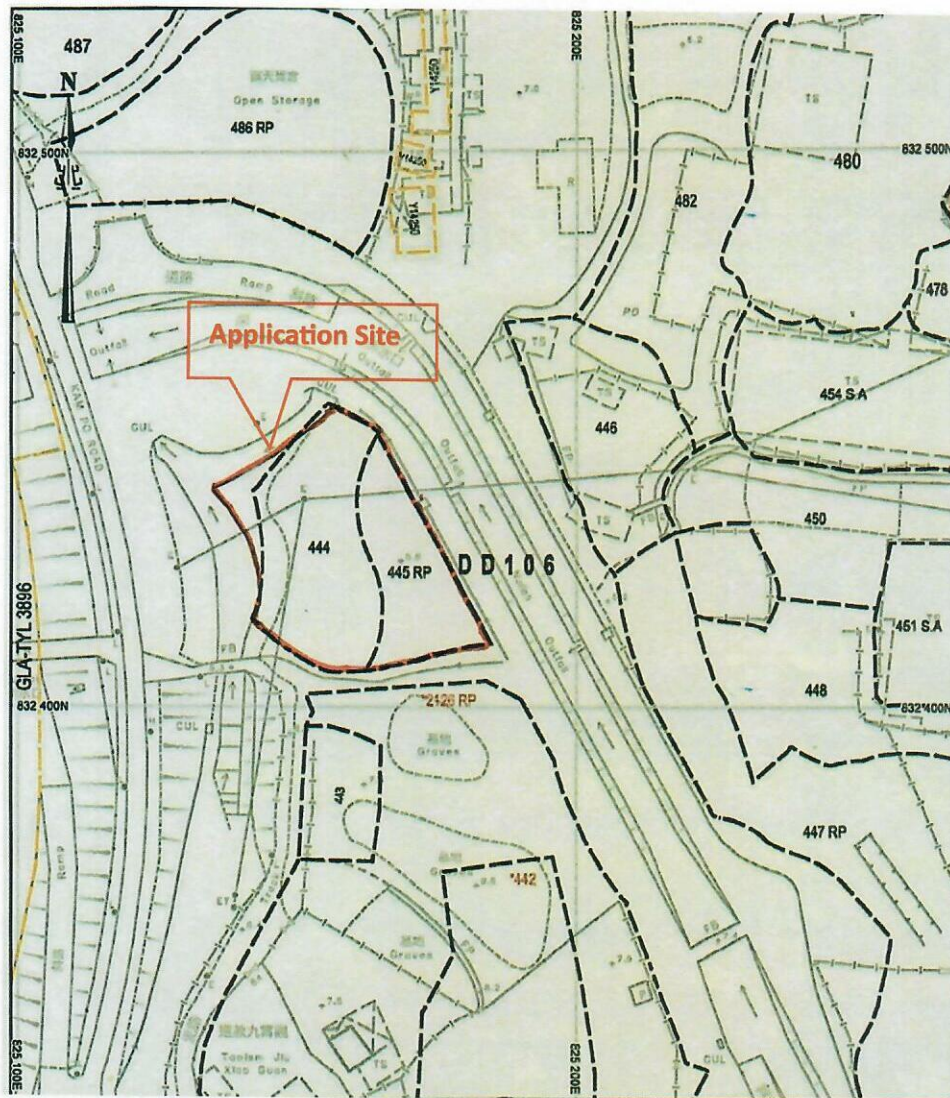

Project: Proposed Temporary Warehouse (excluding Dangerous Goods Godown) with Ancillary Facilities for a Period of 3 Years at Lot 444 (Part), 445 RP in DD 106, and adjoining Government Land, Kam Tin, New Territories	Title: Extract of Lot Index Plan (No.ags-S00000138365-001)	Figure:3 Not to Scale August 2025	Man Chi Consultants and Construction Limited
---	--	--	---

List of Illustrations

Illustration	Existing Condition of the Application Site (Photos A& B)
--------------	--

Photo A- Existing Condition of the Application Site



Photo B-Existing Condition of the Application Site

