

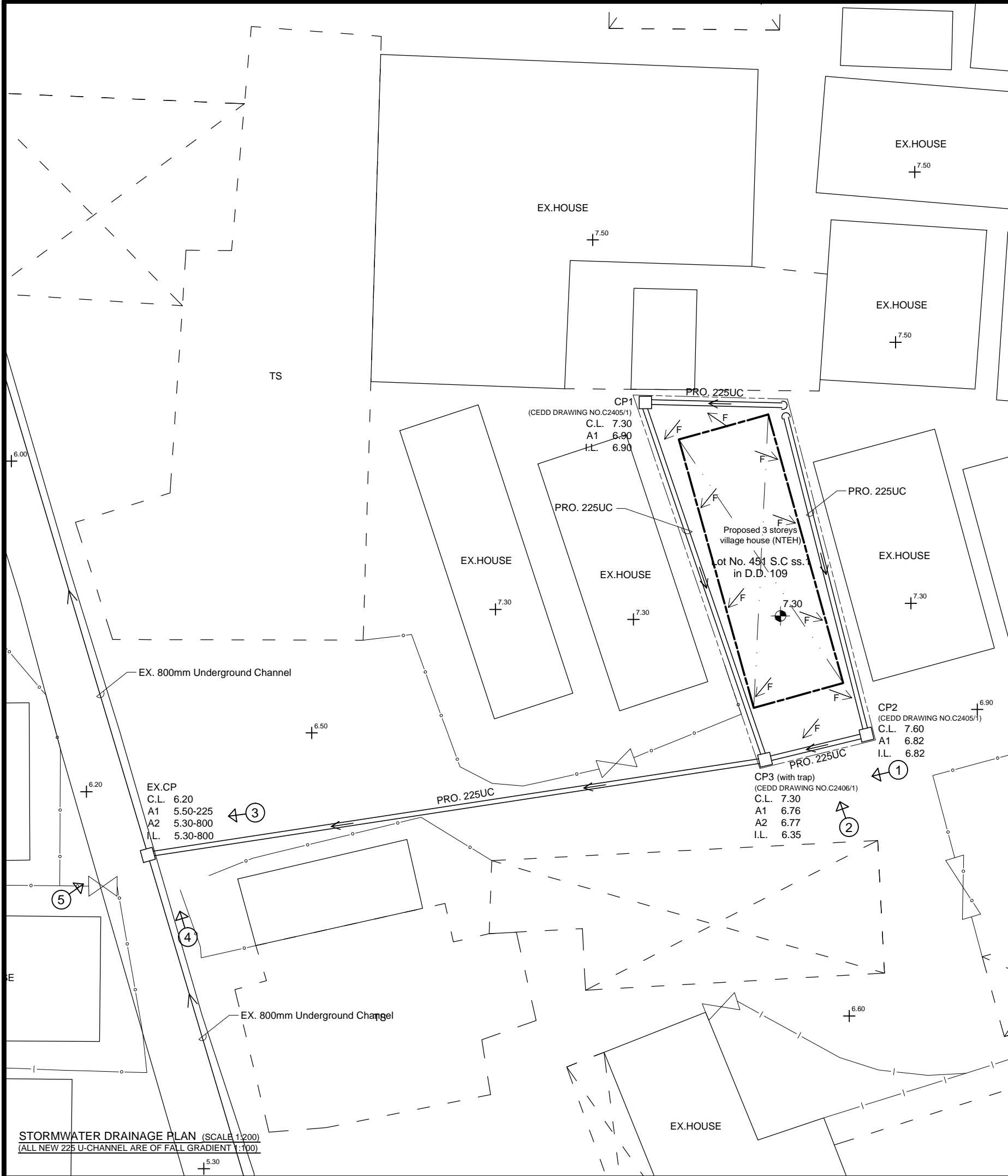

LEGEND:

DATE: 18 / 8 / 2025



STORMWATER DRAINAGE PLAN (SCALE 1:200)  
(ALL NEW 225 U-CHANNEL ARE OF FALL GRADIENT 1:100)

COLOUR INDICATION

- PROPOSED STORMWATER WORKS
- PROPOSED SEWERAGE DRAINAGE WORKS
- CONCRETE WORKS
- STEEL WORKS

LEGEND

- PROPOSED SITE FORMATION LEVEL
- EXISTING SITE FORMATION LEVEL
- FLOW PATTERN
- SUBJECT LOT BOUNDARY
- SUBJECT BUILDING LINE
- PRO. 225 UC
- PROPOSED 225mm / 300mm U-CHANNEL with CONC./C.I. COVER
- PRO. 225mm STEP CHANNEL
- PROPOSED 225mm STEP CHANNEL
- PRO. 75 UPVC
- PROPOSED 75 UPVC PIPE FOR RAINWATER ROOF FALL
- EX. 800mm UNDERGROUND CHANNEL
- EXISTING 800mm UNDERGROUND CHANNEL
- EXISTING STORMWATER MANHOLE
- PROPOSED STORMWATER CATCHPIT
- PROPOSED SEWERAGE MANHOLE
- EXISTING GOVERNMENT SEWERAGE MANHOLE
- PROPOSED SEWERAGE TERMINAL MANHOLE
- C.L.
- COVER LEVEL
- I.L.
- INVERT LEVEL
- D.T.L.
- DISCONNECTING TRAP LEVEL

NOTES FOR DRAINAGE WORKS

- Concrete mix to be grade 30D/20 design mix and comply with CSI:1990.
- Blinding layer to be grade 15P mix.
- Concrete cover to main steel bar to be 50mm.
- Reinforcement marked "R" denote mild steel bar (fy=250 MPa) and marked "Y" denote high tensile steel bar (fy=460 MPa) in compliance with B.S.4449: 1988 and CS2: 1995.
- Confirm that the invert levels of inlet u-channels and outlet u-channels are the same.
- Confirm that the levels of inlet invert and outlet invert of the proposed catchpits are the same.

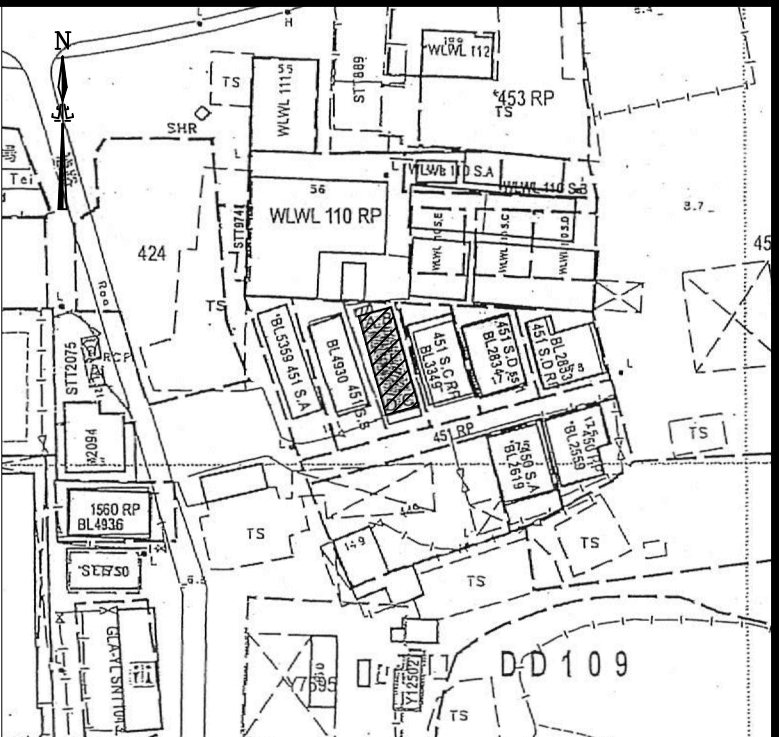

BLOCK PLAN (SCALE 1:1000)

REVISION		
NO.	DATE	
THIS SET OF DRAWING INCLUDES:		
DLO Ref.:		
Our Ref.:		
	NAME	DATE
DRAWN	Veronica Chiu	03/2023
CHECKED	Vincent Li	03/2023
PROJECT		
PROPOSED STORMWATER DRAINAGE WORKS on LOT No. 451 S.C ss.1 in D.D. 109, KAM TIN, Yuen Long, N.T.		
DRAWING TITLE		
BLOCK PLAN, STORMWATER DRAINAGE PLAN, DETAILS AND NOTES		
DRAWING NO.		SCALE
D - 1		AS SHOWN
WINLI 永利建設 CONSULTING ENGINEERS		