

SITE LOCATION

Lot 1812 S.I ss.1 S.A ss.1, in DD 106, Kam Tin, Yuen Long. N.T

APPLICATION FOR

Proposed Temporary Animal Boarding Establishment and Filling of Land for a Period of 3 Years

圖例 LEGEND

 Application Site

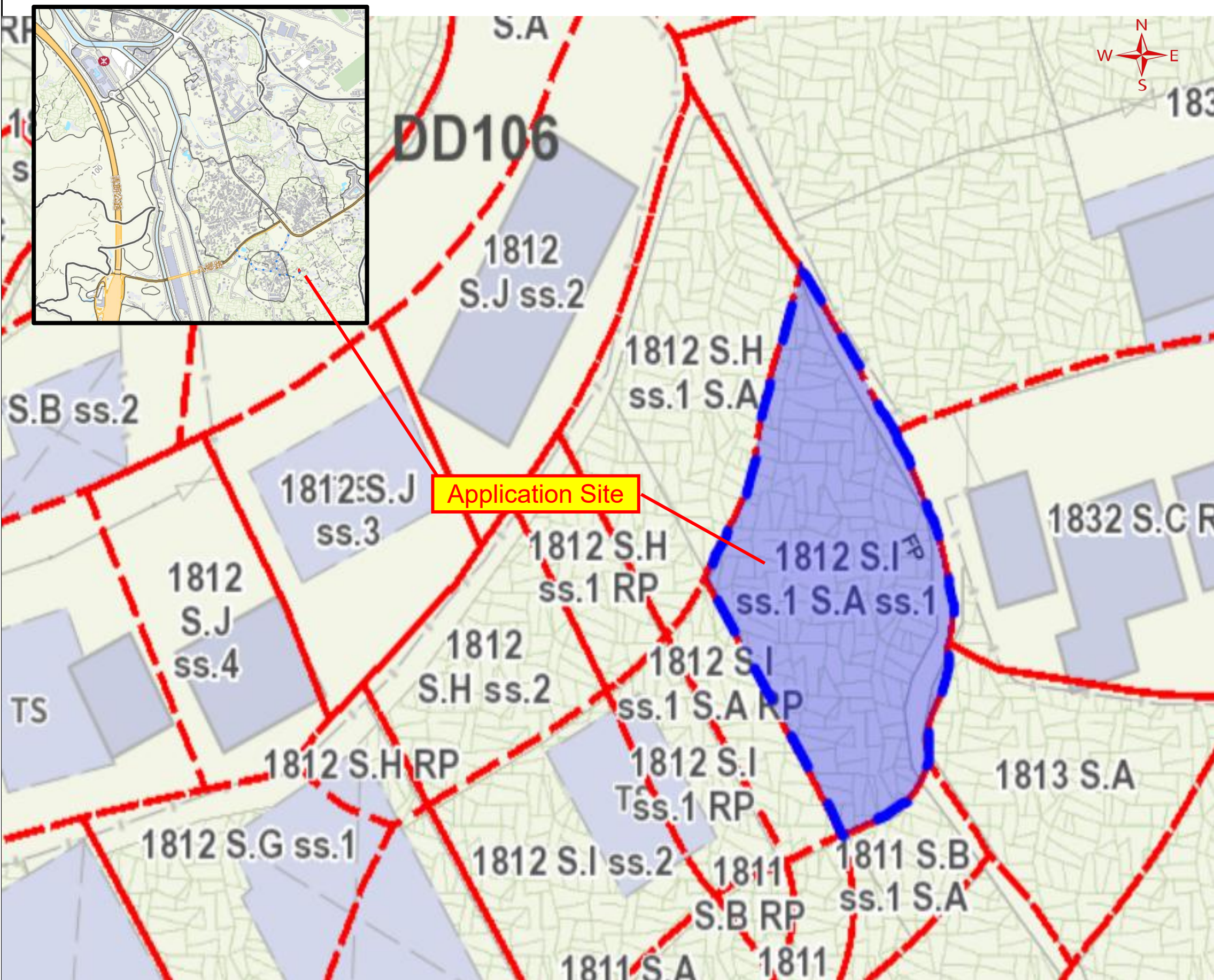

OZP S/YL-KTS/15

District Kam Tin South

Zoning: AGR

DWG TITLE

Location Plan

DWG NO.

1 - 01

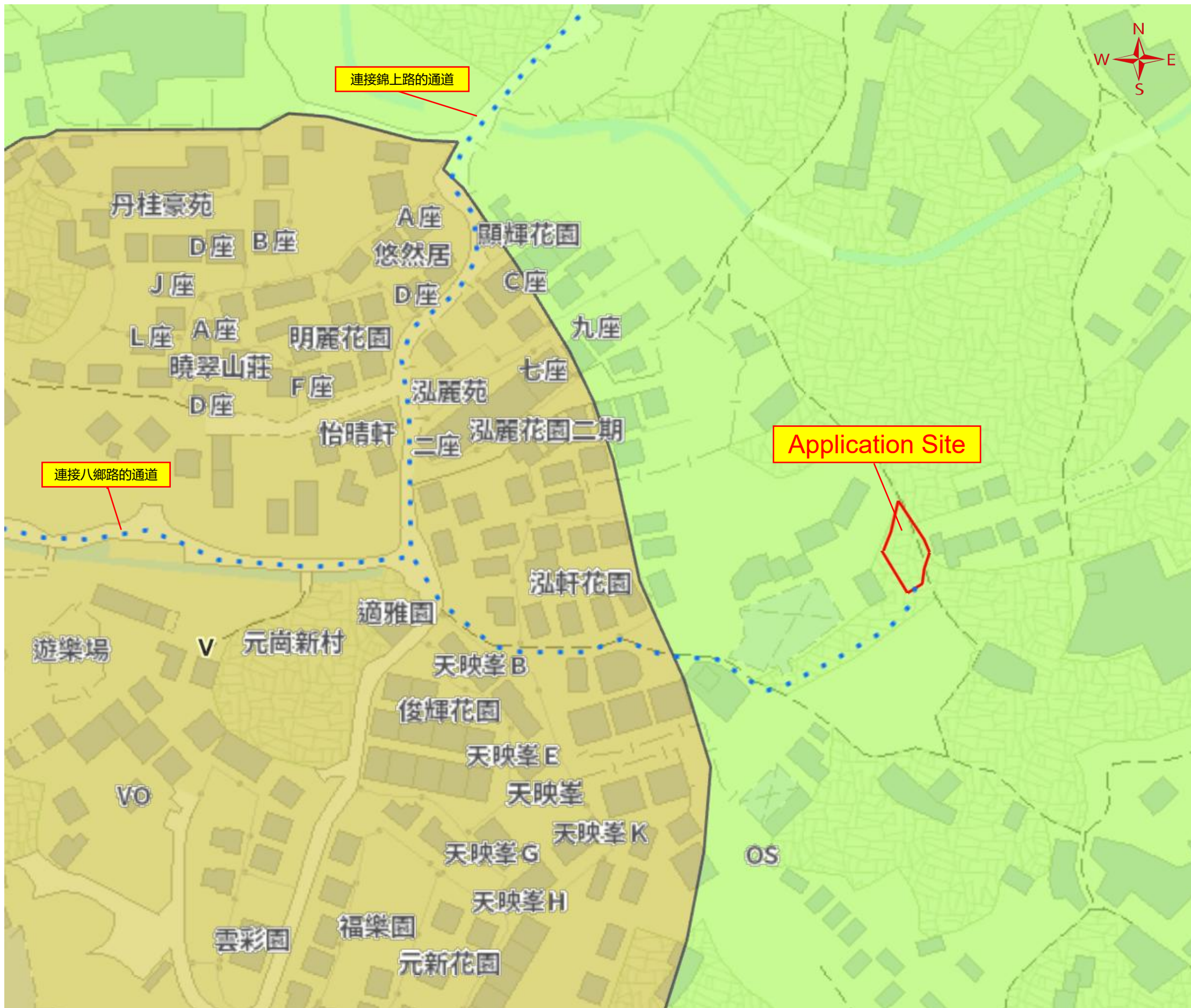

SITE LOCATION
 Lot 1812 S.I ss.1 S.A ss.1, in DD 106, Kam Tin, Yuen Long. N.T

APPLICATION FOR
 Proposed Temporary Animal Boarding Establishment and Filling of Land (for a Period of 3 Years)

圖例 LEGEND

■ AGR	農業
■ R(C)	住宅(丙類)
■ V	鄉村式發展

OZP	S/YL-KTS/15
District	Kam Tin South
Zoning:	AGR

DWG TITLE
Zoning Plan

DWG NO.
2 - 01

Structure 1	Boarding Establishment	77.75 m ² x 1 storey
Structure 2	office & Toilet	6m x 3.5m x 1 storey
Ingress/Egress	Gate wide	4.5m

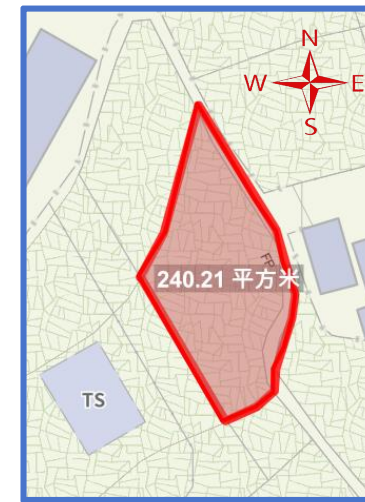

SITE LOCATION
 Lot 1812 S.I ss.1 S.A ss.1, in DD 106, Kam Tin, Yuen Long. N.T

APPLICATION FOR
 Proposed Temporary Animal Boarding Establishment and Filling of Land for a Period of 3 Years

圖例 LEGEND
 300mm surface U-channel (Gradient 1:200)
 Filling area

OZP	S/YL-KTS/15
District	Kam Tin South
Zoning:	AGR

DWG TITLE
 Layout and Filling area

DWG NO.
 3 - 01

Application Site

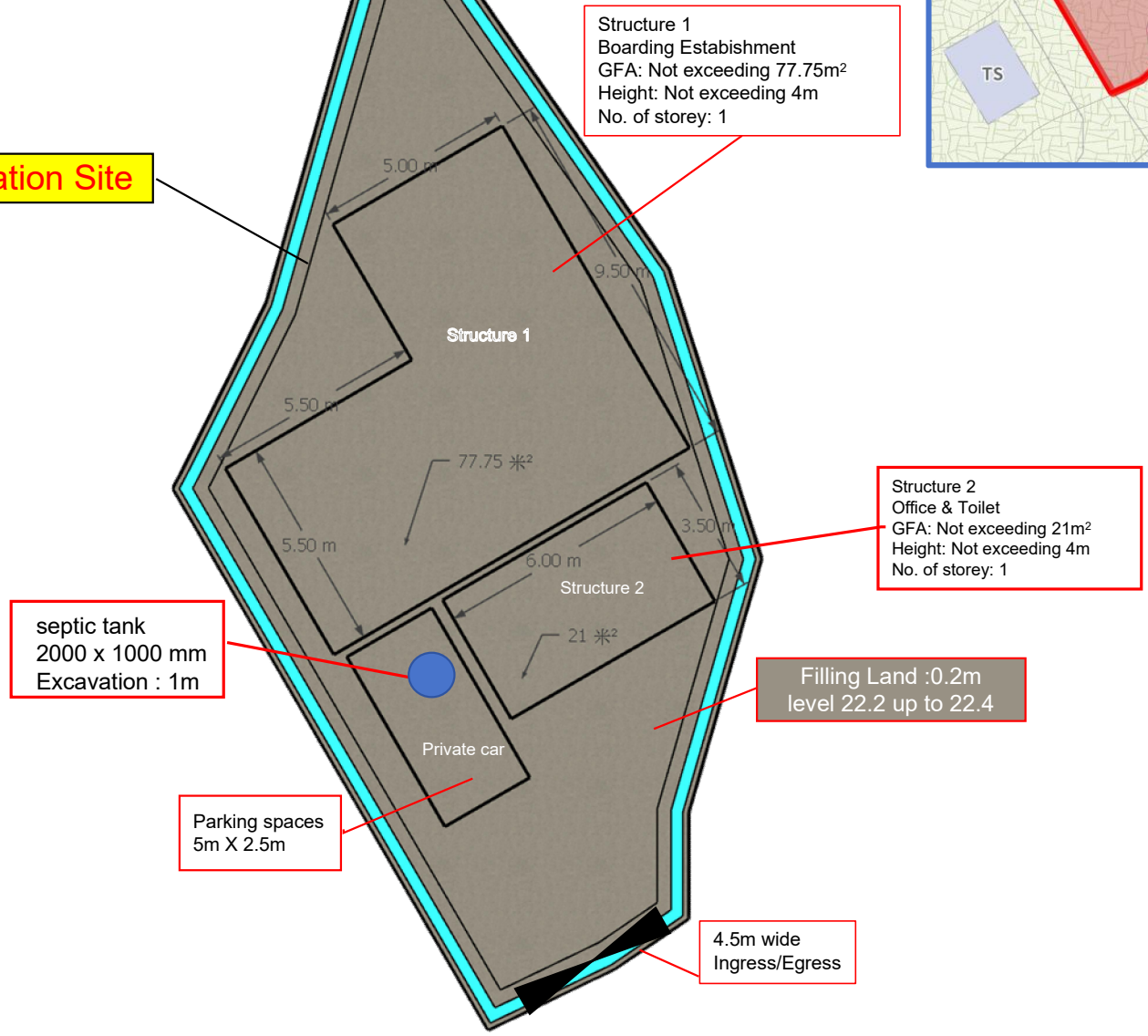

Structure 1
 Boarding Establishment
 GFA: Not exceeding 77.75m²
 Height: Not exceeding 4m
 No. of storey: 1

Structure 2
 Office & Toilet
 GFA: Not exceeding 21m²
 Height: Not exceeding 4m
 No. of storey: 1

Filling Land :0.2m
 level 22.2 up to 22.4

septic tank
 2000 x 1000 mm
 Excavation : 1m

Parking spaces
 5m X 2.5m

4.5m wide
 Ingress/Egress



SITE LOCATION

Lot 1812 S.I ss.1 S.A ss.1, in DD 106, Kam Tin, Yuen Long. N.T

APPLICATION FOR

Proposed Temporary Animal Boarding Establishment and Filling of Land for a Period of 3 Years

圖例 LEGEND

Walking about 550m to Bus Stop

OZP	S/YL-KTS/15
-----	-------------

District	Kam Tin South
----------	---------------

Zoning:	AGR
---------	-----

DWG TITLE

Vehicular access plan

DWG NO.

4 - 01





SITE LOCATION

Lot 1812 S.I ss.1 S.A ss.1, in DD 106, Kam Tin, Yuen Long. N.T

APPLICATION FOR

Proposed Temporary Animal Boarding Establishment and Filling of Land for a Period of 3 Years

圖例 LEGEND



Walking about 550m to Bus Stop



OZP	S/YL-KTS/15
-----	-------------

District	Kam Tin South
----------	---------------

Zoning:	AGR
---------	-----

DWG TITLE
Vehicular access plan

DWG NO.	4 - 02
---------	--------

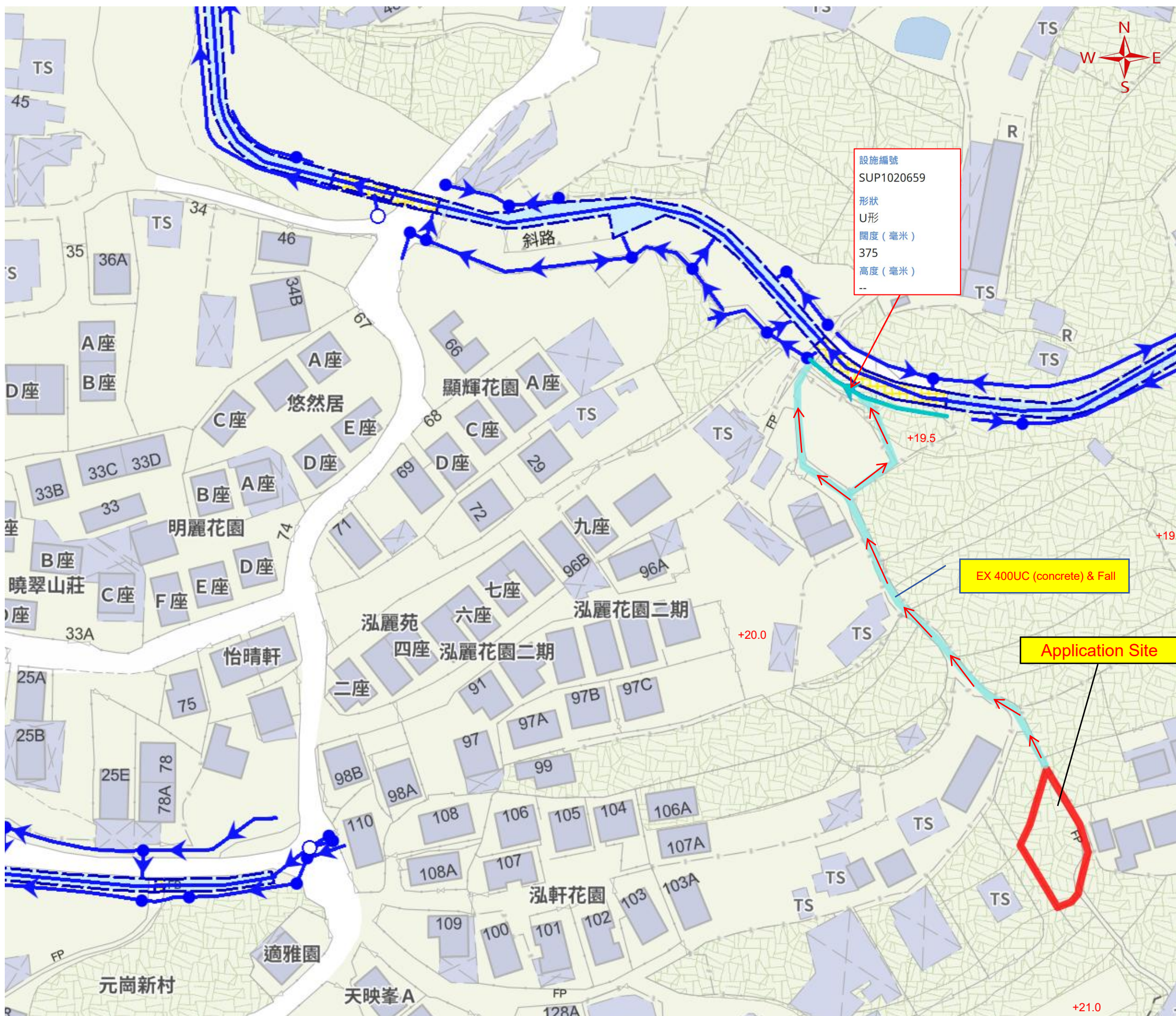

設施編號
SUP1020659
形狀
U形
闊度 (毫米)
375
高度 (毫米)
--

EX 400UC (concrete) & Fall

Application Site

SITE LOCATION
Lot 1812 S.I ss.1 S.A ss.1, in DD 106, Kam Tin, Yuen Long. N.T

APPLICATION FOR
Proposed Temporary Animal Boarding Establishment and Filling of Land (for a Period of 3 Years)

圖例 LEGEND
 Water flow direction
 渠管 (雨水)
 = EX 400UC (concrete) & Fall

OZP	S/YL-KTS/15
District	Kam Tin South
Zoning:	AGR



DWG TITLE
Drainage Plan

DWG NO.
5 - 01



SITE LOCATION
 Lot 1812 S.I ss.1 S.A
 ss.1, in DD 106, Kam
 Tin, Yuen Long. N.T

APPLICATION FOR
 Proposed Temporary
 Animal Boarding
 Establishment
 and Filling of Land for a
 Period of 3 Years

圖例 LEGEND
 300mm surface U-channel
 (Gradient 1:200)
 集水井
 Water flow direction

OZP	S/YL-KTS/15
District	Kam Tin South
Zoning:	AGR

DWG TITLE
Drainage Plan

DWG NO.
5 - 02

Application Site

Proposed 300mm
 surface U-channel
 (Gradient 1:200)

Proposed 300mm surface U-channel
 (Gradient 1:200)

300mm surface U-channel

Proposed 300mm
 surface U-channel
 (Gradient 1:200)

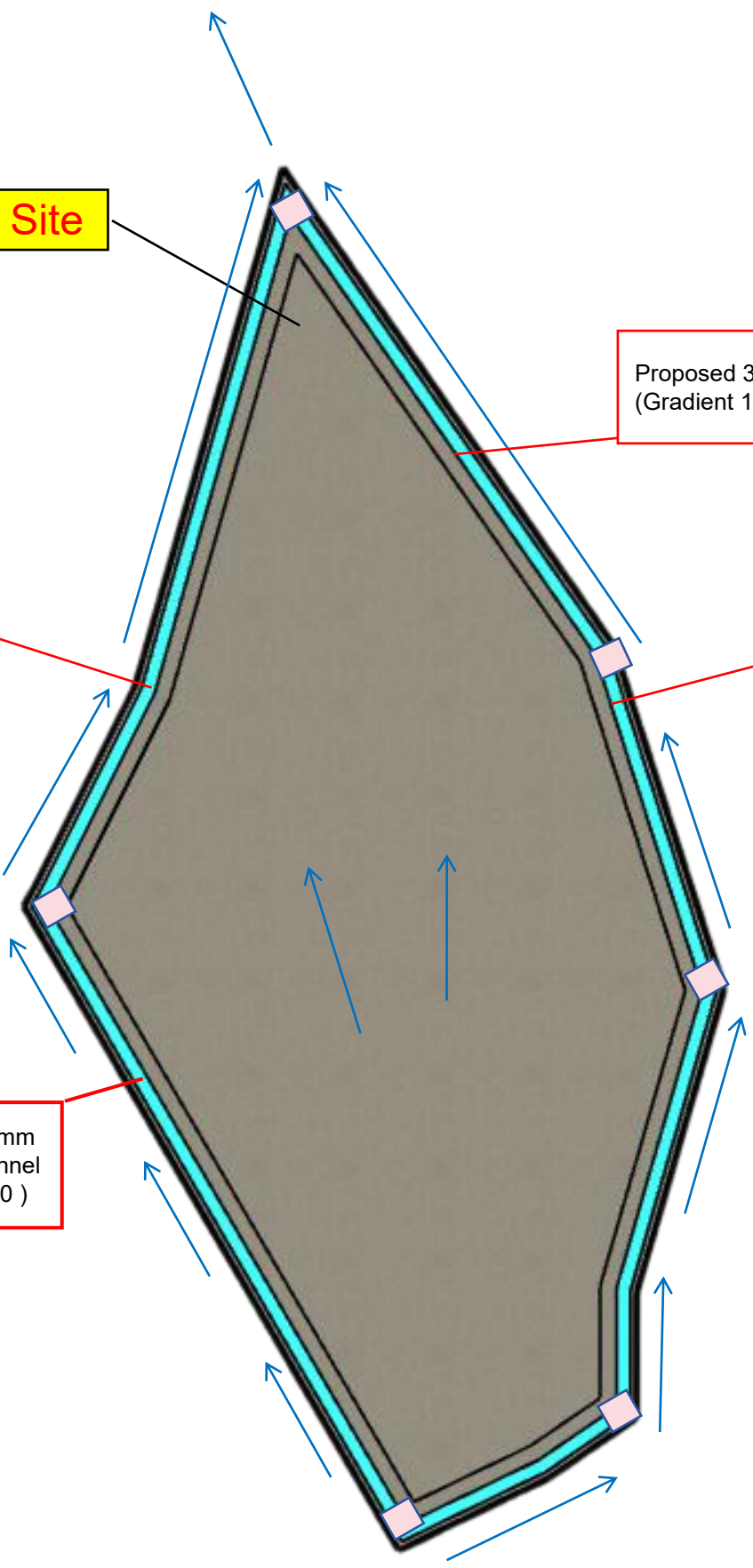

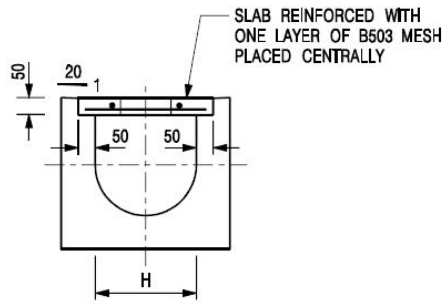

TYPICAL SECTION

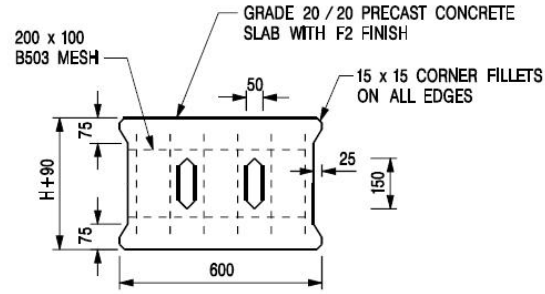

PLAN OF SLAB

U-CHANNELS WITH PRECAST CONCRETE SLABS

(UP TO H OF 525)

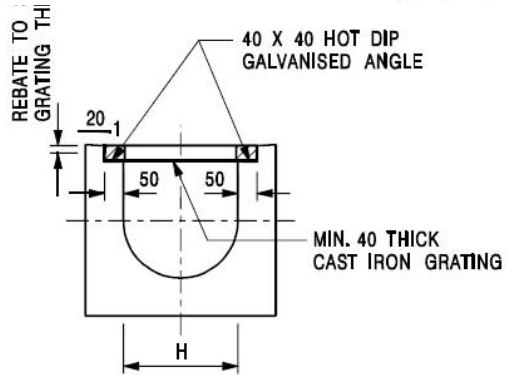

TYPICAL SECTION

(DIMENSIONS ARE FOR GUIDANCE ONLY, CONTRACTOR MAY SUBMIT EQUIVALENT TYPE)

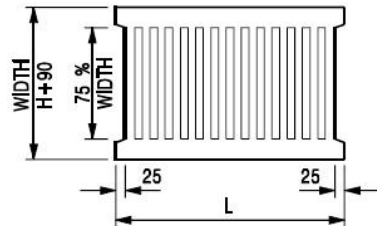

L = 600mm FOR H ≤ 375mm
L = 400mm FOR H > 375mm

CAST IRON GRATING

U-CHANNEL WITH CAST IRON GRATING

(UP TO H OF 525)

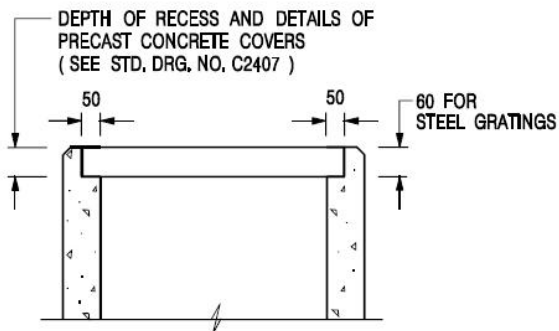

ALTERNATIVE TOP SECTION

FOR PRECAST CONCRETE COVERS / GRATINGS

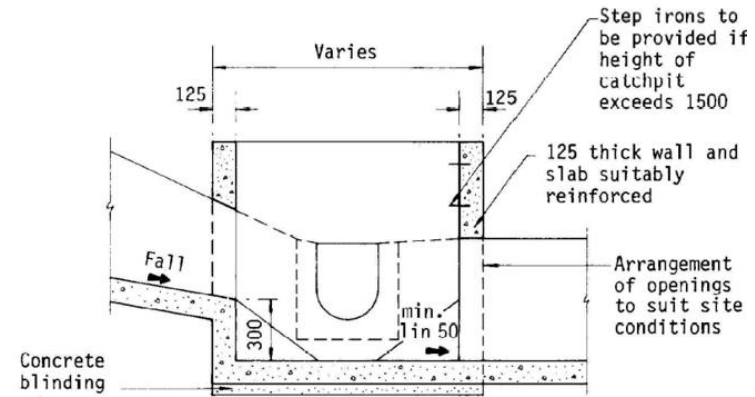

SECTION A-A

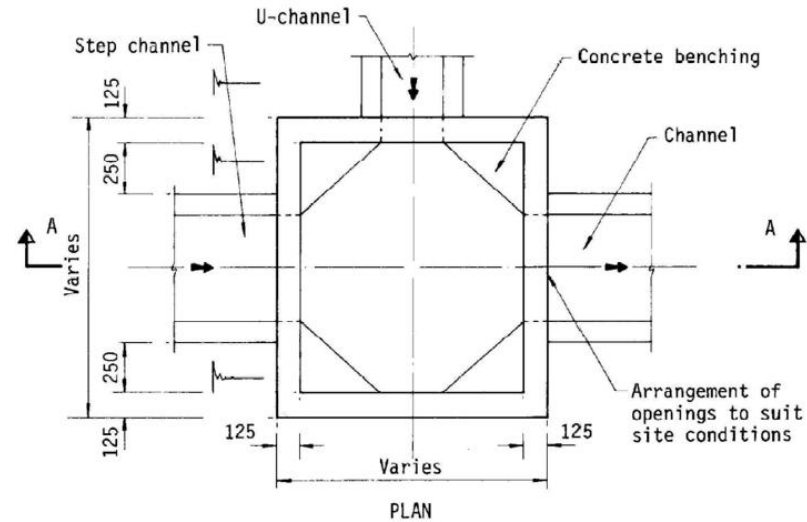

PLAN

Note : All dimensions in millimetres

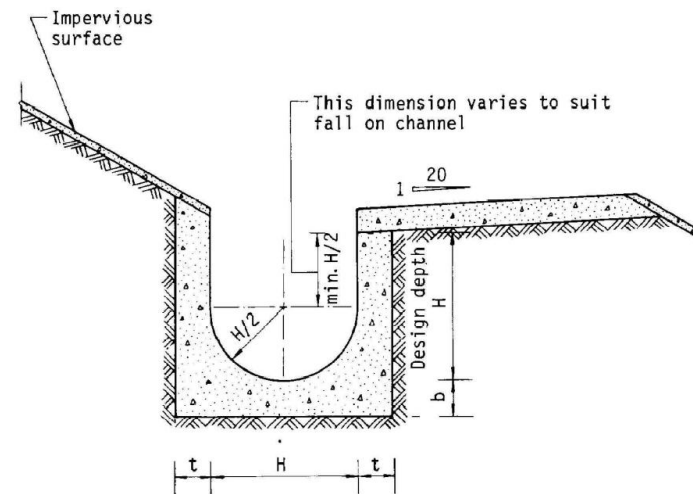

LEGEND

SITE LOCATION

Lot1812 S.I ss.1 S.A ss.1, in DD 106, Kam Tin, Yuen Long. N.T

PROJECT

Proposed Temporary Animal Boarding Establishment and Filling of Land. (for a Period of 3 Years)

SCALE

OZP: SYL-KTS/15

District: Kam Tin South

Zoning: AGR

DWG TITLE

Drainage Plan

DWG NO.

5 - 03

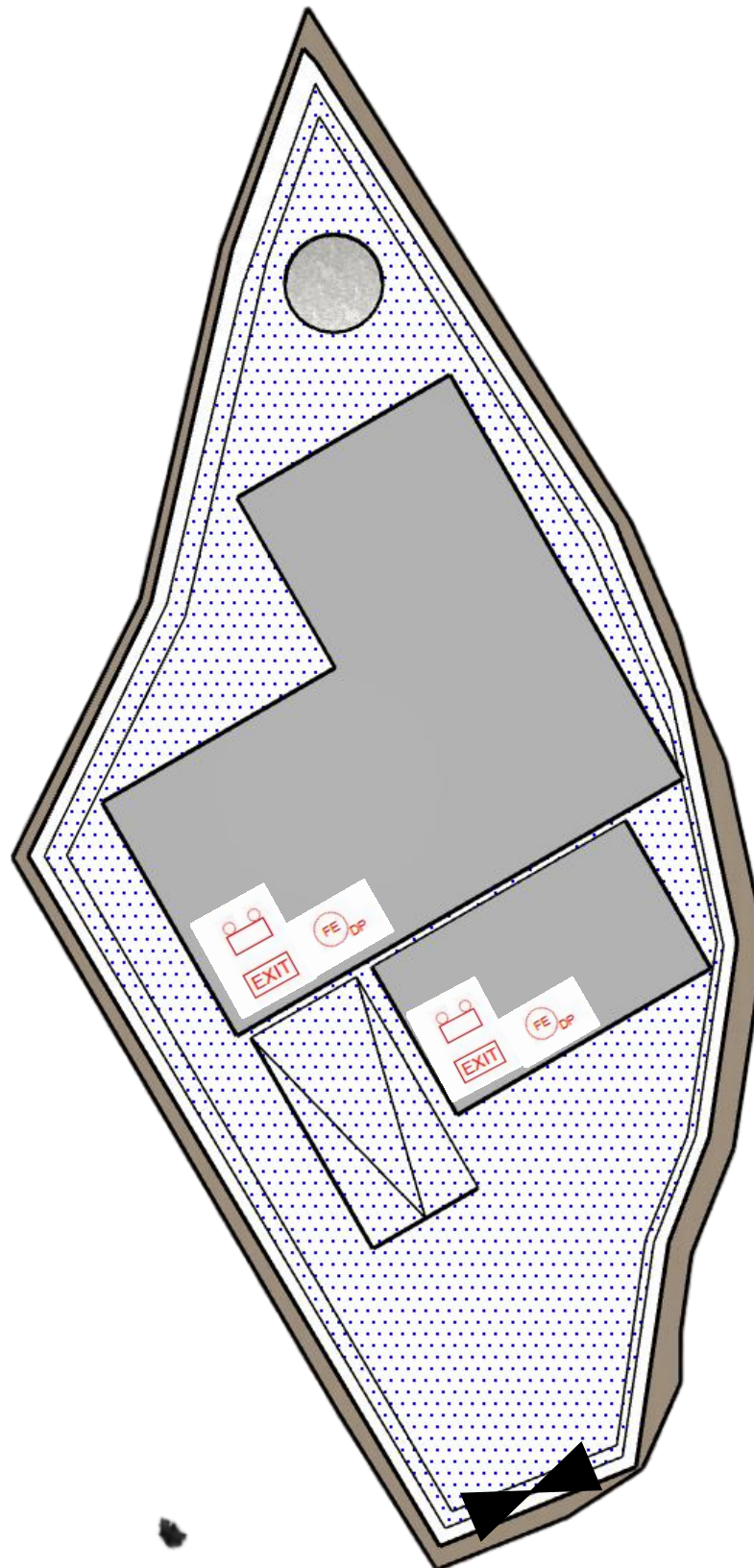

FIRE SERVICE INSTALLATIONS

-  EMERGENCY LIGHT
-  EXIT SIGN
-  4 KG DRY POWDER TYPE FIRE EXTINGUISHER





FS NOTES:

1. SUFFICIENT EMERGENCY LIGHTING SHALL BE PROVIDED THROUGHOUT THE ENTIRE BUILDING IN ACCORDANCE WITH BS 5266-1:2016 AND BS EN1838:2013 AND FSD CIRCULAR LETTER 4/2021.
2. SUFFICIENT DIRECTIONAL AND EXIT SIGN SHALL BE PROVIDED IN ACCORDANCE WITH BS5266-1:2016 AND THE FSD CIRCULAR LETTER 5/2008.
3. PORTABLE HAND-OPERATED APPROVED APPLIANCE SHALL BE PROVIDED AS REQUIRED BY OCCUPANCY.
4. ACCESS IS PROVIDED FOR EMERGENCY VEHICLE TO REACH 30m OF ALL PART OF STRUCTURES.

**SITE BOUNDARY FOR IDENTIFICATION PURPOSE ONLY.*



LEGEND

-  APPLICATION SITE
-  STRUCTURE (ENCLOSED)
-  PARKING SPACE
-  INGRESS / EGRESS

SITE LOCATION

Lot1812 S.I ss.1 S.A ss.1, in DD 106, Kam Tin, Yuen Long. N.T

PROJECT

Proposed Temporary Animal Boarding Establishment and Filling of Land. (for a Period of 3 Years)

SCALE

OZP: S/YL-KTS/15

District: Kam Tin South

Zoning: AGR

DWG TITLE

Proposed FIRE Plan

DWG NO.

6 - 01

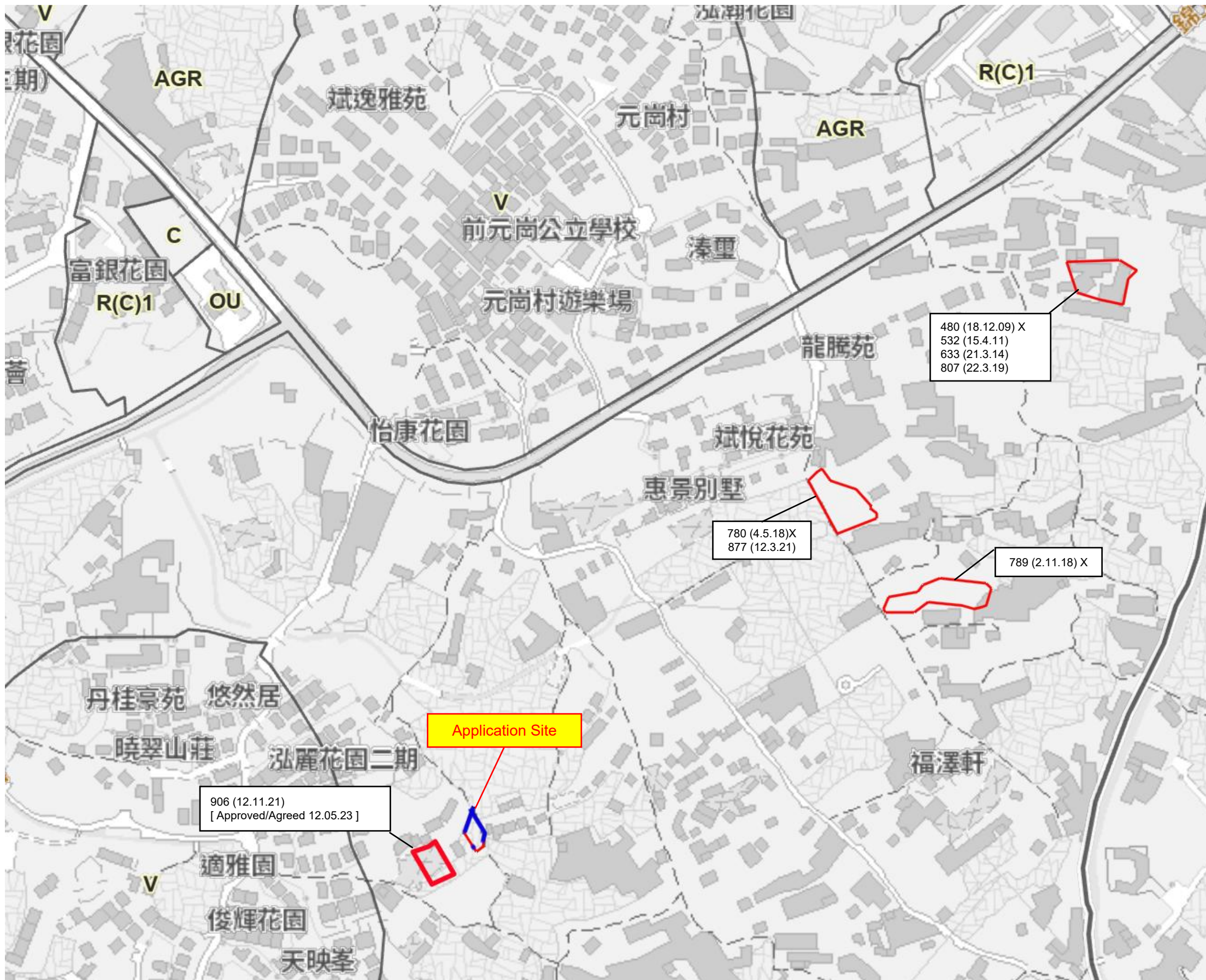

圖例 LEGEND

243 (17.7.04)	獲批准的申請 APPROVED APPLICATION
244 (17.7.04)	被拒絕的申請 REJECTED APPLICATION
72 (10.9.99) X	已撤銷 REVOKED
	會議日期 DATE OF MEETING
	申請編號 APPLICATION NUMBER

申請地點界線只作識別用
APPLICATION SITE BOUNDARY
FOR IDENTIFICATION PURPOSE ONLY

SITE LOCATION

Lot1812 S.I ss.1 S.A
ss.1, in DD 106, Kam
Tin, Yuen Long. N.T

PROJECT

Proposed Temporary
Animal Boarding
Establishment and
Filling of Land. (for a
Period of 3 Years)

SCALE

OZP: S/YL-KTS/15

District: Kam Tin South

Zoning: AGR

DWG TITLE

Similar Applications
Approved

DWG NO.

7 - 01

Similar Applications in the Same “ Agriculture” Zone on the Kam Tin South OZP Approved Applications

	Application No.	Proposed Uses	Date of Consideration (RNTPC)
1	A/YL-KTS/480*	Proposed Animal Boarding Establishment	18.12.2009 (on temporary basis for a period of 3 Years) [revoked on 18.12.2010]
2	A/YL-KTS/532*	Proposed Animal Boarding Establishment for a Period of 3 Years	15.4.2011
3	A/YL-KTS/633*	Renewal of Planning Approval for Temporary Animal Boarding Establishment under Application No. A/YL-KTS/532 for a Period of 3 Years	21.3.2014 (on temporary basis for a period of 3 years)
4	A/YL-KTS/780#	Proposed Temporary Animal Boarding Establishment for a Period of 3 Years	4.5.2018 [revoked on 4.10.2020]
5	A/YL-KTS/789	Proposed Temporary Animal Boarding Establishment for a Period of 3 Years	2.11.2018 [revoked on 2.4.2019]
6	A/YL-KTS/807*	Temporary Animal Boarding Establishment for a Period of 3 Years	22.3.2019
7	A/YL-KTS/877#	Proposed Temporary Animal Boarding Establishment for a Period of 5 Years	12.3.2021
8	A/YL-KTS/906	Proposed Temporary Animal Boarding Establishment (Cattery) for a Period of 3 Years and Filling of Land.	12.11.2021 [Approved/Agreed 12.05.2023]

These applications share the same site to the northeast of the current application Site.

* These applications share the same site to the further northeast of the current application Site.

Site Location

Lot1812 S.I ss.1 S.A ss.1,
in DD 106, Kam Tin,
Yuen Long. N.T

PROJECT

Proposed Temporary Animal Boarding Establishment and Filling of Land. (fo

圖例 LEGEND

SCALE

OZP: S/YL-KTS/15

District: Kam Tin South

Zoning: AGR

DWG TITLE

DWG NO.

8 - 01