

**Application Site**

**Access Road**

**Extracted from Approved Kam Tin South Outline Zoning Plan No. S/YL-KTS/15**

<p>N.T.S</p>	<p><b>Location Plan</b></p>	<p><b>Goldrich Planners &amp; Surveyors Ltd.</b></p>
<p><b>February 2026</b></p>	<p>Lots 1892 S.AO, 1892 S.AR, 1892 S.AS, 1892 S.AU(part), 1892 S.AV, 1892 S.AX and 1892 S.AZ(part) in D.D.106 and adjoining government land</p>	<p><b>Plan 1 ( P 26007 )</b></p>

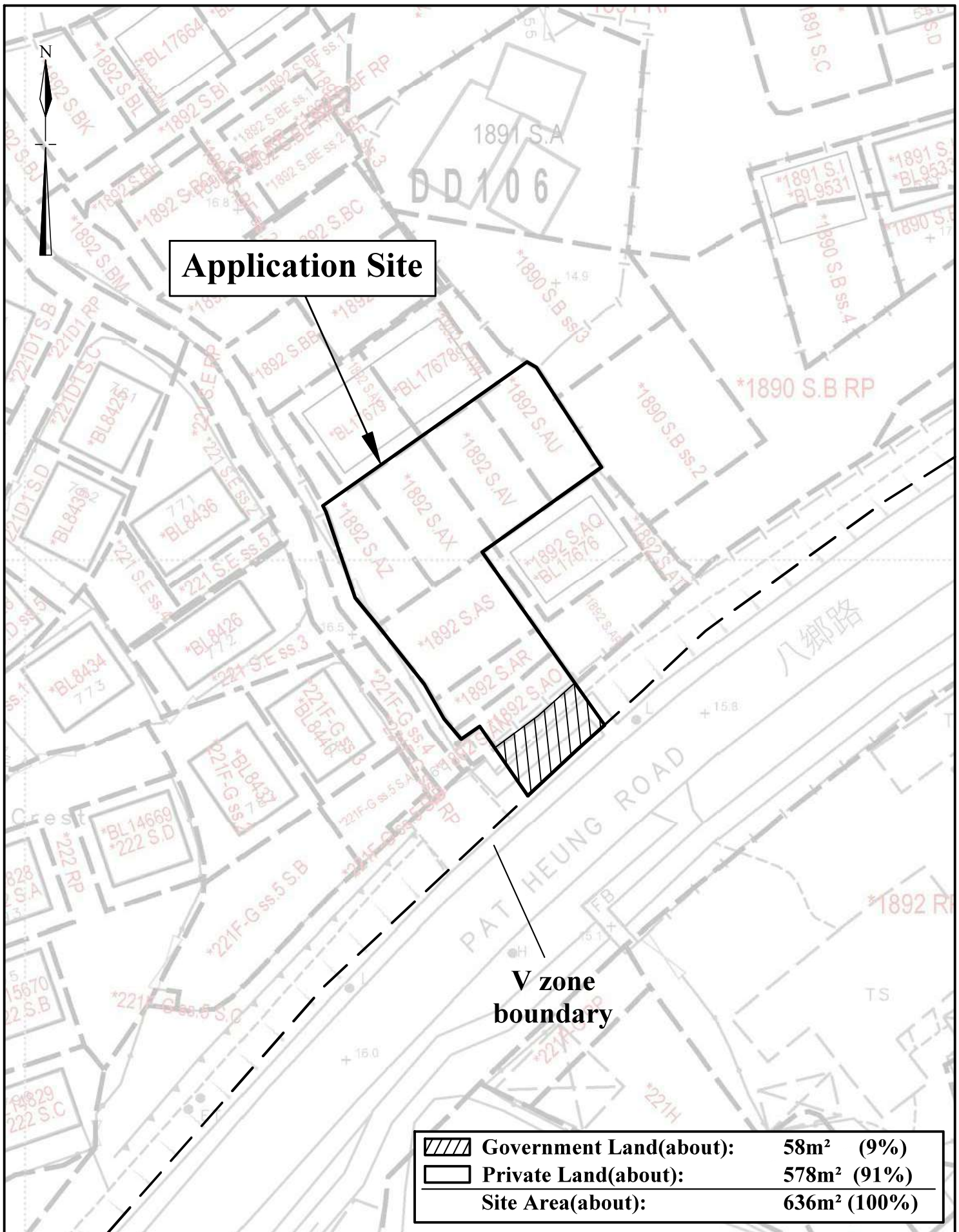

<p style="text-align: center;"><b>1:500</b></p>	<p style="text-align: center;"><b>Lot Index Plan</b></p>	<p style="text-align: center;"><b>Goldrich Planners &amp; Surveyors Ltd.</b></p>
<p style="text-align: center;"><b>February 2026</b></p>	<p style="text-align: center;">Lots 1892 S.AO, 1892 S.AR, 1892 S.AS, 1892 S.AU(part), 1892 S.AV, 1892 S.AX and 1892 S.AZ(part) in D.D.106 and adjoining government land</p>	<p style="text-align: center;"><b>Plan 2 ( P 26007 )</b></p>

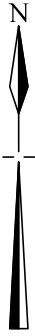

**Application Site**

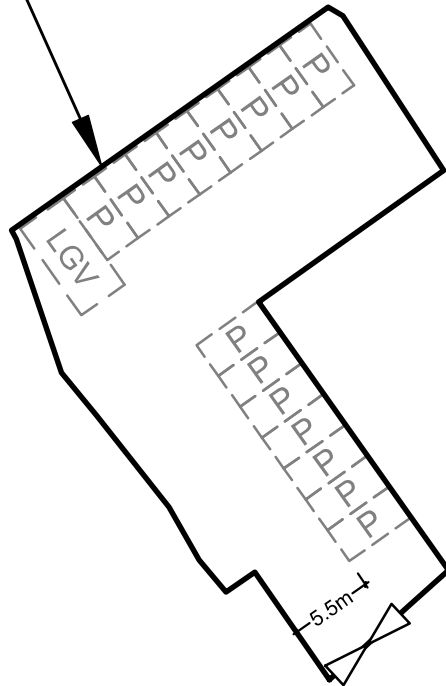

## Legend

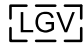
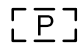
-  Vehicular Ingress / Egress
-  Parking space for light goods vehicle  
(7m (L) x 3.5m (W)) x 1 nos.
-  Parking space for private cars  
(5m (L) x 2.5m (W)) x 15 nos.

**Site Area(about): 636m<sup>2</sup>**

<b>1:500</b>	<b>Layout Plan</b>	<b>Goldrich Planners &amp; Surveyors Ltd.</b>
<b>May 2026</b>	<b>Lots 1892 S.AO, 1892 S.AR, 1892 S.AS, 1892 S.AU(part), 1892 S.AV, 1892 S.AX and 1892 S.AZ(part) in D.D.106 and adjoining government land</b>	<b>Plan 3 ( P 26007 )</b>

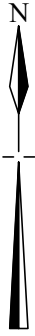

**Application Site**

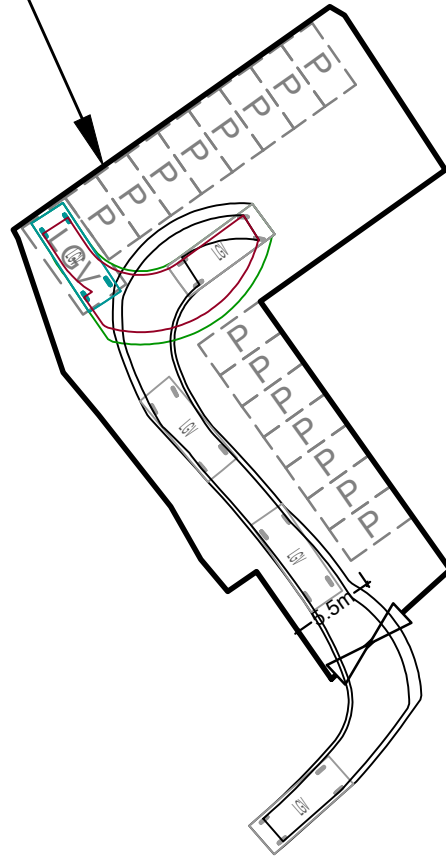

## Legend

 Vehicular Ingress / Egress

 Parking space for light goods vehicle  
(7m (L) x 3.5m (W))

 Parking space for private cars  
(5m (L) x 2.5m (W))

 Light goods vehicle  
(7m (L) x 2.5m (W))

**Site Area(about): 636m<sup>2</sup>**

<b>1:500</b>	<b>Swept Path Analysis</b>	<b>Goldrich Planners &amp; Surveyors Ltd.</b>
<b>May 2026</b>	<b>Lots 1892 S.AO, 1892 S.AR, 1892 S.AS, 1892 S.AU(part), 1892 S.AV, 1892 S.AX and 1892 S.AZ(part) in D.D.106 and adjoining government land</b>	<b>Plan 4 ( P 26007 )</b>