

PLANNING LIMITED

規劃顧問有限公司

UNIT K, 16/F, MG TOWER  
133 HOI BUN ROAD, KWUN TONG  
KOWLOON, HONG KONG

九龍觀塘海濱道133號  
萬兆豐中心16樓K室

電話TEL (852) 3426 0451

傳真FAX (852) 3426 9737

電郵EMAIL kta@ktaplanning.com

By Email

Our Ref: S3162/GREENFIELD/25/007Lg

1 August 2025

Secretary, Town Planning Board  
15/F, North Point Government Offices  
333 Java Road  
North Point  
Hong Kong

Dear Sir/Madam,

**Proposed Place of Recreation, Sports or Culture (Organic Farm,  
Barbecue Site, Education and Visitor Centre, Leisure Activity Area and  
Ancillary Facilities) and Filling of Pond and Land for a Temporary Period of 5 Years  
in "Green Belt" and "Village Type Development" Zones,  
Lots 2766 RP (Part), 2767 (Part), 2782, 2783, 2784, 2785 S.A, 2785 RP, 2787, 2828,  
2829, 2830, 2831 (Part), 2833, 2834, 2835, 2836, 2837, 2838, 2839, 2840, 2841 S.A RP  
(Part), 2841 S.B RP (Part), 2843 and 2845 RP (Part) in D.D. 129  
& Adjoining Government Land, Sha Kong Wai, Lau Fau Shan, New Territories  
(Planning Application No. A/YL-LFS/561)**

Reference is made to the captioned S16 Planning Application which comments from relevant Government Departments was received via emails from Tuen Mun and Yuen Long West District Planning Office ("DPO") on 18 July 2025.

With a view to address the comments received from the relevant Government Departments, please find below the Further Information ("FI") No. 2 consisting of the followings:

Responses-to-Comments Table

Annex A – Updated Information of the Existing Trees within the Site

Annex B – Updated Layout Plan

Should you have any queries in relation to the attached, please do not hesitate to contact the undersigned or Mr Faith Lai at Thank you for your kind attention.

Yours faithfully  
For and on behalf of  
KTA PLANNING LTD

Pauline Lam

Encl. Responses-to-Comments table with Annexes A to B

cc. DPO – Mr Wilfred Chu (by Email)  
Applicant & Team

PL/FL/vy



FS 579819



**Proposed Place of Recreation, Sports or Culture (Organic Farm, Barbecue Site, Education and Visitor Centre, Leisure Activity Area and Ancillary Facilities) for a temporary period of 5 Years and Filling of Pond in “GB” and “V” zones at Various Lots in DD129 and adjoining Government Land, Sha Kong Wai, Lau Fau Shan, New Territories  
(Planning Application No. A/YL-LFS/561)**

**Comments forwarded from Tuen Mun and Yuen Long West District Planning Office**

Comments	Responses
<b>Comments from Urban Design and Landscape Section, Planning Department (received on 18 July 2025) (Contact Person: Ms. May CHAN; Tel: 3565 3949)</b>	
1. In the FI (1), it is observed that the information on the trees located at the southeast of the pond is missing in the broad-brush tree survey.	Noted. The information on the trees located at the southeast of the pond is supplemented in the updated tree survey ( <b>Annex A</b> refers).
2. We would reserve our comment upon the receipt of the required landscape technical information in accordance with “Guidance notes on the application for permission under Section 16 of the Town Planning Ordinance (Cap. 131).	Noted.
<b>Comments from Tuen Mun and Yuen Long West District Planning Office, Planning Department (received on 18 July 2025) (Contact Person: Mr. Wilfred CHU; Tel: 2158 6290)</b>	
1. It is noted that the tree survey in the FI does not tally with the landscaping area in the layout plan (e.g. the trees at the southeast of the recreational pond are not included in the tree survey). Please review the tree survey and layout plan accordingly	Noted. The layout plan has been updated accordingly ( <b>Annex B</b> refers).

Compiled by: KTA

Date: 01 August 2025

## ***Annex A***

---

### **Updated Information of the Existing Trees within the Site**

## Tree Schedule

Old item	Item	Species	Chinese Name	Quantity
T1	T1	<i>Terminalia mantaly</i>	細葉欖仁	7
T2	T2	<i>Litchi chinensis</i>	荔枝	2
T3	T3	<i>Ficus benamina</i>	垂榕	14
T4	T4	<i>Heteropanax fragrans</i>	幌傘楓	5
T5	T5	<i>Juniperus chinensis</i>	龍柏	4
T6	(out of boundary)	<i>Ficus benamina</i>	垂榕	1
T7	(out of boundary)	<i>Ficus microcarpa</i>	細葉榕	1
T8	(out of boundary)	<i>Ficus virens</i>	黃葛樹	4
T9	(out of boundary)	<i>Plumeria obtusa</i>	雞蛋花	6
T10	(out of boundary)	<i>Artocarpus heterophyllus</i>	菠籐蜜	4
T11	T6	<i>Ficus virens</i>	黃葛樹	33
T12	(out of boundary)	<i>Syzygium jambos</i>	蒲桃	1
T13	(out of boundary)	<i>Ficus virens</i>	黃葛樹	1
T14	(out of boundary)	<i>Ficus benamina</i>	垂榕	3
T15	(out of boundary)	<i>Melia azedarach</i>	苦楝	1
T16	(out of boundary)	<i>Terminalia mantaly</i>	細葉欖仁	1
T17	(out of boundary)	<i>Litchi chinensis</i>	荔枝	1
T18	(out of boundary)	<i>Terminalia mantaly</i>	細葉欖仁	6
T19	(out of boundary)	<i>Melaleuca cajuputi</i>	白千層	1
T20	(out of boundary)	<i>Terminalia mantaly</i>	細葉欖仁	6
T21	(out of boundary)	<i>Terminalia mantaly</i>	細葉欖仁	2
T22	(out of boundary)	<i>Celtis sinensis</i>	朴樹	1
T23	T7	<i>Melaleuca cajuputi</i>	白千層	1
T24	T8	<i>Terminalia mantaly</i>	細葉欖仁	7
T25	T9	<i>Terminalia mantaly</i>	細葉欖仁	6; and 4 out of boundary
T26	T10	<i>Ficus virens</i>	黃葛樹	4
T27	T11	<i>Corymbia torelliana</i>	毛葉桉	1
T28	T12	<i>Archontophoenix alexandrae</i>	假檳榔	5
T29	T13	<i>Ficus microcarpa</i>	細葉榕	3
T30	T14	<i>Ficus benamina</i>	垂榕	2
T31	T15	<i>Ficus microcarpa</i>	細葉榕	2
T32	T16	<i>Ficus virens</i>	黃葛樹	1
T33	(out of boundary)	<i>Livistona chinensis</i>	蒲葵	2
T34	(out of boundary)	<i>Roystonea regia</i>	王棕	6
T35	(out of boundary)	<i>Bombax ceiba</i>	木棉	1
T36	T17	<i>Ficus microcarpa</i>	細葉榕	4
T37	T18	<i>Terminalia mantaly</i>	細葉欖仁	2
T38	T19	<i>Ficus virens</i>	黃葛樹	1
T39	T20	<i>Terminalia mantaly</i>	細葉欖仁	4

Total No. of Trees: 108 (excluding 43 out of boundary)



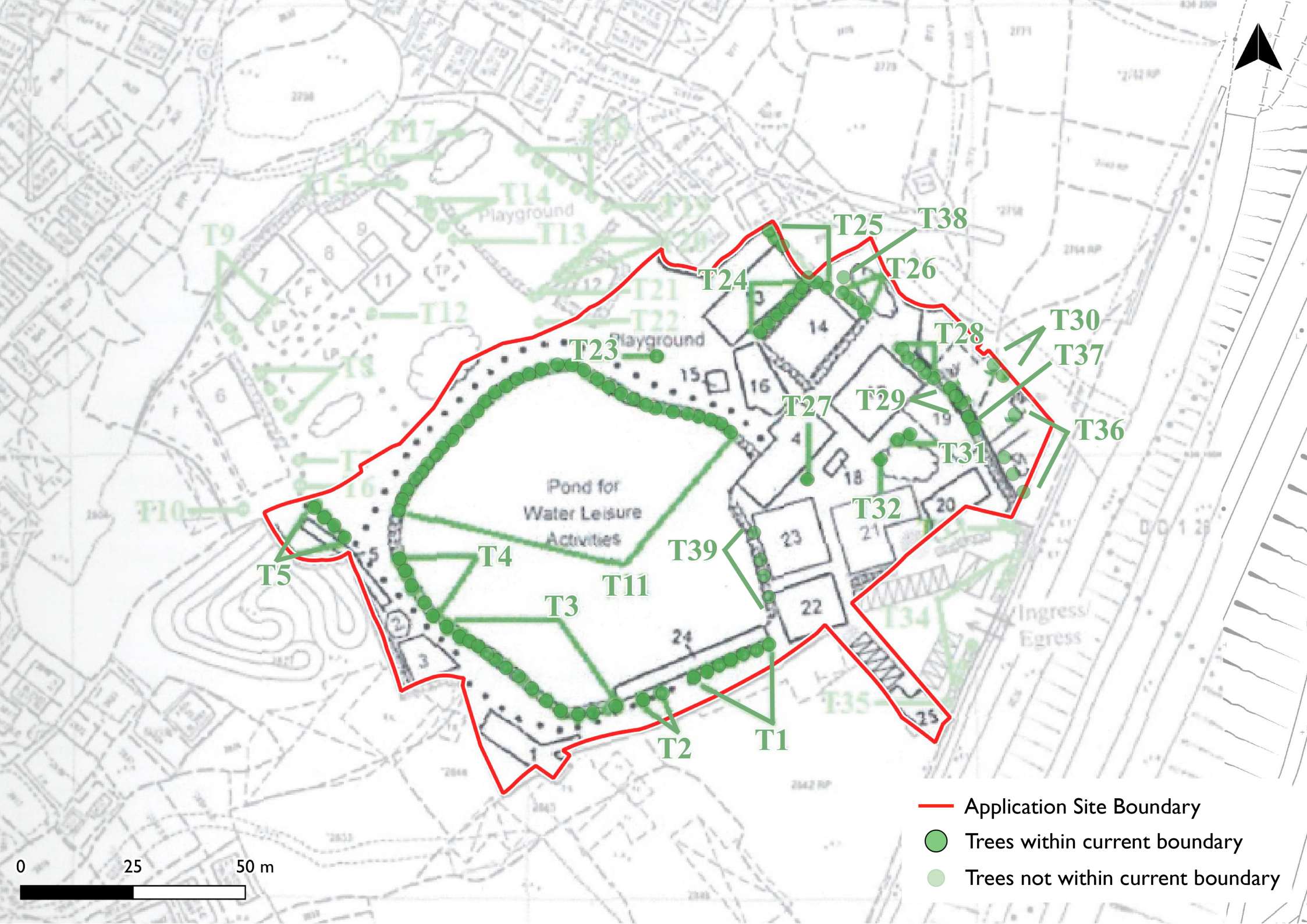



**Proposed Place of Recreation, Sports or Culture  
(Organic Farm, Barbecue Site, Education and Visitor Centre,  
Leisure Activity Area and Ancillary Facilities)  
for a temporary period of 5 Years in “GB” and “V” zones  
at Various Lots in DD129 and adjoining Government Land,  
Sha Kong Wai, Lau Fau Shan, New Territories**



**T1**



**T2**



**T3**

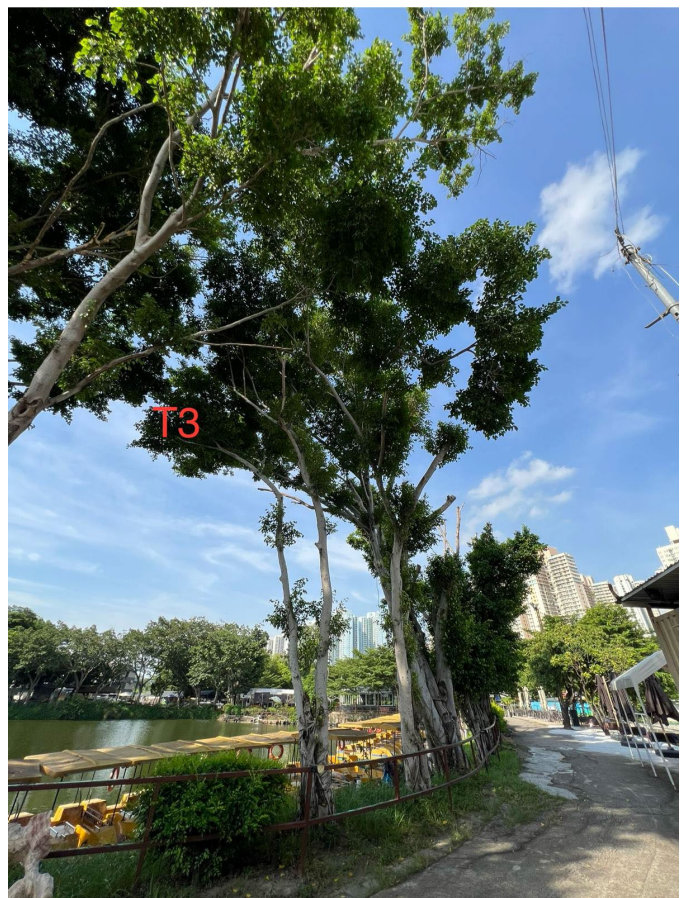

**T3**





T4



T4



T5



T5





T11



T11

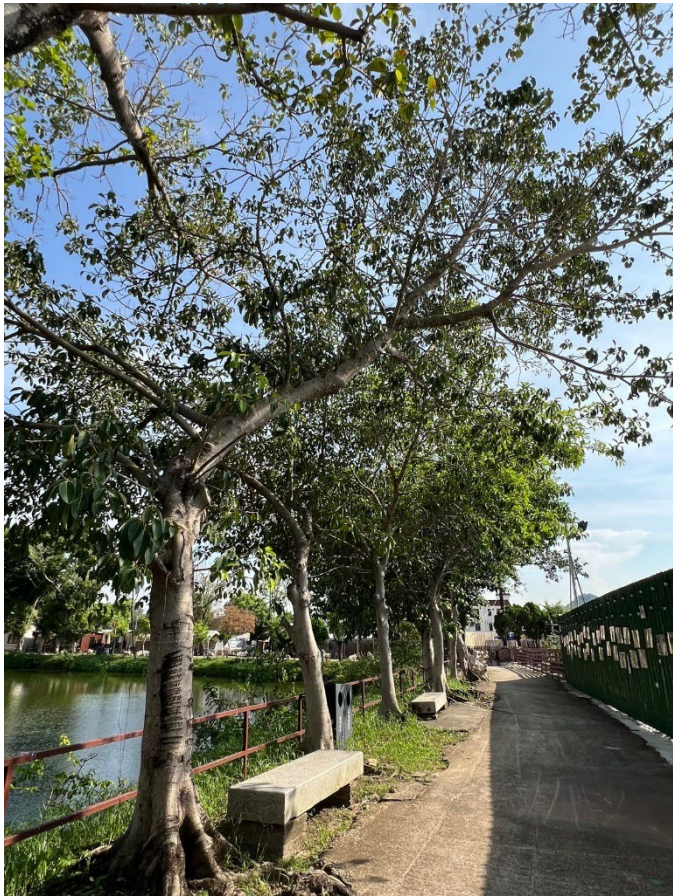

T11

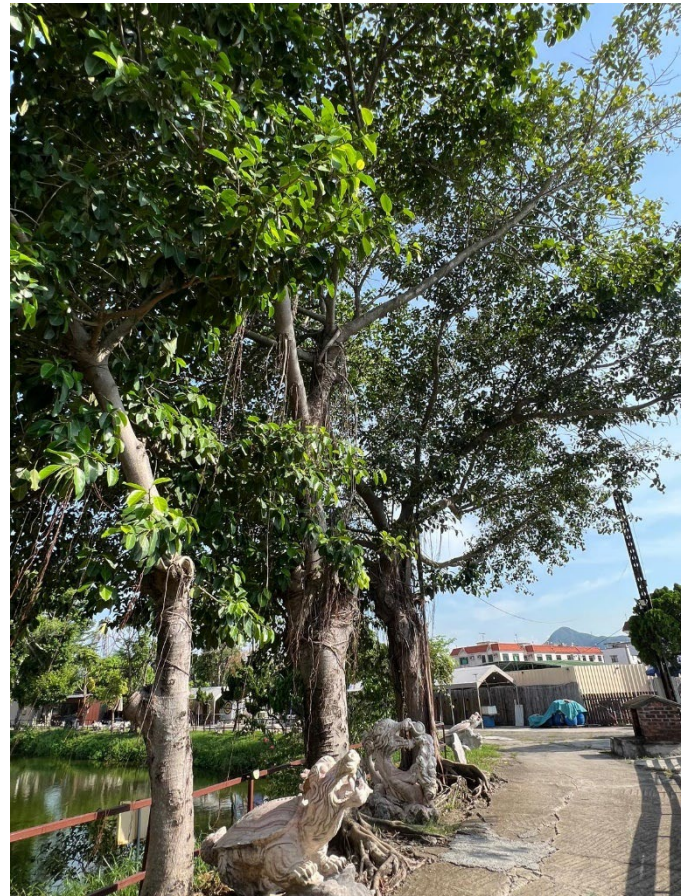

T11



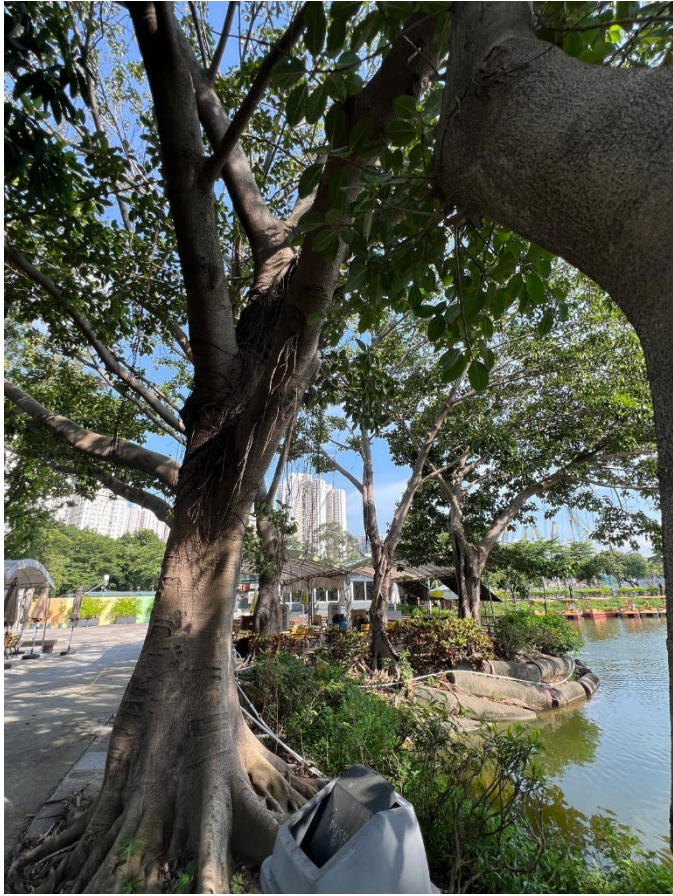

T11



T11



T23



T24





**T25**

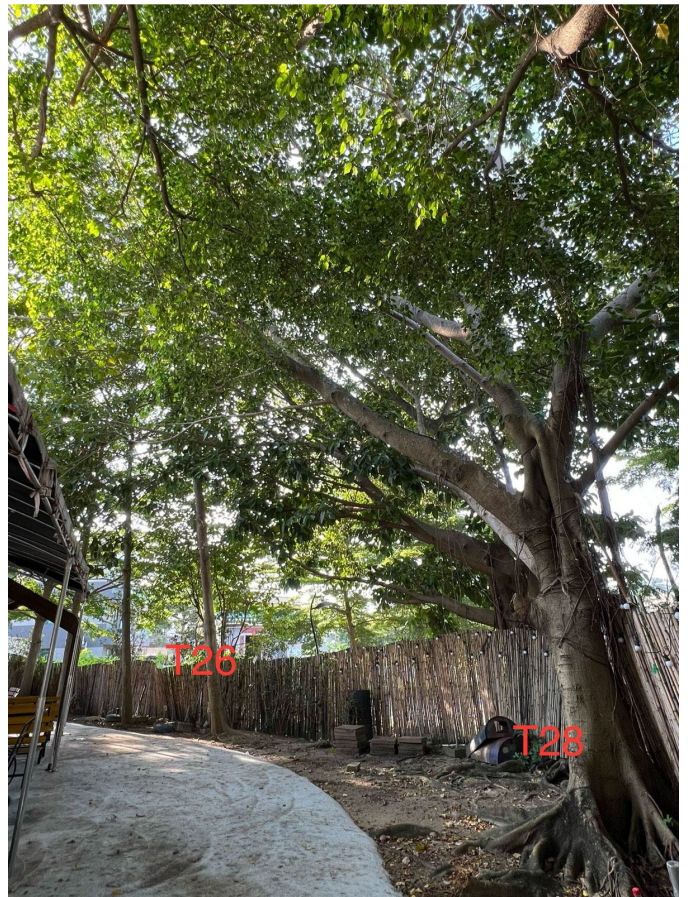

**T26 & T28**



**T27**



**T28**





T29 & T30

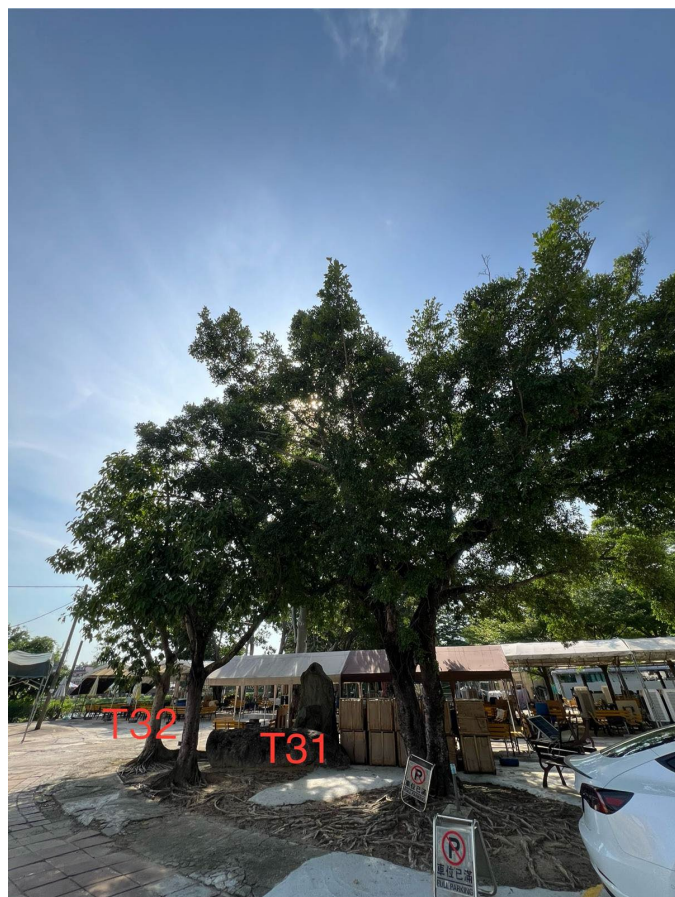

T31 & T32



T36



T36





**T37**



**T38**



**T39**



## ***Annex B***

---

### **Updated Layout Plan**

