

☐Urgent ☐Return receipt ☐Expand Group ☐Restricted ☐Prevent Copy ☐Confidential

**Christina Ki Na LEE/PLAND**

---

寄件者: king king [REDACTED]  
寄件日期: 2025年12月23日星期二 8:42  
收件者: tpbpd/PLAND; Christina Ki Na LEE/PLAND  
主旨: A/YL-LFS/577  
附件: LFS577-ltr-02.pdf  
  
類別: Internet Email

Dear Sir,

Please see attached GPRR for the consideration of the CEDD. Thank you.

Best Regards,

Patrick Tsui  
[REDACTED]

Total: 57 pages

Date: 23 December 2025

TPB Ref.: A/YL-LFS/577

By Email

Town Planning Board  
15/F, North Point Government Offices  
333, Java Road  
North Point  
Hong Kong  
(Attn: The Secretary)

Dear Sir,

**Proposed Temporary Open Storage of Construction Machinery & Construction Materials for a Period of 3 Years at Lots 1703 (Part) & 1704 (Part) in D.D. 129, Lau Fau Shan, Yuen Long, N.T.**

We are glad to submit the attached GPRR for the consideration of the CEDD.

Should you have any enquiries, please feel free to contact our Mr. Patrick Tsui at [REDACTED]  
[REDACTED] at your convenience.

Yours faithfully,

The block contains a handwritten signature in black ink, which appears to be 'Patrick Tsui'. To the right of the signature is a purple circular stamp. The stamp has the text 'URBAN PLANNING & DEVELOPMENT COMPANY LIMITED' around the perimeter. In the center, there is Chinese text: '都市規劃及發展顧問有限公司'.

Patrick Tsui

c.c. Tuen Mun and Yuen Long West District Planning Office (Attn: Ms. Christina LEE) – By Email

**GEOTECHNICAL PLANNING REVIEW REPORT (GPRR)**

**FOR**

**TEMPORARY OPEN STORAGE OF CONSTRUCTION  
MATERIALS FOR A PERIOD OF 3 YEARS**

**AT**

**LOT NO. 1703 (PART) & 1704 (PART) IN D.D. 129,  
LAU FAU SHAN, YUEN LONG, N.T.**

**Dec 2025**

## **CONTENTS**

|  |   |
|--|---|
| 1. INTRODUCTION .....  | 1 |
| 2. SITE DESCRIPTION.....   | 1 |
| 2.1 Existing Features in the Vicinity of the Site .....                    | 1 |
| 3. DESK STUDY.....   | 2 |
| 3.1 Site Geology.....  | 2 |
| 3.2 Past Ground Investigation and Relevant Geotechnical Record in GIU..... | 2 |
| 3.3 Groundwater .....  | 2 |
| 4. GEOTECHNICAL CONSIDERATIONS .....                                       | 3 |
| 4.1 Gradient across the Site .....   | 3 |
| 4.2 Existing Geotechnical Features.....                                    | 3 |
| 5. CONCLUSION .....  | 4 |

## **FIGURES**

Figure 1 Location Plan

Figure 2 Layout Plan

Figure 3 Existing Plan

Figure 4 Photo Plan

Figure 5 Sections

Figure 6 Hong Kong Geological Map Sheet No. 2

## **PLATES**

Photo V1 – General view of the site (western side)

Photo V2 – General view of the site (the north side)

Photo V3 – General view of Feature 2SW-C/C120

Photo V4 – General view of the site

Photo V5 – Landslide scar

Photo V6 – Landslide scar

Photo V7 – General view of the site

Photo V8 – General view of the site

Photo V9 – General view of the site

Photo V10 – General view of the site (the north side)

Photo V11 – General view of the Feature 2SW-C/C115

Photo V12 – General view of the Feature 2SW-C/C115

## **APPENDICES**

Appendix A SIS for Registered Features in the Vicinity of the Site

Appendix B SIMAR for Registered Features in the Vicinity of the Site

Appendix C Incident Record for Registered Features in the Vicinity of the Site



## 1. INTRODUCTION

It is proposed to apply the site to be the temporary open storage of construction materials for a period of 3 years at Lot Nos. 1703 (Part) and 1704 (Part) in D.D. 129, Lau Fau Shan, Yuen Long, N.T., under section 16 of the Town Planning Ordinance (Application No. A/YL-LFS/577). This report presents a Geotechnical Planning Review Report (GPRR) of the site to support the planning application.

## 2. SITE DESCRIPTION

The subject site is located at Lot Nos. 1703 (Part) and 1704 (Part) in D.D. 129. A site location plan and site layout plan are shown in Figure 1 and Figure 2, respectively. The site is about rectangular shape on plan and has an area of approximately 880m<sup>2</sup>, and the site is an open space.

### 2.1 Existing Features in the Vicinity of the Site

There are 3 registered features in the vicinity of the proposed development. The locations of the features are shown in Figure 3. Slope Information System (SIS) reports, and Slope Maintenance Responsibility Information System (SIMAR) reports indicating the location of the features and their maintenance responsibility are attached in Appendix A and B. A landslide occurred at around 13m near the site area.

Maintenance Responsibility of features in the vicinity of the proposed development:

| Feature No. | Sub-division No. | Maintenance Responsibility |
|-------------|------------------|----------------------------|
| 2SW-C/C 112 | 1                | D.D.129 Lot 1710           |
|             | 2                | D.D.129 Lot 1711           |
|             | 3                | D.D.129 Lot 1712           |
|             | 4                | Lands Department           |
|             | 5                | D.D.129 Lot 2279 S.B       |
|             | 6                | D.D.129 Lot 2280           |
|             | 7                | D.D.129 Lot 2285           |
|             | 8                | D.D.129 Lot 2296           |
|             | 9                | D.D.129 Lot 2284           |
| 2SW-C/C 115 | 1                | D.D.129 Lot 1710           |
|             | 2                | D.D.129 Lot 1711           |
|             | 3                | Lands Department           |
|             | 4                | D.D.129 Lot 1706           |
|             | 5                | D.D.129 Lot 1705 S.B       |
|             | 6                | D.D.129 Lot 1705 S.A       |
|             | 7                | D.D.129 Lot 1701           |
|             | 8                | D.D.129 Lot 1703           |
|             | 9                | D.D.129 Lot 1704           |
| 2SW-C/C 120 | 1                | D.D.129 Lot 1702           |

Description of the features is as follows:

*Feature No. 2SW-C/C112*

The feature is located at the north-west boundary of the site. It is a vegetated slope with a maximum height of 9 m, and the average slope angle is 54°. The feature length is 155 m. A 15 m long sheet pile wall on plan was found at the crest of Feature 2SW-C/C112 adjacent to the Application Site. Photos V2 and V10 show the location of the sheet pile.

*Feature No. 2SW-C/C115*

This is a U-shaped feature located at the eastern boundary of the site. It consists of a vegetated slope with a maximum height of 7 m and has a face angle of about 60°. This feature is about 160m long.

*Feature No. 2SW-C/C120*

The feature is located at the southern-west side boundary of the site. The feature is a slope with a maximum 3 m high and the slope angle is about 55°. The slope is dipping from west to east, and the length of the slope is about 55 m. During the site inspection carried out on 10 December 2025, 24 nos. of 1.0m x 1.0m x 1.0m concrete blocks have been placed along the northern part of the slope toe; the photo is shown in Photo V3.

### **3. DESK STUDY**

#### **3.1 Site Geology**

With reference to the 1:20,000 geological map published by the Geotechnical Control Office, Hong Kong Geological Survey Sheet No. 2, the site is located within the area of megacrystic fine-medium-grained granite (gfm), which is in line with the site observation. It is reasonably expected that the subsurface geology comprises a stratum of CDG. An extract from the geological survey sheet is shown in Figure 4.

Feature 2SW-C/C112 was studied under S2R069/2018 in 2018. The study recommended the installation of drainage only; no action was required for the portion closest to our site. Landslide incident was recorded in Ginfo on 13 August 2025 at sub-division 4 & 6 of the feature. The location of the landslide scars is marked in the existing plan in Figure 2.

#### **3.2 Past Ground Investigation and Relevant Geotechnical Record in GIU**

Based on the information search in the Geotechnical Information Unit (GIU) carried out on 19 December 2025 at the Civil Engineering & Development Department (CEDD), it revealed that there is no ground investigation and no relevant geotechnical record or report could be found in the vicinity of the site.

#### **3.3 Groundwater**

No piezometer or standpipe monitoring record could be found in the vicinity of the site.

## 4. GEOTECHNICAL CONSIDERATIONS

### 4.1 Gradient across the Site

The site is located on a level platform at around +21.5mPD with little level difference to be proposed as a temporary open storage area for the construction materials at Lau Fau Shan, Yuen Long.

### 4.2 Existing Geotechnical Features

Based on the GEO Technical Guidance Note No. 15 (TGN 15) - Guideline for Classification of Consequence-to-Life Category for Slope Features, the slope stability would not affect the proposed development when the facilities are not located within the crest and toe influence zone. The estimated crest influence zone of the feature is 0.4 times the slope height. And for the toe influence zone, the estimation is referred to Figure 1 of TGN 15, and the travel angle for the travel distance of landslide debris is estimated from paragraph 5.2.2 of TGN 15. The area of influence zone would be shown in the Existing Plan in Figure 2.

#### *Feature No. 2SW-C/C112*

The feature is located at the northwestern side outside the site, the application site is located at the crest of this feature, and no works will be carried out within the crest influence zone of the feature. Although a landslip occurred on 13 August 2025, the location of the landslip is at a sufficient distance from the site location. No other signs of distress or instability were found at the portion adjacent to the site during site reconnaissance; it was concluded that the proposed development is geotechnical feasible provided that the boundary of the application site adjacent to the feature is set back 4m to avoid the crest influence zone.

The feature's maximum height is 9.0m, and the crest influence zone of the feature is estimated as 3.6m away from the slope crest.

#### *Feature No. 2SW-C/C115*

This is a U-shaped feature which located adjacent to the eastern boundary of the site. Since the proposed development is a temporary open storage area for construction materials without any structure or building constructed on site, and no foundation works, site formation works, building works, or excavation works will be carried out. Hence, the proposed development is considered to be feasible from a geotechnical point of view.

The cut slope height of the feature is 7.0m. According to Paragraph 5.3.1 in TGN 15, the estimated crest influence zone is not larger than 0.4 times the slope height. It is therefore, the crest influence zone is about 3.0m away from the existing slope crest.

*Feature No. 2SW-C/C120*

The feature could not be found at the location marked on the plan. However, a retaining wall can be found at around 6m west of the supposed location of the feature. This retaining wall is composed of a maximum of 2 mass concrete blocks and is around 2.5m high. The estimated toe influence zone of said structure is estimated at around 1m and will not cause a stability threat to the application site.

## **5. CONCLUSION**

This report has discussed all the issues concerning the geotechnical planning review under Town Planning Ordinance Section 16 for the captioned project. Since no foundation works, site formation works, building works, or excavation works would be involved in this application, therefore, the stability of existing features would not be affected. In conclusion, the proposed development is considered geotechnical feasible.

## FIGURES

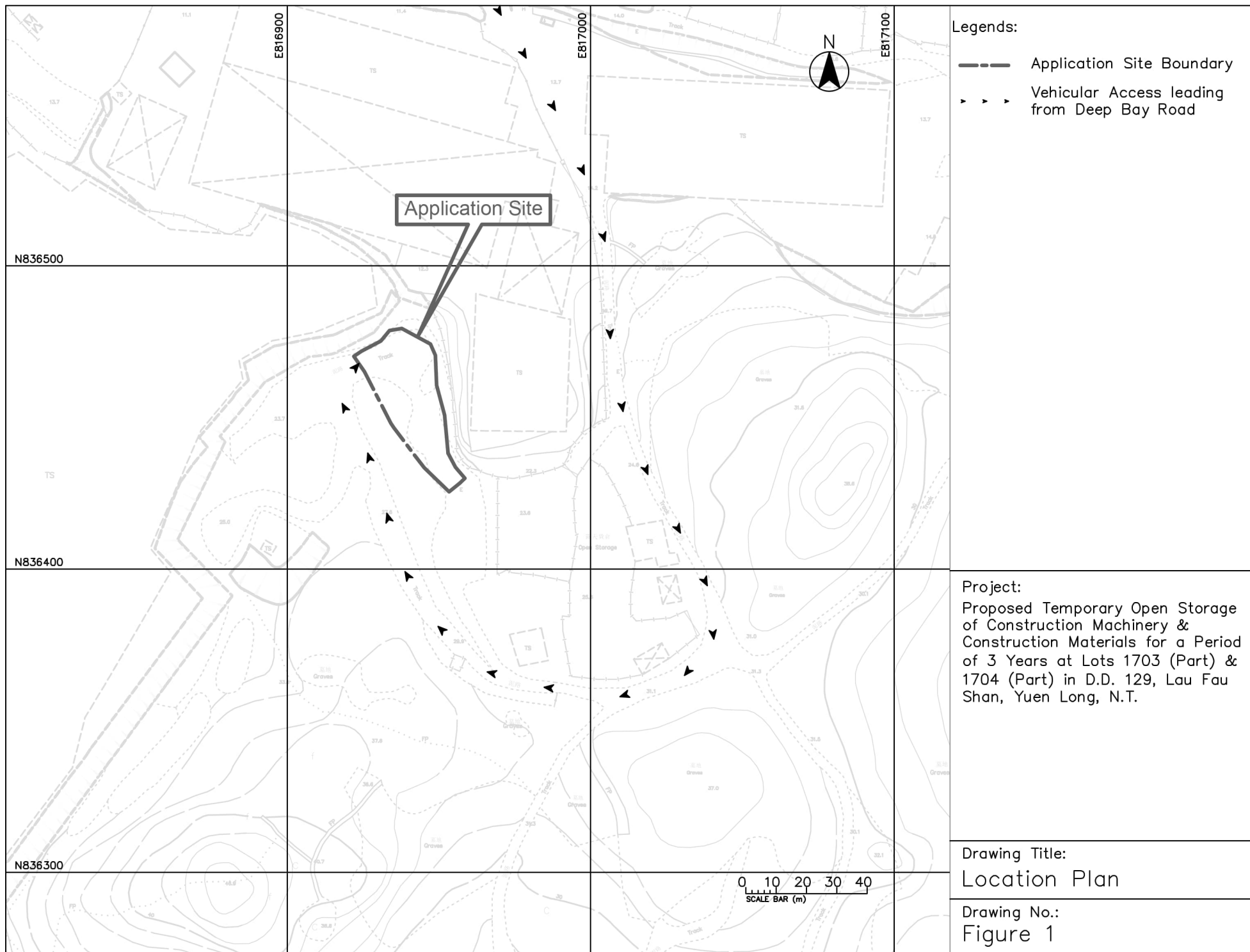

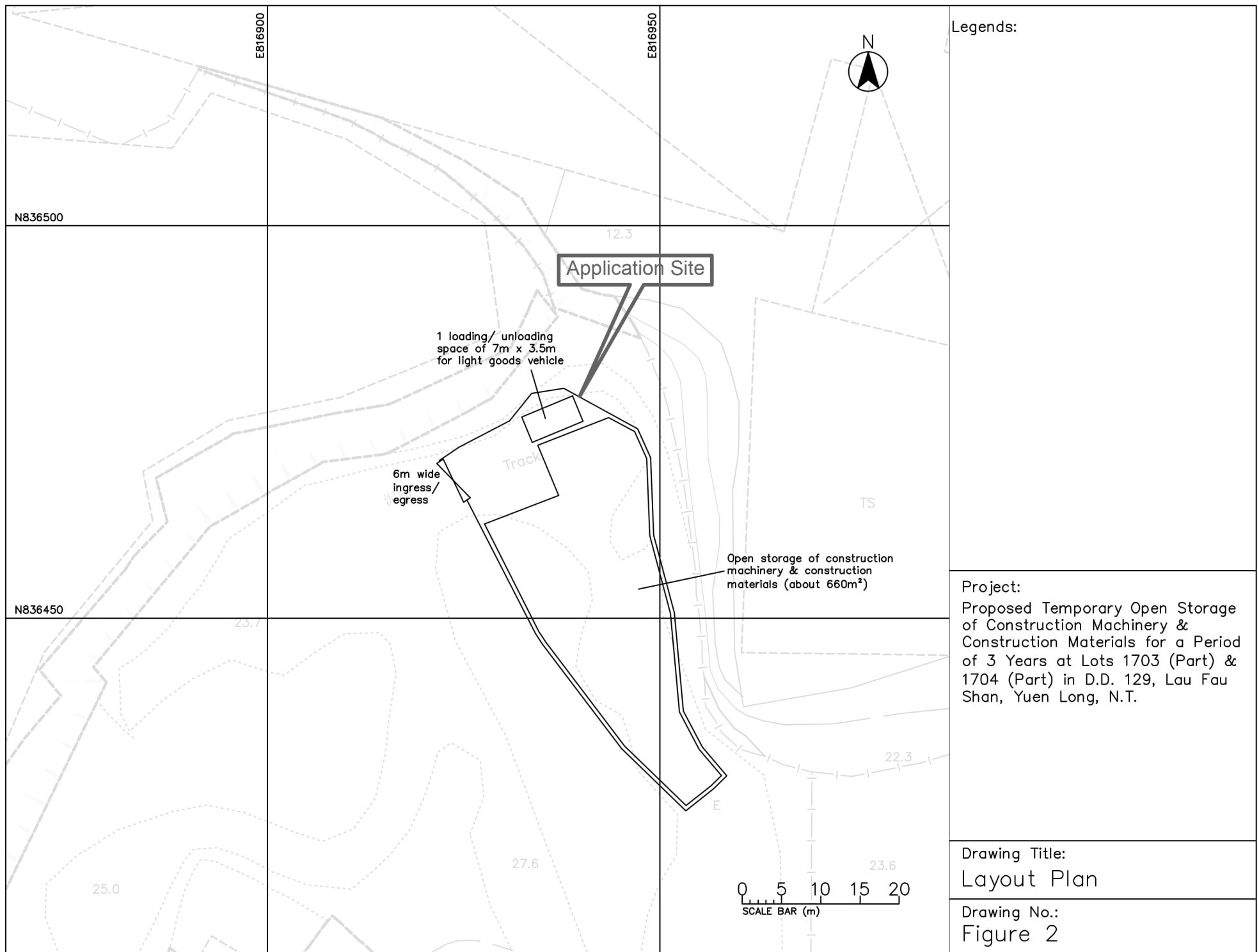

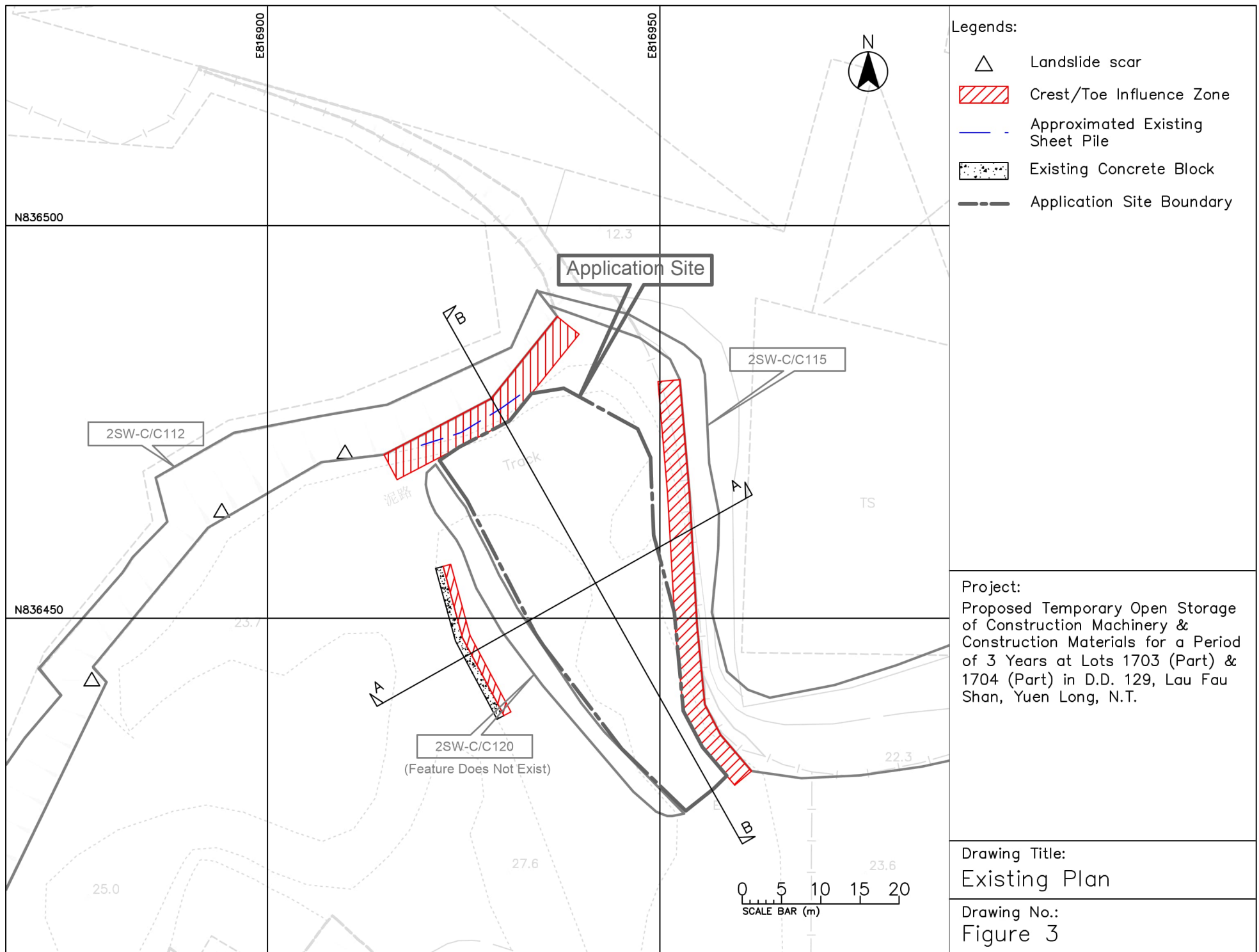



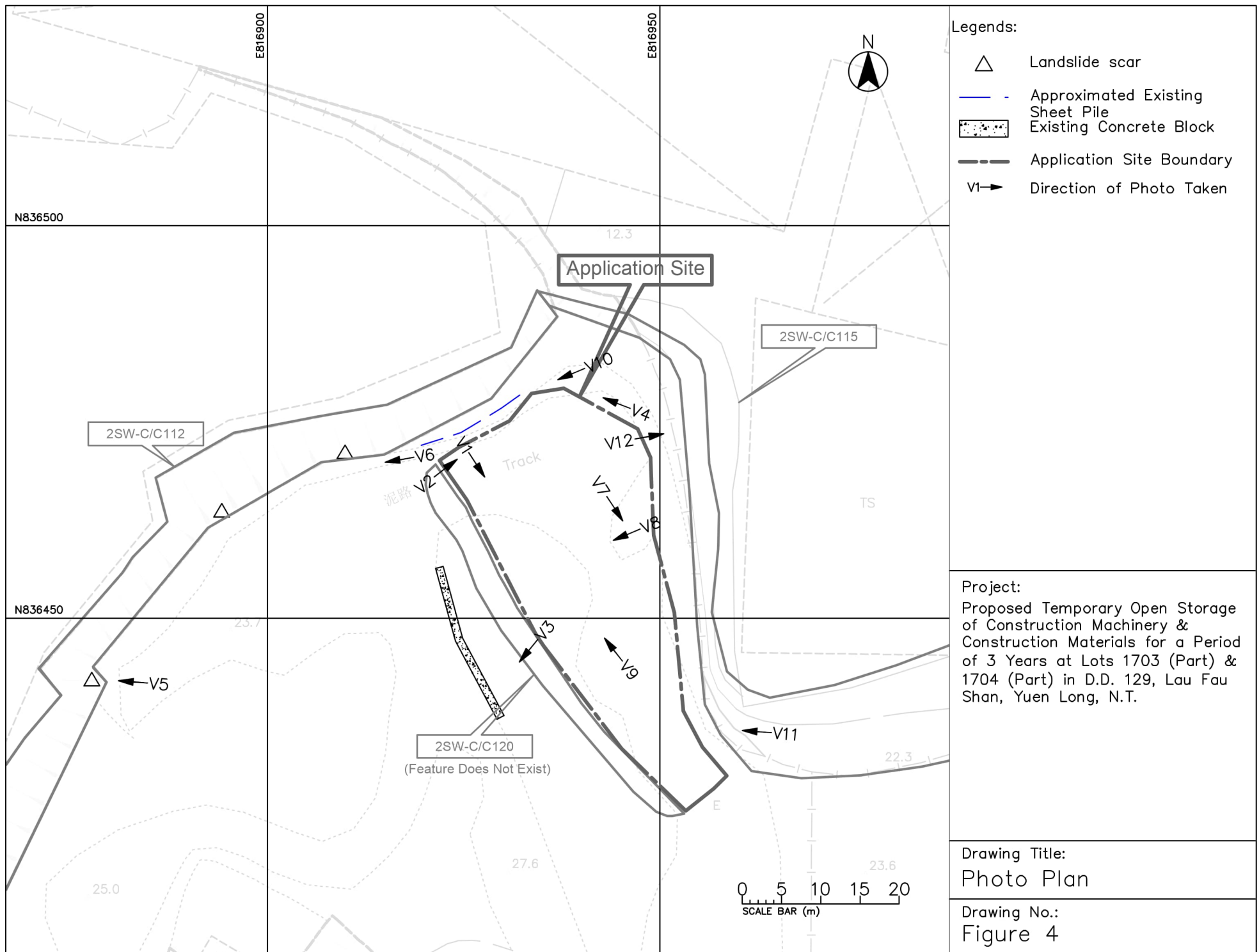

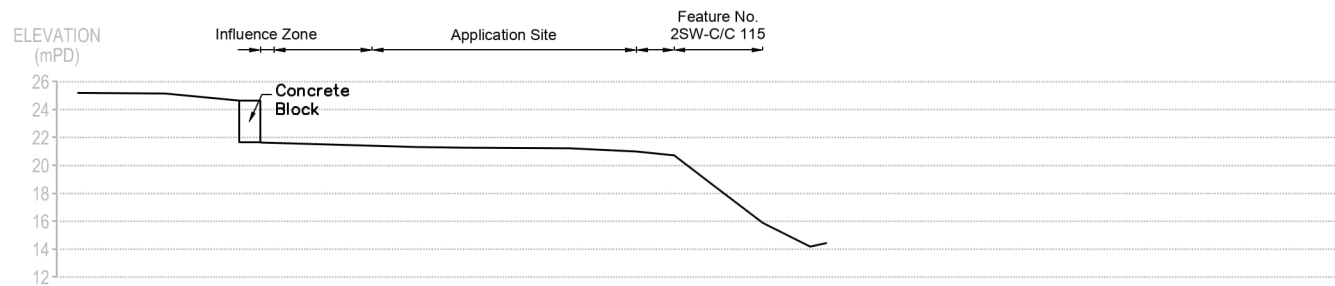

Section A-A

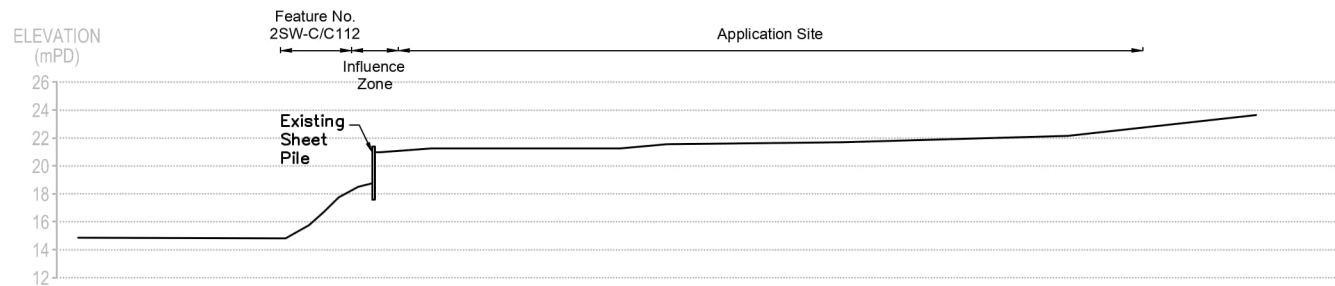

Section B-B

Legends:

Project:

Proposed Temporary Open Storage of Construction Machinery & Construction Materials for a Period of 3 Years at Lots 1703 (Part) & 1704 (Part) in D.D. 129, Lau Fau Shan, Yuen Long, N.T.

Drawing Title:

Sections

Drawing No.:

Figure 5

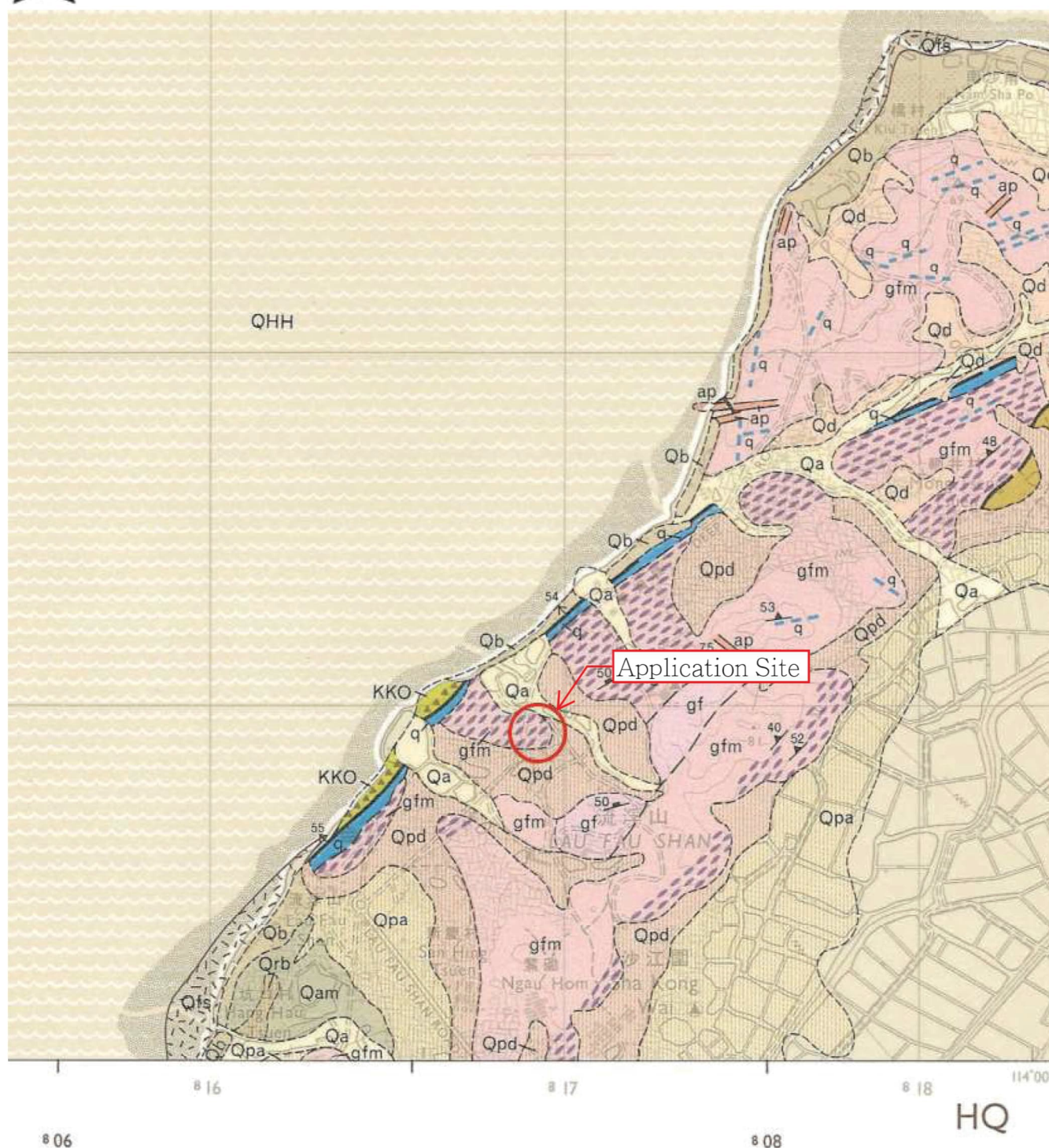

Project 項目名稱:

Proposed Temporary Open Storage of Construction Machinery & Construction Materials for a Period of 3 Years at Lots 1703 (Part) & 1704 (Part) in D.D. 129, Lau Fau Shan, Yuen Long, N.T.

Drawing Title 圖目:

Hong Kong Geological Map Sheet No. 2

Remarks 備註:

Drawing No. 圖號:

Figure 4

Scale 比例:

1:20000

## PLATES



Location: LOT NO. 1703 (Part) & 1704 (Part) IN D.D. 129, LAU FAU SHAN, YUEN LONG, N.T.

RECORD PHOTOGRAPHS



Photo V1 - General view of the site (western side)



Photo V2 - General view of the site (the north side)



**Location: LOT NO. 1703 (Part) & 1704 (Part) IN D.D. 129, LAU FAU SHAN, YUEN LONG, N.T.**

**RECORD PHOTOGRAPHS**



Photo V3 - General view of Feature 2SW-C/C120



Photo V4 - General view of the site



RECORD PHOTOGRAPHS



Photo V5 - Landslide scar



Photo V6 - Landslide scar



RECORD PHOTOGRAPHS



Photo V7 - General view of the site



Photo V8 - General view of the site



RECORD PHOTOGRAPHS



Photo V9 - General view of the site



Photo V10 - General view of the site (the north side)



RECORD PHOTOGRAPHS



Photo V11 - General view of the Feature 2SW-C/C115



Photo V12 - General view of the Feature 2SW-C/C115

## **APPENDIX A**

### **SIS FOR REGISTERED FEATURES IN THE VICINITY OF THE SITE**

## BASIC INFORMATION

Location: PERIMETER OF OPEN STORAGE AREA(CONTAINER), NEAR SAN HING TSUEN, LAU FAU SHAN, YUEN LONG  
Registration Date: 06-05-1998  
Ranking Score (NPRS): 1102 (LPMit)  
Date of Formation: post-1977  
Date of Construction/ Modification:  
Data Source: SIRST  
Approximate Coordinates: Easting : 816882 Northing : 836453

## CONSEQUENCE-TO-LIFE CATEGORY

Facility at Crest: Undeveloped green belt  
Distance of Facility from Crest (m): 0  
Facility at Toe: Other thinly populated buildings  
Distance of Facility from Toe (m): 1  
Consequence-to-life Category: 1  
Remarks: N/A

## SLOPE PART

(1) Max. Height (m): 9 Length (m): 155 Average Angle (deg): 54

## WALL PART

N/A

## MAINTENANCE RESPONSIBILITY

|                 |               |                           |                |                   |                 |                                 |
|-----------------|---------------|---------------------------|----------------|-------------------|-----------------|---------------------------------|
| (1) Sub Div.: 1 | Mixed Feature | Party: DD129 LOT 1710     | Agent: N/A     | Land Cat.: 1      | Reason Code: 1  | MR Endorsement Date: 29-08-2025 |
| (2) Sub Div.: 2 | Mixed Feature | Party: DD129 LOT 1711     | Agent: N/A     | Land Cat.: 1      | Reason Code: 1  | MR Endorsement Date: 29-08-2025 |
| (3) Sub Div.: 3 | Mixed Feature | Party: DD129 LOT 1712     | Agent: N/A     | Land Cat.: 1      | Reason Code: 1  | MR Endorsement Date: 29-08-2025 |
| (4) Sub Div.: 4 | Mixed Feature | Party: Lands D            | Agent: Lands D | Land Cat.: 5b(vi) | Reason Code: 62 | MR Endorsement Date: 29-08-2025 |
| (5) Sub Div.: 5 | Mixed Feature | Party: DD129 LOT 2279 S.B | Agent: N/A     | Land Cat.: 1      | Reason Code: 1  | MR Endorsement Date: 29-08-2025 |
| (6) Sub Div.: 6 | Mixed Feature | Party: DD129 LOT 2280     | Agent: N/A     | Land Cat.: 1      | Reason Code: 1  | MR Endorsement Date: 29-08-2025 |
| (7) Sub Div.: 7 | Mixed Feature | Party: DD129 LOT 2285     | Agent: N/A     | Land Cat.: 1      | Reason Code: 1  | MR Endorsement Date: 29-08-2025 |
| (8) Sub Div.: 8 | Mixed Feature | Party: DD129 LOT 2296     | Agent: N/A     | Land Cat.: 1      | Reason Code: 1  | MR Endorsement Date: 29-08-2025 |
| (9) Sub Div.: 9 | Mixed Feature | Party: DD129 LOT 2284     | Agent: N/A     | Land Cat.: 1      | Reason Code: 1  | MR Endorsement Date: 29-08-2025 |

## DETAILS OF SLOPE / RETAINING WALL

Date of Inspection: 26-02-1998  
Data Source: SIRST  
Slope Part Drainage: N/A  
Wall Part Drainage: N/A

## SLOPE PART

### Slope Part (1)

Surface Protection (%): Bare: 70 Vegetated: 30 Chunam: 0 Shotcrete: 0 Other Cover: 0  
Material Description: Material type: Soil Geology: Decomposed granite  
Berm: No. of Berms: N/A Min. Berm Width (m): N/A  
Weepholes: Size (mm): N/A Spacing (m): N/A

## WALL PART

N/A

## SERVICES

N/A

## CHECKING STATUS INFORMATION

N/A

## BACKGROUND INFORMATION

GIU Cell Ref.: 2SW22C2  
Map Sheet Reference (1:1000): 2SW-22C  
Aerial Photos: A 24264 (1990), A24265 (1990)  
Nearest Rainguage Station (Station Number): Hong Shui House, Shui Pin Wai Estate(N12)  
Data Collected On: 26-02-1998  
Date of Construction, Subsequent Modification and Demolition: Modification: Constructed Before: 1990 After: 1988  
Related Reports/Files or Documents: N/A  
Remarks: N/A  
Follow Up Actions: N/A  
DH-Order (To Be Confirmed with Buildings Department): None  
Advisory Letter (To Be Confirmed with Buildings Department): Date of Recommendation to BD: N/A File Reference: N/A  
Date Served by BD: 29/11/2019  
Date of Recommendation to BD: N/A File Reference: N/A  
Date Served by BD: 29/11/2019  
LPMIS: Agreement No.: CE50/2017 Report No.: S2R069/2018

## ENHANCED MAINTENANCE INFORMATION

From Maintenance Department: (Last Updated Date: 21/11/2025)

### STAGE 1 STUDY REPORT

Inspected On:

Weather:

District: MW

Section No: 1-1

Height(m):

Type of Toe Facility: Other thinly populated buildings

Distance from Toe(m): 1

Type of Crest Facility: Undeveloped green belt

Distance from Crest(m): 0

Consequence Category:

Engineering Judgement:

Section No: 2-2

Type of Toe Facility:

Distance from Toe(m):

Type of Crest Facility:

Distance from Crest(m):

Consequence Category:

Engineering Judgement:

Sign of Seepage:

Criterion A satisfied:

Sign of Distress:

Criterion D satisfied:

Non-routine maintenance required:

Note:

Masonry wall/Masonry facing:

Note:

Consequence category (for critical section):

Observations: N/A

Emergency Action Required:

Action By: N/A

### ACTION TO INITIATE PREVENTIVE WORKS

Criterion A/Criterion D: N/A

Action By: N/A



Further Study:

Action By: N/A

## OTHER EXTERNAL ACTION

Check / repair Services:

Action By: N/A

Non-routine Maintenance:

Action By: N/A

## eLPMIS

### LPM/LPMit Details Report

|  |   |
|--|---|
| LPM Study Feature No.:                                   | 2SW-C/C 112   |
| Location:  | PERIMETER OF OPEN STORAGE AREA(CONTAINER), NEAR SAN HING TSUEN, LAU FAU SHAN, YUEN LONG                             |
| District Council:  | Yuen Long   |
| Maintenance Responsibility (At the Time of Selection):   | Private   |
| Responsible Party for Maintenance of Government Portion: | N/A   |
| Private Lot No.:   | DD129 Lot1710,DD129 Lot1711,DD129 Lot1712,DD129 Lot2279B,DD129 Lot2280,DD129 Lot2285,DD129 Lot2296,DD129 Lot2812DRP |

### LPM/LPMit Study

|  |   |
|--|---|
| Agreement No.:                             | CE50/2017   |
| Study Type:                                | Stage 2 Study   |
| Consultant:                                | C M Wong & Associates Ltd.                                    |
| GEO Managing Section / Engineer:           | SS / SS2  |
| Study Status:                              | Study completed   |
| Design Approach:                           | N/A   |
| Option Assessment Accepted:                | N   |
| Study Report No.:                          | S2R069/2018   |
| Programme / Actual Commencement:           | 07-09-2018  |
| Programme / Actual Completion:             | 29-11-2019  |
| Report Recommendation (For Stage 2 Study): | Advisory Letter,No action required                            |
| District Check Status:                     | N/A   |
| Checking Certificate No.:                  | N/A   |
| GEO Engineer's Remarks:                    | Advisory Letters for sub-division 6 & 7 issued on 29/11/2019. |

### LPM/LPMit Works

|                                  |           |
|----------------------------------|-----------|
| Works Contract No.:              | N/A       |
| GEO Managing Section / Engineer: | N/A / N/A |
| Contractor:                      | N/A       |
| Progress Status:                 | N/A       |

|  |     |
|--|-----|
| Reason of Study Termination / Works Deletion (If Necessary): | N/A |
| Forecast Commencement Date:                                  | N/A |
| Forecast Completion Date:                                    | N/A |
| Completion Cert. Issued:                                     | N/A |
| Site Handed Over to Maintenance Department on:               | N/A |
| Estimated Cost for Upgrading (HK\$M):                        | N/A |
| Maintenance Manual No.:                                      | N/A |
| Actual Works:  | N/A |
| No. of Tree Felled:  | N/A |
| No. of Tree Planted (Incl. Transplant):                      | N/A |
| % Bare of Slope Surfacing:                                   | N/A |
| % Vegetated of Slope Surfacing:                              | N/A |
| % Shotcrete of Slope Surfacing:                              | N/A |
| Other Hard Surface of Slope Surfacing:                       | N/A |



PHOTO





## BASIC INFORMATION

Location: Behind stone cutting storage yard, near Lau Fau Shan  
Registration Date: 06-05-1998  
Ranking Score (NPRS): 0 (EI)  
Date of Formation: pre-1977  
Date of Construction/ Modification:  
Data Source: EI  
Approximate Coordinates: Easting : 816984 Northing : 836438

## CONSEQUENCE-TO-LIFE CATEGORY

Facility at Crest: Road/footpath with low traffic density  
Distance of Facility from Crest (m): 0  
Facility at Toe: Non-dangerous goods storage site  
Distance of Facility from Toe (m): 0  
Consequence-to-life Category: 3  
Remarks: N/A

## SLOPE PART

(1) Max. Height (m): 7 Length (m): 160 Average Angle (deg): 60

## WALL PART

N/A

## MAINTENANCE RESPONSIBILITY

|                 |               |                           |                |                   |                    |                                 |
|-----------------|---------------|---------------------------|----------------|-------------------|--------------------|---------------------------------|
| (1) Sub Div.: 1 | Mixed Feature | Party: DD129 LOT 1710     | Agent: N/A     | Land Cat.: 1      | Reason Code: 1     | MR Endorsement Date: 27-09-2021 |
| (2) Sub Div.: 2 | Mixed Feature | Party: DD129 LOT 1711     | Agent: N/A     | Land Cat.: 1      | Reason Code: 1     | MR Endorsement Date: 27-09-2021 |
| (3) Sub Div.: 3 | Mixed Feature | Party: Lands D            | Agent: Lands D | Land Cat.: 5b(vi) | Reason Code: 59,62 | MR Endorsement Date: 27-09-2021 |
| (4) Sub Div.: 4 | Mixed Feature | Party: DD129 LOT 1706     | Agent: N/A     | Land Cat.: 1      | Reason Code: 1     | MR Endorsement Date: 27-09-2021 |
| (5) Sub Div.: 5 | Mixed Feature | Party: DD129 LOT 1705 S.B | Agent: N/A     | Land Cat.: 1      | Reason Code: 1     | MR Endorsement Date: 27-09-2021 |
| (6) Sub Div.: 6 | Mixed Feature | Party: DD129 LOT 1705 S.A | Agent: N/A     | Land Cat.: 1      | Reason Code: 1     | MR Endorsement Date: 27-09-2021 |
| (7) Sub Div.: 7 | Mixed Feature | Party: DD129 LOT 1701     | Agent: N/A     | Land Cat.: 1      | Reason Code: 1     | MR Endorsement Date: 27-09-2021 |
| (8) Sub Div.: 8 | Mixed Feature | Party: DD129 LOT 1703     | Agent: N/A     | Land Cat.: 1      | Reason Code: 1     | MR Endorsement Date: 27-09-2021 |
| (9) Sub Div.: 9 | Mixed Feature | Party: DD129 LOT 1704     | Agent: N/A     | Land Cat.: 1      | Reason Code: 1     | MR Endorsement Date: 27-09-2021 |

## DETAILS OF SLOPE / RETAINING WALL

Date of Inspection: 07-11-2001  
Data Source: EI  
Slope Part Drainage: N/A  
Wall Part Drainage: N/A

## SLOPE PART

### Slope Part (1)

Surface Protection (%): Bare: 0 Vegetated: 100 Chunam: 0 Shotcrete: 0 Other Cover: 0  
Material Description: Material type: Soil Geology: Decomposed granite  
Berm: No. of Berms: N/A Min. Berm Width (m): N/A  
Weepholes: Size (mm): N/A Spacing (m): N/A

## WALL PART

N/A

## SERVICES

N/A

## CHECKING STATUS INFORMATION

N/A

## BACKGROUND INFORMATION

GIU Cell Ref.: 2SW22C2  
Map Sheet Reference (1:1000): 2SW-22C  
Aerial Photos: 9874 (1974), 9875 (1974)  
Nearest Rainwater Station (Station Number): Hong Shui House, Shui Pin Wai Estate(N12)  
Data Collected On: 07-11-2001  
Date of Construction, Subsequent Modification and Demolition: Modification: Constructed Before: 1973 After: 1963  
Related Reports/Files or Documents: N/A  
Remarks: N/A  
Follow Up Actions: N/A  
DH-Order (To Be Confirmed with Buildings Department): None  
Advisory Letter (To Be Confirmed with Buildings Department): None  
LPMIS: None

## ENHANCED MAINTENANCE INFORMATION

From Maintenance Department: (Last Updated Date: 21/11/2025)

### STAGE 1 STUDY REPORT

Inspected On: 26-02-1998

Weather: Some Rain

District: MW

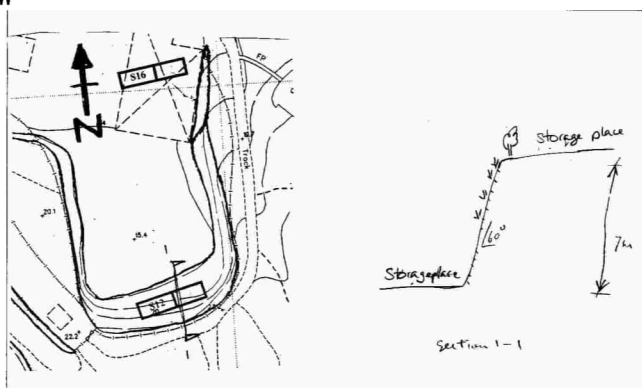

|                                   |   |
|-----------------------------------|---|
| Section No:                       | 1-1                                       |
| Height(m):                        | H1 : 7 , H2 : 0                           |
| Type of Toe Facility:             | Non-dangerous goods storage site          |
| Distance from Toe(m):             | 0   |
| Type of Crest Facility:           | Road/footpath with low traffic density    |
| Distance from Crest(m):           | 0   |
| Consequence Category:             | 3   |
| Engineering Judgement:            | P   |
| Section No:                       | 2-2                                       |
| Type of Toe Facility:             | N/A                                       |
| Distance from Toe(m):             | 0   |
| Type of Crest Facility:           | N/A                                       |
| Distance from Crest(m):           | 0   |
| Consequence Category:             | 3   |
| Engineering Judgement:            | P   |
| Sign of Seepage:                  | Slope : No signs of seepage<br>Wall : N/A |
| Criterion A satisfied:            | N   |
| Sign of Distress:                 | Slope : N/A<br>Wall : N/A                 |
| Criterion D satisfied:            | N   |
| Non-routine maintenance required: | N   |
| Note:                             | N/A                                       |
| Masonry wall/Masonry facing:      | N   |
| Note:                             | N/A                                       |





Consequence category (for critical section): 3  
Observations: N/A  
Emergency Action Required: N  
Action By: N/A

### ACTION TO INITIATE PREVENTIVE WORKS

Criterion A/Criterion D: N/A  
Action By: N/A  
Further Study: Y  
Action By: Mixed

### OTHER EXTERNAL ACTION

Check / repair Services: N  
Action By: N/A  
Non-routine Maintenance: N  
Action By: N/A

**PHOTO**



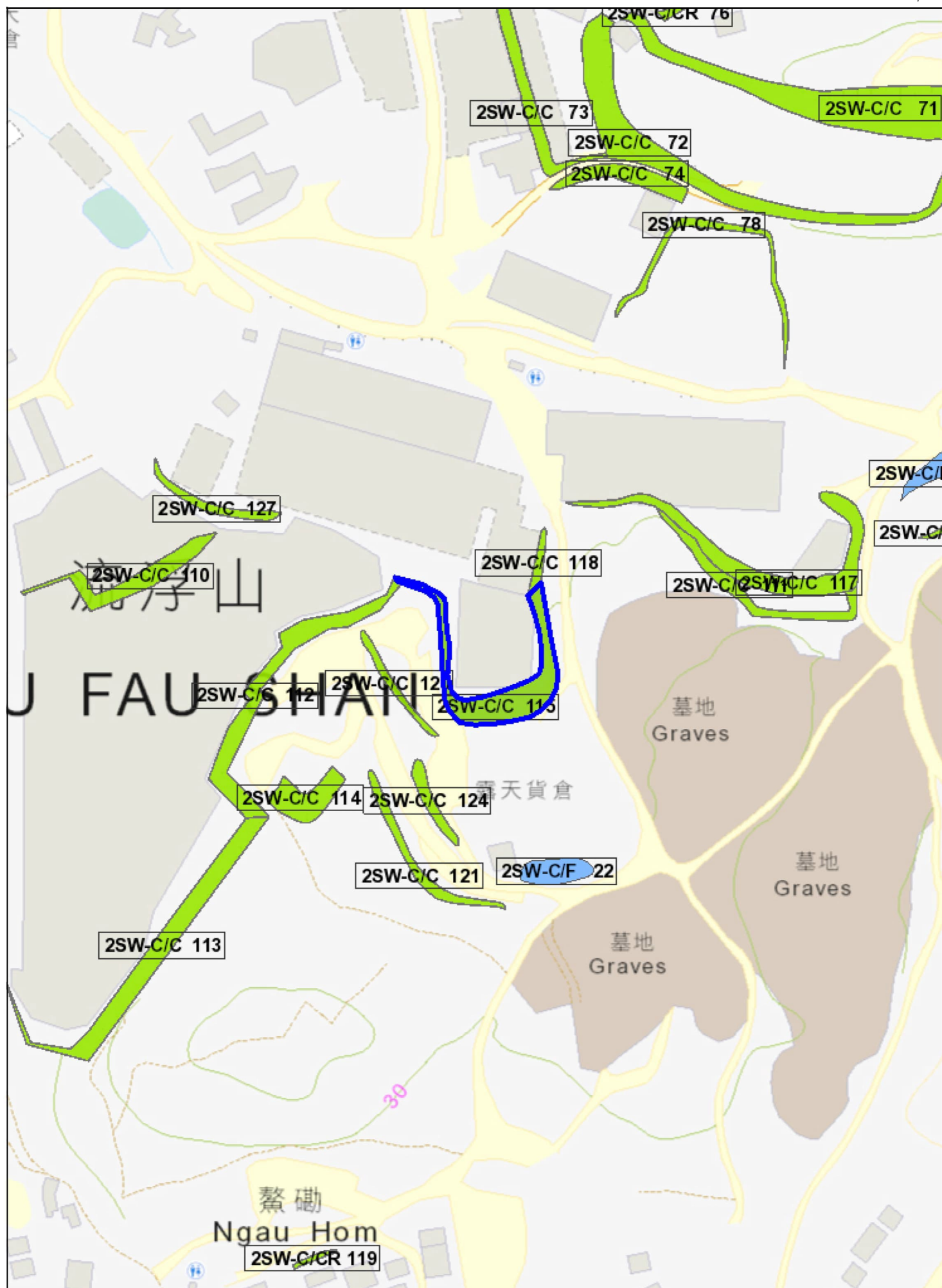



## BASIC INFORMATION

Location: 250M NORTH OF NGAU HOM, LAU FAU SHAN, YUEN LONG  
Registration Date: 06-05-1998  
Ranking Score (NPRS): 0 (Notional)  
Date of Formation: post-1977  
Date of Construction/ Modification:  
Data Source: SIRST  
Approximate Coordinates: Easting : 816933    Northing : 836446

## CONSEQUENCE-TO-LIFE CATEGORY

Facility at Crest: Undeveloped green belt  
Distance of Facility from Crest (m): 0  
Facility at Toe: Non-dangerous goods storage site  
Distance of Facility from Toe (m): 1  
Consequence-to-life Category: 3  
Remarks: N/A

## SLOPE PART

(1)    Max. Height (m): 3    Length (m): 55    Average Angle (deg): 55

## WALL PART

N/A

## MAINTENANCE RESPONSIBILITY

(1) Sub Div.: 0    Private Feature    Party: DD129 Lot1702    Agent: N/A    Land Cat.: 1    Reason Code: 1    MR Endorsement Date: 01-09-1998

## DETAILS OF SLOPE / RETAINING WALL

Date of Inspection: 26-02-1998  
Data Source: SIRST  
Slope Part Drainage: N/A  
Wall Part Drainage: N/A

## SLOPE PART

Slope Part (1)  
Surface Protection (%): Bare: 0    Vegetated: 100    Chunam: 0    Shotcrete: 0    Other Cover: 0  
Material Description: Material type: Soil    Geology: Decomposed granite  
Berm: No. of Berms: N/A    Min. Berm Width (m): N/A  
Weepholes: Size (mm): N/A    Spacing (m): N/A

## WALL PART

N/A

## SERVICES

N/A

## CHECKING STATUS INFORMATION

N/A

## BACKGROUND INFORMATION

|   |  |
|---|--|
| GIU Cell Ref.:  | 2SW22C2  |
| Map Sheet Reference (1:1000):                                 | 2SW-22C  |
| Aerial Photos:  | 55758 (1984), 55759 (1984)                               |
| Nearest Rainguage Station (Station Number):                   | Hong Shui House, Shui Pin Wai Estate(N12)                |
| Data Collected On:  | 26-02-1998   |
| Date of Construction, Subsequent Modification and Demolition: | Modification: Constructed    Before: 1984    After: 1981 |
| Related Reports/Files or Documents:                           | N/A  |
| Remarks:  | N/A  |
| Follow Up Actions:  | N/A  |
| DH-Order (To Be Confirmed with Buildings Department):         | None   |
| Advisory Letter (To Be Confirmed with Buildings Department):  | None   |
| LPMIS:  | None   |

## ENHANCED MAINTENANCE INFORMATION

From Maintenance Department: (Last Updated Date: 21/11/2025)

## STAGE 1 STUDY REPORT

Inspected On:

Weather:

District: MW

Section No: 1-1

Height(m):

Type of Toe Facility: Non-dangerous goods storage site

Distance from Toe(m): 1

Type of Crest Facility: Undeveloped green belt

Distance from Crest(m): 0

Consequence Category:

Engineering Judgement:

Section No: 2-2

Type of Toe Facility:

Distance from Toe(m):

Type of Crest Facility:

Distance from Crest(m):

Consequence Category:

Engineering Judgement:

Sign of Seepage:

Criterion A satisfied:

Sign of Distress:

Criterion D satisfied:

Non-routine maintenance required:

Note:

Masonry wall/Masonry facing:

Note:

Consequence category (for critical section):

Observations: N/A

Emergency Action Required:

Action By: N/A

## ACTION TO INITIATE PREVENTIVE WORKS

Criterion A/Criterion D: N/A

Action By: N/A

Further Study:

Action By: N/A

## OTHER EXTERNAL ACTION

Check / repair Services:

Action By: N/A

Non-routine Maintenance:



Action By:

N/A

PHOTO



2SW-C/C 120

GENERAL VIEW

F18



## **APPENDIX B**

# **SIMAR FOR REGISTERED FEATURES IN THE VICINITY OF THE SITE**



**Slope Maintenance Responsibility Report**

(2SW-C/C112)

**ESTATE MANAGEMENT SECTION**  
**LANDS DEPARTMENT**
**List of Slope Maintenance Responsibility Area(s)**

|   |                       |   |                   |  |                  |
|---|-----------------------|---|-------------------|--|------------------|
| 1 | 2SW-C/C112            |   | Sub-Division      |  | 1                |
|   | Location              | Partly within DD129 LOT 1710, LOT 1711, LOT 1712, LOT 2279 S.B, LOT 2280, LOT 2285, LOT 2296, LOT 2284 and partly within unallocated Government land, Lau Fau Shan, Yuen Long |                   |  |                  |
|   | Responsible Lot/Party | DD129 LOT 1710  | Maintenance Agent |  | Not Applicable   |
|   | Remarks               | Not Applicable  |                   |  |                  |
| 2 | 2SW-C/C112            |   | Sub-Division      |  | 2                |
|   | Location              | Partly within DD129 LOT 1710, LOT 1711, LOT 1712, LOT 2279 S.B, LOT 2280, LOT 2285, LOT 2296, LOT 2284 and partly within unallocated Government land, Lau Fau Shan, Yuen Long |                   |  |                  |
|   | Responsible Lot/Party | DD129 LOT 1711  | Maintenance Agent |  | Not Applicable   |
|   | Remarks               | Not Applicable  |                   |  |                  |
| 3 | 2SW-C/C112            |   | Sub-Division      |  | 3                |
|   | Location              | Partly within DD129 LOT 1710, LOT 1711, LOT 1712, LOT 2279 S.B, LOT 2280, LOT 2285, LOT 2296, LOT 2284 and partly within unallocated Government land, Lau Fau Shan, Yuen Long |                   |  |                  |
|   | Responsible Lot/Party | DD129 LOT 1712  | Maintenance Agent |  | Not Applicable   |
|   | Remarks               | Not Applicable  |                   |  |                  |
| 4 | 2SW-C/C112            |   | Sub-Division      |  | 4                |
|   | Location              | Partly within DD129 LOT 1710, LOT 1711, LOT 1712, LOT 2279 S.B, LOT 2280, LOT 2285, LOT 2296, LOT 2284 and partly within unallocated Government land, Lau Fau Shan, Yuen Long |                   |  |                  |
|   | Responsible Lot/Party | Lands Department  | Maintenance Agent |  | Lands Department |
|   | Remarks               | For enquiries about the maintenance of this slope / sub-division of the slope, please contact the Maintenance Agent directly.   |                   |  |                  |
| 5 | 2SW-C/C112            |   | Sub-Division      |  | 5                |
|   | Location              | Partly within DD129 LOT 1710, LOT 1711, LOT 1712, LOT 2279 S.B, LOT 2280, LOT 2285, LOT 2296, LOT 2284 and partly within unallocated Government land, Lau Fau Shan, Yuen Long |                   |  |                  |
|   | Responsible Lot/Party | DD129 LOT 2279 S.B  | Maintenance Agent |  | Not Applicable   |
|   | Remarks               | Not Applicable  |                   |  |                  |

The use of this report and plan is subject to the terms and conditions set out under the respective Disclaimers, Copyright Notice and Privacy Policy displayed on the Slope Maintenance Responsibility Information System webpage at <http://www.slope.landsd.gov.hk/smris/disclaimer>. The contents of this report and plan, including but not limited to all text, graphics, drawings, diagrams and compilation of data or other materials are protected by copyright. The users of this report and plan acknowledge that the Government of the Hong Kong Special Administrative Region is the owner of all copyright works contained in this report and plan. Any reproduction, adaptation, distribution, dissemination or making available of any copyright works contained in this report and plan to the public is strictly prohibited unless prior written authorization is obtained from the Lands Department.

Search Criteria: 2SW-C/C112



|   |                       |   |                   |                |
|---|-----------------------|---|-------------------|----------------|
| 6 | 2SW-C/C112            |   | Sub-Division      | 6              |
|   | Location              | Partly within DD129 LOT 1710, LOT 1711, LOT 1712, LOT 2279 S.B, LOT 2280, LOT 2285, LOT 2296, LOT 2284 and partly within unallocated Government land, Lau Fau Shan, Yuen Long |                   |                |
|   | Responsible Lot/Party | DD129 LOT 2280  | Maintenance Agent | Not Applicable |
|   | Remarks               | Not Applicable  |                   |                |
| 7 | 2SW-C/C112            |   | Sub-Division      | 7              |
|   | Location              | Partly within DD129 LOT 1710, LOT 1711, LOT 1712, LOT 2279 S.B, LOT 2280, LOT 2285, LOT 2296, LOT 2284 and partly within unallocated Government land, Lau Fau Shan, Yuen Long |                   |                |
|   | Responsible Lot/Party | DD129 LOT 2285  | Maintenance Agent | Not Applicable |
|   | Remarks               | Not Applicable  |                   |                |
| 8 | 2SW-C/C112            |   | Sub-Division      | 8              |
|   | Location              | Partly within DD129 LOT 1710, LOT 1711, LOT 1712, LOT 2279 S.B, LOT 2280, LOT 2285, LOT 2296, LOT 2284 and partly within unallocated Government land, Lau Fau Shan, Yuen Long |                   |                |
|   | Responsible Lot/Party | DD129 LOT 2296  | Maintenance Agent | Not Applicable |
|   | Remarks               | Not Applicable  |                   |                |
| 9 | 2SW-C/C112            |   | Sub-Division      | 9              |
|   | Location              | Partly within DD129 LOT 1710, LOT 1711, LOT 1712, LOT 2279 S.B, LOT 2280, LOT 2285, LOT 2296, LOT 2284 and partly within unallocated Government land, Lau Fau Shan, Yuen Long |                   |                |
|   | Responsible Lot/Party | DD129 LOT 2284  | Maintenance Agent | Not Applicable |
|   | Remarks               | Not Applicable  |                   |                |

- End of Report -

**Notes:**

- (i) The location plan in Annex is for identification purposes of slope(s) only.
- (ii) The slope(s) as listed in the Slope Maintenance Responsibility Report may not be shown on the location plan in Annex.

The use of this report and plan is subject to the terms and conditions set out under the respective Disclaimers, Copyright Notice and Privacy Policy displayed on the Slope Maintenance Responsibility Information System webpage at <http://www.slope.landsd.gov.hk/smr/s/disclaimer>. The contents of this report and plan, including but not limited to all text, graphics, drawings, diagrams and compilation of data or other materials are protected by copyright. The users of this report and plan acknowledge that the Government of the Hong Kong Special Administrative Region is the owner of all copyright works contained in this report and plan. Any reproduction, adaptation, distribution, dissemination or making available of any copyright works contained in this report and plan to the public is strictly prohibited unless prior written authorization is obtained from the Lands Department.

## Location Plan

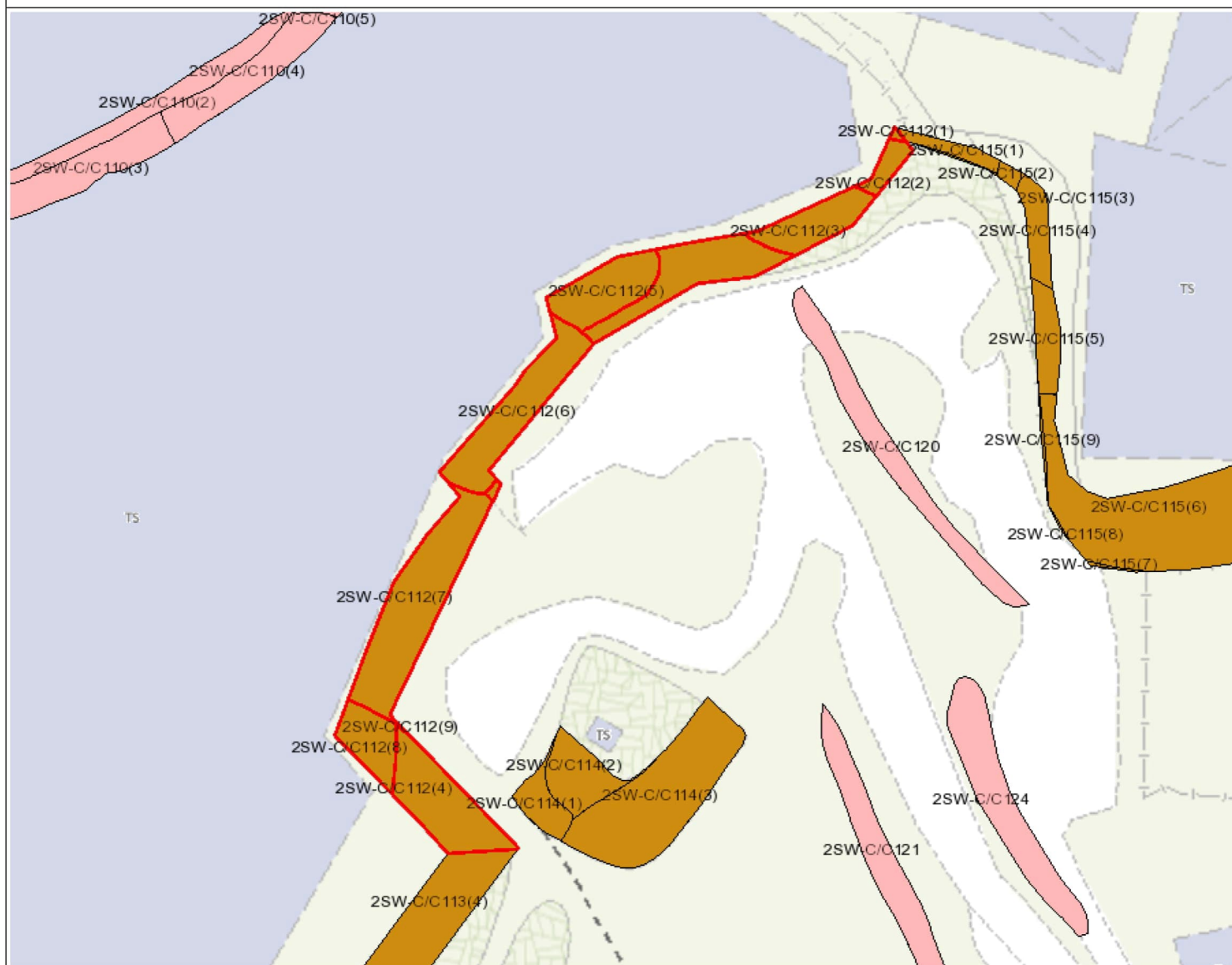

## Legend

- Slope Area(s)
- - - - - Search Location
- Slope(s) Maintained by Government
- Slope(s) Maintained by Private Party/Parties
- Slope(s) Maintained by Government and Private Party/Parties



**ESTATE MANAGEMENT SECTION**  
**LANDS DEPARTMENT**

This Plan is **NOT TO SCALE** and intended for **IDENTIFICATION** only. All information shown on this plan **MUST** be verified by field survey.

Printed on: 18/12/2025

The use of this report and plan is subject to the terms and conditions set out under the respective Disclaimers, Copyright Notice and Privacy Policy displayed on the Slope Maintenance Responsibility Information System webpage at <http://www.slope.landsgov.hk/smris/disclaimer>. The contents of this report and plan, including but not limited to all text, graphics, drawings, diagrams and compilation of data or other materials are protected by copyright. The users of this report and plan acknowledge that the Government of the Hong Kong Special Administrative Region is the owner of all copyright works contained in this report and plan. Any reproduction, adaptation, distribution, dissemination or making available of any copyright works contained in this report and plan to the public is strictly prohibited unless prior written authorization is obtained from the Lands Department.

Search Criteria: 2SW-C/C112

# Slope Maintenance Responsibility Report

(2SW-C/C115)



ESTATE MANAGEMENT SECTION  
LANDS DEPARTMENT

## List of Slope Maintenance Responsibility Area(s)

|   |                       |  |                   |                  |
|---|-----------------------|--|-------------------|------------------|
| 1 | 2SW-C/C115            |  | Sub-Division      | 1                |
|   | Location              | Partly within DD129 LOT 1710, LOT 1711, LOT 1706, LOT 1705 S.B, LOT 1705 S.A, LOT 1704, LOT 1703 and LOT 1701, partly within STT3175 and partly on adjoining Government land |                   |                  |
|   | Responsible Lot/Party | DD129 LOT 1710   | Maintenance Agent | Not Applicable   |
|   | Remarks               | Slope information being reviewed.  |                   |                  |
| 2 | 2SW-C/C115            |  | Sub-Division      | 2                |
|   | Location              | Partly within DD129 LOT 1710, LOT 1711, LOT 1706, LOT 1705 S.B, LOT 1705 S.A, LOT 1704, LOT 1703 and LOT 1701, partly within STT3175 and partly on adjoining Government land |                   |                  |
|   | Responsible Lot/Party | DD129 LOT 1711   | Maintenance Agent | Not Applicable   |
|   | Remarks               | Slope information being reviewed.  |                   |                  |
| 3 | 2SW-C/C115            |  | Sub-Division      | 3                |
|   | Location              | Partly within DD129 LOT 1710, LOT 1711, LOT 1706, LOT 1705 S.B, LOT 1705 S.A, LOT 1704, LOT 1703 and LOT 1701, partly within STT3175 and partly on adjoining Government land |                   |                  |
|   | Responsible Lot/Party | Lands Department   | Maintenance Agent | Lands Department |
|   | Remarks               | 1. Slope information being reviewed.<br><br>2. For enquiries about the maintenance of this slope / sub-division of the slope, please contact the Maintenance Agent directly. |                   |                  |
| 4 | 2SW-C/C115            |  | Sub-Division      | 4                |
|   | Location              | Partly within DD129 LOT 1710, LOT 1711, LOT 1706, LOT 1705 S.B, LOT 1705 S.A, LOT 1704, LOT 1703 and LOT 1701, partly within STT3175 and partly on adjoining Government land |                   |                  |
|   | Responsible Lot/Party | DD129 LOT 1706   | Maintenance Agent | Not Applicable   |
|   | Remarks               | Slope information being reviewed.  |                   |                  |
| 5 | 2SW-C/C115            |  | Sub-Division      | 5                |
|   | Location              | Partly within DD129 LOT 1710, LOT 1711, LOT 1706, LOT 1705 S.B, LOT 1705 S.A, LOT 1704, LOT 1703 and LOT 1701, partly within STT3175 and partly on adjoining Government land |                   |                  |
|   | Responsible Lot/Party | DD129 LOT 1705 S.B   | Maintenance Agent | Not Applicable   |
|   | Remarks               | Slope information being reviewed.  |                   |                  |

The use of this report and plan is subject to the terms and conditions set out under the respective Disclaimers, Copyright Notice and Privacy Policy displayed on the Slope Maintenance Responsibility Information System webpage at <http://www.slope.landsd.gov.hk/smr/s/disclaimer>. The contents of this report and plan, including but not limited to all text, graphics, drawings, diagrams and compilation of data or other materials are protected by copyright. The users of this report and plan acknowledge that the Government of the Hong Kong Special Administrative Region is the owner of all copyright works contained in this report and plan. Any reproduction, adaptation, distribution, dissemination or making available of any copyright works contained in this report and plan to the public is strictly prohibited unless prior written authorization is obtained from the Lands Department.

Search Criteria: 2SW-C/C115

|   |                       |  |                   |                |
|---|-----------------------|--|-------------------|----------------|
| 6 | 2SW-C/C115            |  | Sub-Division      | 6              |
|   | Location              | Partly within DD129 LOT 1710, LOT 1711, LOT 1706, LOT 1705 S.B, LOT 1705 S.A, LOT 1704, LOT 1703 and LOT 1701, partly within STT3175 and partly on adjoining Government land |                   |                |
|   | Responsible Lot/Party | DD129 LOT 1705 S.A   | Maintenance Agent | Not Applicable |
|   | Remarks               | Slope information being reviewed.  |                   |                |
| 7 | 2SW-C/C115            |  | Sub-Division      | 7              |
|   | Location              | Partly within DD129 LOT 1710, LOT 1711, LOT 1706, LOT 1705 S.B, LOT 1705 S.A, LOT 1704, LOT 1703 and LOT 1701, partly within STT3175 and partly on adjoining Government land |                   |                |
|   | Responsible Lot/Party | DD129 LOT 1701   | Maintenance Agent | Not Applicable |
|   | Remarks               | Slope information being reviewed.  |                   |                |
| 8 | 2SW-C/C115            |  | Sub-Division      | 8              |
|   | Location              | Partly within DD129 LOT 1710, LOT 1711, LOT 1706, LOT 1705 S.B, LOT 1705 S.A, LOT 1704, LOT 1703 and LOT 1701, partly within STT3175 and partly on adjoining Government land |                   |                |
|   | Responsible Lot/Party | DD129 LOT 1703   | Maintenance Agent | Not Applicable |
|   | Remarks               | Slope information being reviewed.  |                   |                |
| 9 | 2SW-C/C115            |  | Sub-Division      | 9              |
|   | Location              | Partly within DD129 LOT 1710, LOT 1711, LOT 1706, LOT 1705 S.B, LOT 1705 S.A, LOT 1704, LOT 1703 and LOT 1701, partly within STT3175 and partly on adjoining Government land |                   |                |
|   | Responsible Lot/Party | DD129 LOT 1704   | Maintenance Agent | Not Applicable |
|   | Remarks               | Slope information being reviewed.  |                   |                |

- End of Report -

**Notes:**

- (i) The location plan in Annex is for identification purposes of slope(s) only.
- (ii) The slope(s) as listed in the Slope Maintenance Responsibility Report may not be shown on the location plan in Annex.

The use of this report and plan is subject to the terms and conditions set out under the respective Disclaimers, Copyright Notice and Privacy Policy displayed on the Slope Maintenance Responsibility Information System webpage at <http://www.slope.landsd.gov.hk/smris/disclaimer>. The contents of this report and plan, including but not limited to all text, graphics, drawings, diagrams and compilation of data or other materials are protected by copyright. The users of this report and plan acknowledge that the Government of the Hong Kong Special Administrative Region is the owner of all copyright works contained in this report and plan. Any reproduction, adaptation, distribution, dissemination or making available of any copyright works contained in this report and plan to the public is strictly prohibited unless prior written authorization is obtained from the Lands Department.



## Location Plan

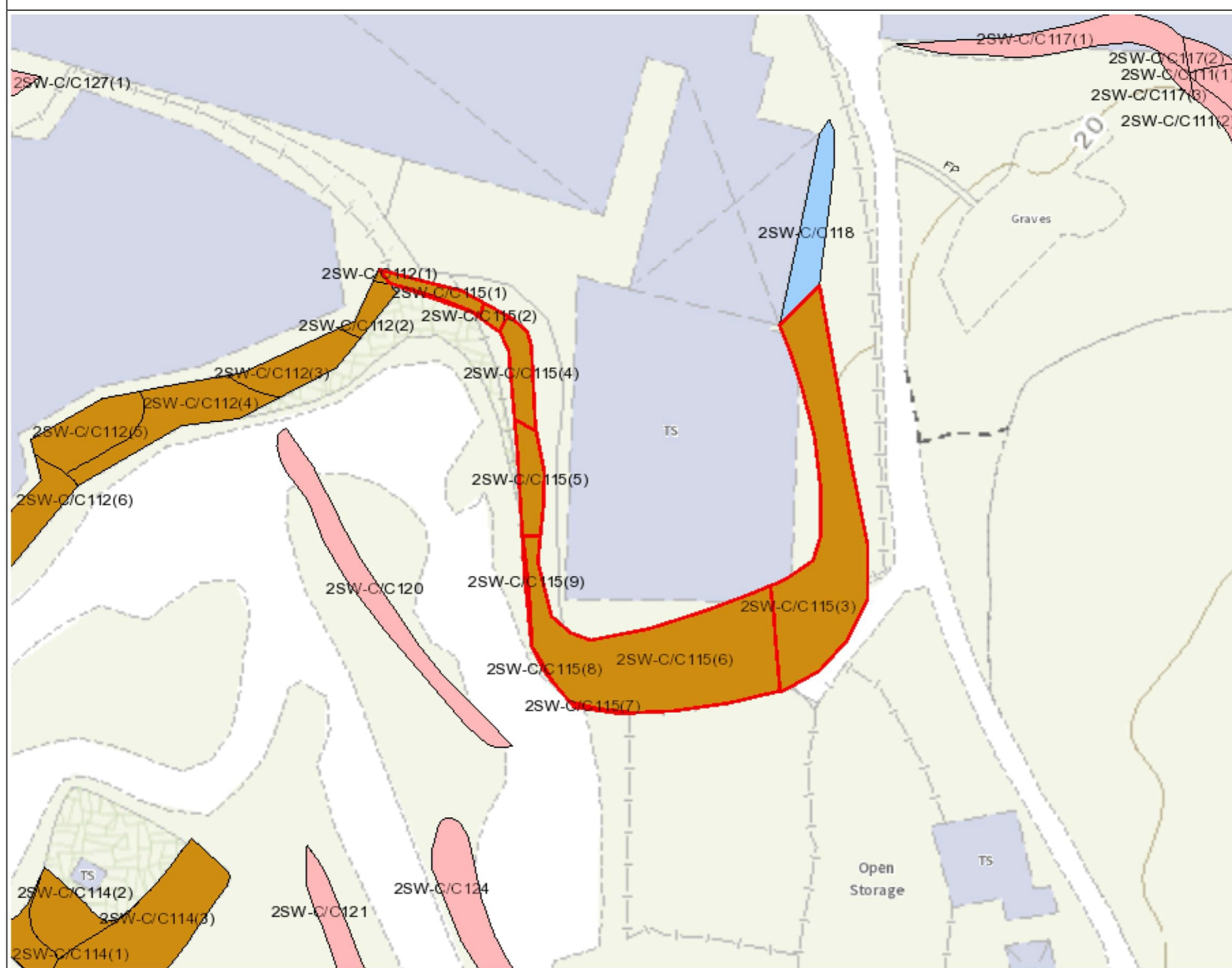

## Legend

- Slope Area(s)
- - - - - Search Location
- Slope(s) Maintained by Government
- Slope(s) Maintained by Private Party/Parties
- Slope(s) Maintained by Government and Private Party/Parties



**ESTATE MANAGEMENT SECTION**  
**LANDS DEPARTMENT**

This Plan is **NOT TO SCALE** and intended for **IDENTIFICATION** only. All information shown on this plan **MUST** be verified by field survey.

Printed on: 18/12/2025

The use of this report and plan is subject to the terms and conditions set out under the respective Disclaimers, Copyright Notice and Privacy Policy displayed on the Slope Maintenance Responsibility Information System webpage at <http://www.slope.landsd.gov.hk/smris/disclaimer>. The contents of this report and plan, including but not limited to all text, graphics, drawings, diagrams and compilation of data or other materials are protected by copyright. The users of this report and plan acknowledge that the Government of the Hong Kong Special Administrative Region is the owner of all copyright works contained in this report and plan. Any reproduction, adaptation, distribution, dissemination or making available of any copyright works contained in this report and plan to the public is strictly prohibited unless prior written authorization is obtained from the Lands Department.

Search Criteria: 2SW-C/C115

## Slope Maintenance Responsibility Report

(2SW-C/C120)



ESTATE MANAGEMENT SECTION  
LANDS DEPARTMENT

### List of Slope Maintenance Responsibility Area(s)

|   |                       |                      |                   |                |
|---|-----------------------|----------------------|-------------------|----------------|
| 1 | 2SW-C/C120            |                      | Sub-Division      | Not Applicable |
|   | Location              | WITHIN DD129 LOT1702 |                   |                |
|   | Responsible Lot/Party | DD129 Lot1702        | Maintenance Agent | Not Applicable |
|   | Remarks               | Not Applicable       |                   |                |

- End of Report -

#### Notes:

- (i) The location plan in Annex is for identification purposes of slope(s) only.
- (ii) The slope(s) as listed in the Slope Maintenance Responsibility Report may not be shown on the location plan in Annex.

The use of this report and plan is subject to the terms and conditions set out under the respective Disclaimers, Copyright Notice and Privacy Policy displayed on the Slope Maintenance Responsibility Information System webpage at <http://www.slope.landsd.gov.hk/smr/s/disclaimer>. The contents of this report and plan, including but not limited to all text, graphics, drawings, diagrams and compilation of data or other materials are protected by copyright. The users of this report and plan acknowledge that the Government of the Hong Kong Special Administrative Region is the owner of all copyright works contained in this report and plan. Any reproduction, adaptation, distribution, dissemination or making available of any copyright works contained in this report and plan to the public is strictly prohibited unless prior written authorization is obtained from the Lands Department.

Search Criteria: 2SW-C/C120



## Location Plan

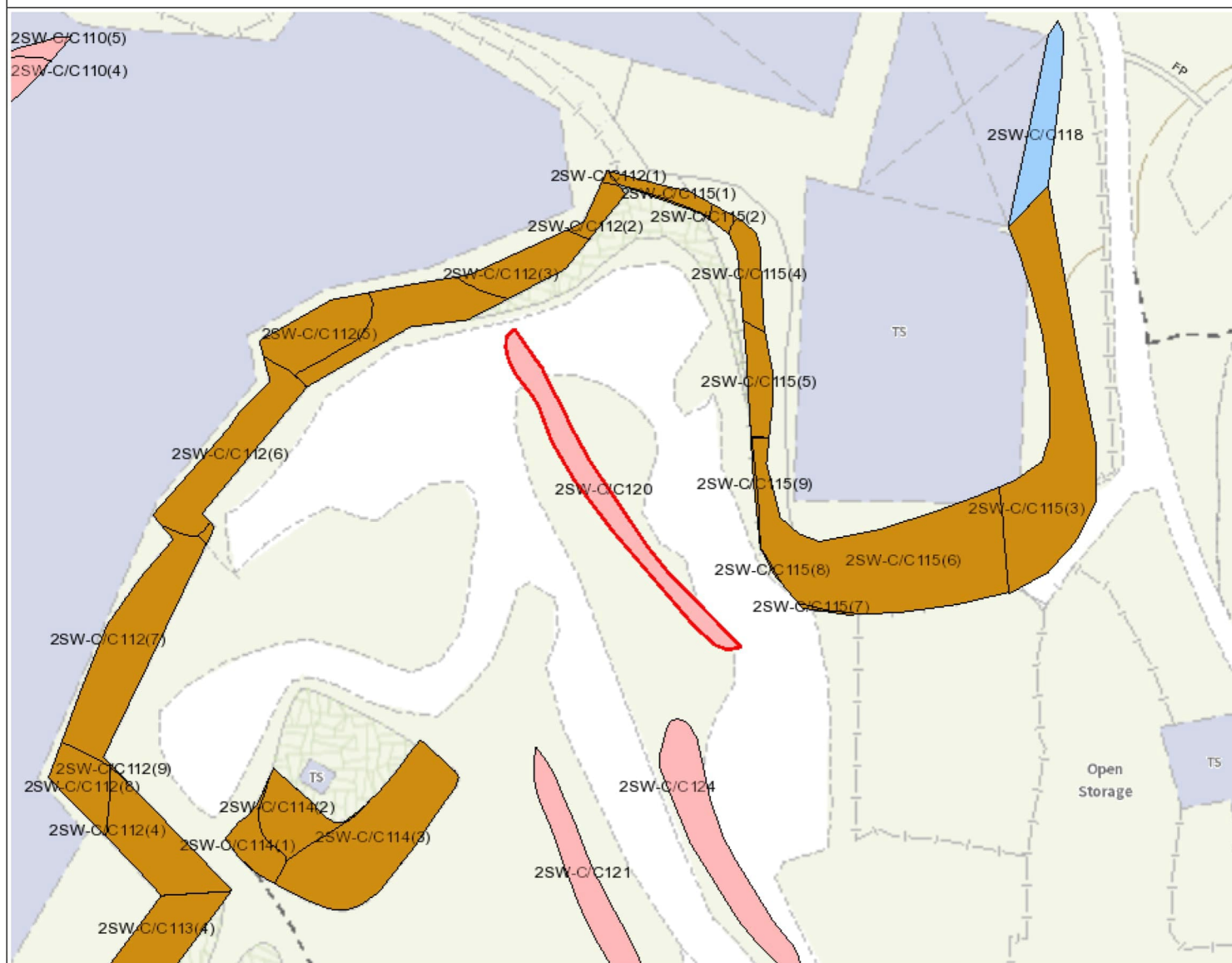

## Legend

- Slope Area(s)
- - - - - Search Location
- Slope(s) Maintained by Government
- Slope(s) Maintained by Private Party/Parties
- Slope(s) Maintained by Government and Private Party/Parties



**ESTATE MANAGEMENT SECTION**  
**LANDS DEPARTMENT**

This Plan is **NOT TO SCALE** and intended for **IDENTIFICATION** only. All information shown on this plan **MUST** be verified by field survey.

Printed on: 18/12/2025

The use of this report and plan is subject to the terms and conditions set out under the respective Disclaimers, Copyright Notice and Privacy Policy displayed on the Slope Maintenance Responsibility Information System webpage at <http://www.slope.landsd.gov.hk/smris/disclaimer>. The contents of this report and plan, including but not limited to all text, graphics, drawings, diagrams and compilation of data or other materials are protected by copyright. The users of this report and plan acknowledge that the Government of the Hong Kong Special Administrative Region is the owner of all copyright works contained in this report and plan. Any reproduction, adaptation, distribution, dissemination or making available of any copyright works contained in this report and plan to the public is strictly prohibited unless prior written authorization is obtained from the Lands Department.

Search Criteria: 2SW-C/C120

## **APPENDIX C**

### **INCIDENT RECORD FOR REGISTERED FEATURES IN THE VICINITY OF THE SITE**



YOUR REF 來函檔號：

OUR REF 本署檔號： BD EB-SS-010-015-F02786-P001

FAX 圖文傳真： 2136 8200

TEL 電話： 3842 3916

www.bd.gov.hk

27 August 2025

Wong Hung Cheong (黃鴻昌)  
No.67, Fook Hang Tsuen, Lam Tei,  
Tuen Mun, New Territories, Hong Kong

Dear Sir/Madam,

**Emergency Slope Repair Works for  
Landslide at Feature No. 2SW-C/C112 (Sub-Division No. 6)  
at Lot No. 2280 in D.D. 129  
Lau Fau Shan, Yuen Long, New Territories**

Site inspection by staffs of Geotechnical Engineering Office and this Department on 13 August 2025 revealed landslide scars at the captioned feature. A location plan and inspection photos are attached for your easy reference.

2. As Landslide Scar no.3 shown on the location plan rest on your private lot, you are requested to carry out the following emergency slope repair works within your lot immediately:-

- (i) Remove the landslide debris;
- (ii) Remove loose materials on the failure scars and minor trim back the failure surfaces; and
- (iii) Provide hard surface cover with wire mesh and weepholes to the failure surfaces.

3. The Government Contractor was also instructed on 13 August 2025 to cordon off area in danger behind the failed portions of the captioned feature and cover the failure scars with secured tarpaulin sheet as an emergency, on your behalf under section 27A(4) of the Buildings Ordinance. Pursuant to the same section stated above, the cost of the works in question plus supervision charges shall be recoverable from you as owner(s) under Section 32A, 32B and 33 of the Buildings Ordinance and I shall shortly forward to you a demand note for this purpose.

4. You are requested to appoint an authorized person and a registered geotechnical engineer to undertake the works. If the works involve structural elements, a registered structural engineer shall be appointed. The appointee(s) could be the same person provided that he/she possesses the required qualifications.

P.2/.....



5. To safeguard your interest, you shall carry out site survey to verify your private lot boundary and the landslide scar to determine the portion of the area under your purview that need to repair.
6. This Department has also issued a similar letter to the owners of Lot No. 2812 s.D R.P. in D.D. 129 and Lot No. 2279 s.B in D.D. 129. It would be of mutual benefit for you to liaise with the above owners to co-ordinate the works.
7. You are required to notify on commencement and completion of the recommended emergency slope repair works to this Department. If we have not received your notification on commencement of the works before **1 September 2025**, the Building Authority may instruct the Government Contractor to carry out the necessary emergency works under section 27A(4) of the Buildings Ordinance on your behalf and subsequently recover the cost of the emergency works plus supervision charges from you.
8. To notify on commencement and completion of the works or if you need further information, please contact our Structural Engineer/Slope Safety 7, Mr. LO Ming-kay at 3842 3916 or Survey Officer/Slope Safety 7, Mr. CHAN Kin-wai at 3842 3979.

Yours faithfully,

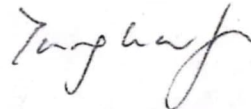

( TANG Wan-fung )  
Senior Structural Engineer/Slope Safety (MW)  
for Building Authority

Encl.

c.c. CGE/MW, GEO, CEDD ✓



| MW                     |               | Area              | ESH-00000 |
|------------------------|---------------|-------------------|-----------|
| Mainland West Division |               | ERKS No.          |           |
| MW-                    | DH/OIS-F02786 |                   |           |
| CGE/MW                 | PTO/M         | Due Date          |           |
| SGE/MW1                | STO/MW1       |                   |           |
| SGE/MW2                | STO/MW2       |                   |           |
| SGE/MW3                | STO/MW3&5     | Following in      |           |
| SGE/MW4                | STO/MW4       | Lapilli           |           |
| SGE/MW5                | STO/MW6       | Is there BU item* |           |
| SGE/MW6                | PSH           | RIS Phase 1 Y / N |           |
| SGE/MW7                | GR            | Type II Y / N     |           |
| GE 53                  | GE            | Priority Y / N    |           |
| CC MW-                 | 25W-C 10112   |                   |           |



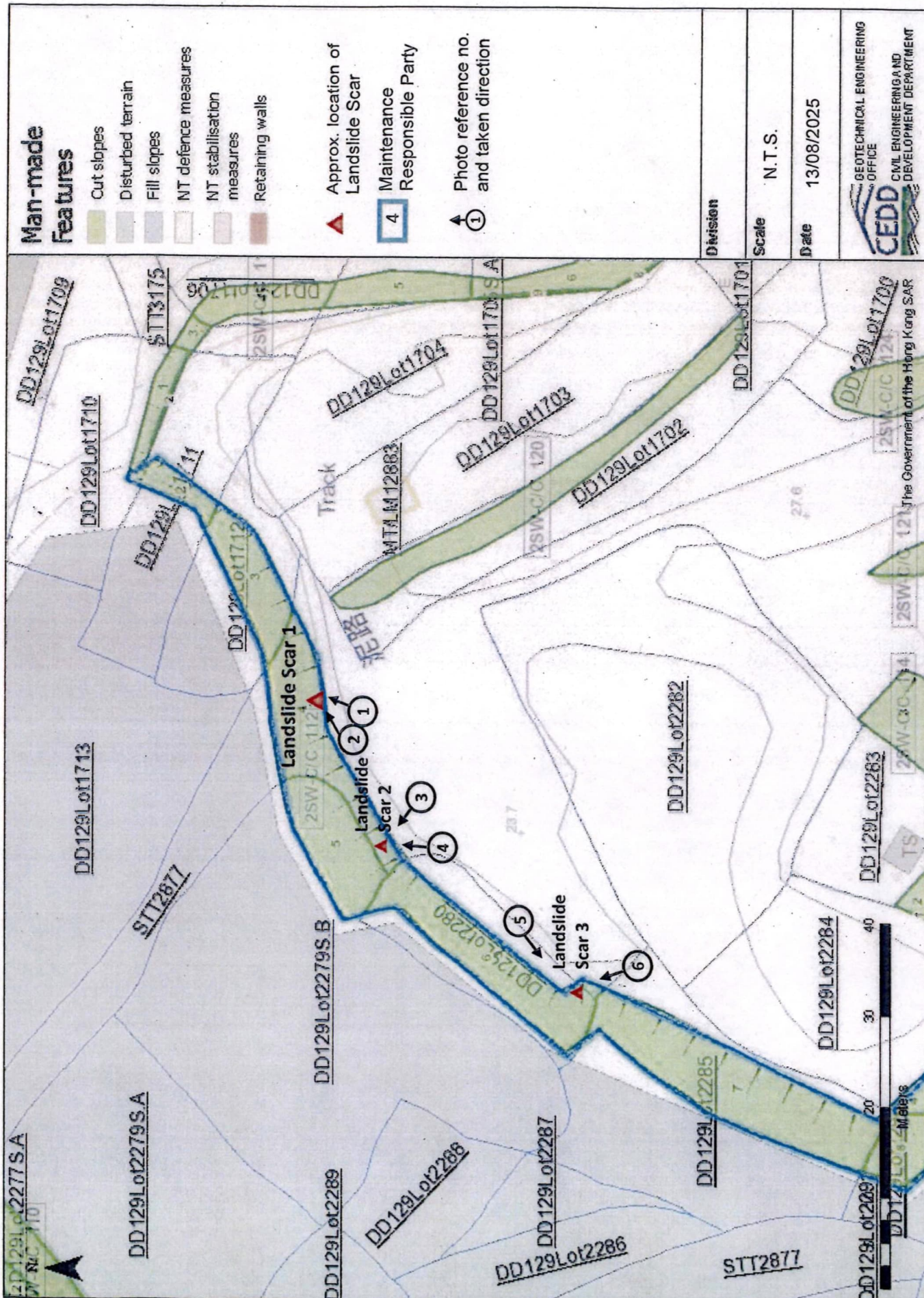

# Man-made Features

- Cut slopes
- Disturbed terrain
- Fill slopes
- NT defence measures
- NT stabilisation measures
- Retaining walls

▲ Approx. location of Landslide Scar

4 Maintenance Responsible Party

① Photo reference no. and taken direction

Division

Scale

N.T.S.

Date

13/08/2025

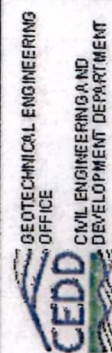



**PHOTOGRAPHS**

File Ref.: Incident No. 2025/08/3982

Location : Feature No. 2SW-C/C112, Perimeter of Open Storage Area near San Hing Tsuen, Lau Fau Shan, Yuen Long



Photo 1 (Landslide Scar 1)



Photo 2 (Landslide Scar 1)

**Geotechnical Engineering Office****District Division**



**PHOTOGRAPHS**

File Ref.: Incident No. 2025/08/3982

Location : Feature No. 2SW-C/C112, Perimeter of Open Storage Area near San Hing Tsuen, Lau Fau Shan, Yuen Long



Photo 3 (Landslide Scar 2)



Photo 4 (Landslide Scar 2)

**Geotechnical Engineering Office****District Division**



**PHOTOGRAPHS**

File Ref.: Incident No. 2025/08/3982

Location : Feature No. 2SW-C/C112, Perimeter of Open Storage Area near San Hing Tsuen, Lau Fau Shan, Yuen Long



Photo 5 (Landslide Scar 3)



Photo 6 (Landslide Scar 3)

**Geotechnical Engineering Office****District Division**