

Our Ref.: YL/TPN/2592A/L02

27 January 2025

Secretary
Town Planning Board
15/F, North Point Government Offices
333 Java Road, North Point
Hong Kong

By Post and Email

Dear Sir/Madam,

**Planning Application For
Proposed Temporary Shop and Services (Sale of Electric Goods Vehicles) and
Electric Goods Vehicle Charging Station
for a Period of Three Years
Lot Nos. 2942sARP(Part), 2952 and 2953 in D.D. 104
Mai Po, Yuen Long, New Territories**

We refer to the captioned planning application.

We would like to clarify the followings:

- (1) the site wholly falls within "Recreation" zone;
- (2) the site boundary has been revised and the application area is revised to 1,583m²; and
- (3) the site layout has been revised due to deletion of the transformer room and relocation of the site office.

We would also like to provide the following documents:

- (1) a set of revised Executive Summary, page 2 and page 4 of the planning statement;
- (2) a revised Proposed Layout Plan (Appendix 2 of the planning statement);
- (3) a revised Site Plan (Lot Index Plan) (Appendix 3 of the planning statement); and
- (4) revised page 2, page 5, page 10 and page 11 of the application form.

Should you have any queries, please feel free to call our Mr. Anson Lee at 2301-1869.
Thank you for your attention.

Yours faithfully,
For and on behalf of
LANBASE SURVEYORS LIMITED

Anson Lee

Encl.
RK/AL



ISO 9001 : 2015
Certificate No.: CC 1687
(Valuation & Land Administration)



ISO 9001 : 2015
Certificate No.: CC 1687
(Valuation & Land Administration)

EXECUTIVE SUMMARY

The Application Site ('the Site') comprises Lot Nos. 2942sARP(Part), 2952 and 2953 in D.D. 104, Mai Po, Yuen Long, New Territories. It is located at the southwest of the junction of Geranium Path and Castle Peak Road – Mai Po. The Site is applied for the use of "Temporary Shop and Services (Sale of Electric Goods Vehicles) and Electric Goods Vehicle Charging Station" for a period of 3 years. The Site occupies a site area of about 1,583m². In accordance with the Approved Mai Po and Fairview Park Outline Zoning Plan (OZP) No. S/YL-MP/8 dated 20.9.2024, the Site falls within an area zoned "Recreation" ("REC"). According to the Town Planning Board Guidelines for Application for Developments within Deep Bay Area" (TPB PG-No.12C), the Site falls within the "Wetland Buffer Area (WBA)".

A planning permission is sought to use the Site as "Temporary Shop and Services (Sale of Electric Goods Vehicles) and Electric Goods Vehicle Charging Station". Since the Site is small in scale, no adverse traffic and environmental impacts are anticipated.

The subject application is justified on the following grounds: 1) No Contravention to the Long Term Planning Intention; 2) Being in Line with Government Policy; 3) Coping with Demand for Charging Station for Electric Goods Vehicles; 4) Compatible with the Surrounding Land Uses; 5) No Adverse Environmental Impact; and 6) No Adverse Traffic Impact.

申請摘要

申請場地乃新界元朗米埔丈量約份104約地段第2942號A段餘段(部份)、第2952號及第2953號。申請場地位於洋葵徑及青山公路米埔段交匯處西南面。現申請三年臨時規劃許可作「臨時商店及服務行業(電動貨車銷售)及電動貨車充電站」用途。申請地段佔地共1,583平方米。是項申請地段位於米埔及錦繡花園分區計劃大綱核准圖編號S/YL-MP/8(發表於2024年9月20日)內之「康樂」地帶。根據城市規劃委員會規劃指引編號12C「擬於后海灣地區內進行發展」，申請場地被列作「濕地緩衝區」。

是項臨時許可申請把場地申請用作「臨時商店及服務行業(電動貨車銷售)及電動貨車充電站」。由於場地規模細小，相信並不會引致不良的交通、渠務及環境影響。

是項申請的理由如下：1)沒有違反長遠之規劃意向； 2)與政府政策相一致； 3)應付電動貨車充電站的需求； 4)與附近的土地用途相容； 5)善用空置土地；6)沒有不良的環境影響；及7)沒有不良的交通影響。

2. SITE CONTEXT

2.1 Application Site

The Application Site ('the Site') comprises Lot Nos. 2942sARP(Part), 2952 and 2953 in D.D. 104, Mai Po, Yuen Long, New Territories.. The Site occupies a site area of about 1,583m². Please refer to Location Plan at **Appendix 3** and Site Plan at **Appendix 4**.

2.2 Lease Particulars

The subject lots are held under Block Crown Lease and demised as agricultural land. The lease is virtually unrestricted, apart from offensive trade clause and will expire on 30th June 2047.

2.3 Surrounding Land Uses

2.3.1 It is located at the southwest of the junction of Geranium Path and Castle Peak Road – Mai Po.

2.3.2 To its immediate west is some residential dwellings and temporary structures.

2.3.3 To its east is vacant land and Castle Peak Road – Mai Po and San Tin Highway.

2.3.4 To its north is immediate north is Geranium Path and open storages.

2.4 Accessibility

2.4.1 The Site is accessible from Geranium Path, which is connected to Castle Peak Road– Mai Po Section.

2.4.2 The subject area is served by various modes of public transport, including buses, minibuses and taxis.

4. PROPOSED DEVELOPMENT

4.1 Applied Use

The subject application is submitted for the use of “Temporary Shop and Services (Sale of Electric Goods Vehicles) and Electric Goods Vehicle Charging Station” on site for a period of 3 years.

4.2 Proposed Use and Site Layout

It is proposed to provide “Temporary Shop and Services (Sale of Electric Goods Vehicles) and Electric Goods Vehicle Charging Station” at the Site.

4.3 Ancillary Facilities

There are a single-storey converted container sales office, two open-sided metal covers for both new electric lorry showroom area and charging area, 5 electric lorry charging spaces and 3 private car parking spaces provided in support of the proposed use.

4.5. Operation Hours

4.5.1 The proposed “Temporary Shop and Services (Sale of Electric Goods Vehicles)” would be operated from 11am to 6pm daily (from Monday to Saturday except public holidays).

4.5.2 The proposed “Temporary Electric Goods Vehicle Charging Station” would be operated from 24 hours a day and 7 days a week (from Monday to Sunday and Public Holidays).

4.6 Traffic

4.6.1 There would be some traffic arrangement, as listed below:

- (a) there would be only 30 times of trips generation and attraction for the electric lorry per day (i.e. mainly during 8am to 9am, 12pm to 4pm and 6pm to 8pm);
- (b) there would be only 6 times of trip generation and attraction for the private car per day (i.e. mainly for staff use during 7am to 9am and 5pm to 7pm);
- (c) there are 2 nos. of HGV/MGV waiting spaces for avoiding any queuing up on the public road;
- (d) adequate manoeuvring space would be reserved within the Site in order to avoid any reverse driving out from the Site; and

For Official Use Only 請勿填寫此欄	Application No. 申請編號	
	Date Received 收到日期	

- The completed form and supporting documents (if any) should be sent to the Secretary, Town Planning Board (the Board), 15/F, North Point Government Offices, 333 Java Road, North Point, Hong Kong.
申請人須把填妥的申請表格及其他支持申請的文件(倘有), 送交香港北角渣華道 333 號北角政府合署 15 樓城市規劃委員會(下稱「委員會」)秘書收。
- Please read the "Guidance Notes" carefully before you fill in this form. The document can be downloaded from the Board's website at <http://www.tpb.gov.hk/>. It can also be obtained from the Secretariat of the Board at 15/F, North Point Government Offices, 333 Java Road, North Point, Hong Kong (Tel: 2231 4810 or 2231 4835), and the Planning Enquiry Counters of the Planning Department (Hotline: 2231 5000) (17/F, North Point Government Offices, 333 Java Road, North Point, Hong Kong and 14/F, Sha Tin Government Offices, 1 Sheung Wo Che Road, Sha Tin, New Territories).
請先細閱《申請須知》的資料單張, 然後填寫此表格。該份文件可從委員會的網頁下載(網址: <http://www.tpb.gov.hk/>), 亦可向委員會秘書處(香港北角渣華道 333 號北角政府合署 15 樓 - 電話: 2231 4810 或 2231 4835)及規劃署的規劃資料查詢處(熱線: 2231 5000)(香港北角渣華道 333 號北角政府合署 17 樓及新界沙田上禾輦路 1 號沙田政府合署 14 樓)索取。
- This form can be downloaded from the Board's website, and obtained from the Secretariat of the Board and the Planning Enquiry Counters of the Planning Department. The form should be typed or completed in block letters. The processing of the application may be refused if the required information or the required copies are incomplete.
此表格可從委員會的網頁下載, 亦可向委員會秘書處及規劃署的規劃資料查詢處索取。申請人須以打印方式或以正楷填寫表格。如果申請人所提交的資料或文件副本不齊全, 委員會可拒絕處理有關申請。

1. Name of Applicant 申請人姓名/名稱

(☐ Mr. 先生 / ☐ Mrs. 夫人 / ☐ Miss 小姐 / ☐ Ms. 女士 / ☒ Company 公司 / ☐ Organisation 機構)

AMPLE FORWARDING LTD. 豐盛貨運有限公司

2. Name of Authorised Agent (if applicable) 獲授權代理人姓名/名稱 (如適用)

(☐ Mr. 先生 / ☐ Mrs. 夫人 / ☐ Miss 小姐 / ☐ Ms. 女士 / ☒ Company 公司 / ☐ Organisation 機構)

LANBASE SURVEYORS LIMITED 宏基測量師行有限公司

3. Application Site 申請地點

(a) Full address / location / demarcation district and lot number (if applicable) 詳細地址/地點/丈量約份及地段號碼(如適用)	LOT NOS. 2942S.ARP(PART), 2952 AND 2953 IN D.D. 104, MAI PO, YUEN LONG, NEW TERRITORIES
(b) Site area and/or gross floor area involved 涉及的地盤面積及/或總樓面面積	<input checked="" type="checkbox"/> Site area 地盤面積 1,583 sq.m 平方米 <input checked="" type="checkbox"/> About 約 <input checked="" type="checkbox"/> Gross floor area 總樓面面積 271.28 sq.m 平方米 <input checked="" type="checkbox"/> About 約
(c) Area of Government land included (if any) 所包括的政府土地面積(倘有)	NIL sq.m 平方米 <input type="checkbox"/> About 約

6. Type(s) of Application 申請類別	
(A) Temporary Use/Development of Land and/or Building Not Exceeding 3 Years in Rural Areas or Regulated Areas 位於鄉郊地區或受規管地區土地上及/或建築物內進行為期不超過三年的臨時用途/發展 (For Renewal of Permission for Temporary Use or Development in Rural Areas or Regulated Areas, please proceed to Part (B)) (如屬位於鄉郊地區或受規管地區臨時用途/發展的規劃許可續期，請填寫(B)部分)	
(a) Proposed use(s)/development 擬議用途/發展	TEMPORARY SHOP AND SERVICES (SALE OF ELECTRIC GOODS VEHICLES) AND ELECTRIC GOODS VEHICLE CHARGING STATION (Please illustrate the details of the proposal on a layout plan) (請用平面圖說明擬議詳情)
(b) Effective period of permission applied for 申請的許可有效期	<input checked="" type="checkbox"/> year(s) 年 3 <input type="checkbox"/> month(s) 個月
(c) Development Schedule 發展細節表	
Proposed uncovered land area 擬議露天土地面積	1,311.72sq.m <input checked="" type="checkbox"/> About 約
Proposed covered land area 擬議有上蓋土地面積	271.28sq.m <input checked="" type="checkbox"/> About 約
Proposed number of buildings/structures 擬議建築物/構築物數目	4
Proposed domestic floor area 擬議住用樓面面積	NILsq.m <input type="checkbox"/> About 約
Proposed non-domestic floor area 擬議非住用樓面面積	271.28sq.m <input checked="" type="checkbox"/> About 約
Proposed gross floor area 擬議總樓面面積	271.28sq.m <input checked="" type="checkbox"/> About 約
Proposed height and use(s) of different floors of buildings/structures (if applicable) 建築物/構築物的擬議高度及不同樓層的擬議用途 (如適用) (Please use separate sheets if the space below is insufficient) (如以下空間不足，請另頁說明) STRUCTURE 1: SHOWROOM AREA (5M IN HEIGHT)(1-STOREY) STRUCTURE 2: SITE OFFICE (2.6M IN HEIGHT)(1-STOREY) STRUCTURE 3: COVERED CHARGING AREA (5M IN HEIGHT)(1-STOREY)	
Proposed number of car parking spaces by types 不同種類停車位的擬議數目	
Private Car Parking Spaces 私家車車位	3
Motorcycle Parking Spaces 電單車車位	NIL
Light Goods Vehicle Parking Spaces 輕型貨車泊車位	NIL
Medium Goods Vehicle Parking Spaces 中型貨車泊車位	NIL
Heavy Goods Vehicle Parking Spaces 重型貨車泊車位	NIL
Others (Please Specify) 其他 (請列明)	5
(HGV/MGV CHARGING SPACES)	
Proposed number of loading/unloading spaces 上落客貨車位的擬議數目	
Taxi Spaces 的士車位	NIL
Coach Spaces 旅遊巴車位	NIL
Light Goods Vehicle Spaces 輕型貨車車位	NIL
Medium Goods Vehicle Spaces 中型貨車車位	NIL
Heavy Goods Vehicle Spaces 重型貨車車位	NIL
Others (Please Specify) 其他 (請列明)	2
(HGV/MGV WAITING SPACES)	

Gist of Application 申請摘要

(Please provide details in both English and Chinese as far as possible. This part will be circulated to relevant consultees, uploaded to the Town Planning Board's Website for browsing and free downloading by the public and available at the Planning Enquiry Counters of the Planning Department for general information.)
(請盡量以英文及中文填寫。此部分將會發送予相關諮詢人士、上載至城市規劃委員會網頁供公眾免費瀏覽及下載及於規劃署規劃資料查詢處供一般參閱。)

Application No. 申請編號	(For Official Use Only) (請勿填寫此欄)
Location/address 位置/地址	LOT NOS. 2942S.ARP(PART), 2952 AND 2953 IN D.D. 104, MAI PO, YUEN LONG, NEW TERRITORIES
Site area 地盤面積	1,583 sq. m 平方米 <input checked="" type="checkbox"/> About 約 (includes Government land of 包括政府土地 sq. m 平方米 <input type="checkbox"/> About 約)
Plan 圖則	APPROVED MAI PO AND FAIRVIEW PARK OUTLINE ZONING PLAN NO. S/YL- ST/8
Zoning 地帶	RECREATION
Type of Application 申請類別	<input checked="" type="checkbox"/> Temporary Use/Development in Rural Areas or Regulated Areas for a Period of 位於鄉郊地區或受規管地區的臨時用途/發展為期 <input checked="" type="checkbox"/> Year(s) 年 <u>3</u> <input type="checkbox"/> Month(s) 月 _____ <input type="checkbox"/> Renewal of Planning Approval for Temporary Use/Development in Rural Areas or Regulated Areas for a Period of 位於鄉郊地區或受規管地區臨時用途/發展的規劃許可續期為期 <input type="checkbox"/> Year(s) 年 _____ <input type="checkbox"/> Month(s) 月 _____
Applied use/ development 申請用途/發展	TEMPORARY SHOP AND SERVICES (SALE OF ELECTRIC GOODS VEHICLES) AND ELECTRIC GOODS VEHICLE CHARGING STATION) FOR A PERIOD OF 3 YEARS

(i) Gross floor area and/or plot ratio 總樓面面積及／或地積比率		sq.m 平方米	Plot Ratio 地積比率
	Domestic 住用	<input type="checkbox"/> About 約 <input type="checkbox"/> Not more than 不多於	<input type="checkbox"/> About 約 <input type="checkbox"/> Not more than 不多於
	Non-domestic 非住用	271.28 <input checked="" type="checkbox"/> About 約 <input type="checkbox"/> Not more than 不多於	0.17 <input checked="" type="checkbox"/> About 約 <input type="checkbox"/> Not more than 不多於
(ii) No. of blocks 幢數	Domestic 住用		
	Non-domestic 非住用	3	
(iii) Building height/No. of storeys 建築物高度／層數	Domestic 住用	m 米 <input type="checkbox"/> (Not more than 不多於)	
		Storeys(s) 層 <input type="checkbox"/> (Not more than 不多於)	
	Non-domestic 非住用	2.6 to 5 m 米 <input type="checkbox"/> (Not more than 不多於)	
		1 Storeys(s) 層 <input checked="" type="checkbox"/> (Not more than 不多於)	
(iv) Site coverage 上蓋面積	17.13 % <input checked="" type="checkbox"/> About 約		
(v) No. of parking spaces and loading / unloading spaces 停車位及上落客貨車位數目	Total no. of vehicle parking spaces 停車位總數		8
	Private Car Parking Spaces 私家車車位		3
	Motorcycle Parking Spaces 電單車車位		NIL
	Light Goods Vehicle Parking Spaces 輕型貨車泊車位		NIL
	Medium Goods Vehicle Parking Spaces 中型貨車泊車位		NIL
	Heavy Goods Vehicle Parking Spaces 重型貨車泊車位		NIL
	Others (Please Specify) 其他 (請列明)		NIL
	HGV/MGV CHARGING SPACES		5
	Total no. of vehicle loading/unloading bays/lay-bys 上落客貨車位／停車處總數		2
	Taxi Spaces 的士車位		NIL
	Coach Spaces 旅遊巴車位		NIL
	Light Goods Vehicle Spaces 輕型貨車車位		NIL
	Medium Goods Vehicle Spaces 中型貨車車位		NIL
	Heavy Goods Vehicle Spaces 重型貨車車位		NIL
	Others (Please Specify) 其他 (請列明)		NIL
	HGV/MGV WAITING SPACES		2

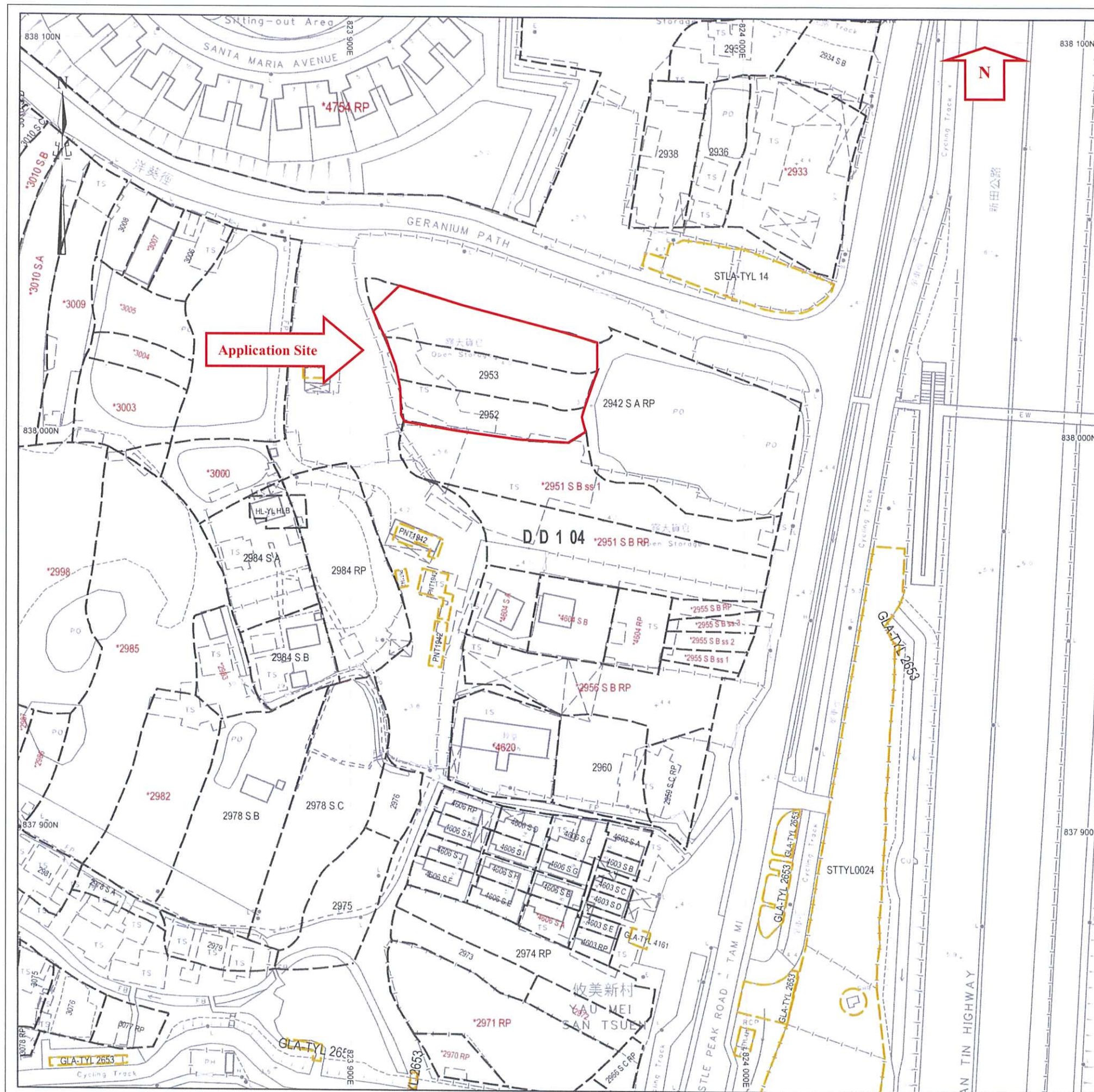

地段索引圖 LOT INDEX PLAN

摘要說明：本地段索引圖在其背景的地形圖上標示了各種永久和短期持有的土地的圖像界線。這些土地包括私人地段、政府撥地、短期租約批地，以及其他作核准用途的土地。請注意：(1)本索引圖上的資料會被不時更新而不作事先通知；(2)索引圖的更新或會延後於有關資料的實際變更；以及(3)本索引圖中顯示的界線僅供識別之用，資料是否準確可靠，應徵詢專業土地測量師的意見。
免責說明：如因使用本地段索引圖，或因所依據的本索引圖資料出錯、遺漏、過時或有誤差而引致任何損失或損害，政府概不承擔任何法律責任。

Explanatory notes : This plan shows the graphical boundaries of different kinds of permanent and temporary land holdings with the topographic map in the backdrop. The land holdings as shown may include private lots, government land allocations, short term tenancies and other permitted uses of land. It must be noted that: (1) the information shown on this plan is subject to update without prior notification; (2) there may be time lag between an update and the related changes taken place; and (3) the graphical boundaries as shown are for identification purpose only and interpretation of their accuracy and reliability requires the advice from professional land surveyor.
Disclaimer : The Government shall not be responsible for any loss or damage howsoever arising from the use of this plan or in reliance upon its correctness, completeness, timeliness or accuracy.



地政總署測繪處
Survey and Mapping Office
Lands Department

香港特別行政區政府 — 版權所有
© Copyright reserved — Hong Kong SAR Government

比例尺 SCALE 1:1 000
metres 10 0 10 20 30 40 50 metres

For Identification Only

Locality :

Lot Index Plan No. : ags_S00000121021_0001

District Survey Office : Lands Information Center

Date :08-Dec-2023

Reference No. : 2-SE-16B,2-SE-17A

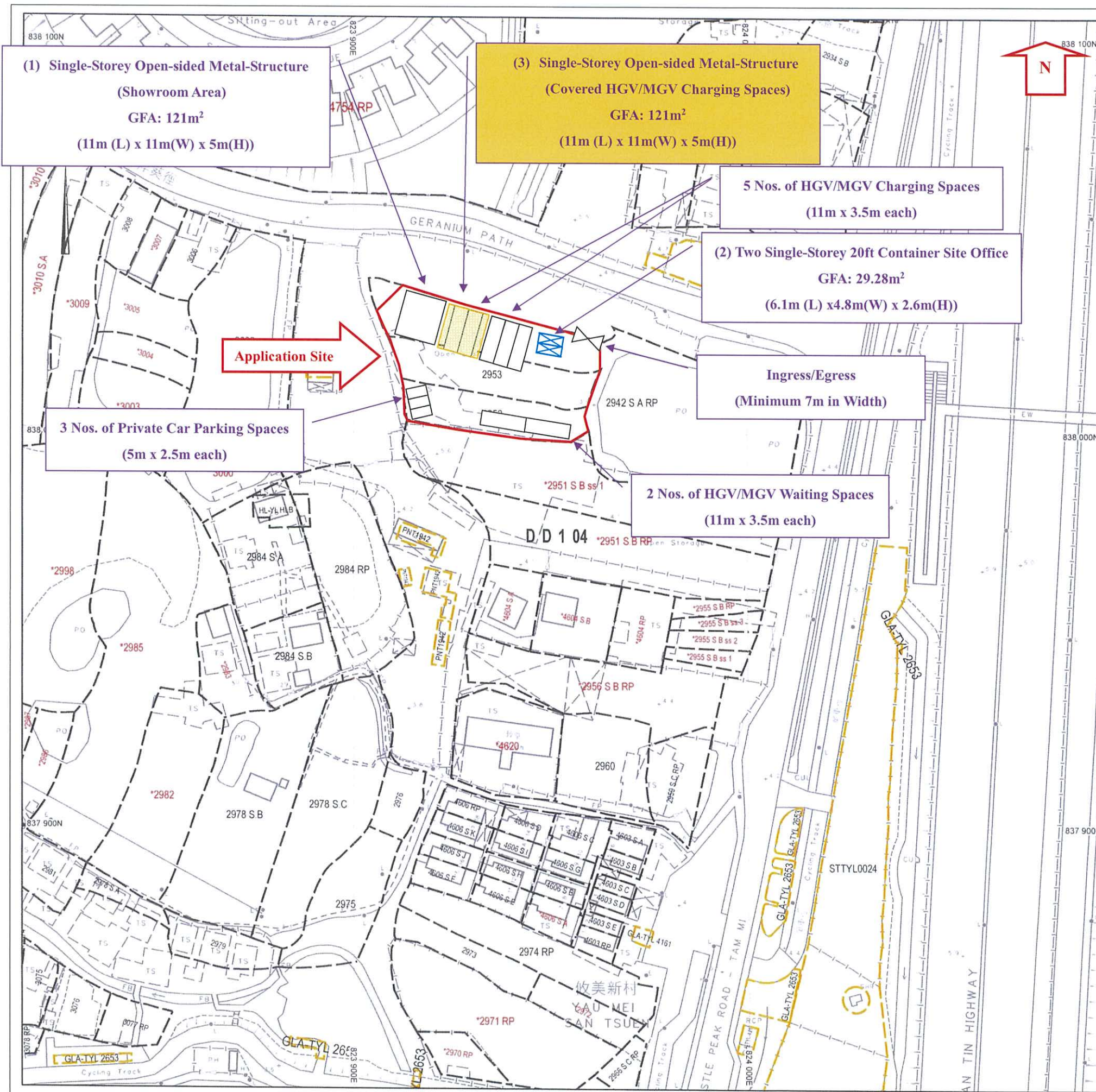

地段索引圖 LOT INDEX PLAN

摘要說明：本地段索引圖在其背景的地形圖上標示了各種永久和短期持有的土地的圖像界線。這些土地包括私人地段、政府撥地、短期租約批地，以及其他作核准用途的土地。請注意：(1)本索引圖上的資料會被不時更新而不作事先通知；(2)索引圖的更新或會延後於有關資料的實際變更；以及(3)本索引圖中顯示的界線僅供識別之用，資料是否準確可靠，應徵詢專業土地測量師的意見。
免責說明：如因使用本地段索引圖，或因所依據的本索引圖資料出錯、遺漏、過時或有誤差而引致任何損失或損害，政府概不承擔任何法律責任。

Explanatory notes: This plan shows the graphical boundaries of different kinds of permanent and temporary land holdings with the topographic map in the backdrop. The land holdings as shown may include private lots, government land allocations, short term tenancies and other permitted uses of land. It must be noted that: (1) the information shown on this plan is subject to update without prior notification; (2) there may be time lag between an update and the related changes taken place; and (3) the graphical boundaries as shown are for identification purpose only and interpretation of their accuracy and reliability requires the advice from professional land surveyor.
Disclaimer: The Government shall not be responsible for any loss or damage howsoever arising from the use of this plan or in reliance upon its correctness, completeness, timeliness or accuracy.



地政總署測繪處
Survey and Mapping Office
Lands Department

香港特別行政區政府 — 版權所有
© Copyright reserved — Hong Kong SAR Government

比例尺 SCALE 1:1000
metres 10 0 10 20 30 40 50 metres

For Identification Only

Locality :

Lot Index Plan No. : ags_S00000121021_0001

District Survey Office : Lands Information Center

Date :08-Dec-2023

Reference No. : 2-SE-16B,2-SE-17A

Our Ref.: YL/TPN/2592A/L03

19 February 2025

Secretary
Town Planning Board
15/F, North Point Government Offices
333 Java Road, North Point
Hong Kong

By Post and Email

Dear Sir/Madam,

**Planning Application For
Proposed Temporary Shop and Services (Sale of Electric Goods Vehicles) and
Electric Goods Vehicle Charging Station
for a Period of Three Years
Lot Nos. 2942sARP(Part), 2952 and 2953 in D.D. 104
Mai Po, Yuen Long, New Territories
(Planning Application No. A/YL-MP/387)**

We refer to the captioned planning application.

We would like to provide herewith a revised proposed layout plan for submission. Should you have any queries, please feel free to call our Mr. Anson Lee at 2301-1869. Thank you for your attention.

Yours faithfully,
For and on behalf of
LANBASE SURVEYORS LIMITED

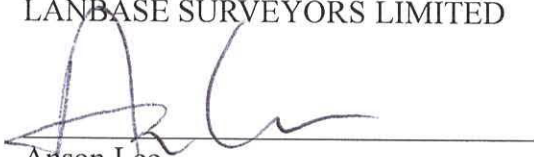
Anson Lee
Encl.
RK/AL

c.c.

DPO / FSS & YLE

(Attn.: Mr. Louis Cheung

By Email)



ISO 9001 : 2015
Certificate No.: CC 1687
(Valuation & Land Administration)



ISO 9001 : 2015
Certificate No.: CC 1687
(Valuation & Land Administration)

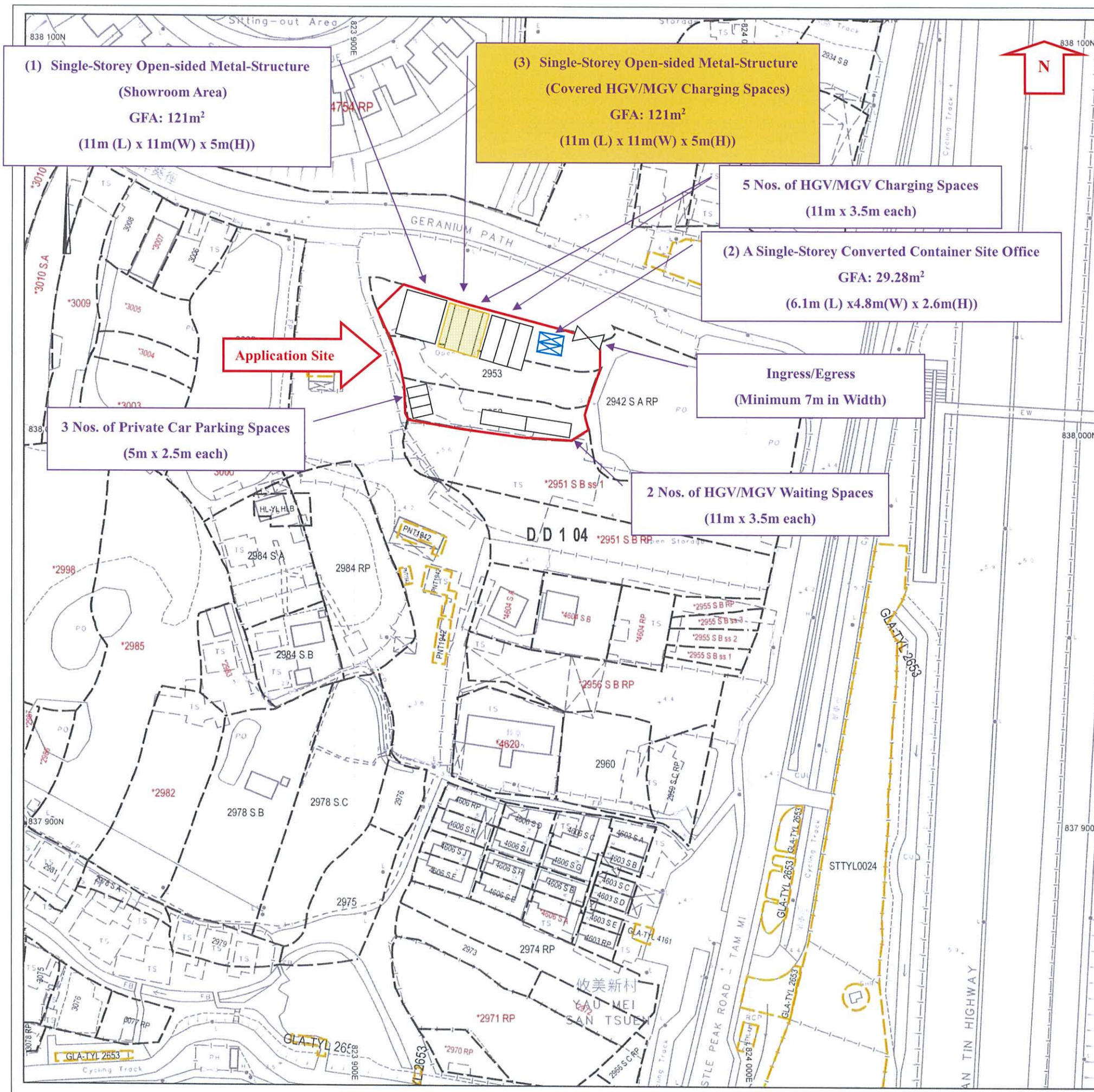

地段索引圖 LOT INDEX PLAN

摘要說明：本地段索引圖在其背景的地形圖上標示了各種永久和短期持有的土地的圖像界線。這些土地包括私人地段、政府撥地、短期租約批地，以及其他作核准用途的土地。請注意：(1)本索引圖上的資料會被不時更新而不作事先通知；(2)索引圖的更新或會延後於有關資料的實際變更；以及(3)本索引圖中顯示的界線僅供識別之用，資料是否準確可靠，應徵詢專業土地測量師的意見。
免責說明：如因使用本地段索引圖，或因所依據的本索引圖資料出錯、遺漏、過時或有誤差而引致任何損失或損害，政府概不承擔任何法律責任。

Explanatory notes: This plan shows the graphical boundaries of different kinds of permanent and temporary land holdings with the topographic map in the backdrop. The land holdings as shown may include private lots, government land allocations, short term tenancies and other permitted uses of land. It must be noted that: (1) the information shown on this plan is subject to update without prior notification; (2) there may be time lag between an update and the related changes taken place; and (3) the graphical boundaries as shown are for identification purpose only and interpretation of their accuracy and reliability requires the advice from professional land surveyor.
Disclaimer: The Government shall not be responsible for any loss or damage howsoever arising from the use of this plan or in reliance upon its correctness, completeness, timeliness or accuracy.



地政總署測繪處
Survey and Mapping Office
Lands Department

香港特別行政區政府 — 版權所有
© Copyright reserved — Hong Kong SAR Government

比例尺 SCALE 1:1 000
metres 10 0 10 20 30 40 50 metres

For Identification Only

Locality :

Lot Index Plan No. : ags_S00000121021_0001

District Survey Office : Lands Information Center

Date :08-Dec-2023

Reference No. : 2-SE-16B,2-SE-17A

6. Type(s) of Application 申請類別	
(A) Temporary Use/Development of Land and/or Building Not Exceeding 3 Years in Rural Areas or Regulated Areas 位於鄉郊地區或受規管地區土地上及/或建築物內進行為期不超過三年的臨時用途/發展 (For Renewal of Permission for Temporary Use or Development in Rural Areas or Regulated Areas, please proceed to Part (B)) (如屬位於鄉郊地區或受規管地區臨時用途/發展的規劃許可續期，請填寫(B)部分)	
(a) Proposed use(s)/development 擬議用途/發展	TEMPORARY SHOP AND SERVICES (SALE OF ELECTRIC GOODS VEHICLES) AND ELECTRIC GOODS VEHICLE CHARGING STATION (Please illustrate the details of the proposal on a layout plan) (請用平面圖說明擬議詳情)
(b) Effective period of permission applied for 申請的許可有效期	<input checked="" type="checkbox"/> year(s) 年 3 <input type="checkbox"/> month(s) 個月
(c) Development Schedule 發展細節表	
Proposed uncovered land area 擬議露天土地面積 1,311.72sq.m <input checked="" type="checkbox"/> About 約
Proposed covered land area 擬議有上蓋土地面積 271.28sq.m <input checked="" type="checkbox"/> About 約
Proposed number of buildings/structures 擬議建築物/構築物數目 3
Proposed domestic floor area 擬議住用樓面面積 NILsq.m <input type="checkbox"/> About 約
Proposed non-domestic floor area 擬議非住用樓面面積 271.28sq.m <input checked="" type="checkbox"/> About 約
Proposed gross floor area 擬議總樓面面積 271.28sq.m <input checked="" type="checkbox"/> About 約
Proposed height and use(s) of different floors of buildings/structures (if applicable) 建築物/構築物的擬議高度及不同樓層的擬議用途 (如適用) (Please use separate sheets if the space below is insufficient) (如以下空間不足，請另頁說明) STRUCTURE 1: SHOWROOM AREA (5M IN HEIGHT)(1-STOREY) STRUCTURE 2: SITE OFFICE (2.6M IN HEIGHT)(1-STOREY) STRUCTURE 3: COVERED CHARGING AREA (5M IN HEIGHT)(1-STOREY)	
Proposed number of car parking spaces by types 不同種類停車位的擬議數目	
Private Car Parking Spaces 私家車車位 3
Motorcycle Parking Spaces 電單車車位 NIL
Light Goods Vehicle Parking Spaces 輕型貨車泊車位 NIL
Medium Goods Vehicle Parking Spaces 中型貨車泊車位 NIL
Heavy Goods Vehicle Parking Spaces 重型貨車泊車位 NIL
Others (Please Specify) 其他 (請列明) 5
(HGV/MGV CHARGING SPACES)	
Proposed number of loading/unloading spaces 上落客貨車位的擬議數目	
Taxi Spaces 的士車位 NIL
Coach Spaces 旅遊巴車位 NIL
Light Goods Vehicle Spaces 輕型貨車車位 NIL
Medium Goods Vehicle Spaces 中型貨車車位 NIL
Heavy Goods Vehicle Spaces 重型貨車車位 NIL
Others (Please Specify) 其他 (請列明) 2
(HGV/MGV WAITING SPACES)	

Gist of Application 申請摘要

(Please provide details in both English and Chinese as far as possible. This part will be circulated to relevant consultees, uploaded to the Town Planning Board's Website for browsing and free downloading by the public and available at the Planning Enquiry Counters of the Planning Department for general information.)
(請盡量以英文及中文填寫。此部分將會發送予相關諮詢人士、上載至城市規劃委員會網頁供公眾免費瀏覽及下載及於規劃署規劃資料查詢處供一般參閱。)

Application No. 申請編號	(For Official Use Only) (請勿填寫此欄)	
Location/address 位置/地址	LOT NOS. 2942S.ARP(PART), 2952 AND 2953 IN D.D. 104, MAI PO, YUEN LONG, NEW TERRITORIES	
Site area 地盤面積	1,583 sq. m 平方米	<input checked="" type="checkbox"/> About 約 (includes Government land of 包括政府土地 sq. m 平方米 <input type="checkbox"/> About 約)
Plan 圖則	APPROVED MAI PO AND FAIRVIEW PARK OUTLINE ZONING PLAN NO. S/YL-MP/8	
Zoning 地帶	RECREATION	
Type of Application 申請類別	<input checked="" type="checkbox"/> Temporary Use/Development in Rural Areas or Regulated Areas for a Period of 位於鄉郊地區或受規管地區的臨時用途/發展為期 <input checked="" type="checkbox"/> Year(s) 年 <u>3</u> <input type="checkbox"/> Month(s) 月 _____ <input type="checkbox"/> Renewal of Planning Approval for Temporary Use/Development in Rural Areas or Regulated Areas for a Period of 位於鄉郊地區或受規管地區臨時用途/發展的規劃許可續期為期 <input type="checkbox"/> Year(s) 年 _____ <input type="checkbox"/> Month(s) 月 _____	
Applied use/ development 申請用途/發展	TEMPORARY SHOP AND SERVICES (SALE OF ELECTRIC GOODS VEHICLES) AND ELECTRIC GOODS VEHICLE CHARGING STATION) FOR A PERIOD OF 3 YEARS	