

CKM Asia Limited

From: Chi Kong LEUNG <chikongleung@td.gov.hk>
Sent: Tuesday, 3 September, 2024 12:28
To: CKM Asia
Cc: Chiyu Wu; Mark YK WONG; Ming Yip TSE
Subject: RE: SS M518: Light Public Housing at Yau Pok Road, Yuen Long - Design of PTT in Zone 1 and Zone 2
Attachments: RtoC (2024 05)_PTT_YPR_CKM_R3.pdf; Fig YPR_PTT1~2 RevD.pdf; Fig YPR_VIS1~2 RevC.pdf; App A - Swept Path RevD.pdf

Dear Mr. Tang,

I refer to your email dated 26 July 2024 regarding the design of PTT in Zone 1 and Zone 2 of the Yau Pok Road LPH Site and have no objection in-principle to the proposed design of PTT.

Please incorporate the latest PTT layout into the GBP submission for our final review.

Thank you.

Regards,
Donald Leung
E/B3, TE/NTW
Transport Department
Tel. 2399 2778

From: CKM Asia [REDACTED]
To: Chi Kong LEUNG <chikon_leun@td.gov.hk>, Mark YK WONG <markykwong@td.gov.hk>
Cc: Chiyu Wu [REDACTED]
Date: 26/07/2024 05:53 PM
Subject: RE: SS M518: Light Public Housing at Yau Pok Road, Yuen Long - Design of PTT in Zone 1 and Zone 2

Attn: Transport Department – Mr Donald Leung (Engr / Boundary 3)

Dear Mr Leung,

We refer to your email of 22nd July 2024 regarding the design of public transport termini (PTT) in Zone 1 and Zone 2 of the **Yau Pok Road (YPR) Site**.

The revised design of PTT together with the full set of response-to-comment table are attached for final review. Should you have no further comment, the Project Architect will incorporate the revised layout of PTT into the coming GBP re-submission.

We look forward to your reply at the earliest convenience.

Thank you for your attention.

Regards,

Contract No. SS M518 Design and Construction of Light Public Housing at Yau Pok Road, Yuen Long, at Tuen Mun Area 3A and at Choi Hing Road, Ngau Tau Kok (General Building Plan Submission for Yau Pok Road Site)

Item	Comments from Transport Department	Responses
	Email dated 22th July 2024:	
i.	Please find my comments on the traffic aids of the PTT in Yau Pok Road LPH site for your follow up action.	Figures YPR/PTT1 and PTT2 have been revised as per the following comments:
	<u>Zone 1</u>	
	1. Please review the necessity of TS286 and TS712.	TS286 and TS712 have been removed.
	2. Please review the necessity of this road marking for the bus stacking space.	Road markings will not be provided for bus stacking space. The dotted lines are for indication only.
	3. Please consider to add TS102 & TS107 on right hand side of egress and remove TS182.	TS102 and TS107 have been provided, and TS182 is removed.
	4. Please consider to adjust road marking for the lay-by.	The road markings for the general lay-by have been updated.
	<u>Zone 2</u>	
	5. Please consider adding yellow strip markings.	Yellow strip markings have been provided.
	6. Please review the necessity of this road marking for the bus stacking space.	Road markings will not be provided for bus stacking space. The dotted lines are for indication only.
	7. Please consider to adjust road marking for the lay-by	The road markings for the general lay-by have been updated.
	8. Please consider to add TS102 & TS107 on right hand side of egress	Additional TS102 and TS107 have been provided.
	9. Please review the necessity of TS286 and TS712	TS286 and TS712 have been removed.
	10. Please review the road marking according to TPDM Vol.3 chapter 5.3 clause 5.3.2.22.	The road markings have been revised as per Volume 3 Chapter 5.3 Clause 5.3.2.22 of TPDM
	11. Please consider to add road marking TS1135 and TS1136 for the ped. crossing and remove TS182	RM1135 and 1136 have been provided, and TS182 is removed.
ii.	For the internal driveway within the site, noted it would be share-used between pedestrian and vehicles, you are advised to install TS460 in both Sites to warn the motorists the existence of pedestrian on the internal driveway.	A pair of TS460 will be erected at the main gate to the housing blocks. Please refer to revised Figures YPR/PTT1 and PTT2.
iii.	You are also reminded to incorporate all of my previous comments on the GBP / PTT and submit a revised GBP for our final review.	Noted.
	Email dated 5th July 2024:	
	I refer to your preceding email regarding the revised layout of PTT in Yau Pok Road LPH Site, in generally, we have no major comments on the revised PTT layout. Nonetheless, please find our minor comments	Noted.

Contract No. SS M518 Design and Construction of Light Public Housing at Yau Pok Road, Yuen Long, at Tuen Mun Area 3A and at Choi Hing Road, Ngau Tau Kok (General Building Plan Submission for Yau Pok Road Site)

Item	Comments from Transport Department	Responses
	as follows and supplement with RtoC table and revised layout for our final review.	
1.	For the layout of Zone 2 PTT, please provide TS115 for each pair of the give way line.	For the PTT in Zone 2, additional pairs of TS115 are provided for each give-way line as shown in revised Figure YPR/PTT2.
2.	Please provide necessary traffic signs and road markings, i.e. arrow road markings, to provide clear indication of the direction of traffic on the main driveway to the motorists.	Additional arrow markings are provided along the main driveway in Zone 1 and Zone 2. Please refer to revised Figures YPR/PTT1 and PTT2.
3.	For the layout of both Zone 1 and Zone 2 PTT, please advise necessary traffic management measures to handle the situation that taxis/PCs queuing back to the main driveway from the general lay-by. Especially for Zone 1, queuing back to the public road (i.e. Yau Pok Road) should not be allowed at all time.	To ensure no vehicle tailback from the general lay-by onto the public roads, the following traffic management measures will be undertaken: <ul style="list-style-type: none"> i. CCTVs will be installed at the general lay-bys so that the management office is aware of the real-time condition of pick-up / drop-off activities. ii. Once the general lay-bys are full, management guard will be deployed to instruct vehicles to conduct pick-up / drop-off activities at other remote locations, e.g. the turn-around area outside Refuse Collection Point in Zone 1 and the hammerhead outside the Sewage Pumping Station in Zone 2. iii. In case of illegal parking, the management guard will impound or remove any vehicle in accordance to Cap 374O Road Traffic (Parking on Private Roads) Regulations.
4.	Please indicate the location of the public transport ancillary facilities on the revised layout plan	The Project Architect will liaise with Transport Operations Division separately and indicate the provision of operators' facilities in the coming GBP submission.
5.	According to the agreed TTIA, the project proponent indicated that "simple shelters will be provided in all waiting platforms of the public transport termini" to safeguard these residents / commuters from weather conditions. The project proponent should be prepared to handle the relevant enquiries/complaints if no shelters could be provided.	Noted. The Project Architect will convey this comment to the Project Proponent.
6.	The management office of the above PTI (i.e. HD/HB or their contractors) should allow / approve the allocation of the boarding / alighting bays, stacking bays and placement of ancillary facilities to support the operation of the public transport services	Noted.





Contract No. SS M518 Design and Construction of Light Public Housing at Yau Pok Road, Yuen Long, at Tuen Mun Area 3A and at Choi Hing Road, Ngau Tau Kok (General Building Plan Submission for Yau Pok Road Site)

Item	Comments from Transport Department	Responses																																																																
	Emails dated 21st May and 20th June 2024:																																																																	
1.	<p><u>Transport Operation</u> In general, the GBP submission should tally with that of the agreed TTIA and that the proposed public transport facilities could support the operation of the proposed bus routes and GMB services.</p>	Noted. Further to the meeting with Transport Department on 20 th May 2024, the design of Public Transport Termini (PTT) in Zone 1 and Zone 2 is revised and shown in Figures YPR/PTT1 and PTT2.																																																																
2.	Specifically, a minimum of 2 franchised bus boarding/alighting bus-bays should be provided at each of the Southern and Northern sites	In the revised design, 2 franchised bus boarding / alighting bays are provided for each Zone.																																																																
3.	In addition to the above, a minimum of 4 stacking bays (as required by TPDM) should be provided	In the revised design, 2 bus stacking spaces are provided for each bus boarding / alighting bay. Hence, a total of 4 stacking spaces are provided for each Zone.																																																																
4.	Operator's facilities as according to requirement of TPDM (i.e. Regulator's kiosk, staff rest room and toilet facilities) should be provided	The Project Architect will liaise with Transport Operations Division separately on the provision of operators' facilities.																																																																
5.	With reference to the TTIA report and the updated layout of the terminus, please also evaluate if the passenger queuing areas are sufficient for each of the PT services/routes	<p>Based on the methodology found in the approved TIA report (TPB No. A/YL-MP/341), the Level-of-Service (LOS) for passenger queuing area is re-assessed and presented in Table 2.</p> <p>TABLE 2 LOS AT PASSENGER QUEUING AREA</p> <table border="1" data-bbox="1182 911 2074 1385"> <thead> <tr> <th>Bay</th> <th>Zone ⁽¹⁾</th> <th>Passenger Demand (ped/hr) ⁽²⁾</th> <th>Average Passenger Queue (ped/trip) ⁽³⁾</th> <th>Waiting Area (m²)</th> <th>Waiting Space (m²/ped)</th> <th>LOS</th> </tr> </thead> <tbody> <tr> <td rowspan="3">Bus (to Sheung Shui) ⁽³⁾</td> <td>1</td> <td>128</td> <td>43</td> <td>47</td> <td>1.09</td> <td>B</td> </tr> <tr> <td>2</td> <td>119</td> <td>40</td> <td>54</td> <td>1.35</td> <td>A</td> </tr> <tr> <td>Total</td> <td>247</td> <td></td> <td></td> <td></td> <td></td> </tr> <tr> <td rowspan="3">Bus (to Tai Lam Tunnel) ⁽⁴⁾</td> <td>1</td> <td>225</td> <td>45</td> <td>50</td> <td>1.11</td> <td>B</td> </tr> <tr> <td>2</td> <td>210</td> <td>42</td> <td>45</td> <td>1.07</td> <td>B</td> </tr> <tr> <td>Total</td> <td>435</td> <td></td> <td></td> <td></td> <td></td> </tr> <tr> <td rowspan="3">Minibus ⁽⁵⁾</td> <td>1</td> <td>160</td> <td>18</td> <td>50</td> <td>2.78</td> <td>A</td> </tr> <tr> <td>2</td> <td>150</td> <td>19</td> <td>43</td> <td>2.26</td> <td>A</td> </tr> <tr> <td>Total</td> <td>310</td> <td></td> <td></td> <td></td> <td></td> </tr> </tbody> </table>	Bay	Zone ⁽¹⁾	Passenger Demand (ped/hr) ⁽²⁾	Average Passenger Queue (ped/trip) ⁽³⁾	Waiting Area (m ²)	Waiting Space (m ² /ped)	LOS	Bus (to Sheung Shui) ⁽³⁾	1	128	43	47	1.09	B	2	119	40	54	1.35	A	Total	247					Bus (to Tai Lam Tunnel) ⁽⁴⁾	1	225	45	50	1.11	B	2	210	42	45	1.07	B	Total	435					Minibus ⁽⁵⁾	1	160	18	50	2.78	A	2	150	19	43	2.26	A	Total	310				
Bay	Zone ⁽¹⁾	Passenger Demand (ped/hr) ⁽²⁾	Average Passenger Queue (ped/trip) ⁽³⁾	Waiting Area (m ²)	Waiting Space (m ² /ped)	LOS																																																												
Bus (to Sheung Shui) ⁽³⁾	1	128	43	47	1.09	B																																																												
	2	119	40	54	1.35	A																																																												
	Total	247																																																																
Bus (to Tai Lam Tunnel) ⁽⁴⁾	1	225	45	50	1.11	B																																																												
	2	210	42	45	1.07	B																																																												
	Total	435																																																																
Minibus ⁽⁵⁾	1	160	18	50	2.78	A																																																												
	2	150	19	43	2.26	A																																																												
	Total	310																																																																

Contract No. SS M518 Design and Construction of Light Public Housing at Yau Pok Road, Yuen Long, at Tuen Mun Area 3A and at Choi Hing Road, Ngau Tau Kok (General Building Plan Submission for Yau Pok Road Site)		
Item	Comments from Transport Department	Responses
		<p>Note: ⁽¹⁾ Zones 1 and 2 will provide 1,114 and 1,042 units respectively ⁽²⁾ based on the passenger demand estimated in the approved TIA report, and demand for each zone is calculated pro-rata to the number of residential units ⁽³⁾ based on 3 bus trips from each Zone to Sheung Shui, as assumed in the approved TIA report ⁽⁴⁾ based on 5 bus trips from each Zone to Tai Lam Tunnel Interchange, as assumed in the approved TIA report ⁽⁵⁾ based on 9 and 8 minibus trips for Zones 1 and 2 respectively, as assumed in the approved TIA report</p> <p>Table 2 shows that all passenger queuing area would operate with LOS B or above, which is acceptable.</p>
6.	According to the earlier TTIA, the applicant/consultants has indicated "simple shelters will be provided in all waiting platforms of the public transport termini" to safeguard these residents/commuters from weather conditions. If no shelters were provided, it could attract dissatisfaction and complaints from the residents of Yau Pok Road LPH, which may create negative publicity for the LPH project and the project proponent should be prepared to handle the relevant enquiries/complaints.	Given that the YPR site is only for a 5-year life period, ArchSD has decided not to provide any shelter for the PTT.
1.	<u>Transport Engineering</u> Further to the update on the PTT layout, please provide updated swept path for all vehicles in PTT for comment.	The CAD-based swept path analysis programme, <i>Autodesk Vehicle Tracking</i> , was used to check the ease of manoeuvring of vehicles, and vehicles are found to have no manoeuvring problems. The swept path analysis drawings are found in Appendix A.
2.	It is noted that the RCP layout would be changed. Please update the GBP and provide updated swept path of the RCV for comment.	
3.	Please clearly indicate the dimensions of L/UL bay and width of EVA in GBP.	The Project Architect will indicate the dimensions of loading / unloading bays and width of EVA in the coming GBP submission.
4.	Please re-measure the waiting area in the passenger queuing area assessment and update the LOS accordingly	The waiting area and dimensions are indicated on Figures YPR/PTT1 and PTT2.
5.	Please indicate clearly the location of general layby in GBP.	The location of 18m general lay-by in Zone 1 and Zone 2 is indicated in Figures YPR/PTT1 and PTT2.
6.	Please provide sufficient bicycle rack near PTT in zone 1 to facilitate the cycle parking.	The Project Architect will revise the drawings for the coming GBP submission.

Contract No. SS M518 Design and Construction of Light Public Housing at Yau Pok Road, Yuen Long, at Tuen Mun Area 3A and at Choi Hing Road, Ngau Tau Kok (General Building Plan Submission for Yau Pok Road Site)		
Item	Comments from Transport Department	Responses
7.	The existing cycle track should be maintained as far as possible. Please update the pedestrian access in Zone 2 in the GBP (next to Fairview Park)	
8.	It is noted that the cycle track marking within EVA would be updated soon. Please provide us the latest GBP for comment.	
9.	To provide a better walking environment, it is suggested to divert cyclists within the site to use the secondary pedestrian access instead of the primary pedestrian access (next to vehicular access).	
10.	Please provide arrow road marking at the T-junction in PTT to provide clear indication on the direction of traffic.	Arrow markings are provided at T-junctions in the PTT. Please refer to Figures YPR/PTT1 and PTT2.
11.	Please update the road marking in PTT in both zone 1 and zone 2 by changing the give way line.	The give-way arrangement in PTT has been revised as shown in Figures YPR/PTT1 and PTT2.
12.	Please provide all the necessary prohibitory signs in PTT.	Prohibitory signs are provided in the PTT as shown in Figures YPR/PTT1 and PTT2.
13.	For Zone 2, it is suggested to provide a proper footpath for pedestrian to have an easy access to the bus stop.	As shown in Figure YPR/PTT2, continuous footpath is provided connecting to the main gate and the nearside bus bay.
14.	Please update the full set of road markings and traffic signs in the GBP accordingly.	Please refer to Figures YPR/PTT1 and PTT2.
15.	As the RCP is located next to the PTT for both Zone 1 and Zone 2 site, please show the PTT layout together with the swept path to demonstrate:- 1) There are sufficient spaces for the turning of RCV such that the operation of PT would not be affected; and 2) Sufficient sightline are provided to the motorists from safety point of view.	As shown in revised Figures SP/YPR/RCV/1 and 2, (1) Separate hammerhead is provided for 3-point turn of RCV. As RCV does not require to turn around at the main driveway, operation of PTT will not be affected; and (2) With reference to the TPDM, the visibility distance should be at least 50m for a road with speed limit of 50km/h. As shown in Figures YPR/VIS1 and VIS2, sufficient sightline could be provided when a RCV is leaving at T-junction.

ZONE 1:

-  traffic sign
-  road marking
-  bus boarding / alighting space (2 nos.)
-  bus stacking space (4 nos.) [indicative only, not road marking]
-  GMB / general lay-by

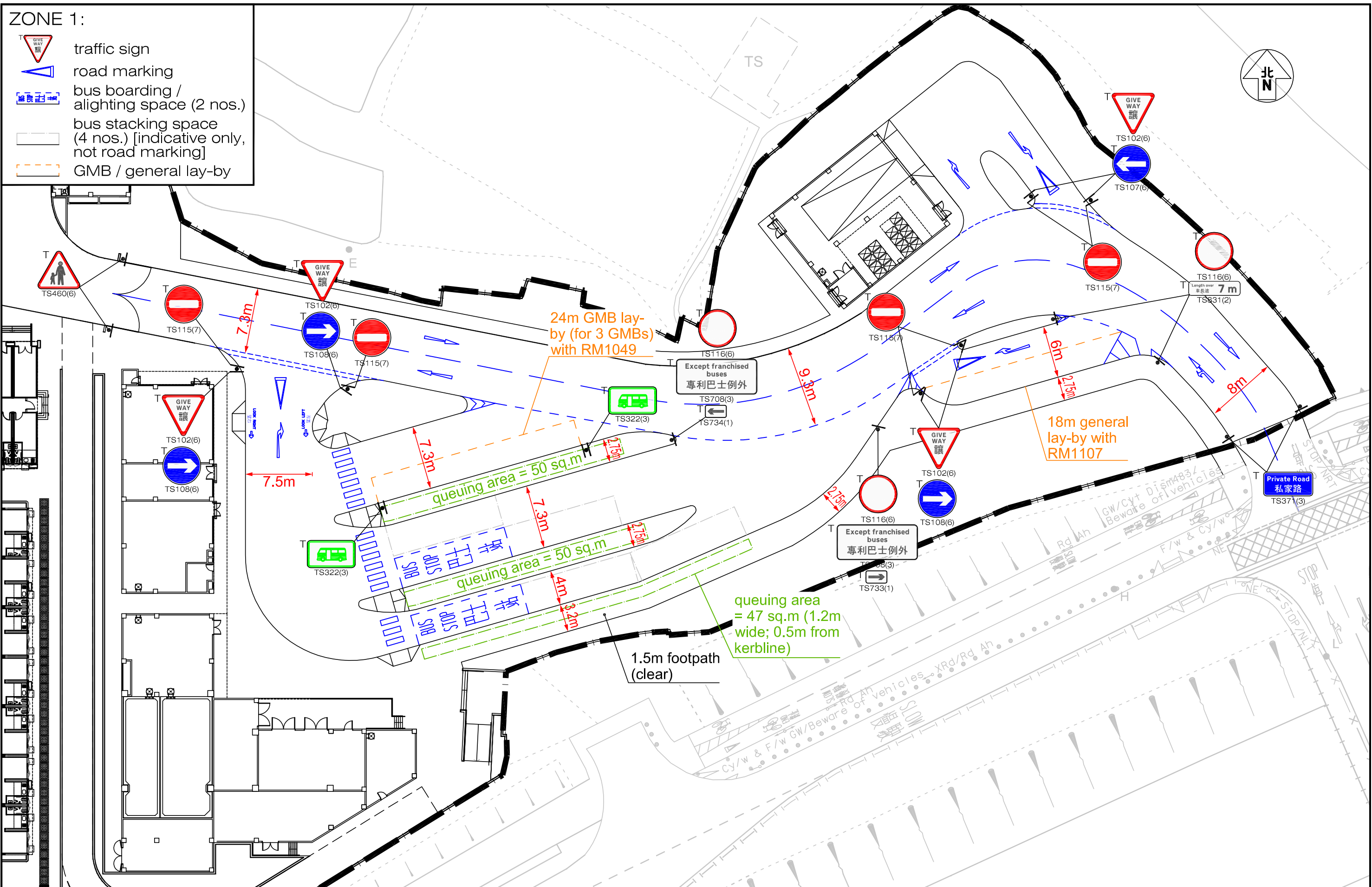

Project Title CONTRACT NO. SS M518 DESIGN AND CONSTRUCTION OF LIGHT PUBLIC HOUSING AT YAU POK ROAD, YUEN LONG, AT TUEN MUN AREA 3A AND AT CHOI HING ROAD, NGAU TAU KOK (DESIGN AND CONSTRUCTION STAGE)

Figure Title **YAU POK ROAD SITE (ZONE 1) - PUBLIC TRANSPORT TERMINUS ARRANGEMENT**

Figure No. **YPR/PTT1** Revision **D**

Designed by **THC** Drawn by **CCL** Checked by **KC**

Scale in A3 **1 : 400** Date **25 JUL 2024**

CKM Asia Limited
Traffic and Transportation Planning Consultants

T:\JOB\J7300-J7349\J7319\Fig YPR_PTT1 - 2 RevD.dwg

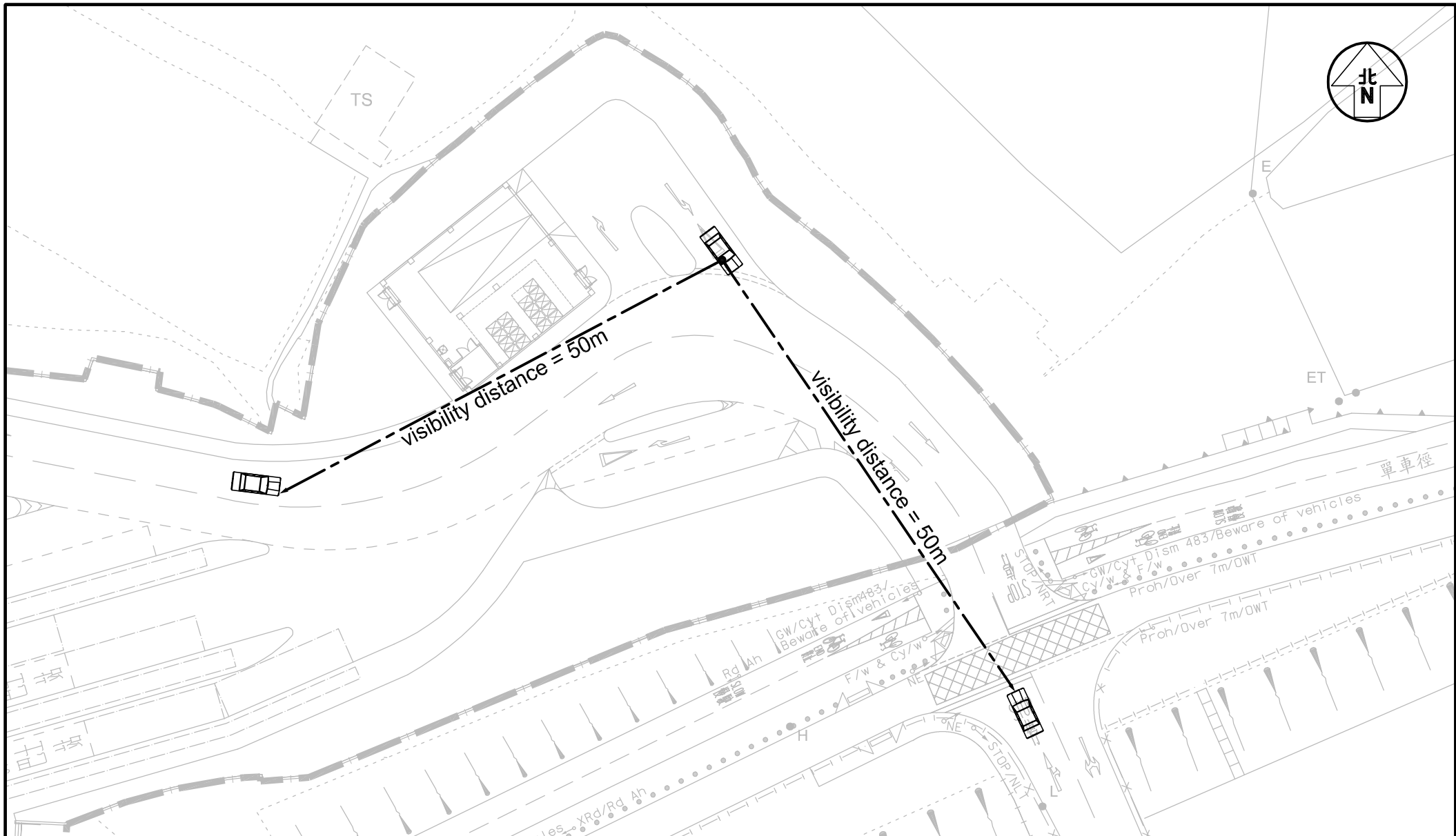

Project Title CONTRACT NO. SS M518 DESIGN AND CONSTRUCTION OF LIGHT PUBLIC HOUSING AT YAU POK ROAD, YUEN LONG, AT TUEN MUN AREA 3A AND AT CHOI HING ROAD, NGAU TAU KOK (DESIGN AND CONSTRUCTION STAGE) J7319

Figure No. YPR/VIS1

Revision C

CKM Asia Limited

Figure Title
**YAU POK ROAD SITE (ZONE 1) –
 VISIBILITY OF MOTORISTS LEAVING REFUSE COLLECTION POINT**

Designed by
 T H C

Drawn by
 C C L

Checked by
 K C

Scale in A4
 1 : 500

Date
 25 JUL 2024

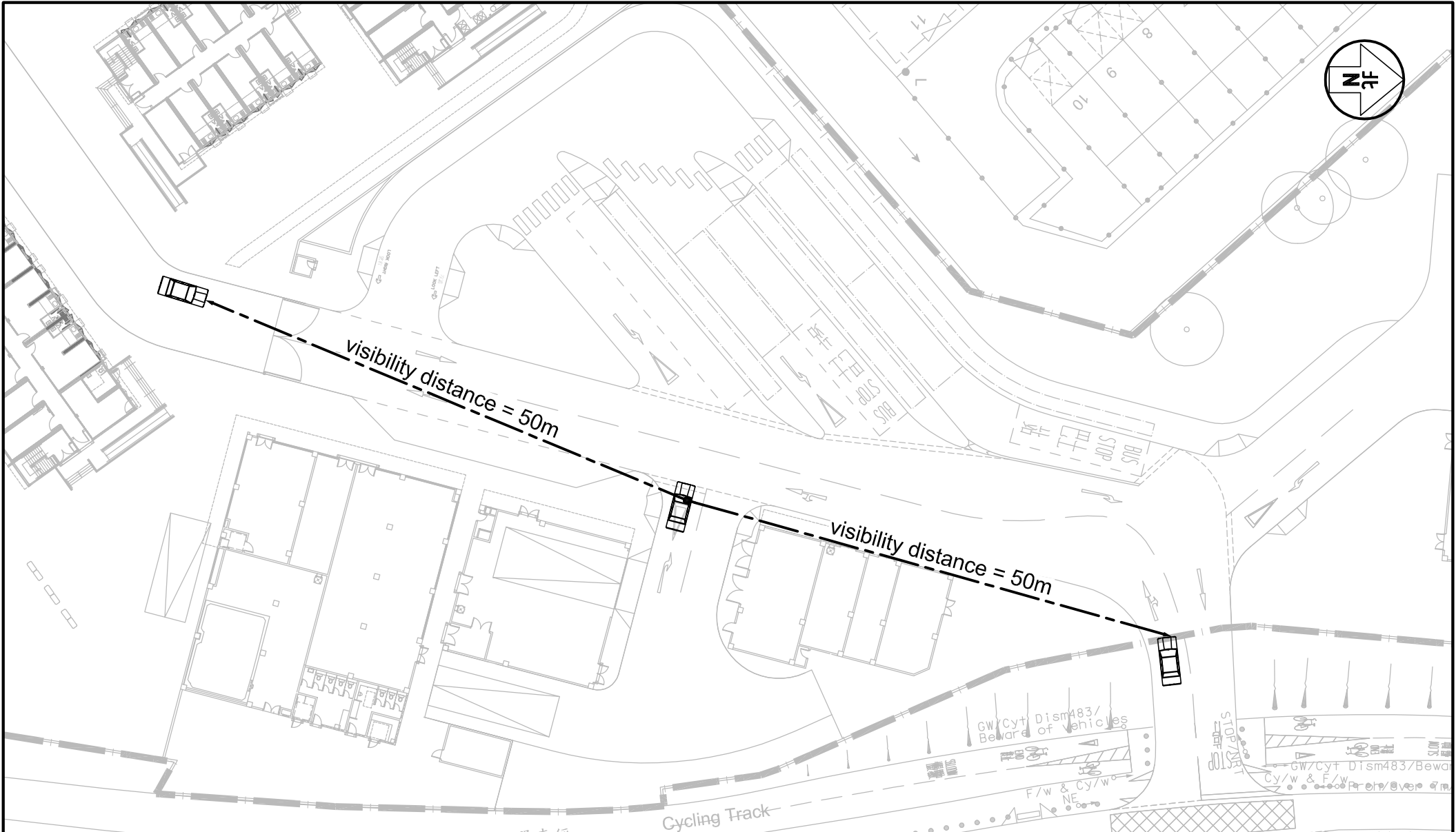

Project Title CONTRACT NO. SS M518 DESIGN AND CONSTRUCTION OF LIGHT PUBLIC HOUSING AT YAU POK ROAD, YUEN LONG, AT TUEN MUN AREA 3A AND AT CHOI HING ROAD, NGAU TAU KOK (DESIGN AND CONSTRUCTION STAGE) J7319

Figure No. YPR/VIS2

Revision C
CKM Asia Limited

Figure Title
**YAU POK ROAD SITE (ZONE 2) -
 VISIBILITY OF MOTORISTS LEAVING REFUSE COLLECTION POINT**

Designed by T H C	Drawn by C C L	Checked by K C
Scale in A4 1 : 500	Date 25 JUL 2024	

T:\JOB\J7300-J7349\J7319\Fig YPR_VIS1 -2 RevC.dwg

Appendix A – Swept Path Analysis



Project Title CONTRACT NO. SS M518 DESIGN AND CONSTRUCTION OF LIGHT PUBLIC HOUSING AT YAU POK ROAD, YUEN LONG, AT TUEN MUN AREA 3A AND AT CHOI HING ROAD, NGAU TAU KOK (DESIGN AND CONSTRUCTION STAGE) J7319

Figure No. SP/YPR/BUS/1 Revision D

CKM Asia Limited

Figure Title
YAU POK ROAD SITE (ZONE 1) – SWEEP PATH OF BUS ENTERING AND LEAVING ZONE 1

Designed by T H C	Drawn by C C L	Checked by K C
Scale in A4 1 : 500	Date 25 JUL 2024	

T:\JOB\J7300-J7349\J7319\Fig SP_YPR RevD.dwg



Project Title CONTRACT NO. SS M518 DESIGN AND CONSTRUCTION OF LIGHT PUBLIC HOUSING AT YAU POK ROAD, YUEN LONG, AT TUEN MUN AREA 3A AND AT CHOI HING ROAD, NGAU TAU KOK (DESIGN AND CONSTRUCTION STAGE) J7319

Figure No. SP/YPR/BUS/2 Revision D

CKM Asia Limited

Figure Title YAU POK ROAD SITE (ZONE 1) – SWEEP PATH OF BUS ENTERING AND LEAVING ZONE 1

Designed by T H C	Drawn by C C L	Checked by K C
Scale in A4 1 : 500	Date 25 JUL 2024	

T:\JOB\J7300-J7349\J7319\Fig SP_YPR RevD.dwg



Project Title CONTRACT NO. SS M518 DESIGN AND CONSTRUCTION OF LIGHT PUBLIC HOUSING AT YAU POK ROAD, YUEN LONG, AT TUEN MUN AREA 3A AND AT CHOI HING ROAD, NGAU TAU KOK (DESIGN AND CONSTRUCTION STAGE) J7319

Figure No. SP/YPR/BUS/3 Revision D

CKM Asia Limited

Figure Title
YAU POK ROAD SITE (ZONE 1) – SWEEP PATH OF BUS ENTERING AND LEAVING ZONE 1

Designed by T H C	Drawn by C C L	Checked by K C
Scale in A4 1 : 500	Date 25 JUL 2024	

T:\JOB\J7300-J7349\J7319\Fig SP_YPR RevD.dwg

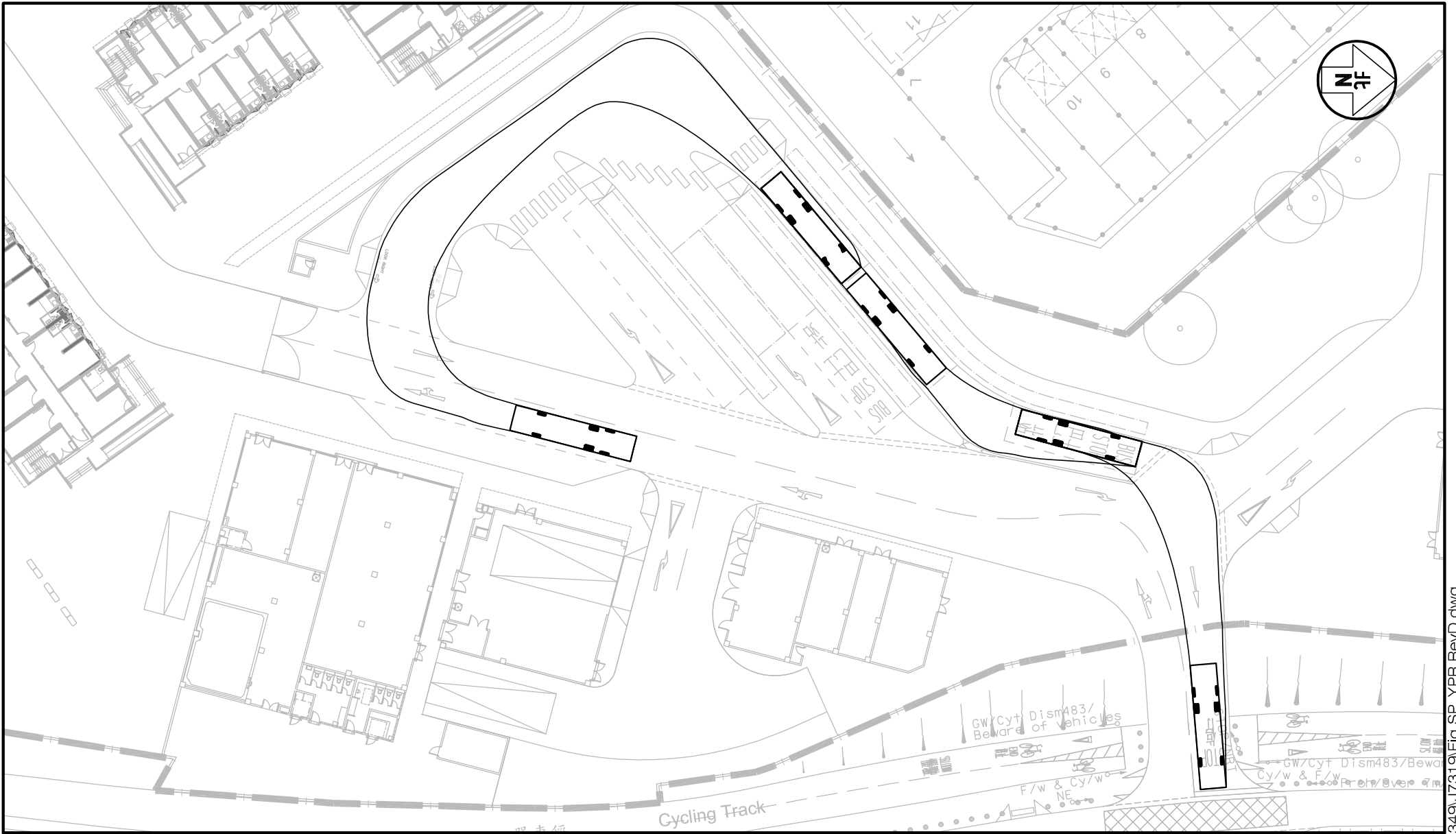

Project Title CONTRACT NO. SS M518 DESIGN AND CONSTRUCTION OF LIGHT PUBLIC HOUSING AT YAU POK ROAD, YUEN LONG, AT TUEN MUN AREA 3A AND AT CHOI HING ROAD, NGAU TAU KOK (DESIGN AND CONSTRUCTION STAGE) J7319

Figure No. SP/YPR/BUS/4

Revision D
CKM Asia Limited

Figure Title
YAU POK ROAD SITE (ZONE 2) – SWEEP PATH OF BUS ENTERING AND LEAVING ZONE 2

Designed by T H C	Drawn by C C L	Checked by K C
Scale in A4 1 : 500	Date 25 JUL 2024	

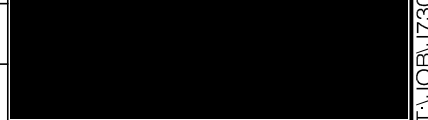

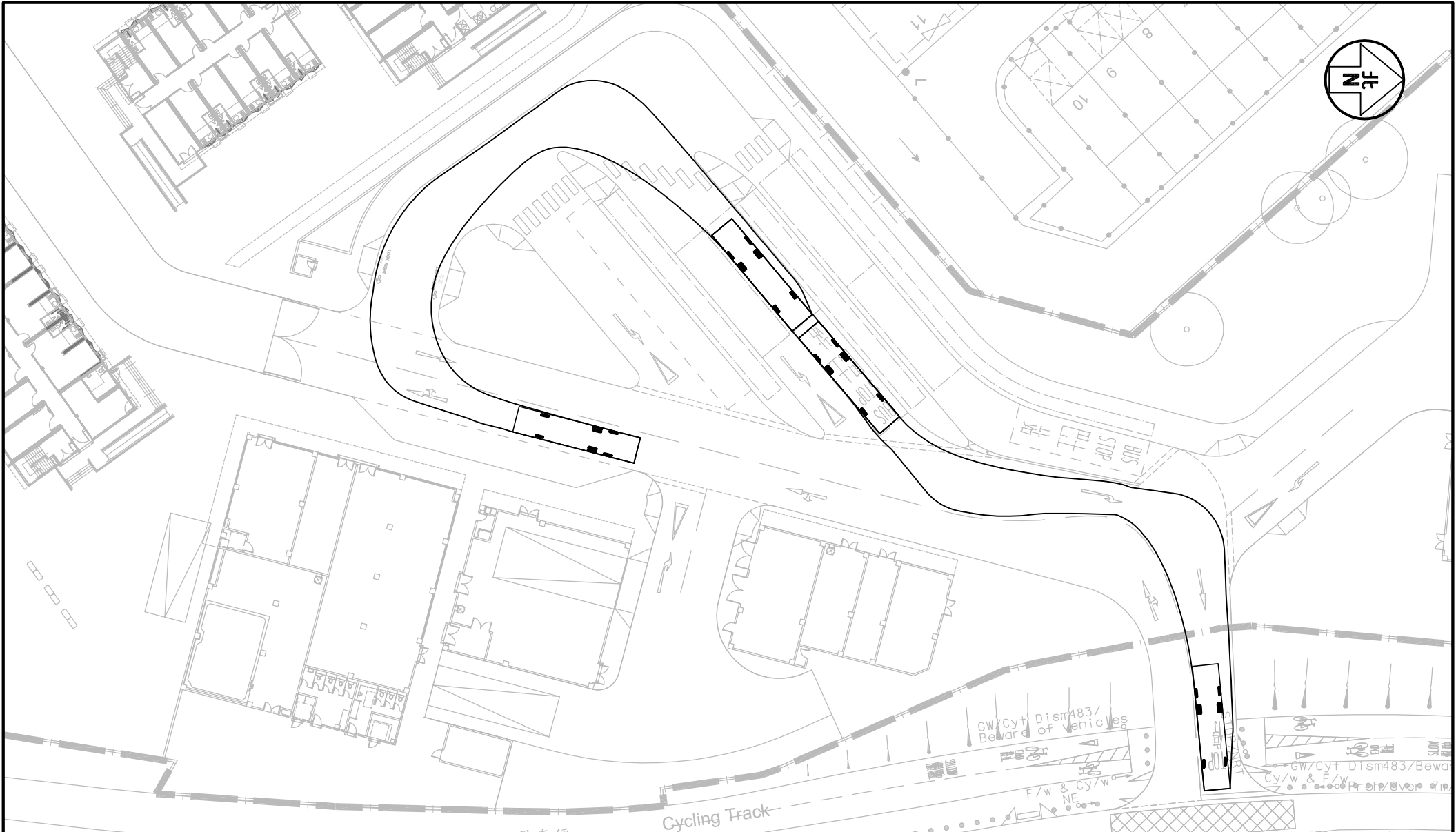

Project Title CONTRACT NO. SS M518 DESIGN AND CONSTRUCTION OF LIGHT PUBLIC HOUSING AT YAU POK ROAD, YUEN LONG, AT TUEN MUN AREA 3A AND AT CHOI HING ROAD, NGAU TAU KOK (DESIGN AND CONSTRUCTION STAGE) J7319

Figure No. SP/YPR/BUS/5
 Revision D

CKM Asia Limited

Figure Title
YAU POK ROAD SITE (ZONE 2) – SWEPT PATH OF BUS ENTERING AND LEAVING ZONE 2

Designed by T H C	Drawn by C C L	Checked by K C
Scale in A4 1 : 500	Date 25 JUL 2024	

T:\JOB\J7300-J7349\J7319\Fig SP_YPR RevD.dwg

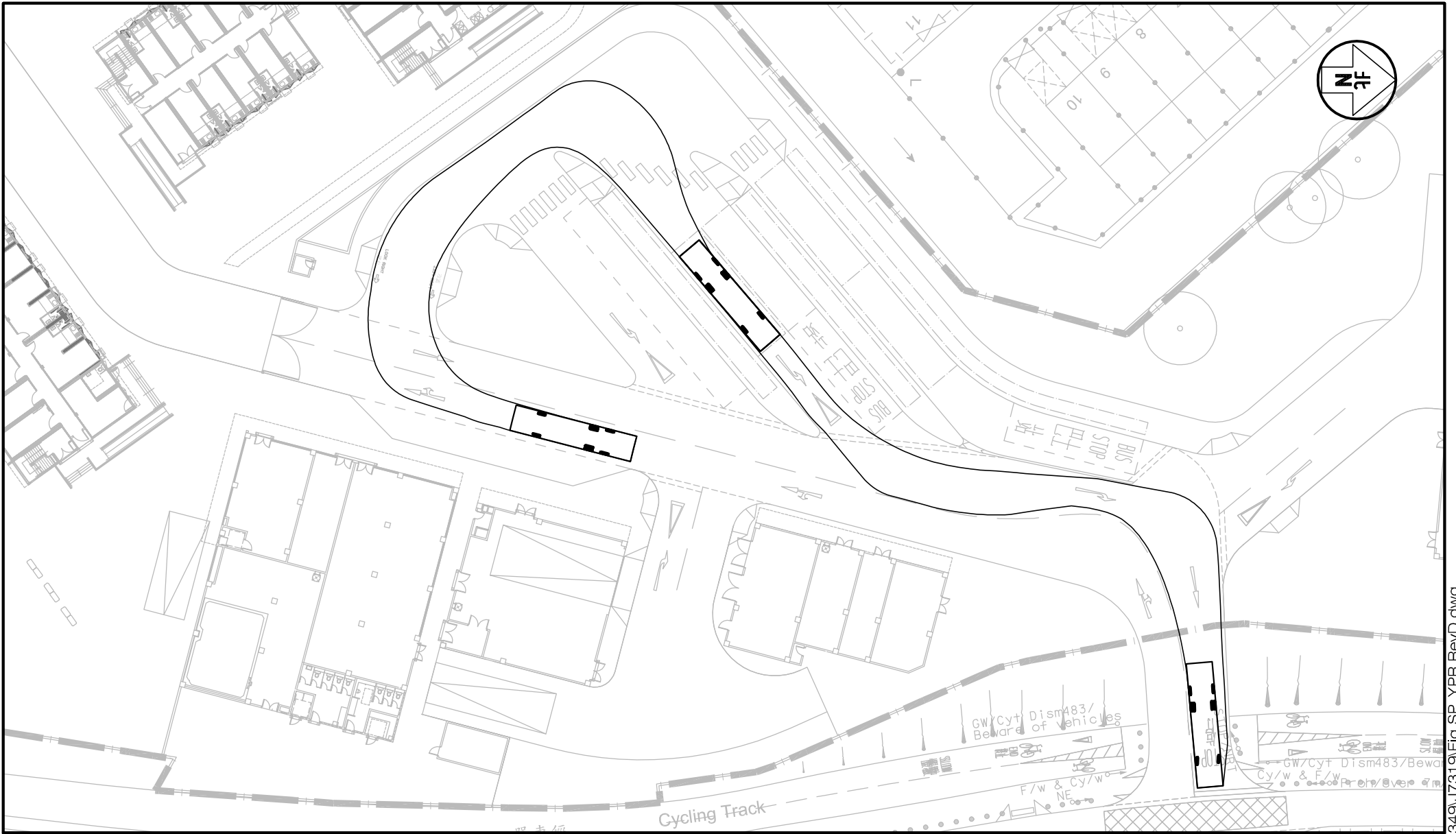

Project Title CONTRACT NO. SS M518 DESIGN AND CONSTRUCTION OF LIGHT PUBLIC HOUSING AT YAU POK ROAD, YUEN LONG, AT TUEN MUN AREA 3A AND AT CHOI HING ROAD, NGAU TAU KOK (DESIGN AND CONSTRUCTION STAGE) J7319

Figure No. SP/YPR/BUS/6 Revision D

CKM Asia Limited

Figure Title
YAU POK ROAD SITE (ZONE 2) – SWEEP PATH OF BUS ENTERING AND LEAVING ZONE 2

Designed by T H C	Drawn by C C L	Checked by K C
Scale in A4 1 : 500	Date 25 JUL 2024	

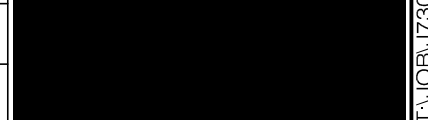

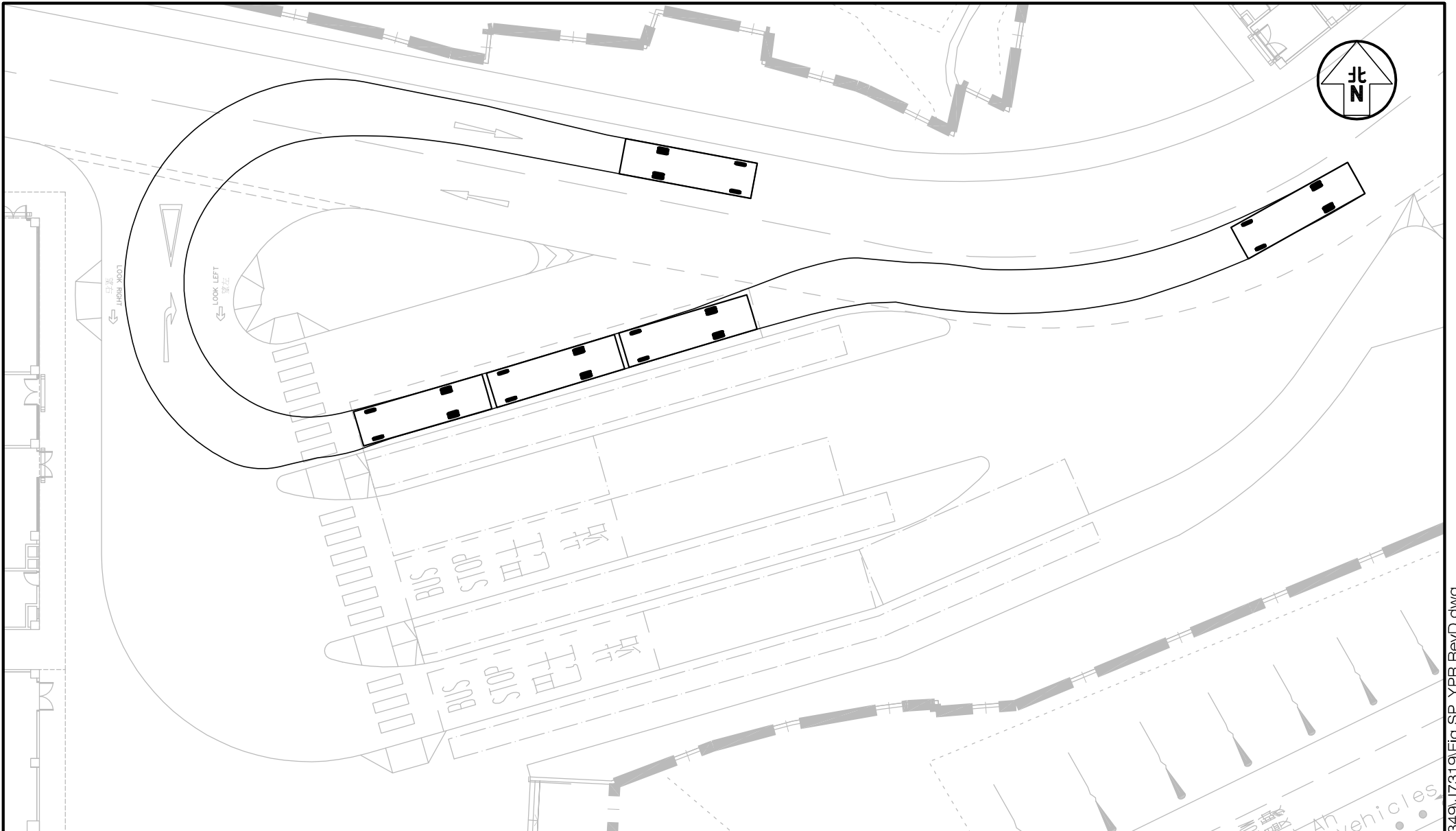

Project Title CONTRACT NO. SS M518 DESIGN AND CONSTRUCTION OF LIGHT PUBLIC HOUSING AT YAU POK ROAD, YUEN LONG, AT TUEN MUN AREA 3A AND AT CHOI HING ROAD, NGAU TAU KOK (DESIGN AND CONSTRUCTION STAGE) J7319

Figure No. SP/YPR/GMB/1
Revision D

CKM Asia Limited

Figure Title
YAU POK ROAD SITE (ZONE 1) – SWEEP PATH OF MINIBUS ENTERING AND LEAVING ZONE 1

Designed by T H C	Drawn by C C L	Checked by K C
Scale in A4 1 : 300	Date 25 JUL 2024	

T:\JOB\J7300-J7349\J7319\Fig SP_YPR RevD.dwg

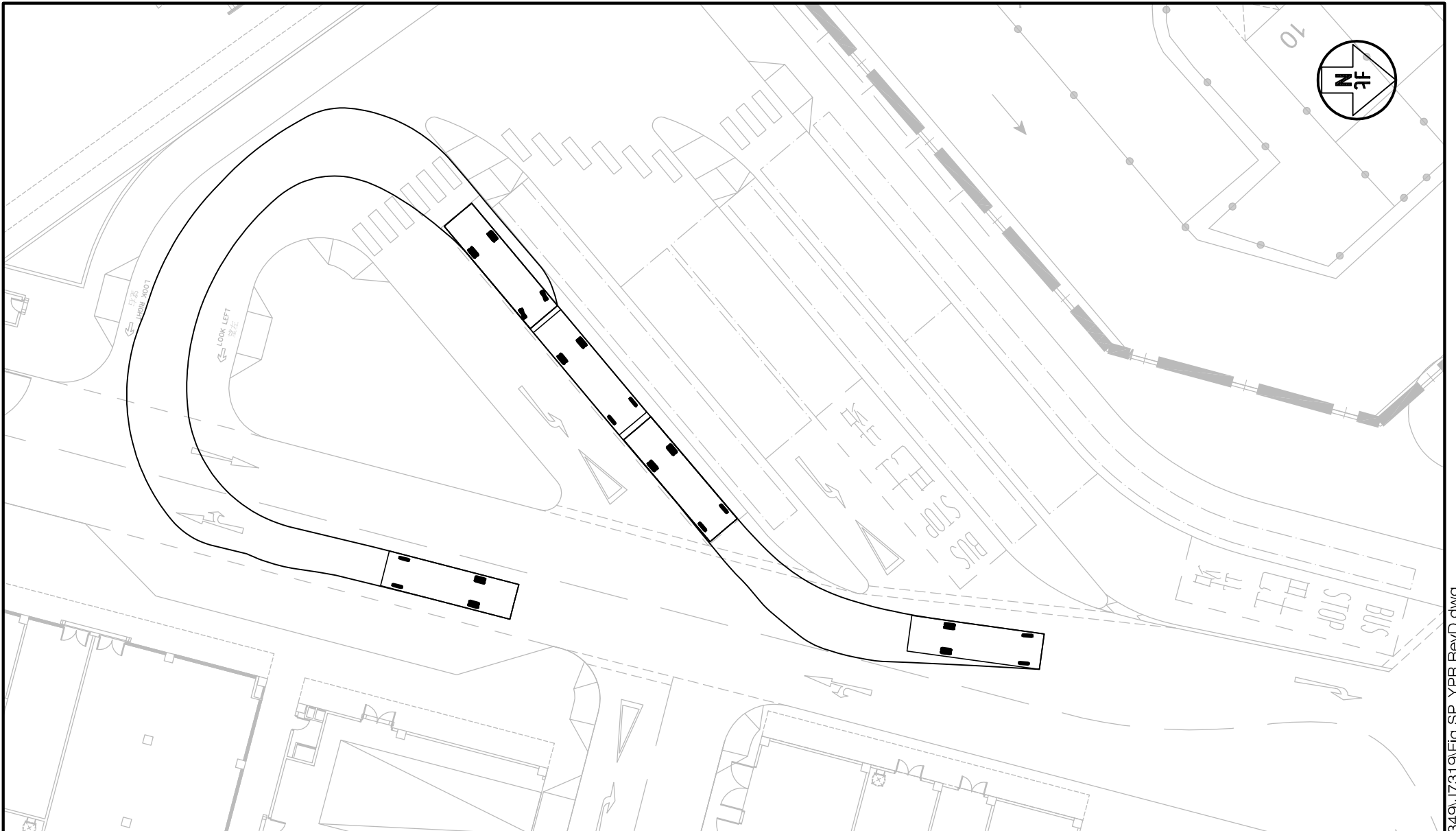

Project Title CONTRACT NO. SS M518 DESIGN AND CONSTRUCTION OF LIGHT PUBLIC HOUSING AT YAU POK ROAD, YUEN LONG, AT TUEN MUN AREA 3A AND AT CHOI HING ROAD, NGAU TAU KOK (DESIGN AND CONSTRUCTION STAGE) J7319

Figure No. SP/YPR/GMB/3
Revision D

CKM Asia Limited

Figure Title
YAU POK ROAD SITE (ZONE 2) - SWEEP PATH OF MINIBUS ENTERING AND LEAVING ZONE 2

Designed by T H C	Drawn by C C L	Checked by K C
Scale in A4 1 : 300	Date 25 JUL 2024	

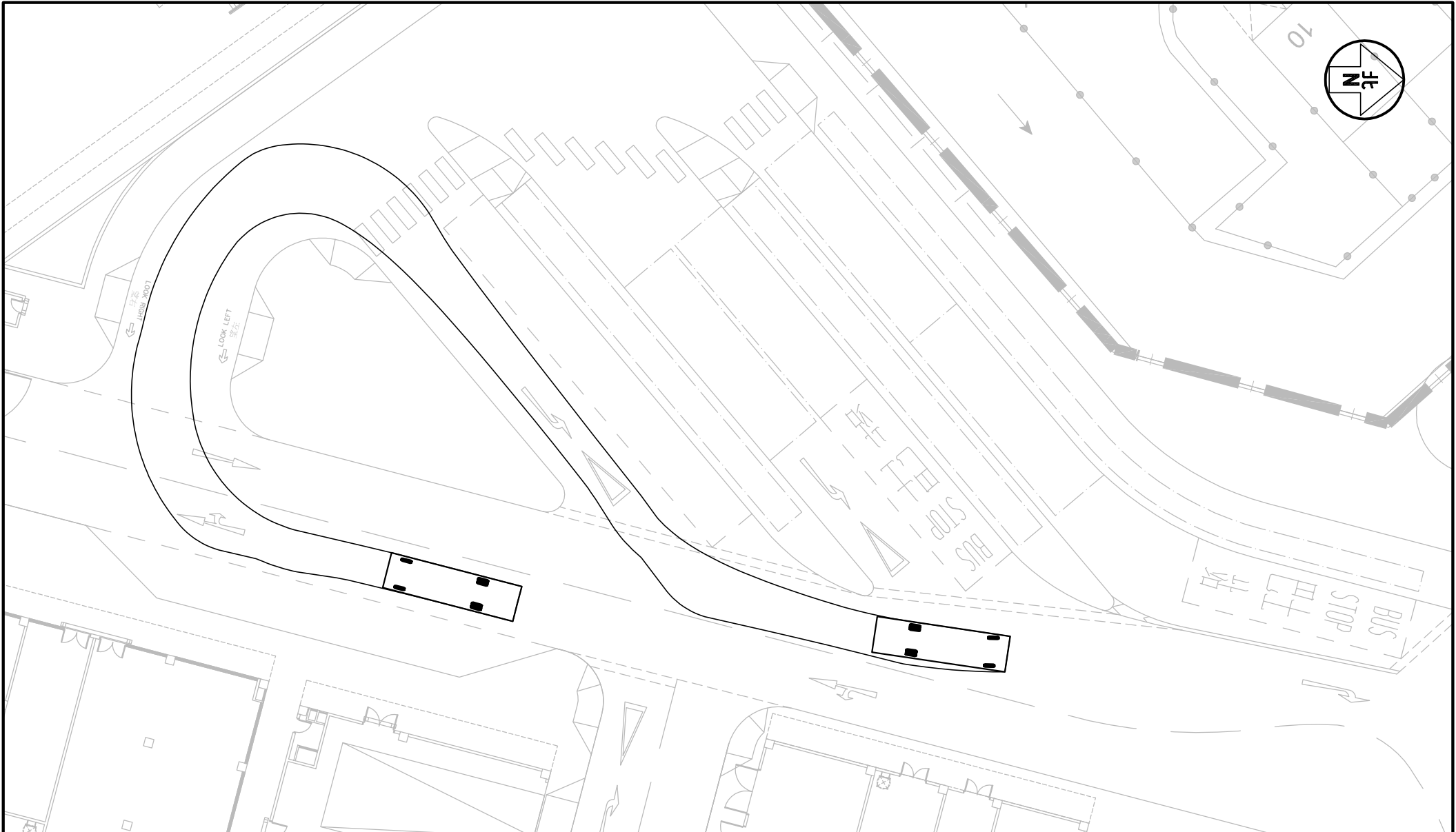

Project Title CONTRACT NO. SS M518 DESIGN AND CONSTRUCTION OF LIGHT PUBLIC HOUSING AT YAU POK ROAD, YUEN LONG, AT TUEN MUN AREA 3A AND AT CHOI HING ROAD, NGAU TAU KOK (DESIGN AND CONSTRUCTION STAGE) J7319

Figure No. SP/YPR/GMB/4
Revision D

CKM Asia Limited

Figure Title
YAU POK ROAD SITE (ZONE 2) – SWEEP PATH OF MINIBUS ENTERING AND LEAVING ZONE 2

Designed by T H C	Drawn by C C L	Checked by K C
Scale in A4 1 : 300	Date 25 JUL 2024	

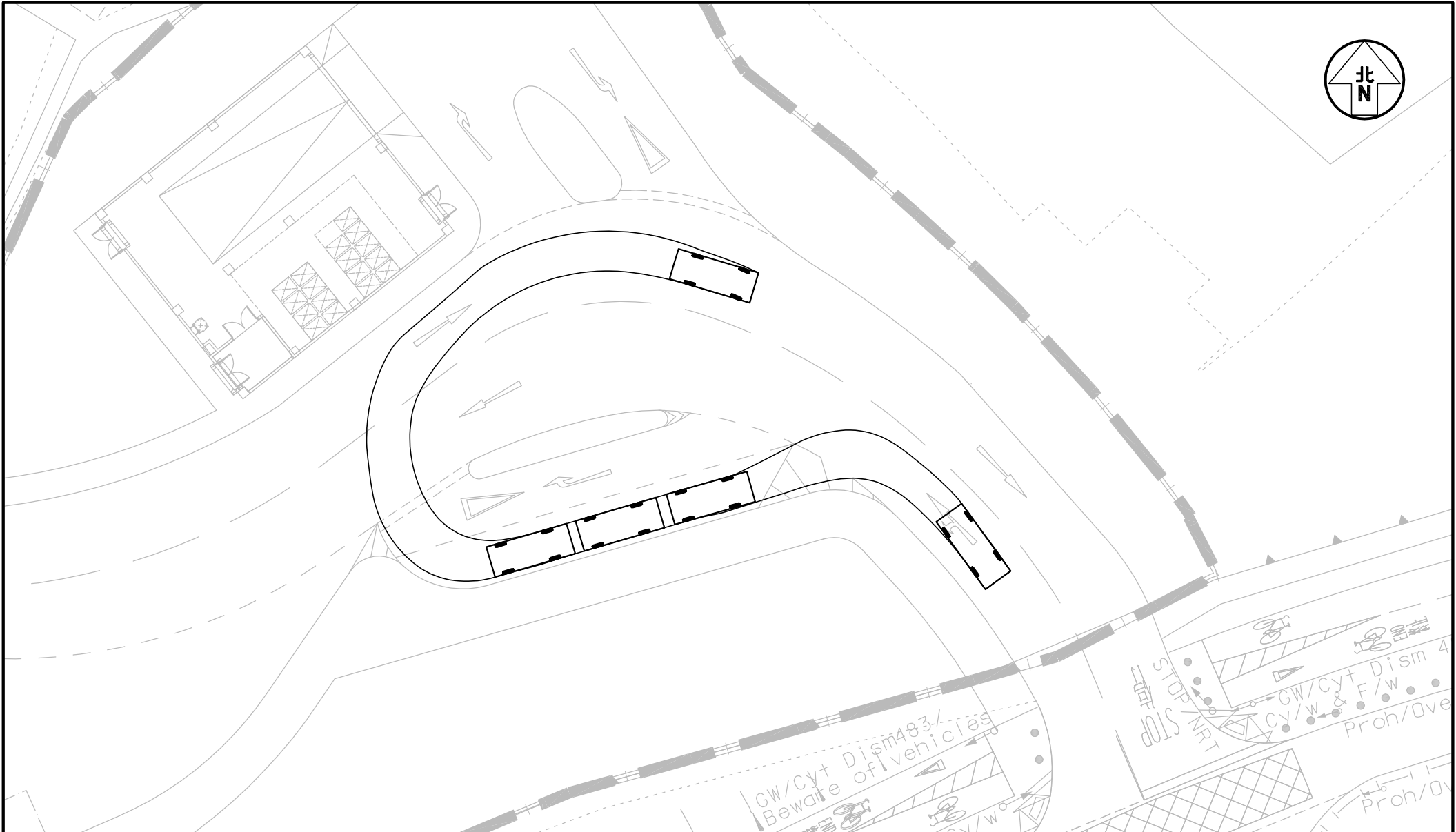

Project Title CONTRACT NO. SS M518 DESIGN AND CONSTRUCTION OF LIGHT PUBLIC HOUSING AT YAU POK ROAD, YUEN LONG, AT TUEN MUN AREA 3A AND AT CHOI HING ROAD, NGAU TAU KOK (DESIGN AND CONSTRUCTION STAGE) J7319

Figure No. SP/YPR/CAR/1 Revision D

CKM Asia Limited

Figure Title YAU POK ROAD SITE (ZONE 1) - SWEPT PATH OF TAXI / PRIVATE CAR ENTERING AND LEAVING THE GENERAL LAY-BY

Designed by T H C	Drawn by C C L	Checked by K C
Scale in A4 1 : 300	Date 25 JUL 2024	

T:\JOB\J7300-J7349\J7319\Fig SP_YPR RevD.dwg

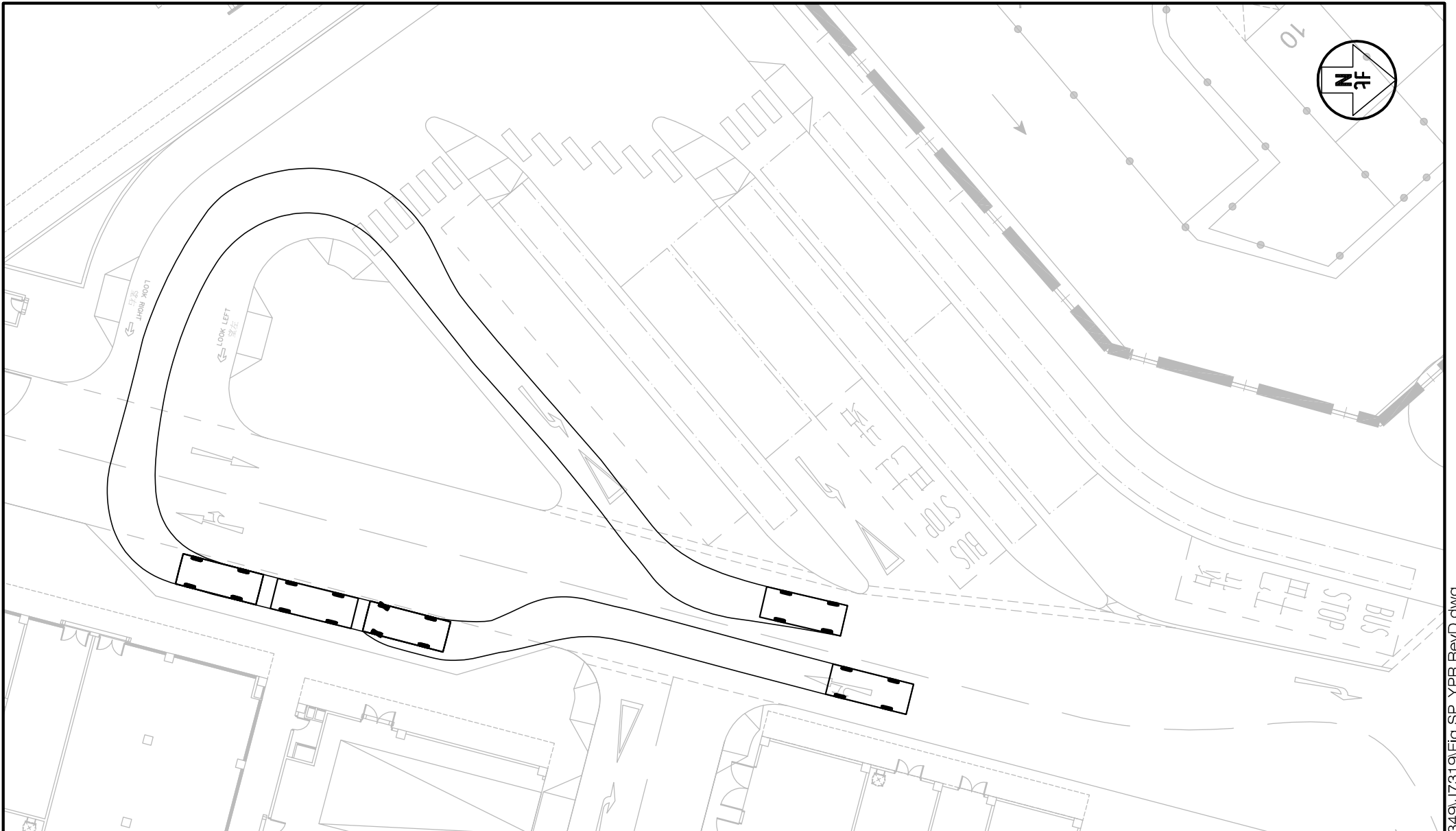

Project Title CONTRACT NO. SS M518 DESIGN AND CONSTRUCTION OF LIGHT PUBLIC HOUSING AT YAU POK ROAD, YUEN LONG, AT TUEN MUN AREA 3A AND AT CHOI HING ROAD, NGAU TAU KOK (DESIGN AND CONSTRUCTION STAGE) J7319

Figure No. SP/YPR/CAR/2 Revision D

CKM Asia Limited

Figure Title
YAU POK ROAD SITE (ZONE 2) - SWEPT PATH OF TAXI / PRIVATE CAR ENTERING AND LEAVING THE GENERAL LAY-BY

Designed by T H C	Drawn by C C L	Checked by K C
Scale in A4 1 : 300	Date 25 JUL 2024	

ENTERING

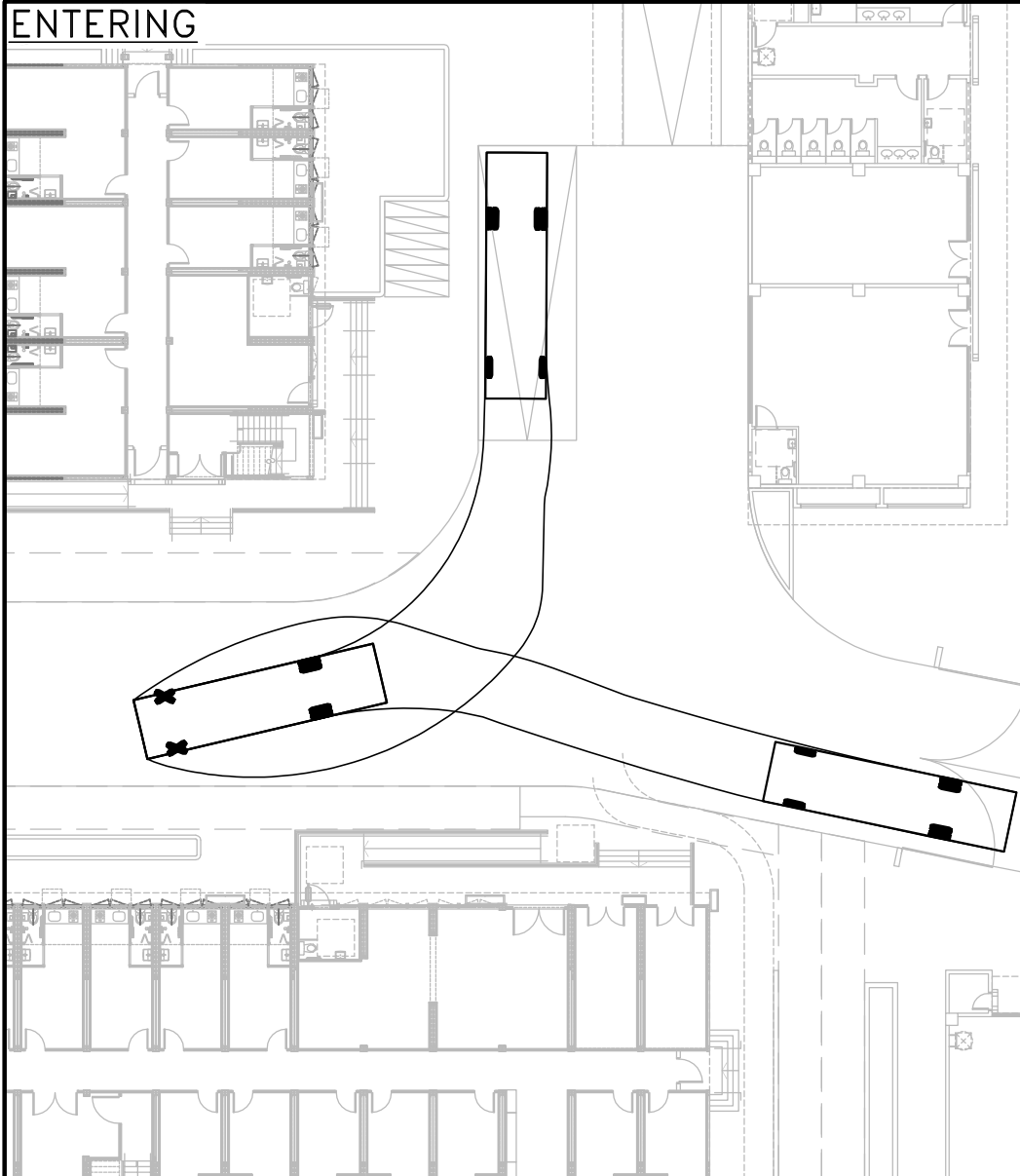

LEAVING

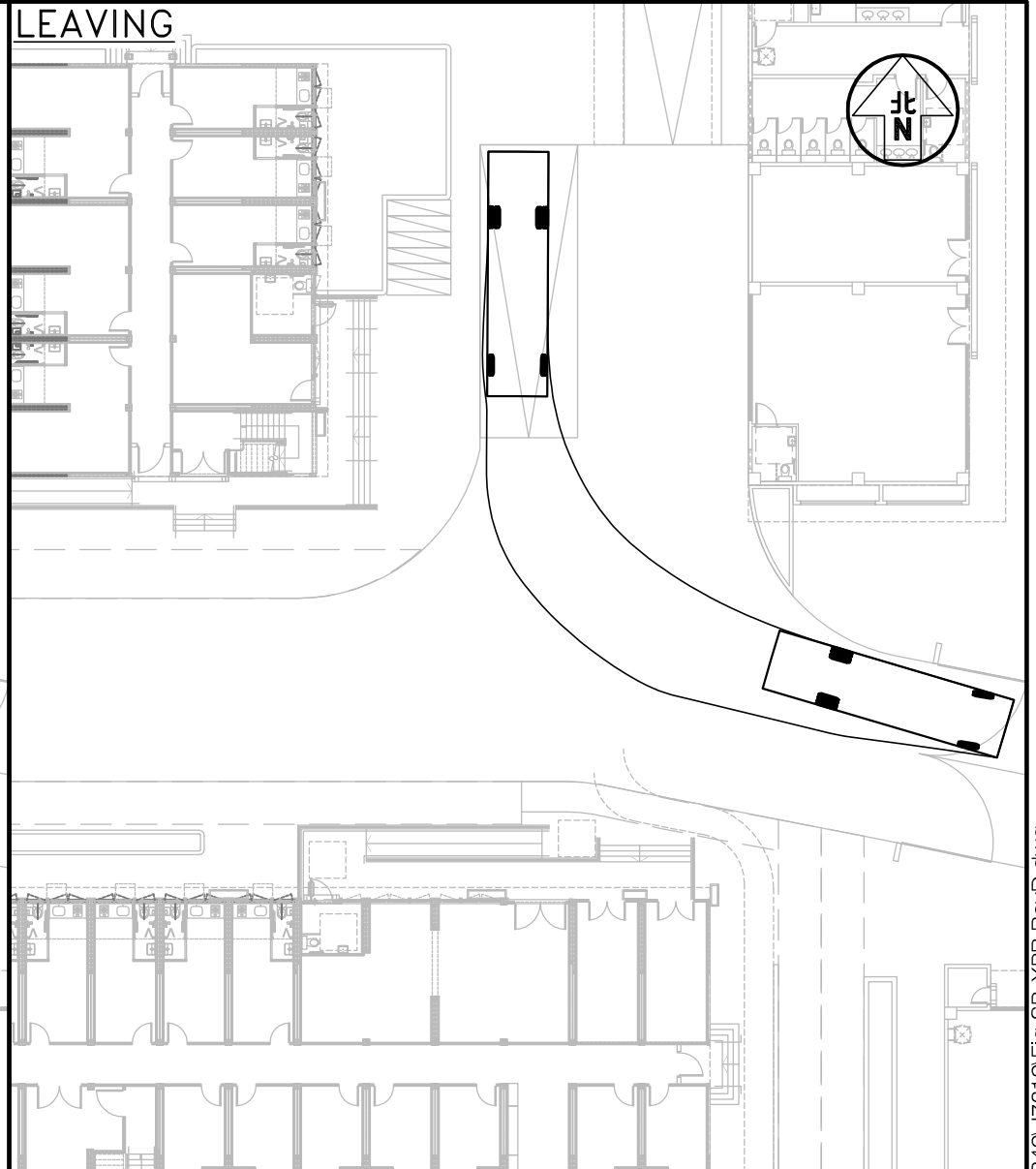

Project Title CONTRACT NO. SS M518 DESIGN AND CONSTRUCTION OF LIGHT PUBLIC HOUSING AT YAU POK ROAD,
YUEN LONG, AT TUEN MUN AREA 3A AND AT CHOI HING ROAD, NGAU TAU KOK (DESIGN AND CONSTRUCTION STAGE) J7319

Figure No. SP/YPR/HGV/1

Revision D

CKM Asia Limited

Figure Title
**YAU POK ROAD SITE (ZONE 1) – SWEEP PATH OF
HEAVY GOODS VEHICLE ENTERING AND LEAVING THE HGV BAY**

Designed by
T H C

Drawn by
C C L

Checked by
K C

Scale in A4
1 : 300

Date
25 JUL 2024

T:\JOB\J7300-J7349\J7319\Fig SP_YPR RevD.dwg

ENTERING

LEAVING



Project Title CONTRACT NO. SS M518 DESIGN AND CONSTRUCTION OF LIGHT PUBLIC HOUSING AT YAU POK ROAD, YUEN LONG, AT TUEN MUN AREA 3A AND AT CHOI HING ROAD, NGAU TAU KOK (DESIGN AND CONSTRUCTION STAGE) J7319

Figure No. SP/YPR/HGV/2

Revision D

CKM Asia Limited

Figure Title
YAU POK ROAD SITE (ZONE 1) – SWEEP PATH OF HEAVY GOODS VEHICLE ENTERING AND LEAVING THE HGV BAY

Designed by
T H C

Drawn by
C C L

Checked by
K C

Scale in A4
1 : 300

Date
25 JUL 2024



ENTERING

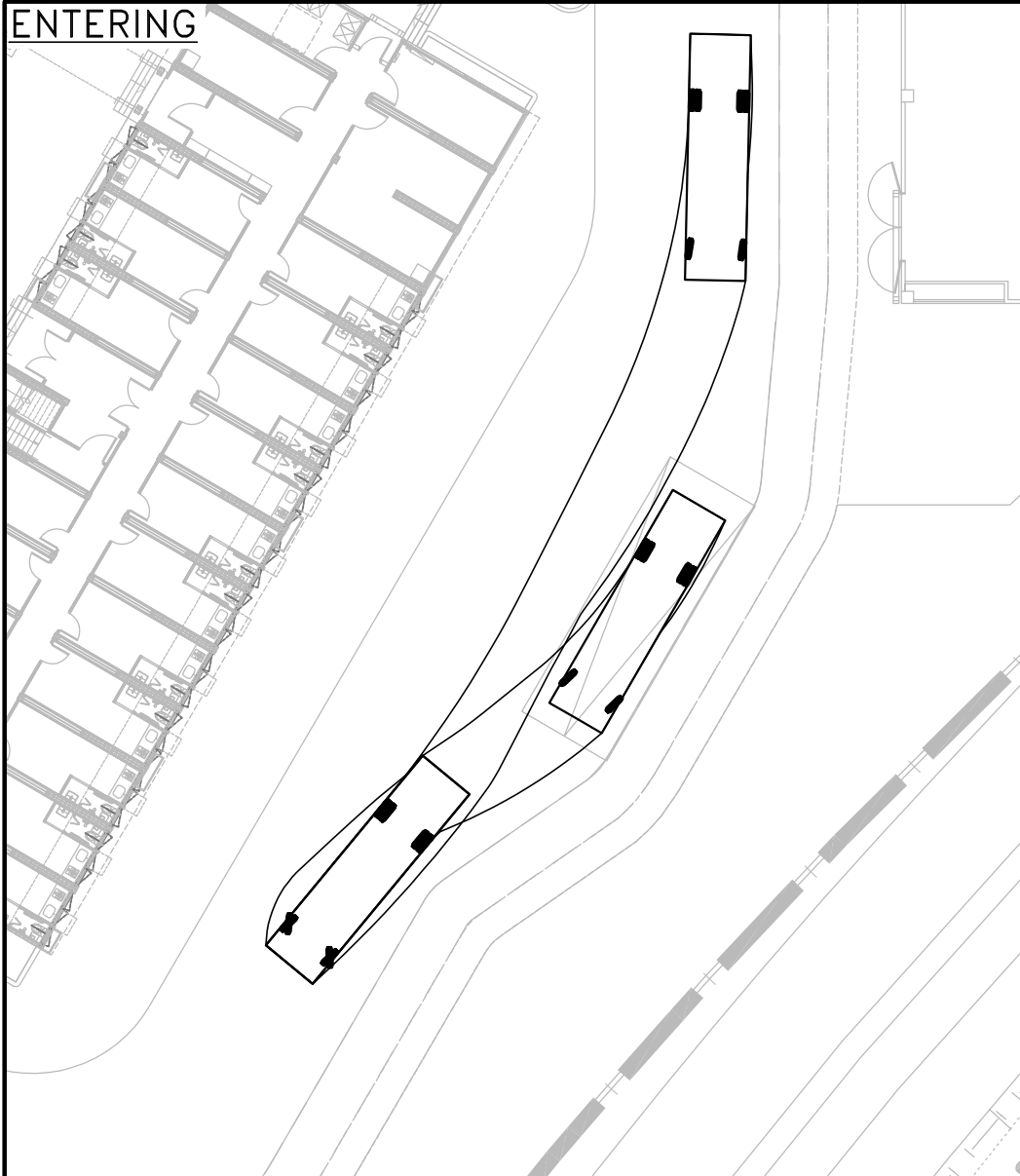

LEAVING

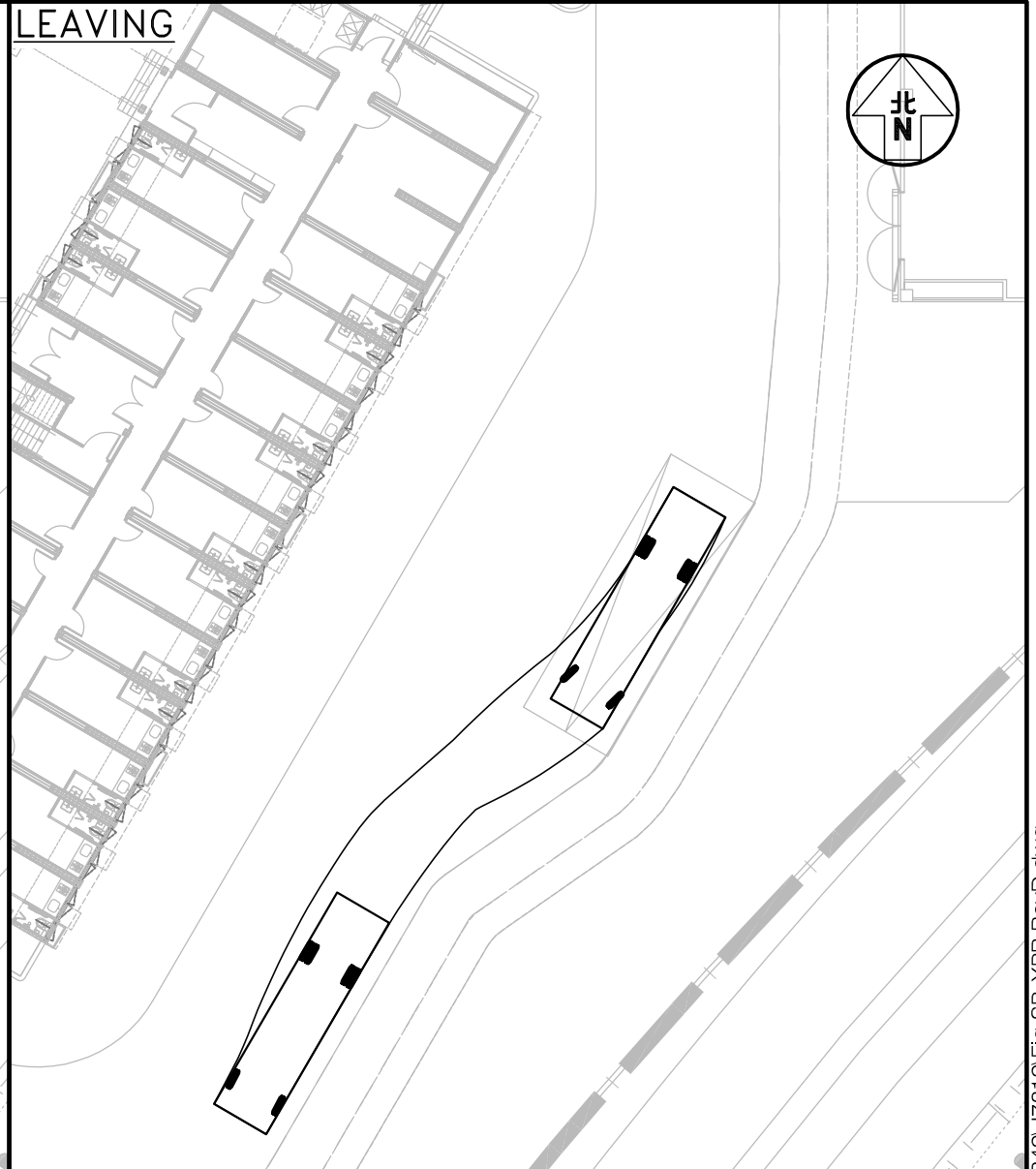

Project Title CONTRACT NO. SS M518 DESIGN AND CONSTRUCTION OF LIGHT PUBLIC HOUSING AT YAU POK ROAD,
 YUEN LONG, AT TUEN MUN AREA 3A AND AT CHOI HING ROAD, NGAU TAU KOK (DESIGN AND CONSTRUCTION STAGE) J7319

Figure No. SP/YPR/HGV/3

Revision D

CKM Asia Limited

Figure Title
 YAU POK ROAD SITE (ZONE 1) – SWEEP PATH OF
 HEAVY GOODS VEHICLE ENTERING AND LEAVING THE HGV BAY

Designed by
 T H C

Drawn by
 C C L

Checked by
 K C

Scale in A4
 1 : 300

Date
 25 JUL 2024

ENTERING

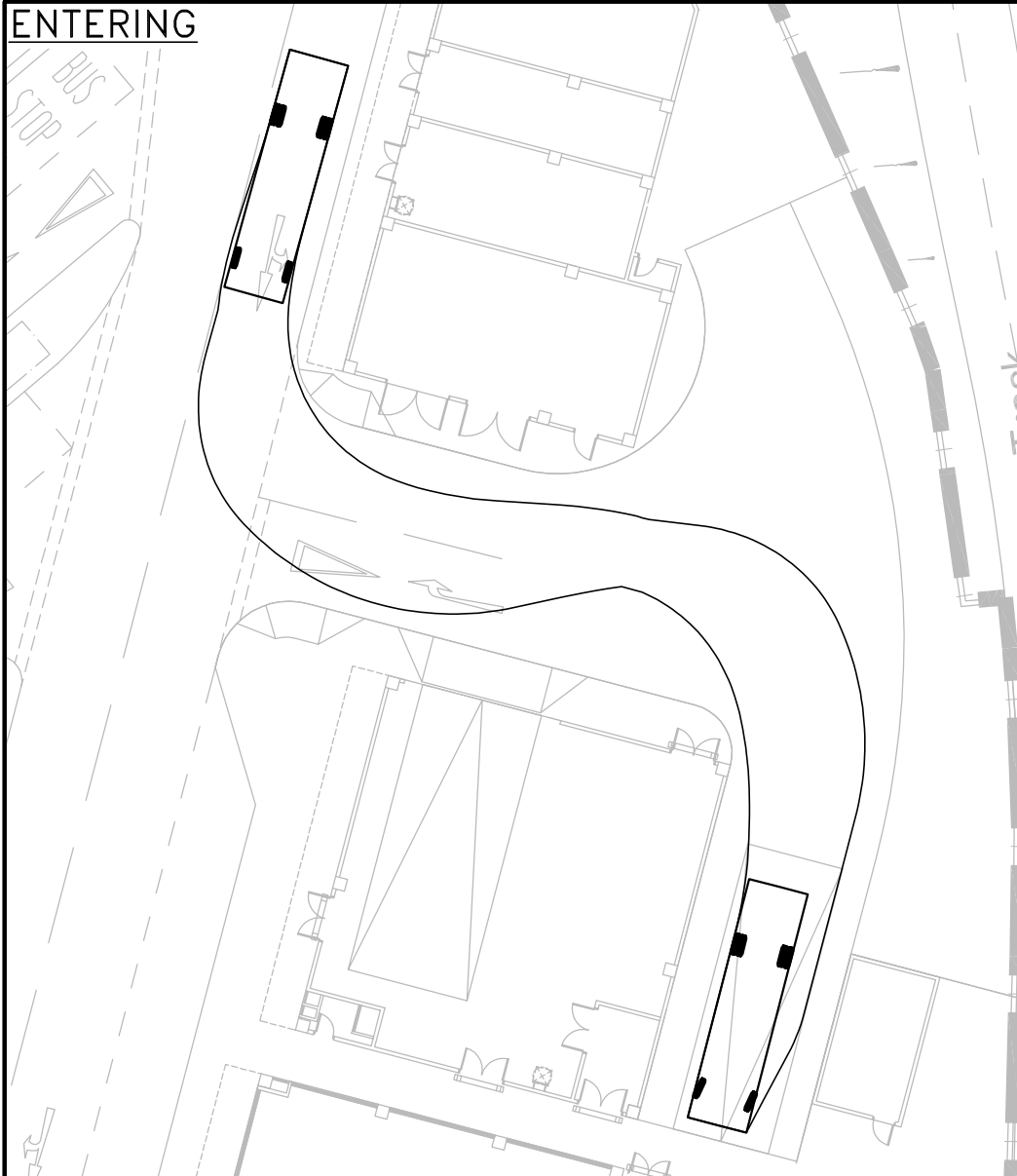

LEAVING

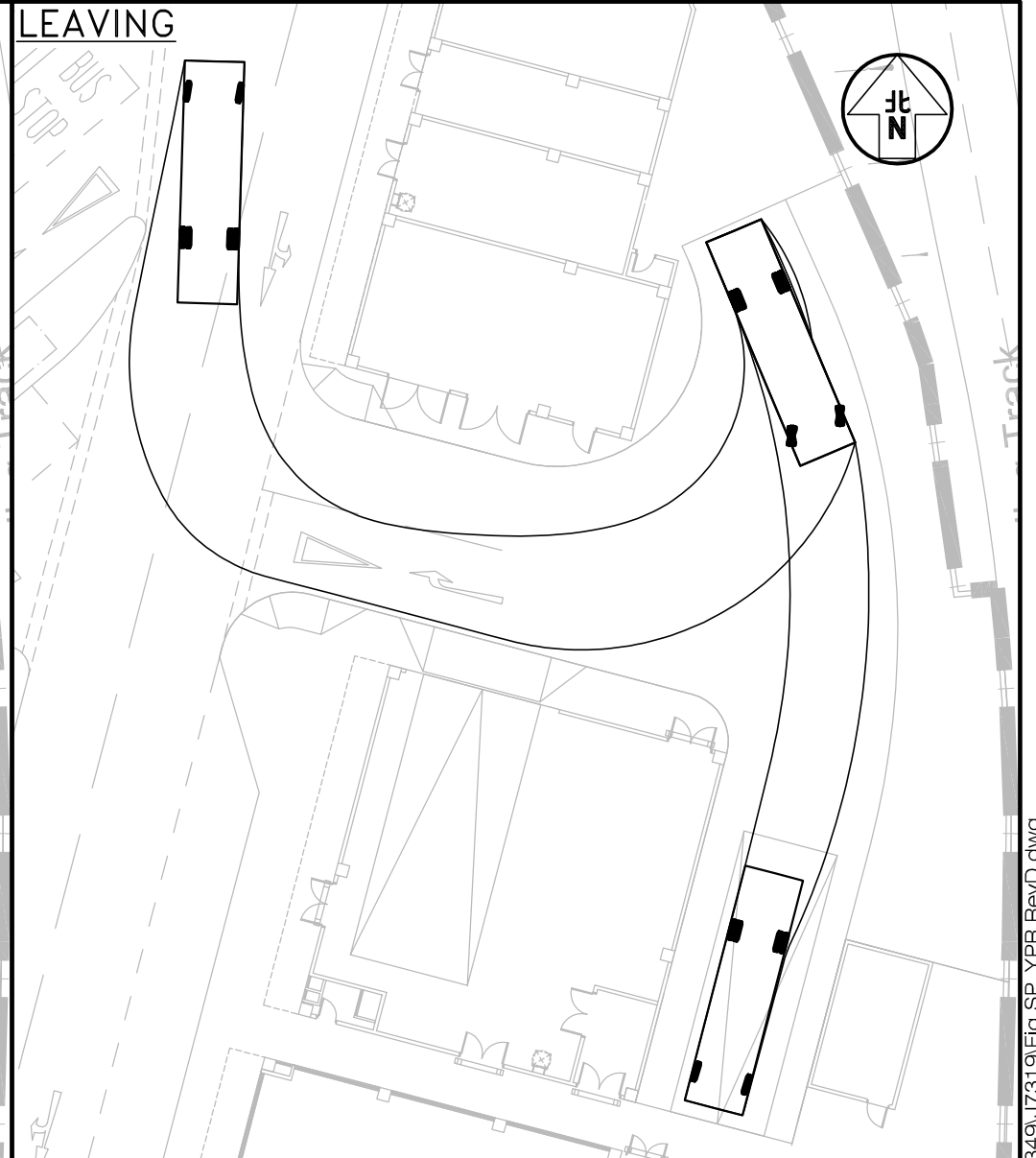

Project Title CONTRACT NO. SS M518 DESIGN AND CONSTRUCTION OF LIGHT PUBLIC HOUSING AT YAU POK ROAD,
YUEN LONG, AT TUEN MUN AREA 3A AND AT CHOI HING ROAD, NGAU TAU KOK (DESIGN AND CONSTRUCTION STAGE) J7319

Figure No. SP/YPR/HGV/4
Revision D

CKM Asia Limited

Figure Title
**YAU POK ROAD SITE (ZONE 2) – SWEEP PATH OF
HEAVY GOODS VEHICLE ENTERING AND LEAVING THE HGV BAY**

Designed by T H C	Drawn by C C L	Checked by K C
Scale in A4 1 : 300	Date 25 JUL 2024	

ENTERING

LEAVING

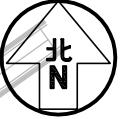

Project Title CONTRACT NO. SS M518 DESIGN AND CONSTRUCTION OF LIGHT PUBLIC HOUSING AT YAU POK ROAD, YUEN LONG, AT TUEN MUN AREA 3A AND AT CHOI HING ROAD, NGAU TAU KOK (DESIGN AND CONSTRUCTION STAGE) J7319

Figure No. SP/YPR/HGV/5

Revision D

CKM Asia Limited

Figure Title
YAU POK ROAD SITE (ZONE 2) – SWEEP PATH OF HEAVY GOODS VEHICLE ENTERING AND LEAVING THE HGV BAY

Designed by
T H C

Drawn by
C C L

Checked by
K C

Scale in A4
1 : 300

Date
25 JUL 2024

T:\JOB\J7300-J7349\J7319\Fig SP_YPR RevD.dwg

ENTERING

LEAVING



Project Title CONTRACT NO. SS M518 DESIGN AND CONSTRUCTION OF LIGHT PUBLIC HOUSING AT YAU POK ROAD,
 YUEN LONG, AT TUEN MUN AREA 3A AND AT CHOI HING ROAD, NGAU TAU KOK (DESIGN AND CONSTRUCTION STAGE) J7319

Figure No. SP/YPR/HGV/6

Revision D

CKM Asia Limited

Figure Title
**YAU POK ROAD SITE (ZONE 2) – SWEEP PATH OF
 HEAVY GOODS VEHICLE ENTERING AND LEAVING THE HGV BAY**

Designed by T H C	Drawn by C C L	Checked by K C
Scale in A4 1 : 300	Date 25 JUL 2024	

ENTERING



LEAVING



Project Title CONTRACT NO. SS M518 DESIGN AND CONSTRUCTION OF LIGHT PUBLIC HOUSING AT YAU POK ROAD,
YUEN LONG, AT TUEN MUN AREA 3A AND AT CHOI HING ROAD, NGAU TAU KOK (DESIGN AND CONSTRUCTION STAGE) J7319

Figure No. SP/YPR/HGV/7

Revision D

CKM Asia Limited

Figure Title
**YAU POK ROAD SITE (ZONE 2) – SWEEP PATH OF
HEAVY GOODS VEHICLE ENTERING AND LEAVING THE HGV BAY**

Designed by
T H C

Drawn by
C C L

Checked by
K C

Scale in A4
1 : 300

Date
25 JUL 2024

ENTERING

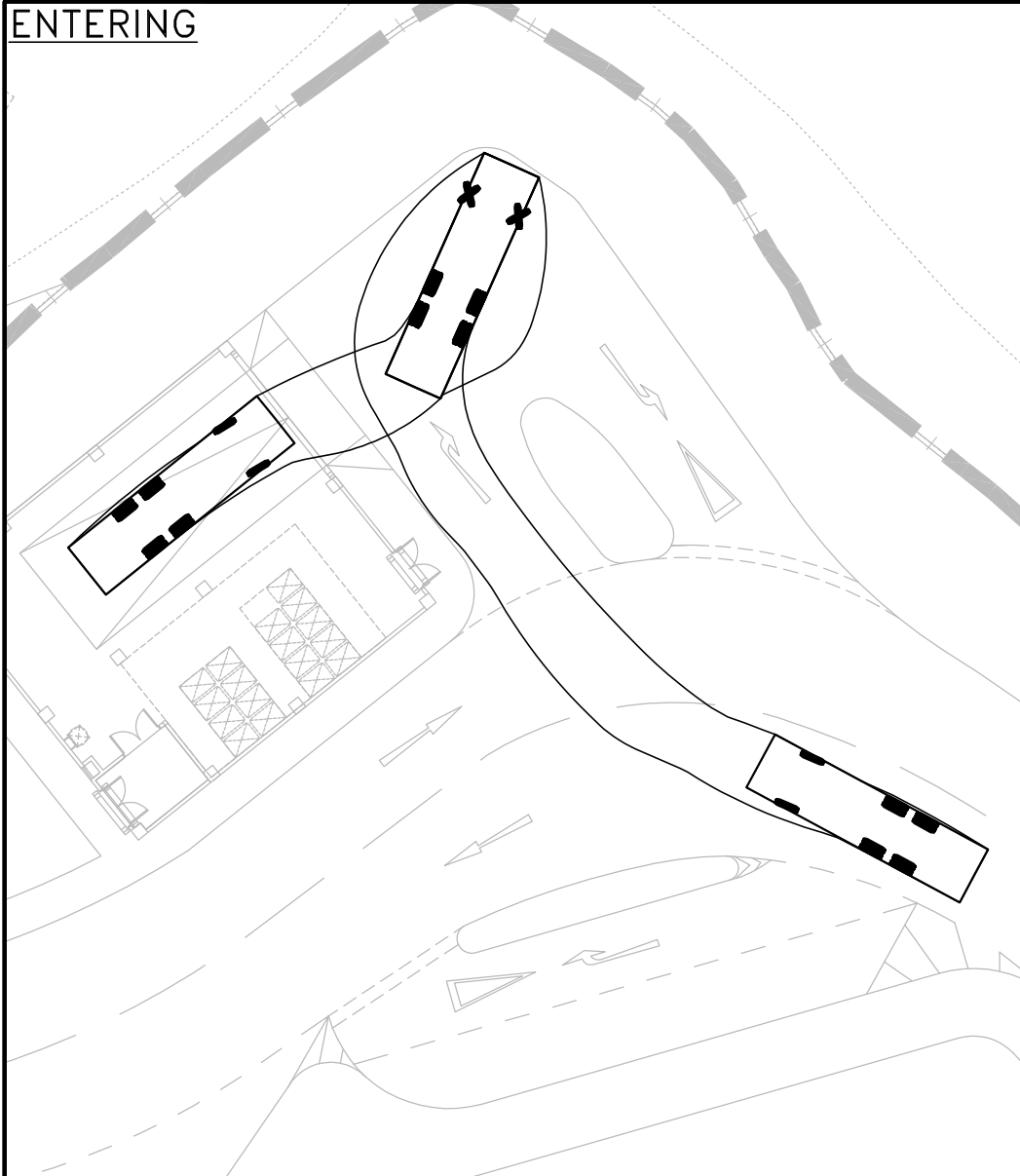

LEAVING

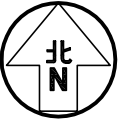
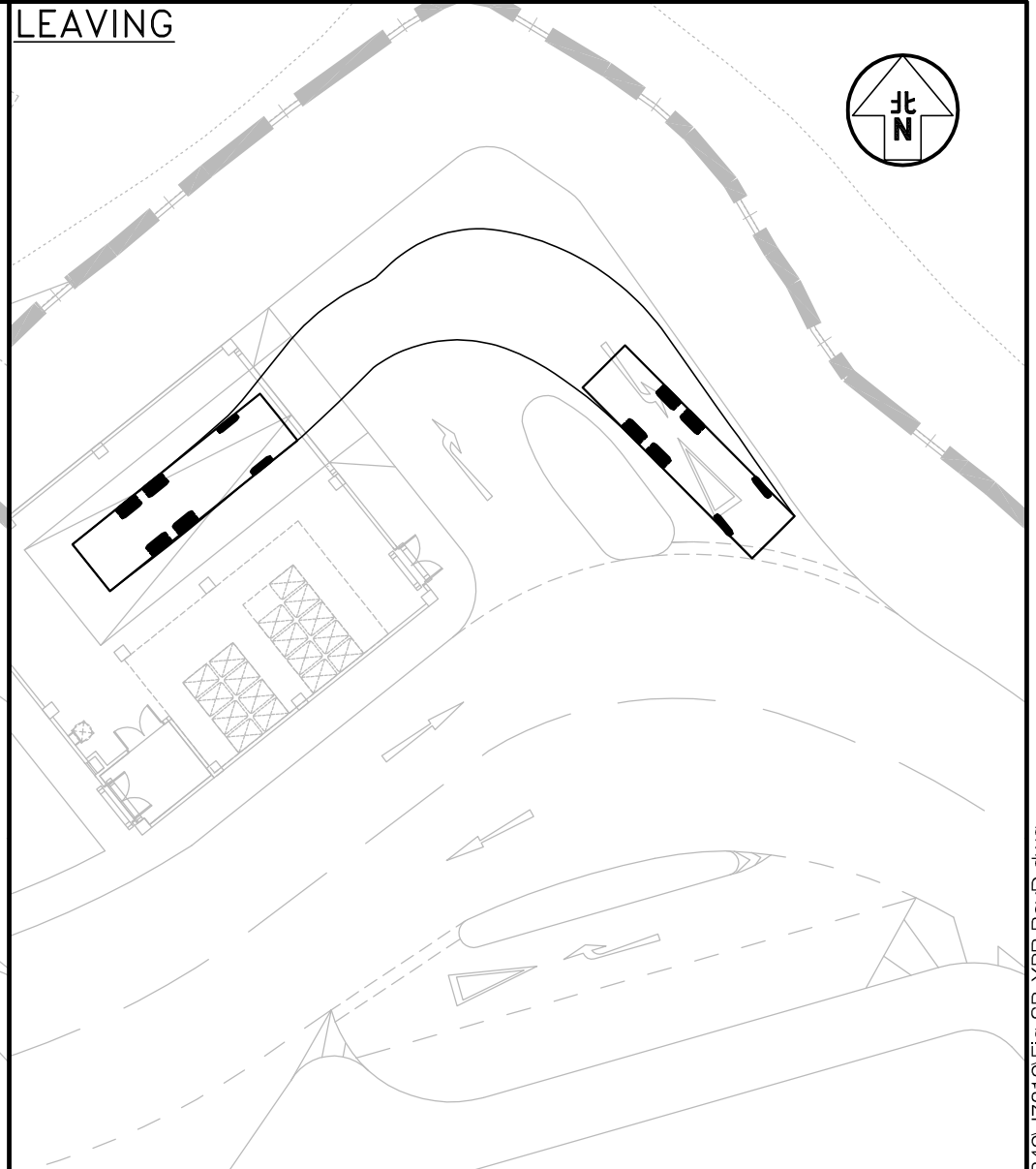

CONTRACT NO. SS M518 DESIGN AND CONSTRUCTION OF LIGHT PUBLIC HOUSING AT YAU POK ROAD,
 YUEN LONG, AT TUEN MUN AREA 3A AND AT CHOI HING ROAD, NGAU TAU KOK (DESIGN AND CONSTRUCTION STAGE) J7319

Figure No. SP/YPR/RCV/1
 Revision D

CKM Asia Limited

YAU POK ROAD SITE (ZONE 1) – SWEEP PATH OF
 REFUSE COLLECTION VEHICLE ENTERING AND LEAVING THE RCV BAY

Designed by T H C	Drawn by C C L	Checked by K C
Scale in A4 1 : 300	Date 25 JUL 2024	

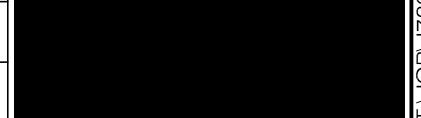

T:\JOB\J7300-J7349\J7319\Fig SP_YPR RevD.dwg

ENTERING

LEAVING

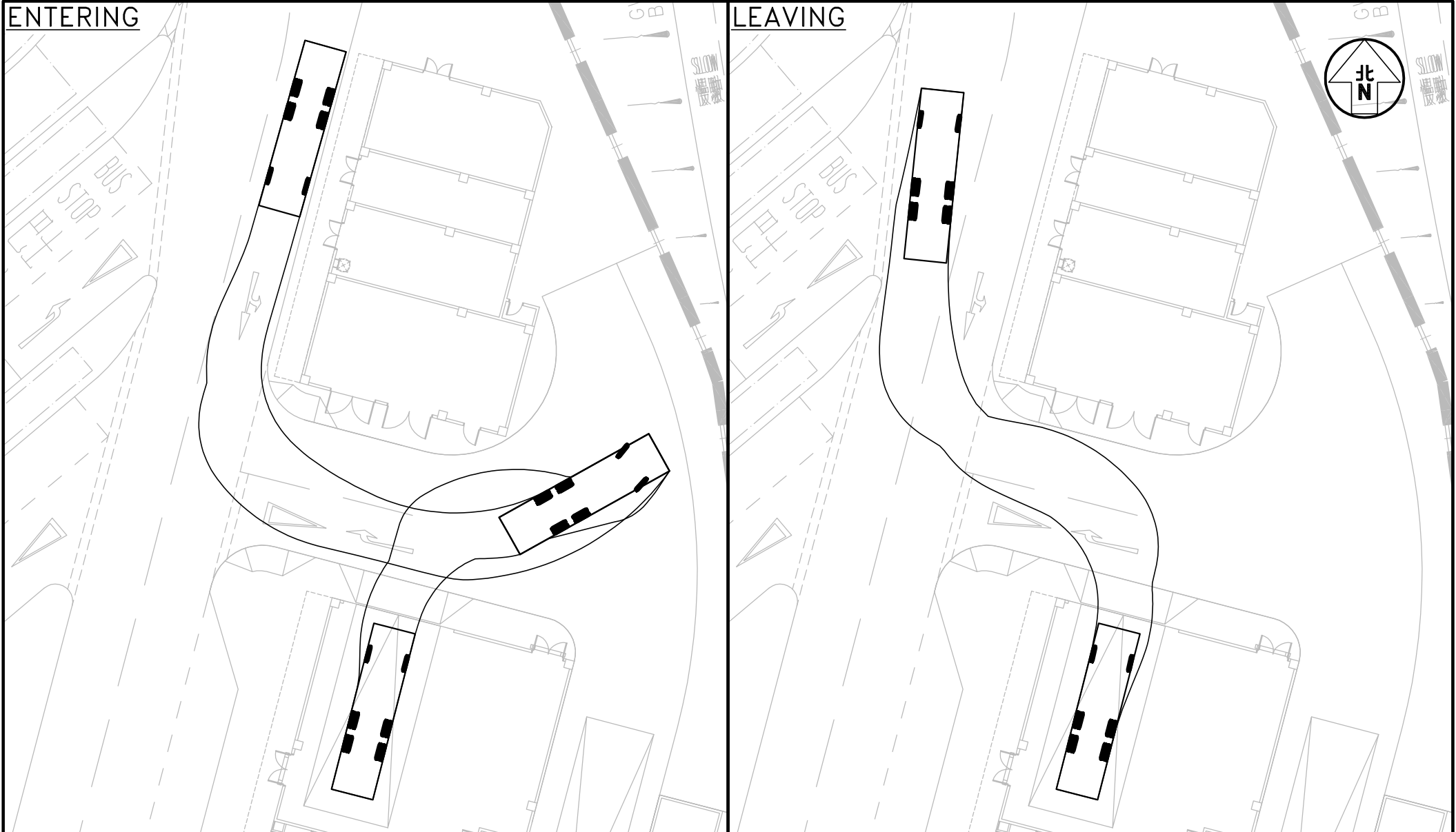

CONTRACT NO. SS M518 DESIGN AND CONSTRUCTION OF LIGHT PUBLIC HOUSING AT YAU POK ROAD,
 YUEN LONG, AT TUEN MUN AREA 3A AND AT CHOI HING ROAD, NGAU TAU KOK (DESIGN AND CONSTRUCTION STAGE) J7319

Figure No. SP/YPR/RCV/2
 Revision D

CKM Asia Limited

Designed by T H C
 Drawn by C C L
 Checked by K C

Scale in A4 1 : 300
 Date 25 JUL 2024

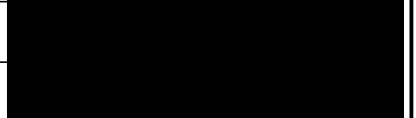

YAU POK ROAD SITE (ZONE 2) – SWEEP PATH OF
 REFUSE COLLECTION VEHICLE ENTERING AND LEAVING THE RCV BAY



Project Title CONTRACT NO. SS M518 DESIGN AND CONSTRUCTION OF LIGHT PUBLIC HOUSING AT YAU POK ROAD, YUEN LONG, AT TUEN MUN AREA 3A AND AT CHOI HING ROAD, NGAU TAU KOK (DESIGN AND CONSTRUCTION STAGE) J7319

Figure No. SP/YPR/FV/1 Revision D

CKM Asia Limited

Figure Title
YAU POK ROAD SITE (ZONE 1) – SWEEP PATH OF FIRE APPLIANCE TURNING AROUND WITHIN ZONE 1

Designed by T H C	Drawn by C C L	Checked by K C
Scale in A4 1 : 300	Date 25 JUL 2024	

T:\JOB\J7300-J7349\J7319\Fig SP_YPR RevD.dwg

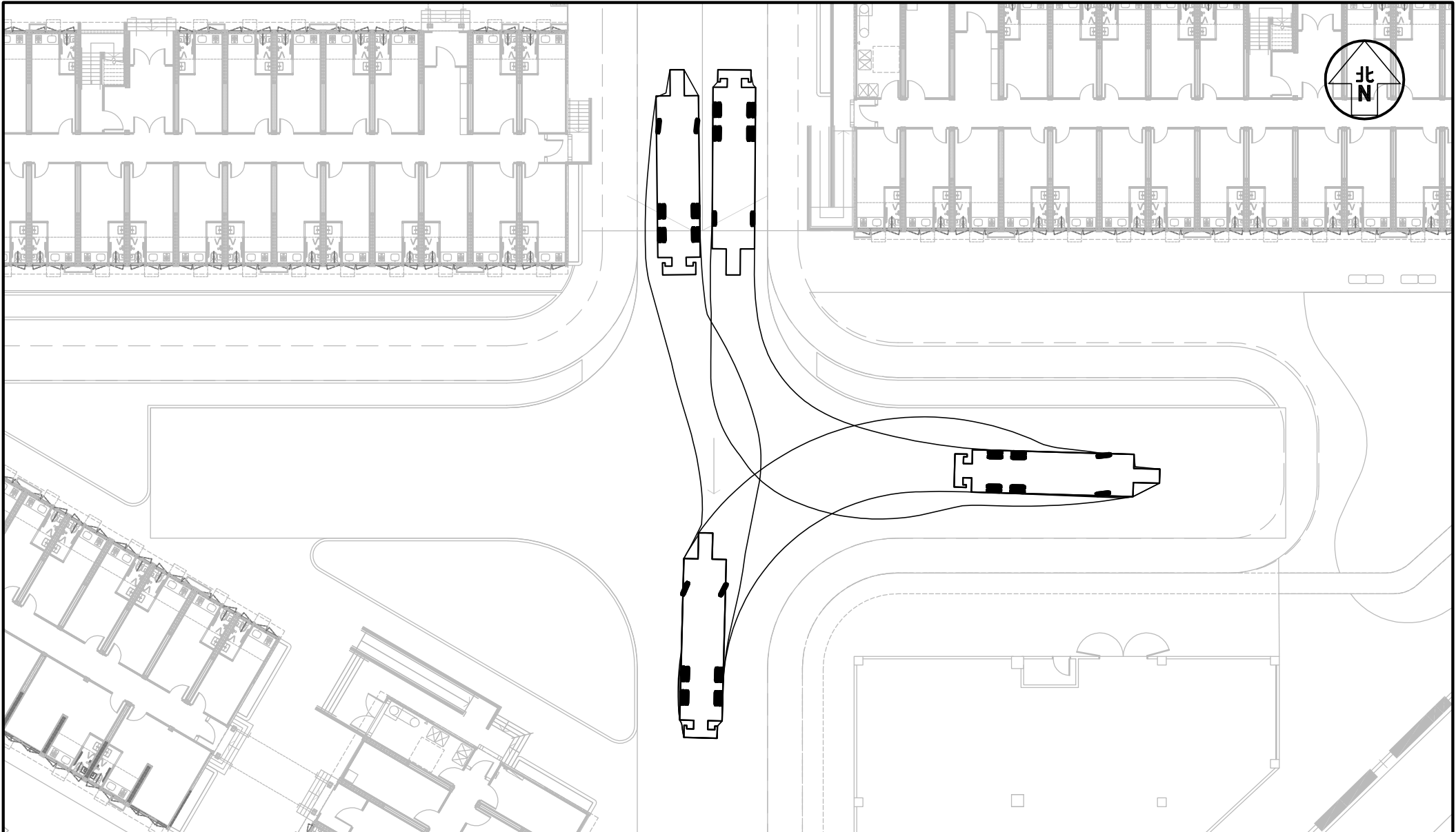

Project Title CONTRACT NO. SS M518 DESIGN AND CONSTRUCTION OF LIGHT PUBLIC HOUSING AT YAU POK ROAD, YUEN LONG, AT TUEN MUN AREA 3A AND AT CHOI HING ROAD, NGAU TAU KOK (DESIGN AND CONSTRUCTION STAGE) J7319

Figure No. SP/YPR/FV/2 Revision D

CKM Asia Limited

Figure Title YAU POK ROAD SITE (ZONE 1) – SWEEP PATH OF FIRE APPLIANCE TURNING AROUND WITHIN ZONE 1

Designed by T H C	Drawn by C C L	Checked by K C
Scale in A4 1 : 300	Date 25 JUL 2024	

T:\JOB\J7300-J7349\J7319\Fig SP_YPR RevD.dwg

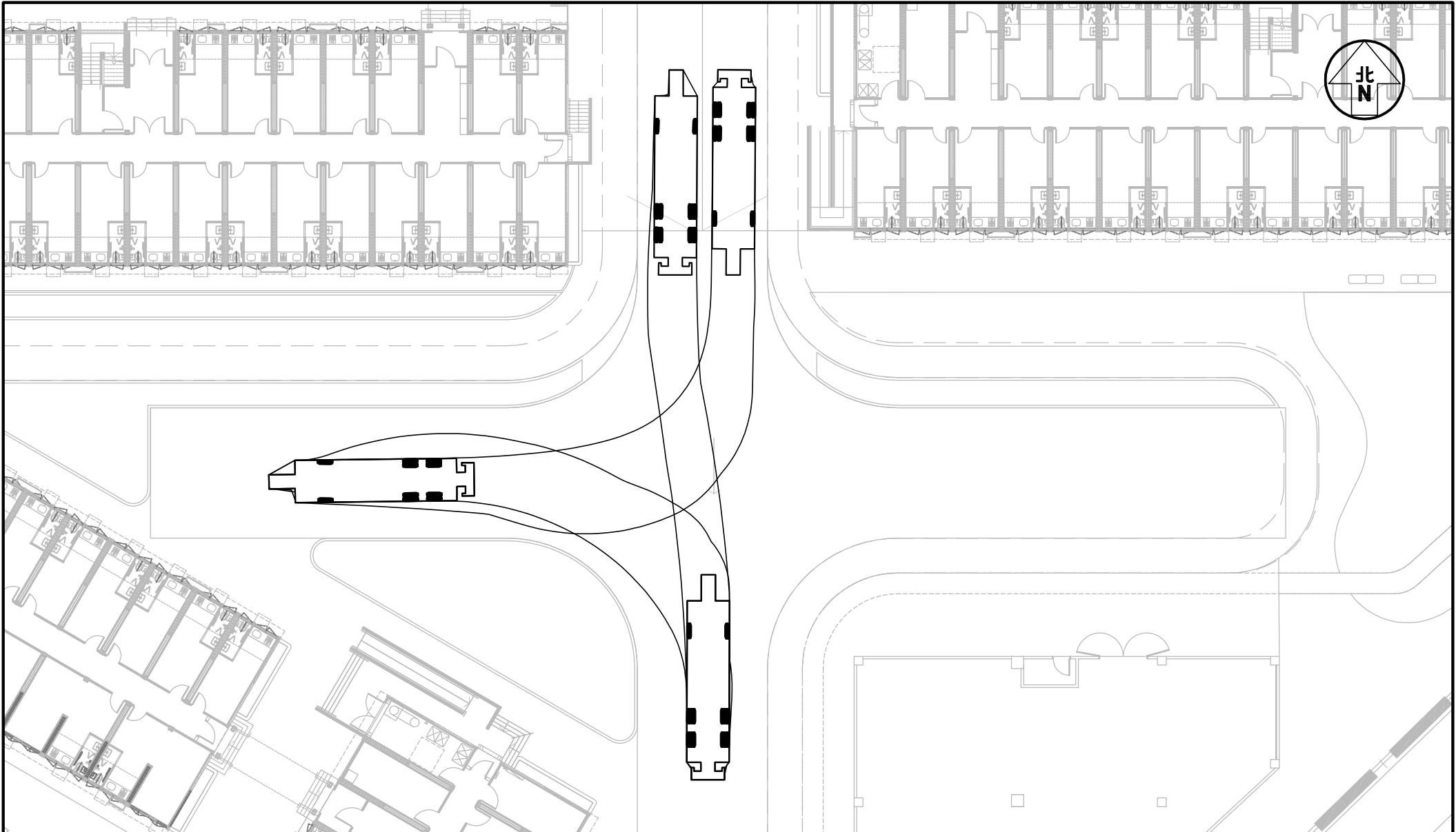

Project Title CONTRACT NO. SS M518 DESIGN AND CONSTRUCTION OF LIGHT PUBLIC HOUSING AT YAU POK ROAD, YUEN LONG, AT TUEN MUN AREA 3A AND AT CHOI HING ROAD, NGAU TAU KOK (DESIGN AND CONSTRUCTION STAGE) J7319

Figure No. SP/YPR/FV/3 Revision D

CKM Asia Limited

Figure Title YAU POK ROAD SITE (ZONE 1) – SWEEP PATH OF FIRE APPLIANCE TURNING AROUND WITHIN ZONE 1

Designed by T H C	Drawn by C C L	Checked by K C
Scale in A4 1 : 300	Date 25 JUL 2024	

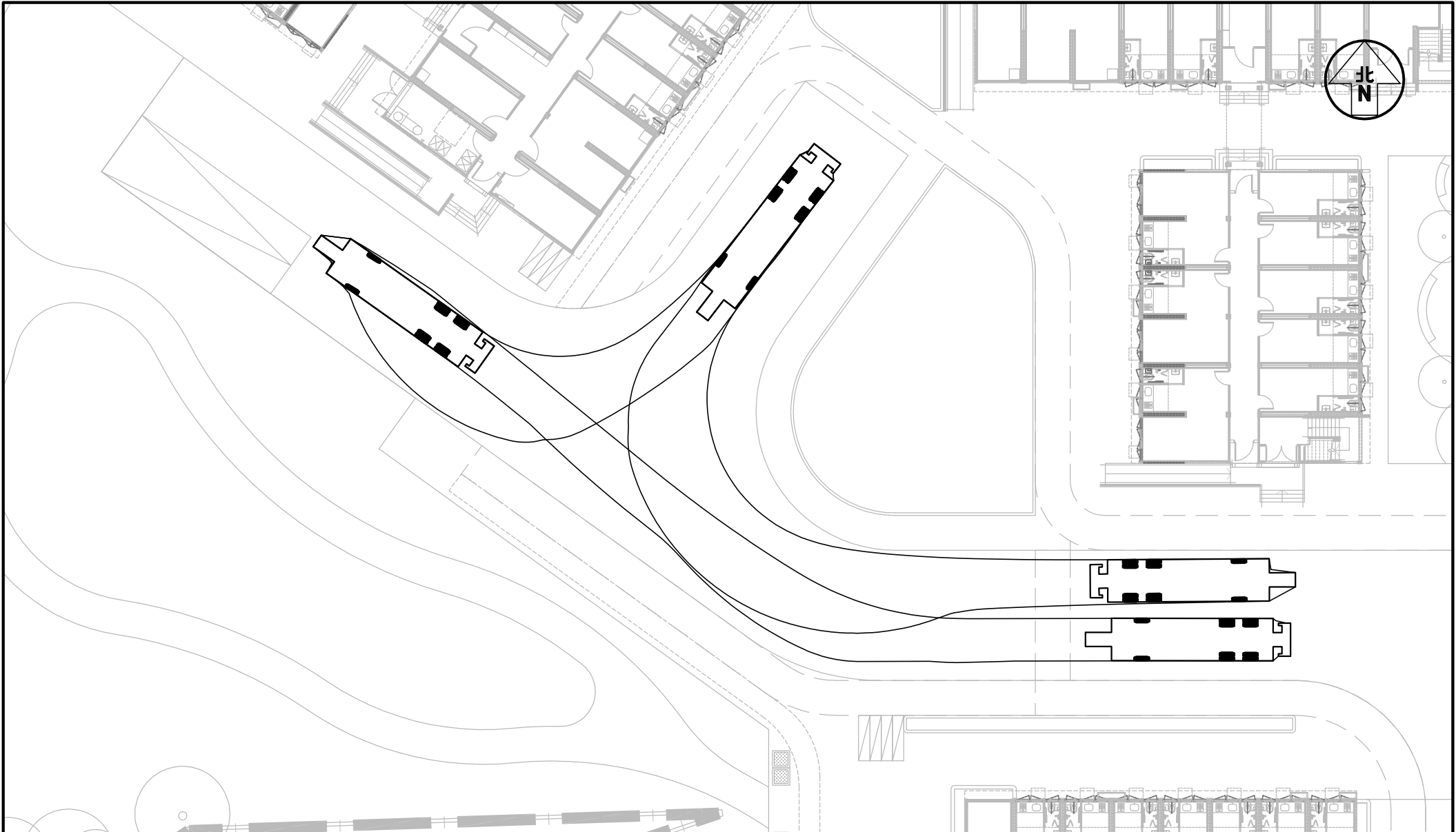

Project Title CONTRACT NO. SS M518 DESIGN AND CONSTRUCTION OF LIGHT PUBLIC HOUSING AT YAU POK ROAD, YUEN LONG, AT TUEN MUN AREA 3A AND AT CHOI HING ROAD, NGAU TAU KOK (DESIGN AND CONSTRUCTION STAGE) J7319

Figure No. SP/YPR/FV/4 Revision D

CKM Asia Limited

Figure Title
YAU POK ROAD SITE (ZONE 1) – SWEEP PATH OF FIRE APPLIANCE TURNING AROUND WITHIN ZONE 1

Designed by T H C	Drawn by C C L	Checked by K C
Scale in A4 1 : 300	Date 25 JUL 2024	

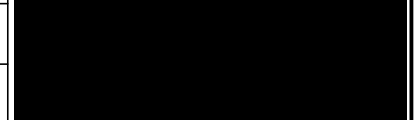

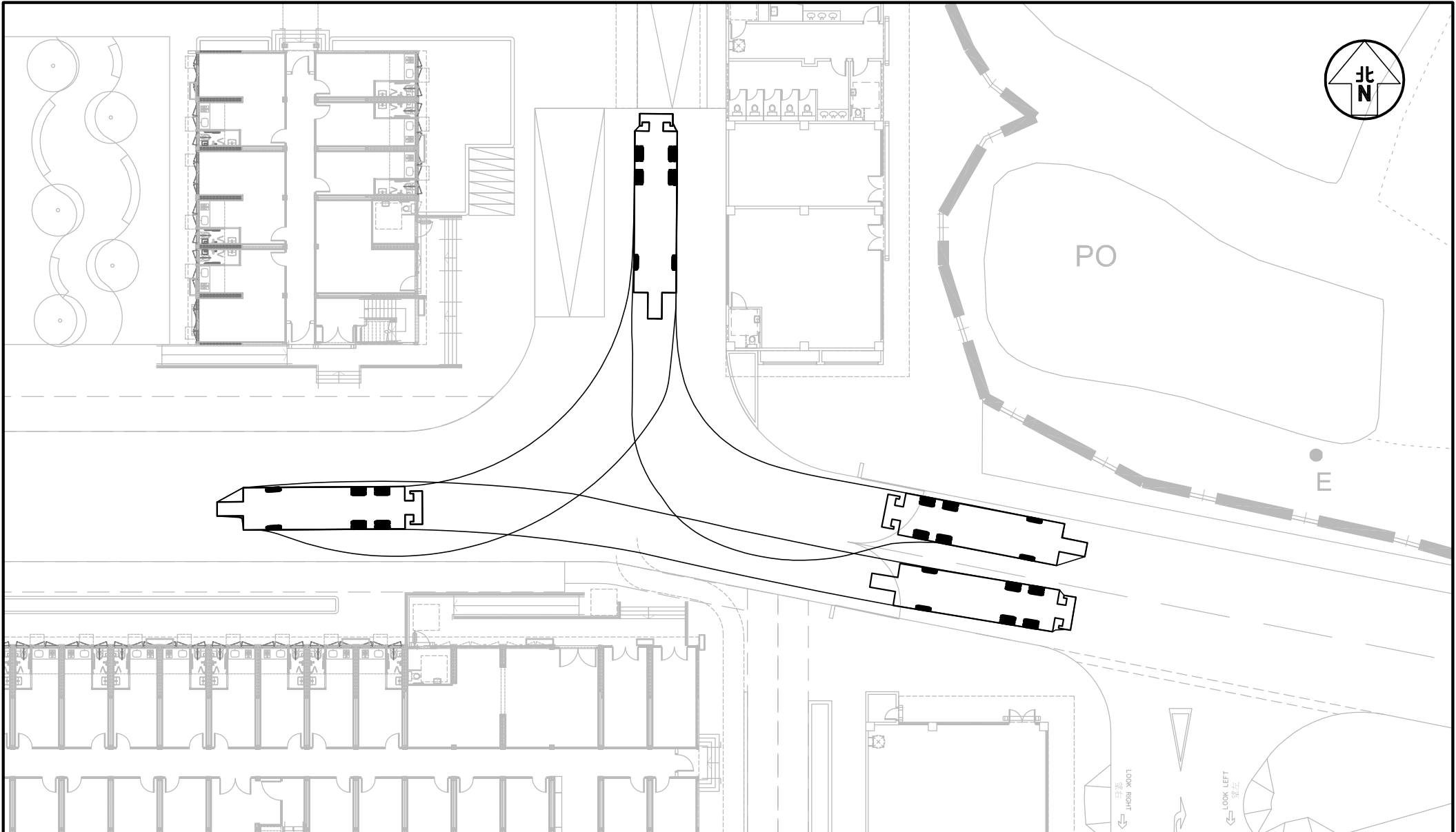

Project Title CONTRACT NO. SS M518 DESIGN AND CONSTRUCTION OF LIGHT PUBLIC HOUSING AT YAU POK ROAD, YUEN LONG, AT TUEN MUN AREA 3A AND AT CHOI HING ROAD, NGAU TAU KOK (DESIGN AND CONSTRUCTION STAGE) J7319

Figure No. SP/YPR/FV/5 Revision D

CKM Asia Limited

Figure Title YAU POK ROAD SITE (ZONE 1) – SWEEP PATH OF FIRE APPLIANCE TURNING AROUND WITHIN ZONE 1

Designed by T H C	Drawn by C C L	Checked by K C
Scale in A4 1 : 300	Date 25 JUL 2024	

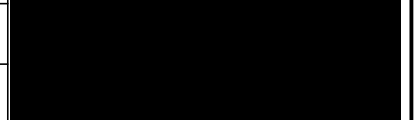

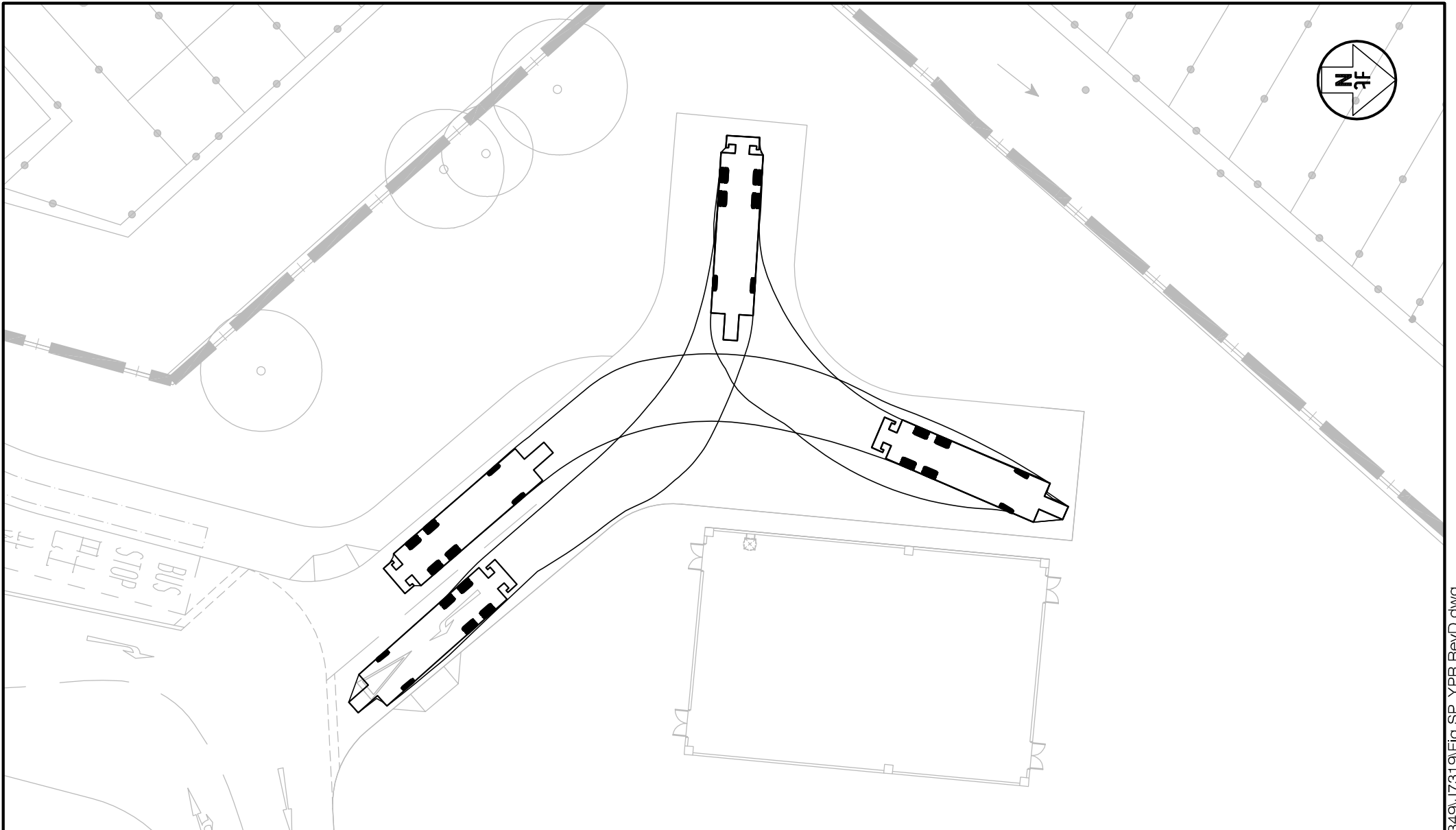

Project Title CONTRACT NO. SS M518 DESIGN AND CONSTRUCTION OF LIGHT PUBLIC HOUSING AT YAU POK ROAD, YUEN LONG, AT TUEN MUN AREA 3A AND AT CHOI HING ROAD, NGAU TAU KOK (DESIGN AND CONSTRUCTION STAGE) J7319

Figure No. SP/YPR/FV/6 Revision D

CKM Asia Limited

Figure Title
YAU POK ROAD SITE (ZONE 2) – SWEEP PATH OF FIRE APPLIANCE TURNING AROUND WITHIN ZONE 2

Designed by T H C	Drawn by C C L	Checked by K C
Scale in A4 1 : 300	Date 25 JUL 2024	

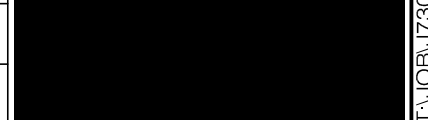

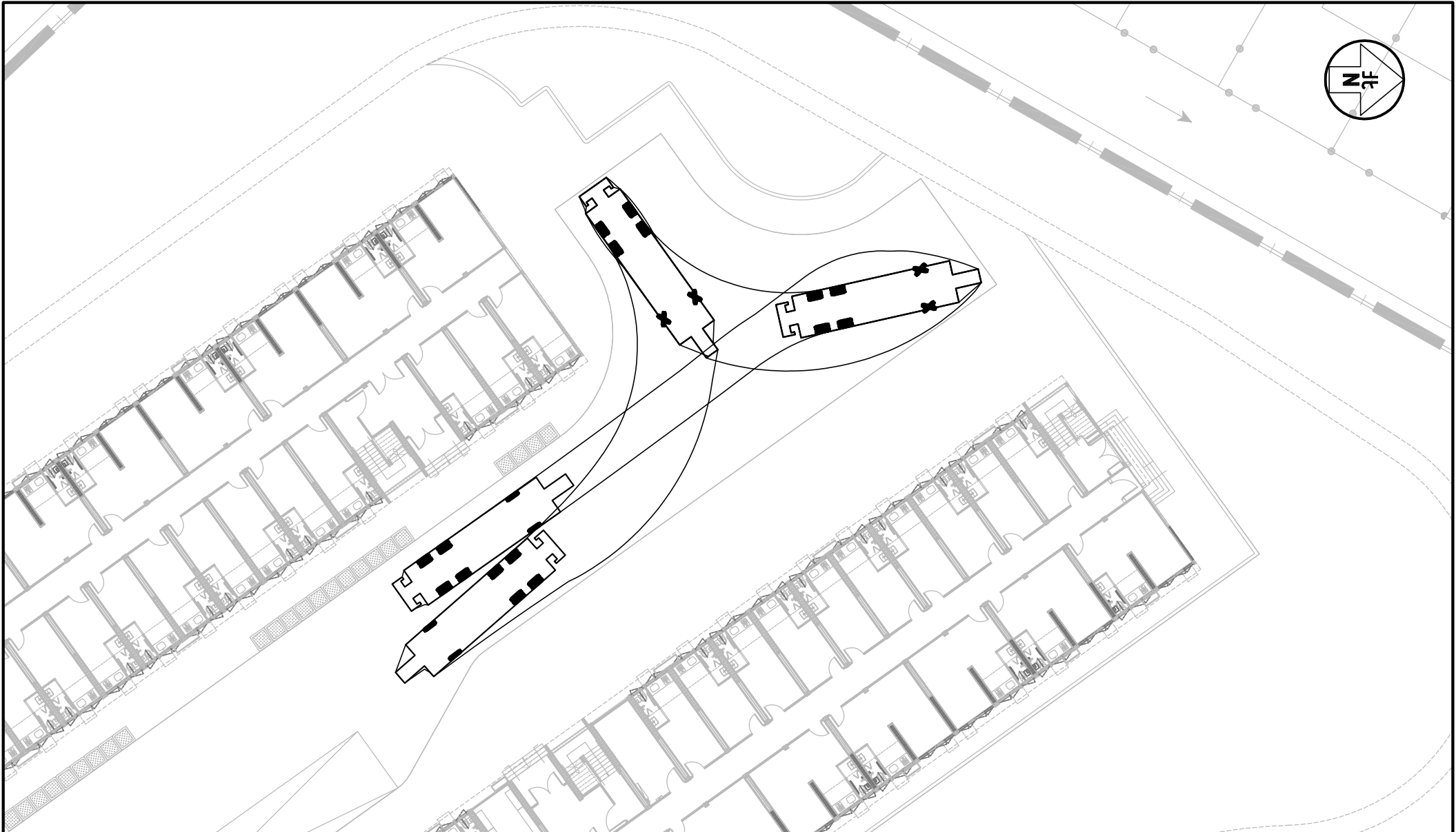

Project Title CONTRACT NO. SS M518 DESIGN AND CONSTRUCTION OF LIGHT PUBLIC HOUSING AT YAU POK ROAD, YUEN LONG, AT TUEN MUN AREA 3A AND AT CHOI HING ROAD, NGAU TAU KOK (DESIGN AND CONSTRUCTION STAGE) J7319

Figure No. SP/YPR/FV/7 Revision D

CKM Asia Limited

Figure Title YAU POK ROAD SITE (ZONE 2) – SWEPT PATH OF FIRE APPLIANCE TURNING AROUND WITHIN ZONE 2

Designed by T H C	Drawn by C C L	Checked by K C
Scale in A4 1 : 300	Date 25 JUL 2024	

T:\JOB\J7300-J7349\J7319\Fig_SP_YPR RevD.dwg