

TYPICAL CABLE TRENCH FOR SINGLE LV CABLE

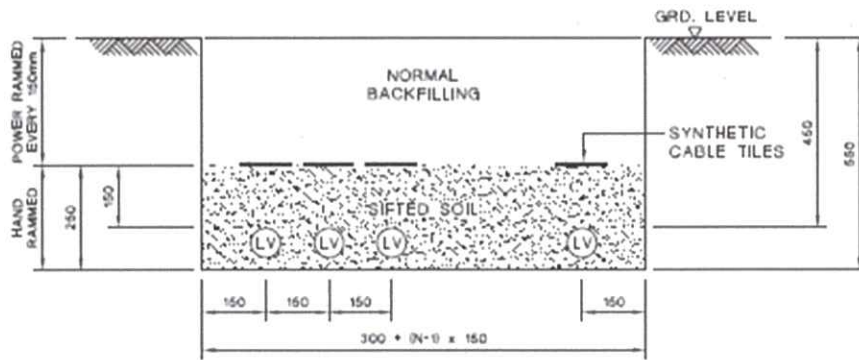

TYPICAL CABLE TRENCH FOR MULTIPLE LV CABLES

LEGEND :

- (LV) LV CABLE
- N NUMBER OF CABLE CIRCUITS

NOTES:

1. ALL SOIL BACKFILLING BENEATH CABLE TILES SHALL BE SIFTED THROUGH 12mm WIRE MESH.
2. ALL DIMENSIONS ARE IN mm.

C GENERAL REVISION		D GENERAL REVISION		A SYNTHETIC CABLE TILE SPECIFIED													
		REVS.	16-7-04	16-6-07	28-6-07												
		INITIAL	C.Y.P.	W.B.LEE	YKMAN												
DRAWN: S.C.T.		DATE: 15 Aug. 2003		TYPICAL LV CABLE TRENCH													
CHECKED: K. K. LEUNG		APPROVED: W. B. LEE															
SCALE: 1 : 15		SHEET(S) IN SET: 1		PROJECT NO.						CONTRACT NO.							
ASSET MANAGEMENT				DRG. NO. T GEN 25500 D E 33 0002 01 C A													

ALL RIGHTS RESERVED AND REPRODUCTION IN ANY FORM MUST BE APPROVED BY CLP POWER

Typical LV Cable Trench

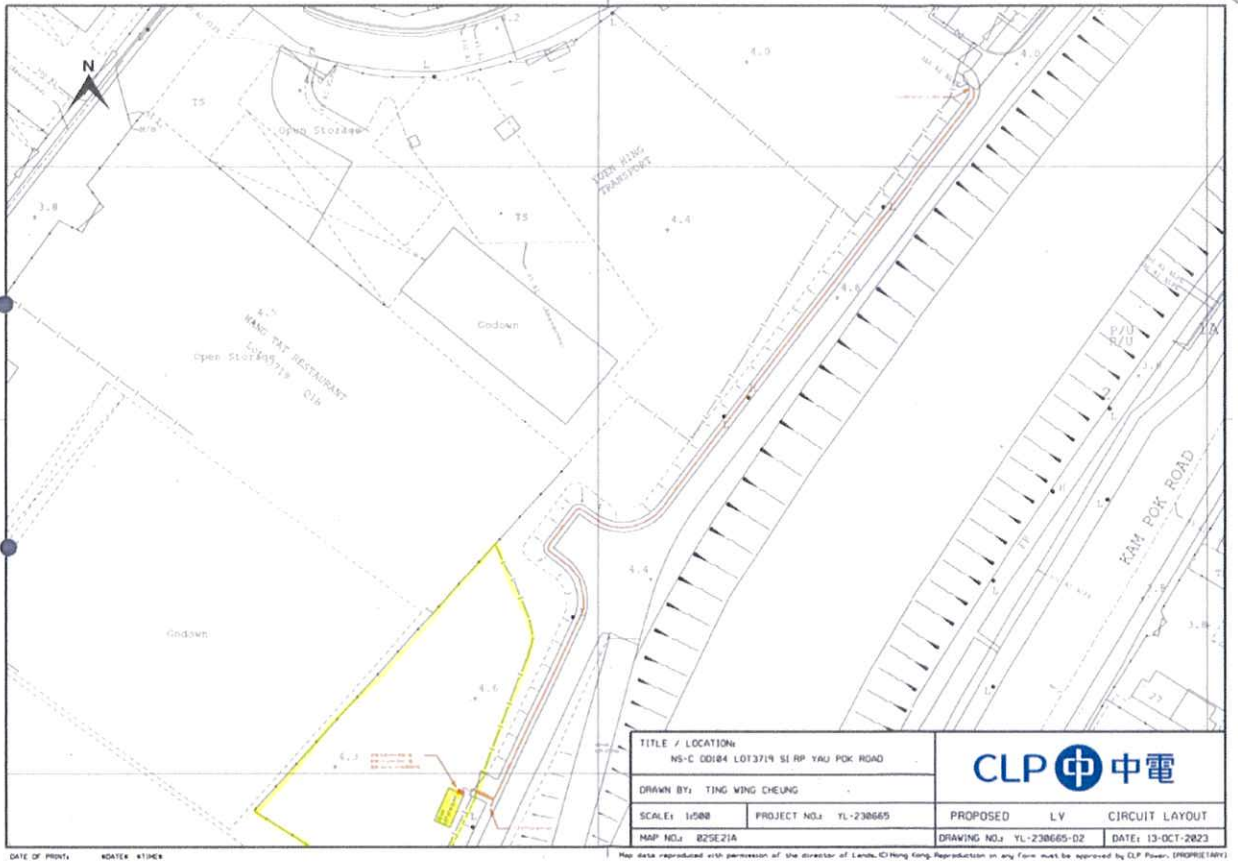

Layout Plan

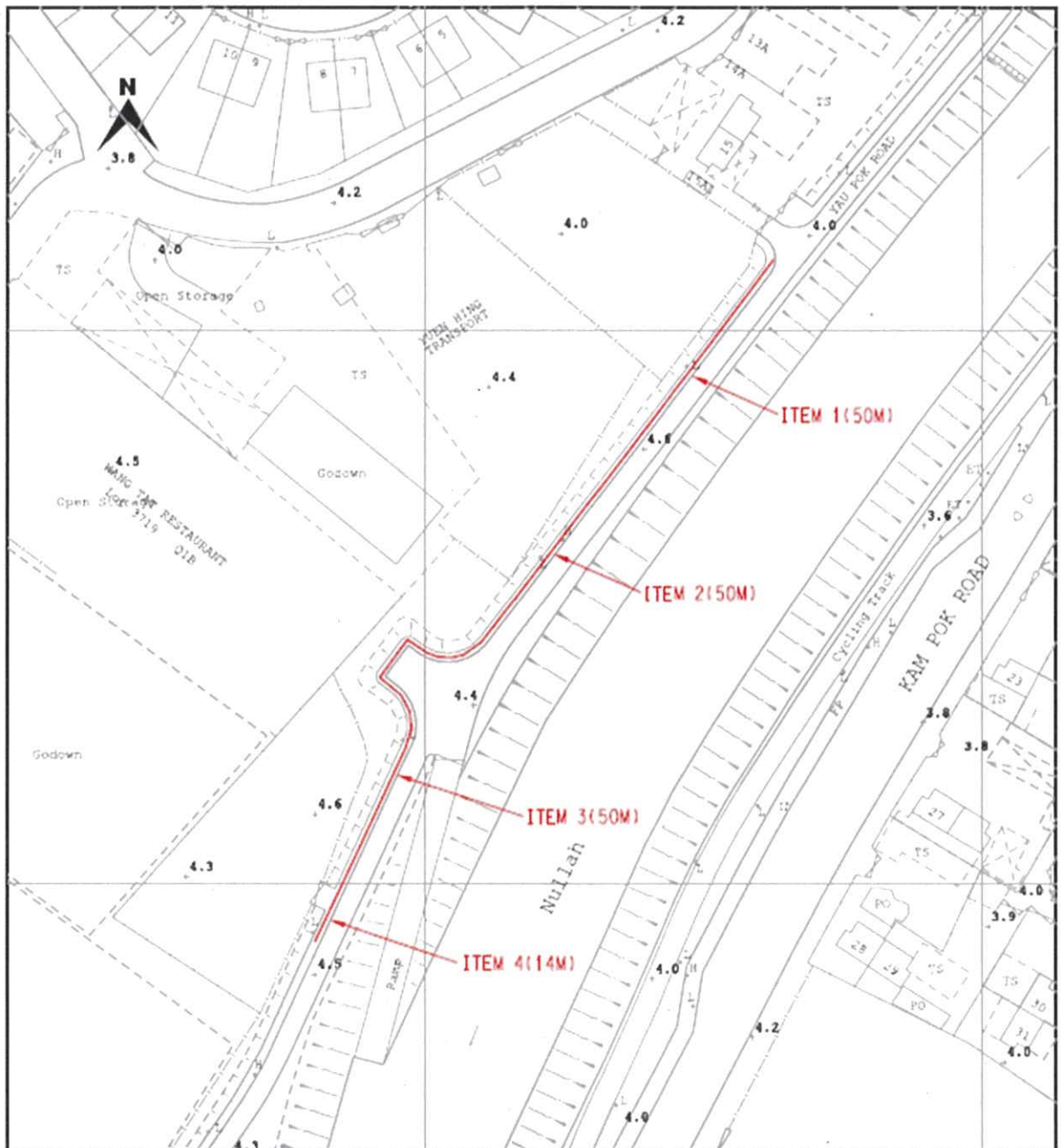

TITLE : LV Cable Laying
At You Pok Road

LEGEND

- PROPOSED TRENCH FOR LAYING / RECOVERING CABLE
- PROPOSED TRENCH FOR LAYING DUCTS
- PROPOSED CABLE THROUGH EXISTING DUCTS
- EXISTING PILLAR
- PROPOSED PILLAR 1.6M x 0.6M x 0.75M / CUTOUT BOX
- EXCAVATION FOR JOINTING / REPAIRING / INSPECTION CABLE
- EXISTING OVERHEAD LINE & POLE
- PROPOSED 11kV, LV, OHL, OF STEEL / WOODEN POLE
- OVERHEAD LINE & POLE TO BE REMOVED
- PROPOSED TREE TRIMMING / CUTTING
- EXISTING POLE MOUNTED TRANSFORMER
- PROPOSED POLE MOUNTED TRANSFORMER
- PROPOSED STAY / STAY POLE
- PROPOSED 3.6M(L) x 3.32M(W) x 2.7M(H) HV PILLAR

MAP NO : 02SE21A

DRAWN : BENSON

E/O NO :

CHECKED : S.W.TAM

REGION :NR

O.C. : YL

DATE : 24-11-2023

PROJECT REF. : YL2023-0665

SCALE : 1:1000

PLAN REF. : NRYL2023-0665-01

Map data reproduced with permission of the Director of Lands. © Hong Kong Information Classification PROPRIETARY

Location Plan

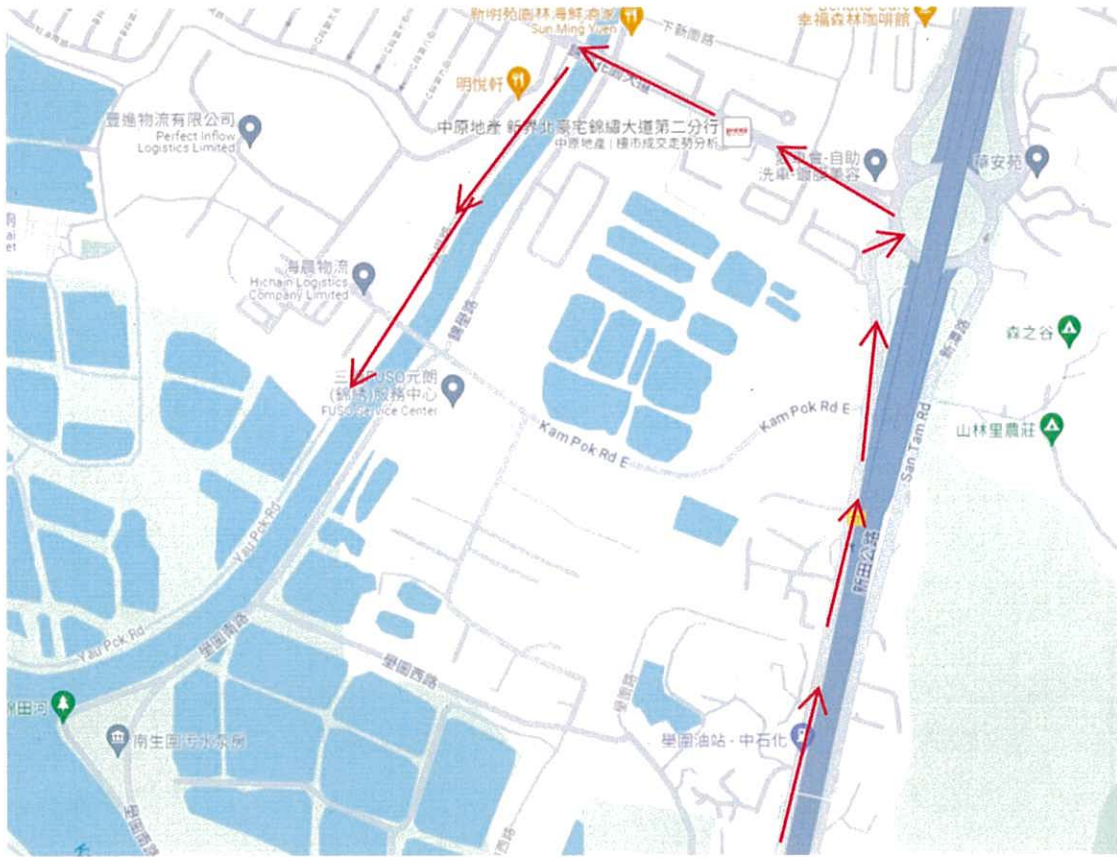

Vehicle Access Plan