

Location Plan showing the zoning of the application site

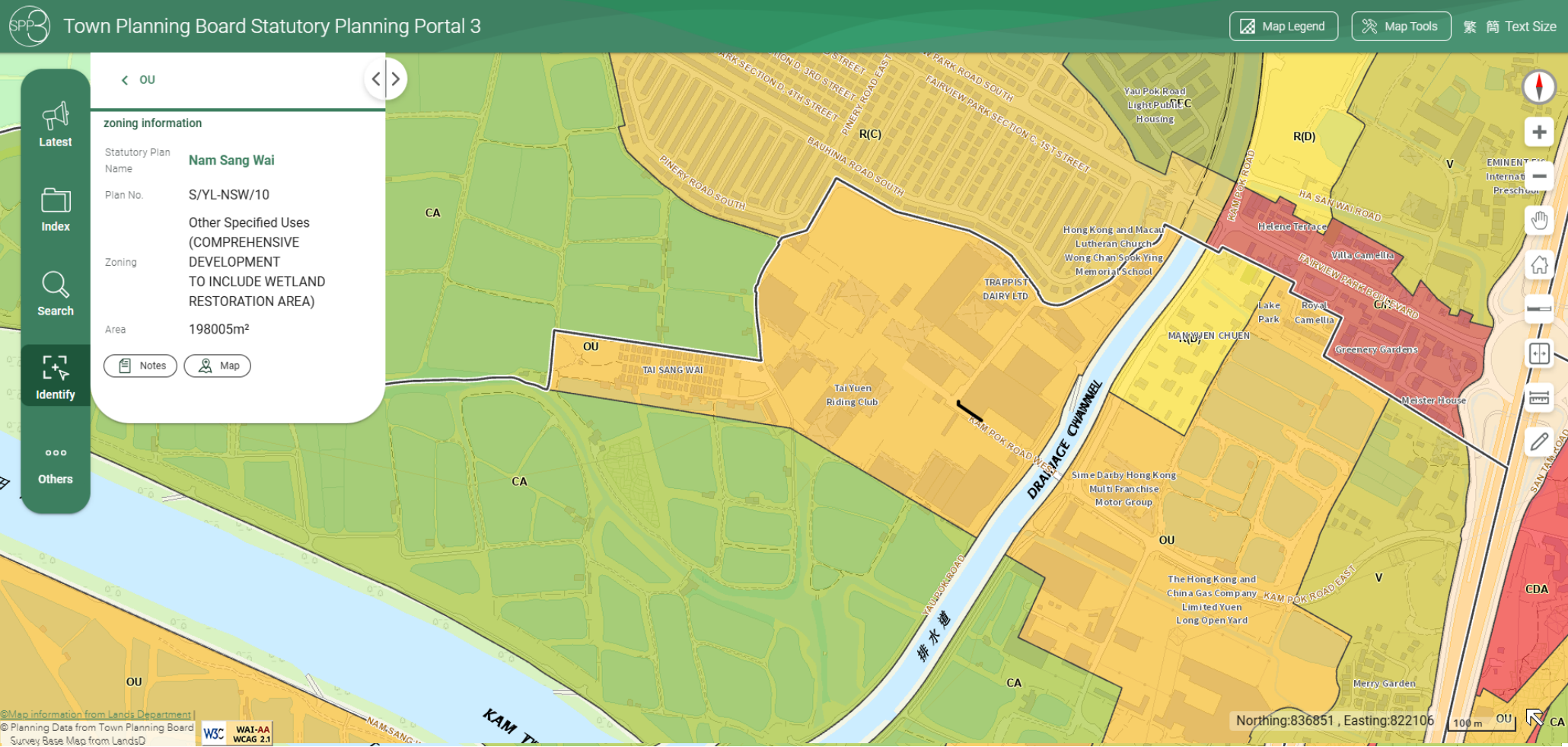

Plan showing the excavation and filling of land alignment

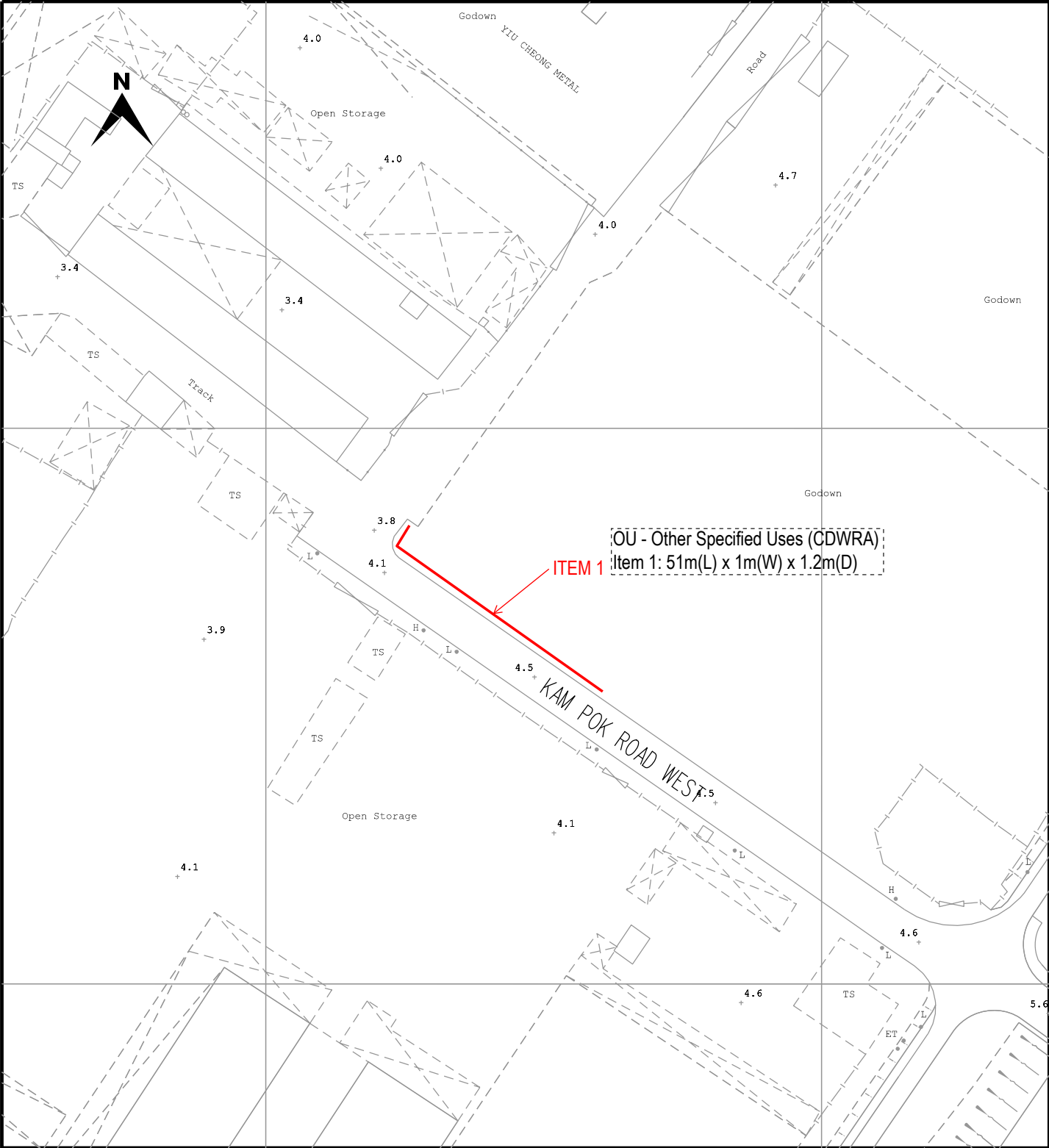

**TITLE :** 11kV CABLE LAYING  
AT KAM POK ROAD WEST

**MAP NO :** 02SE21A

<b>DRAWN :</b> BENSON	<b>E/O NO :</b>	
<b>CHECKED :</b> C.F.WONG	<b>REGION :</b> NR	<b>O.C. :</b> YL
<b>DATE :</b> 06-05-2025	<b>PROJECT REF. :</b> YL2024-0431	
<b>SCALE :</b> 1:1000	<b>PLAN REF. :</b> NRYL2024-0431-02	

**LEGEND**

- PROPOSED TRENCH FOR LAYING / RECOVERING CABLE
- PROPOSED TRENCH FOR LAYING DUCTS
- PROPOSED CABLE THROUGH EXISTING DUCTS
- EXISTING PILLAR
- PROPOSED PILLAR 1.6M x 0.6M x 0.75M / CUTOUT BOX
- EXCAVATION FOR JOINTING / REPAIRING / INSPECTION CABLE
- EXISTING OVERHEAD LINE & POLE
- PROPOSED 11kV, LV, OHL, OF STEEL / WOODEN POLE
- OVERHEAD LINE & POLE TO BE REMOVED
- PROPOSED TREE TRIMMING / CUTTING
- EXISTING POLE MOUNTED TRANSFORMER
- PROPOSED POLE MOUNTED TRANSFORMER
- PROPOSED STAY / STAY POLE
- PROPOSED 3.6M(L) x 3.32M(W) x 2.7M(H) HV PILLAR

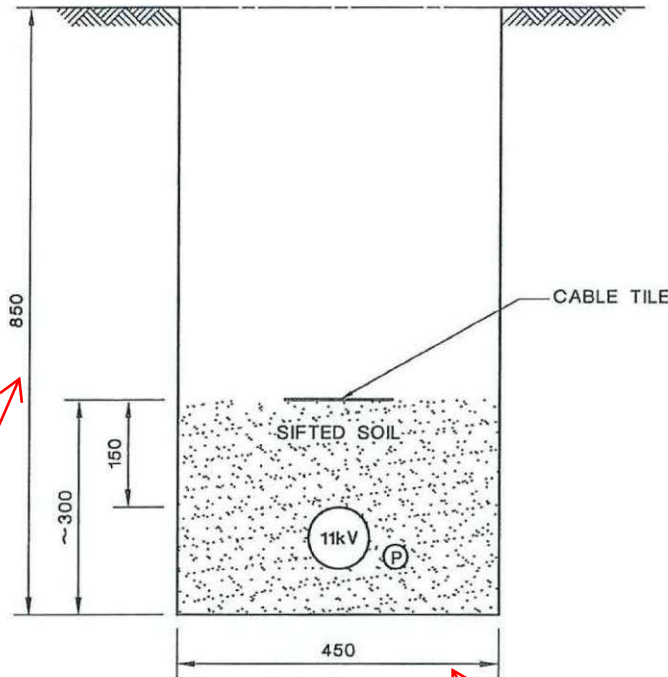

NOTES:

1. ALL SOIL BACKFILLING BENEATH CABLE TILES TO BE SIFTED THROUGH 12mm WIRE MESH.
2. ALL DIMENSIONS ARE IN mm

STANDARD 850mm  
(Buffer up to 1200mm)

EXISTING ARRANGEMENT OF 11kV CABLE TRENCH

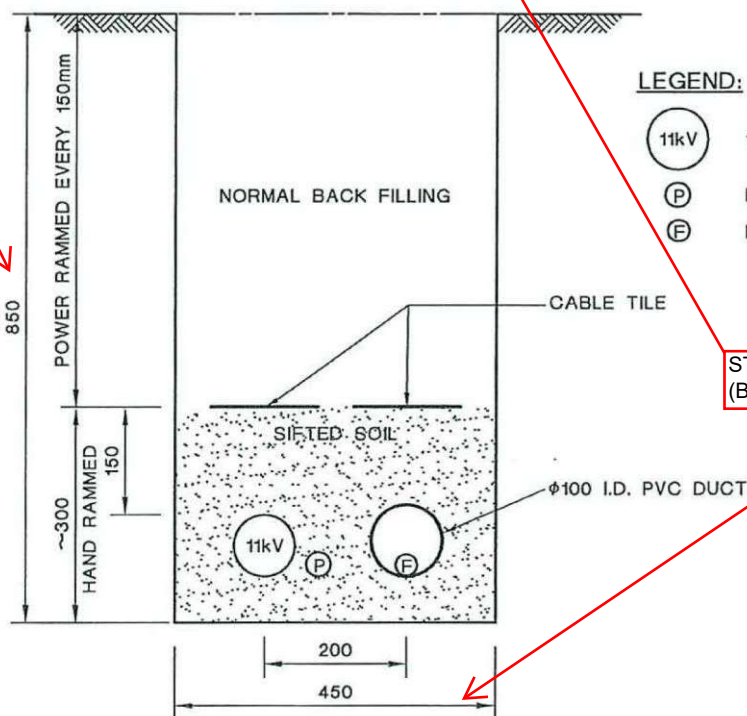

LEGEND:

- 11kV 11kV 3/C XLPE POWER CABLE
- P PILOT CABLE
- F FIBRE OPTIC CABLE

STANDARD 450mm  
(Buffer up to 1000mm)

11kV CABLE TRENCH WITH FIBRE OPTIC CABLE IN PVC DUCT

D	GENERAL REVISION		C	NOTE ADDED				A	NO AMENDMENT AFTER REVIEW						
<div>CLP 中電</div>				REVS.	15.8.03	4.4.07	18.6.07	28.6.11							
					A	B	C	D	E	F	G	H	J	K	L
				INITIAL	C.F.YAM	Y.K.MAN	W.B.LEE	Y.K.MAN							
				TITLE :											
				TYPICAL 11kV CABLE TRENCH WITH PILOT AND FIBRE OPTIC CABLES - TYPE II											
DRAWN: K. F. CHEUNG		DATE: 11-4-2000													
CHECKED: C. Y. IP		APPROVED: W. B. LEE													
SCALE:		SHEET(S) IN SET: 1		PROJECT NO.						CONTRACT NO.					
ASSET MANAGEMENT				DRG. NO. T GEN 10520 DE 33 0006 01 DA											