

**LOCATION OF THE APPLICATION SITE**

APPLICATION SITE AREA : 256 m<sup>2</sup> (ABOUT)

**VEHICULAR ACCESS**

ACCESSIBLE FROM NGAU TAM MEI ROAD VIA A LOCAL ACCESS

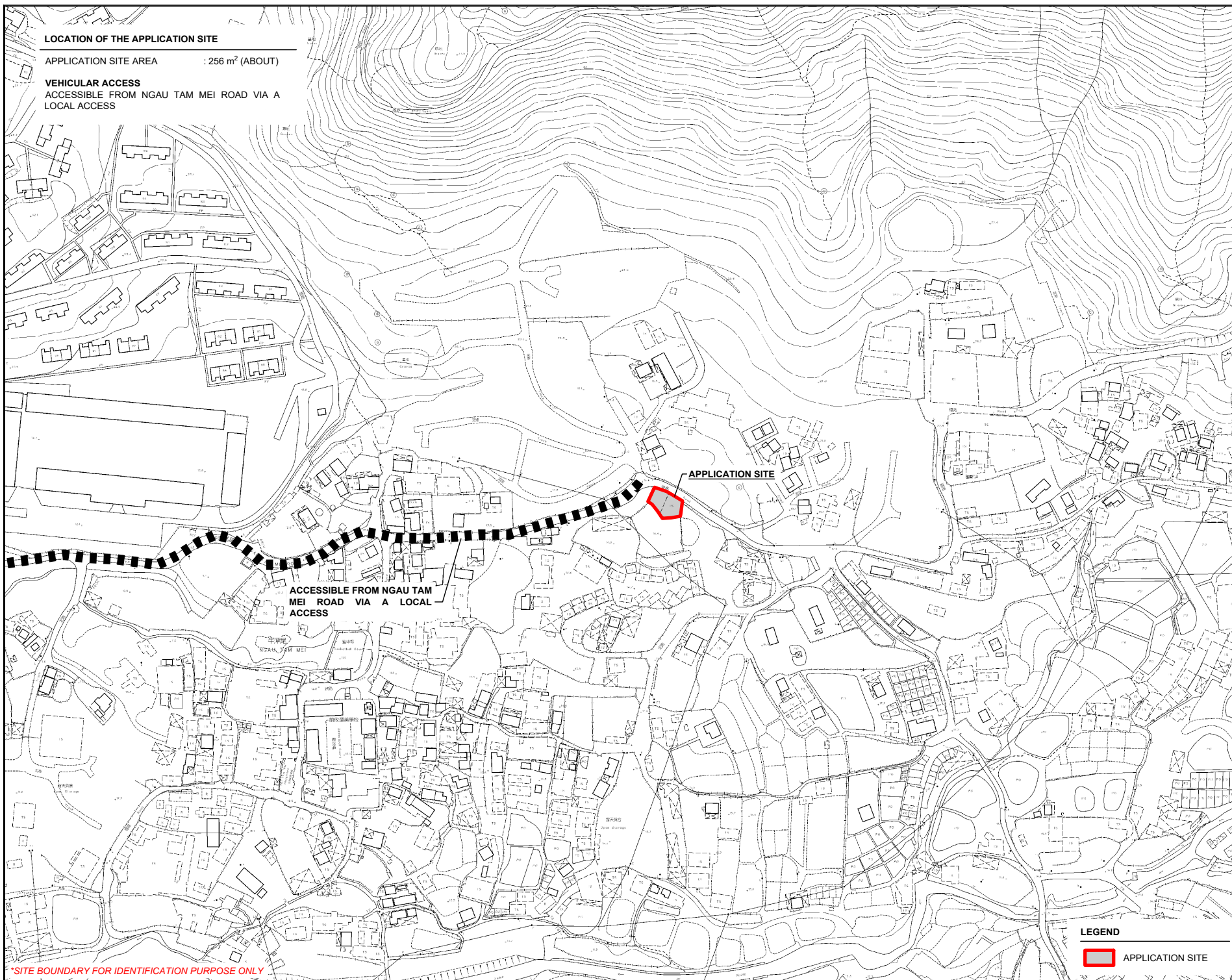
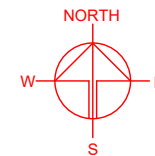

\*SITE BOUNDARY FOR IDENTIFICATION PURPOSE ONLY

PLANNING CONSULTANT



PROJECT

TEMPORARY SHOP AND SERVICES WITH ANCILLARY FACILITIES FOR A PERIOD OF 5 YEARS

SITE LOCATION

LOT 343 IN D.D. 104, NGAU TAM MEI, YUEN LONG, NEW TERRITORIES

SCALE  
1 : 3000 @ A4

DRAWN BY  
MN

DATE  
23.7.2025

REVISED BY

DATE

APPROVED BY

DATE

**LEGEND**

 APPLICATION SITE

DWG. TITLE  
LOCATION PLAN

DWG. NO.  
PLAN 1

VER.  
001

# ZONING OF THE APPLICATION SITE

APPLICATION SITE AREA : 256 m<sup>2</sup> (ABOUT)  
OUTLINE ZONING PLAN : APPROVED NGAU TAM MEI OZP  
OZP PLAN NO. : S/YL-NTM/14  
ZONING OF THE SITE : "RECREATION" ("REC")

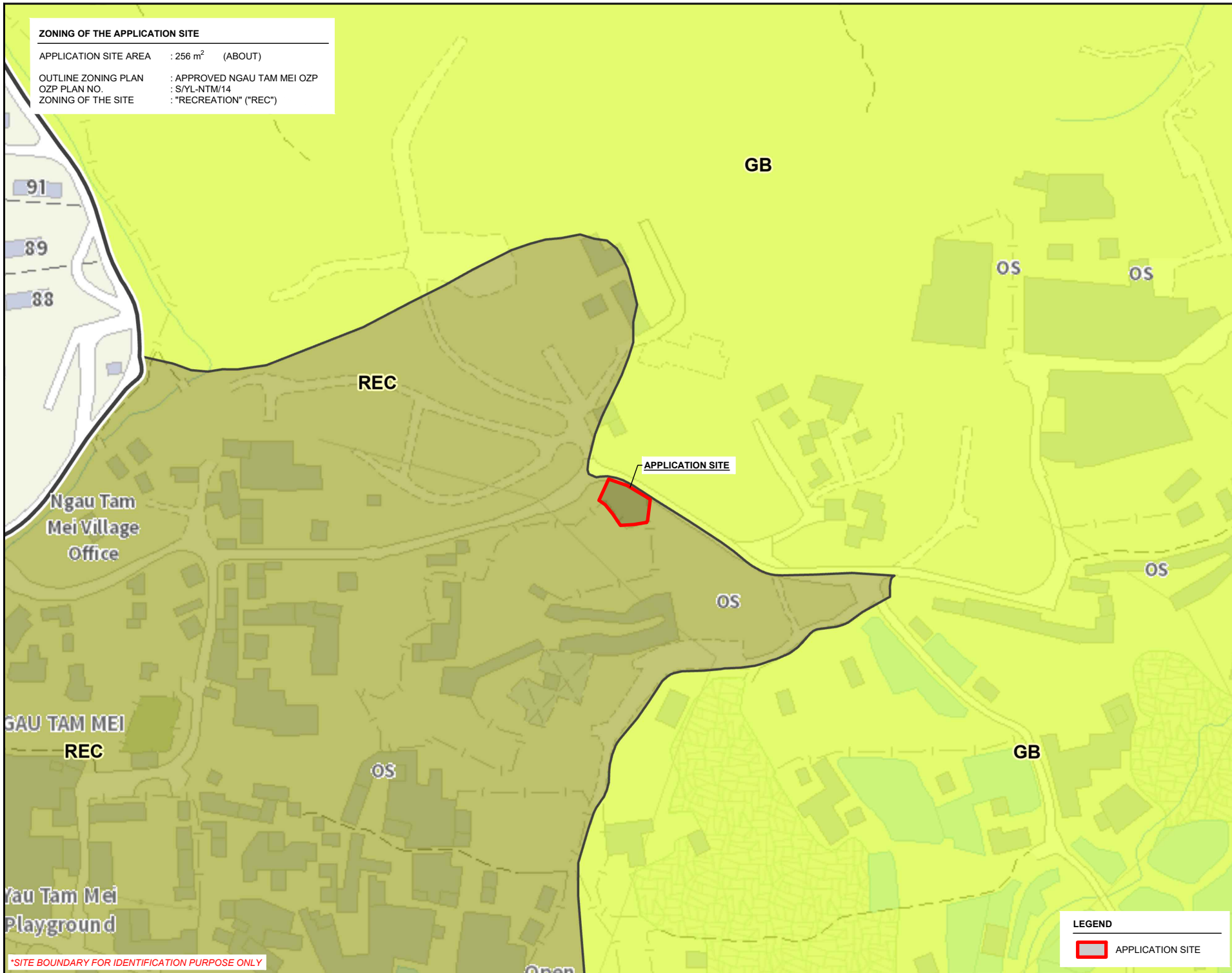
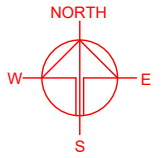

\*SITE BOUNDARY FOR IDENTIFICATION PURPOSE ONLY

PLANNING CONSULTANT



PROJECT

TEMPORARY SHOP AND SERVICES WITH ANCILLARY FACILITIES FOR A PERIOD OF 5 YEARS

SITE LOCATION

LOT 343 IN D.D. 104, NGAU TAM MEI, YUEN LONG, NEW TERRITORIES

SCALE

1 : 2000 @ A4

DRAWN BY

MN

DATE

23.7.2025

REVISED BY

DATE

APPROVED BY

DATE

## LEGEND



APPLICATION SITE

DWG. TITLE

ZONING OF THE SITE

DWG NO.

PLAN 2

VER.

001



APPLICATION SITE AREA	: 256 m <sup>2</sup>	(ABOUT)
AREA OF PRIVATE LAND	: 256 m <sup>2</sup>	(ABOUT)
AREA OF GOVERNMENT LAND	: NOT APPLICABLE	

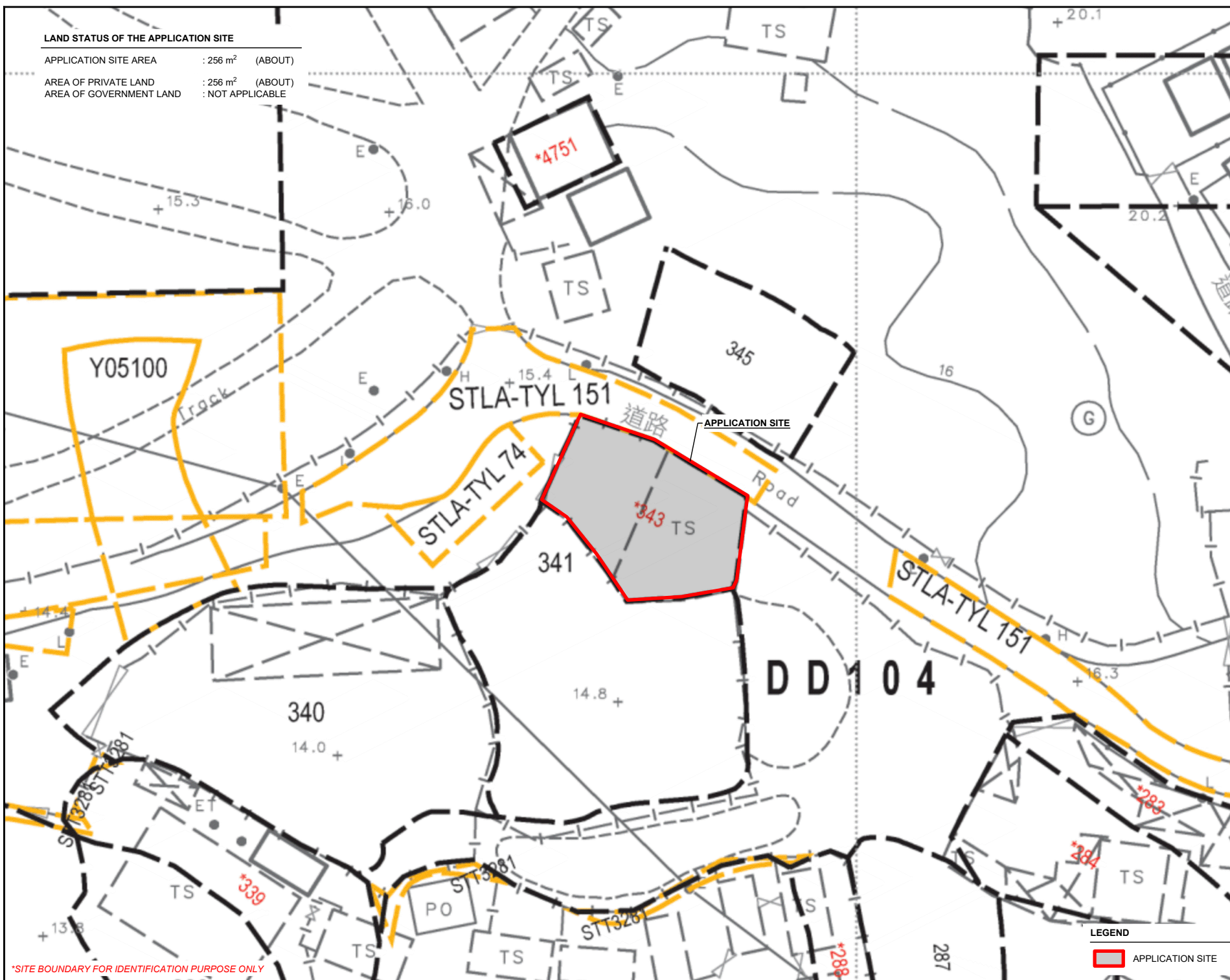
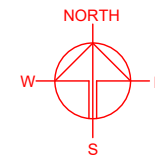

**\*SITE BOUNDARY FOR IDENTIFICATION PURPOSE ONLY**

PLANNING CONSULTANT



PROJECT

TEMPORARY SHOP AND SERVICES WITH ANCILLARY FACILITIES FOR A PERIOD OF 5 YEARS

SITE LOCATION

LOT 343 IN D.D. 104, NGAU TAM  
MEI, YUEN LONG, NEW  
TERRITORIES

SCALE  
1 : 500 @ A4

DRAWN BY	DATE
MN	23 7 2025

REVISED BY	DATE
------------	------

APPROVED BY	DATE
-------------	------

DWG. TITLE  
LAND STATUS OF THE SITE

DWG NO.	VER.
PLAN 3	00

DEVELOPMENT PARAMETERS

APPLICATION SITE AREA	: 256 m <sup>2</sup>	(ABOUT)
COVERED AREA	: 126 m <sup>2</sup>	(ABOUT)
UNCOVERED AREA	: 130 m <sup>2</sup>	(ABOUT)
PLOT RATIO	: 0.49	(ABOUT)
SITE COVERAGE	: 49 %	(ABOUT)
NO. OF STRUCTURE	: 1	
DOMESTIC GFA	: NOT APPLICABLE	
NON-DOMESTIC GFA	: 126 m <sup>2</sup>	(ABOUT)
TOTAL GFA	: 126 m <sup>2</sup>	(ABOUT)
BUILDING HEIGHT	: 4 m	(ABOUT)
NO. OF STOREY	: 1	

STRUCTURE	USE	COVERED AREA	GROSS FLOOR AREA	BUILDING HEIGHT
B1	SHOP AND SERVICES ANCILLARY OFFICE	126 m <sup>2</sup> (ABOUT)	126 m <sup>2</sup> (ABOUT)	4 m (ABOUT)(1-STOREY)
TOTAL		126 m <sup>2</sup> (ABOUT)	126 m <sup>2</sup> (ABOUT)	

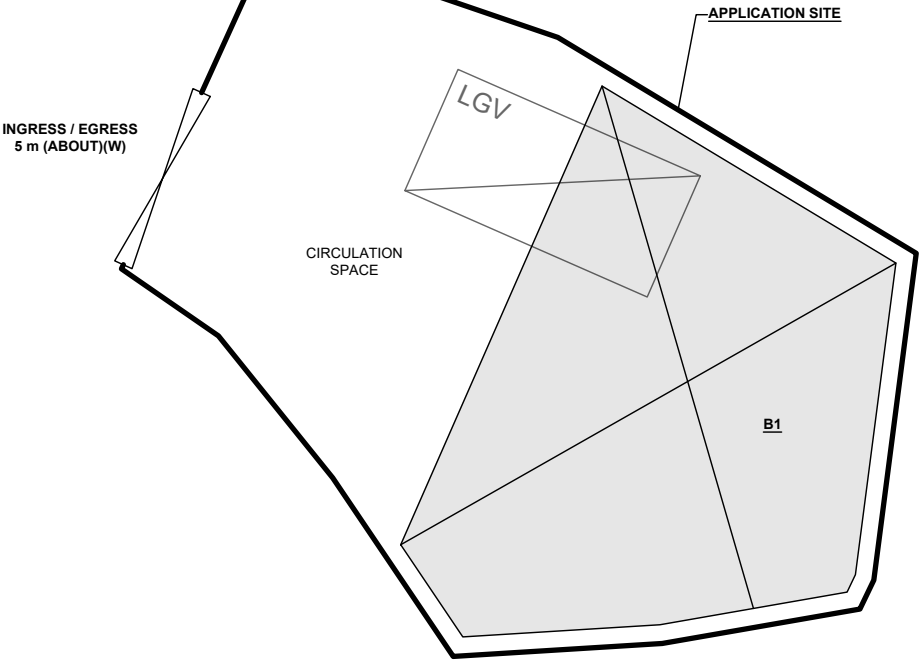
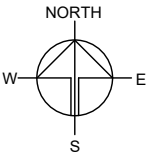

LOADING / UNLOADING (L/UL) PROVISIONS

NO. OF L/UL SPACE FOR LIGHT GOODS VEHICLE	: 1
DIMENSION OF PARKING SPACE	: 3.5 m (W) X 7 m (L)

\*SITE BOUNDARY FOR IDENTIFICATION PURPOSE ONLY

LEGEND

	APPLICATION SITE
	STRUCTURE
	L/UL SPACE (LGV)
	INGRESS / EGRESS

PLANNING CONSULTANT



PROJECT

TEMPORARY SHOP AND  
SERVICES WITH ANCILLARY  
FACILITIES FOR A PERIOD OF 5  
YEARS

SITE LOCATION

LOT 343 IN D.D. 104, NGAU TAM  
MEI, YUEN LONG, NEW  
TERRITORIES

SCALE

1 : 200 @ A4

DRAWN BY MN 23.7.2025

REVISED BY DATE

APPROVED BY DATE

DWG. TITLE  
LAYOUT PLAN

DWG NO. VER.  
PLAN 4 001

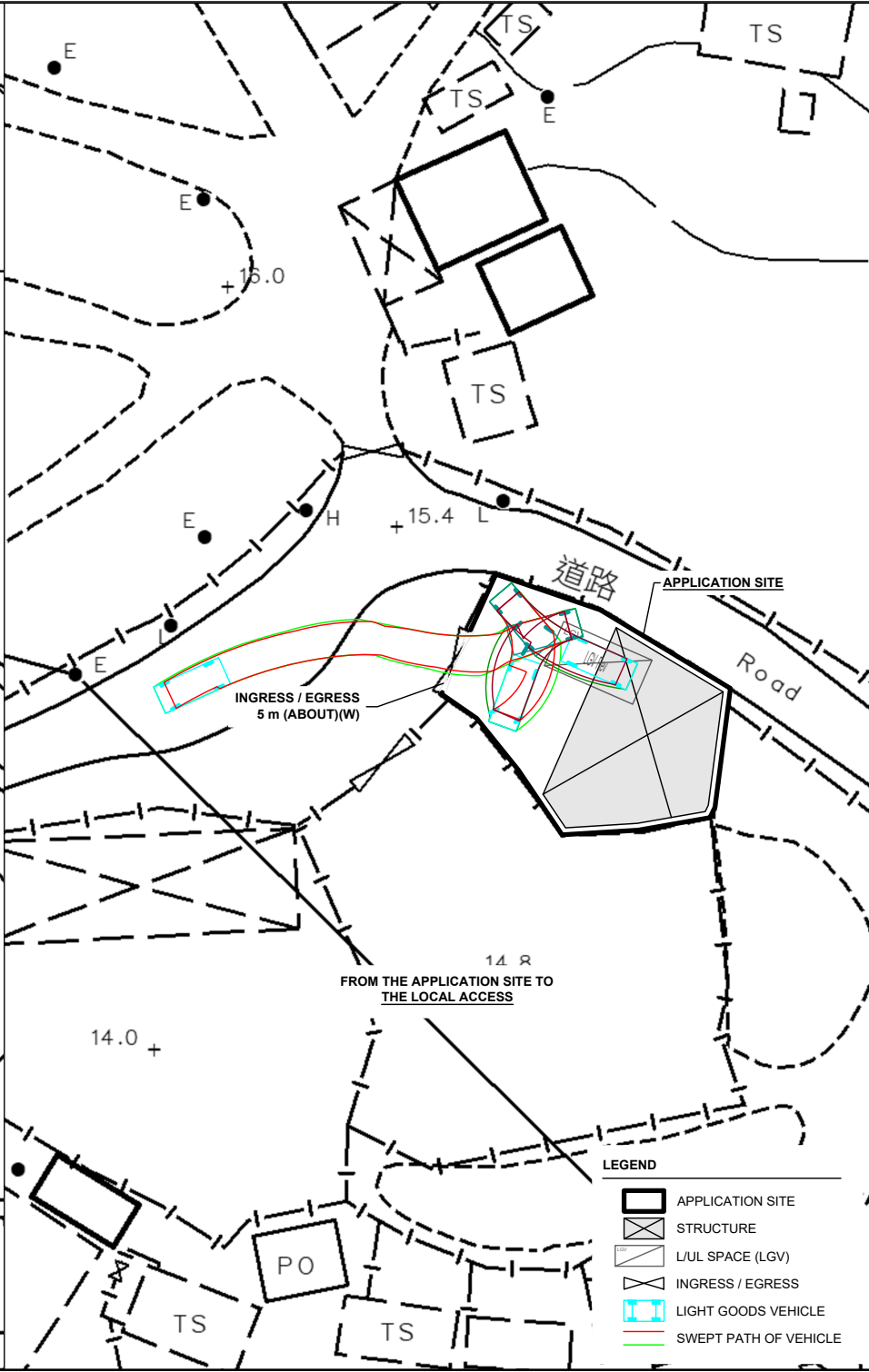
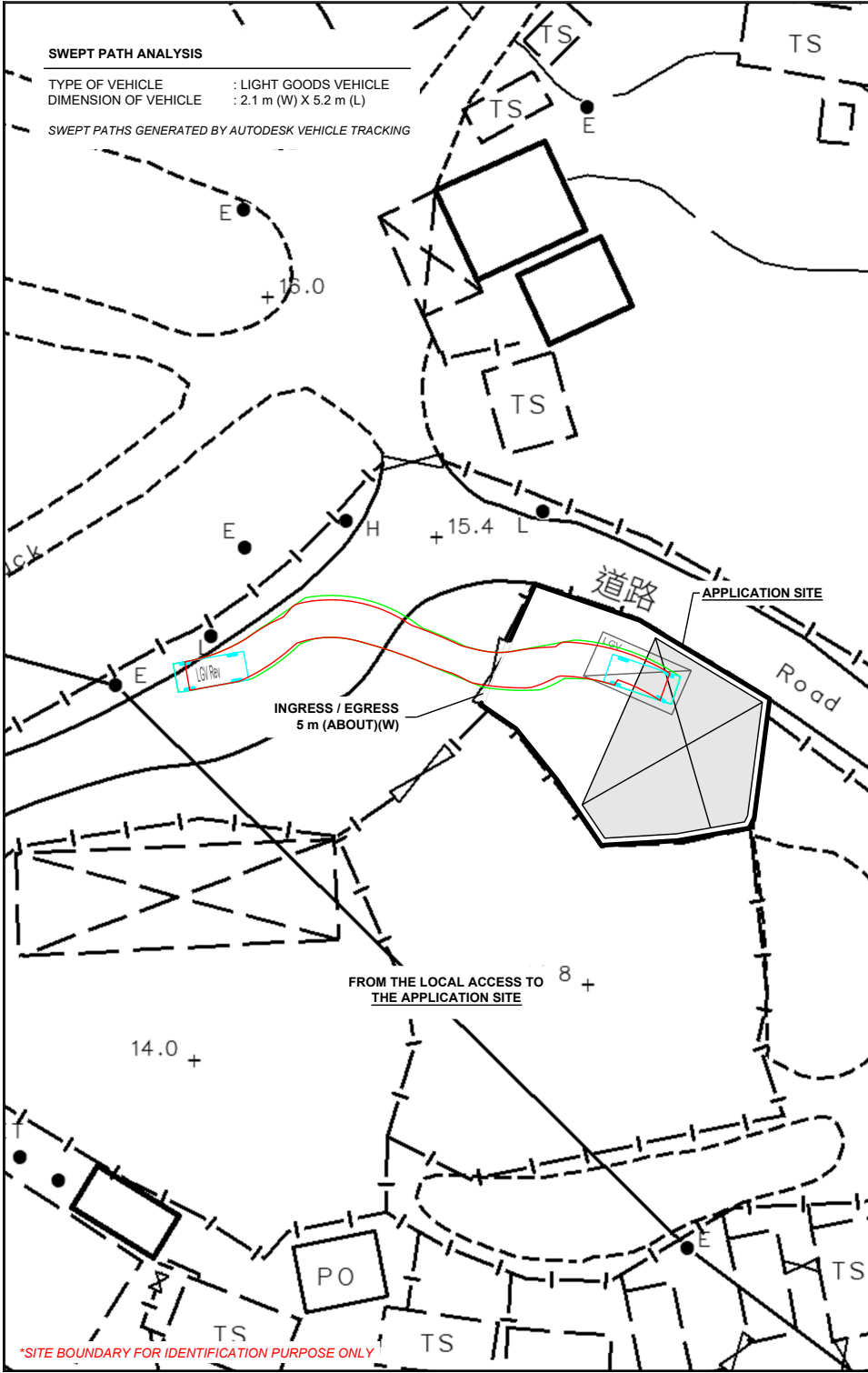

**NORTH**

PLANNING CONSULTANT

PROJECT

TEMPORARY SHOP AND SERVICES WITH ANCILLARY FACILITIES FOR A PERIOD OF 5 YEARS

SITE LOCATION

LOT 343 IN D.D. 104, NGAU TAM MEI, YUEN LONG, NEW TERRITORIES

SCALE

1 : 500 @ A4

DRAWN BY	DATE
MN	23.7.2025
CHECKED BY	DATE
APPROVED BY	DATE

DWG. TITLE

SWEPT PATH ANALYSIS

DWG NO.	VER.
PLAN 5	001

\*SITE BOUNDARY FOR IDENTIFICATION PURPOSE ONLY