



A & D SURVEYORS LTD.
先達測量師行有限公司

BUILDING SURVEYS - GOVERNMENT SUBMISSIONS - PROJECT MANAGEMENT - LICENSING
樓宇勘察 · 政府入則 · 項目策劃 · 牌照申請

Our Ref. : AA/FKR228/003
TPB Ref.: : A/YL-PH/1080
Date : 25 Sep 2025

Secretary, Town Planning Board
15/F North Point Government Offices
333 Java Road, North Point
Hong Kong

Attn.: Assistant Secretary

(By Hand)

Dear Sir/ Madam,

Re: Application for Planning Permission Approval of Temporary Horse Riding School at Lots 64RP, 72S.B. ss.2 and 73S.B RP in D.D. 108, Pat Heung, Yuen Long

Referring to the S.16 Planning Application at the captioned premises, we would like to submit the following :

1. Location Plan showing the route to adjacent horse riding training ground

Should you have any queries, please contact Mr. Martin Chan at 2797 2728 or [REDACTED]

Thank you for your kind attention.

Yours faithfully,

For and on behalf of

A & D Surveyors Ltd.

CHAN Kam Cheong

Encl.

c.c. Client

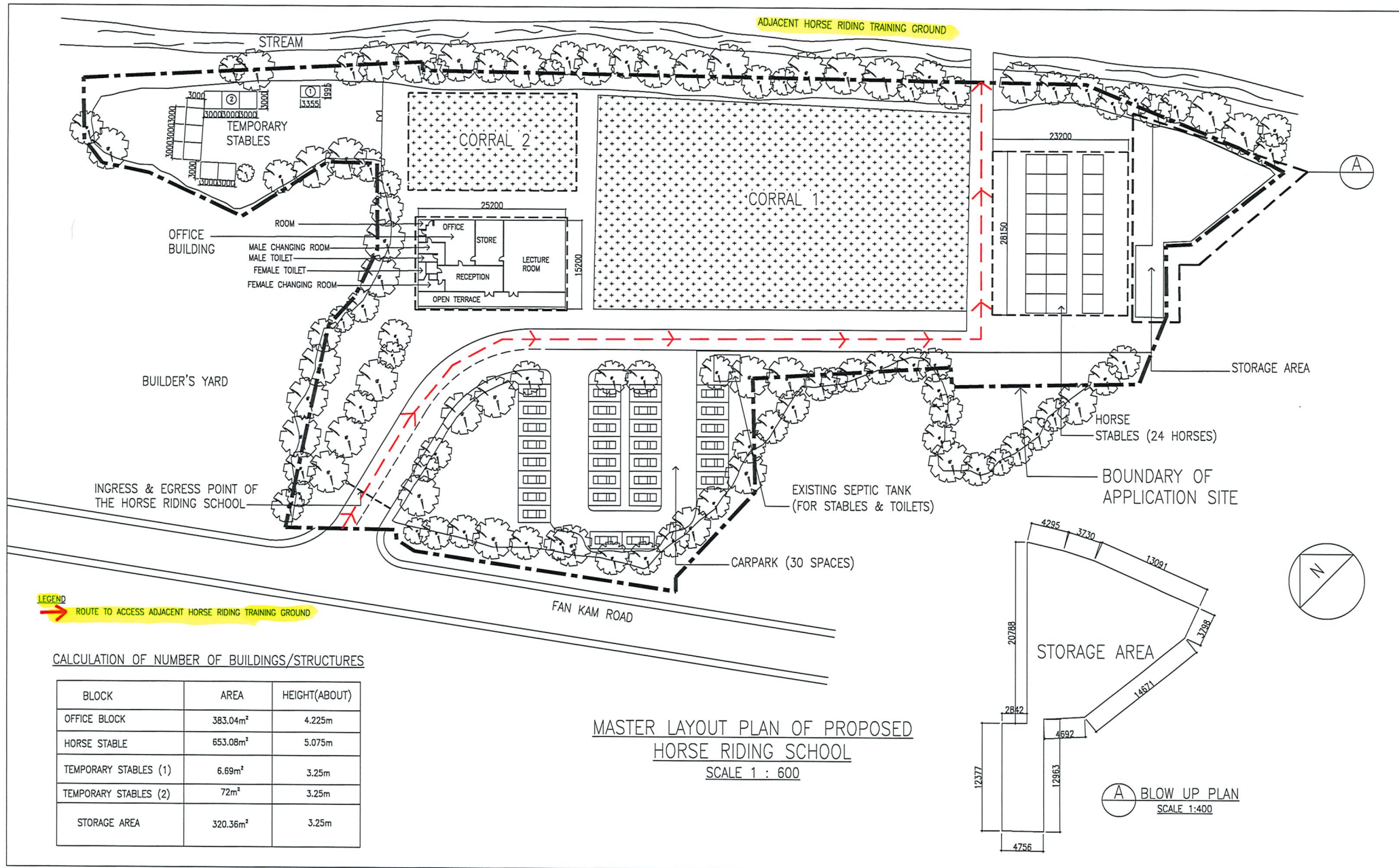



A & D SURVEYORS LTD.
先達測量師行有限公司

BUILDING SURVEYS - GOVERNMENT SUBMISSIONS - PROJECT MANAGEMENT - LICENSING
樓宇勘察・政府入則・項目策劃・牌照申請

Our Ref. : AA/FKR228/002
TPB Ref.: : A/YL-PH/1080
Date : 9 Sep 2025

Secretary, Town Planning Board
15/F North Point Government Offices
333 Java Road, North Point
Hong Kong

Attn.: Assistant Secretary

(By Hand)

Dear Sir/ Madam,

Re: Application for Planning Permission Approval of Temporary Horse Riding School at Lots 64RP, 72S.B. ss.2 and 73S.B RP in D.D. 108, Pat Heung, Yuen Long

Referring to the S.16 Planning Application at the captioned premises, we would like to clarify that the application proposes five number of buildings/structures and no change in the total floor area. The Application Site can accommodate a maximum of 20 persons per hour. It can be demonstrated by the attached trip generation calculation.

Should you have any queries, please contact Mr. Martin Chan at 2797 2728 or [REDACTED]

Thank you for your kind attention.

Yours faithfully,

For and on behalf of

A & D Surveyors Ltd.

CHAN Kam Cheong

Encl.

c.c. Client



A & D SURVEYORS LTD.
先達測量師行有限公司

BUILDING SURVEYS - GOVERNMENT SUBMISSIONS - PROJECT MANAGEMENT - LICENSING
樓宇勘察 · 政府入則 · 項目策劃 · 牌照申請

Our Ref. : AA/FKR228/001
TPB Ref.: : A/YL-PH/1080
Date : 21 July 2025

Secretary, Town Planning Board
15/F North Point Government Offices
333 Java Road, North Point
Hong Kong
Attn.: Assistant Secretary

(By Hand)

Dear Sir/ Madam,

Re: Application for Planning Permission Approval of Temporary Horse Riding School at Lots 64RP, 72S.B. ss.2 and 73S.B RP in D.D. 108, Pat Heung, Yuen Long

Referring to the captioned application and the latest comments from the Transport Department on 01 Feb 2024, please find the supplementary information as below:-

(A) Trip generation / attraction during weekdays and weekends

Based on our assumption on the maximum capacity of visitors and users, we assume that 9 persons and 20 persons will come to the horse-riding school within one hour during weekday and weekend respectively, in which 75% of them will be arrived by private car. The remaining number of people will come to the school by bus which can be dropped down conveniently nearby the Application Site. Therefore, about 7 and 15 private cars will park on the Application Site per hour on weekday and weekend respectively. The Application Site can provide a total of 30 numbers of car parking spaces which will be adequate to accommodate the attracted numbers of private cars.

Information of horse-riding class provided by operator:

1. Operation of riding school: 9am to 12pm ; 2pm to 6pm (Total 7 hours)
2. Number of class on weekday: 30 classes
3. Number of class on weekend: 70 classes
4. Size of class: Max. 2 persons

Assumption:

1. Average number of visitors arriving horse-riding school in one hour (weekday):
 $30 \text{ classes} \times 2 \text{ person} / 7 \text{ hours} = 9 \text{ persons}$



2. Average number of visitors arriving horse-riding school in one hour (weekend):
 $70 \text{ classes} \times 2 \text{ person} / 7 \text{ hours} = 20 \text{ persons}$
3. 75% of visitors come by private car
4. Number of private cars park in the Site in one hour (weekday): $9 \times 75\% = 7$
5. Number of private cars park in the Site in one hour (weekend): $20 \times 75\% = 15$

Should you have any queries, please contact Mr. Martin Chan at 2797 2728 or [REDACTED]

Thank you for your kind attention.

Yours faithfully,
For & on behalf of
A&D Surveyors Ltd.

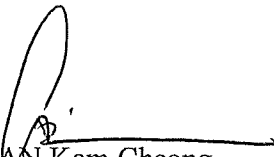

CHAN Kam Cheong

c.c. Client
c.c. Planning Department [REDACTED]

凱惠有限公司 HENWIN LIMITED

Our Ref.: HW/HO-2509/0018

TPB Ref.: A/YL-PH/1080

Date : 1st September 2025

Secretary, Town Planning Board
15/F North Point Government Offices 333 Java
Road, North Point
Hong Kong

Attn.: Assistant Secretary

(By Hand)

Dear Sir/ Madam,

Re: Application for Planning Permission Approval of Temporary Horse Riding School at Lots 64RP, 72S.B. ss.2 and 73S.B RP in D.D. 108, Pat Heung, Yuen Long

Referring to the S.16 application, A/YL-PH/1081, located at the East Side of our riding school, I would like to clarify that they can use our riding school facilities including parking spaces, access road, toilets and other school facilities. This training area act as a supporting facility for our riding school. In addition, it will not generate extra traffic flow and users.

Should you have any queries, please contact Mr. Martin Chan at 2797 2728 or [REDACTED]

Thank you for your kind attention. Yours

faithfully,

For and on behalf of

Henwin Limited



Name : LAI Wai

Applicant

[REDACTED]