

Proposed Temporary Community Shelter at Hobby Farm, CONCORDIA Tsat Sing Kong  
(Planning Application No. A/YL-PH/1083)

Further Information

Background of the Application

- The current application is to facilitate the provision of a pavilion and to allow flexibility for future development for the potential covered walkways within the domestic portion to serve the needs of the residents which aims to improve their living environment. The proposed pavilion is tentatively scheduled for completion in February 2026 while the potential covered walkways would be subject to the sufficient of funding or extra funding, and detailed design.
- The major development parameters for the temporary transitional housing development including the proposed pavilion and potential covered walkway are clarified as follows:

|                                              |                                                |
|----------------------------------------------|------------------------------------------------|
| Site Area                                    | 23,932m <sup>2</sup>                           |
| Plot Ratio                                   | 0.81                                           |
| Gross Floor Area (About)                     | 19,380m <sup>2</sup>                           |
| - Domestic                                   | 18,300m <sup>2</sup>                           |
| - Non-domestic                               | 1,080m <sup>2</sup>                            |
| Site Coverage                                | About 31.11%                                   |
| No. of Blocks/Structures                     | 22                                             |
| - Domestic                                   | 14                                             |
| - Non-domestic                               | 8                                              |
| Building Height                              | Not more than 4 storeys /<br>Not more than 15m |
| Parking Spaces                               |                                                |
| - Loading/unloading for Heavy Goods Vehicles | 6                                              |
| - Franchise Bus Stop                         | 1                                              |
| Number of Units                              | 909                                            |
| Greenery Area                                | About 7,467m <sup>2</sup>                      |
| Hobby Farm                                   | About 8,049m <sup>2</sup>                      |

- The hobby farms are accessible by both the residents and general public and the operation hours is open from 9AM to 6PM.
- The current application would involve changes in development parameters compared with the previous application No. A/YL-PH/999. A new set of building plans for the proposed pavilion the covered walkways will be submitted for approval.

## Essential Ancillary Facility for Hobby Farm

The proposed pavilion is located at the hobby farm at the west plot of the application land and the structural material of the proposed pavilion will be Galvanised Mild Steel (GMS). It serves as an essential ancillary facility to support the farm's operation as well as a focal point to identify the place and provides necessary shading to a large open space with over 5,600m<sup>2</sup> at the Northern portion of the West Plot. It serves as an essential covered rest space for residents for using the farming facilities, as the site is overcast with no shelter, the users are have no weather protection. Essential amenities for farm include storage and tables to handle for produces will support the use of the open space. Loose furniture for example benches, tables and storage shelves would be provided for residents.

## Social Gathering Point for Community Activities

The pavilion will serve as a focal point to gathering residents, supporting social interactions, the aim is to provide a place for building the network for the community to encourage self-help and neighbourhood support for the low-income community in transitional housing. The shelter supports the use of the hobby farm, enable a cover space to carry out agricultural education, farming and planning workshops. It would also support farm-to-table activities for residents, and daily activities such as group exercises and gatherings. The site demographics compose of majority elderly, it is especially beneficial to provide a sheltered area for short rest to encourage the enjoyment of the facilities in hobby farm by elders as well as other age groups.









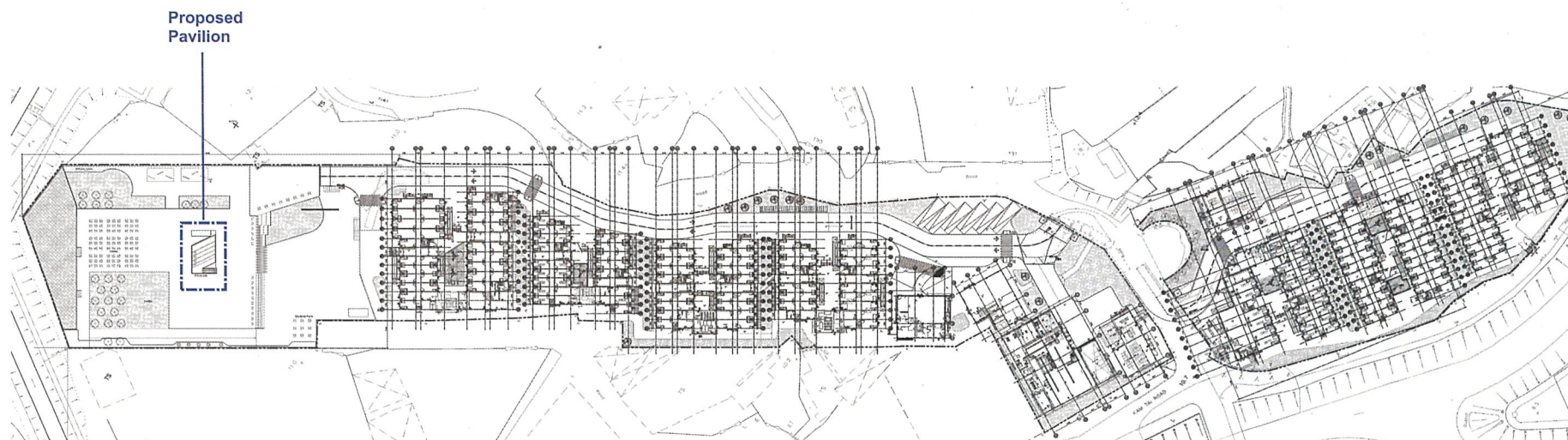

多磨建社  
DOMAT

Notes: Do not scale from these drawings. All dimensions should be verified on site. The copyright of this drawing belongs to Domat Limited.

Project : PROPOSED TEMPORARY TRANSITIONAL HOUSING & HOBBY FARM  
DEVELOPMENT AT TSAT SING KONG, PAT HEUNG, KAM TIN, YUEN LONG  
Drawing Title : MASTER LAYOUT PLAN  
Scale : 1:1,000

Drawing Number : MP00  
Revision : -  
Date : 2025-09-11



