

Proposed Temporary Public Vehicle Park (Private Cars) & Open Storage of Construction Machinery and Construction Materials and Associated Filling of Land for a Period of 3 Years

at

Lots 106 (Part), 107 (Part), 289 (Part), 293 (Part), 294 (Part), 295 (Part), 301 (Part), 302 (Part) and 319 (Part) in D.D. 126, Fung Ka Wai, Ping Shan, Yuen Long, N.T.

Annex 1 Estimated Traffic Generation

- 1.1 The application site is serviced by Tin Wah Road (**Figure 2**).
- 1.2 The application site will be opened for storage of construction machinery and construction materials and public parking of private cars only. 30 parking spaces for public parking of private car and 1 loading/unloading space for the loading/unloading of construction machinery and construction materials are proposed for the proposed development.
- 1.3 The application site is subject to a previous planning permission for public parking of private cars. The estimated average traffic generation and traffic generation rate at peak hours are as follow:

Type of vehicle	<u>Average Traffic Generation Rate</u> (pcu/hr)	<u>Average Traffic Attraction Rate</u> (pcu/hr)	<u>Traffic Generation Rate at Peak Hours</u> (pcu/hr)	<u>Traffic Attraction Rate at Peak Hours</u> (pcu/hr)
Private car	1	1	11	8
Light goods vehicle	0.3	0.3	1.5	0
Total	1.3	1.3	12.5	8

Note 1: The opening hour of the open storage use is restricted to 9:00 a.m. to 7:00 p.m. from Mondays and Saturdays. No operation will be carried out on Sundays including public holidays; The proposed public vehicle park is opened 24 hours.

Note 2: The pcu of private car and light goods vehicle is assumed as 1 and 1.5 respectively; &

Note 3: Morning peak is defined as 7:00a.m. to 9:00a.m. whereas afternoon peak is defined as 5:00p.m. to 7:00p.m.

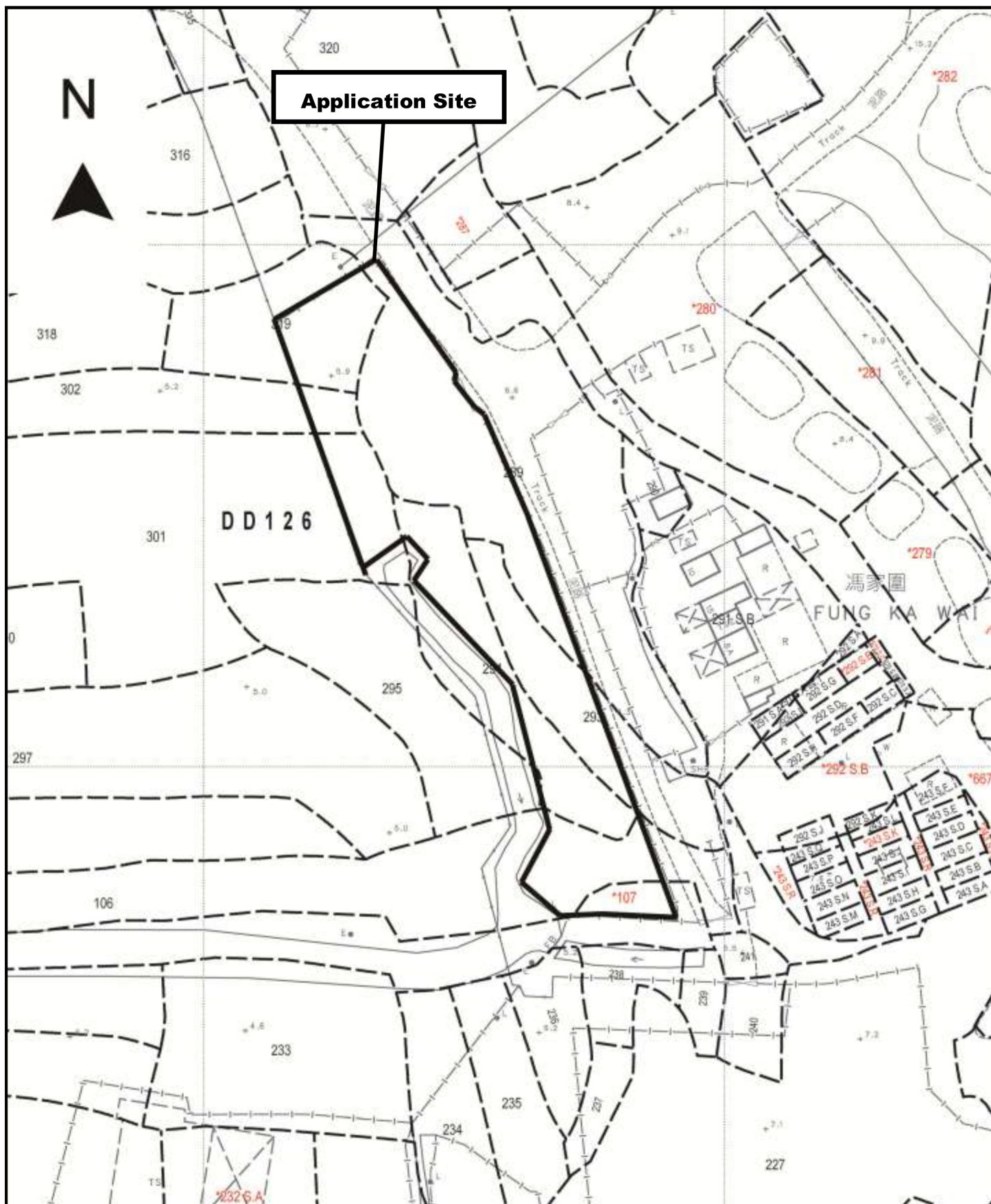

Project 項目名稱:

Proposed Temporary Public Vehicle Park (Private Cars) & Open Storage of Construction Machinery and Construction Materials and Associated Filling of Land for a Period of 3 Years at Lots 106 (Part), 107 (Part), 289 (Part), 293 (Part), 294 (Part), 295 (Part), 301 (Part), 302 (Part) and 319 (Part) in D.D. 126, Fung Ka Wai, Ping Shan, Yuen Long, N.T.

Drawing Title 圖目:

Site Plan

Drawing No. 圖號:

Figure 1

Remarks 備註:

Scale 比例:

1:1000

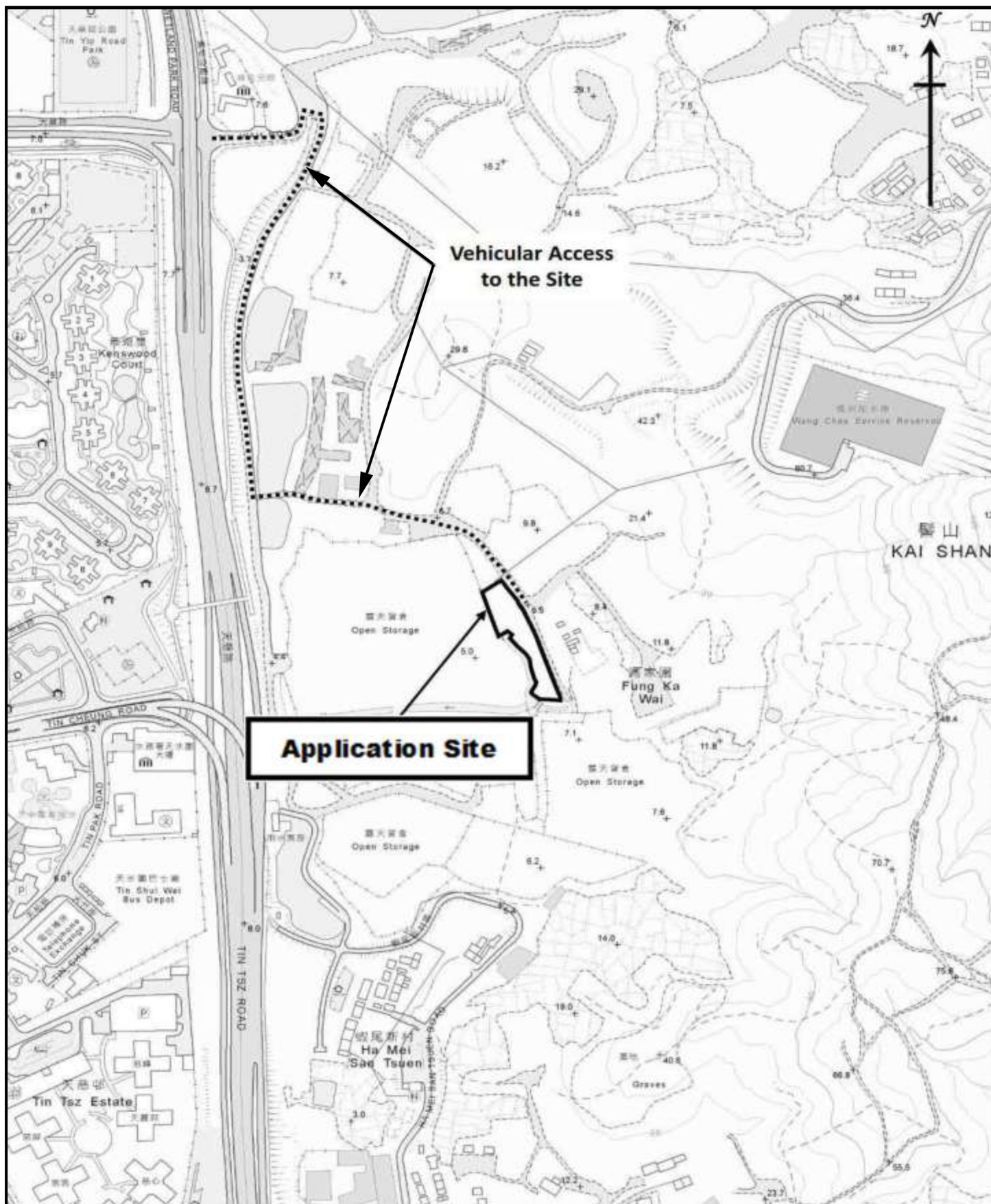

Project 項目名稱:

Proposed Temporary Public Vehicle Park (Private Cars) & Open Storage of Construction Machinery and Construction Materials and Associated Filling of Land for a Period of 3 Years at Lots 106 (Part), 107 (Part), 289 (Part), 293 (Part), 294 (Part), 295 (Part), 301 (Part), 302 (Part) and 319 (Part) in D.D. 126, Fung Ka Wai, Ping Shan, Yuen Long, N.T.

Drawing Title 圖目:

Vehicular Access Plan

Drawing No. 圖號:

Figure 2

Remarks 備註:

Scale 比例:

Not to scale

N

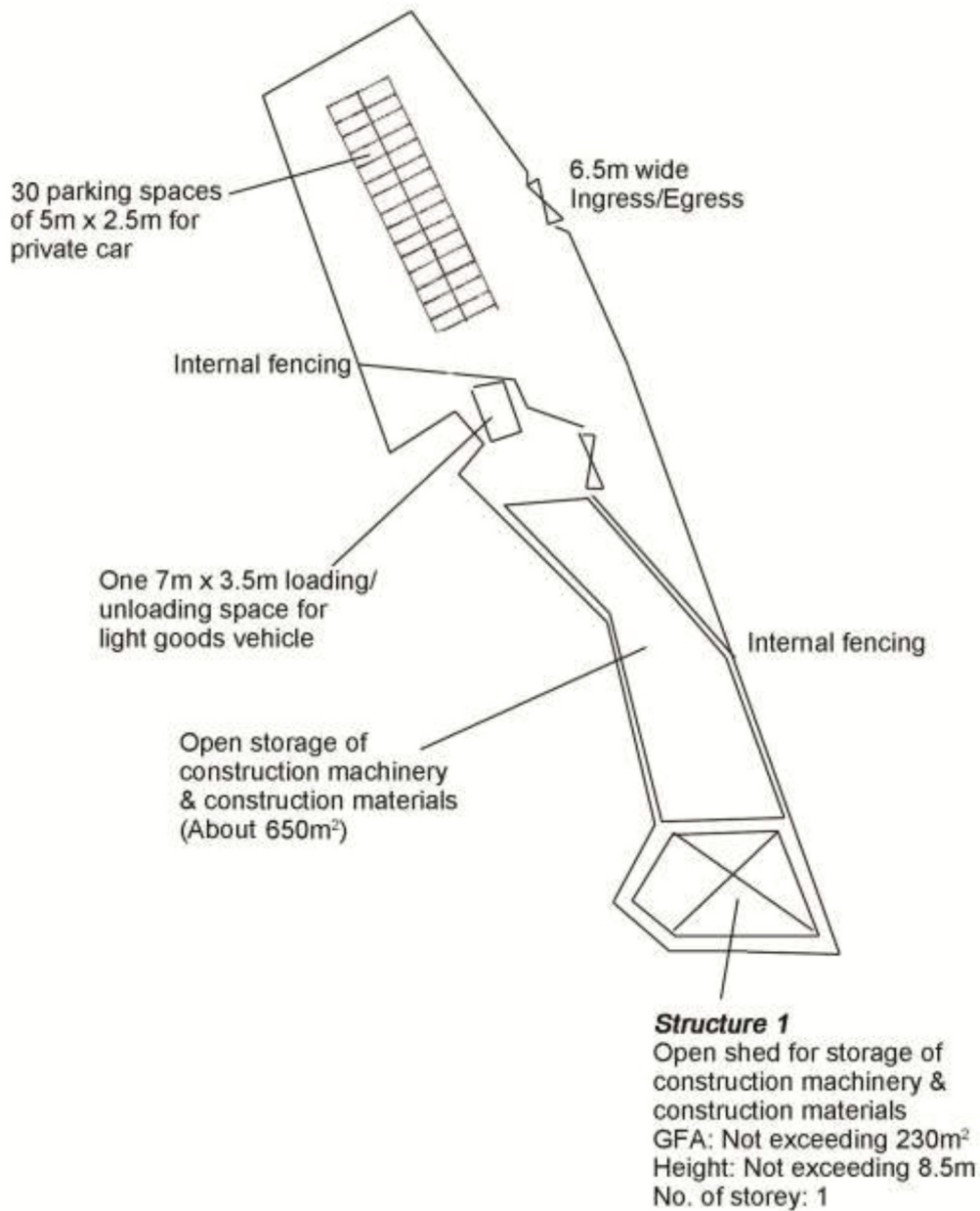

Project 項目名稱:

Proposed Temporary Public Vehicle Park (Private Cars) & Open Storage of Construction Machinery and Construction Materials and Associated Filling of Land for a Period of 3 Years at Lots 106 (Part), 107 (Part), 289 (Part), 293 (Part), 294 (Part), 295 (Part), 301 (Part), 302 (Part) and 319 (Part) in D.D. 126, Fung Ka Wai, Ping Shan, Yuen Long, N.T.

Drawing Title 圖目:

Proposed Layout Plan

Drawing No. 圖號:

Figure 3

Remarks 備註:

Scale 比例:

1:2000

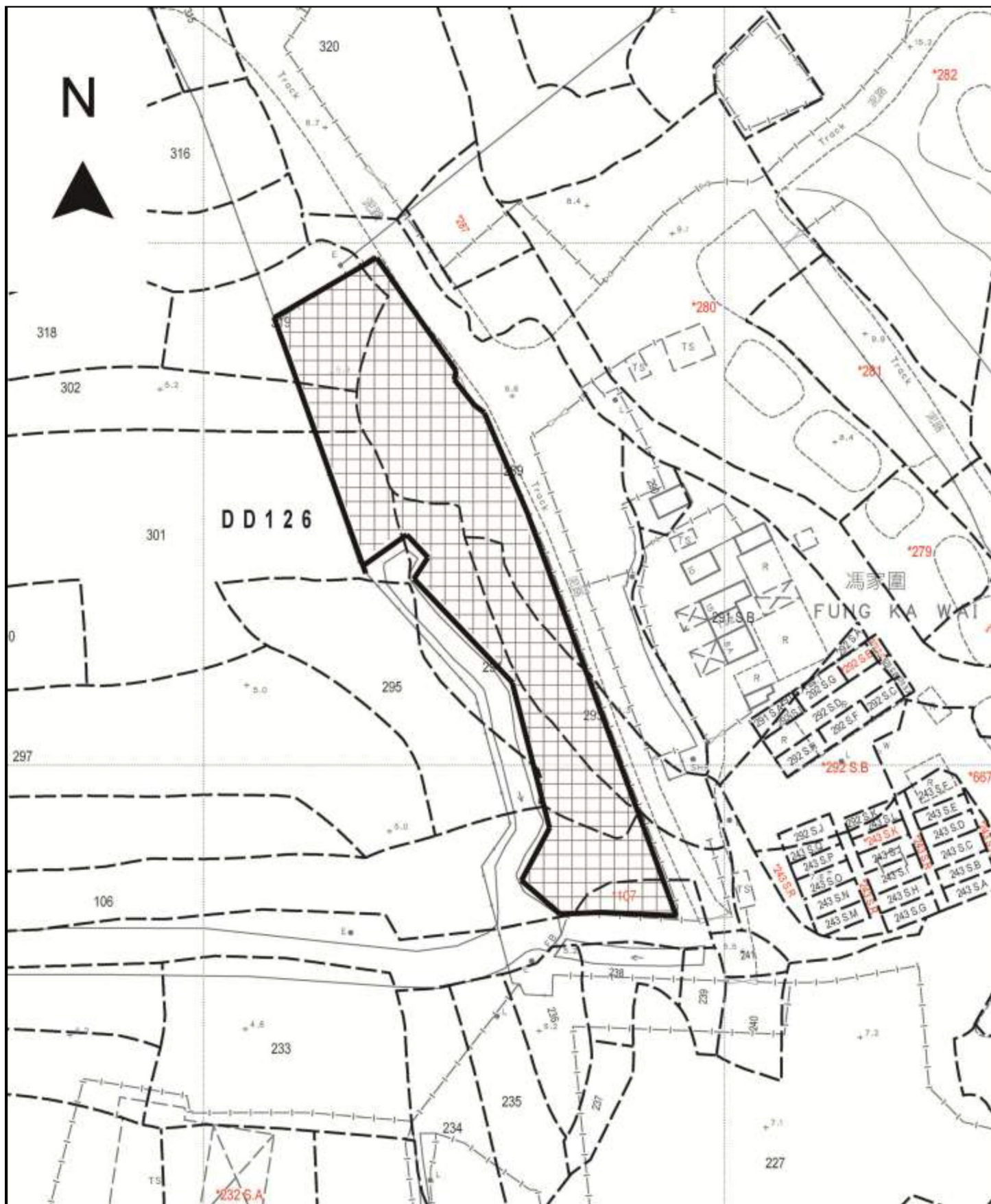

Project 項目名稱:

Drawing Title 圖目:

Drawing No. 圖號:

Remarks 備註:

Regularization of the land
filling of 0.2m concrete