

Temporary Public Vehicle Park for Private Cars, Light Goods Vehicles & 19-seaters Coaches for a Period of 3 Years

at

Lots 21 RP (Part), 22 RP (Part), 24 RP (Part), 25 (Part), 28 RP (Part) & 29 RP (Part) in D.D. 121, Tong Fong Tsuen, Ping Shan, Yuen Long, N.T.

Annex 1 Estimated Traffic Generation

- 1.1 The application site is served by a paved vehicular access leading from Ping Kwai Road. (**Figure 2**)
- 1.2 The application site will be opened for parking of private car, light goods vehicle and 19-seaters coaches only. All 19-seaters coaches to be parked at the application site are below 5.5 tonnes. No medium goods vehicle and heavy goods vehicle exceeding 5.5 tonnes including container trailer and tractor will allow to enter/park at the application site. Also, vehicles without valid licences issued under the Road Traffic Ordinance will not be permitted to park at the application site.
- 1.3 The traffic generation will be solely contributed by the public vehicle park. The estimated average traffic generation and traffic generation rate at peak hours are as follow:

Type of Vehicle	<u>Average Traffic Generation Rate</u> (pcu/hr)	<u>Average Traffic Attraction Rate</u> (pcu/hr)	<u>Traffic Generation Rate at Peak Hours</u> (pcu/hr)	<u>Traffic Attraction Rate at Peak Hours</u> (pcu/hr)
Private car	1.38	1.38	18	14
Light goods vehicle/ 19-seaters coach	1.88	1.88	27	18
Total	3.26	3.26	45	32

Note 1: The proposed public vehicle park operates between 7:00a.m. to 11:00p.m. on Mondays to Sundays including public holidays;

Note 2: The pcu of private car and light goods vehicle/19-seaters coach is taken as 1 and 1.5 respectively; &

Note 3: Morning peak is defined as 7:00a.m. to 9:00a.m. whereas afternoon peak is defined as 5:00p.m. to 7:00p.m.

- 1.4 As shown in the above estimation, it is estimated that the proposed development would not generate significant amount of traffic. It would not affect the traffic condition of the area especially that the proposed development would provide only 48 parking spaces.

Application Site

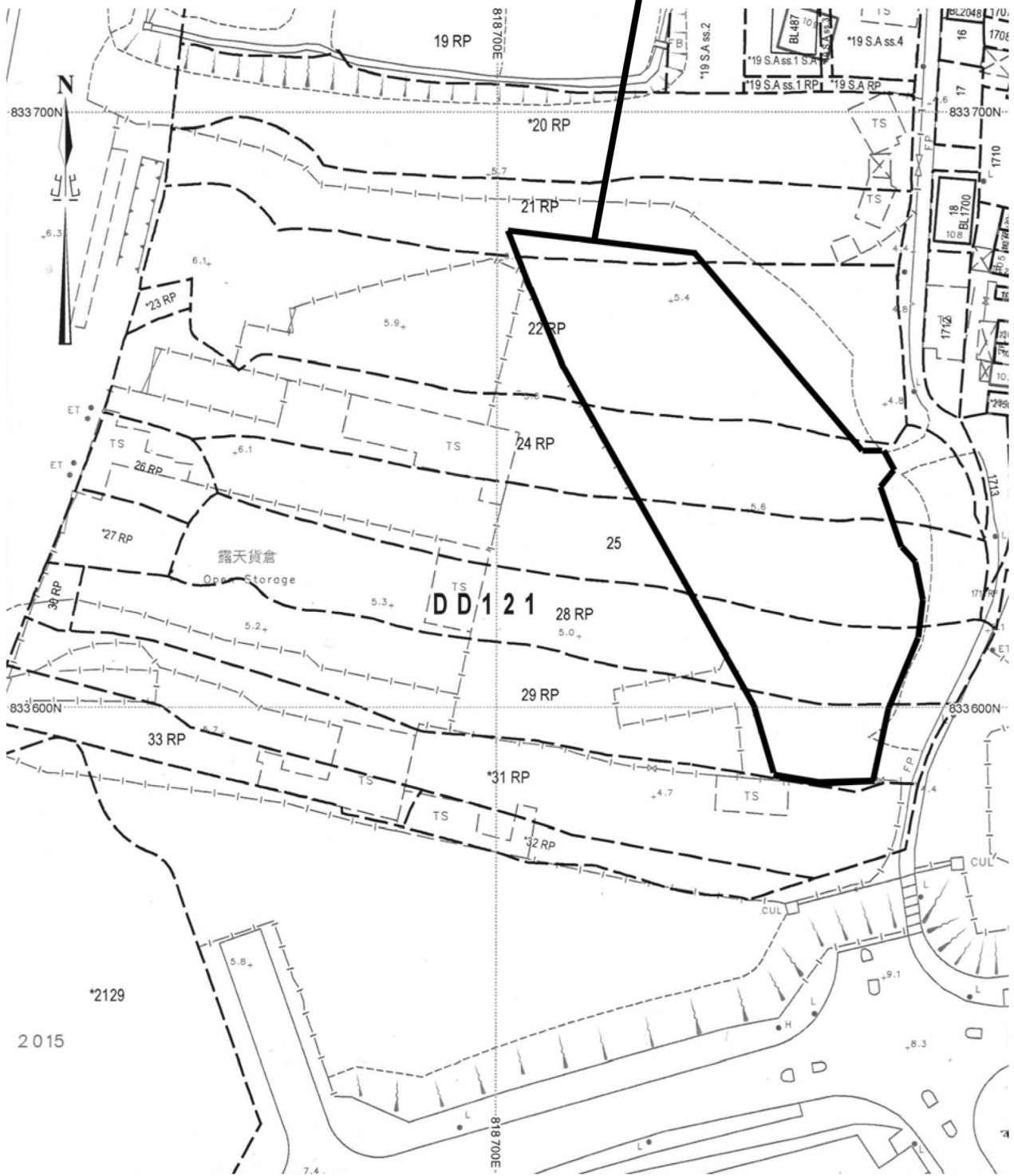

Project 項目名稱:

Proposed Temporary Public Vehicle Park for Private Cars, Light Goods Vehicles and 19-seaters Coaches for a Period of 3 Years at Lots 21 RP (Part), 22 RP (Part), 24 RP (Part), 25 (Part), 28 RP (Part) & 29 RP (Part) in D.D. 121, Tong Fong Tsuen, Ping Shan, Yuen Long, N.T.

Drawing Title 圖目:

Application Site

Remarks 備註:

Drawing No. 圖號:

Figure 1

Scale 比例:

1:1000

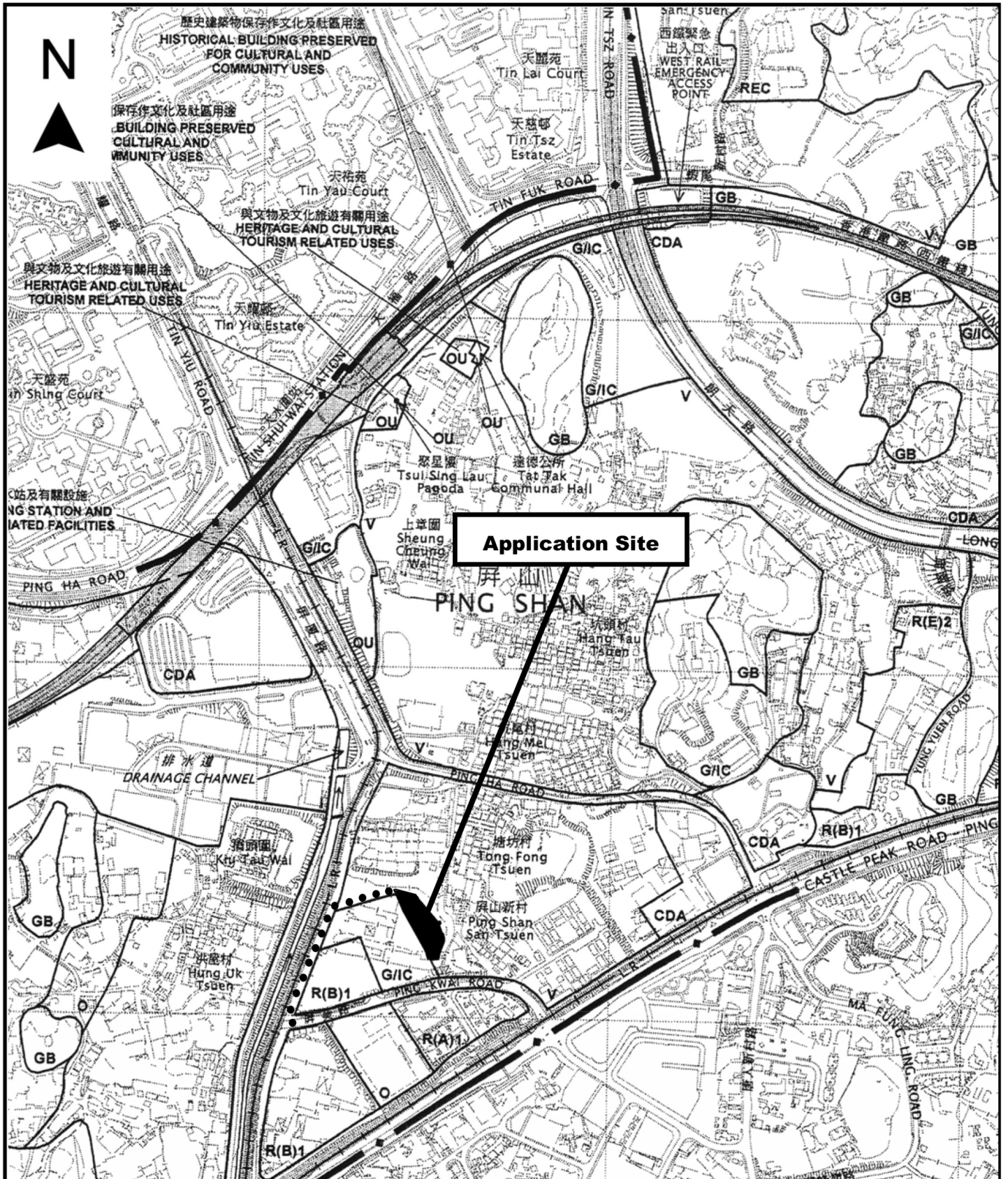

<p>Project 項目名稱:</p> <p>Proposed Temporary Public Vehicle Park for Private Cars, Light Goods Vehicles and 19-seaters Coaches for a Period of 3 Years at Lots 21 RP (Part), 22 RP (Part), 24 RP (Part), 25 (Part), 28 RP (Part) & 29 RP (Part) in D.D. 121, Tong Fong Tsuen, Ping Shan, Yuen Long, N.T.</p>	<p>Drawing Title 圖目:</p> <p>Location Plan</p>	<p>Remarks 備註:</p> <p>●●● Vehicular Access Leading from Ping Kwai Road</p>
	<p>Drawing No. 圖號:</p> <p>Figure 2</p>	<p>Scale 比例:</p> <p>1:7500</p>

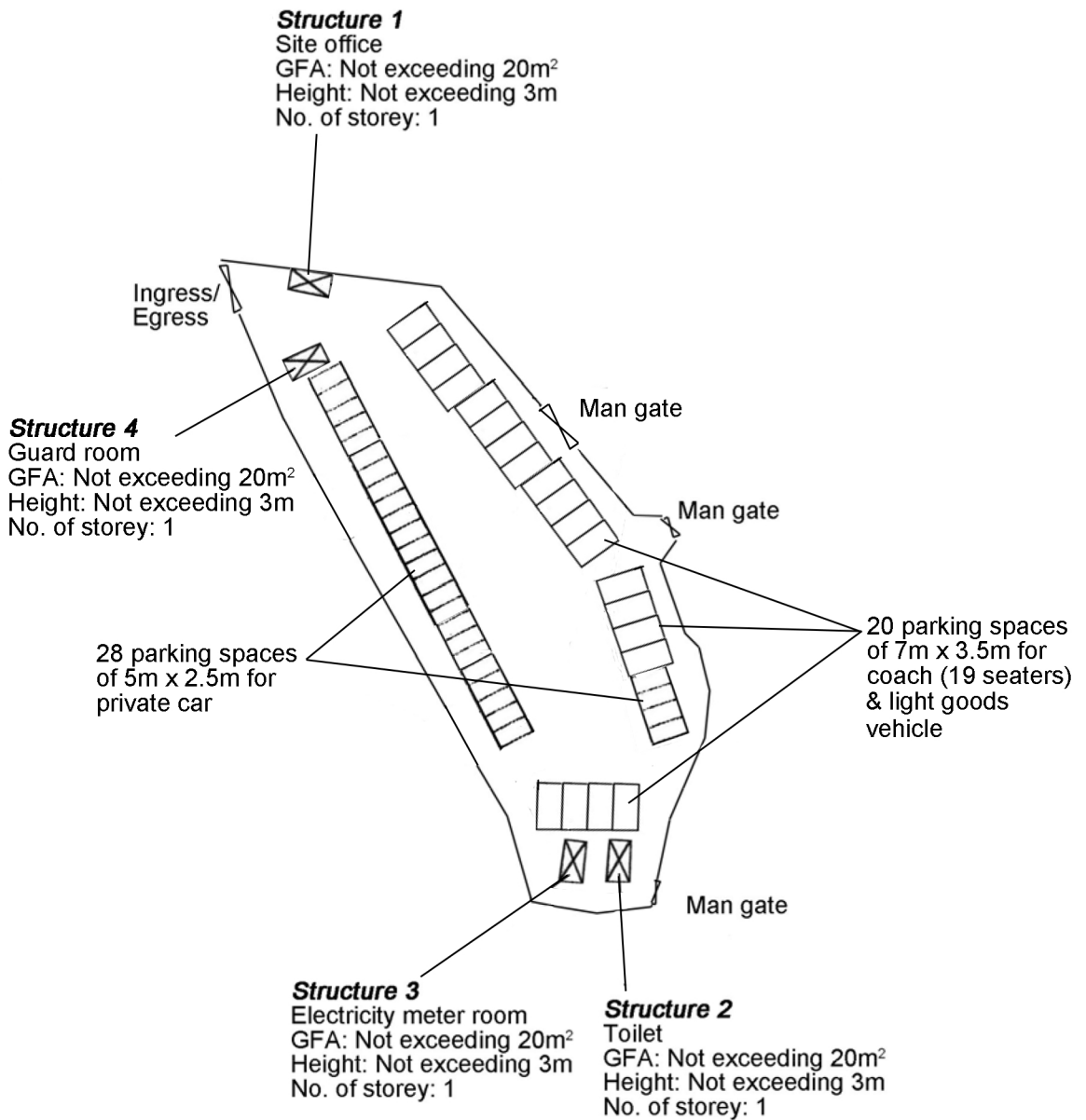

Project 項目名稱:

Proposed Temporary Public Vehicle Park for Private Cars, Light Goods Vehicles and 19-seaters Coaches for a Period of 3 Years at Lots 21 RP (Part), 22 RP (Part), 24 RP (Part), 25 (Part), 28 RP (Part) & 29 RP (Part) in D.D. 121, Tong Fong Tsuen, Ping Shan, Yuen Long, N.T.

Drawing Title 圖目:

Proposed Layout Plan

Remarks 備註:

Drawing No. 圖號:

Figure 3

Scale 比例:

1:1000

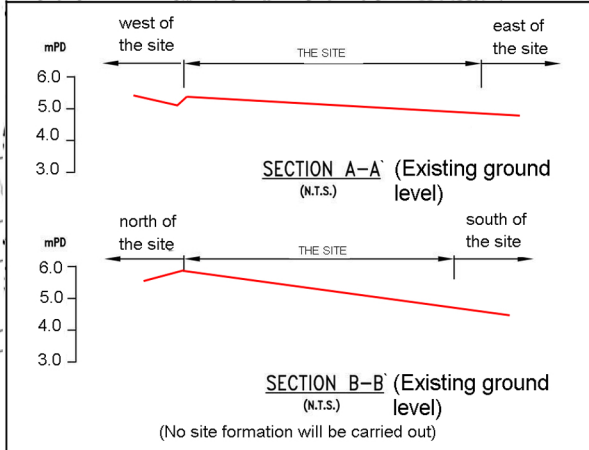
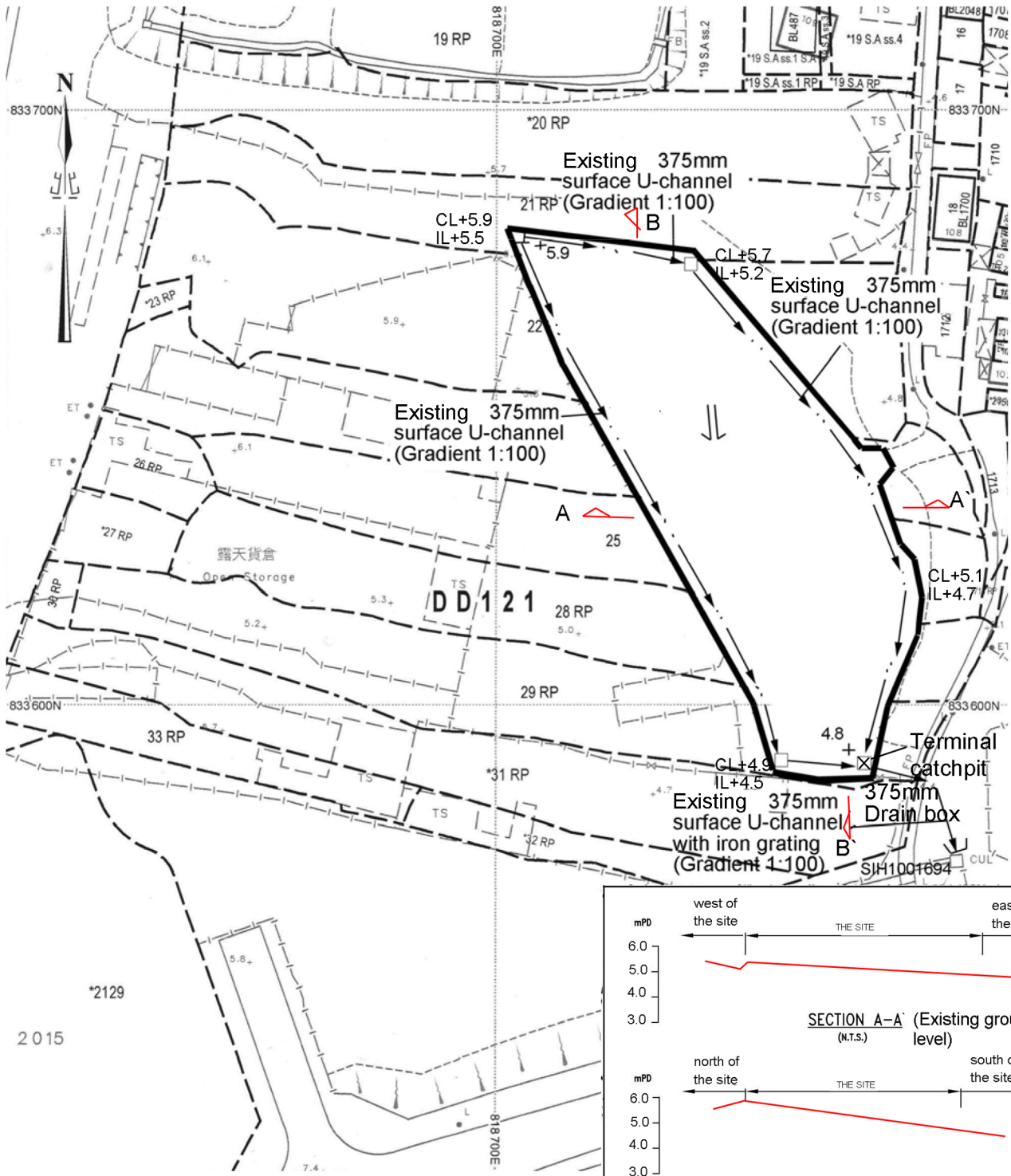

(No site formation will be carried out)

Project 項目名稱:

Proposed Temporary Public Vehicle Park for Private Cars, Light Goods Vehicles and 19-seaters Coaches for a Period of 3 Years at Lots 21 RP (Part), 22 RP (Part), 24 RP (Part), 25 (Part), 28 RP (Part) & 29 RP (Part) in D.D. 121, Tong Fong Tsuen, Ping Shan, Yuen Long, N.T.

Drawing Title 圖目:

As-built Drainage Plan

Drawing No. 圖號:

Figure 4

Remarks 備註:

- Proposed catchpit
- Flow of surface runoff
- ±5.9 Level (in mPD)
- Proposed catchpit with sand trap

Scale 比例:

1:1000