

**Temporary Public Vehicle Park for Private Car for a Period of 3 Years
at
Lots 123 (Part), 126 RP (Part), 130 (Part), 131 (Part), 132 RP (Part) &
135 RP (Part) in D.D. 121, Yuen Long, N.T.**

Annex 1 Estimated Traffic Generation

- 1.1 The application site is serviced by a vehicular track leading from Ping Kwai Road. (Figure 2) It possesses an area of approximately 930m².
- 1.2 The application site will be opened for parking of private car only. No light goods vehicle, medium goods vehicle, heavy goods vehicle and container tractor/trailer will be allowed to enter the site. Also, vehicles without valid licences issued under the Road Traffic Ordinance will not be permitted to park at the application site.
- 1.3 The estimated average traffic generation and traffic generation rate at peak hours are as follow:

Type of Vehicle	Average Traffic Generation Rate (pcu/hr)	Average Traffic Attraction Rate (pcu/hr)	Traffic Generation Rate at Peak Hours (pcu/hr)	Traffic Attraction Rate at Peak Hours (pcu/hr)
Private car	0.8	0.8	7	5

Note 1: The opening hour of the proposed development is restricted to 7:00 a.m. to 11:00 p.m. daily

Note 2: The pcu of private car is taken as 1.

Note 3: Morning peak is defined as 7:00a.m. to 9:00a.m. whereas afternoon peak is defined as 5:00p.m. to 7:00p.m.

- 1.4 As shown in the above estimation, it is estimated that the proposed development would not generate significant amount of traffic. It would not affect the traffic condition of the area especially that the proposed development would provide only 13 parking spaces.

Application Site

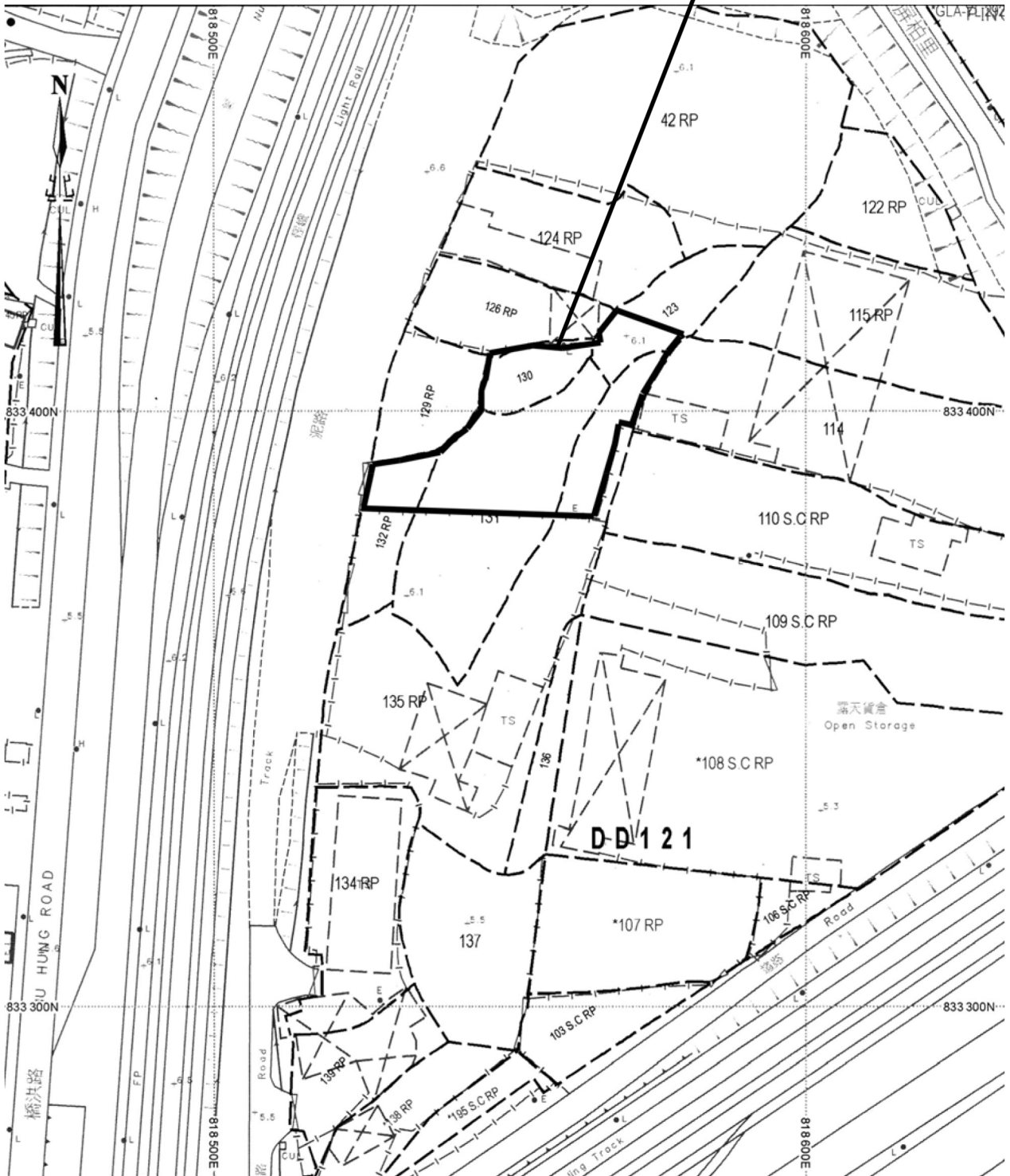

Project 項目名稱:

Proposed Temporary Public Vehicle Park for Private Car for a Period of 3 Years at Lots 123 (Part), 126 RP (Part), 130 (Part), 131 (Part), 132 RP (Part) & 135 RP (Part) in D.D. 121, Yuen Long, N.T.

Drawing Title 圖目:

Site Plan

Remarks 備註:

Drawing No. 圖號:

Figure 1

Scale 比例:

1:1000

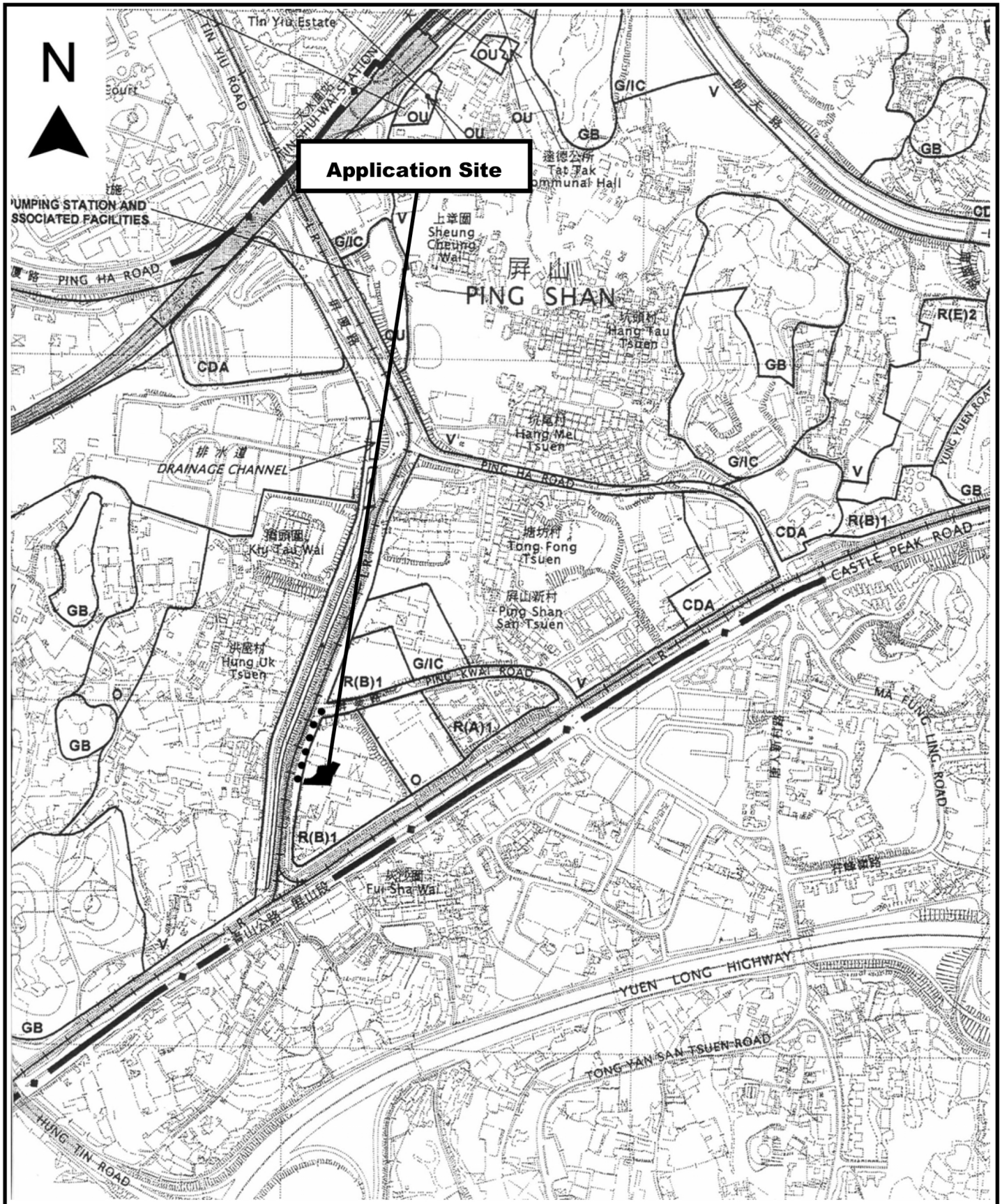

Project 項目名稱:

Proposed Temporary Public Vehicle Park for Private Car for a Period of 3 Years at Lots 123 (Part), 126 RP (Part), 130 (Part), 131 (Part), 132 RP (Part) & 135 RP (Part) in D.D. 121, Yuen Long, N.T.

Drawing Title 圖目:

Location Plan

Drawing No. 圖號:

Figure 2

Remarks 備註:

● ● ● 7.5m wide Vehicular Track Leading from Ping Kwai Road

Scale 比例:

1:7500

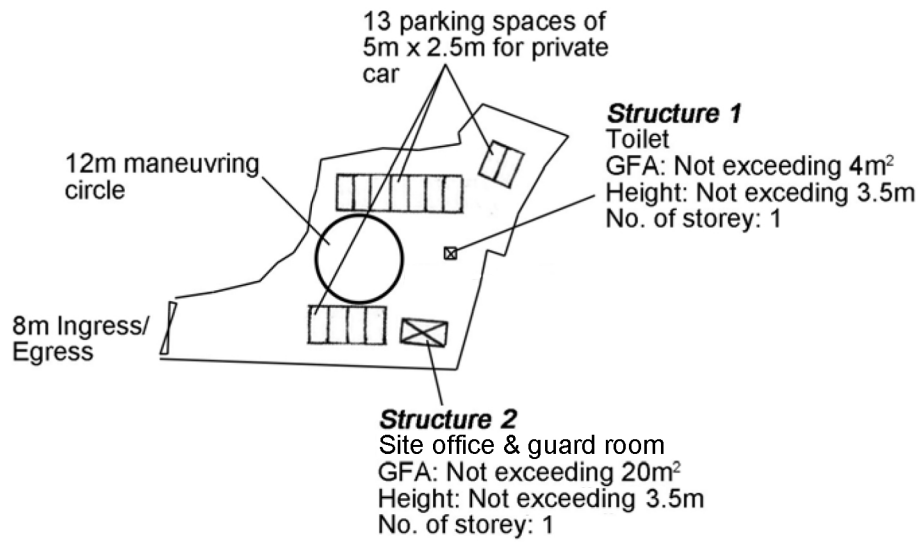

Project 項目名稱:

Proposed Temporary Public Vehicle Park for Private Car for a Period of 3 Years at Lots 123 (Part), 126 RP (Part), 130 (Part), 131 (Part), 132 RP (Part) & 135 RP (Part) in D.D. 121, Yuen Long, N.T.

Drawing Title 圖目:

Proposed Layout Plan

Remarks 備註:

Drawing No. 圖號:

Figure 3

Scale 比例:

1:1000

Tree	Approximate Height	Spacing
— As-planted <i>Bambusa textilis McClure</i> to be preserved	2.75m	450mm

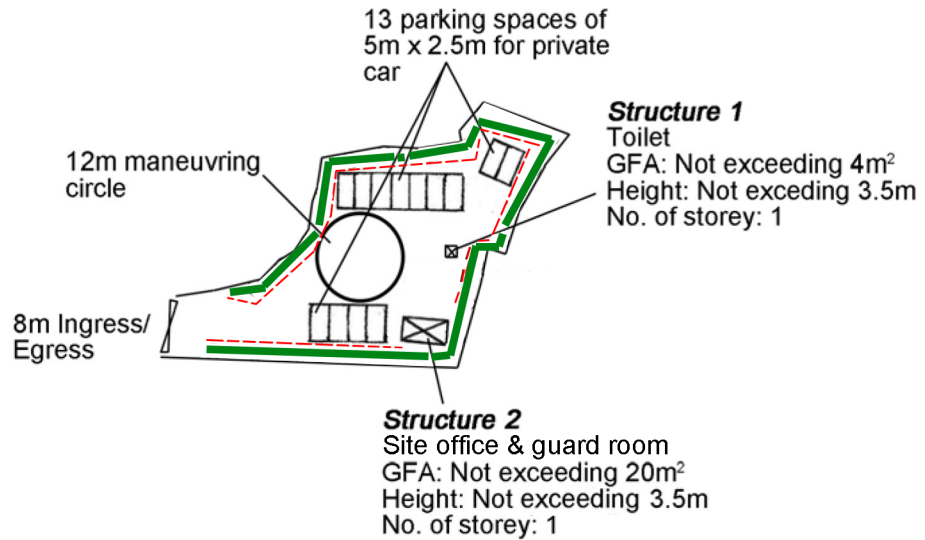

Project 項目名稱:

Proposed Temporary Public Vehicle Park for Private Car for a Period of 3 Years at Lots 123 (Part), 126 RP (Part), 130 (Part), 131 (Part), 132 RP (Part) & 135 RP (Part) in D.D. 121, Yuen Long, N.T.

Drawing Title 圖目:

As-planted Landscape & Tree Preservation Plan

Drawing No. 圖號:

Figure 4

Remarks 備註:

--- Proposed kerb at a minimum 1m away from the existing trees to protect the trees

Scale 比例:

1:1000

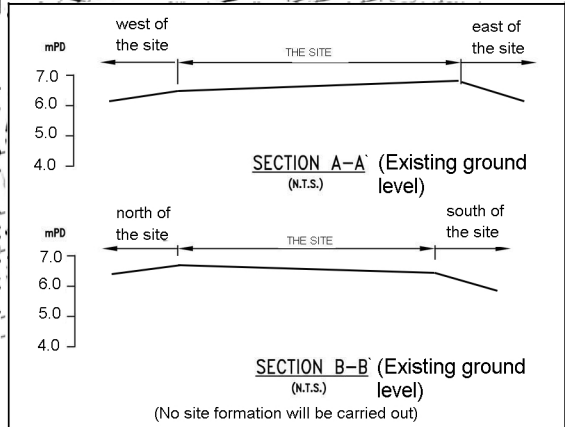
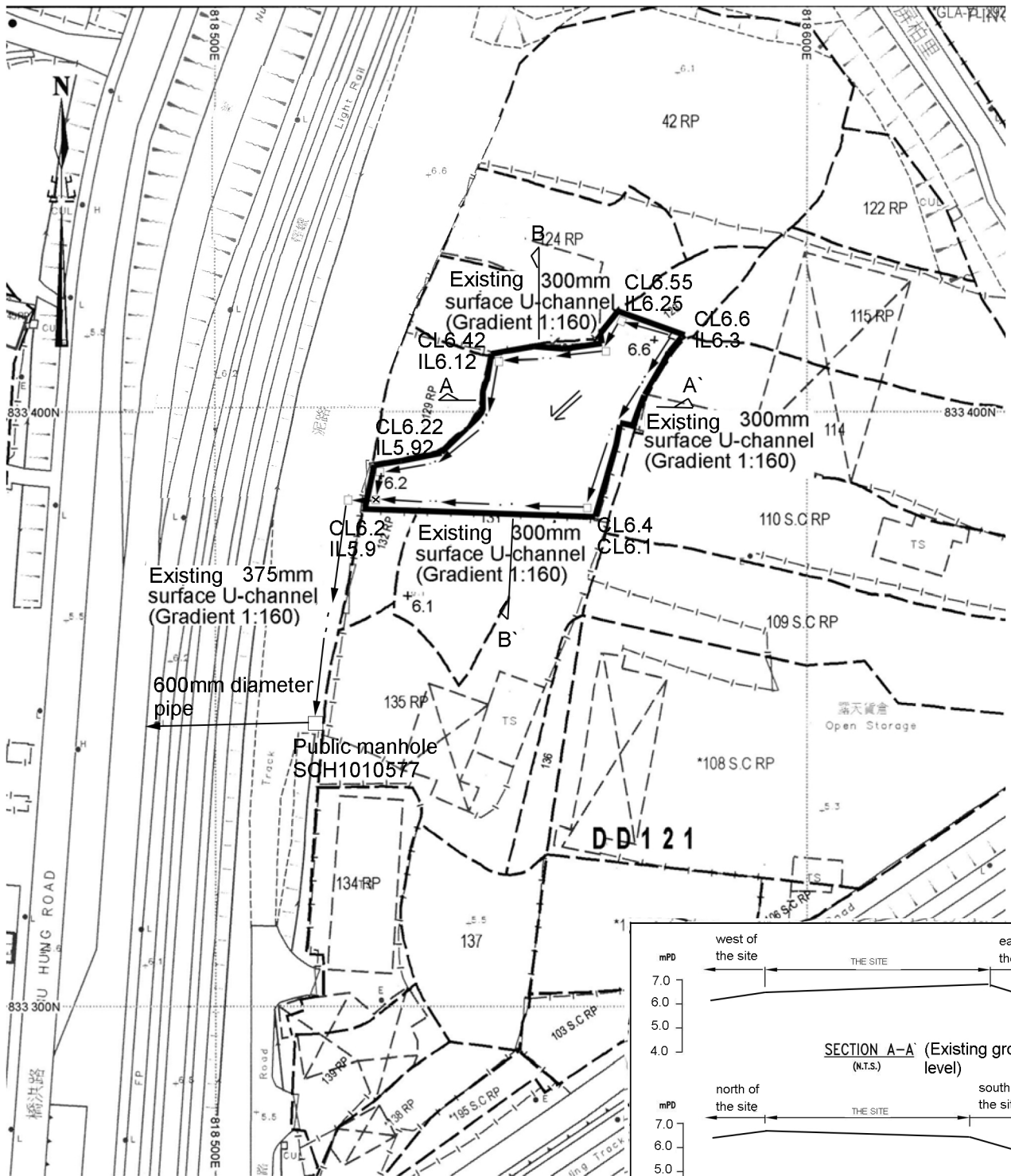

Project 項目名稱:

Proposed Temporary Public Vehicle Park for Private Car for a Period of 3 Years at Lots 123 (Part), 126 RP (Part), 130 (Part), 131 (Part), 132 RP (Part) & 135 RP (Part) in D.D. 121, Yuen Long, N.T.

Drawing Title 圖目:

As-built Drainage Plan

Remarks 備註:

- Existing catchpit
- Flow of surface runoff
- +6.1 Level (in mPD)
- Existing catchpit with sand trap

Drawing No. 圖號:

Figure 5

Scale 比例:

1:1000