

申請地點
Application Site

位置圖 LOCATION PLAN

申請地點界線只作識別用
APPLICATION SITE BOUNDARY
FOR IDENTIFICATION PURPOSE ONLY

EXTRACT PLAN PREPARED ON
12.4.2025 BASED ON OUTLINE ZONING
PLAN No. S/YL-SK/9 APPROVED ON
17.10.2006



Plan 1

As of Ortho Photo 6NE19A in 1963

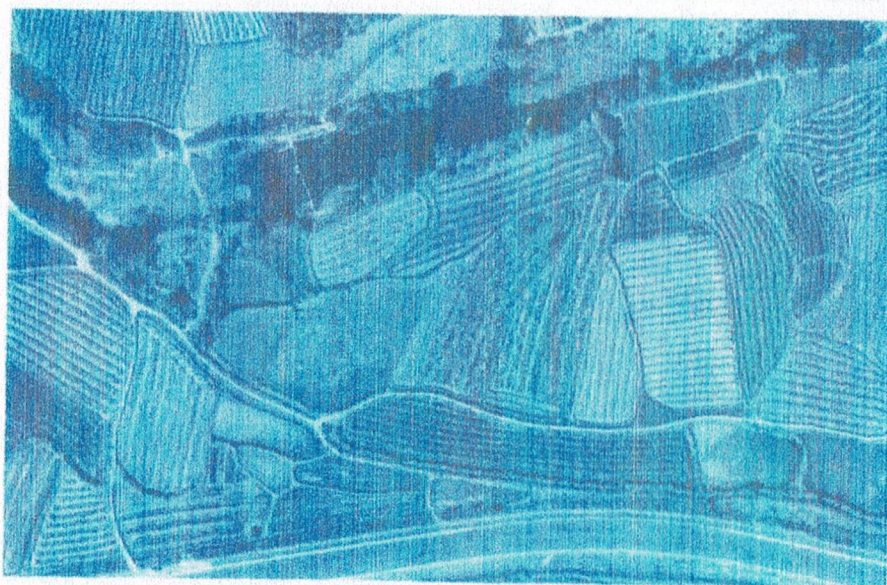

Path indication:

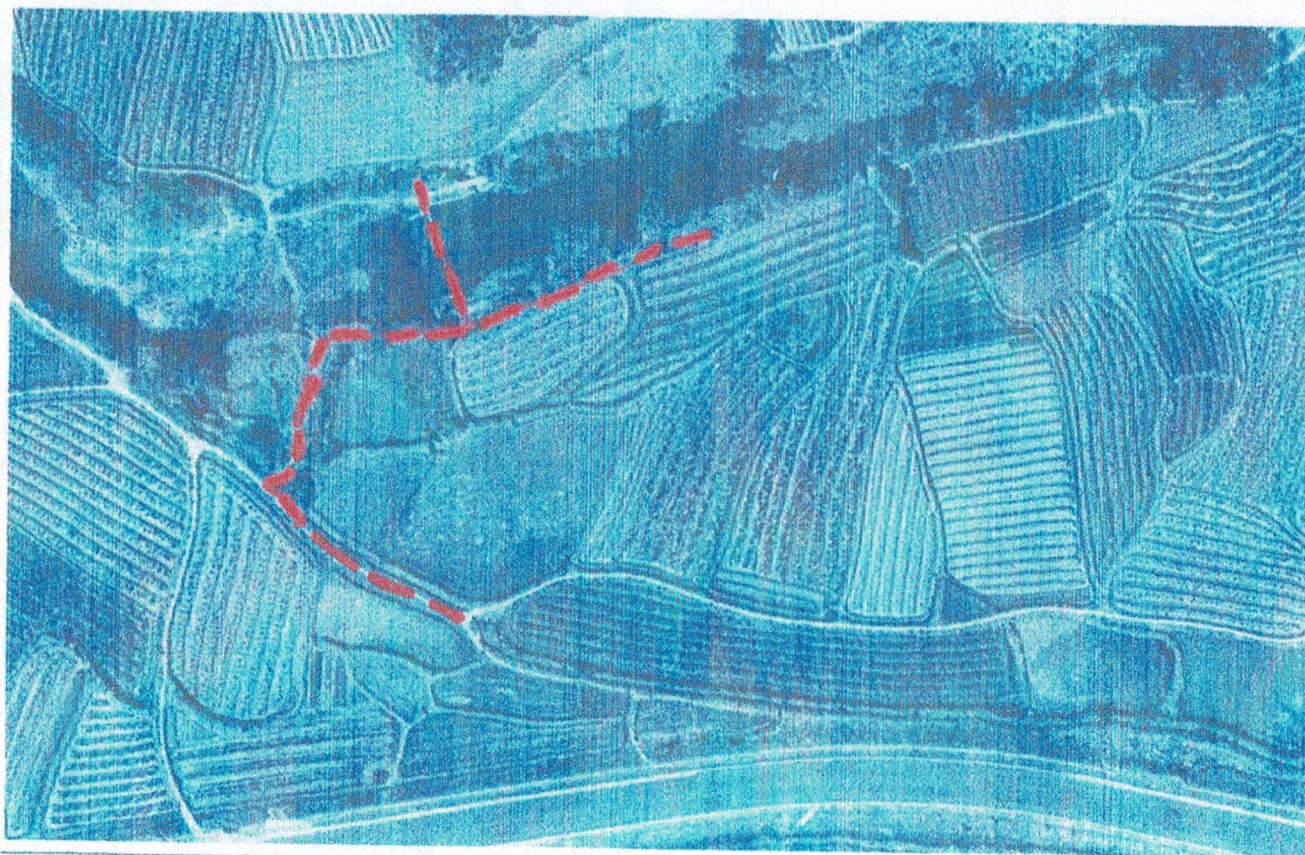

Footpath access

Plan 2

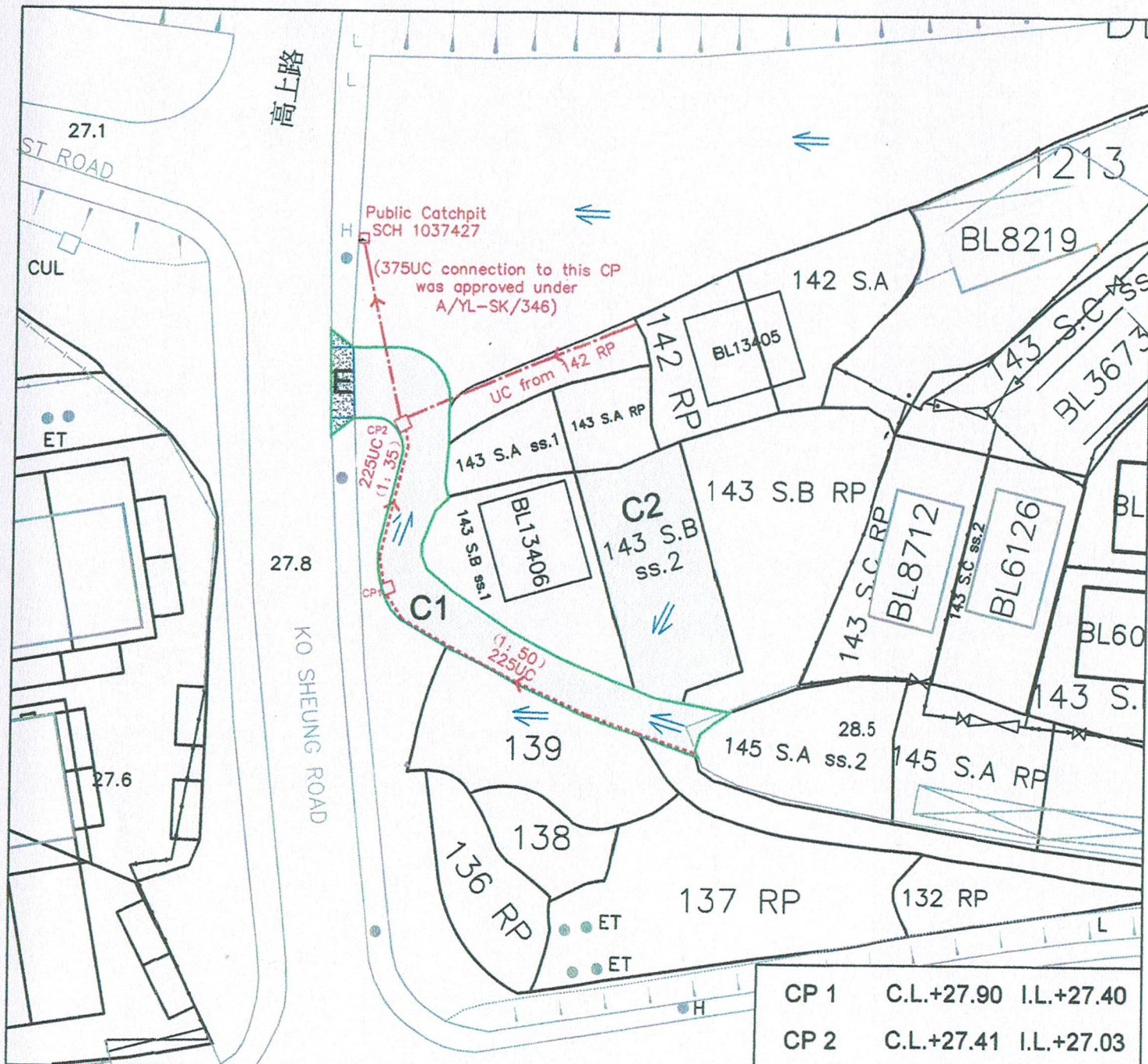

Notes:

1. Catchpit with desilting facility shall follow CEDD standard drawing No. C24061
2. Catchpit and UC follows Typical Details of Geotechnical Manual for Slope Fig 8.10 and Fig 8.11 respectively.
3. Cast Iron Cover or Precast Concrete Cover shall be provided for all proposed UCs
4. The inverted level of the connection point shall be verified on site prior to commencement of work
5. Area of Filling = C1 with 1.2m Max Depth
6. Area of Excavation = E with 0.12m Max Depth

Legend:

- C1 Catchment Area
- Proposed Vehicular Access
- Proposed Catchpit
- Flow of Surface Runoff
- - - ➤ Proposed U-Channel
- - - ➤ Possible U-Channel by others
- (1:50) Approximate Gradient
- Application Site
- Excavation Area

Drainage Plan

Scale: 1 : 500

Plan No.: Plan 4



CONRAD TANG & ASSOCIATES LIMITED



Photo 1 – Application Site Viewed from Southeast



Photo 2 – Application Site Viewed from North



Photo 3 – Run-in Constructed under
A/YL-SK/306 and U-Channel below



Photo 4 – Existing Catchpit and U-
channel below Ko Sheung Road

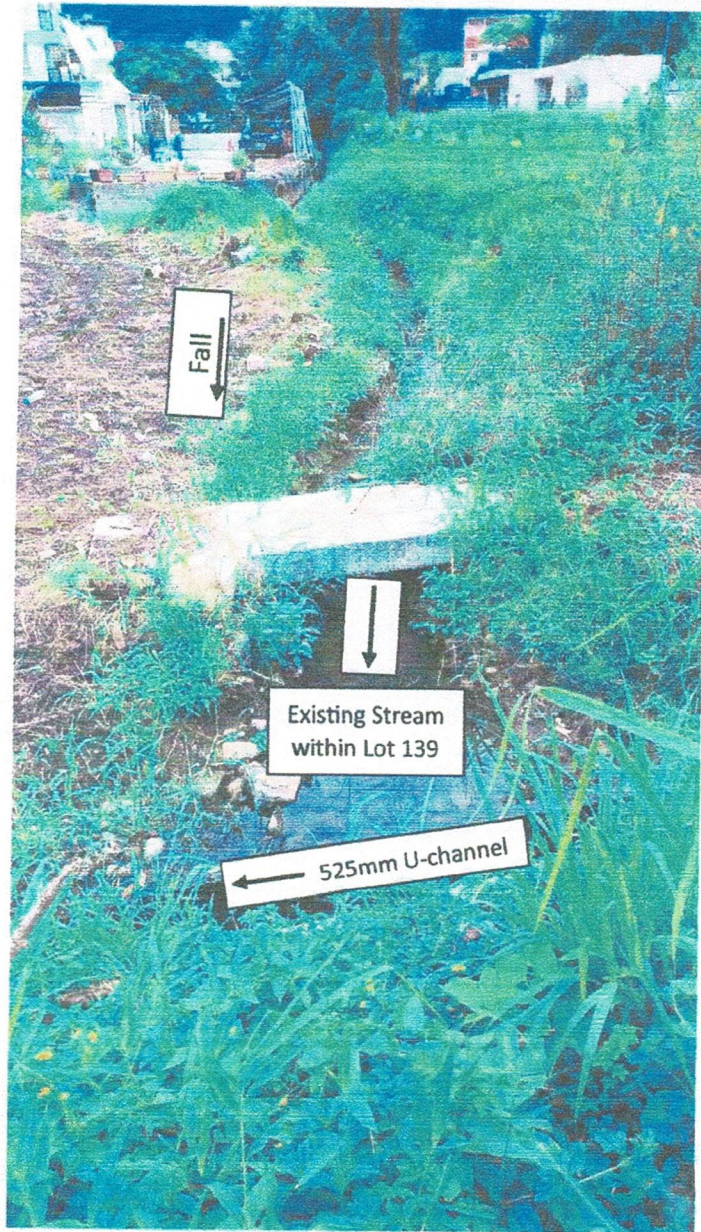
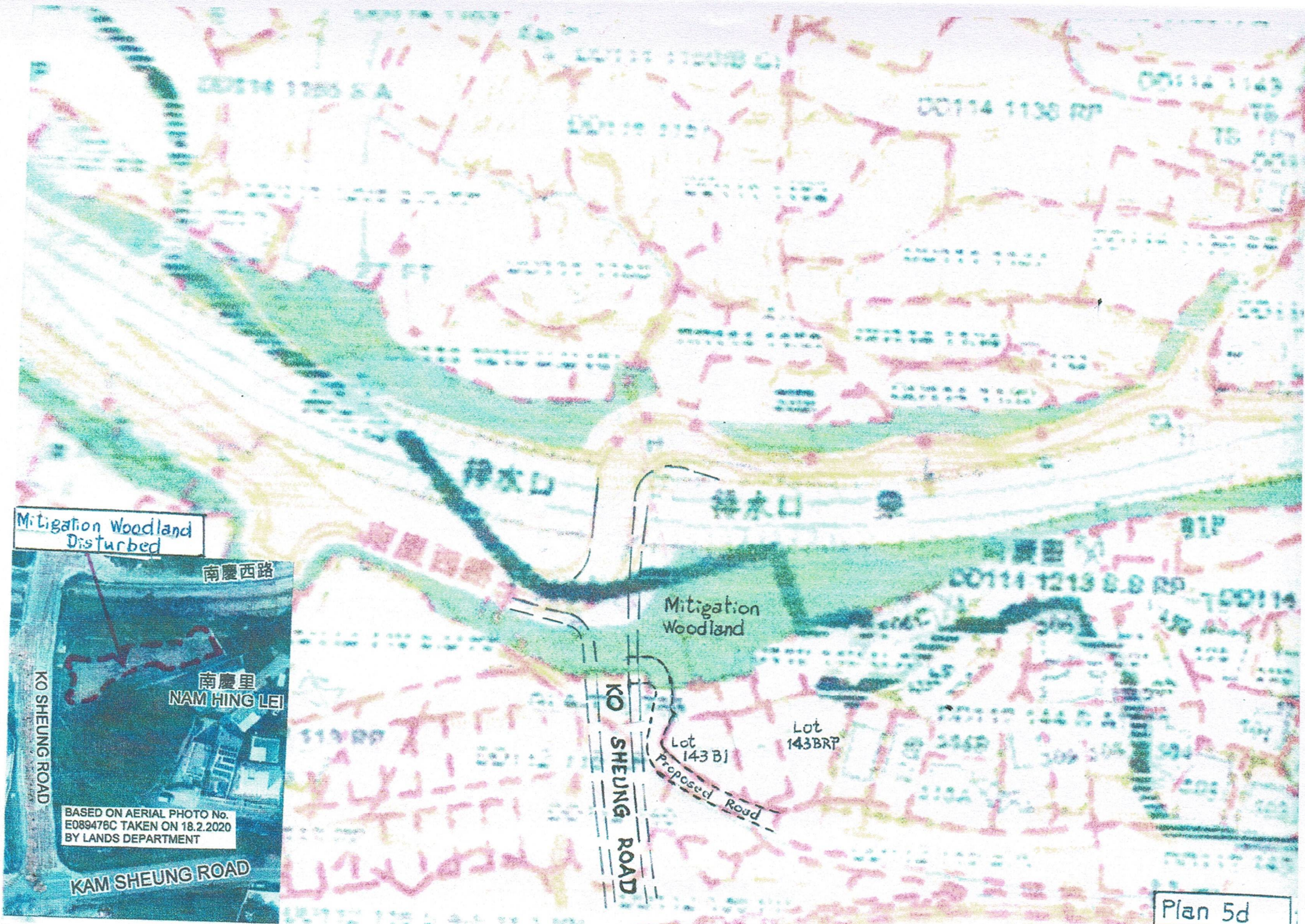

Photo 5 – Existing Stream within Lot 139



Photo 6 – Existing 525 U-channel below Ko Sheung Road



Mitigation Woodland
Disturbed

南慶西路

南慶里
NAM HING LEI

KO SHEUNG ROAD

BASED ON AERIAL PHOTO No.
E089476C TAKEN ON 18.2.2020
BY LANDS DEPARTMENT

KAM SHEUNG ROAD

Mitigation
Woodland

KO
SHEUNG
ROAD

Lot
143B

Lot
143BRP

Proposed Road

Plan 5d