

寄件者:
寄件日期: 2025年08月13日星期三 15:33
收件者: tpbpd/PLAND
副本:
主旨: [FI] S.16 Application No. A/YL-SK/426 - FI to address departmental comments
附件: FI1 for A_YL-SK_426 (20230813).pdf

Dear Sir,

Attached herewith the further information to address departmental comments of the subject application.

Should you require more information, please do not hesitate to contact me. Thank you for your kind attention.

Kind Regards,

Louis TSE | Town Planner
R-riches Group (HK) Limited

R-riches Property Consultants Limited | R-riches Planning Limited | R-riches Construction Limited

Our Ref. : DD106 Lot 987
Your Ref. : TPB/A/YL/426

The Secretary,
Town Planning Board,
15/F, North Point Government Offices,
333 Java Road,
North Point, Hong Kong

By Email

13 August 2025

Dear Sir,

1st Further Information

**Proposed Temporary Open Storage of Construction Materials and Vehicles and
Associated Filling of Land for a Period of 3 Years in "Agriculture" Zone,
Various Lots in D.D.106, Shek Kong, Yuen Long, New Territories**

(S.16 Planning Application No. A/YL-SK/426)

We are writing to submit further information to address departmental comments of the subject application (**Appendix I**).

Should you require more information regarding the application, please contact our
or the undersigned at your convenience.

Thank you for your kind attention.

Yours faithfully,

For and on behalf of
R-riches Planning Limited



Louis TSE
Town Planner



Responses-to-Comments

**Proposed Temporary Open Storage of Construction Materials and Vehicles and
Associated Filling of Land for a Period of 3 Years in "Agriculture" Zone,
Various Lots in D.D.106, Shek Kong, Yuen Long, New Territories**

(Application No. A/YL-SK/426)

(i) A RtoC Table:

Departmental Comments		Applicant's Responses
1. Comments of the District Planning Officer/Fanling, Sheung Shui and Yuen Long East, Planning Department (DPO/FSYLE, PlanD) (Contact Person: Mr. David CHENG; Tel:)		
(a)	<p>According to the applicant's submission, the subject site (the Site) has an area of about 6,427m² and has already been hard-paved. Open Storage of construction materials and vehicles (80 private cars and light goods vehicles) will be involved. To the north of the Site is a streamcourse. To the immediate south of the Site is an area subject to earlier application No. A/YL-SK/371 for temporary open storage, with a site area of about 7.8ha (filling of land for 100% site area), which was approved with conditions by the Rural and New Town Planning Committee of the Town Planning Board in 2025. The Site is surrounded to the east and west by residential structures and vegetation. Considering the site context and scale of the proposed use, drainage and fire service installations proposals shall be submitted to the relevant departments for review.</p>	<p>Noted. The fire service installations and drainage proposals are provided by the applicant in support of the application (Annexes I and II).</p>

DEVELOPMENT PARAMETERS

APPLICATION SITE AREA : 6,427 m² (ABOUT)
COVERED AREA : NOT APPLICABLE
UNCOVERED AREA : 6,427 m² (ABOUT)

OPEN STORAGE AREA : 4,120 m² (ABOUT)
HEIGHT OF STACKING : NOT MORE THAN 3 m

NO STRUCTURE IS PROPOSED AT THE APPLICATION SITE.

FIRE SERVICE INSTALLATIONS

FE_{DP} 4 KG DRY POWDER TYPE FIRE EXTINGUISHER

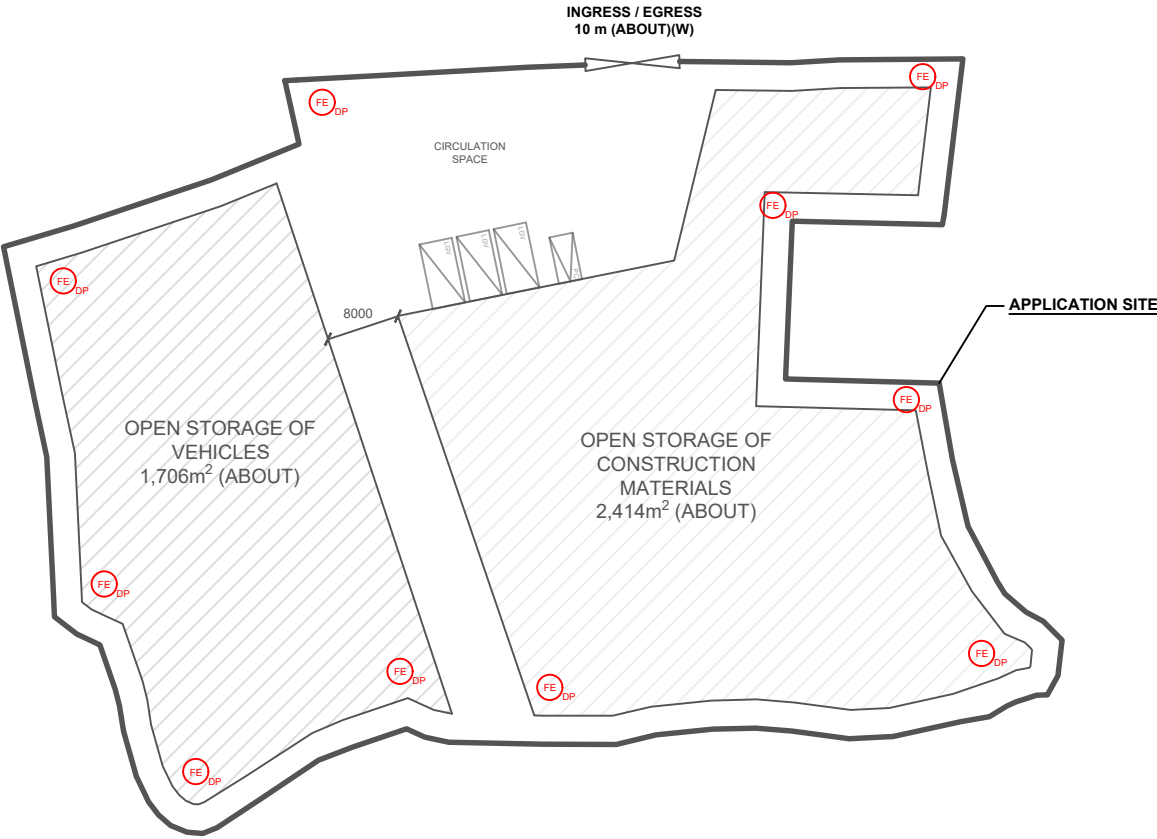
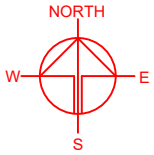

PARKING AND LOADING/UNLOADING PROVISION

NO. OF PRIVATE CAR PARKING SPACE : 1
DIMENSION OF PARKING SPACE : 5 m (L) X 2.5 m (W)

NO. L/UL SPACE FOR LIGHT GOODS VEHICLE : 3
DIMENSION OF L/UL SPACE : 7 m (L) X 3.5 m (W)

LEGEND

- APPLICATION SITE
- PARKING SPACE (PRIVATE CAR)
- L/UL SPACE (LIGHT GOODS VEHICLE)
- INGRESS / EGRESS

PLANNING CONSULTANT



PROJECT

PROPOSED TEMPORARY OPEN STORAGE OF CONSTRUCTION MATERIALS AND VEHICLES AND ASSOCIATED FILLING OF LAND FOR A PERIOD OF 3 YEARS

SITE LOCATION

VARIOUS LOTS IN D.D. 106, SHEK KONG, YUEN LONG, NEW TERRITORIES

SCALE

1 : 800 @ A4

DRAWN BY LT DATE 11.6.2025

CHECKED BY DATE

APPROVED BY DATE

DWG. TITLE

FSI PROPOSAL

DWG NO. ANNEX I

VER. 002

DEVELOPMENT PARAMETERS

APPLICATION SITE AREA : 6,427 m² (ABOUT)
 COVERED AREA : NOT APPLICABLE
 UNCOVERED AREA : 6,427 m² (ABOUT)
 OPEN STORAGE AREA : 4,120 m² (ABOUT)
 HEIGHT OF STACKING : NOT MORE THAN 3 m

NO STRUCTURE IS PROPOSED AT THE APPLICATION SITE.

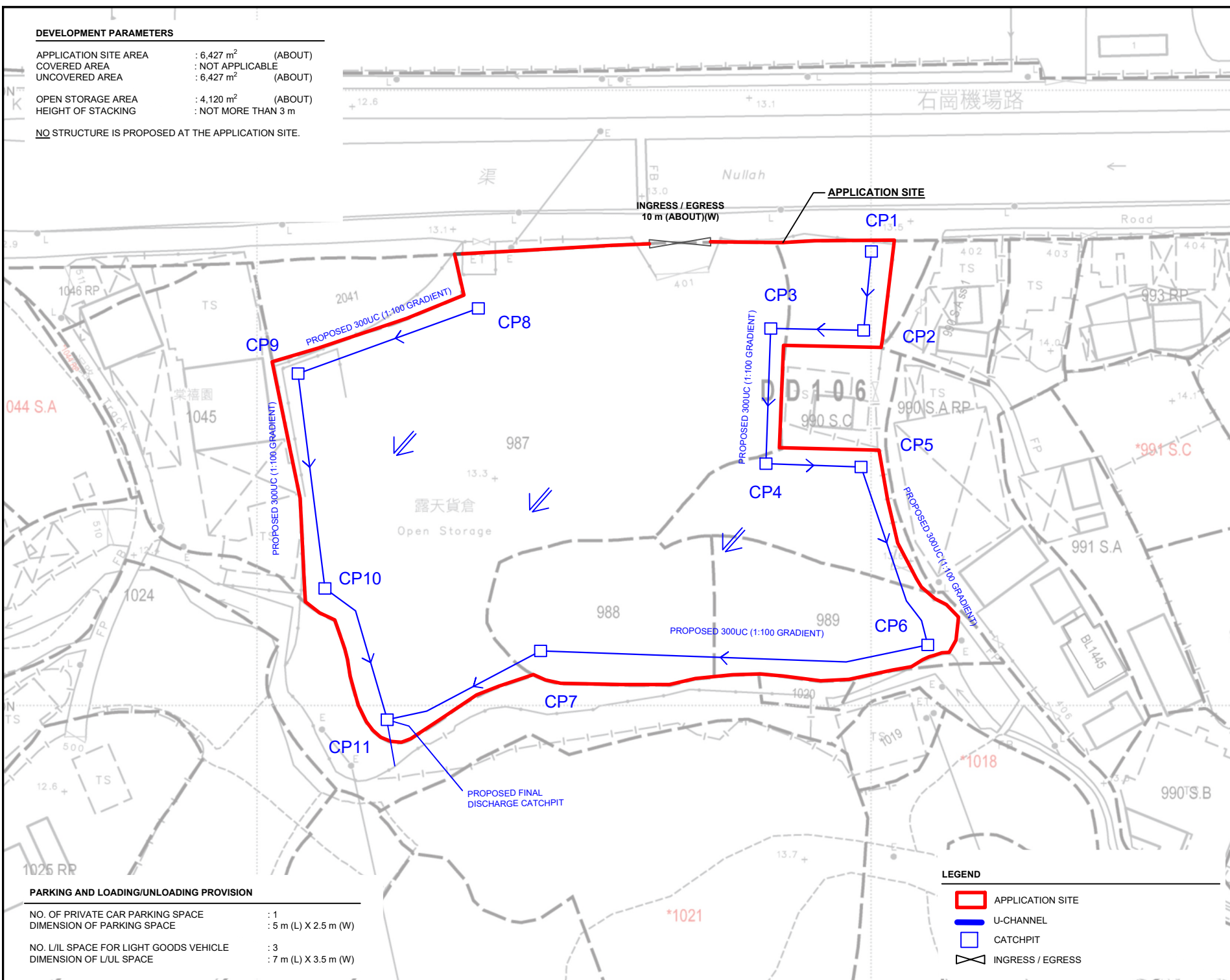
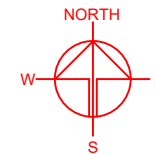

PARKING AND LOADING/UNLOADING PROVISION

NO. OF PRIVATE CAR PARKING SPACE : 1
 DIMENSION OF PARKING SPACE : 5 m (L) X 2.5 m (W)
 NO. L/L SPACE FOR LIGHT GOODS VEHICLE : 3
 DIMENSION OF L/L SPACE : 7 m (L) X 3.5 m (W)

LEGEND

- APPLICATION SITE
- U-CHANNEL
- CATCHPIT
- INGRESS / EGRESS

PLANNING CONSULTANT



PROJECT

PROPOSED TEMPORARY OPEN STORAGE OF CONSTRUCTION MATERIALS AND VEHICLES AND ASSOCIATED FILLING OF LAND FOR A PERIOD OF 3 YEARS

SITE LOCATION

VARIOUS LOTS IN D.D. 106, SHEK KONG, YUEN LONG, NEW TERRITORIES

SCALE

1 : 800 @ A4

DRAWN BY

LT

DATE

11.6.2025

CHECKED BY

DATE

APPROVED BY

DATE

DWG. TITLE

DRAINAGE PROPOSAL

DWG NO.

ANNEX II

VER.

002