

Legend:

 Application Site 申請範圍

Appendix 1

Location: DD 118 Lot 2309 RP

OZP: S/YL-TT/20
District: Tai Tong
Zoning: Agriculture

Date: 2 November 2025

Location

位置圖

擬議臨時康體文娛場所 (休閒農場)
連附屬設施及相關填土工程
(為期5年)

Proposed Temporary Place of Recreation, Sports or Culture (Hobby Farm) with Ancillary Facilities and Associated Filling of Land For a Period of 5 Years

SCALE

1:1000

@A4

For Identification Only

Drawing No.:

1-01

Proposed Structures Details

	<u>Structures</u>	<u>Gross Floor Area (GFA)</u>	<u>Height (Not Exceeding)</u>	<u>Storey</u>	<u>Unit(s)</u>
1	G/F: Farm Reception	About 6m x 3.2m = 19.2 m ²	7m	2	1
	U/F: Ancillary Storage	About 6m x 3.2m = 19.2 m ²			
	Total	<u>About 38.4 m²</u>			
	Private Car Parking Space	5m x 2.5m			1

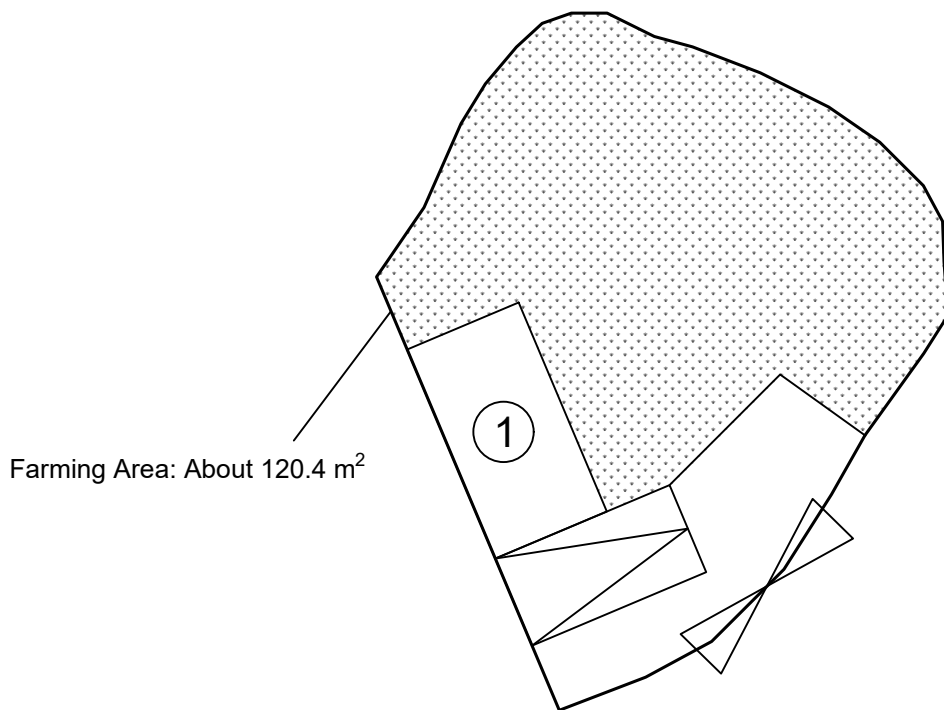

Farming Area: About 120.4 m²

Legend:

- ⊞ Ingress/egress (Width: About 4.5m)
- ▣ Proposed Structures
- ▤ Private Car Parking Space
- ① Farm Reception and Storage

Total Area: 177.4 m² (About)
 Covered Area: 19.2 m² (About)
 Uncovered Area: 158.2 m² (About)
 Non-Domestic GFA: 38.4 m² (About)
 Nos. of Proposed Structures: 1

<p style="text-align: center;"><u>Appendix 2</u></p> <p>Location: DD 118 Lot 2309 RP</p> <p>OZP: S/YL-TT/20 District: Tai Tong Zoning: Agriculture</p> <p>Date: 9 March 2026</p>	<p><u>Proposed Layout Plan</u> 擬議佈局平面圖</p> <p>擬議臨時康體文娛場所 (休閒農場) 連附屬設施及相關填土工程 (為期5年)</p> <p>Proposed Temporary Place of Recreation, Sports or Culture (Hobby Farm) with Ancillary Facilities and Associated Filling of Land For a Period of 5 Years</p>	<p><u>SCALE</u></p> <p>1:200</p> <p>@A4</p>
		<p>For Identification Only</p>
		<p>Drawing No.: 2-01</p>

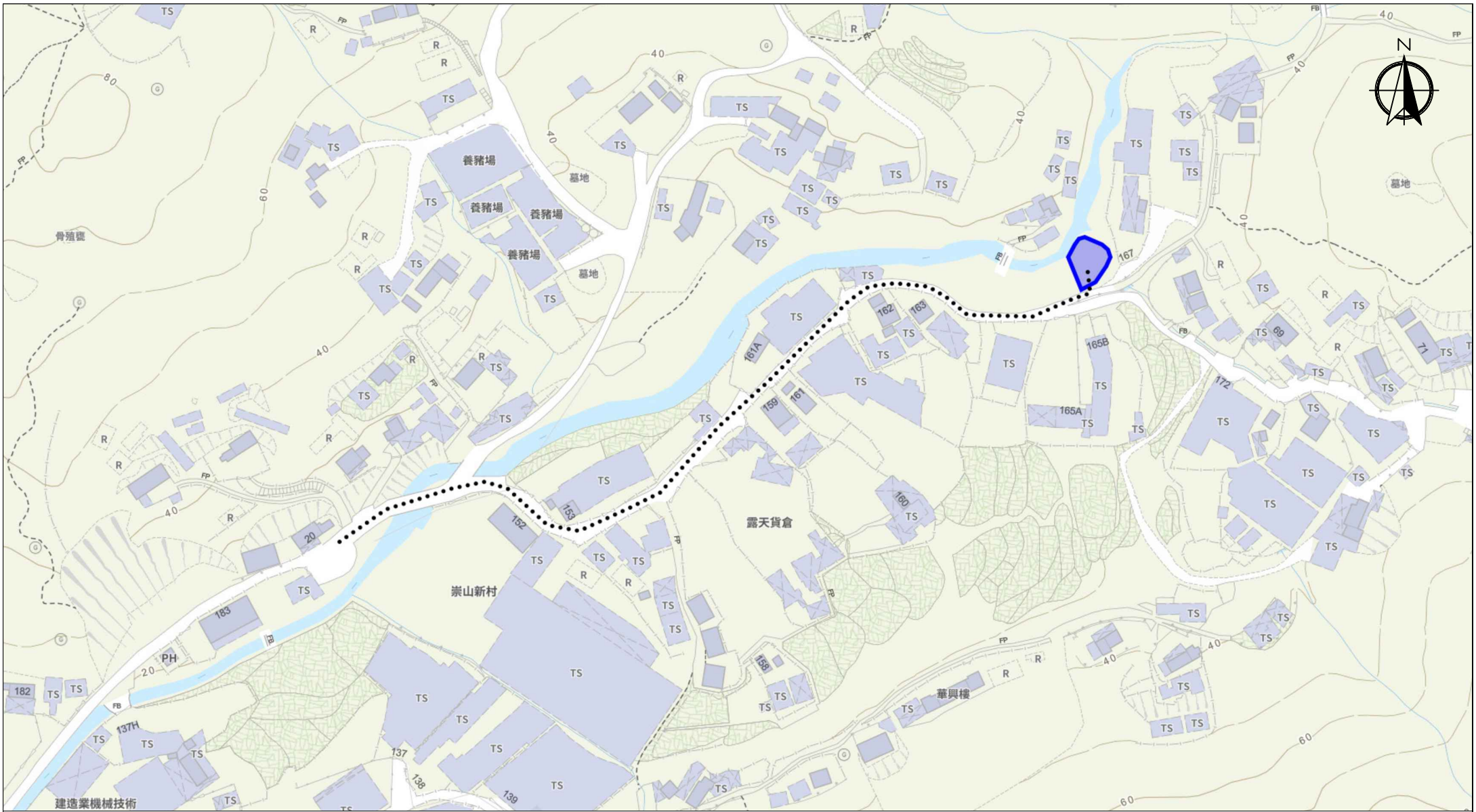

Scale: Undefined @A4

Captured from map.gov.hk on 14th August 2025

<p>Appendix 3 Existing Vehicular Access</p>	<p>Location: D.D. 118 Lot 2309 S.A (Part) OZP: S/YL-TT/20 District: Tai Tong Zoning: Agriculture</p>	<p>Project: Proposed Temporary Place of Recreation, Sports or Culture (Hobby Farm) with Ancillary Facilities and Associated Filling of Land For a Period of 5 Years</p>	<p>Width of Tai Shue Ha Road East: 6m (About) with passing space Map Legend: ●●●●● Road Path — Site Boundary</p>	<p>Drawing No.: 3-01 For Identification Only Date: 24/11/2025</p>
--	--	--	--	---

Proposed Filling of Land Perimeter

Application Site Area: 177.4 m²(About)
 Proposed Land Filling Area: 57 m² (About)
 Depth of Land Filling: About 0.2 m
 Original Site Levels: +27.6 mPD (About)
 Existing Site Levels: +27.8 mPD (About)
 Material of Filling: Concrete
 Proposed Use: Structures building, Car Parking and Circulation Space



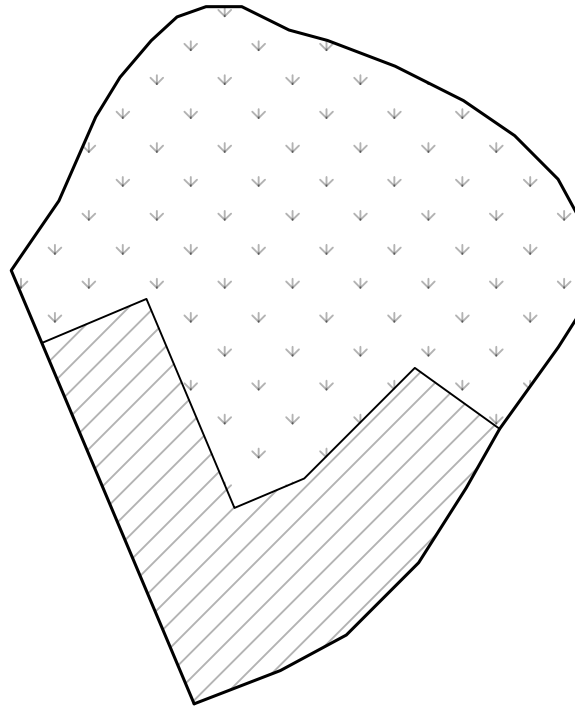

Pave Ratio

Farm Area (Non-Paved Area): About 120.4 m² (About 67.9%)
 Paved Area: (Paved with Concrete): About 57 m² (About 32.1%)





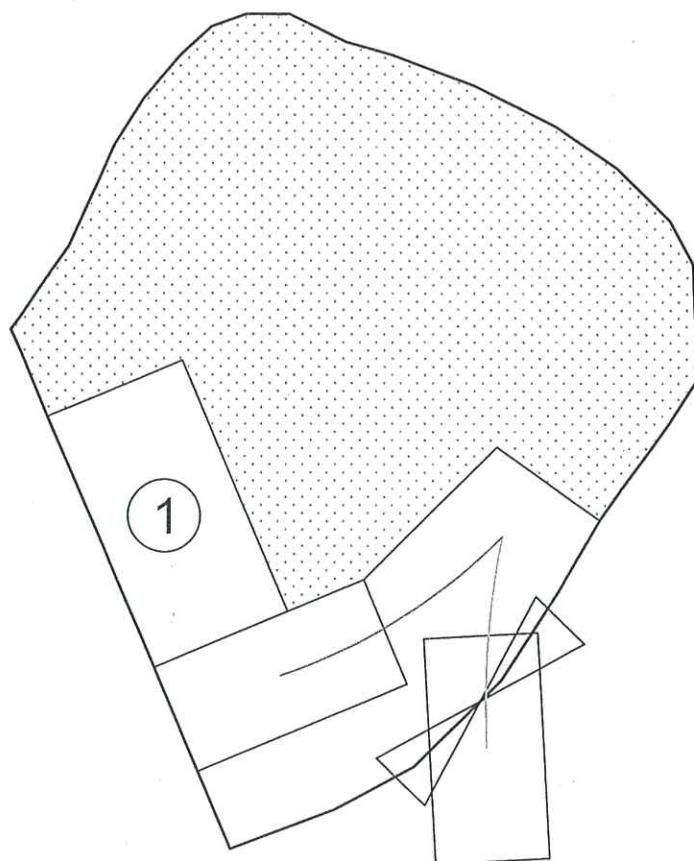

Legend:

-  Paved with Concrete Area
-  Non-Paved Area

<p><u>Appendix 4</u></p> <p>Location: DD 118 Lot 2309 RP</p> <p>OZP: S/YL-TT/20 District: Tai Tong Zoning: Agriculture</p> <p>Date: 15 February 2026</p>	<p><u>Paved Area</u> 平整位置圖</p> <p>擬議臨時康體文娛場所 (休閒農場) 連附屬設施及相關填土工程 (為期5年)</p> <p>Proposed Temporary Place of Recreation, Sports or Culture (Hobby Farm) with Ancillary Facilities and Associated Filling of Land For a Period of 5 Years</p>	<p><u>SCALE</u></p> <p>1:200</p> <p>@A4</p>
<p>For Identification Only</p>		<p>Drawing No.: 4-01</p>



Legend:

-  Ingress/egress (Width: About 4.5m)
-  Proposed Structures
-  Private Car Parking Space
-  Farm Reception and Storage

<p style="text-align: center;"><u>Appendix 5</u></p> <p>Location: DD 118 Lot 2309 RP</p> <p>OZP: S/YL-TT/20 District: Tai Tong Zoning: Agriculture</p> <p>Date: 4 February 2026</p>	<p style="text-align: center;"><u>Vehicle Maneuvering Plan</u></p> <p style="text-align: center;">擬議臨時康體文娛場所 (休閒農場) 連附屬設施及相關填土工程 (為期5年)</p> <p>Proposed Temporary Place of Recreation, Sports or Culture (Hobby Farm) with Ancillary Facilities and Associated Filling of Land For a Period of 5 Years</p>	<p style="text-align: center;"><u>SCALE</u></p> <p style="text-align: center;">1:160</p> <p style="text-align: center;">@A4</p> <table border="1" style="width: 100%; border-collapse: collapse;"> <tr> <td style="text-align: center;">For Identification Only</td> <td style="text-align: center; font-size: small;">Drawing No.:</td> </tr> <tr> <td></td> <td style="text-align: center;">5</td> </tr> </table>	For Identification Only	Drawing No.:		5
For Identification Only	Drawing No.:					
	5					

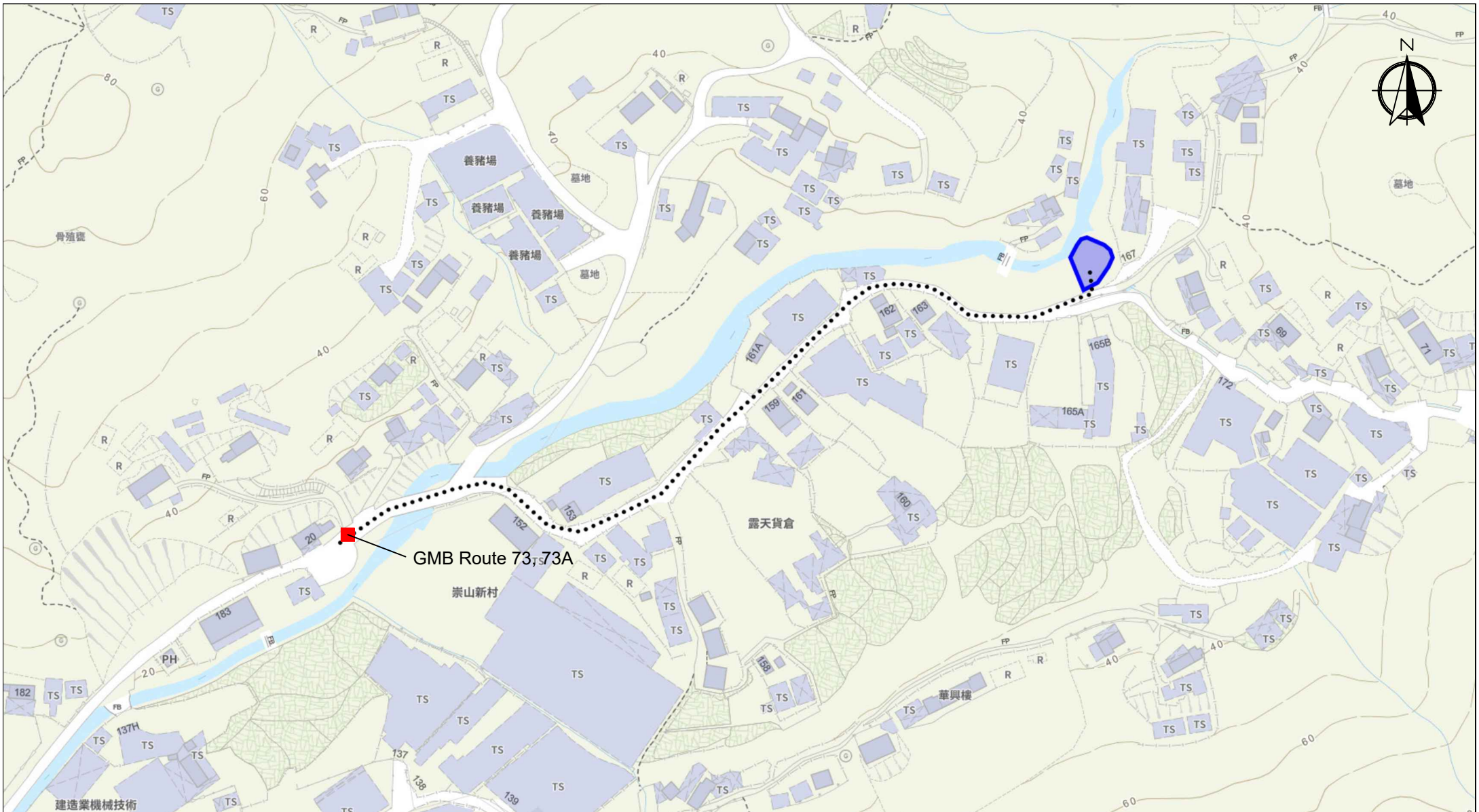



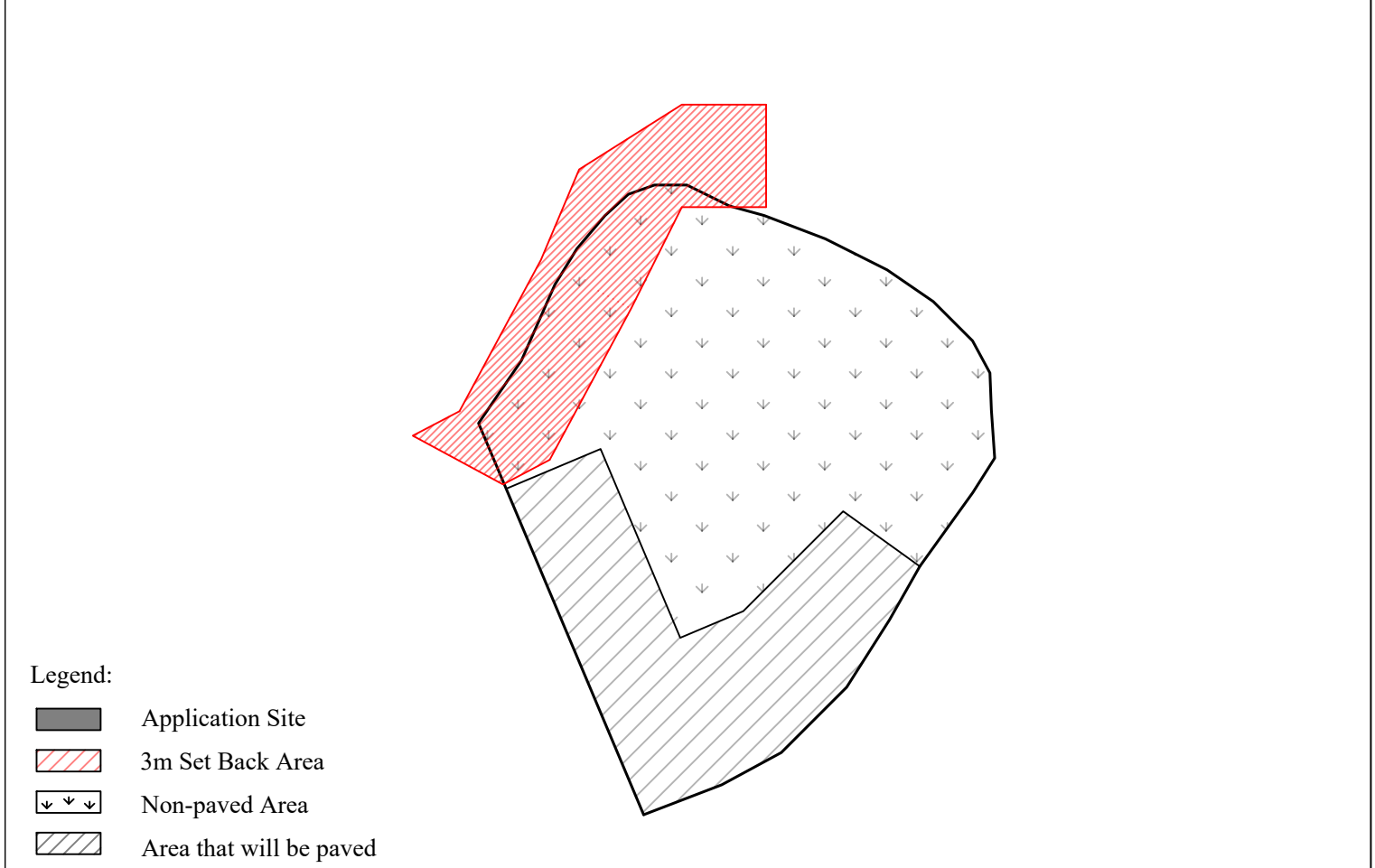
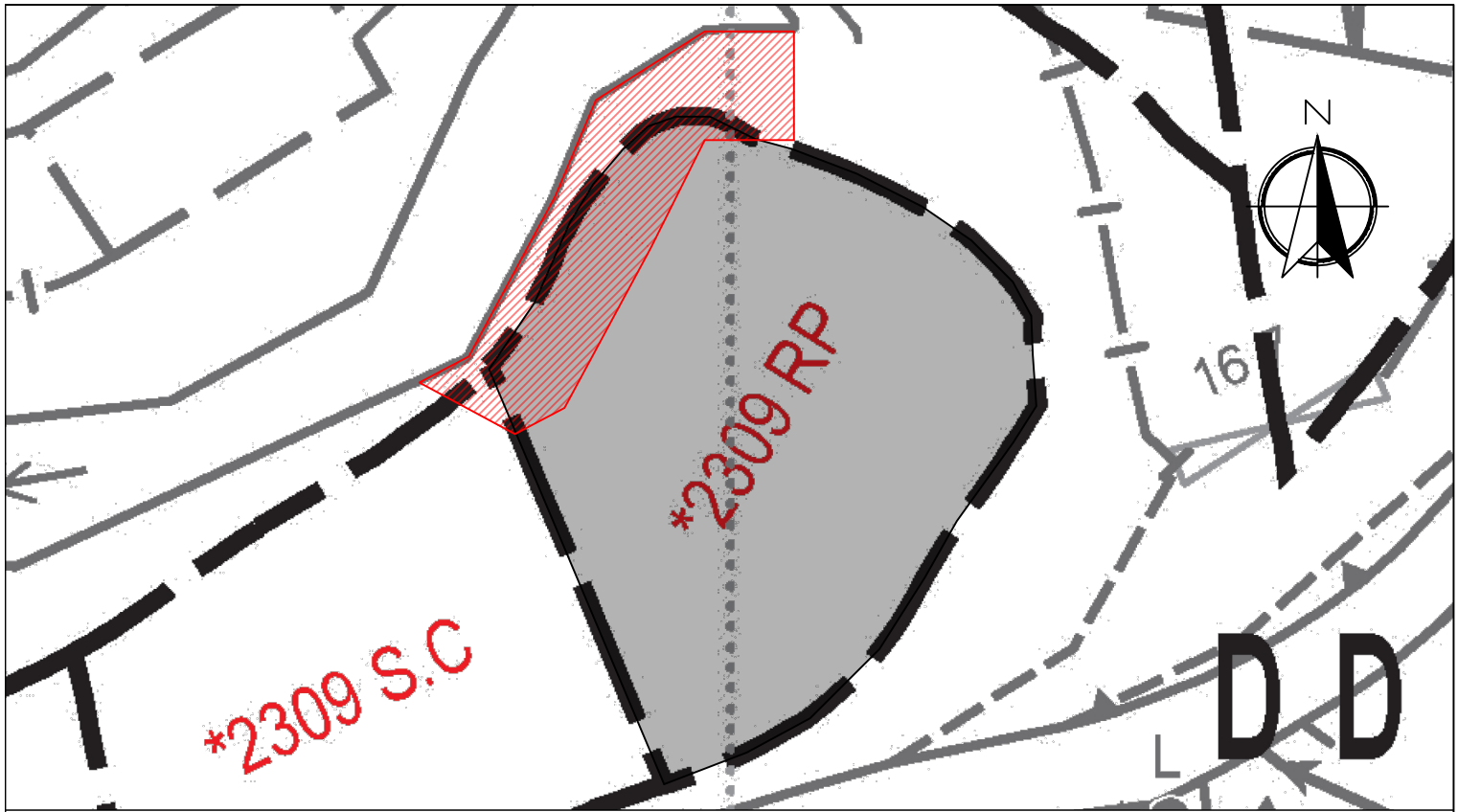

Scale: Undefined @A4

Captured from map.gov.hk on 14th August 2025

<p>Appendix 6 Public Transport</p>	<p>Location: D.D. 118 Lot 2309 S.A (Part) OZP: S/YL-TT/20 District: Tai Tong Zoning: Agriculture</p>	<p>Project: Proposed Temporary Place of Recreation, Sports or Culture (Hobby Farm) with Ancillary Facilities and Associated Filling of Land For a Period of 5 Years</p>	<p>Width of Tai Shue Ha Road East: 6m (About) with passing space Map Legend: ●●●●● Road Path — Site Boundary</p>	<p>Drawing No.: 6 For Identification Only Date: 04/02/2026</p>
---	--	--	--	--



Legend:

-  Application Site
-  3m Set Back Area
-  Non-paved Area
-  Area that will be paved

<p><u>Appendix 7</u></p> <p>Location: DD 118 Lot 2309 RP</p> <p>OZP: S/YL-TT/20 District: Tai Tong Zoning: Agriculture</p> <p>Date: 9 March 2026</p>	<p><u>Stream Set Back Area</u></p> <p>擬議臨時康體文娛場所 (休閒農場) 連附屬設施及相關填土工程 (為期5年)</p> <p>Proposed Temporary Place of Recreation, Sports or Culture (Hobby Farm) with Ancillary Facilities and Associated Filling of Land For a Period of 5 Years</p>	<p><u>SCALE</u></p> <p>1:200</p> <p>@A4</p>	<p>For Identification Only</p>	<p>Drawing No.:</p> <p>7</p>
--	--	---	--------------------------------	------------------------------