

Proposed Structures Details

	Structures	Gross Floor Area (GFA)	Height (Not Exceeding)	Storey	Unit(s)
1	G/F: Farm Reception	About 6m x 3.2m = 19.2 m ²	7m	2	1
	U/F: Ancillary Storage	About 6m x 3.2m = 19.2 m ²			
	Total	<u>About 38.4 m²</u>			
	Private Car Parking Space	5m x 2.5m			1

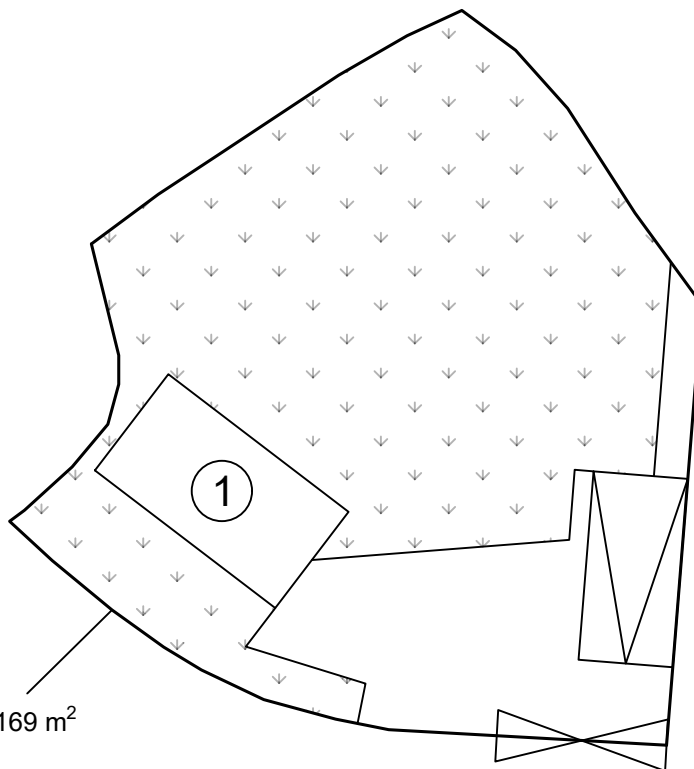

Farming Area: About 169 m²

Farming Area: About 169 m² (About 69% of Total Area)

Legend:

- ⊞ Ingress/egress (Width: About 4.5m)
- ⊞ Proposed Structures
- ⊞ Private Car Parking Space
- ⊞ Farming Area

① Farm Reception and Storage

Total Area: 245 m² (About)
 Covered Area: 19.2 m² (About)
 Uncovered Area: 225.8 m² (About)
 Non-Domestic GFA: 38.4 m² (About)
 Nos. of Proposed Structures: 1

<p><u>Appendix 2</u></p> <p>Location: DD 118 Lot 2309 S.A (Part)</p> <p>OZP: S/YL-TT/20</p> <p>District: Tai Tong</p> <p>Zoning: Agriculture</p> <p>Date: 9 March 2026</p>	<p><u>Proposed Layout Plan</u></p> <p>擬議佈局平面圖</p> <p>擬議臨時康體文娛場所 (休閒農場)</p> <p>連附屬設施及相關填土工程</p> <p>(為期5年)</p> <p>Proposed Temporary Place of Recreation, Sports or Culture (Hobby Farm) with Ancillary Facilities and Associated Filling of Land For a Period of 5 Years</p>	<p><u>SCALE</u></p> <p>1:200</p> <p>@A4</p>
		<p>For Identification Only</p>
		<p>Drawing No.: 2-01</p>

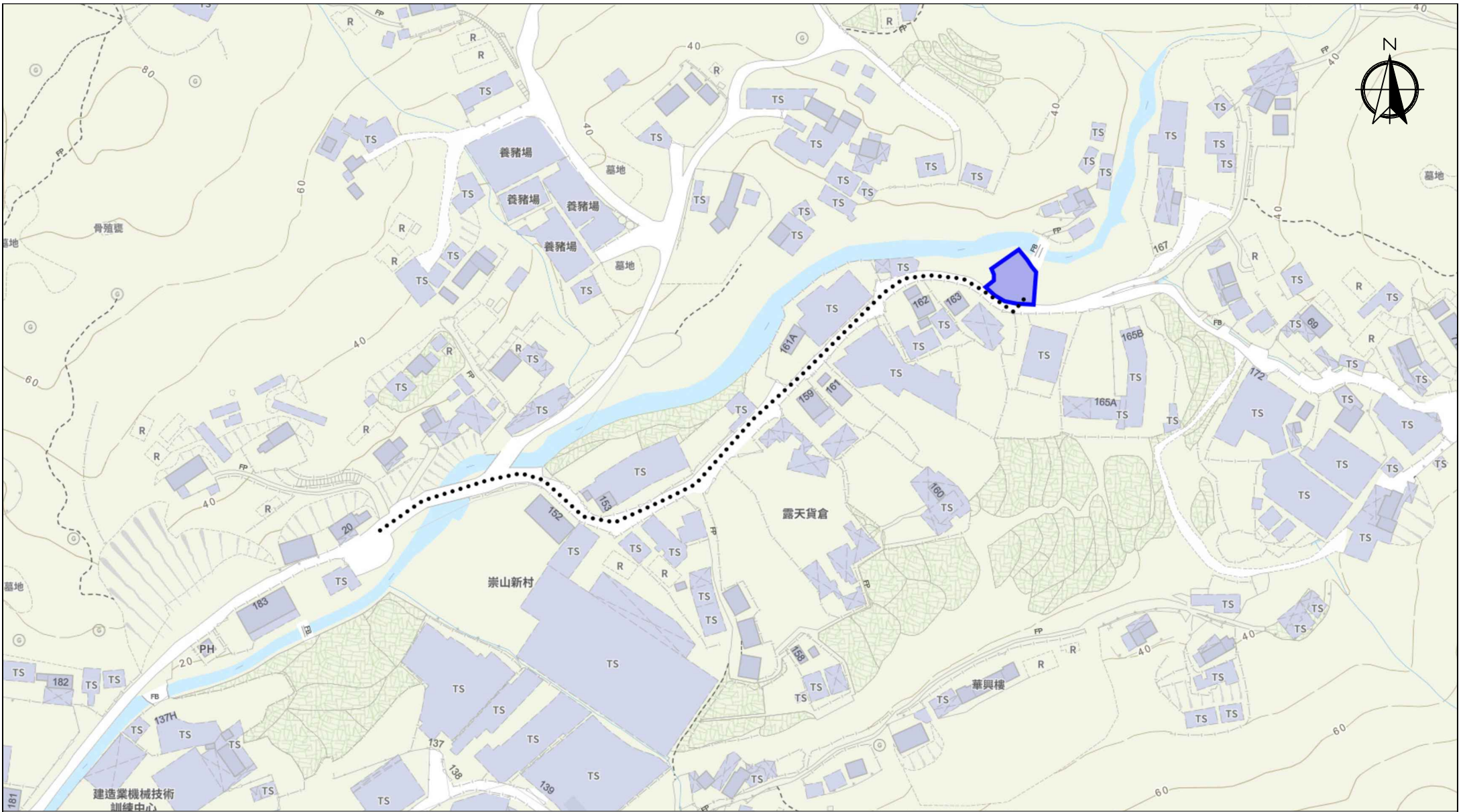

Scale: Undefined @A4

Captured from map.gov.hk on 14th November 2025

<p>Appendix 3 Existing Vehicular Access</p>	<p>Location: D.D. 118 Lot 2309 S.A (Part) OZP: S/YL-TT/20 District: Tai Tong Zoning: Agriculture</p>	<p>Project: Proposed Temporary Place of Recreation, Sports or Culture (Hobby Farm) with Ancillary Facilities and Associated Filling of Land For a Period of 5 Years</p>	<p>Width of Tai Shue Ha Road East: 6m (About) with passing space Map Legend: ●●●●● Road Path — Site Boundary</p>	<p>Drawing No.: 3-01 For Identification Only Date: 14/11/2025</p>
--	--	--	--	--

Proposed Filling of Land Perimeter

Application Site Area: 245 m² (About)
 Proposed Land Filling Area: 76 m² (About)
 Depth of Land Filling: About 0.2 m
 Original Site Levels: +25.6 mPD (About)
 Proposed Site Levels: +25.8 mPD (About)
 Material of Filling: Concrete
 Proposed Use: Structures building, Car Parking and Circulation Space



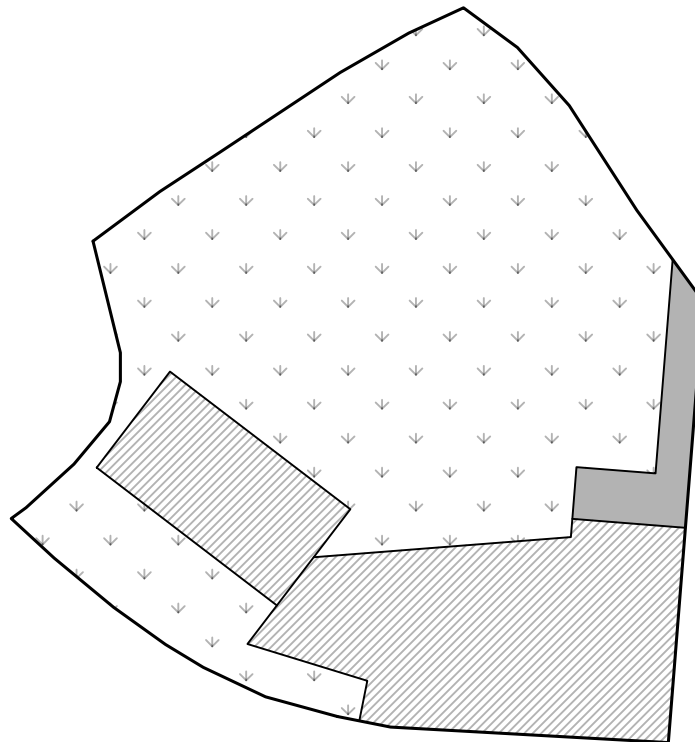

Pave Ratio

Farm Area (Non-Paved Area): About 169 m² (About 69%)
 Paved with Concrete (regularized area): About 67.3 m² (About 27%)
 Will be paved with Concrete Area: About 8.7 m² (About 4%)



Legend:

-  Paved with Concrete Area
-  Non-Paved Area
-  Will be paved with Concrete Area

Appendix 4

Location: DD 118 Lot 2309 S.A (Part)

OZP: S/YL-TT/20
 District: Tai Tong
 Zoning: Agriculture

Date: 2 March 2026

Filling of Land Plan

擬議臨時康體文娛場所 (休閒農場)
 連附屬設施及相關填土工程
 (為期5年)

Proposed Temporary Place of Recreation, Sports or Culture (Hobby Farm) with Ancillary Facilities and Associated Filling of Land For a Period of 5 Years

SCALE

1:200

@A4

For Identification Only

Drawing No.:

4-01

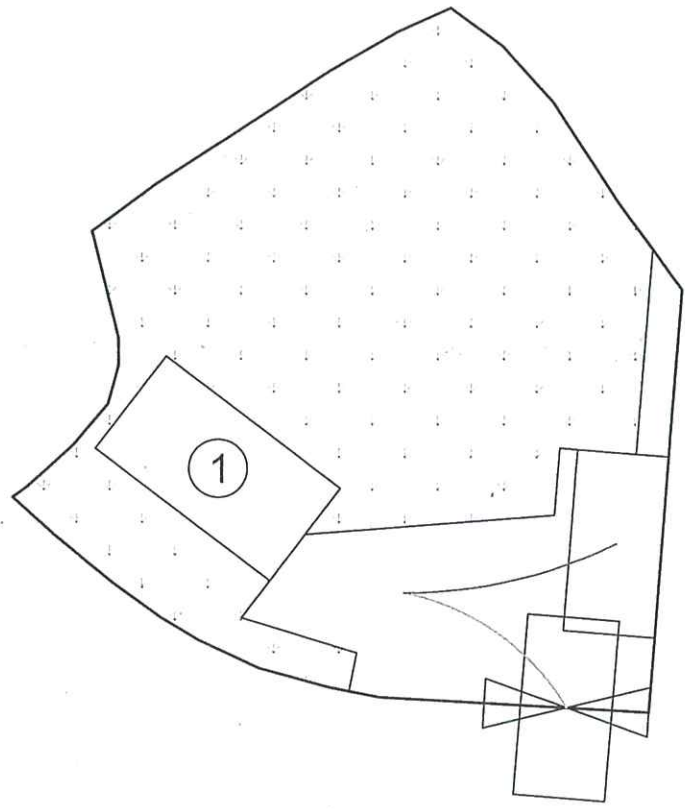

Legend:

- Ingress/egress (Width: About 4.5m)
- Proposed Structures
- Private Car Parking Space
- 1 Farm Reception and Storage

<p><u>Appendix 5</u></p> <p>Location: DD 118 Lot 2309 S.A (Part)</p> <p>OZP: S/YL-TT/20</p> <p>District: Tai Tong</p> <p>Zoning: Agriculture</p> <p>Date: 2 March 2026</p>	<p><u>Vehicle Maneuvering Plan</u></p> <p>擬議臨時康體文娛場所 (休閒農場) 連附屬設施及相關填土工程 (為期5年)</p> <p>Proposed Temporary Place of Recreation, Sports or Culture (Hobby Farm) with Ancillary Facilities and Associated Filling of Land For a Period of 5 Years</p>	<p><u>SCALE</u></p> <p>1:200</p> <p>@A4</p>		
		<p>For Identification Only</p>		
		<table border="1" style="border-collapse: collapse;"> <tr> <td style="padding: 2px;">Drawing No.:</td> </tr> <tr> <td style="text-align: center; padding: 2px;">5</td> </tr> </table>	Drawing No.:	5
Drawing No.:				
5				

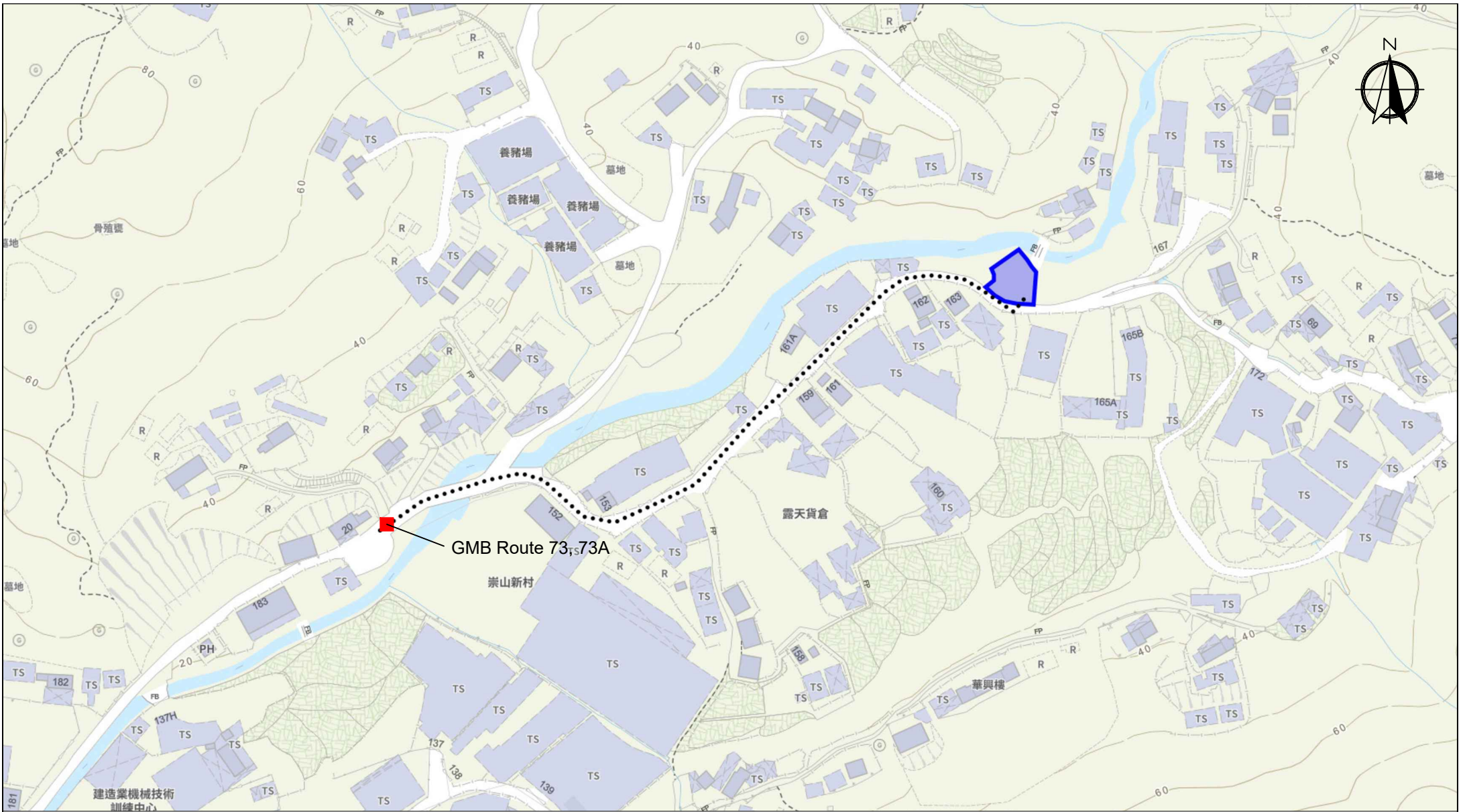

Scale: Undefined @A4

Captured from map.gov.hk on 14th November 2025

<p>Appendix 6 Public Transport</p>	<p>Location: D.D. 118 Lot 2309 S.A (Part) OZP: S/YL-TT/20 District: Tai Tong Zoning: Agriculture</p>	<p>Project: Proposed Temporary Place of Recreation, Sports or Culture (Hobby Farm) with Ancillary Facilities and Associated Filling of Land For a Period of 5 Years</p>	<p>Width of Tai Shue Ha Road East: 6m (About) with passing space Map Legend: ●●●●● Road Path — Site Boundary</p>	<p>Drawing No.: 3-01 For Identification Only Date: 04/02/2026</p>
---	--	--	--	---

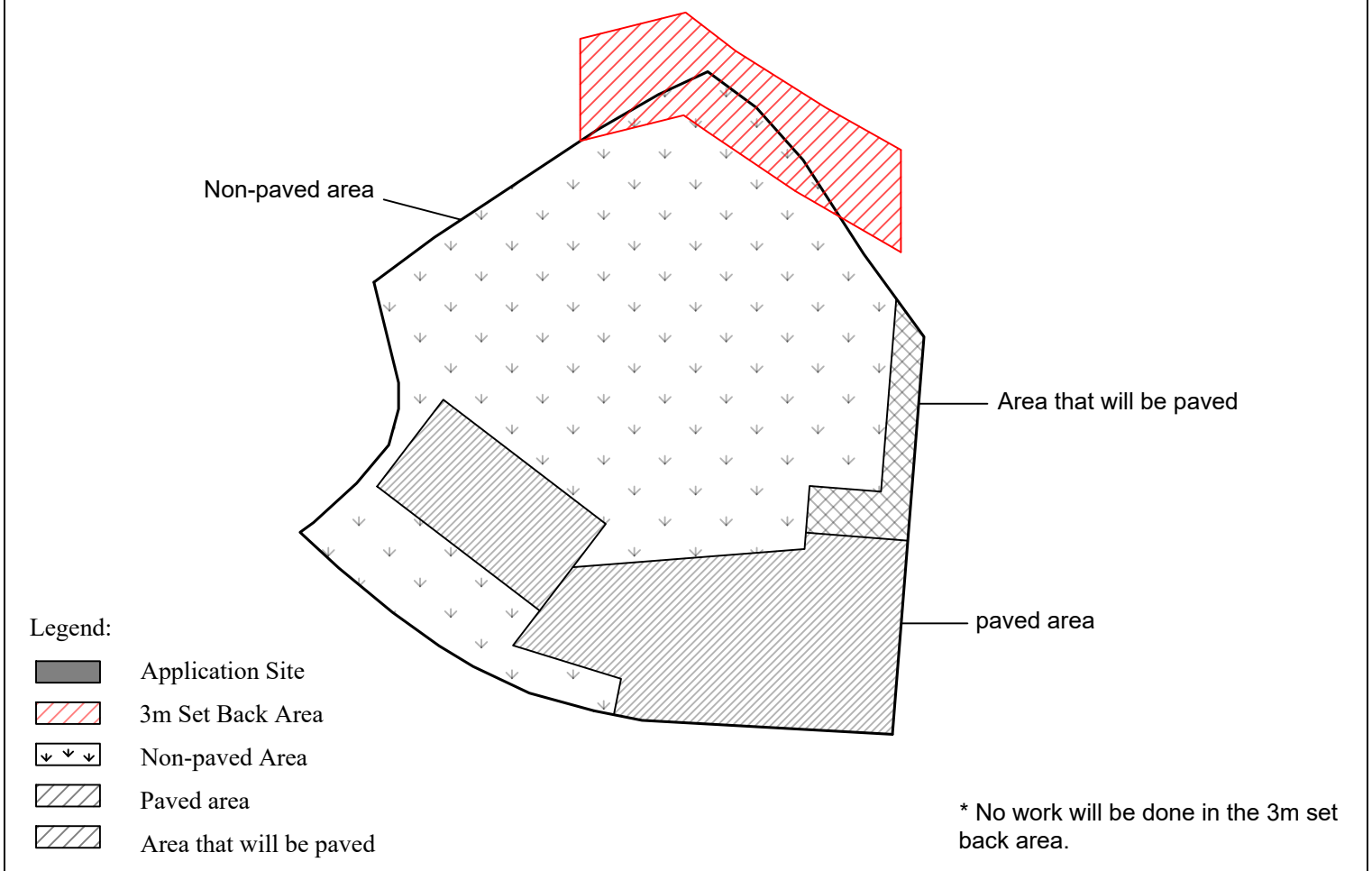
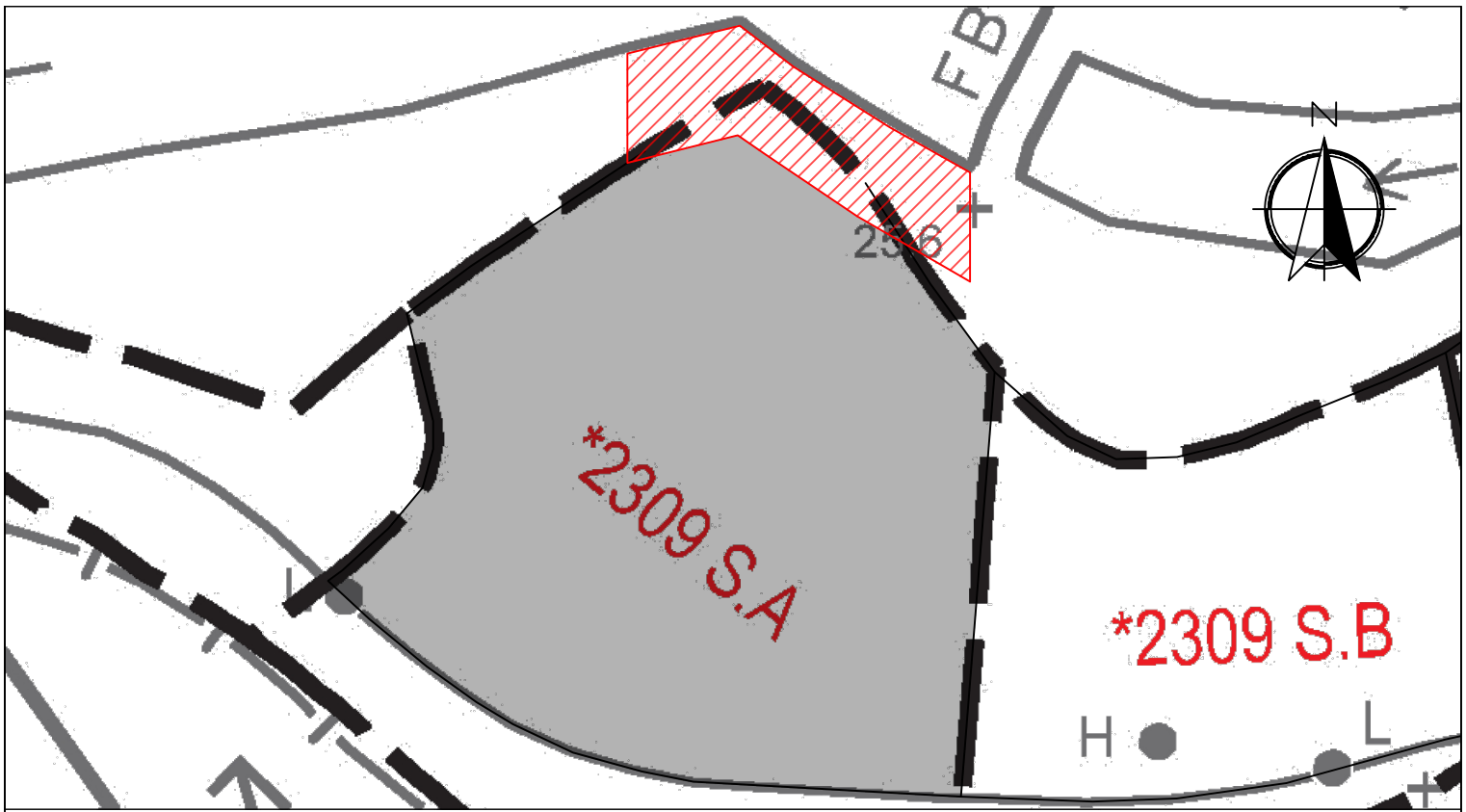



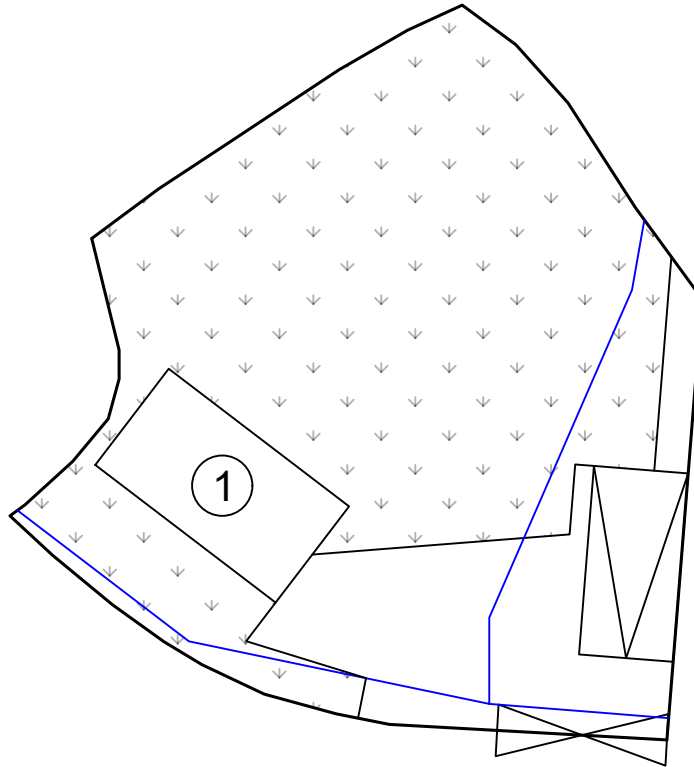

<u>Appendix 7</u>		<u>Stream Set Back Area</u>		<u>SCALE</u>	
Location:	DD 118 Lot 2309 S.A (Part)	擬議臨時康體文娛場所 (休閒農場) 連附屬設施及相關填土工程 (為期5年) Proposed Temporary Place of Recreation, Sports or Culture (Hobby Farm) with Ancillary Facilities and Associated Filling of Land For a Period of 5 Years		1:200	Drawing No.:
OZP:	S/YL-TT/20			@A4	
District:	Tai Tong				
Zoning:	Agriculture	For Identification Only		7	
Date:	9 March 2026				



* 1.5m reserves has been provided for WSD to carry out relevant work.

Legend:

-  Farming Area
-  Proposed Structure
-  Private Car Parking Space
-  Water Main

<p><u>Appendix 8</u></p> <p>Location: DD 118 Lot 2309 S.A (Part)</p> <p>OZP: S/YL-TT/20</p> <p>District: Tai Tong</p> <p>Zoning: Agriculture</p> <p>Date: 2 March 2026</p>	<p><u>Water Main Plan</u></p> <p>擬議臨時康體文娛場所 (休閒農場) 連附屬設施及相關填土工程 (為期5年)</p> <p>Proposed Temporary Place of Recreation, Sports or Culture (Hobby Farm) with Ancillary Facilities and Associated Filling of Land For a Period of 5 Years</p>	<p><u>SCALE</u></p> <p>1:200</p> <p>@A4</p>
		<p>For Identification Only</p>
		<p>Drawing No.:</p> <p style="text-align: center;">8</p>