



連接僑興路的通道
Access leading from
Kiu Hing Road

Application site

Proposed Temporary Shop & Services
for a period of 3 Years at Lots 1777 S.C,
1777S.D, 1777S.F, 1777RP(part), 1777S.M,
1777S.N, 1777S.O(part), 1777S.U, 1777S.V,
1777S.AA, 1777S.AB, 1777S.G, 1777S.H,
1777RP(part), 1777S.N, 1777S.H. and 1778
in D.D. 119, Tai Tong ,Yuen Long,N.T.

Vehicular Access Plan

● ● ● Vehicular Access leading
From Kiu Hing Road

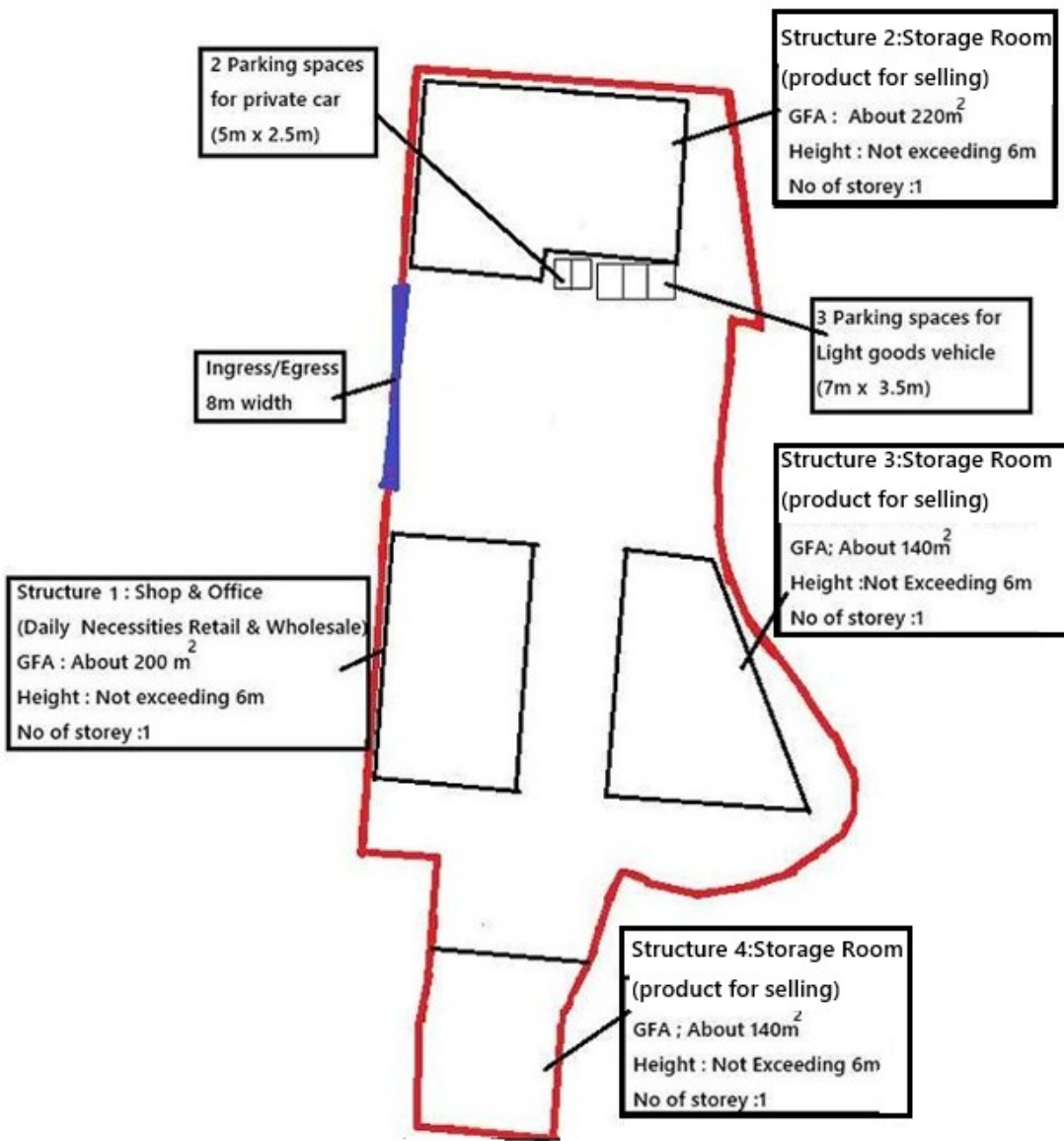

Proposed Temporary Shop & Services and Associated Filling of land for a period of 3 years at Lots 1777S.C, 1777S.D, 1777S.F, 1777RP(part), 1775S.M, 1775S.N, 1775S.O(part), 1775S.U, 1775S.V, 1775S.AA, 1775S.AB, 1772S.G, 1772S.H, 1772RP(part),1772S.N, 1771S.H and 1778 in D.D.119 ,Tai Long ,Yuen Long N.T.

Proposed Layout Plan

Remark:

 Structure

 Ingress/Egress

Paved Area plan



Application site

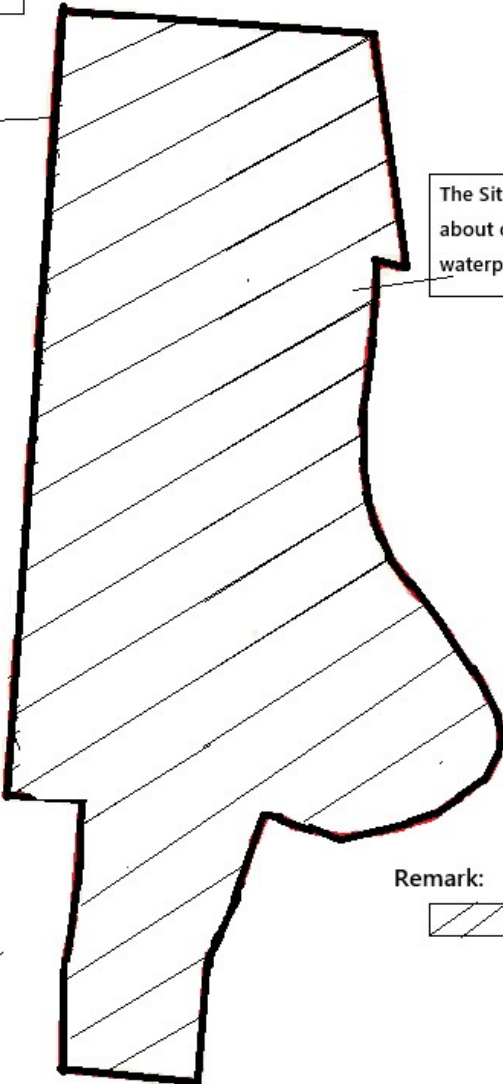

The Site will paved with concrete at a depth about of 0.2 m to provide a suitable level and waterproof surface for erection of structures

Remark:

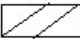
-  Paved area (proposed filling of land)
- Site area=Paved area
- Area: about 1410m²

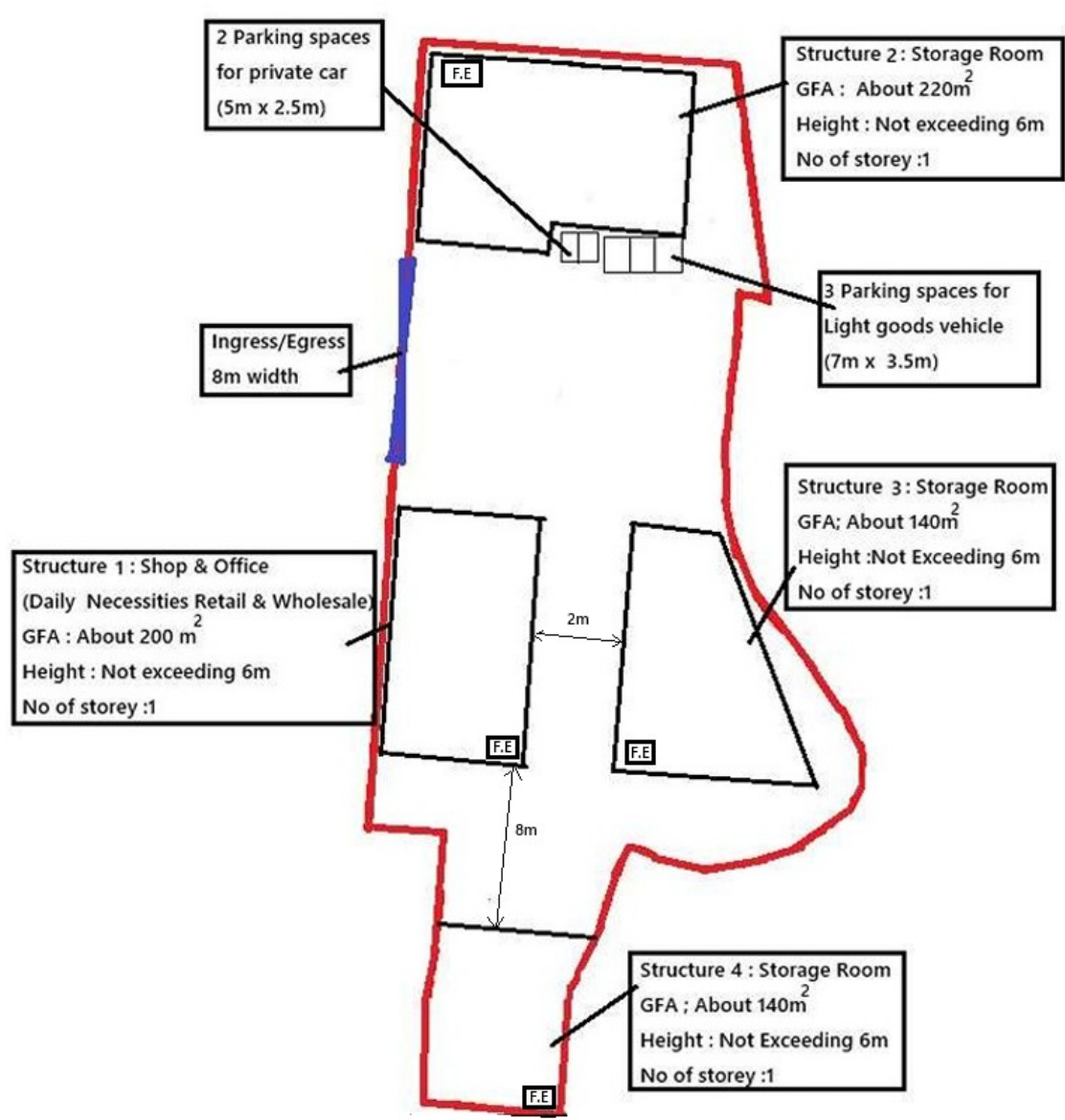

<p>Proposed Temporary Shop & Services and Associated Filling of land for a period of 3 years at Lots 1777S.C, 1777S.D, 1777S.F, 1777RP(part), 1775S.M, 1775S.N, 1775S.O(part), 1775S.U, 1775S.V, 1775S.AA, 1775S.AB, 1772S.G, 1772S.H, 1772RP(part),1772S.N, 1771S.H and 1778 in D.D.119 ,Tai Long ,Yuen Long N.T.</p>	<h3>Proposed Fire Service Installations Plan</h3>	<p>Remark:</p> <ul style="list-style-type: none"> Structure Ingress/Egress F.E 5KG carbon dioxide fire extinguisher
--	---	--