

**Proposed Temporary Warehouse for Construction Material and Ancillary Site Office for a Period of 3 Years
at
Lots 1229 (Part), 1237 (Part), 1238 (Part) & 1252 (Part) in D.D. 119, Pak Sha Tsuen, Yuen Long, N.T.**

Annex 1 Estimated Traffic Generation

- 1.1 The application site is accessible via an existing vehicular access leading from Kung Um Road. Having mentioned that the site is intended for warehouse, traffic generated by the proposed development is extremely insignificant.
- 1.2 The estimated average traffic generation and traffic generation rate at peak hours are as follow:

Type of Vehicle	<u>Average Traffic Generation Rate</u> (pcu/hr)	<u>Average Traffic Attraction Rate</u> (pcu/hr)	<u>Traffic Generation Rate at Peak Hours</u> (pcu/hr)	<u>Traffic Attraction Rate at Peak Hours</u> (pcu/hr)
Light goods vehicle (not exceeding 5.5 tones)	0.19	0.19	0	0

Note 1: The opening hour of the proposed development is restricted to 9:00 a.m. to 5:00 p.m. from Mondays to Saturdays. No operation will be held on Sundays and public holidays.

Note 2: The pcu of light goods vehicle is taken as 1.5.

Note 3: Morning peak is defined as 7:00a.m. to 9:00a.m. whereas afternoon peak is defined as 5:00p.m. to 7:00p.m.

- 1.3 In association with the intended purpose, adequate space for manoeuvring of light goods vehicle would be provided and so queueing up of traffic would not be the result especially that the traffic generated is insignificant. The negligible increase in traffic would not aggravate the traffic condition of Kung Um Road and nearby road networks.

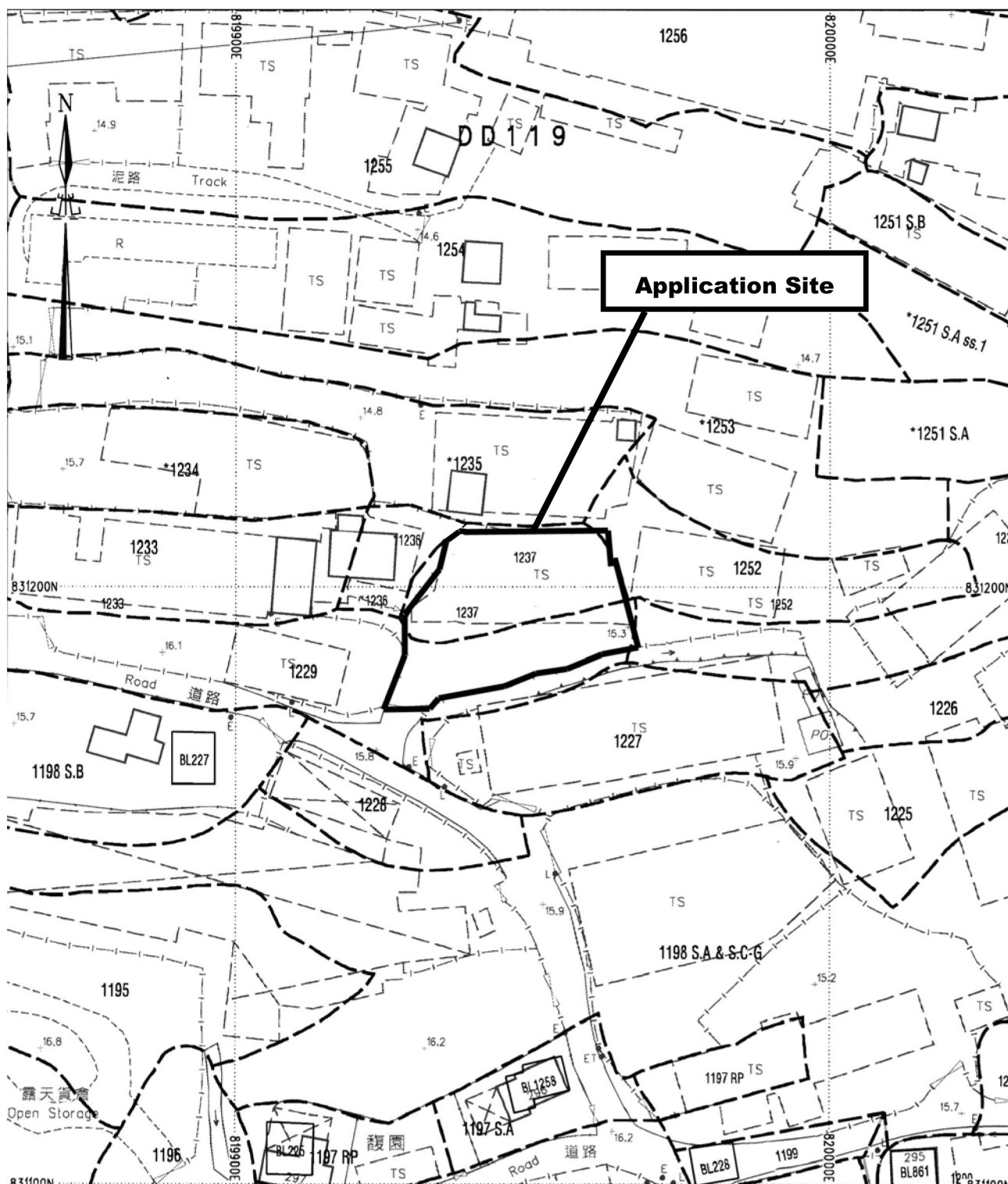

Project 項目名稱:

Proposed Temporary Warehouse for Storage of Construction Material & Ancillary Site Office for a Period of 3 Years at Lots 1229 (Part), 1237 (Part), 1238 (Part) & 1252 (Part) in D.D. 119, Pak Sha Tsuen, Yuen Long, N.T.

Drawing Title :

Application Site

Drawing No. 圖號:

Figure 1

Remarks 備註:

Scale 比例:

1:1000

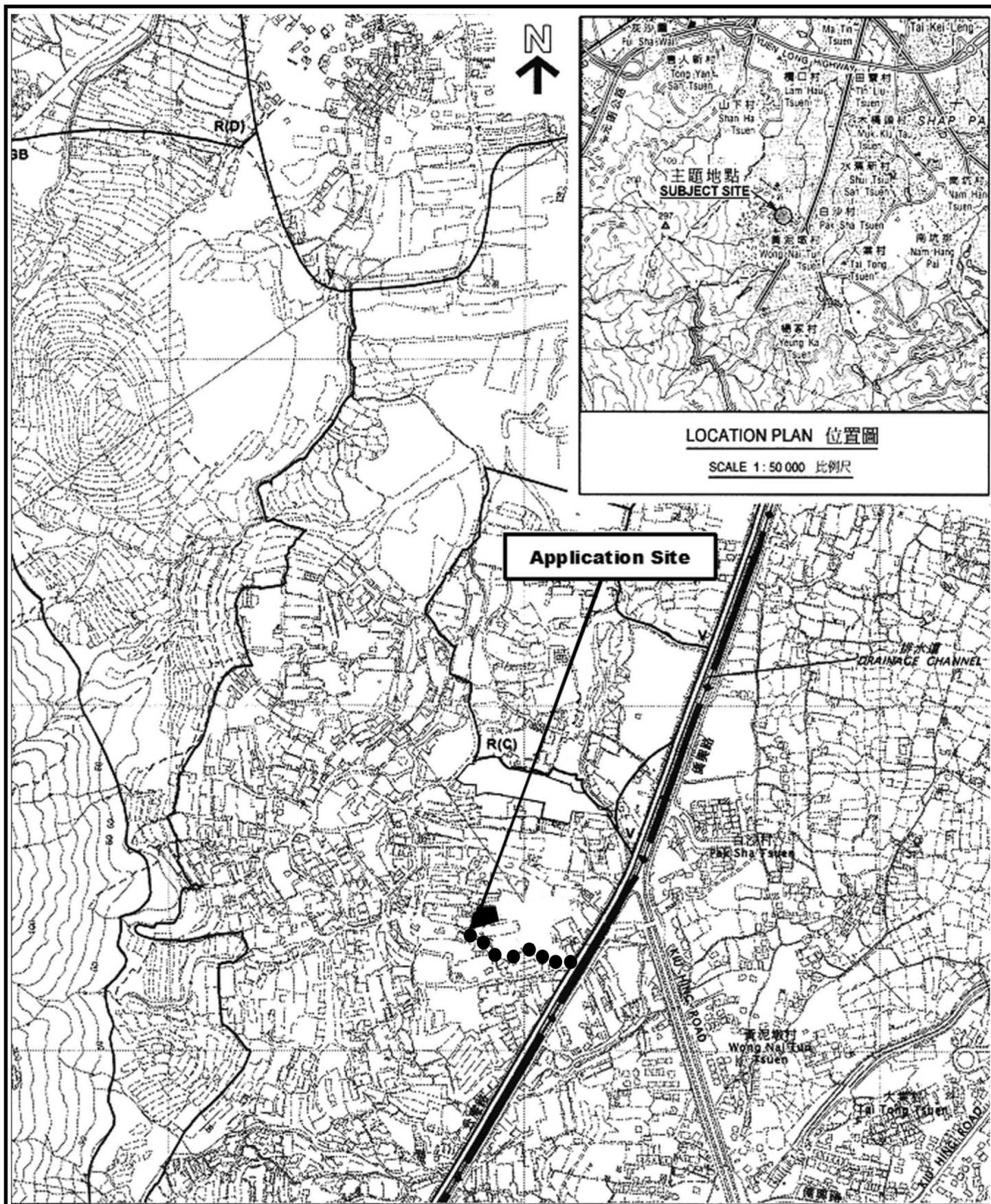

Project 項目名稱:

Proposed Temporary Warehouse for Storage of Construction Material & Ancillary Site Office for a Period of 3 Years at Lots 1229 (Part), 1237 (Part), 1238 (Part) & 1252 (Part) in D.D. 119, Pak Sha Tsuen, Yuen Long, N.T.

Drawing Title 圖目:

Location Plan

Drawing No. 圖號:

Figure 2

Remarks 備註:

●●● Vehicular access leading from Kung Um Road

Scale 比例:

1:7500

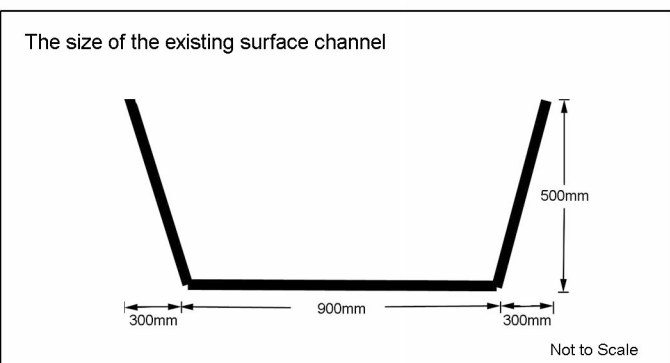
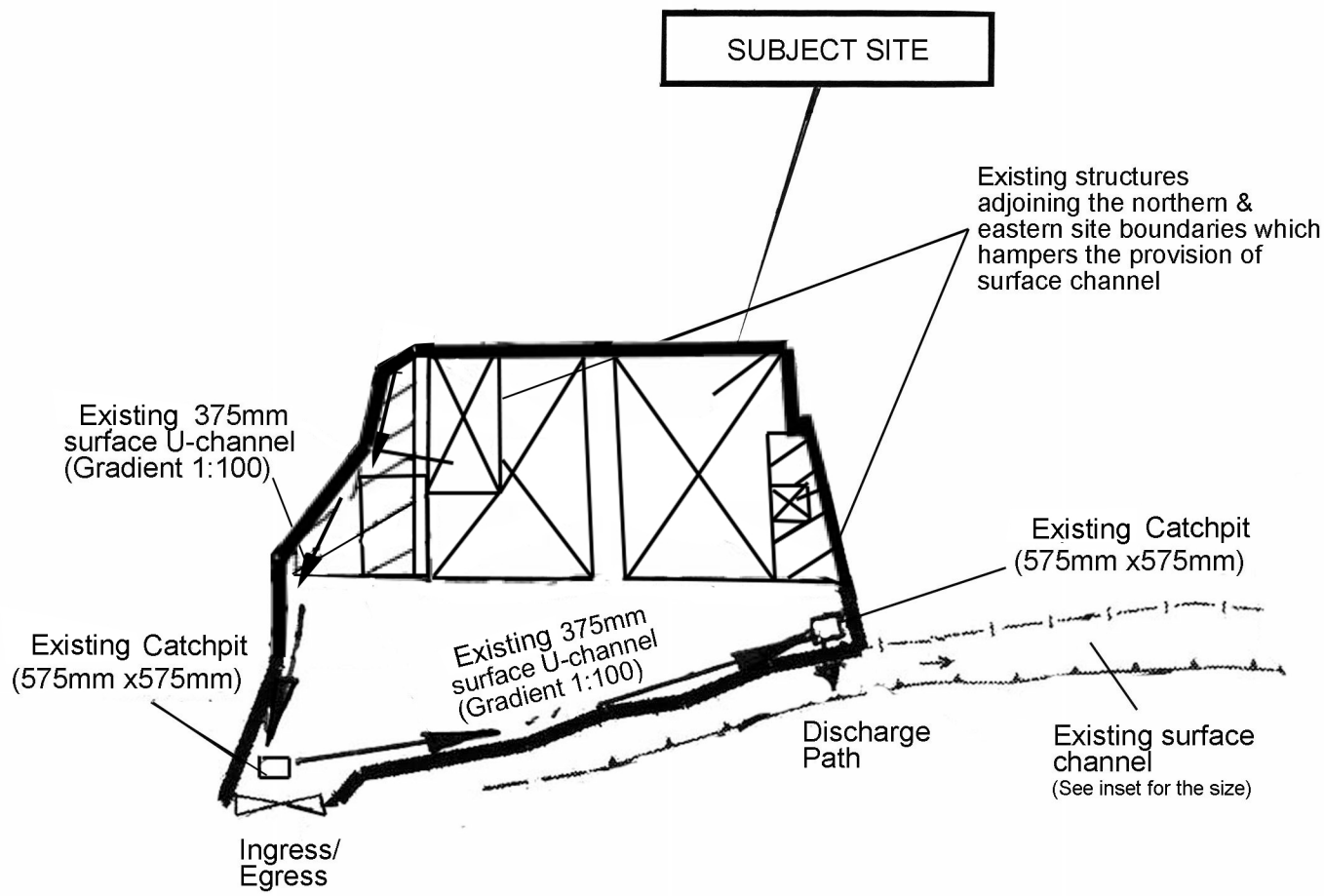

Project 項目名稱:

Proposed Temporary Warehouse for Storage of Construction Material & Ancillary Site Office for a Period of 3 Years at Lots 1229 (Part), 1237 (Part), 1238 (Part) & 1252 (Part) in D.D. 119, Pak Sha Tsuen, Yuen Long, N.T.

Drawing Title 圖目:

As-built Drainage Plan

Drawing No. 圖號:

Figure 4

Remarks 備註:

The drainage plan has been approved for the planning permission No. A/YL-TYST/491

Scale 比例:

1:500