

# LAYOUT PLAN

## AFTER LAND RESUMPTION

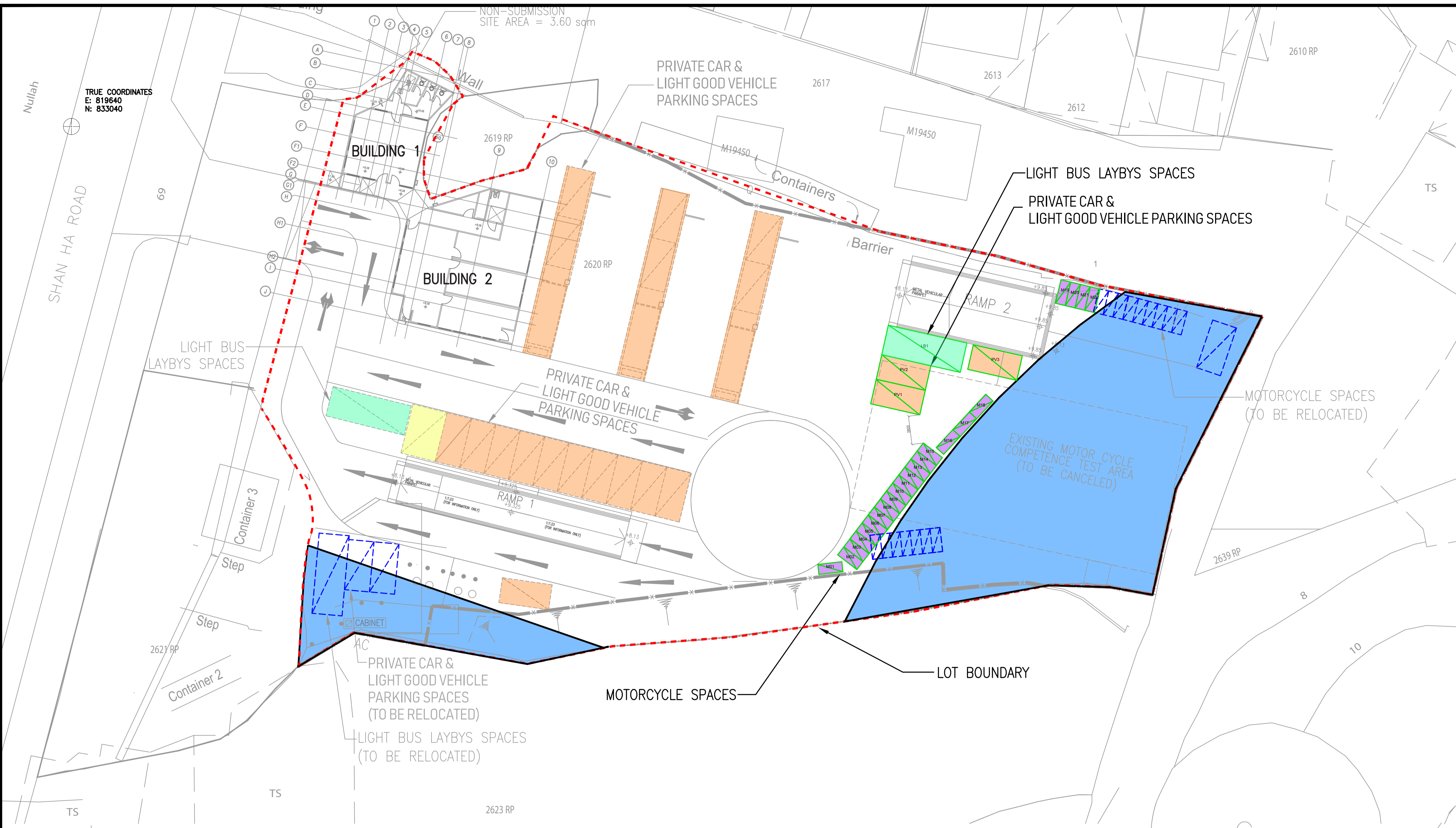

### LEGEND

- PARKING SPACE TO BE CANCELED
- NEW PROPOSED PARKING SPACE
- THE LANDS AS HATCHED ARE THE CONFIRMED LAND RESUMPTION AREA.

PARKING SIZE	QUANTITY	
MOTORCYCLE	2.4M (L) X 1.0M (W) X 2.4M (H) MIN	22 <span style="background-color: purple; display: inline-block; width: 15px; height: 10px; vertical-align: middle;"></span>
PRIVATE CAR & LIGHT GOOD VEHICLE	5.0M (L) X 2.5M (W) X 2.4M (H) MIN	23 <span style="background-color: orange; display: inline-block; width: 15px; height: 10px; vertical-align: middle;"></span>
ACCESSIBLE CAR	5.0M (L) X 3.5M (W) X 2.4M (H) MIN	1 <span style="background-color: yellow; display: inline-block; width: 15px; height: 10px; vertical-align: middle;"></span>
LIGHTBUS LAYBY	8.0M (L) X 3.5M (W) X 3.3M (H) MIN	2 <span style="background-color: lightgreen; display: inline-block; width: 15px; height: 10px; vertical-align: middle;"></span>

**BUILDING**  
 BUILDING 1: 82.61 SQ.M, HEIGHT 3.6M  
 BUILDING 2: 168.55 SQ.M, HEIGHT 3.6M



NUMBER / 編號	DATE / 日期	AMENDMENT / 修訂

CLIENT



安佳駕駛學院  
ANKOR DRIVING SCHOOL

LEAD CONSULTANT & ARCHITECT  
**E. CHUNG DESIGN**  
 歷中設計

MEP CONSULTANT  
**LEE & CHUNG ENGINEERS**

PROJECT / 工程項目  
 ANKOR DRIVING SCHOOL  
 AT LOT 2620RP IN  
 DD 120

DRAWING / 圖名  
**LAYOUT PLAN**

SCALE / 比例	JOB NUMBER / 工程編號
1:200 ON A1	ECLC2502
DATE / 日期	DRAWING NUMBER / 圖號
30-9-2025	2502-1-101

DESIGNED / 設計: EL  
 CHECKED / 審核: EC  
 APPROVED / 審定: EC

• ALL DIMENSIONS ARE IN MILLIMETRES UNLESS OTHERWISE NOTED  
 • 除特別註明外, 所有尺寸均以毫米制  
 • DO NOT SCALE DRAWING  
 • 圖中所有標註尺寸均為準, 不應量度  
 • ALL MEASUREMENTS SHOULD BE VERIFIED ON SITE  
 • 最終尺寸須在現場核對準確  
 THE OWNERSHIP OF THE COPYRIGHT OF THIS DRAWING IS RETAINED BY E. CHUNG DESIGN AND LEE & CHUNG ENGINEERS WHOSE CONSENT MUST BE OBTAINED BEFORE ANY USE/ REPRODUCTION OF THE DRAWING OR ANY PART THEREOF, CAN BE MADE.  
 圖紙內容版權屬中設計所有, 採用或複製此圖紙內容, 必需得本公司的同意