

Extracted from the approved Sha Tau Kok Outline Zoning Plan no. S/NE-STK/2

"Agriculture" zone:	8,618 m ²
"Green Belt" zone:	4,764 m ²
Total Area (about):	13,382 m ²

Not to Scale	<p align="center">Location Plan</p> <p align="center">Rezoning Application from "AGR" and "GB" to "OU (Columbarium)" on various Lots in D. D. 41 and Adjoining Government Land, Tong To, Sha Tau Kok, N.T.</p>	Goldrich Planners & Surveyors Ltd.
October 2025		Plan 1 (P 17106)

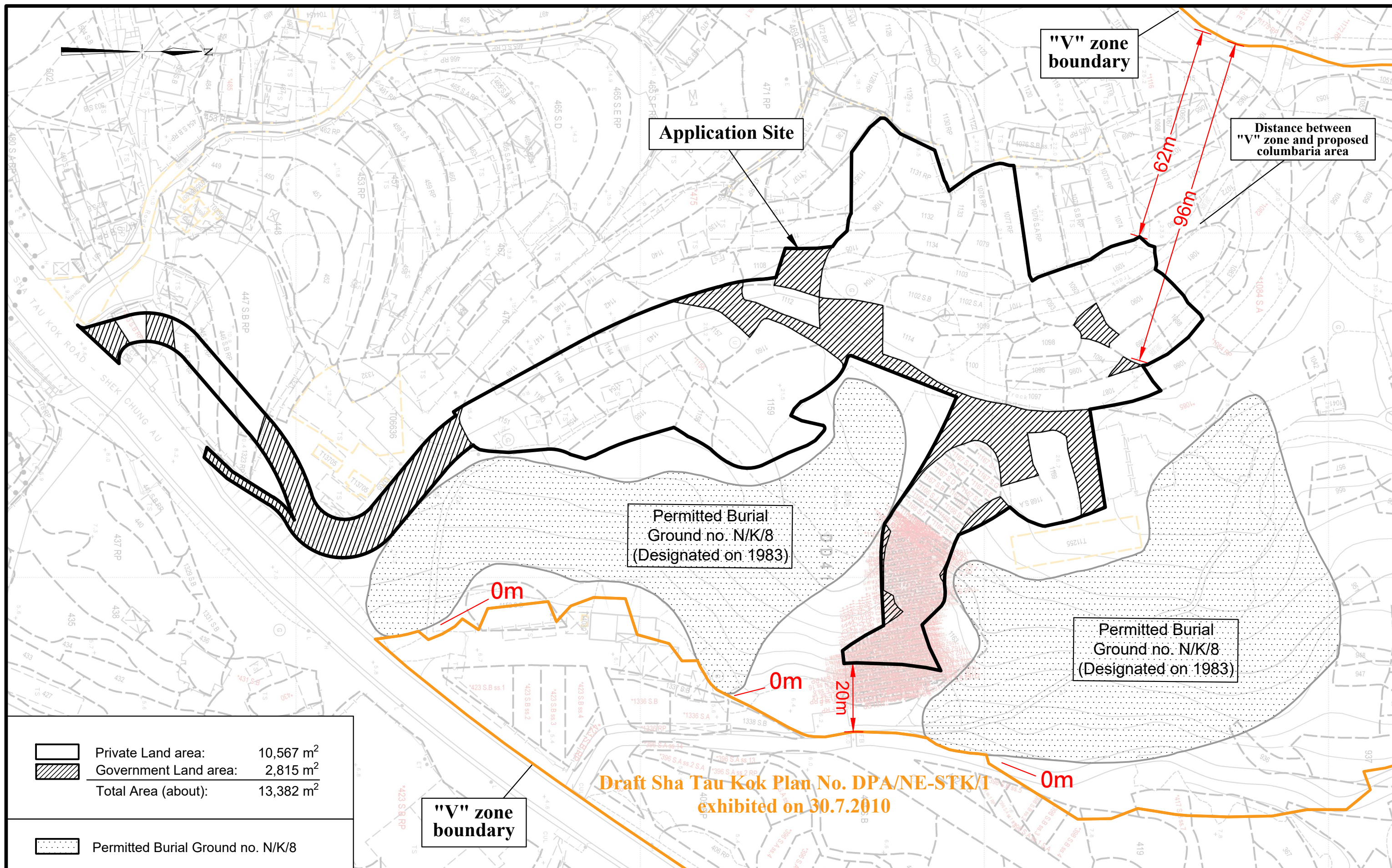

1 : 1000

October 2025

Lot Index Plan

Rezoning Application from "AGR" and "GB" to "OU (Columbarium)"
on various Lots in D. D. 41
and Adjoining Government Land, Tong To, Sha Tau Kok, N.T.

Goldrich Planners
& Surveyors Ltd.

Plan 2
(P 17106)

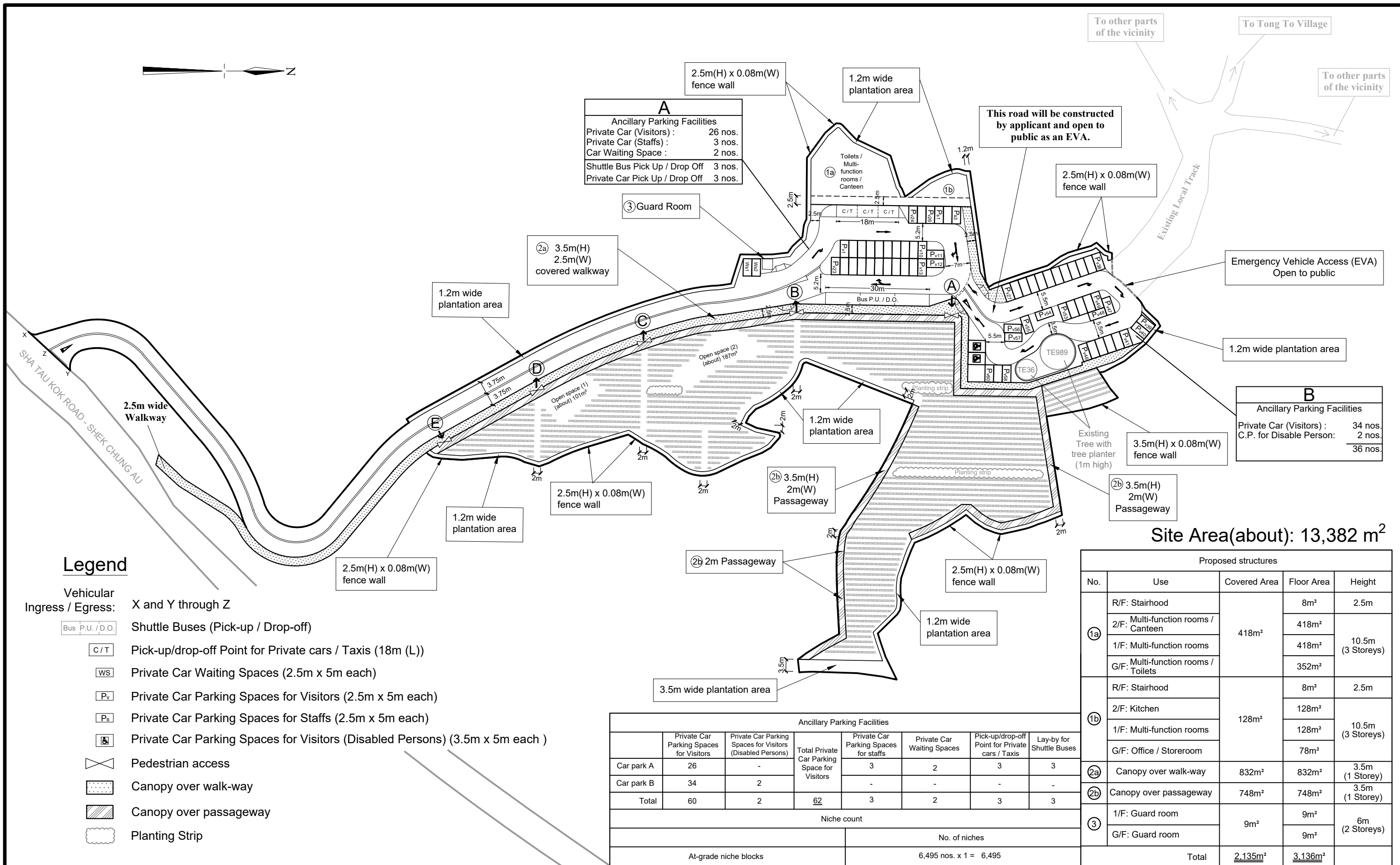
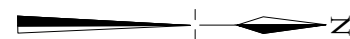

Legend

- Vehicular Ingress / Egress: X and Y through Z
- Bus P.U. / D.O. Shuttle Buses (Pick-up / Drop-off)
- C / T Pick-up/drop-off Point for Private cars / Taxis (18m (L))
- WS Private Car Waiting Spaces (2.5m x 5m each)
- Pv Private Car Parking Spaces for Visitors (2.5m x 5m each)
- Ps Private Car Parking Spaces for Staffs (2.5m x 5m each)
- Private Car Parking Spaces for Visitors (Disabled Persons) (3.5m x 5m each)
- Pedestrian access
- Canopy over walk-way
- Canopy over passageway
- Planting Strip

Ancillary Parking Facilities							
	Private Car Parking Spaces for Visitors	Private Car Parking Spaces for Visitors (Disabled Persons)	Total Private Car Parking Space for Visitors	Private Car Parking Spaces for staffs	Private Car Waiting Spaces	Pick-up/drop-off Point for Private cars / Taxis	Lay-by for Shuttle Buses
Car park A	26	-	62	3	2	3	3
Car park B	34	2		-	-	-	-
Total	60	2		3	2	3	3
Niche count							
				No. of niches			
At-grade niche blocks				6,495 nos. x 1 = 6,495			

Proposed structures				
No.	Use	Covered Area	Floor Area	Height
1a	R/F: Stairhood	418m²	8m²	2.5m
	2/F: Multi-function rooms / Canteen		418m²	10.5m (3 Storeys)
	1/F: Multi-function rooms		418m²	
	G/F: Multi-function rooms / Toilets		352m²	
1b	R/F: Stairhood	128m²	8m²	2.5m
	2/F: Kitchen		128m²	10.5m (3 Storeys)
	1/F: Multi-function rooms		128m²	
	G/F: Office / Storeroom		78m²	
2a	Canopy over walk-way	832m²	832m²	3.5m (1 Storey)
2b	Canopy over passageway	748m²	748m²	3.5m (1 Storey)
3	1/F: Guard room	9m²	9m²	6m (2 Storeys)
	G/F: Guard room		9m²	
Total		2,135m²	3,136m²	

1 : 1000 (A3)

Master Layout Plan

Rezoning Application from “AGR” and “GB” to “OU (Columbarium)”
on various Lots in D. D. 41
and Adjoining Government Land, Tong To, Sha Tau Kok, N.T.

Goldrich Planners
& Surveyors Ltd.

October 2025

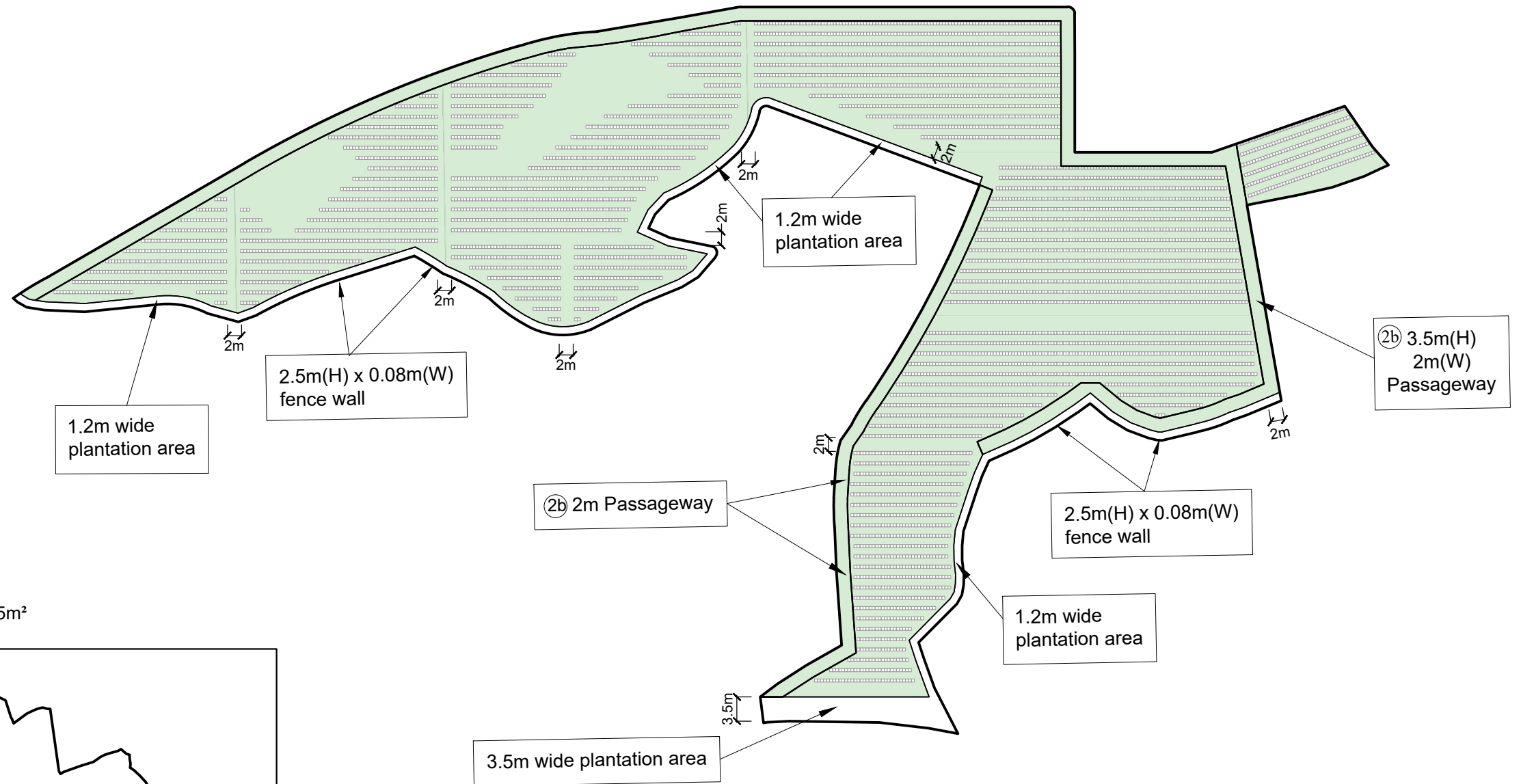
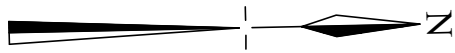

Plan 4
(P 17106)



Note:

Niches Blocks Area:	1,282m ²
Alley and Passageway:	4,467m ²
Open Space Area:	288m ²
Total Area:	<u>6,037m²</u>

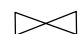
Legend

-  Pedestrian access
-  Alley + Passageway + open space area: 4,755m²

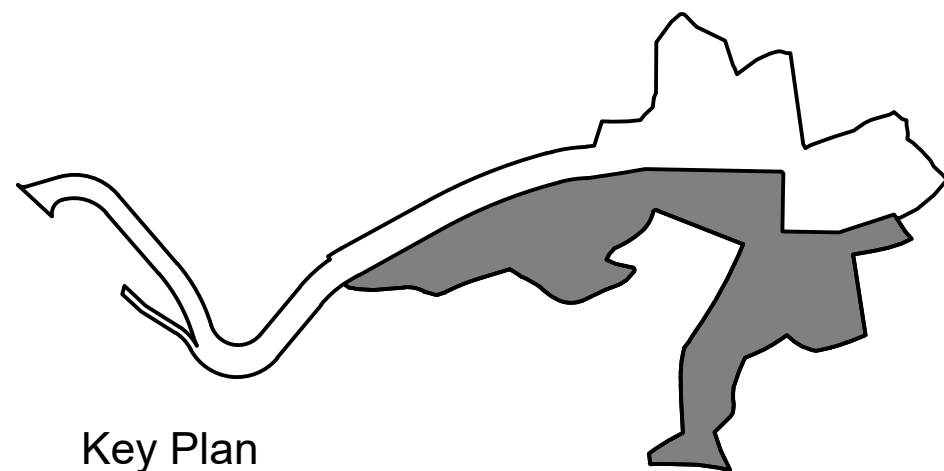

Key Plan
scale n.t.s.

1 : 750 (A3)

October 2025

Layout Plan of Columbarium Area

Rezoning Application from “AGR” and “GB” to “OU (Columbarium)”
on various Lots in D. D. 41
and Adjoining Government Land, Tong To, Sha Tau Kok, N.T.

**Goldrich Planners
& Surveyors Ltd.**

**Plan 5
(P 17106)**

2/F

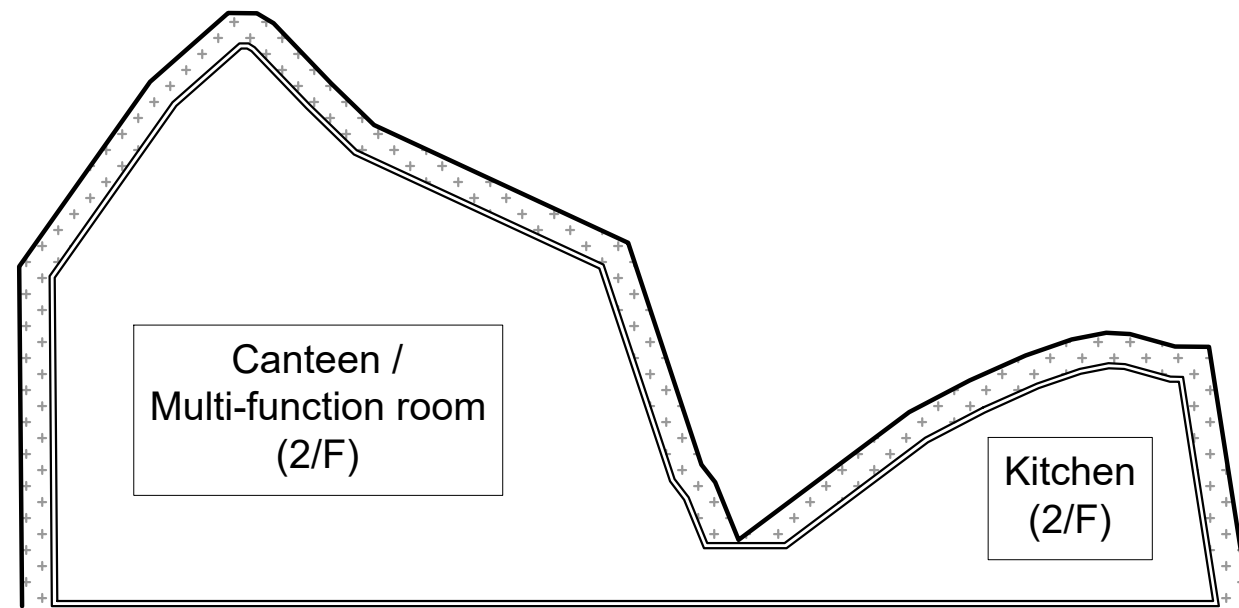

Key Plan
scale n.t.s.

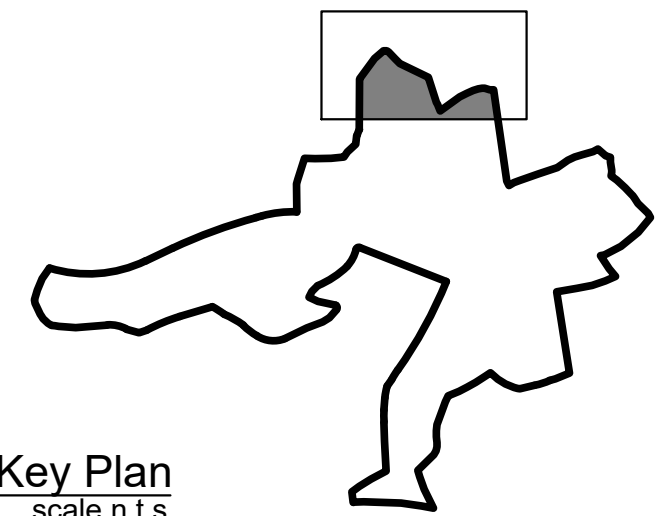

Legend

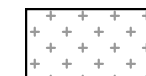

Plantation Area

1/F

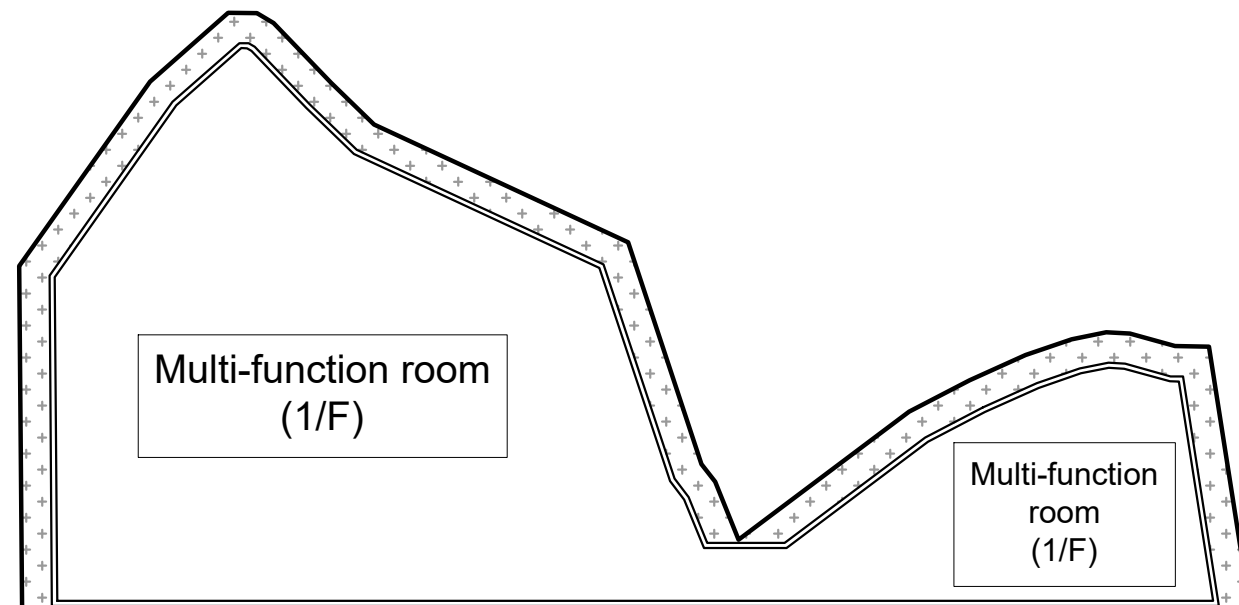

G/F

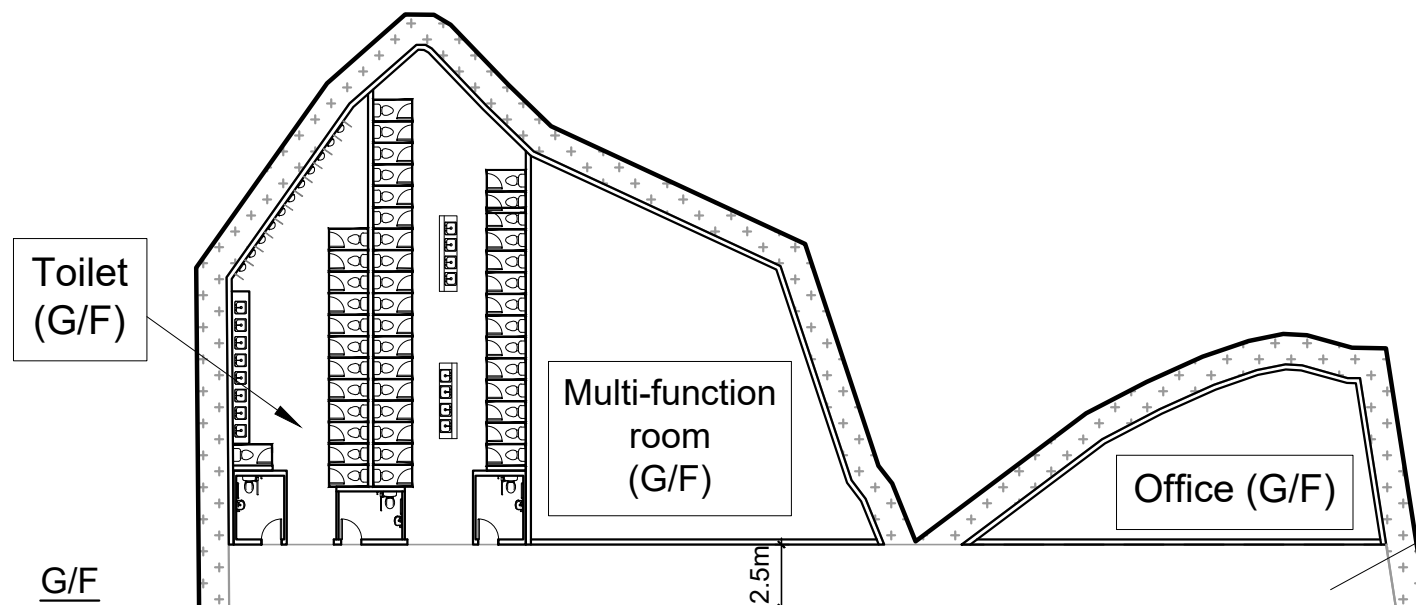

	Stairhood	Kitchen	Canteen / Multi-function room	Multi-function rooms	Toilet	Office
	Floor Area	Floor Area	Floor Area	Floor Area	Floor Area	Floor Area
G/F	--	--	--	146m²	206m²	78m²
1/F	--	--	--	546m²	--	--
2/F	--	128m²	418m²	--	--	--
R/F	16m²	--	--	--	--	--
Sub Total	16m²	128m²	1,110m²		206m²	78m²
Total	<u>1,538m²</u>					

1 : 300 (A3)

May 2025

Layout Plan of Ancillary Service Buildings

Rezoning Application from “AGR” and “GB” to “OU (Columbarium)”
on various Lots in D. D. 41
and Adjoining Government Land, Tong To, Sha Tau Kok, N.T.

Goldrich Planners &
Surveyors Ltd.

Plan 6
(P 17106)

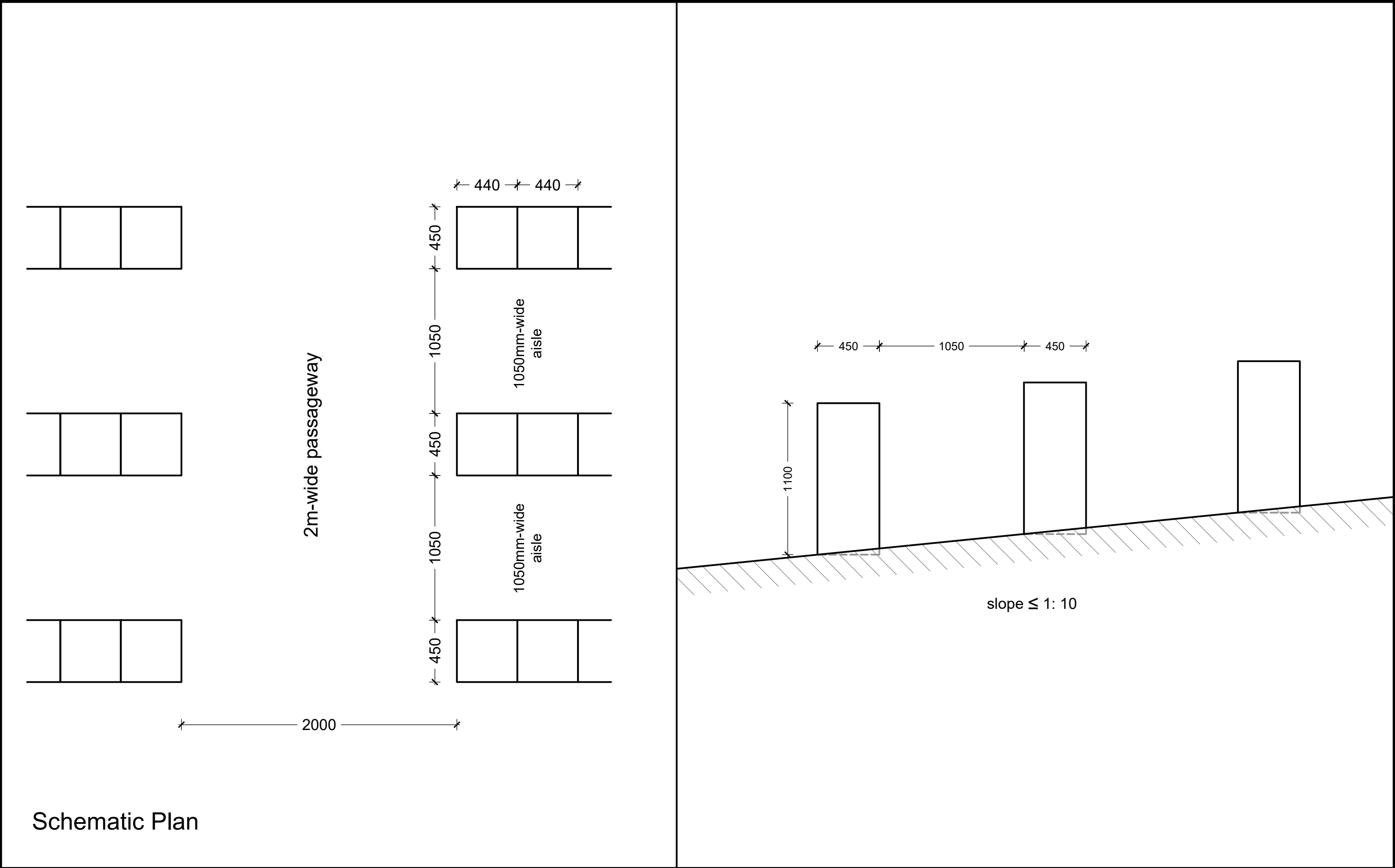

Schematic Plan

1 : 25(A3)	Schematic Design (At-grade niche block) (1) Rezoning Application from “AGR” and “GB” to “OU (Columbarium)” on various Lots in D. D. 41 and Adjoining Government Land, Tong To, Sha Tau Kok, N.T.	Goldrich Planners & Surveyors Ltd.
September 2025		Plan 7 (P 17106)

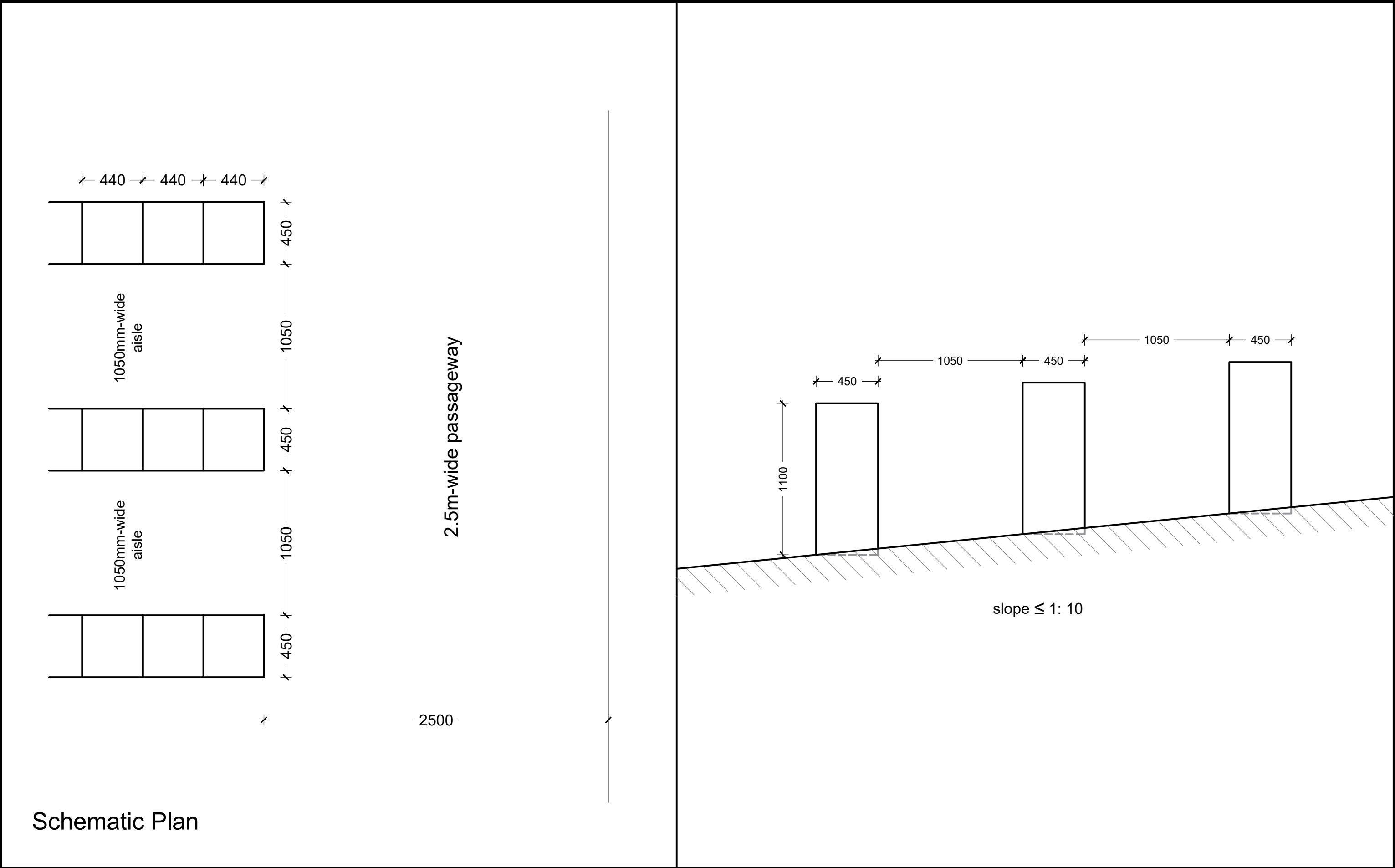

Schematic Plan

1 : 25(A3)	Schematic Design (At-grade niche block) (2) Rezoning Application from “AGR” and “GB” to “OU (Columbarium)” on various Lots in D. D. 41 and Adjoining Government Land, Tong To, Sha Tau Kok, N.T.	Goldrich Planners & Surveyors Ltd.
June 2025		Plan 8 (P 17106)

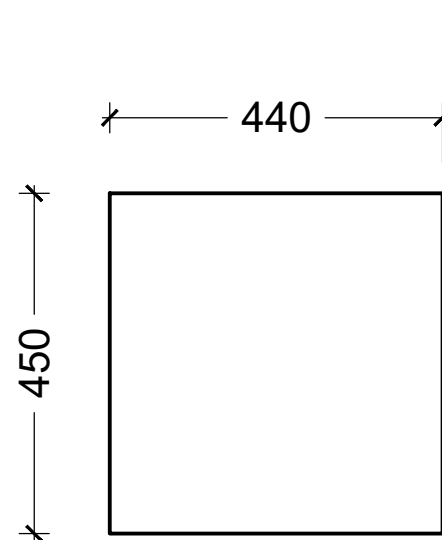

Top View

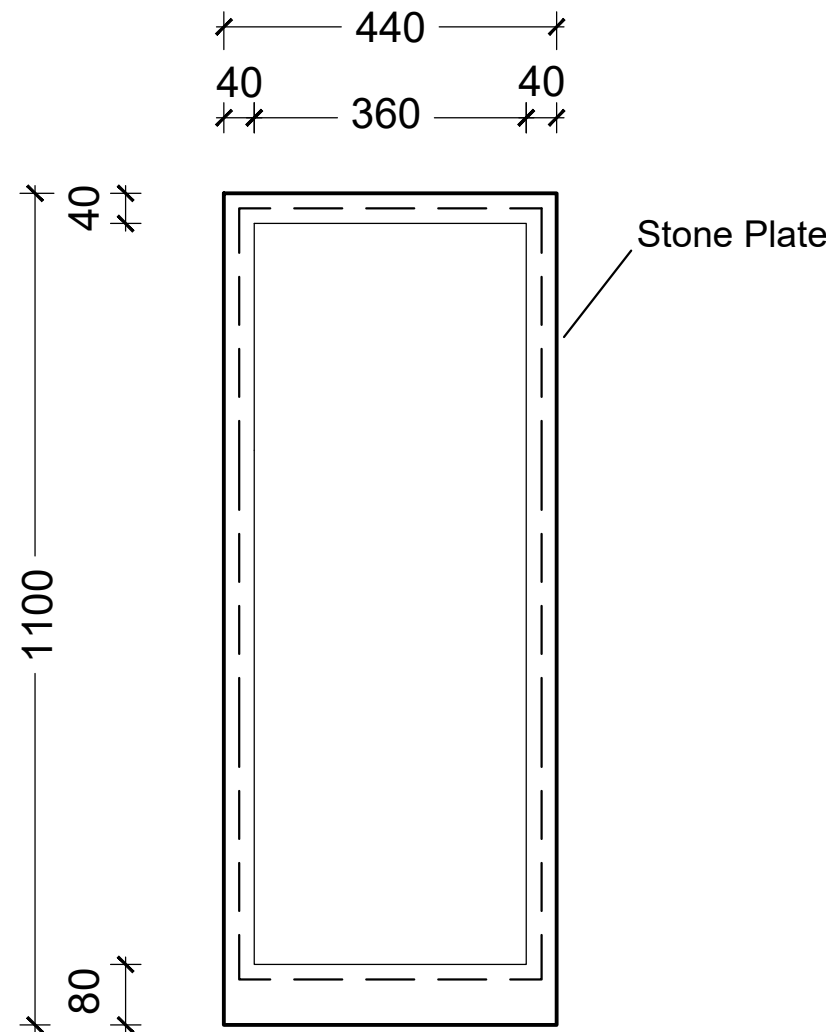

Front View

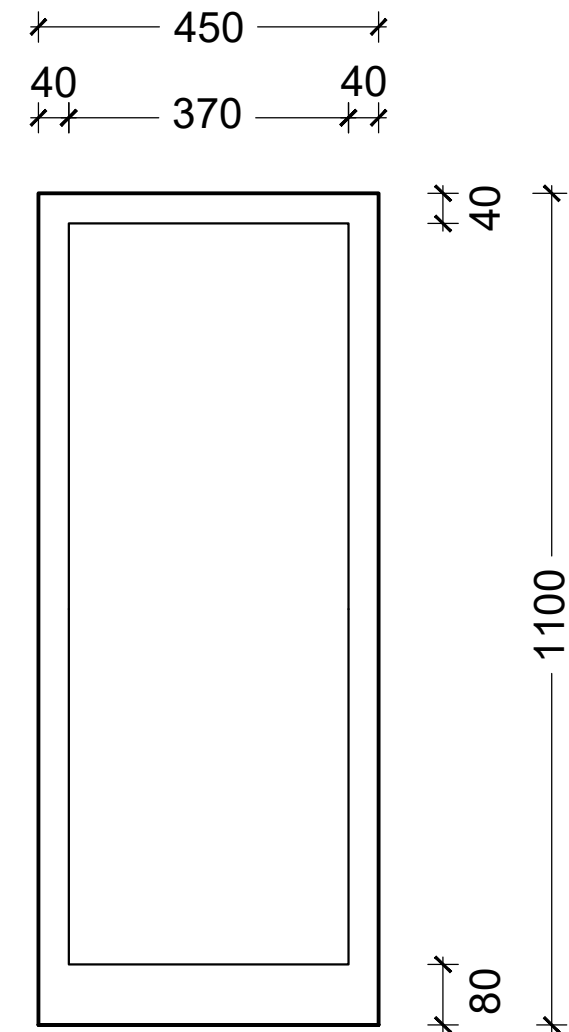

Section View

1 : 10	Schematic Design (At-grade niche block) (3) Rezoning Application from “AGR” and “GB” to “OU (Columbarium)” on various Lots in D. D. 41 and Adjoining Government Land, Tong To, Sha Tau Kok, N.T.	Goldrich Planners & Surveyors Ltd.
June 2025		Plan 9 (P 17106)

Total no. of niches in at-grade niche blocks

Area A		
Row no.	No. of niche blocks	No. of niches
1	33	33
2	27	27
3	20	20
4	16	16
5	16	16
6	18	18
7	22	22
8	27	27
9	30	30
10	32	32
11	32	32
12	32	32
13	31	31
14	31	31
15	33	33
16	33	33
17	34	34
18	35	35
19	36	36
20	37	37
21	37	37
22	38	38
23	39	39
24	39	39
25	44	44
26	49	49
27	53	53
28	55	55
29	58	58
30	3	3
31	23	23
32	36	36
33	49	49
34	117	117
35	114	114
36	112	112
37	110	110
38	107	107
Sub total	1,658	1,658

Block Area	Number of niche
Area A	1,658
Area B	2,471
Area C	1,417
Area D	658
Area E	291
Total	6,495

Area B		
Row no.	No. of niche blocks	No. of niches
39	100	100
40	97	97
41	95	95
42	93	93
43	90	90
44	89	89
45	86	86
46	85	85
47	82	82
48	80	80
49	79	79
50	76	76
51	74	74
52	74	74
53	44	44
54	43	43
55	41	41
56	40	40
57	38	38
58	37	37
59	46	46
60	55	55
61	64	64
62	73	73
63	83	83
64	101	101
65	101	101
66	101	101
67	101	101
68	101	101
69	101	101
70	101	101
Sub total	2,471	2,471

Area C		
Row no.	No. of niche blocks	No. of niches
71	6	6
72	17	17
73	29	29
74	40	40
75	53	53
76	67	67
77	73	73
78	62	62
79	56	56
80	58	58
81	59	59
82	61	61
83	64	64
84	68	68
85	50	50
86	50	50
87	50	50
88	49	49
89	47	47
90	42	42
91	36	36
92	24	24
93	12	12
94	17	17
95	24	24
96	30	30
97	36	36
98	20	20
99	2	2
100	15	15
101	16	16
102	17	17
103	22	22
104	27	27
105	31	31
106	33	33
107	27	27
108	18	18
109	9	9
Sub total	1,417	1,417

Area D		
Row no.	No. of niche blocks	No. of niches
110	6	6
111	13	13
112	20	20
113	29	29
114	40	40
115	51	51
116	65	65
117	47	47
118	43	43
119	39	39
120	36	36
121	32	32
122	28	28
123	23	23
124	27	27
125	31	31
126	36	36
127	30	30
128	22	22
129	14	14
130	6	6
131	10	10
132	7	7
133	3	3
Sub total	658	658

Area E		
Row no.	No. of niche blocks	No. of niches
134	4	4
135	10	10
136	51	51
137	46	46
138	40	40
139	34	34
140	28	28
141	22	22
142	16	16
143	10	10
144	4	4
145	26	26
Sub total	291	291

Total nos. of niches

Rezoning Application from “AGR” and “GB” to “OU (Columbarium)”
on various Lots in D. D. 41 and Adjoining Government Land, Tong To, Sha Tau Kok, N.T.

Goldrich Planners &
Surveyors Ltd.

Plan 10
(P 17106)

September 2025

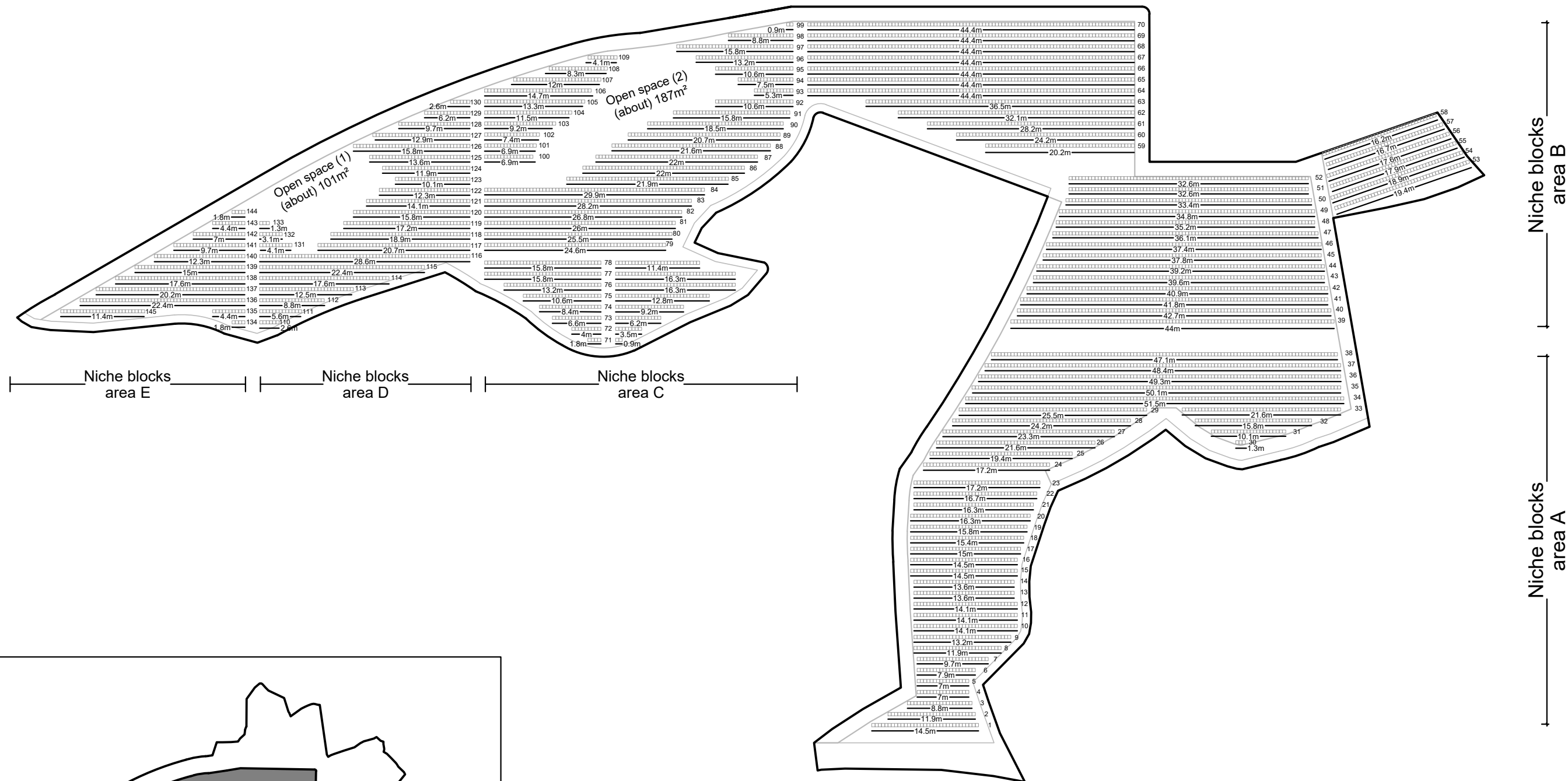
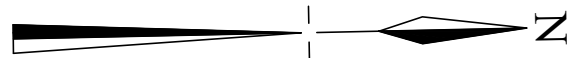

Key Plan
scale n.t.s.

1 : 600 (A3)

October 2025

Columbarium Area - niche count plan

Rezoning Application from “AGR” and “GB” to “OU (Columbarium)”
on various Lots in D. D. 41
and Adjoining Government Land, Tong To, Sha Tau Kok, N.T.

Goldrich Planners
& Surveyors Ltd.

Plan 11
(P 17106)

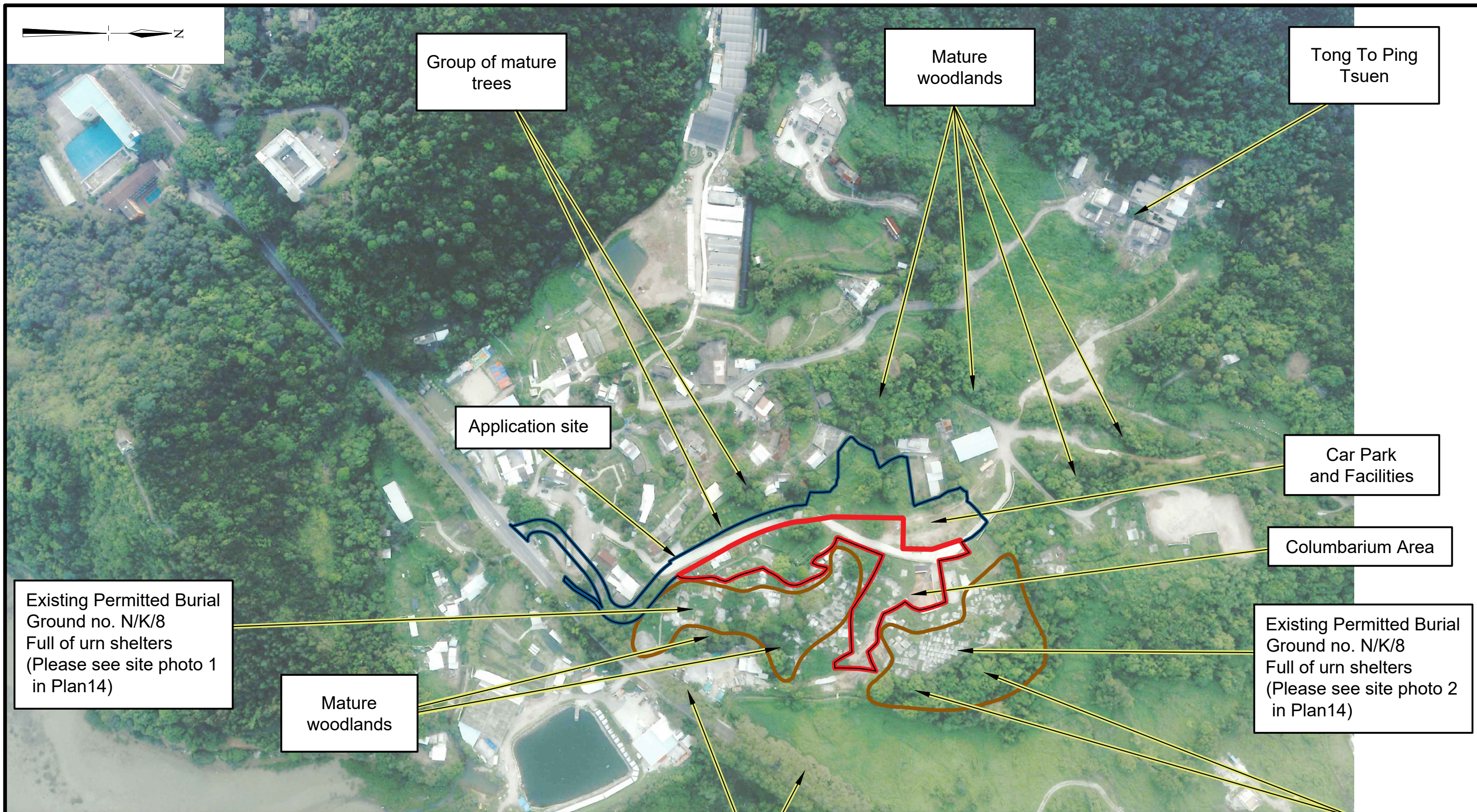

Extracted from aerial photograph Ref. No. E024251C
dated 29.4.2017 from the Survey and Mapping Office

Not to Scale	Aerial Photo Rezoning Application from "AGR" and "GB" to "OU (Columbarium)" on various Lots in D. D. 41 and Adjoining Government Land, Tong To, Sha Tau Kok, N.T.	Goldrich Planners & Surveyors Ltd.
October 2025		Plan 12 (P 17106)



Permitted Burial Ground 1



Permitted Burial Ground 2

Not to scale

**Site photos of existing urn shelters in
permitted burial ground no. N/K/8**

**Goldrich Planners &
Surveyors Ltd.**

June 2025

Rezoning Application from "AGR" and "GB" to "OU (Columbarium)"
on various Lots in D. D. 41
and Adjoining Government Land, Tong To, Sha Tau Kok, N.T.

**Plan 13
(P 17106)**

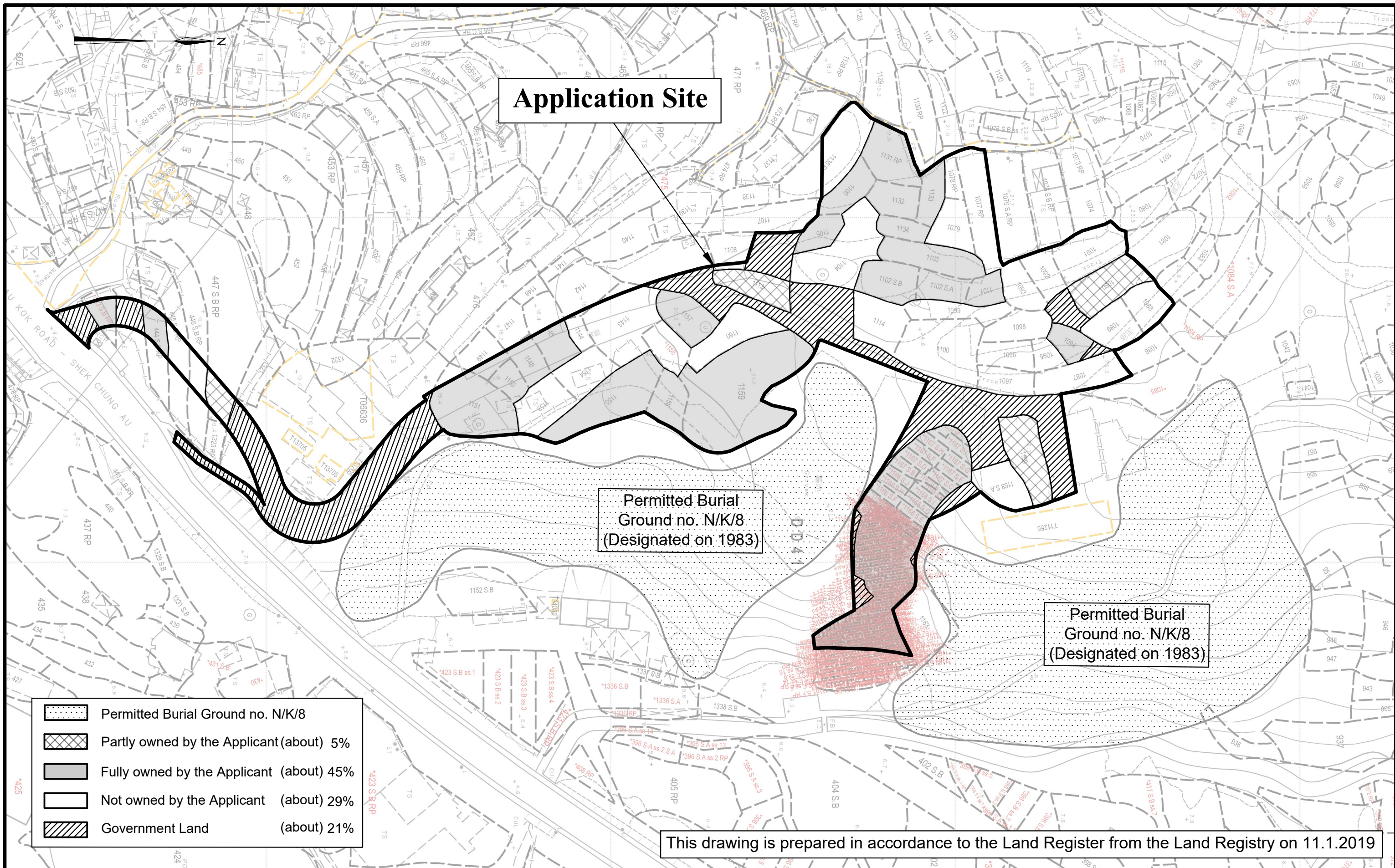

This drawing is prepared in accordance to the Land Register from the Land Registry on 11.1.2019

1 : 1000 (A3)	Land Ownership Plan Rezoning Application from “AGR” and “GB” to “OU (Columbarium)” on various Lots in D. D. 41 and Adjoining Government Land, Tong To, Sha Tau Kok, N.T.	Goldrich Planners & Surveyors Ltd.
September 2025		Plan 14 (P 17106)

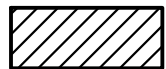
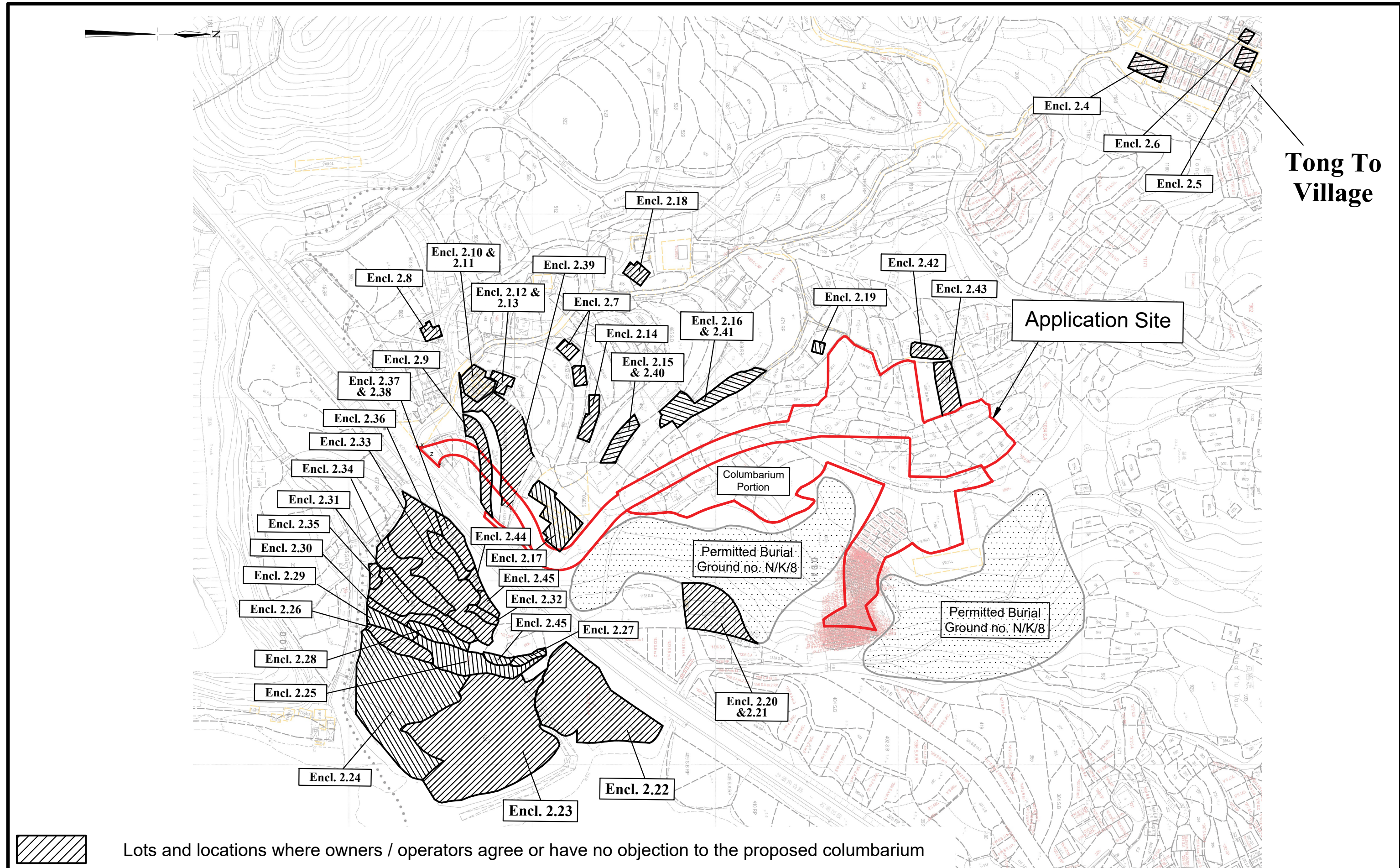

Lots and locations where owners / operators agree or have no objection to the proposed columbarium

Not to Scale

October 2025

Plan Showing Lots and Locations Where Owners / Operators Support or Have No Objection to the Previous Proposed Columbarium

Rezoning Application from "AGR" and "GB" to "OU (Columbarium)"
on various Lots in D. D. 41
and Adjoining Government Land, Tong To, Sha Tau Kok, N.T.

Goldrich Planners
& Surveyors Ltd.

Plan 15
(P 17106)

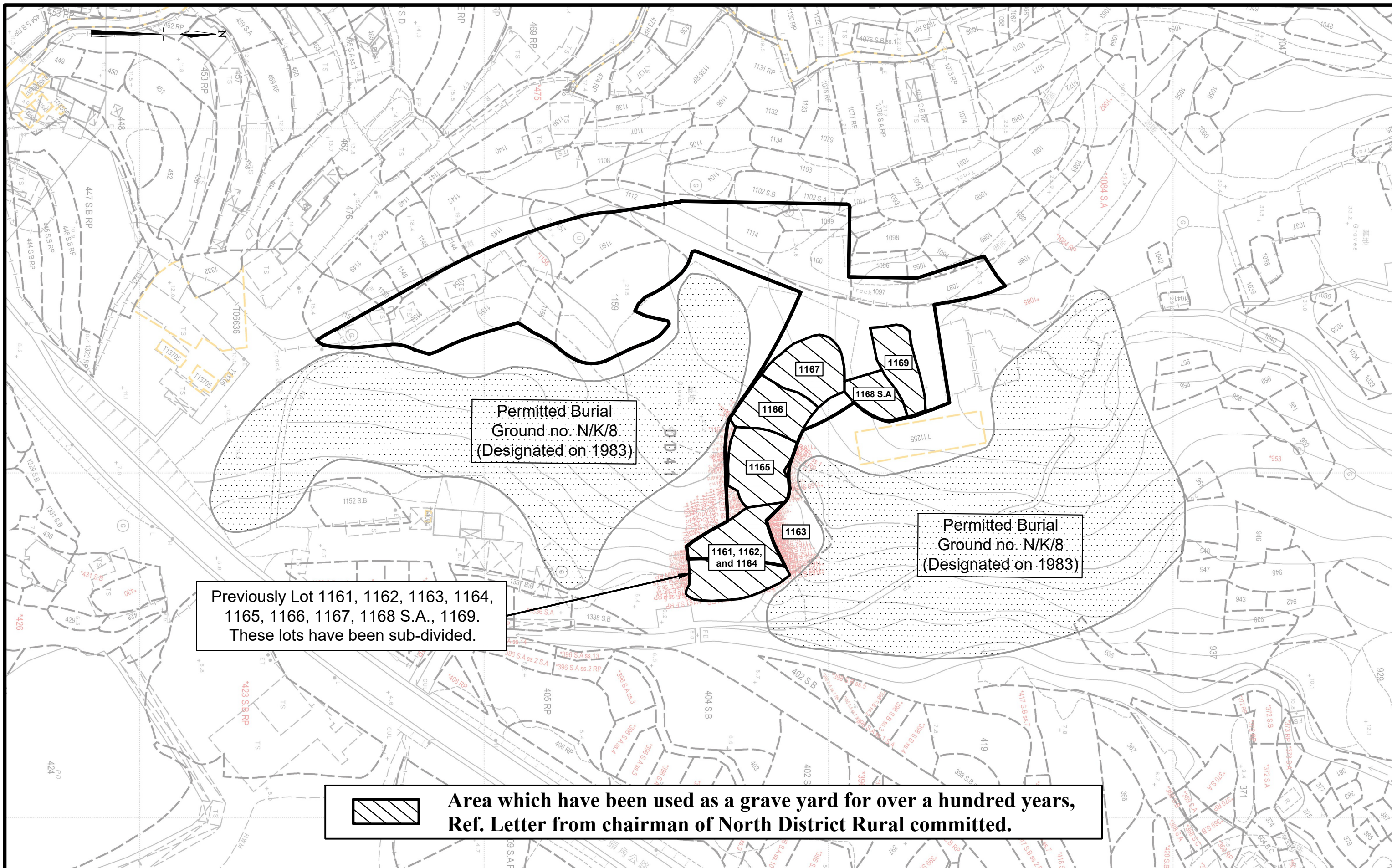

1 : 1000 (A3)	Lots mentioned in the letter from the Chairman of Sha Tau Tok Rural Committee, N.T. to the Town Planning Board dated 3.6.2015	Goldrich Planners & Surveyors Ltd.
October 2025		

Rezoning Application from “AGR” and “GB” to “OU (Columbarium)”
on various Lots in D. D. 41
and Adjoining Government Land, Tong To, Sha Tau Kok, N.T.

Plan 16
(P 17106)

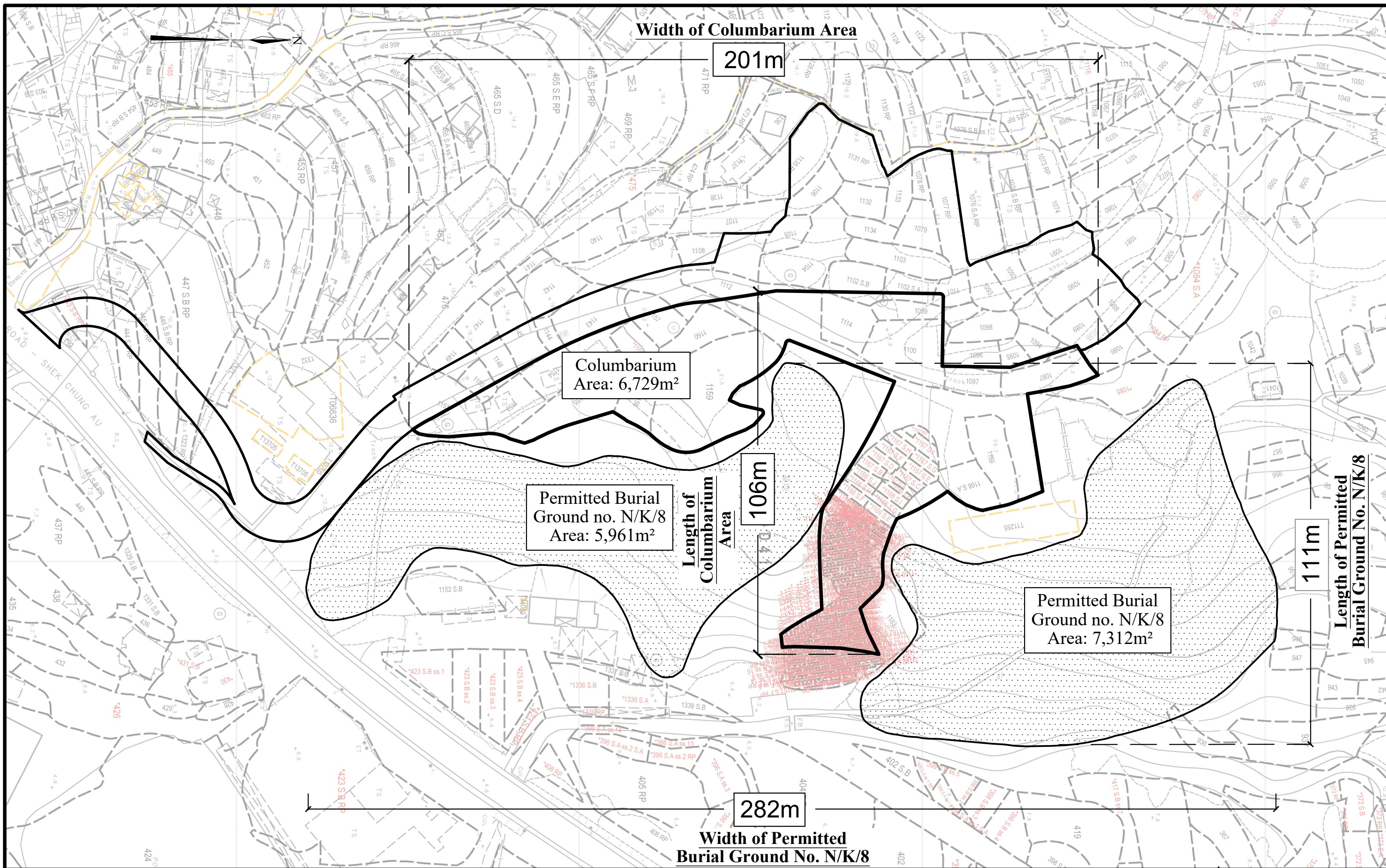

Dimension and Area Comparison of Existing Permitted Burial Ground and Proposed Columbarium

Rezoning Application from "AGR" and "GB" to "OU (Columbarium)"
on various Lots in D. D. 41
and Adjoining Government Land, Tong To, Sha Tau Kok, N.T.

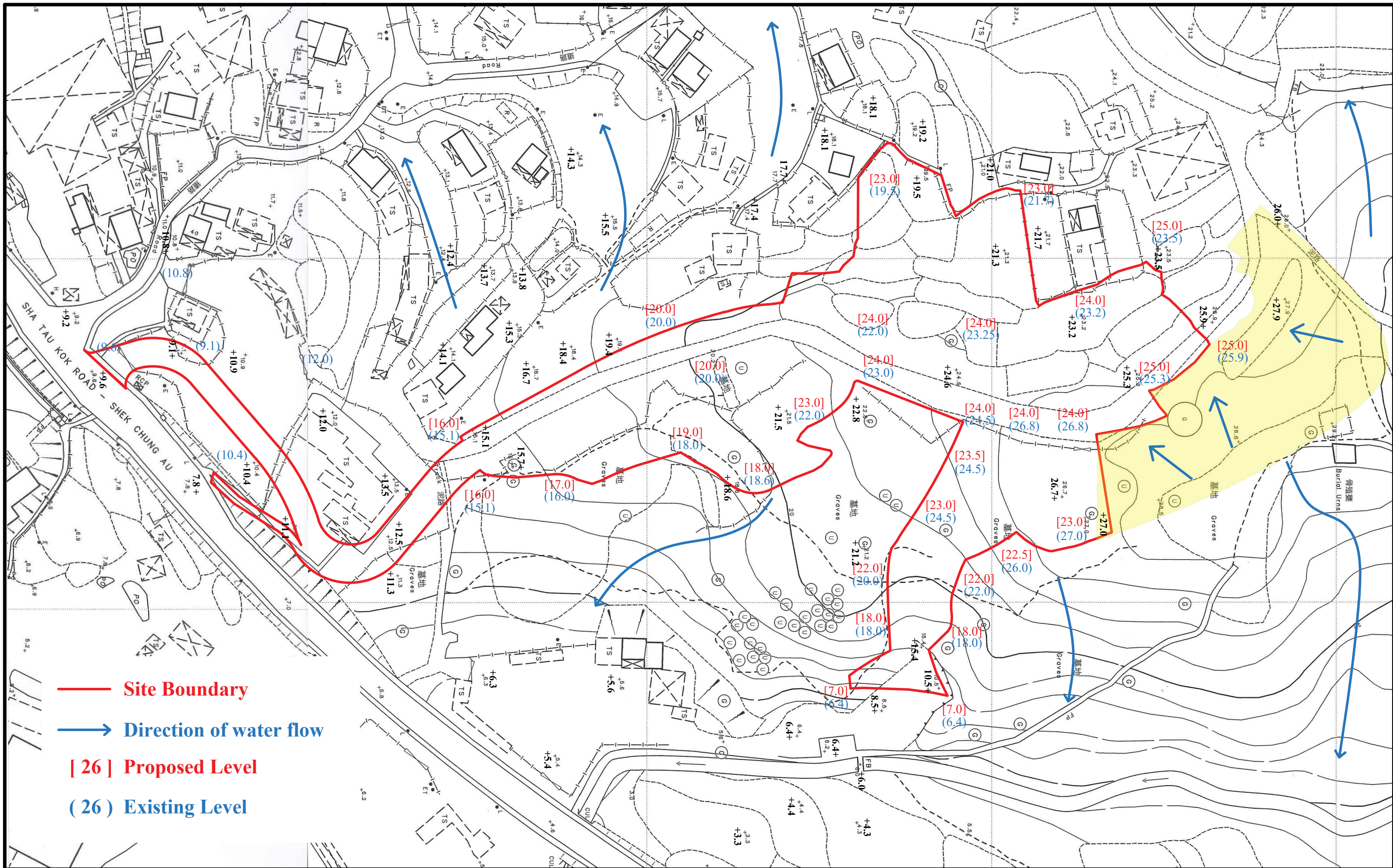

1 : 1000

October 2025

Existing and Proposed Site Formation Level

Rezoning Application from “AGR” and “GB” to “OU (Columbarium)”
on various Lots in D. D. 41
and Adjoining Government Land, Tong To, Sha Tau Kok, N.T.

Goldrich Planners
& Surveyors Ltd.

Plan 18
(P 17106)

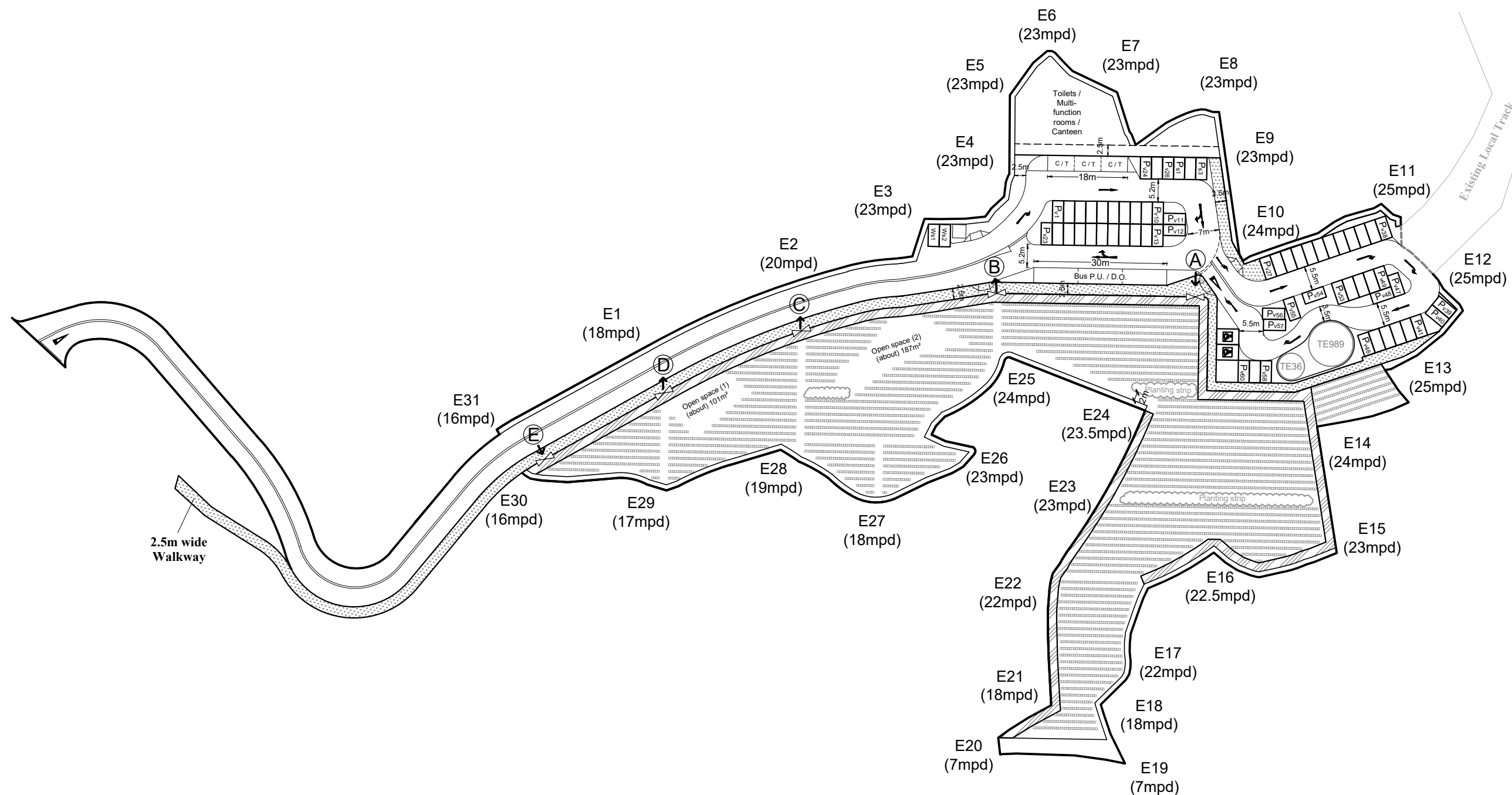
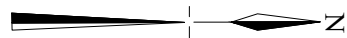

1 : 1000 (A3)

October 2025

Proposed Site Formation Level

Rezoning Application from “AGR” and “GB” to “OU (Columbarium)”
on various Lots in D. D. 41
and Adjoining Government Land, Tong To, Sha Tau Kok, N.T.

Goldrich Planners
& Surveyors Ltd.

Plan 19
(P 17106)

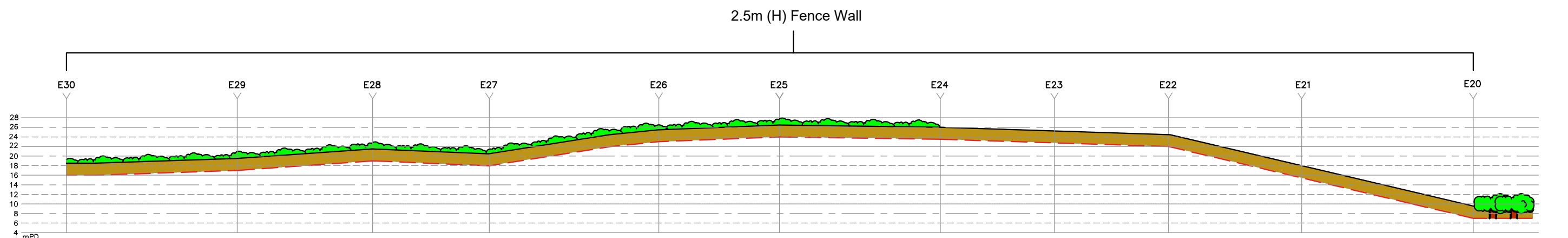
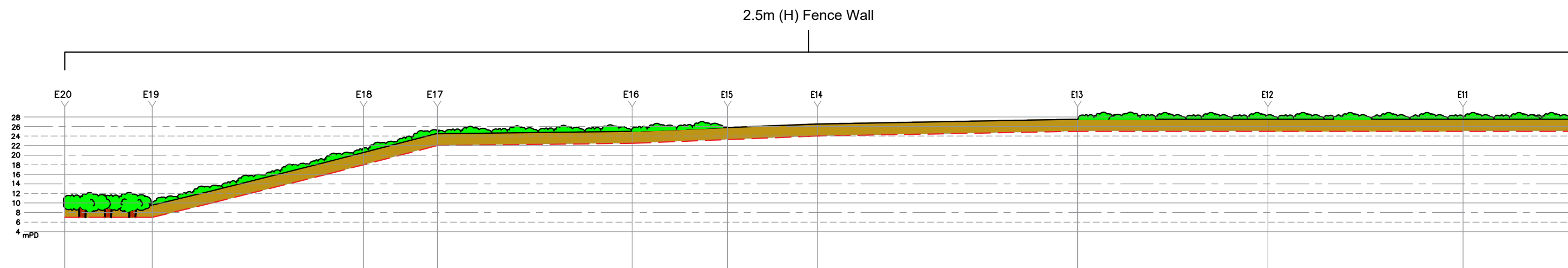
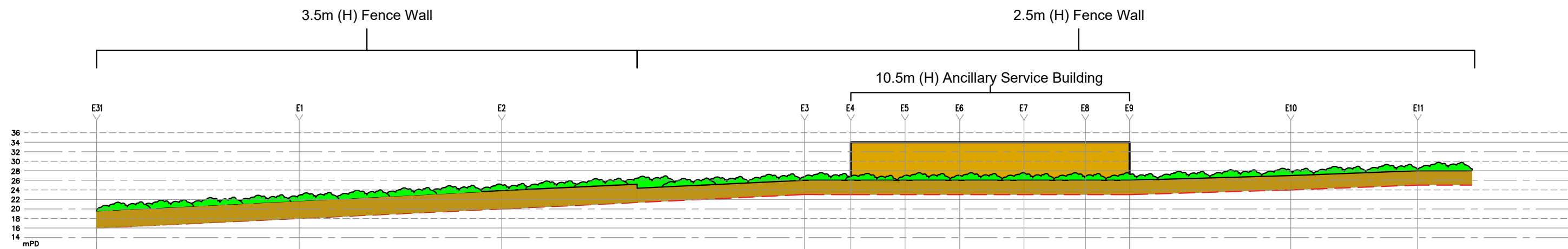

Legend

--- Proposed

Not to Scale

October 2025

Proposed Site Formation Level (Section)

Rezoning Application from “AGR” and “GB” to “OU (Columbarium)”
on various Lots in D. D. 41
and Adjoining Government Land, Tong To, Sha Tau Kok, N.T.

Goldrich Planners
& Surveyors Ltd.

Plan 20
(P 17106)

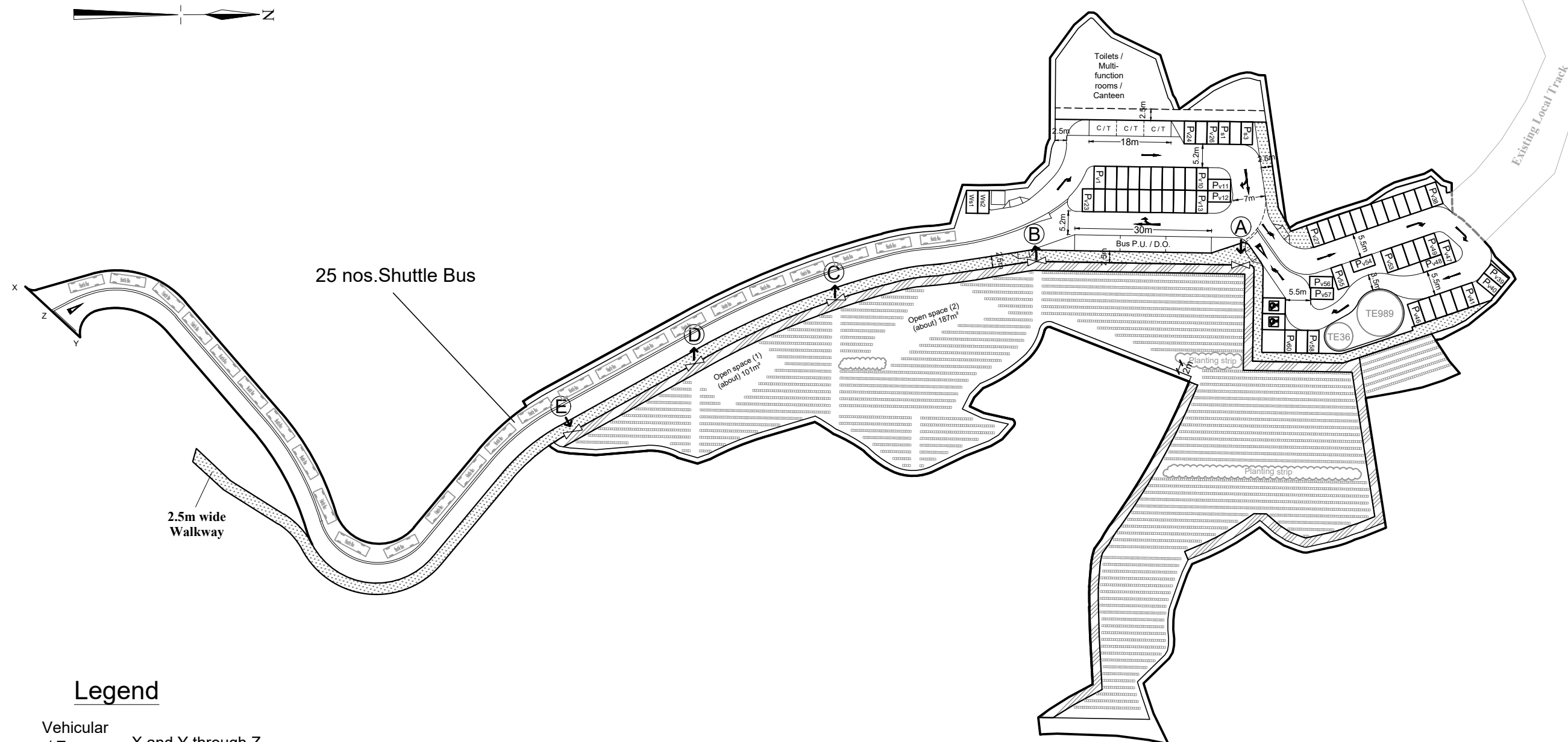
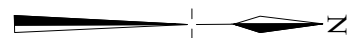

Legend

Vehicular
Ingress / Egress: X and Y through Z

Shuttle Bus Lay-by for Shuttle Buses

C / T Pick-up/drop-off Point for Private cars / Taxis (18m (L))

WS Private Car Waiting Spaces (2.5m x 5m each)

Pv Private Car Parking Spaces for Visitors (2.5m x 5m each)

Ps Private Car Parking Spaces for Staffs (2.5m x 5m each)

Private Car Parking Spaces for Visitors (Disabled Persons) (3.5m x 5m each)

Pedestrian access

2.1m x 7.7m Shuttle Bus

Ancillary Parking Facilities							
	Private Car Parking Spaces for Visitors	Private Car Parking Spaces for Visitors (Disabled Persons)	Total Private Car Parking Space for Visitors	Private Car Parking Spaces for staffs	Private Car Waiting Spaces	Pick-up/drop-off Point for Private cars / Taxis	Lay-by for Shuttle Buses
Car park A	26	-	62	3	2	3	3
Car park B	34	2		-	-	-	-
Total	60	2	62	3	2	3	3
Niche count							
				No. of niches			
At-grade niche blocks				6,495 nos. x 1 = 6,495			

1 : 1000 (A3)

Plan showing the number of coaches that can be accommodated on the driveway

Goldrich Planners
& Surveyors Ltd.

October 2025

Rezoning Application from “AGR” and “GB” to “OU (Columbarium)”
on various Lots in D. D. 41
and Adjoining Government Land, Tong To, Sha Tau Kok, N.T.

Plan 21
(P 17106)

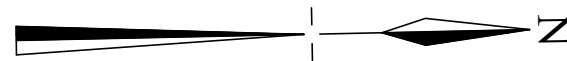

1.2m wide
plantation area

Open space (1)
(about) 101m²

Open space (2)
(about) 187m²

1.2m wide
plantation area

3.5m(H)
2m(W)
Passageway

2m Passageway

2.5m(H) x 0.08m(W)
fence wall

3.5m wide plantation area

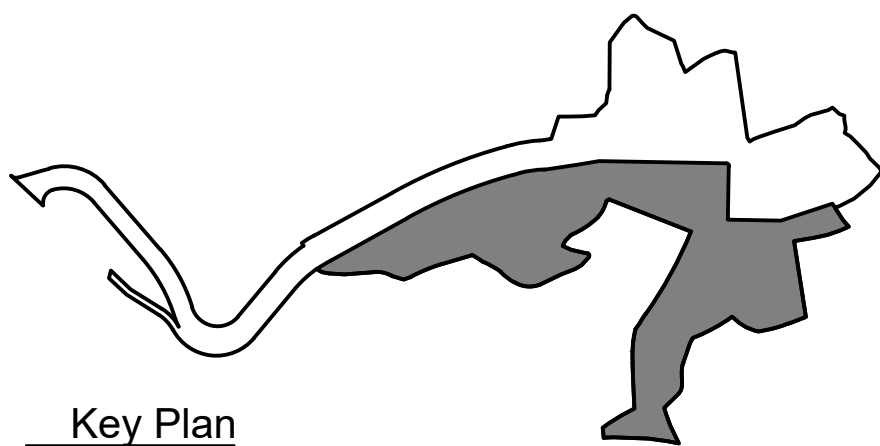

Key Plan
scale n.t.s.

1 : 600 (A3)

October 2025

Pedestrian Flow Direction

Rezoning Application from “AGR” and “GB” to “OU (Columbarium)”
on various Lots in D. D. 41
and Adjoining Government Land, Tong To, Sha Tau Kok, N.T.

Goldrich Planners
& Surveyors Ltd.

Plan 22
(P 17106)